

TH-1040-CTS
TH-1040-CTL

Installation Instructions

telehook

Ceiling Tilt Short Mount / Ceiling Tilt Long Mount

Component Checklist



Ceiling Plate



Ceiling Plate Cover



Small VESA Plate

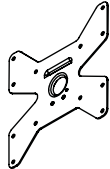

Large VESA Plate

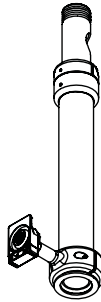

Pole Assembly



Tension Tool

Hardware



Coach Screw (x4)



Nylon Anchor (x4)



M4/5 Spacer (x4)



Security Screw

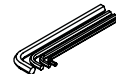

2/2.5/3/5mm
Allen Key



M4/5/10 Washer
(x4 each)



M5/6 Spacer (x4)



Set Screw



M4x16/25mm (x4 each)



M5x16/25mm (x4 each)



M6x16/30mm (x4 each)

Display Mounting Screws

Tools Required:

- Power Drill
- 7mm (0.28") Drill Bit
- 12mm (0.5") Masonry Drill Bit
- Phillips Head Screw Driver
- 17mm (0.67") Socket Wrench or Shifter

IMPORTANT INFORMATION:

- ! **IMPORTANT - Install Telehook 1040 Ceiling Tilt Mount (Short/Long) as per Installation Instructions.**
- ! This product supports a maximum load of 25kg (55lbs).
- ! This product supports VESA mounting hole configurations: Small VESA plate, 75x75mm (3"x3") and 100x100mm (4"x4"). Large VESA plate, 100x100mm (4"x4"), 200x100mm (8"x4") and 200x200mm (8"x8").
- ! The manufacturer accepts no responsibility for incorrect installation.

Step 1. Check Components

Check you have received all parts against the component checklist and Hardware above.

Step 2. Install Ceiling Plate

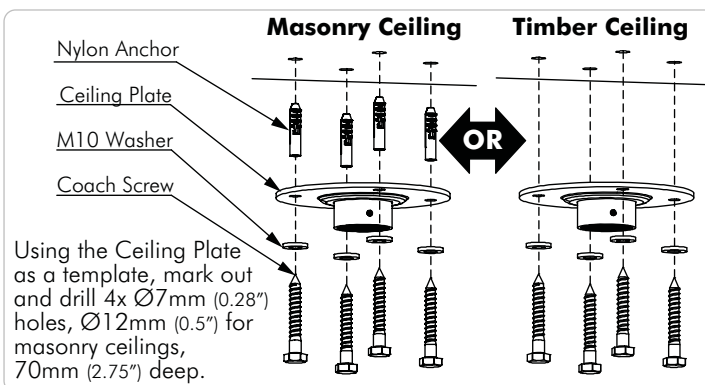

Step 3. Install Ceiling Plate Cover

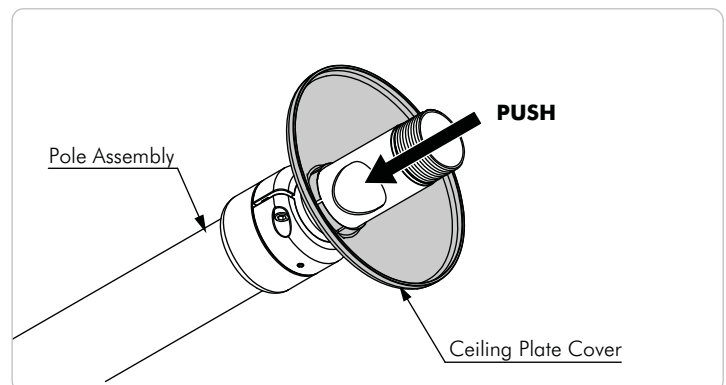

Step 4. Attach Pole Assembly to Ceiling Plate

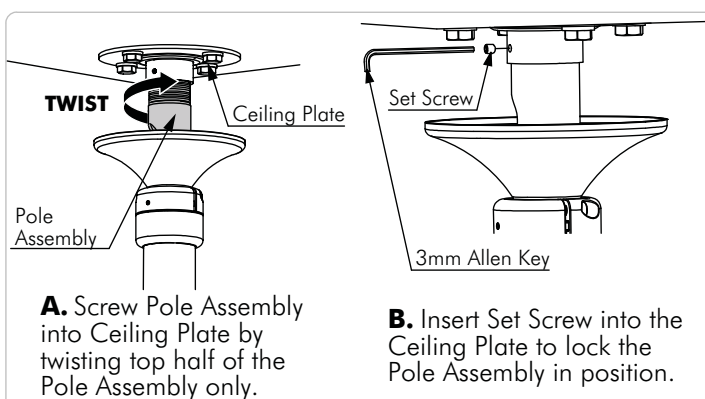

Step 5. Position Ceiling Plate Cover

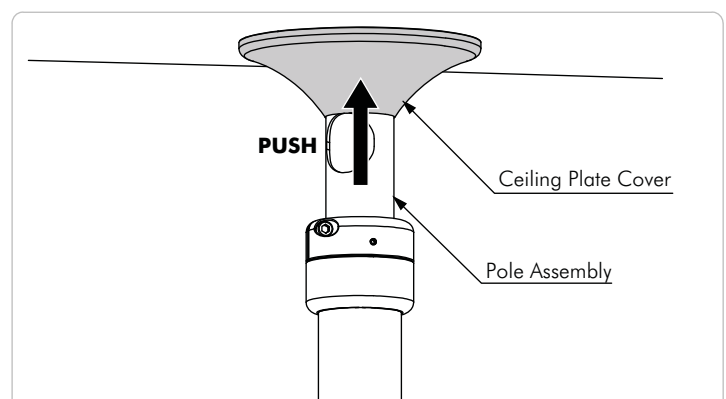

Step 6. Set Height of Pole

A. Loosen (do not remove) Socket Cap Screws x2. Support lower half of Pole Assembly whilst loosening.

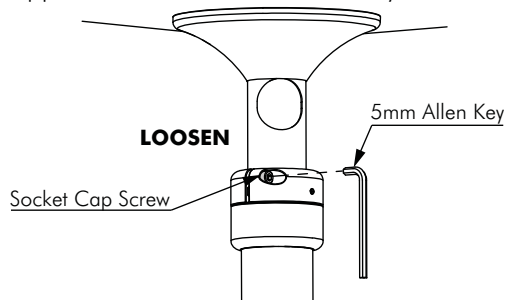

B. Slide lower half of Pole Assembly to the desired height.

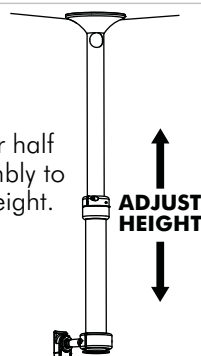

C. Once at the desired height, tighten the Socket Cap Screws (x2).

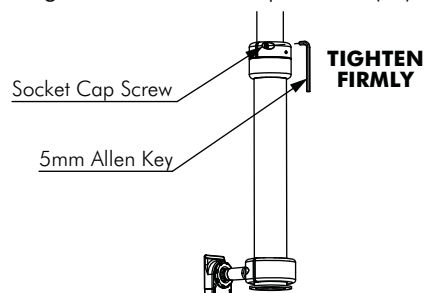

Step 7. Centralise Pole Joint

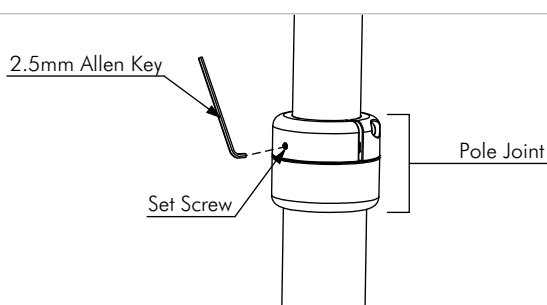

If necessary, centralise the Pole Joint by tightening the Set Screws (x2) to suit.

Step 8. Attach VESA Plate to Display

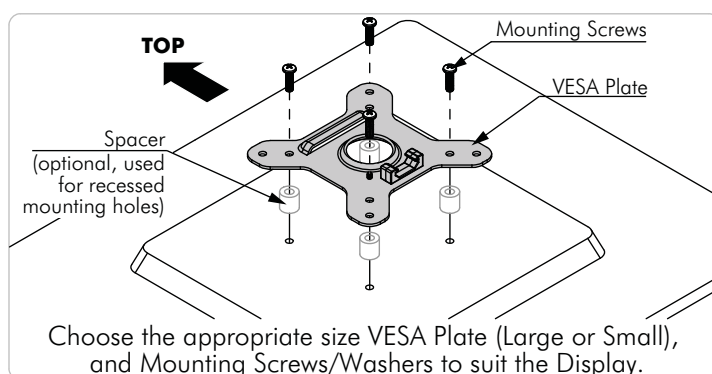

Step 9. Attach Display to Pole Assembly

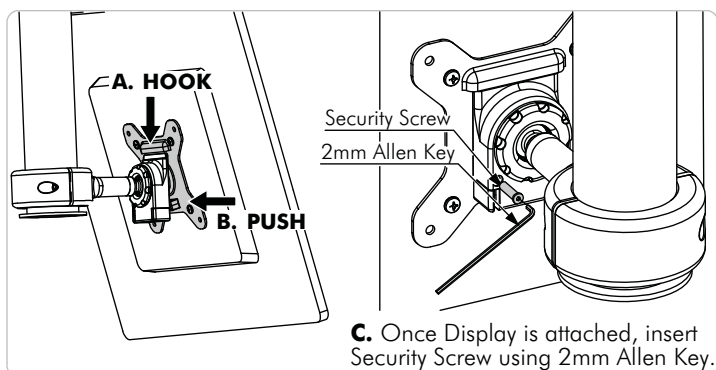

Step 10. Cable Management

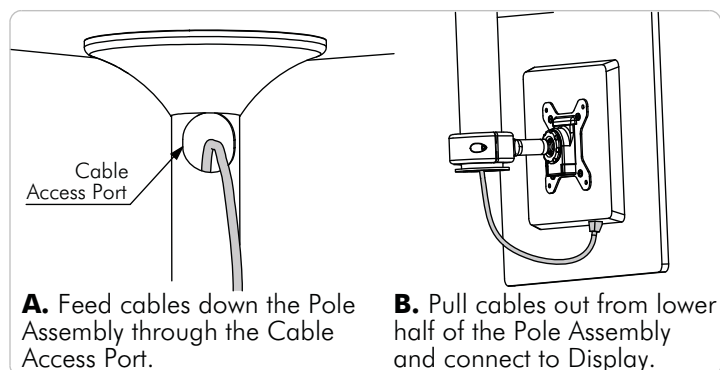

Step 11. Height Adjustment

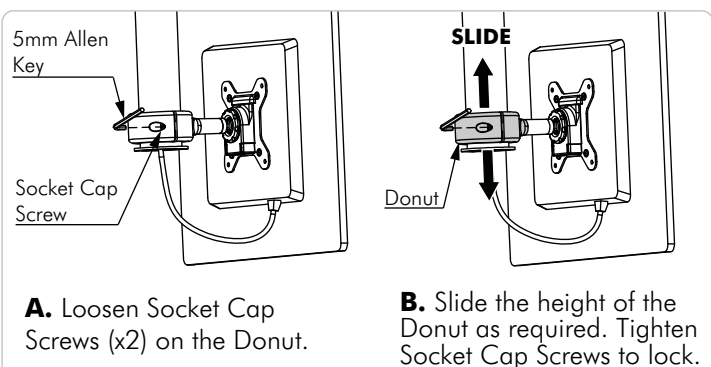

Step 12. Final Adjustment

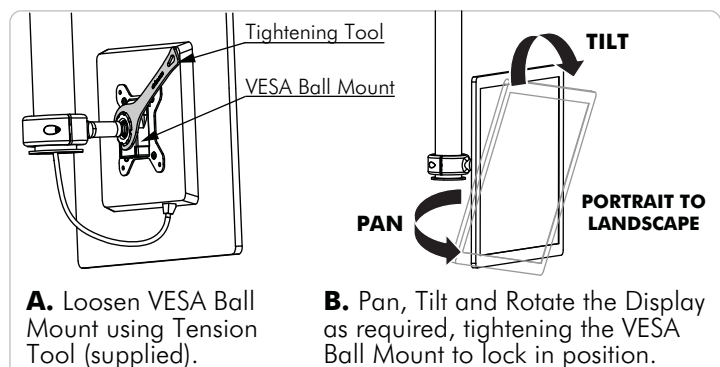

Installation Complete

