

MICROWAVE IN-A-DRAWER™

INSTALLATION INSTRUCTIONS



Model MMDV30S

For Use With:

MMDV30S
MMD30
MMD24

Table of Contents

Important Safety Instructions	E1	24" Drawer Measurements.....	E3
What You Need to Know About Safety		30" Drawer Measurements.....	E4
Instructions	E1	Anti-tip Block	E5
Safety Symbols and Labels	E1	Installation Instructions.....	E5-E6
Installation Requirements	E2	Verifying Package Contents.....	E5
Important Notes To The Installer	E2	Electrical Outlet.....	E5
Important Notes To The Consumer.....	E2	Drawer Installation	E6
Grounding Instructions.....	E2	Model and Serial Number Location	E6
Design Specifications	E3-E5	Care, Cleaning and Maintenance.....	E6
Clearances and Dimensions.....	E3	Before You Call for Service.....	E6

IMPORTANT SAFETY INSTRUCTIONS

WARNING

- If the information in this manual is not followed exactly, a fire or electrical shock may result that could cause property damage, personal injury or death.
- To reduce the risk of tipping, the Microwave In-A-Drawer™ must be secured by a properly installed anti-tip block.
- This drawer must be electrically grounded in accordance with local codes.
- Make sure the wall coverings and the cabinets around the drawer can withstand the heat generated by the microwave.
- **Never leave children alone or unattended in the area where a microwave is in use.** Never leave the drawer open when the microwave is unattended.
- Stepping, leaning or sitting on the drawer may result in serious injuries and can also cause damage to the Microwave In-A-Drawer™.
- **Do not use the drawer as a storage space.** Doing so creates a potentially hazardous situation.
- Check that the time-of-day is on the display. If not, touch **STOP/CLEAR** to prevent unintended use.

WHAT YOU NEED TO KNOW ABOUT SAFETY INSTRUCTIONS

Warnings and Important Safety Instructions appearing in this guide are not meant to cover all possible conditions and situations that may occur. Always use common sense, caution and care when installing, maintaining or operating this appliance.

Always contact Dacor® about problems or conditions you do not understand.

SAFETY SYMBOLS AND LABELS

DANGER

Immediate hazards that **WILL** result in severe personal injury or death.

WARNING

Hazards or unsafe practices that **COULD** result in severe personal injury or death.

CAUTION

Hazards or unsafe practices that **COULD** result in minor personal injury or property damage.

Installer: Leave these instructions with the appliance.

Customer: Please read and keep these installation instructions for future reference. This guide provides proper installation information.

If you have any questions, call:

Dacor Customer Service

1-800-793-0093 (U.S.A. and Canada)

Monday — Friday 6:00 AM to 5:00 PM Pacific Time

Web site: www.Dacor.com

Have the complete model and serial number identification of your appliance ready. These numbers are found on a serial number plate, located on the faceplate behind the drawer front. See page 6.

Installation Requirements

The importance of the proper installation of your new appliance cannot be overemphasized. Installation should be done by a qualified installer.

Before you begin the installation process, read this entire installation instruction manual. It contains information necessary for proper, safe installation.

Any questions or problems with the installation should be directed to your Dacor dealer or the Dacor Customer Service Department at 800.793.0093. You can also visit our web site at www.Dacor.com.

IMPORTANT NOTES TO THE INSTALLER

- Read all of the installation instructions before installing the Microwave In-A-Drawer™.
- Remove all packing material before connecting the electrical supply.
- Observe all governing codes and ordinances.
- Be sure to leave these instructions with the consumer.

IMPORTANT NOTES TO THE CONSUMER

Keep these instructions with your use & care manual for future reference.

- When using any microwave oven generating heat, there are certain safety precautions you should follow, that are listed in the use & care manual. Read the use and care manual and follow all safety precautions carefully.
- Be sure your Microwave In-A-Drawer™ is installed and grounded properly by a qualified installer or service technician.

For SAFETY CONSIDERATIONS do not install the drawer in any combustible cabinetry, which is not in accord with the stated clearances and dimensions on pages 3, 4 and 5. See **Figure 2** (for 24") or **Figures 4 and 5** (for 30").

GROUNDING INSTRUCTIONS

WARNING

Improper use of the grounding plug can result in a risk of electric shock.

This appliance is equipped with a three-prong grounding plug for your protection against possible electric shock hazards. It must be plugged into a grounded wall receptacle. If only a two-prong wall receptacle is available, it is the responsibility of the customer to have it replaced with a properly grounded three-prong wall receptacle. **Do not under any circumstances, cut or remove the third (ground) prong from the power cord.** Do not use an adapter plug. Do not use an extension cord. If the power supply cord is too short, have a qualified electrician or serviceman install an outlet near the appliance. **Do not use a Ground Fault Circuit Interrupter.**

Power supply cord with three-prong grounding plug

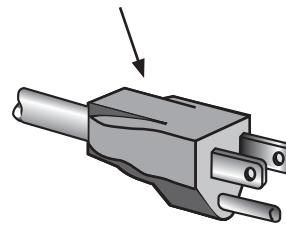

Grounding type wall receptacle (ground fault circuit not allowed)

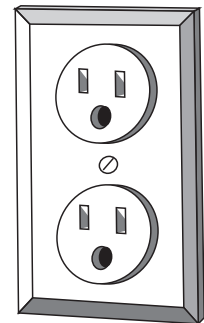

Design Specifications

CLEARANCES AND DIMENSIONS

- Dimensions that are shown in **Figures 2, 4 and 5** must be used. Given dimensions provide minimum clearance. Locate the electrical outlet in the shaded area in the upper left-hand corner of the cutout. See **Figure 8**.
- The contact surface must be solid and level. Pay special attention to the floor on which the drawer will sit. The floor of the opening should be constructed of plywood strong enough to support the weight of the unit (about 100 pounds).
- Check the location where the drawer will be installed for proper electrical supply.
- Your oven can be built into a cabinet or wall by itself or under any gas or electric wall oven.
- Be sure that the clearance of the floor between the wall oven and the drawer is a minimum of 2".
- For updates of approved appliances that can be used adjacent to the Microwave In-A-Drawer™ go to www.Dacor.com.

24" DRAWER MEASUREMENTS

Figures 1 and 2 contain many Microwave In-A-Drawer™ measurements for reference when planning the drawer's location.

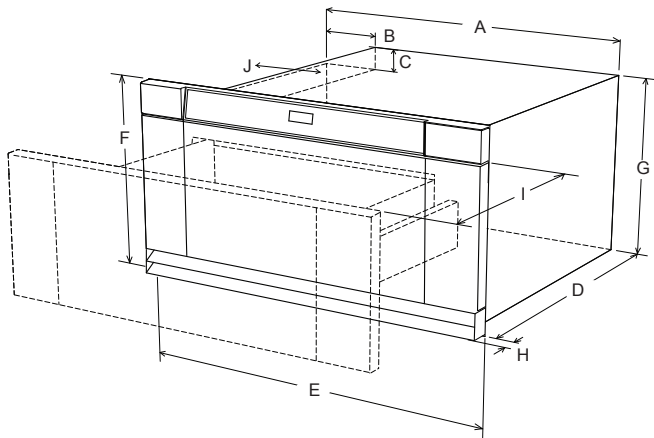

Figure 1

- | | |
|---------------------------------------|--------------------------------------|
| A. 21 ¹⁹ / ₃₂ " | F. 15 ⁵ / ₈ " |
| B. 4 ¹¹ / ₁₆ " | G. 15 ¹ / ₁₆ " |
| C. 1 ²³ / ₃₂ " | H. 1" door thickness |
| D. 23 ³ / ₈ " | I. 15" auto drawer opening |
| E. 23 ¹³ / ₁₆ " | J. 48" power cord length |

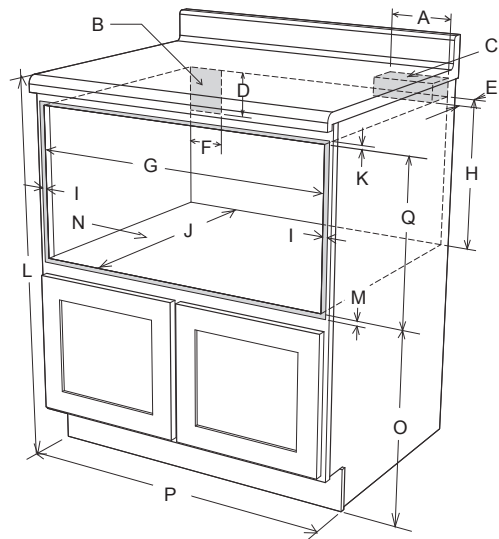

Figure 2

- | | |
|---|---|
| A. 6" | J. 23 ¹ / ₂ " minimum depth |
| B. Electrical outlet location | K. Allow ³ / ₁₆ " minimum overlap |
| C. anti-tip block | L. 36" nominal countertop height |
| D. 5" | M. Allow ⁷ / ₁₆ " minimum overlap |
| E. 3 ¹ / ₂ " | N. Floor must support 100 lbs. |
| F. 4" | O. 19" to top of floor (recommended) |
| G. 22 ¹ / ₄ " opening | P. *24" cabinet minimum |
| H. 14 ³ / ₄ " to bottom of anti-tip block | Q. 15 ³ / ₁₆ " ± ¹ / ₁₆ " opening |
| I. Allow ⁷ / ₈ " minimum overlap | NOTE: Open Top Cabinet illustrated |

Design Specifications

30" DRAWER MEASUREMENTS

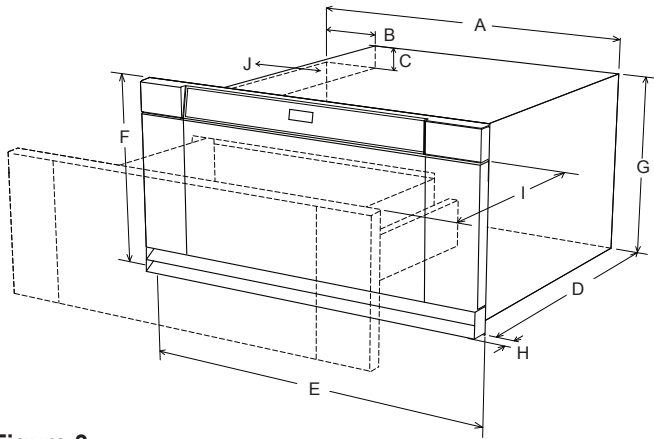

Figure 3

- A. 28 ⁵/₁₆"
- B. 4 ¹¹/₁₆"
- C. 2"
- D. 23 ³/₈"
- E. 30"
- F. 15 ⁵/₈"
- G. 15 ¹/₁₆"
- H. 1" door thickness
- I. 15 ¹/₄" auto drawer opening
- J. 48" power cord length

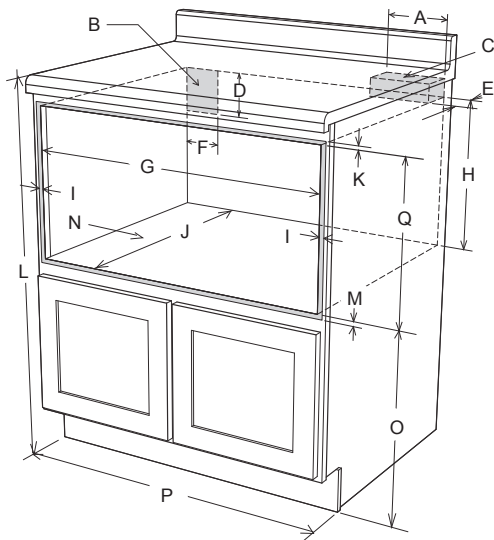

Figure 4

- A. 6"
- B. Electrical outlet location
- C. Anti-tip block
- D. 5"
- E. 3 ¹/₂"
- F. 4"
- G. 28 ¹/₂" opening
- H. 14 ³/₄" to bottom of anti-tip block
- I. Allow ³/₄" minimum overlap
- J. 23 ¹/₂" minimum depth
- K. Allow ¹/₄" minimum overlap
- L. 36" nominal countertop height
- M. Allow ⁷/₁₆" minimum overlap
- N. Floor must support 100 lbs.
- O. 19" to top of floor (recommended)
- P. *30" cabinet minimum
- Q. 15 ³/₁₆" ± ¹/₁₆" opening

NOTE: Open Top Cabinet illustrated

Figures 3, 4 and 5 contain the appliance and cutout measurements for reference when planning the drawer's location.

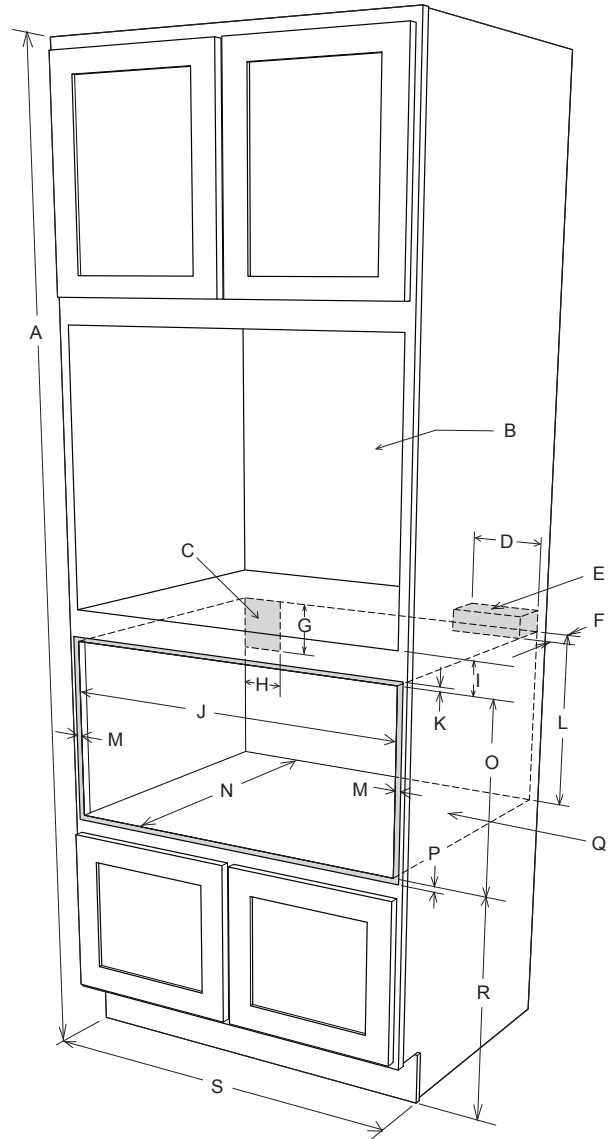

Figure 5

- A. 84" nominal wall cabinet
- B. Optional wall oven cutout illustrated in sketch
- C. Electrical outlet location
- D. 6"
- E. Anti-tip block
- F. 3 ¹/₂"
- G. 5"
- H. 4"
- I. 2" minimum
- J. 28 ¹/₂" opening
- K. Allow ¹/₄" overlap
- L. 14 ³/₄" to bottom of anti-tip block
- M. Allow ³/₄" overlap
- N. 23 ¹/₂" minimum depth
- O. 15 ³/₁₆" ± ¹/₁₆" opening
- P. Allow ⁷/₁₆" minimum overlap
- Q. Floor must support 100 lbs.
- R. * 19" to top of floor (recommended)
- S. 30" cabinet minimum

Design Specifications

ANTI-TIP BLOCK

NORMAL INSTALLATION STEPS

ANTI-TIP BLOCK INSTALLATION INSTRUCTIONS

To reduce the risk of tipping the drawer, the anti-tip block must be properly installed 14 ¾" above the floor cutout. The 6" anti-tip block must be provided by the installer. See **Figures 2 and 6** for (24") or **Figures 4, 5, and 6** (for 30"). The anti-tip block prevents serious injury that might result from spilled hot liquids.

If the drawer is moved to a different location later, the anti-tip block must also be moved and installed. When installed to the wall, make sure that the screws completely penetrate the dry wall and are properly secured into the

base material underneath so that the block is totally stable. When fastening, be sure that the screws do not penetrate electrical wiring or plumbing.

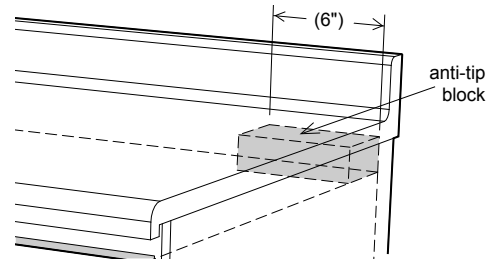
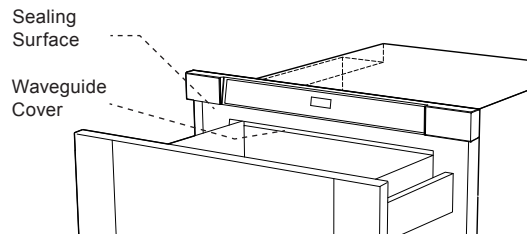

Figure 6

Installation Instructions

VERIFYING PACKAGE CONTENTS

- Remove all packing materials from inside the drawer. **DO NOT REMOVE THE WAVEGUIDE COVER**, which is located inside, on the ceiling of the Microwave In-A-Drawer™.



- Remove the feature sticker, if there is one. Check the drawer for any damage, such as misaligned or bent drawer, damaged drawer seals and sealing surfaces, broken or loose drawer guides and dents inside the cavity or on the front side of the drawer. If there is any damage, do not install or operate the Microwave In-A-Drawer™ and contact your dealer or a DACOR AUTHORIZED SERVICER.

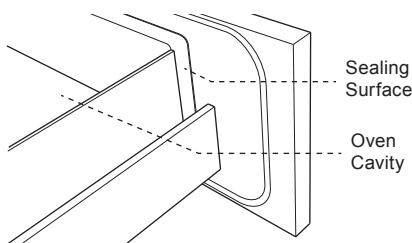

Figure 7

ELECTRICAL OUTLET

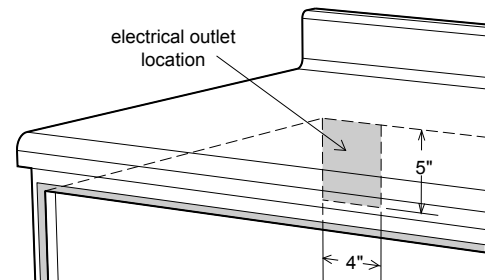

Figure 8

The electrical requirements are a 120 volt 60 Hz, AC only, 15 amp. or more protected electrical supply. It is recommended that a separate circuit serving only this appliance be provided.

The drawer is equipped with a 3-prong grounding plug. It must be plugged into a wall receptacle that is properly installed and grounded. Should you only have a 2-prong outlet, have a qualified electrician install a correct wall receptacle.

NOTE:

If you have any questions about the grounding or electrical instructions, consult a qualified electrician or service person.

Installation Instructions

DRAWER INSTALLATION

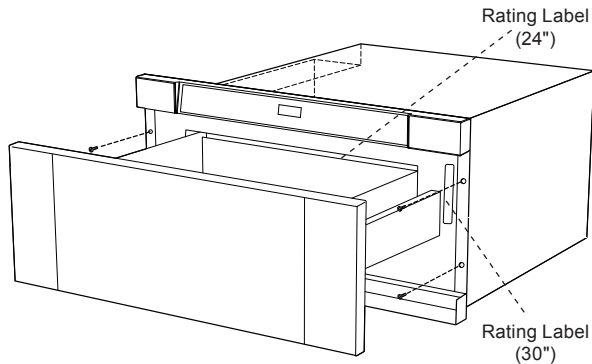

Figure 9A

1. Place the drawer adjacent to the wall or cabinet opening. Plug the power supply cord into the electrical outlet.
2. Carefully guide the unit into the prepared opening. Avoid pinching the cord between the appliance and the wall.
3. Slide the drawer in until the mounting flange is flush with the face of the cabinet.
4. Open the drawer. Using the 4 holes on the drawer as a template, predrill the cabinet using a $\frac{1}{16}$ " drill bit. See **Figure 9A**.
5. Secure the drawer with the 4 screws supplied. See **Figure 9B**.

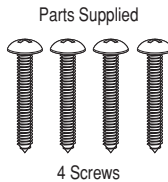

Figure 9B

MODEL AND SERIAL NUMBER LOCATION

For models MMDV30S and MMD30

The name plate, including model and serial number, is located on the faceplate behind the microwave drawer front. See **Figure 9A**.

For model MMD24

The name plate includes the model and serial number. Open the microwave drawer fully. The label is located slightly beyond the back wall of the microwave cavity facing up from the flat surface. See **Figure 9A**.

CARE, CLEANING AND MAINTENANCE

Refer to the use & care manual for cleaning instructions.

BEFORE YOU CALL FOR SERVICE

Read the BEFORE YOU CALL and operating instruction sections in your use & care manual. It may save you time and expense. The list includes common occurrences that are not the result of defective workmanship or materials in this range.

Refer to the warranty in your use & care manual for Dacor's toll-free service number and address. Please call or write if you have inquiries about your microwave product and/or need to order parts.