



USE & CARE GUIDE

PARKSIDE RESIN WICKER SWING

Product Code: D71 M1228

KSN: 0-08803261-0

UPC Code: 095457158008

Date of Purchase: ____/____/____

Thank you for your purchase

Thank you for your purchase!

We are pleased that you have chosen Sears for your outdoor furniture purchase. We hope that you enjoy the unmatched quality, comfort, and style of your new patio set. Every piece is meticulously considered all the way down to the smallest details, exclusively for you, by our world class design team. We know you have a choice when it comes to your patio furniture needs, so from our team to yours, thank you for letting us be a part of your outdoors.

Table of Contents

Table of Contents.....	2
Safety Information.....	3
Set Up Your Furniture Properly.....	3
Examine your furniture.....	3
Warranty.....	3
What is Covered.....	4
What is Not Covered.....	4
Care and Maintenance.....	4
 Pre-Assembly.....	 5
Planning Assembly.....	5
Hardware Included.....	5
Observe weight Limits.....	5
Package Contents.....	6
 Assembly Instructions	 7-17
Customer Service.....	18

Safety Information

SET UP YOUR FURNITURE PROPERLY

- ☐ Ensure that all parts are assembled properly and fully tightened as per the instructions.
- ☐ When placing in the desired location, ensure that all legs are resting on the same surface. You may adjust the leg levelers as needed to ensure the item stands securely on your surface.

EXAMINE YOUR FURNITURE

- ☐ Examine occasionally to ensure that there are no loose parts. If loose parts are found, they must be retightened fully before additional use.

Warranty

1 YEAR WARRANTY FOR FRAME, RESIN WEAVE AND CUSHIONS

WHAT IS COVERED

We warrant to the original purchaser for one year, from the date of purchase, that the frame, resin weave and cushions will be free from manufacturing defects. This warranty also covers peeling, crackling, blistering, discoloration, or fading for this one year period.

WHAT IS NOT COVERED

It remains the customer's responsibility for freight and packaging charges to and from our service center. This warranty does not cover commercial use, acts of nature, fire, freezing, and abusive use. Discoloration or fading of the finish or fabrics as a result of chemicals or spills is not covered. Glass tabletop breakage and corrosion or rusting of hardware are not covered. In addition, purchased parts are not covered under this warranty. Proof of purchase (dated register receipt) is required for warranty claims. We reserve the right to make substitutions with similar merchandise, if the model is no longer in production. Warranty is to the original purchaser and is not transferable. As some states do not allow exclusions or limitations on an implied warranty, the above exclusions and limitations may not apply. This warranty gives you specific rights, but you may also have other rights which will vary from state to state.

WARRANTY

This limited warranty is extended to the original purchaser and applies to defects in material and workmanship of your patio furniture, provided your furniture is maintained with care and used only for personal, residential purposes.

Resin wicker is warranted to be free from defects in material or workmanship for a period of one (1) year.

Warranty

Cushions are covered for a period of one (1) year against defects in material or workmanship.

Frames are warranted to be free from defects in material or workmanship for a period of one (1) year.

Exclusions: items used for commercial, contract, or other nonresidential purposes, or items damaged due to acts of nature, vandalism, misuse, or improper assembly is not covered. Discoloration and fading of the finish or fabrics as a result of chemicals or spills are not covered. Glass table top breakage and corrosion or rusting of hardware are not covered. If within the stated warranty period, this product is found to be defective in material or workmanship, the purchaser must contact the manufacturer's customer service department. The manufacturer, at its option, will repair or replace the defectives parts. Proof of purchase (date register receipt) is required for warranty claims. It remains the customer's responsibility to pay for freight and packing charges to and from the service center. Warranty is to the original purchaser and is nontransferable.

Any replacement of warranted items will be in the original style and color, or a similar style and color if the original is unavailable or has been discontinued. As some states do not allow exclusions or limitations on an implied warranty, the above exclusions and limitations may not apply. This warranty gives you specific rights, but you may also have other rights which will vary from state to state.

Care instructions: protecting furniture from the elements, when not in use is highly recommended. Wipe frame with a lightly damp cloth and dry completely, do not use bleach or solvents. Wash cushions with mild solution of soap and water, rinse thoroughly. Do not machine wash.

Customer service 1-800-585-9969

Care and Maintenance

- ☐ Wash the frame with a mild solution of soap and water, rinse with clean water and dry thoroughly.
- ☐ Cushions may also be cleaned by hand with a mild solution of soap and water. Rinse the cushion cover thoroughly and allow to drip dry. The back cushion and pillow should be spot cleaned with a soft cloth. Do not machine wash or tumble dry as cushions may shrink. Do not use bleach or solvents on fabrics. Never use cleaners that contain acid or abrasive materials.
- ☐ Use and operation: To improve the lifespan of this furniture, cover when not use and store in a dry place in the off season.

Pre-Assembly

PLANNING ASSEMBLY

To prevent damage, place all parts on a soft surface during assembly. Remove all protective caps before beginning assembly. It takes about 60 minutes for two people to complete all the assembly.

OBSERVE WEIGHT LIMITS

The recommended weight limits for the following products are listed below:

- Swing: 400 lbs



CAUTION: If you overload your furniture, injuries can occur.

HARDWARE INCLUDED



NOTED: Hardware not shown to actual size.

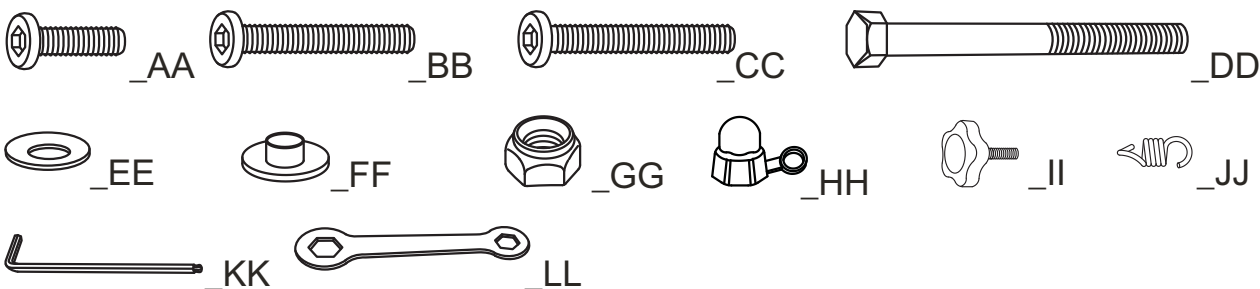

Part	Description	Size	QTY.
AA	BOLTS	(Φ 6.35x16mm)	12
BB	BOLTS	(Φ 6.35x35mm)	16
CC	BOLTS	(Φ 6.35x42mm)	2
DD	HEXAGONAL BOLTS	(Φ 8x95mm)	4
EE	WASHERS	(Φ 13mm)	30
FF	WASHERS	(4mm)	8
GG	NUTS	(8.5mm)	4
HH	NUTS CAP	(12mm)	8
II	PLASTIC KNOB	(52x50x52mm)	2
JJ	SPRING HOOK	(7mm)	2
KK	ALLEN WRENCH	(4mm)	1
LL	WRENCH	(2mm)	2

Package Contents

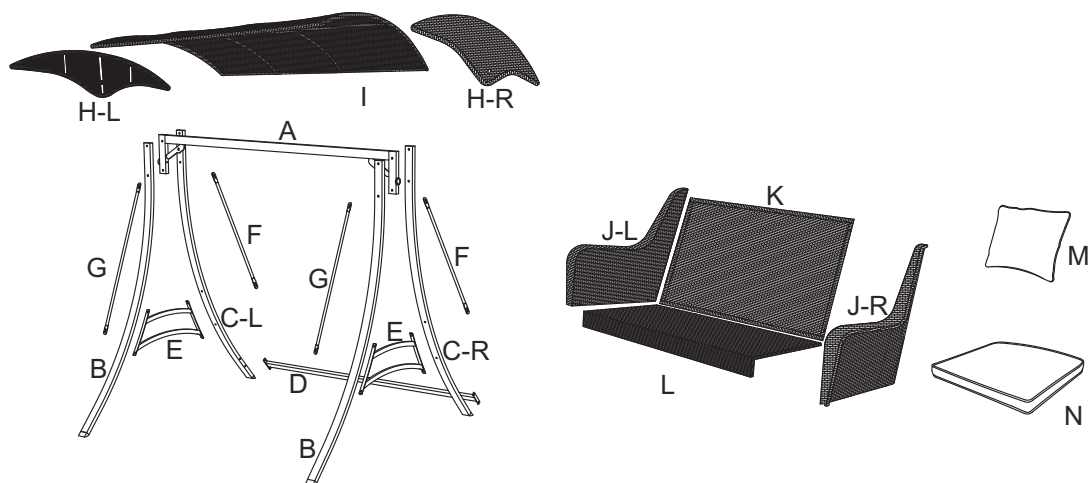

PART	DESCRIPTION	QUANTITY
A	TOP BAR	1
B	FRONT LEG	2
C	BACK LEG(R&L)	2
D	LEG CROSS BAR	1
E	LEG SUPPORT BAR	2
F	BACK HANG BAR	2
G	FRONT HANG BAR	2
H	WICKER SIDE PANEL(R&L)	2
I	SWING TOP	1
J	WICKER ARM(R&L)	2
K	WICKER BACK	1
L	WICKER SEAT	1
M	BACK CUSHION	2
N	SEAT CUSHION	2



Safety Information

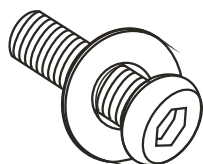

1. EVERY BOLT NEEDS TO BE USED WITH A WASHER.
2. DO NOT FULLY TIGHTEN BOLTS UNTIL INDICATED IN STEP 6.

Assembly Instructions

1 Attaching the swing top

- ATTACH TWO WICKER SIDE PANEL "H" TO THE SWING TOP "I", FASTEN WITH EIGHT BOLTS "BB" AND EIGHT WASHERS "EE", TIGHTEN HALF THE WAY USING ALLEN WRENCH "KK".
- CHECK AND MAKE ADJUSTMENT AS NEEDED. USING THE WRENCH "KK" FULLY TIGHTEN THE BOLTS.

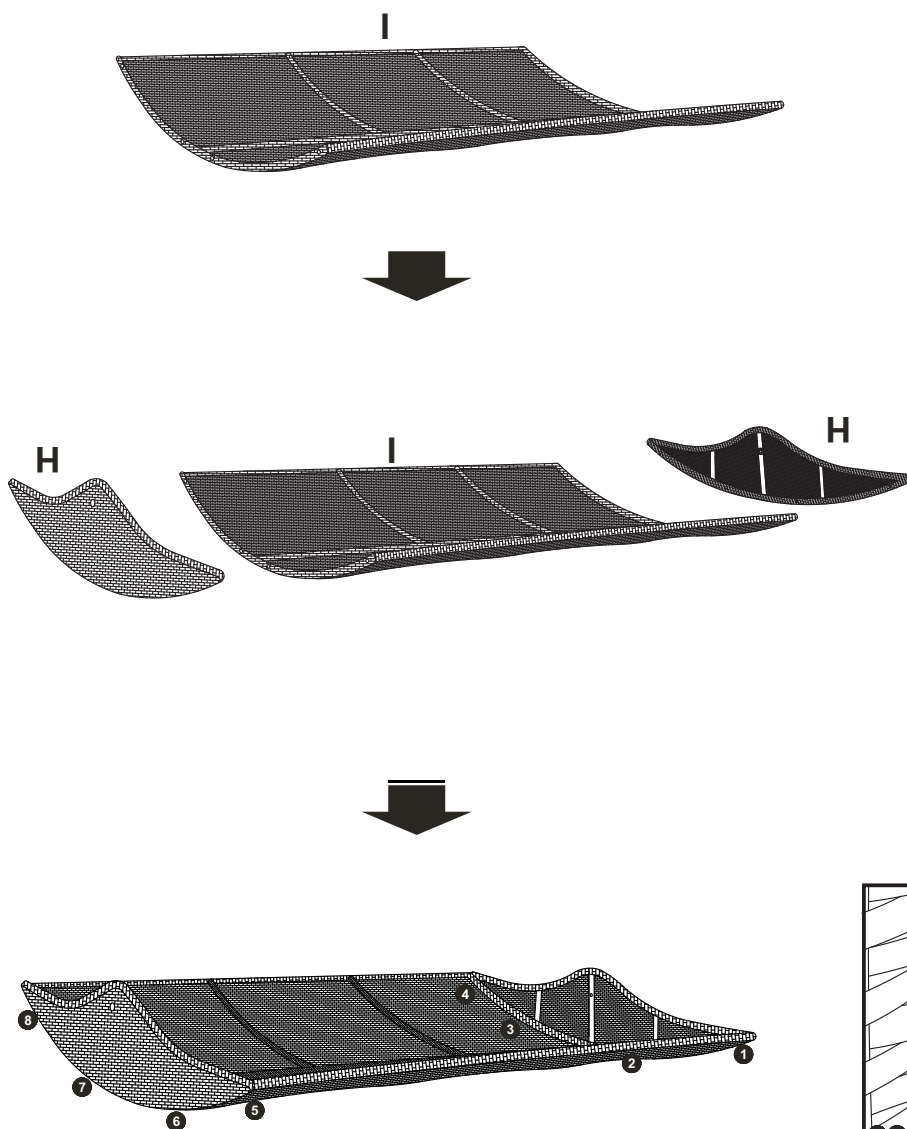

Assembly Instructions

2 Attaching the leg and the top bar

- PLACE THE FRONT LEG "B" AND BACK LEG "C" TOWARD THE TOP BAR "A", FASTEN WITH FOUR HEXAGONAL BOLTS "DD", EIGHT WASHERS "FF", EIGHT NUT CAPS "HH" AND FOUR NUTS "GG". TIGHTEN HALF THE WAY USING TWO WRENCH "LL".

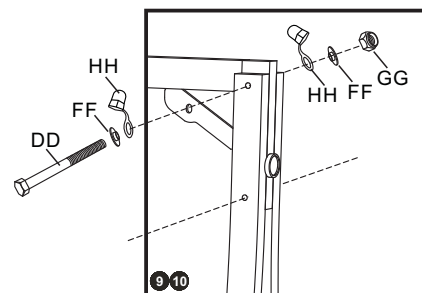
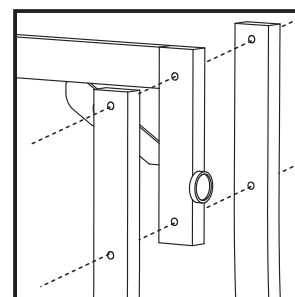
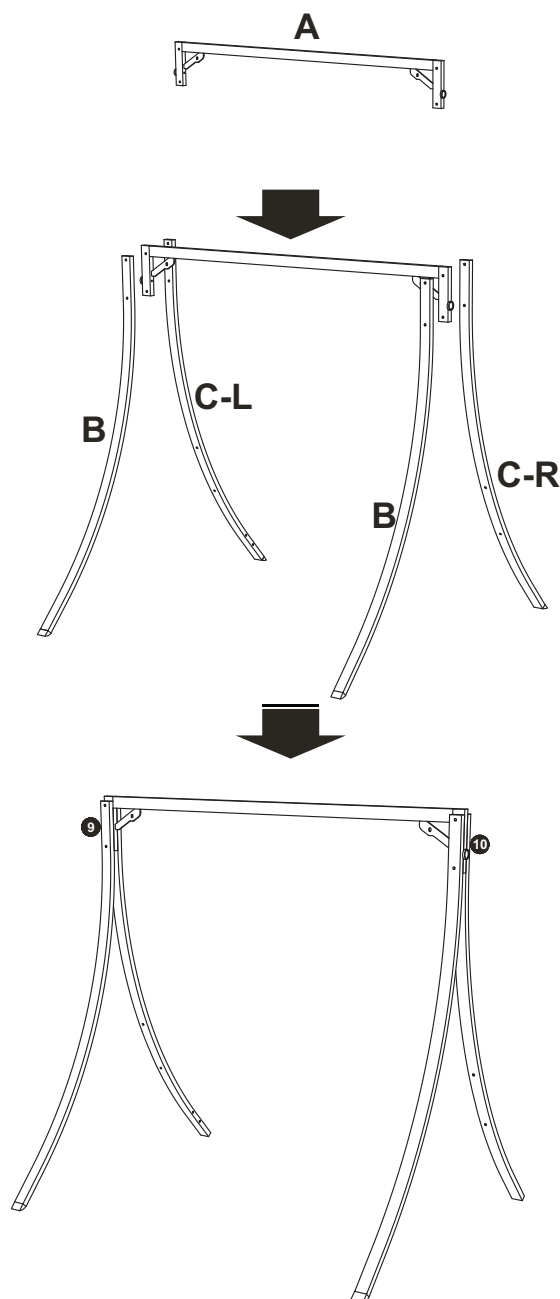
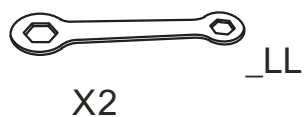
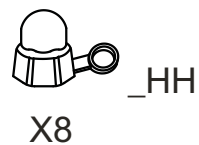
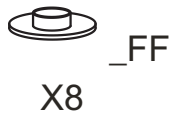
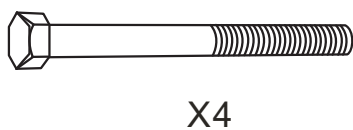

Assembly Instructions

3 Attach the leg support bar

- ATTACH TWO LEG SUPPORT BARS "E" TO THE FRONT LEG "B" AND BACK LEG "C"(C-L & C-R), FASTEN WITH EIGHT BOLTS "AA" AND EIGHT WASHERS "EE". TIGHTEN HALF THE WAY USING ALLEN WRENCH "KK".



X8



X8



X1

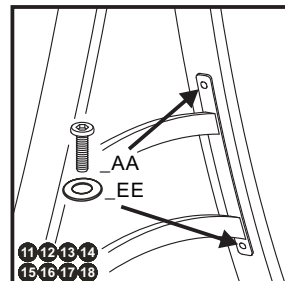
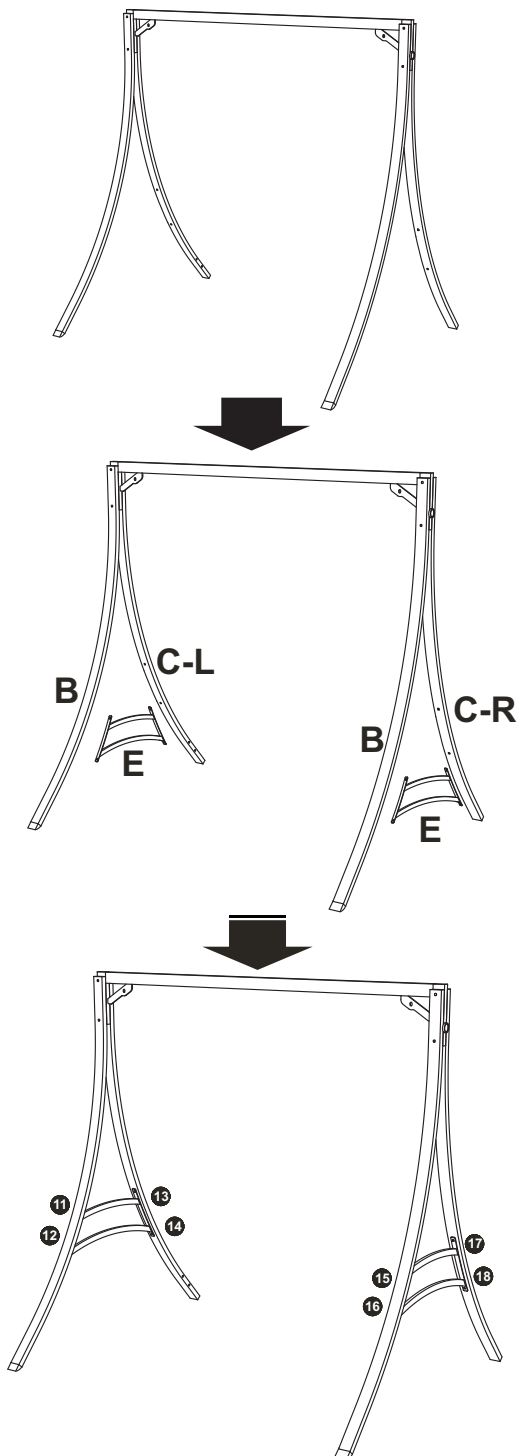

Assembly Instructions

4 Attach the leg cross bar

- ATTACH THE LEG CROSS BAR “D” TO THE BACK LEG “C”(C-L & C-R), FASTEN WITH FOUR BOLTS “AA” AND FOUR WASHERS “EE”. USING THE ALLEN WRENCH “KK” FULLY TIGHTEN ALL THE BOLTS.

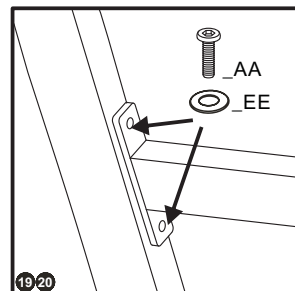
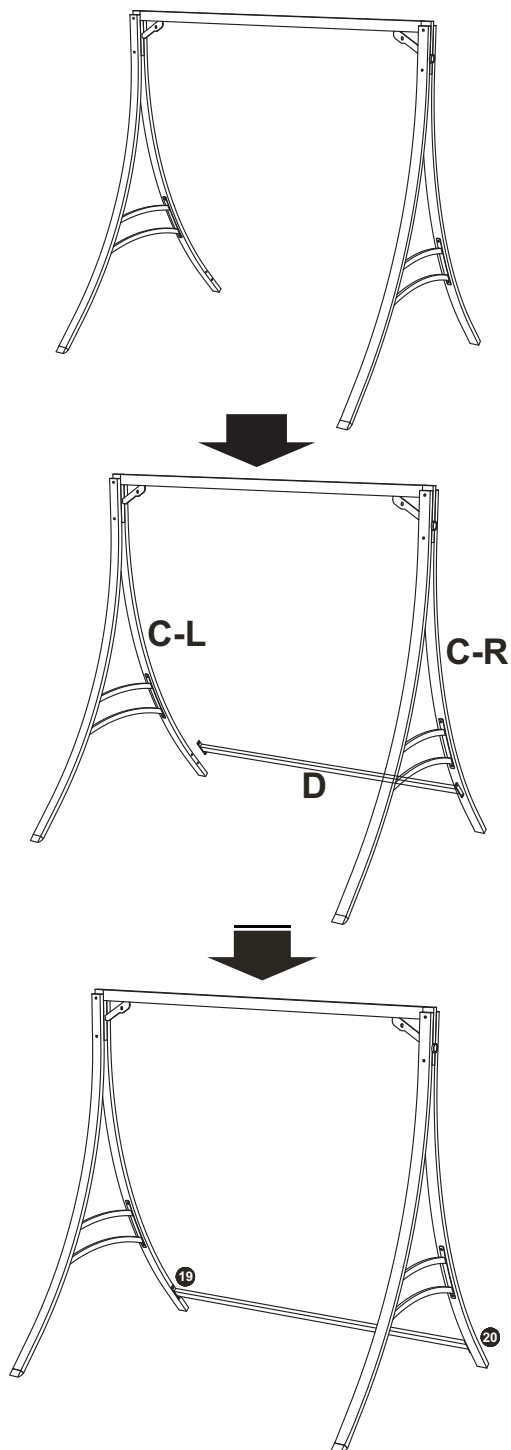

5 Attach the wicker back

- ATTACH THE WICKER BACK “K” TO THE WICKER SEAT “L”, FASTEN WITH TWO BOLTS “CC” AND TWO WASHERS “EE”. TIGHTEN HALF THE WAY USING ALLEN WRENCH “KK”.

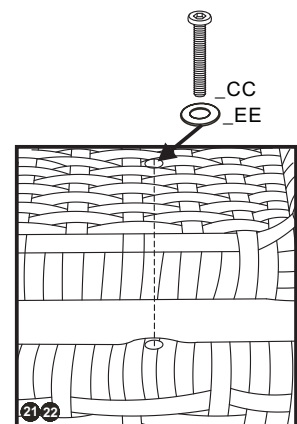
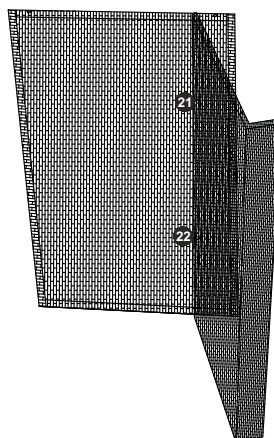
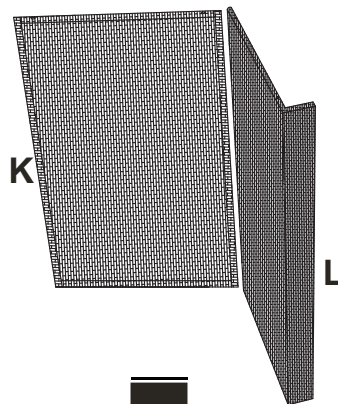

6 Attach the wicker arm

- ATTACH THE WICKER ARMS “J”(J-L & J-R) TO THE WICKER BACK “K” AND WICKER “L”, SEE PICTURE 24, 25, 28 & 29. FASTEN WITH FOUR BOLTS “BB” AND FOUR WASHERS “EE”. REPEAT FOR PICTURE 23, 26, 27 & 30. USING THE ALLEN WRENCH “KK” FULLY TIGHTEN ALL THE BOLTS.

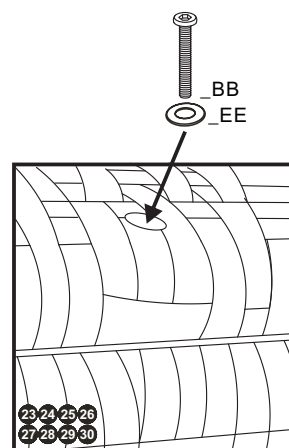
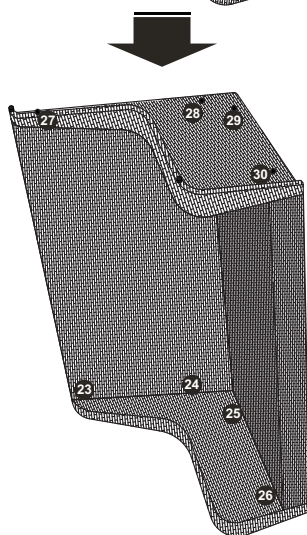
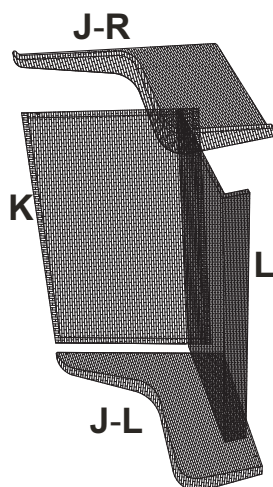
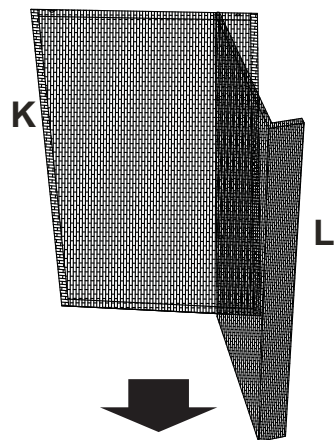

Assembly Instructions

7 Assembling the spring hook and the hang bar

- PLACE TWO FRONT HANG BARS “G” AND TWO BACK HANG BARS “F” INTO THE SPRING HOOK “JJ”.

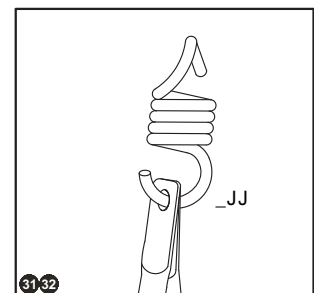
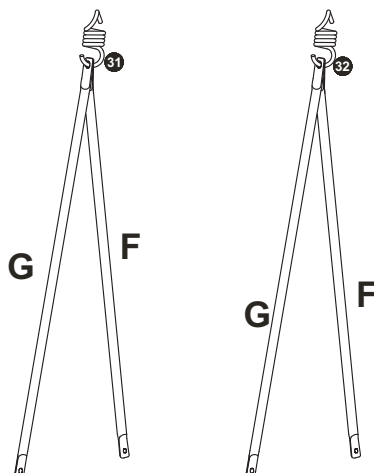
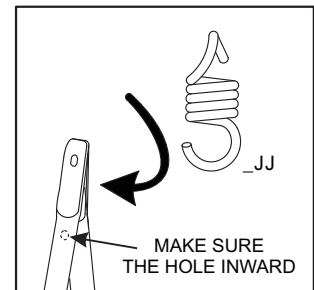
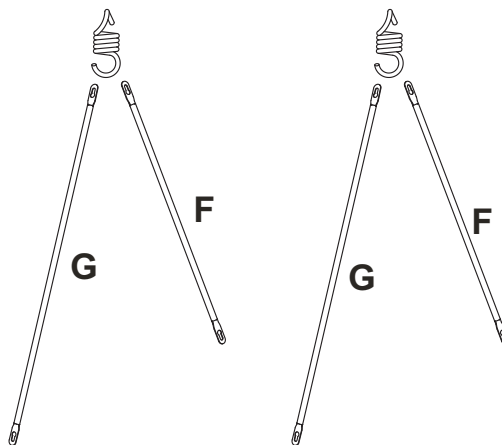
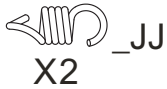

Assembly Instructions

8 Place the hang bars to the wicker arm

- PLACE TWO FRONT HANG BARS "G" AND TWO BACK HANG BARS "F" INTO THE WICKER ARMS "J" (J-L & J-R).

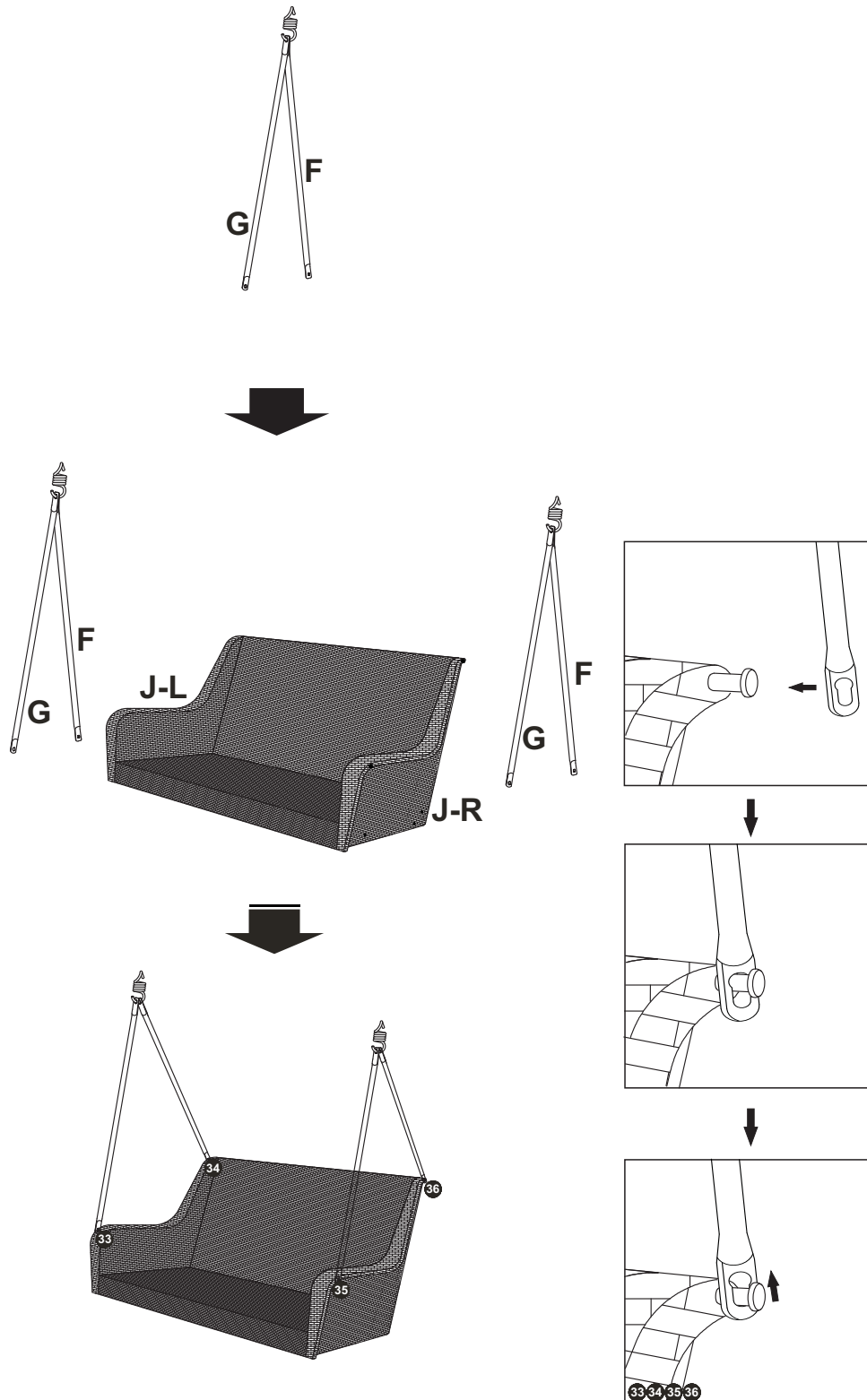

9 Place the spring hook to the top bar

- PLACE THE TWO SPRING HOOKS “JJ” TO THE TOP BAR “A” SMOOTHLY.

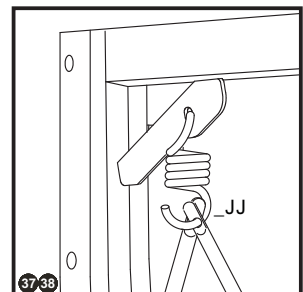
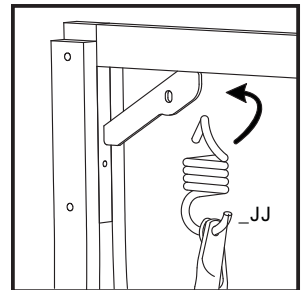
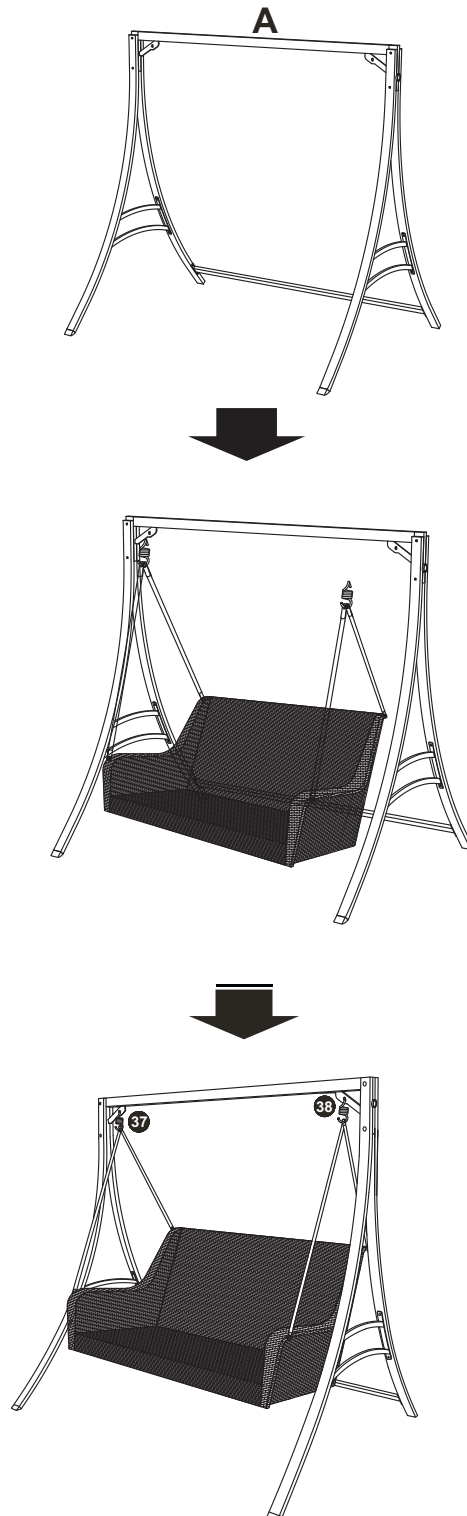

10 Attach the swing side panel and top bar

- ATTACH THE SWING SIDE PANEL "H" TO THE TOP BAR "A", USING THE PLASTIC KNOB "II" TO FIX IT AND ADJUST THE ANGLE OF SWING CANOPY CAREFULLY.

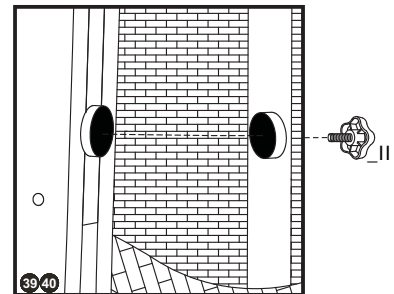
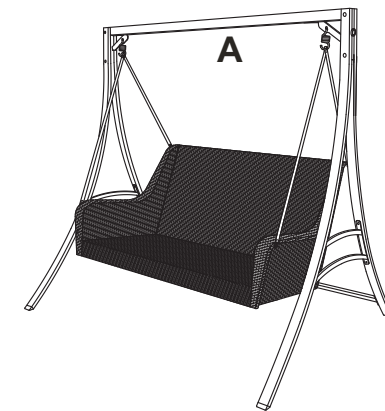
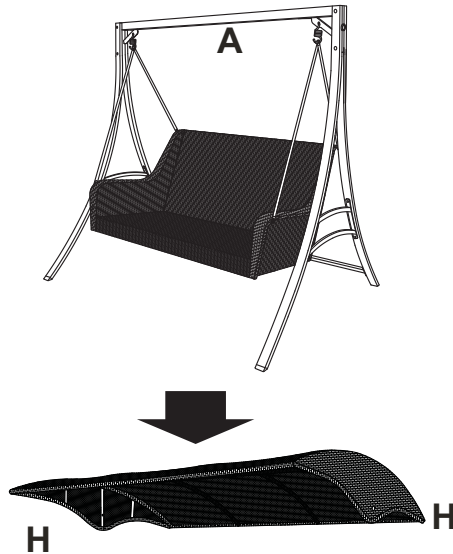
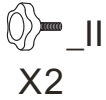

11

Place the cushions

- ☐ PLACE THE SEAT CUSHIONS “N” ONTO THE WICKER SEAT, AND PLACE THE BACK CUSHIONS “M” TO THE WICKER BACK.
- ☐ THE SWING IS READY TO USE NOW.

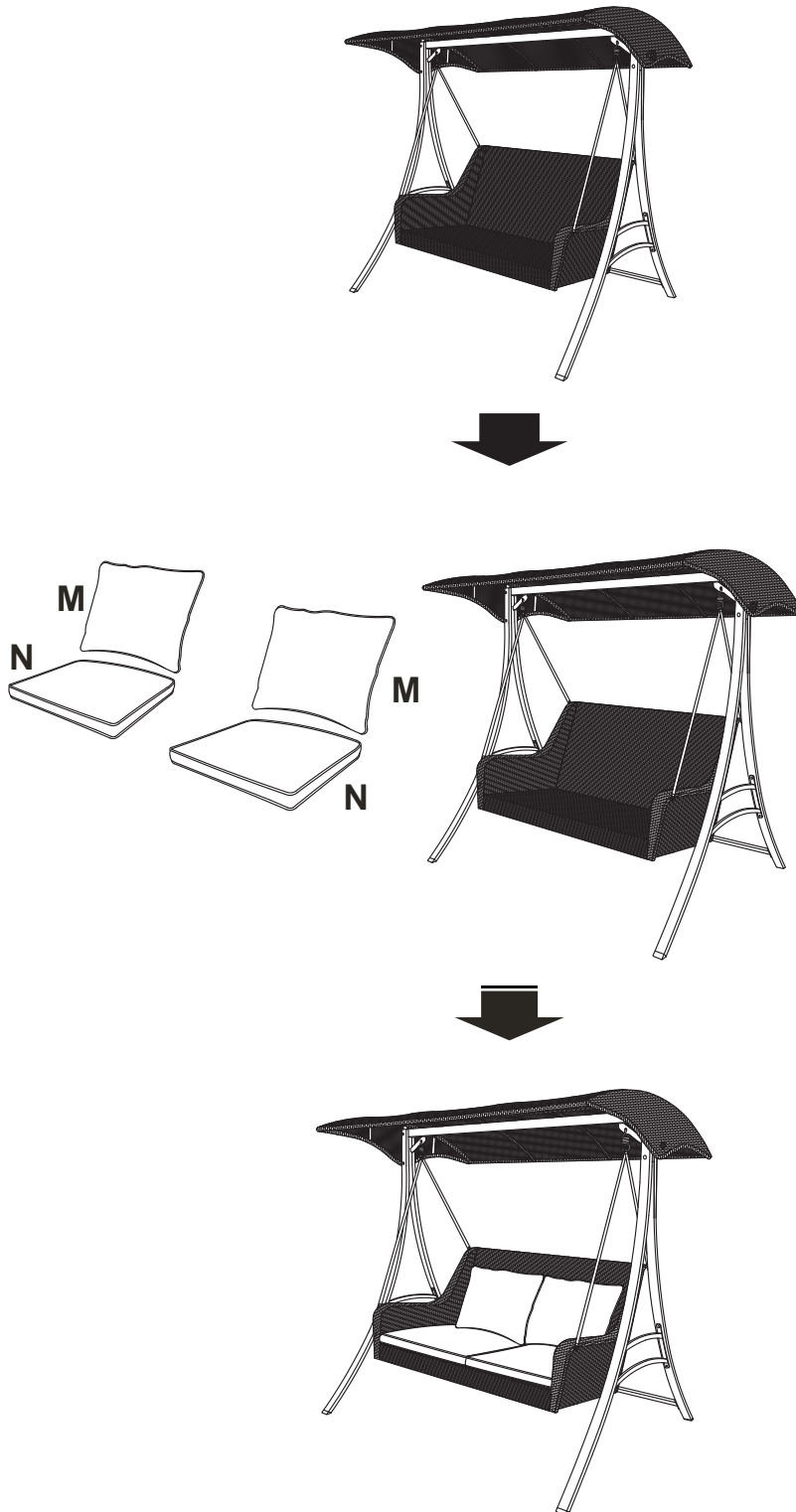



SHINCREST PTE., LTD.
TSY Services, LLC.



HOME OFFICE: 13033 Arctic Circle, Santa Fe Springs, CA 90670
FAX: (562)376-8364
CUSTOMER SERVICE HOT LINE: 1-800-585-9969
SERVICE HOURS: MONDAY - FRIDAY 8:30 AM - 4:30 PM (EST)
E-MAIL: service@tsyservices.com

sears

Please refer to part numbers when reordering

For questions or comments about product:

Email: service@tsyservices.com or Call toll-free: 1-800-585-9969

Made in / Hech en CHINA

Distributed by Sears, Roebuck and Co., Hoffman Estates, IL 60179

See our extensive assortment of outdoor living products
on-line at www.sears.com and www.kmart.com