

**THIS INFORMATION IS DESIGNED TO ASSIST
QUALIFIED REPAIR PERSONNEL ONLY.
UNTRAINED PERSONS SHOULD NOT ATTEMPT
TO MAKE REPAIRS DUE TO THE POSSIBILITY
OF ELECTRICAL SHOCK.**

TECH SHEET
PART N0.16120300A01531

WARNING

DISCONNECT FROM
ELECTRICAL SUPPLY
BEFORE SERVICING

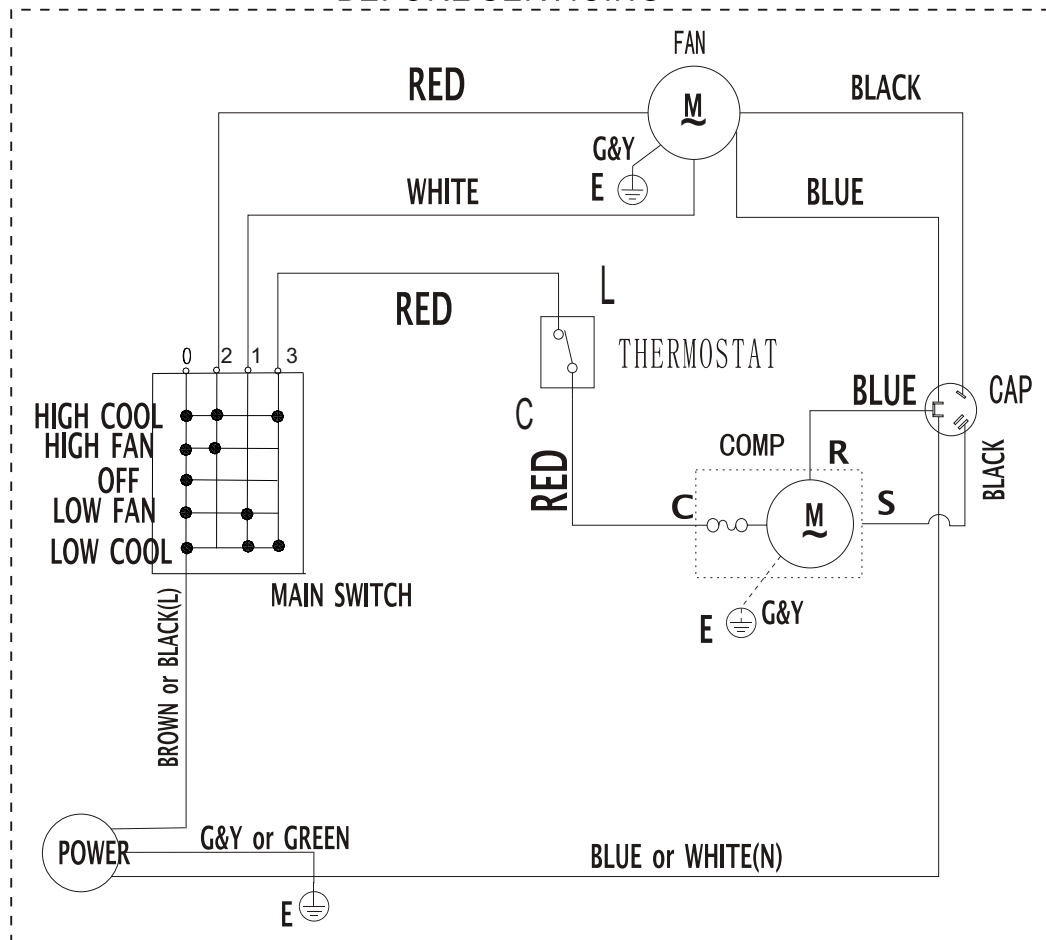

NOTE:

For compressor terminal arrangement, refer to compressor terminal cover.

Refer to Nameplate For:
Voltage, Amps and Refrigerant Charge.

Locked Rotor Amps 21.5

FUNCTIONAL PARTS

NAME	PART NO.
Compressor	11103010001248
Capacitor	202401400005 (35+6UF/250V)
Fan Motor	202400401795
Turbo Fan	201100100060
Fan	201100300558
Room Thermistor	202301610035
Overload Protector	B180-140T-241C

NOTICE: PLEASE RETURN THIS SHEET TO ITS ORIGINAL LOCATION

TO USE THE PERFORMANCE CHART

- 1. Record inlet and outlet air dry bulb temperature.
- 2. Subtract outlet temperature from inlet temperature.
- 3. Record inlet air wet bulb temperature.
- 4. Locate wet bulb temperature on line "B".
- 5. Extend point on line "B" up to sloped performance line on chart; then over to the L.H. column. (line "A")
- 6. Actual temperature differential should not be more than $\pm 3^{\circ}$ from this reading.

PERFORMANCE CHART

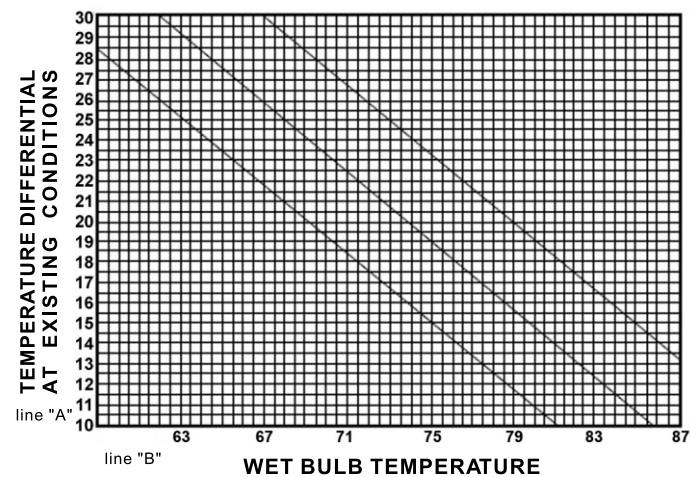

COMPENSATION CHART

If Outside Ambient Air Temp. is;	Correct Performance Line by:	Wattage
80	Adding $1\frac{1}{2}^{\circ}$	350
85	Adding 1°	
90	Adding $\frac{1}{2}^{\circ}$	
95	No Correction	445
100	Deducting $\frac{1}{2}^{\circ}$	
105	Deducting 1°	
110	Deducting $1\frac{1}{2}^{\circ}$	540

TO DISASSEMBLE MECHANICAL PARTS

FRONT FRAME

- 1. Unplug the unit from the source of power.
- 2. Remove the screws securing the front frame.
- 3. Depress the cabinet sides to release the side frame locking tabs.
- 4. Lift front frame slightly to unlock top tabs and rotate frame to the left.
- 5. Remove the front frame.

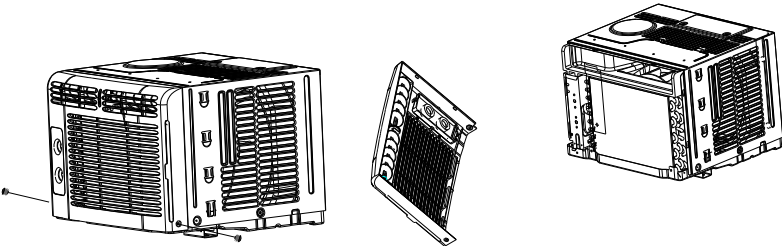

CABINET

- 1. Remove the screws that secure the refrigeration unit to the cabinet.
- 2. Pull the unit out of the cabinet.

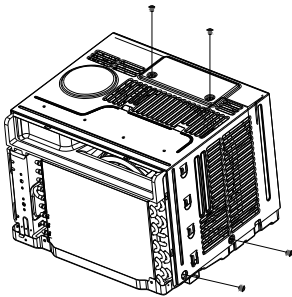

EVAPORATOR FAN AND SCROLL

- 1. Lift the scroll air duct, and then remove it.
- 2. Disconnect the compressor and fan motor wires in the control box.
- 3. Remove the screws which fasten the shroud to the base.
- 4. Gently pull up the assembly of turbo fan, fan motor, shroud and condenser fan, exposing the turbo fan and condenser fan.
- 5. Remove turbofan lock nut using socket wrench, and then remove the turbo fan.

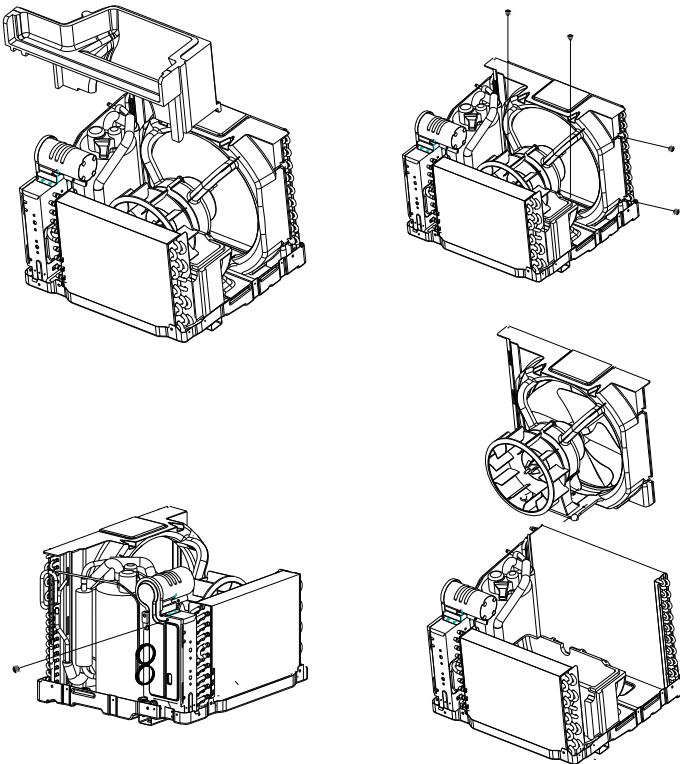

CONDENSER FAN AND SHROUD

- 1. Remove the condenser fan lock nut using a socket wrench, and then remove the condenser fan.
- 2. Remove screws that fasten the fan motor to the shroud, and then remove the motor.

