

CONTENTS

Child Safety Guide	02
Caution and Warning	02
Safety Precautions	04
Preparation for Your New TV	05
Check Accessories	05
Setup TV Table Stand	05
Select TV Location	05
Connection and Using	05
TV Signal Connection	05
Cable Connections	05
Side Panel Connections	05
Connecting AV Composite video device	05
Connecting YPbPr Component device	06
Connecting HDMI device	06
How to obtain various kinds of Input Sources	06
TV Jacks Explanation	06
Keypad and Front Panel	07
Keypad Buttons	07
Front Panel	07

Basic Operations	07
Turning On and Off	07
Choosing TV Channel	07
Selecting Input Source	07
Channel Bar	08
Adjusting Volume	08
EPG (Electronic Program Guide)	08
OSD Menu Operations	08
Adjust the OSD Screen	08
Quick Menu	08
Channel Menu	08
Picture Menu	08
Audio Menu	09
Time Menu	09
Setup Menu	10
Lock Menu	10
Frequently Asked Questions (FAQs)	11
Troubleshooting	12
Wall Mounting Unit Specification	13
USB Media Play	13
Product Specification	14
Warranty Card	14

1 2

LED LCD TV

USER'S MANUAL

MODEL
LED32G30RQ

Please register your product at www.rca.com
Please keep your sales receipt and keep the record of the serial number and the date of purchase in order to receive warranty parts and service. The serial number is located at the back of the TV.

Serial Number

Date of Purchase



Safety Precautions

- Read these instructions.
- Keep these instructions.
- Heed all warnings.
- Follow all instructions.
- Do not use this apparatus near water. For example, do not use near a laundry tub, in a wet basement, or near a swimming pool, and the like.
- Clean only with dry cloth.
- Do not block any ventilation openings. Install in accordance with the manufacturer's instructions. Slots and openings in the cabinet back or bottom are provided for ventilation, to ensure reliable operation of the TV and to protect it from overheating. These openings must not be blocked or covered. The openings should never be blocked by placing the TV on a bed, sofa, rug, or other similar surface.
- Do not install near any heat sources such as radiators, heat registers, stoves, or other apparatus (including amplifiers) that produce heat.
- Do not defeat the safety purpose of the polarized or grounding-type plug. A polarized plug has two blades with one wider than the other. A grounding-type plug has two blades and a third grounding prong. The wide blade or the third prong is provided for your safety. If the provided plug does not fit into your outlet, consult an electrician for replacement of the obsolete outlet.
- Protect the power cord from being walked on or pinched particularly at plugs, convenience receptacles, and the point where they exit from the apparatus.
- Only use attachments/accessories specified by the manufacturer.
- Use only with cart, stand, tripod, bracket, or table specified by the manufacturer, or sold with the apparatus. When a cart is used, use caution when moving the cart/apparatus combination to avoid injury from tip-over.
- A TV and cart combination should be moved with care. Quick stops, excessive force, and uneven surfaces may cause the TV and cart combination to overturn.
- Unplug this apparatus during lightning storms or when unused for long periods of time.
- For added protection for this TV receiver during a lightning storm, or when it is left unused for long periods of time, unplug it from the wall outlet and disconnect antenna or cable system. This will prevent damage to the TV due to lightning and power line surges.
- Refer all servicing to qualified service personnel. Servicing is required when the apparatus has been damaged in any way, such as power-supply cord or plug is damaged, liquid has been spilled or objects have fallen into the apparatus, the apparatus has been exposed to rain or moisture, does not operate normally, or has been dropped.
- This product should be operated only from the type of power supply indicated on the rating label.
- If customer is not sure the type of power supply in your home, consult your appliance dealer or local power company. For TV remote control battery power, refer to the operating instructions.
- The TV set shall not be exposed to dripping or splashing. No objects filled with liquids, such as vases, shall be placed on the TV set.

17. Never push objects of any kind into this TV through openings as they may touch dangerous voltage or other electrical parts that could result in fire or electric shock. Never spill liquid of any kind into the TV.

18. Unplug the TV from the wall outlet before cleaning. Do not use liquid or aero cleaners. Use a damp cloth for cleaning.

19. This TV should never be placed near or over a radiator or heat resource. This TV should not be placed in a built-in installation such as a bookcase or rack unless proper ventilation is provided or the manufacturer's instructions have been adhered to.

20. Do not place this TV on an unstable cart, stand, tripod, bracket, or table. The TV may fall, causing serious injury to someone, and serious damage to the appliance.

21. Do not attempt to service this TV by yourself because opening or removing covers may expose you to dangerous high voltage or other hazards. Refer all servicing to qualified service personnel.

22. This device complies with Part 15 of the FCC Rules. Operation is subject to the following two conditions: (1) this device may not cause harmful interference, and (2) this device must accept any interference received, including interference that may cause undesired operation.

23. WARNING: To prevent injury, this apparatus must be securely attached to the floor/wall in accordance with the installation instructions.

24. To reduce the risk of electric shock, the grounding of center pin of plug must be maintained.

25. If an outside antenna or cable system is connected to the TV, be sure the antenna or cable system is grounded to provide some protection against voltage surges and built-up static charges.

Section 810 of the National Electrical Code, ANSI/NFPA NO.70, provides information with respect to proper grounding of the mast and supporting structure, grounding of the lead-in wire to an antenna discharge unit, size of grounding conductors, location of antenna discharge unit, connection to grounding electrodes, and requirements for the grounding electrodes. (See figure A)

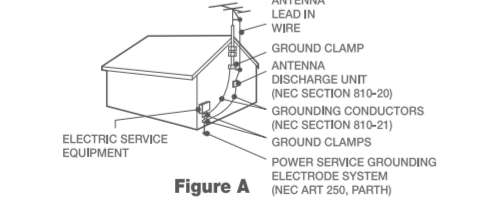

Safety Strap

Caution: Pushing, pulling or climbing on the TV may cause the TV falling. Do not let children climb or hang on the TV. Always place the TV on a sturdy, level, stable surface that can hold the weight of TV. And if possible, secure the TV according to the instruction below (Note: The fastening components such as screws are not supplied with TV).

Step one: Insert the M6 mounting screws into the upper two wall mounting screw holes and fasten them (Figure B).
Step two: Insert anchors to wall and connect the bolts and anchors with ropes or chains (Figure C).

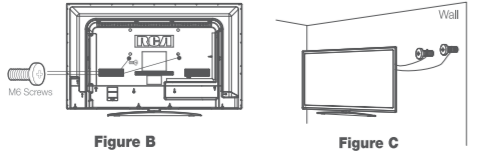

4 5

Preparation for Your New TV

Before Turning On TV

Check Accessories
Check the accessories that are packed with your TV. (refer to Quick Start Guide)

Select TV Table Stand

Please refer to Quick Start Guide to carry out stand installing.

Connection and Using

Select a flat, stable table to place your TV set. Please follow the safety instructions when placing the TV.
After placing your TV properly, you can connect the TV with power supply and cable components. For further information, see page 5 to page 6.

TV Signal Connection

The first step in connecting your TV is obtaining the signal. Your TV LED32G30RQ has a back panel, which allows you to receive analog and/or digital television channels via ANT/CABLE jack. Before connecting your TV, determine using an antenna or a cable service to obtain the signal.

A. Antenna

Connect the antenna to TV via coaxial cable on ANT/CABLE jack of the back panel. You are ready to receive air local digital and analog channels.

B. Cable TV service

Connect the cable TV wall jack to TV via coaxial cable on ANT/CABLE jack of the back panel. You are ready to receive off-air local digital and analog channels.

C. Set-Top Box

If you use a set-top box, you may need to call your cable company or satellite service provider, which use a special connection, please refer to the user's guide of set-top box.

Note: Do not plug the AC cord until you have accomplished all the connections. This TV does not support QAM under cable channel search.

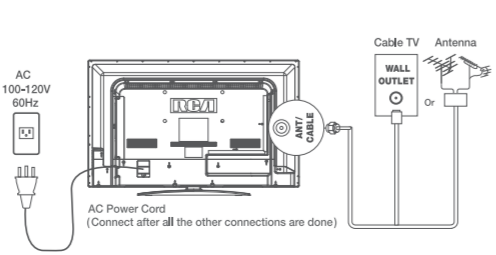

Cable Connections

Choose Your Connections

TV LED32G30RQ supports various connections to other devices (such as DVD, VCR, Set-top box, etc.). Please follow the table to choose the cables which adapt to your device.

Jacks	Cables	Further Information
COMPOSITE L-AUDIO-R	Video/Audio cable	See the below
COMPONENT Y, Pb, Pr L-AUDIO-R	COMPONENT video cable	Go to page 6
HDMI IN 1/DVI/MHL, 2/ARC	HDMI-DVI cable HDMI cable MHL cable	Go to page 6

Note: HDMI, the HDMI logo, and High-Definition Multimedia Interface are trademarks or registered trademarks of HDMI Licensing LLC

Caution: Unplug the AC cord when you connect other devices to TV.

Side Panel Connections

Connecting AV Composite device (Good Video Quality)

Composite connector will be shared with Component Y connector. To connect a composite AV device, such as a DVD player, follow these steps:

- Connect the COMPOSITE jack on the side of TV to the video output jacks of device via video cable (yellow).
- Connect the L-AUDIO-R jacks on the side of TV to the audio output jacks of device via audio cable. Notice the left channel jack and plugs are white and the right channel jack and plugs are red.

Note: AV signal belongs to composite video. This kind of video signal has regular good display quality.

Composite Video Connection

The picture below is an example of a connection using the composite video jack.

Child Safety Guide

Congratulations on your purchase! As you enjoy your new product, please keep these safety tips in mind :

The Issue

The home theater entertainment experience is a growing trend and larger flat panel displays and popular purchases.

However, flat panel displays are not always supported on the proper stands of installed according to the manufacturer's recommendations.

Flat panel displays that are inappropriately situated on dressers, bookcases, shelves, desks, speakers, chests or cats may fall over and cause injury.

This Manufacturer Cares!

The consumer electronics industry is committed to making home entertainment enjoyable and safe.

Wall Mounting : IF YOU DECIDE TO WALL MOUNT YOUR FLAT PANEL DISPLAY, ALWAYS :

- Use a mount that has been recommended by the display manufacturer and/or listed by an independent laboratory (such as UL, CSA, ETL).
- Follow all instructions supplied by the display and wall mount manufacturers.
- If you have any doubts about your ability to safely install your flat panel display, contact your retailer about professional installation.
- Make sure that the wall where you are mounting the display is appropriate. Some block construction. If you are unsure, contact a professional installer.
- A minimum of two people are required for installation. Flat panel displays can be heavy.

Caution and Warning

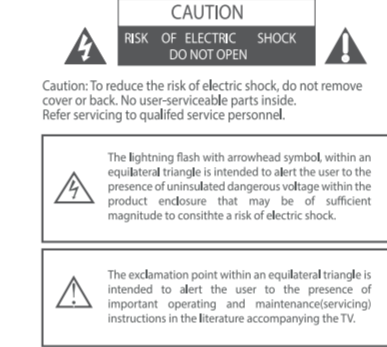

Tune Into Safety

- One size does NOT fit all. Follow the manufacturer's recommendation for the safe installation and use of your flat panel display.
- Carefully read and understand all enclosed instructions for proper use of this product.
- Don't allow children to climb on or play with furniture and television sets.
- Don't place flat panel displays on furniture that can easily be used as steps, such as a chest of drawers.
- Remember that children can become excited while watching a program, especially on a "larger than life" flat panel display. Care should be taken to place or install the display where it cannot be pushed, pulled over, or knocked down.
- Care should be taken to route all cords and cables connected to the panel display so that they cannot be pulled or grabbed by curious children.



Guía de seguridad para niños

¡Muchas gracias por su uso del presente producto! Cuando usted disfruta de su nuevo producto, por favor tenga en cuenta los consejos de seguridad:

Posibles Problemas

- La experiencia de entretenimiento de cine en casa es una tendencia creciente y los grandes monitores de pantalla plana son muy populares.
- embargo, los monitores de pantalla plana no se han instalado siempre en los soportes adecuados o instalado de acuerdo con las recomendaciones de fabricante.
- Los monitores de pantalla plana que se han instalado inadecuadamente en tocadores, estanterías, estantes, escritorios, oradores, baules o carros se pueden caer y causar el daño corporal.
- Recuerde que los niños pueden llegar a ser excitados al ver una programación, especialmente en el monitor de pantalla plana "más grande que vida". El cuidado se tiene que empezar por poner o instalar el monitor donde no se puede empujar, detener al cuidado del camino ni echar abajo.
- El cuidado se tiene que empezar por encaminar todos los cordones y cables conectados al monitor de pantalla plana para que no se puedan tirar o agarrar conectados al monitor de pantalla plana para que no se puedan tirar o agarrar por los niños curiosos.

¿Al Fabricante le Importa

- La industria electrónica del consumidor está comprometida a hacer el entretenimiento de casa agradable y seguro.

Montaje de Pared: SI USTED DECIDE A MONTAR SU MONITOR DE PANTALLA PLANA LA PARED, SIEMPRE

- Use una montura que se ha recomendado por el fabricante de monitor y/o listado por un laboratorio independiente (como UL, CSA, ETL).
- Siga todas las instrucciones ofrecidas por el fabricante de monitor y montaje de pared.
- Si usted tiene cualquier duda sobre su habilidad para instalar seguramente su monitor de pantalla plana, contacte a su distribuidor para la instalación profesional.
- Compruebe que la pared adonde se está montando el monitor es adecuada. Algunos montajes de la pared no son diseñados para ser montados a paredes con tachones de acero o la vieja construcción de bloque de ceniza. Si usted está inseguro, contacte a un instalador profesional.
- Por lo menos dos personas se requieren para la instalación. Los monitores de pantalla plana puede ser pesados.

FCC Notice

Fcc Information

This equipment has been tested and found to comply with the limits for a Class B digital device, pursuant to Part 15 of the FCC rules. These limits are designed to provide reasonable protection against harmful interference in a residential installation. This equipment generates, uses and can radiate radio frequency energy and, if not installed and used in accordance with the instructions, may cause harmful interference to radio communications. However, there is no Guarantee that interference will not occur in a particular installation.

If this equipment does cause harmful interference to radio or television reception, which can be determined by turning the equipment off and on, the user is encouraged to try to correct the interference by one or more of the following measures:

- Reorient or relocate the receiving antenna.
- Increase the separation between the equipment and the receiver.
- Connect the equipment into an outlet on a circuit different from that to which the receiver is connected.
- Consult the dealer or an experienced radio/TV technician for help.

Device complies with FDA radiation performance standards, 21 CFR subchapter. Caution: (Invisible) Laser Radiation when open. Do not stare into beam.

HEAD PHONE: Connect a 3.5mm headphone for personal audio. **USB:** Connect your USB storage device to enjoy music/photo files on your TV. (Also used for service purpose).

HDMI IN
HDMI1/DVI, 2: (High-Definition Multimedia Interface) It provides an uncompressed digital connection that carries both video and audio data by way of an integrated mini-plug cable.
MHL: (Mobile High-Definition Link) To standard HDMI input, transmit the video/audio from portable electronic device (cellphone, digital camera, digital-video camera) to TV set.
ARC: (Audio Return Channel) Adopted in TV output of digital audio, can be connected to the device supporting ARC, transmit the TV sound to the device.

COMPONENT Y/Pb/Pr: Connect a device that has component video jacks, such as a DVD player. To access device connected to the Y/Pb/Pr jack, press the INPUT button on your remote; then press the up/down arrow to select Component. Press the OK button at last to confirm.

Y/Pb/Pr (Component Video): They provide good picture quality because the video signal is separated into three components. Use these video-grade or component video cables for the connection. When using Y/Pb/Pr, make sure you connect left and right audio cables to the AUDIO IN L/R jacks.

L-AUDIO-R, COMPOSITE: Connect an AV device that has composite video jacks, such as a VCR or a DVD player. To access device connected to these jacks, press the INPUT button on your remote; then press the up/down arrow to select AV. Press the OK button at last to confirm.

AUDIO IN L: Left audio channel connection. The left audio connector is usually white. For mono audio sources, be sure to use the left AUDIO INPUT.

AUDIO IN R: Right audio channel connection. The right audio connector is usually red.

ANT/CABLE: Connect to receive the signal from your antenna or cable via coaxial cable.

Digital Audio out: Connect a coaxial cable for digital audio output.

Keypad and Front Panel

Keypad Buttons

If you cannot locate your remote, you can use the keypad buttons on your TV to operate many TV features.

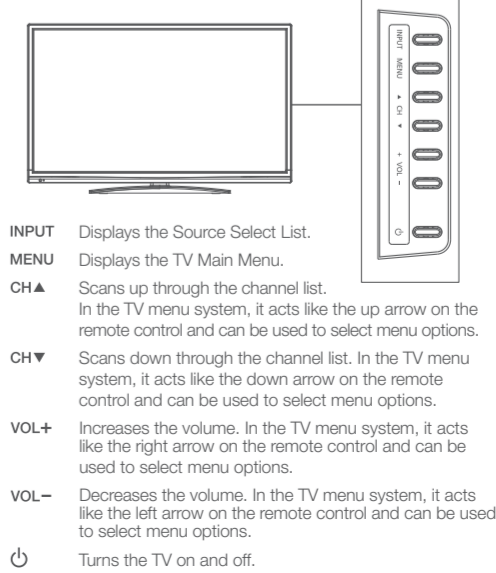

Front Panel

About remote control working distance and angle, see the quick start guide.

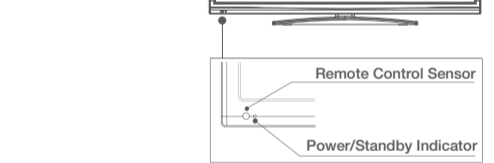

Power/Standby Indicator: Light up in red when the TV is in standby mode. Light out when the TV is on.

Remote Control Sensor: Remote control IR sensor, which receives infrared ray sent by remote control.

Codes for Cox Communications: 0178

Codes for Comcast: 10178

Codes for Dish Network: 627

Codes for Fios Verizon: 0205, 0057, 0493, 0775

Basic Operations

Turning On and Off

Connect the AC cord to power the LED LCD TV. At this time the TV will enter standby mode and power indicator will turn red. Use Power button (P) on the top panel of TV or on the remote control to turn on the TV. After switching off the TV for 5 seconds, you can turn on TV again.

Choosing TV Channel

Tuning To Analog Channels

An analog channel has a channel number beginning with "A". Input the digital number with numeric buttons directly and press OK button to confirm. For example, to watch analog channel "A51", press "51", "OK" on remote control in sequence.

Note: Although there is no analog TV signal available in America, we reserve ATV functions for some expandable use.

Tuning To Digital Channels

A digital channel has a channel number beginning with "D". Input the main digital number with numeric buttons directly, then press "-" button on remote control, and input the sub number at last.

For example, to watch analog channel "D31-1", press "31", "1", "-", "1", "OK" on remote control in sequence.

Changing Channels Directly You can use CH+ button to increase channel number and CH- to decrease channel number.

When no OSD (On Screen Display) is used, the up/down arrows can also work as CH+/CH- buttons.

Selecting Input Source

Press INPUT button on remote control to display Source Select list. Use up/down arrows to highlight the source you need and press OK to confirm.

Source Select
TV
AV
Component
HDMI 1
HDMI 2
USB
More

Channel Bar

Press the OK button on the remote control, when OSD (on-screen displays) not used, the channel bar will appear on the Bottom of the screen. It displays the current channel's information. The following list describes the items on the channel bar.

D14-1	ATSC-1	A2	
Air 4:3	English 480i Jan-01 07:10 Sat	Air CC Jan-01 07:10 Sat	Stereo 480i Jan-01 07:10 Sat
DTV			ATV
D14-1/A2	If the channel is analog, A is displayed. If it's a digital channel, D is displayed. For example, in the pictures above, A2 is an analog channel, and D50-1 is a digital channel (-1 is a sub-channel number).		
ATSC-1	Display the current TV signal type.		
English/Stereo	Displays whether the current channel is being broadcasted in stereo or mono. If the current channel is digital, this space will be SAP (Second Audio Program) language.		
480i/480i	Displays the signal resolution.		
4:3/CC	Displays the screen aspect ratio. Display the CC status (on or off).		
Jan-01 07:10 Sat	Displays current program date and time.		

Adjusting Volume

Press the VOL+/-VOL- button on the remote control to adjust the volume. If you want to switch sound off, press MUTE. When OSD (On Screen Display) is not used, the arrows left/right can also work as VOL-/VOL+ buttons.

EPG (Electronic Program Guide)

Press EPG button on the remote control, the electronic program guide will appear in the center of screen. The electronic program guide gives the TV program playing project. You can use left/right arrows to switch pages.

OSD Menu Operations

Adjust the OSD Screen

The OSD (On Screen Display) menu enables you to approach to the TV functions.

To use OSD menu system, press OK button on remote control, then use left/right arrow to highlight an option from QUICK, CHANNEL, PICTURE, AUDIO, TIME, SETUP or LOCK and press OK/down button.

Press the up and down arrow to move to a different option within each menu. If necessary, press OK or right arrow to display the choices of the option you've highlighted. If available, use the text at the bottom of each screen for help. To return to the previous menu, press the MENU button.

To exit the OSD menu:

- Press the EXIT button. The menu will clear from the screen.
- Press the MENU button repeatedly until the menus disappear.

How do I tell an analog channel from a digital channel?

Press the OK button to display the Channel Bar. When OSD (on-screen display) not used, Look at the top right corner of the screen. An "A" is displayed for an analog channel. A "D" is displayed for a digital channel.

Note: Since the analog TV in America has been cut off, we reserve analog TV function only for some unexpected use.

Why are there bars on my screen, and can I get rid of them?

Most digital video is sent in a 16/9 format which fills your screen, but is sometimes sent in 4/3 which does not fill your screen. It depends on how the station or device connected to your TV is formatting the video. If there are bars on the screen, Check Screen size in the picture mode to try a different format that may eliminate the bars. Some bars can't be removed because of the way the format is sent by the broadcaster. The format changes as you choose screen size type in the picture mode and the format type is displayed at the bottom of the screen. For more information on screen size, go to page 9.

Why does channel search find a lot of channels, but when I try to tune to them, there's nothing there?

Some channels don't carry programming, such as video On Demand. When channels are unavailable, your TV screen is blank or appears like snow. You probably want to remove these channels from your channel list. Remove these in the Channel List Menu. Go to page 8 for more information.

Why does it take a long time when I search the channels at first time?

If you have both analog and digital channels, the TV is looking for all available channels in the channel list. If you do have digital channels, the TV is also searching for scrambled channels, non-scrambled channels, and each sub-channel of that digital channel.

Troubleshooting

Identifying Problems

If there are any problems when using the product, please consult the list below. If the list does not solve the problem, call our Customer Service Center immediately.

TV Problems

The TV can't be turned on.

- Make sure the AC cord is plugged in.
- Check the wall outlet, make sure the AC output works normally and stably.
- The side panel may be locked (disabled). Use the remote control to turn on the TV.
- Select the Keypad Lock function in the PARENTAL control Menu and press OK to uncheck the locking status.

There is no picture or sound but the TV is on and there is a "No Signal" sign on screen.

- Are you trying to use an input source with no device connected to it? For using other video/audio device, make sure the external device works normally first, then press INPUT and choose the right input source.
- The Signal Type option may be set incorrectly. Go to page 8 for detailed instructions.
- The channel may be blank. Try to search the channel again or change another channel.

The sound is fine, but the picture is poor.

- If you can only get black and white pictures from external device that you've connected to your TV, maybe it is due to the video

Quick Menu

The Quick Menu contains menus and provides you a quick way to approach the main settings that may be most possibly and frequently approached. Press MENU on the remote and then you will see the Quick Menu showing on your screen. Press the down button to proceed the Quick Menu. Use up/down to choose the function you need, press OK to enter a sub-menu and press left/right arrow to adjust a sub-menu.

PICTURE					
PICTURE Mode					
Sound Mode					
Closed Caption					
Sleep Timer					
Channel List					
Move Select Return					

Channel Menu

The Channel Menu enables you to search, view and edit channels. It is available in TV mode only. Press MENU and choose CHANNEL from the Main Menu. Press the OK/down button to proceed to CHANNEL menu.

CHANNEL					
Auto Scan					
Show / Hide					
Channel List					
Signal Type					
DTV Signal					
Move Select Return					

Use up/down to choose the function you need, press OK or right arrow to adjust or enter a sub-menu. The detailed explanation are shown below.

Auto Scan

Execute an auto channel search.

Show / Hide

Enter sub-menu and press OK to show or hide the TV channel.

Channel List

Displays a channel list. It shows the current channels. Press OK to go to TV channel directly in sub-menu.

Signal Type

Select your TV signal type: Air or Cable.

DTV Signal(In DTV Mode)

Display how strong your TV signal is.

Picture Menu

The Picture Menu contains menus and controls to configure the way the picture appears. The Picture Menu options apply to the video for the main TV and VIDEO INPUT selections. All picture options can be applied to each input.

Press MENU on the remote. Select Picture from the Main Menu. Press the OK/down button to proceed to PICTURE menu.

PICTURE					
Picture Mode					
Color Mode					
Screen Size					
Noise Reduction					
Dynamic Contrast					
Video Style					
Move Select Return					

Use up/down to choose the function you need, press OK or right arrow to adjust or enter a sub-menu. The detailed explanation are shown below. If available, use the text at the bottom of each screen for help.

Picture Mode

Choose the preset visual mode of your TV: Standard, Movie, User, Dynamic, Power Saving.(Only in User mode you can adjust Brightness, Contrast, Color, Tint and Sharpness. Changes to Power Saving mode can decrease the power consumption.)

- Brightness:** Adjust the brightness of picture.

- Contrast:** Adjust the contrast of color.

- Color:** Adjust the richness of color.

- Tint:** Adjust the balance between red and green level (only available in NTSC signal).

- Sharpness:** Adjust the sharpness level of picture.

Color Mode

This option allows you to select one of three automatic color adjustments: Cool for a bluer palette of picture colors; Normal or Warm for a redder palette of color.

Screen Size: Select a screen aspect ratio. (Available ratio: Wide, Cinema, Zoom, and Normal.) Please choose the ratio that applies to your video signal format best.

Noise Reduction

Set noise reduction as Off/low/Medium/High.

Note: Noise reduction helps to reduce the picture "static" or any type of interference. This feature is especially useful for providing a clearer picture in weak analog signal conditions.

Dynamic Contrast

Set dynamic contrast Off/low/Medium/High.

Video Style

If you connect the HDMI/DVI port of PC to HDMI jack of the TV and the video signal is 1080p, please choose the **compatible video style:** Video, Graphic.

Note: This model doesn't support Video Style function.

Audio Menu

The Audio Menu lets you adjust audio output. To access the Audio Menu, press MENU on the remote, and then select Audio from the Main Menu. Press OK/down button to proceed to AUDIO menu.

AUDIO					
Sound Mode					
Audio Language					
Analog Audio Output					
Digital Audio Output					
Surround					
Audio Only					
Move Select Return					

Sound Mode

Select your TV signal type: Air or Cable.

Audio Language

Select your TV signal type: Air or Cable.

Analog Audio Output

Select your TV signal type: Air or Cable.

Digital Audio Output

Select your TV signal type: Air or Cable.

Surround

Select your TV signal type: Air or Cable.

Audio Only

Select your TV signal type: Air or Cable.

Use up/down to choose the function you need, press OK or right arrow to adjust or enter a sub-menu. The detailed explanation are shown below.

Sound Mode

Choose the preset sound mode of your TV: Standard, Soft, User, Dynamic. Only in User mode you can adjust Bass, Treble, Balance.

- Bass:** Adjust the bass component of TV sound.

- Treble:** Adjust the treble component of TV sound.

- Balance:** Adjust the balance between the left and right channel.

Audio Language

Select digital TV audio language type: English, French or Spanish (only available for DTV channel).

Analog Audio Output

Select analog TV audio sound type: Stereo, SAP or Mono (only available in TV mode).

Digital Audio Output

Set the audio output type as Off, PCM or Raw. Please select this option according to your power amplifier.

Surround

Creates a 3D sound surround from standard stereo material, with deep and rich enhancement.

Audio Only

Press OK button to activate audio only mode. The TV will output only sound and the LED LCD panel will be turned off. To restore normal playing, hold POWER button for three seconds.

Auto Volume

Set auto volume control on/off.

Equalizer Settings

The seven-band graphic equalizer allows you to adjust the audio frequency settings. You can select one of the equalizer presets (Off, Pop, Rock, Jazz) or create your own personal preset (User). Press the left or right arrow to select the frequency (100Hz, 250Hz, 500Hz, 1KHz, 2KHz, 4KHz, 10KHz), you want to adjust. Use the up or down arrow to adjust.

Time Menu

The Time Menu lets you change the TV time settings. To access the Time Menu, press MENU on the remote, and then select Time from the Main Menu.

TIME					
Sleep Timer					
Time Zone					
Auto Clock					
Clock					
Wake Up					
OSD Display Duration					
Move Select Return					

Use up/down to choose the function you need, press OK or right arrow to adjust or enter a sub-menu. The detailed explanation are shown below.

Sleep Timer

Set the sleep timer(Off, 5, 10, 15, 30, 60, 90, 120, 180, 240 Min.). The TV will automatically enter standby mode after times up.

Time Zone

Showing the country's time zone, you can Set Time zone Off Eastern, Central, Mountain, Pacific, Alaska, Hawaii, Samoa, Newfoundland, Atlantic.

Media Support Specification

Supported Files	
• Photo	JPG/JPEG files
• Music	WAV files
• Movie	MPG files
Supported USB storage/file system format	
• USB Storage	USB flash drive
• File System format	FAT32

Caution: Do not turn off the TV or disconnect USB storage device while the TV is playing back picture or music.

This may result in loss of data or damage to the USB storage device, and RCA is not responsible for any damage to, or loss of, data on the USB storage device.

USB Media Play

With USB Media Play, you can enjoy music and photo files stored in a USB storage device on your RCA TV.

Connecting a USB storage device	
- Connect a USB storage device to the USB port in the back of the TV.	
- Press "INPUT" and select "USB".	
- "USB Media Play" menu will appear.	
USB 2.0	
PHOTO MUSIC MOVIE TEXT	

PHOTO MUSIC MOVIE TEXT			

Playing back Photo files

- Press arrow (◀▶) to select "Photo" and press "OK".
- The file or folder list will show up. Press arrow(▲▼) to select a file or folder. Press "OK", and you will be given several options to view photo files.
- You can directly open and playback the file. View thumbnails for photo preview, or play slideshow.

Playing back Music files

- Press arrow (◀▶) to select "Music" and press "OK".
- The file or folder list will show up. Press arrow(▲▼) to select a file or folder. Press "OK" to playback the music file you selected.

Playing back Movie files

- Press arrow (◀▶) to select "MOVIE" and press "OK".
- The file or folder list will show up. Press arrow(▲▼) to select a file or folder. Press "OK" to playback the movie file you selected.

Playing back Text files

Similar to the photo menu, You can use TEXT menu to access and display text on your RCA TV.

Auto Clock

Select auto clock on/off. Auto clock helps you synchronize your TV time to standard time (from DTV signal).

Clock

Set your TV time manually (needs to turn off auto clock), press up/down and left/right arrow to config the current time.

Wake Up

Set the Wake Up time for your TV. after enters menu, you can use the up/down and left/right arrow on the remote control to adjust it.

OSD Display Duration

Set the time how long to display OSD menu(5 Sec, 15 Sec, 30 Sec, 45 Sec, 60 Sec).

Setup Menu

The Setup Menu lets you config the TV with your preferences. Select SETUP from the Main Menu. Press OK/down button to proceed to SETUP menu.

SETUP					
Menu Language					
Menu Transparency					
Closed Caption					
All reset					
Initial Setup Wizard					
Blue Background					
Move Select Return					

Use up/down to choose the function you need, press OK or right arrow to adjust or enter a sub-menu. The detailed explanation are shown below.

Menu Language

To choose your menu language, press the left/right arrow until the language you need appears. **Available languages:** English, French and Spanish.

Transparency

To choose your menu transparency mode, press the left/right arrow until the transparency you need appears: 0%, 25%, 75% 100%.

Closed Caption

Press OK to enter closed caption sub-menu, the detail as follow.

LOCK					

 SETUP Closed Caption	Caption Display	◀ CC Off ▶
	Digital Caption Type	
	Digital Caption Style	
Show or hide closed caption		
▲ Move	◀ ▶ Change Setting	⏮️ ⏭️ Return