

- 11** Insert and tighten the T-10 (Torx) screw in the bottom of the Smart-Lock cover.

Note: This screw is not mandatory, but it protects against undesired access to the inside of the lock.

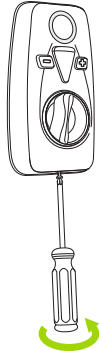

- 12** The installation process is complete.

You are now ready to register your Smart-Lock online.

- 13** Create your account at:
<https://portal.okidokeys.com>
Register your Smart-lock according to the online instructions.



If you purchased a Smart-reader, please install it before going through the registration process.

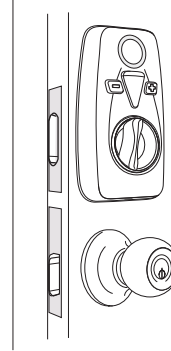

SMART-LOCK INSTALLATION GUIDE

You can view the OKIDOKEYS Smart-Lock installation video online at:
www.okidokeys.com/installation,

or scan the QR code.



Your metal keys.

Your existing metal keys are still working with your new OKIDOKEYS Smart-Lock. To achieve this, your Smart-Lock motor will operate some cycles after each locking or unlocking, to reach its original position and be ready for next move. The motor is also programmed to reposition your Smart-Lock to its previous position (locked or unlocked) in case of incomplete manual operation. In this case, you will hear a sound and the motor moving.

If you need further assistance, let us help.

You can find additional help and information at our OKIDOKEYS support forum at:
support.okidokeys.com

For additional support, returns, or questions, please contact us through any of the following methods (all times are Eastern Time)

Visit our website: **www.okidokeys.com**

Call: **888-853-2309** | Monday-Friday 8 a.m. to 8 p.m. | Saturday 10 a.m. to 4 p.m.

Email: **support@okidokeys.com**

FCC/IC Regulatory notices.

Modification statement:

Practical House has not approved any changes or modifications to this device by the user. Any changes or modifications could void the user's authority to operate the equipment.

Interference statement:

This device complies with Part 15 of the FCC Rules and Industry Canada licence-exempt RSS standard(s). Operation is subject to the following two conditions: (1) this device may not cause interference, and (2) this device must accept any interference, including interference that may cause undesired operation of the device.

Wireless notice:

This device complies with FCC/IC radiation exposure limits set forth for an uncontrolled environment and meets the FCC radio frequency (RF) Exposure Guidelines and RSS-102 of the IC radio frequency (RF) Exposure rules. This transmitter must not be co-located or operating in conjunction with any other antenna or transmitter.

FCC Class B digital device notice:

This equipment has been tested and found to comply with the limits for a Class B digital device, pursuant to part 15 of the FCC Rules. These limits are designed to provide reasonable protection against harmful interference in a residential installation. This equipment generates, uses and can radiate radio frequency energy and, if not installed and used in accordance with the instructions, may cause harmful interference to radio communications. However, there is no guarantee that interference will not occur in a particular installation. If this equipment does cause harmful interference to radio or television reception, which can be determined by turning the equipment off and on, the user is encouraged to try to correct the interference by one or more of the following measures:

- Reorient or relocate the receiving antenna.
- Increase the separation between the equipment and receiver.
- Connect the equipment into an outlet on a circuit different from that to which the receiver is connected.
- Consult the dealer or an experienced radio/TV technician for help.

CAN ICES-3 (B) / NMB-3 (B):

This Class B digital apparatus complies with Canadian ICES-003.

- 1 - Install your Smart-Lock**
- 2 - Create your account on portal.okidokeys.com and register your Smart-Lock**
- 3 - Create users and assign them to your Smart-Lock**
- 4 - Install the OKIDOKEYS App and synchronize your Smart-Lock**

IMPORTANT:

Before you begin the Smart-Lock installation, ensure that your existing deadbolt engages freely into the locked position. You should not have to push, pull, or force the existing deadbolt into position. If the deadbolt does not engage freely into position, make the necessary adjustments according to your existing deadbolt installation instructions.

Once the existing deadbolt engages freely into the locked position, you are ready to begin installing your Smart-Lock system.

PARTS LIST:

- 1 (x4) AAA Batteries
- 2 (x1) D-shaped Key Cylinder Spindle Adapter
- 3 (x1) Flat Key Cylinder Spindle Adapter
- 4 (x2) Long Phillips-head Screws
- 5 (x1) T-10 (Torx) Screw
- 6 (x1) Sensor Kit (Screw, Sensor, Magnet)
- 7 (x1) T-10 (Torx) Screwdriver
- 8 (x1) **Reversible** (Phillips/Flathead) Screwdriver
- 9 (x1) Metal Plate and Rubber Gasket
- 10 (x1) Smart-Lock and optional covers

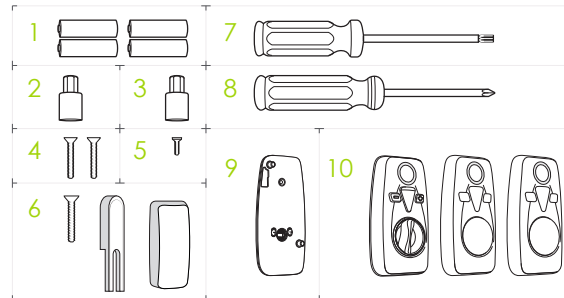

- 1** Apply tape to the outside key cylinder.

Note: This keeps the key cylinder on the door while you install the Smart-Lock.

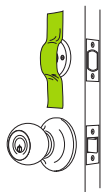

- 2** Remove the **two screws** from the existing interior deadbolt.

Note: Place the screws in a safe location. You will need them during Step 3.

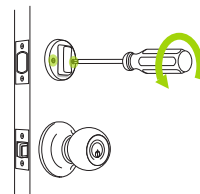

Remove the interior thumb-turn.

Ensure the deadbolt is retracted inside the door before removing the thumb-turn.

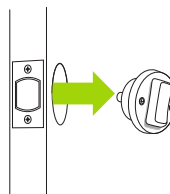

- 3** Align the Smart-Lock metal plate and rubber gasket against the door.

Insert the **two screws** from Step 2 through the two lower holes. Tighten the screws into the external key cylinder.

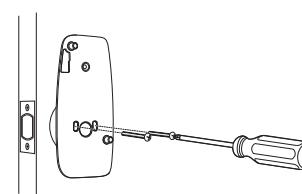

- 4.1** Remove the Smart-Lock cover.



Select the appropriate adapter to match the existing spindle.

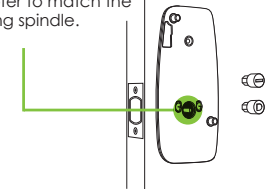

- 4.2** Align and insert the adapter to the magnetic hole in the rear of the Smart-Lock.

Thumb turn should be vertical

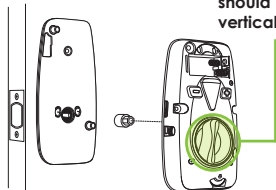

- 5** Align the Smart-Lock to the spindle adapter. Insert and tighten one phillips-head screw into the top-left hole in the Smart-Lock. Insert and tighten one phillips-head screw into the bottom-right hole in the Smart-Lock.

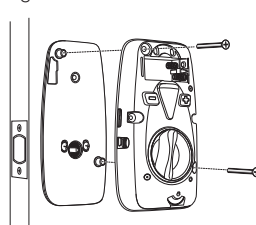

- 6** Use the Smart-Lock metal thumb-turn to lock and unlock the deadbolt. Ensure the deadbolt moves freely and engages completely into the door frame.



Note: Test your metal key in the outside key cylinder.

- 7** Take a picture or write down the 17-character serial number on the side sticker. This will be used to register your lock online.

Install the four AAA batteries.

A light will appear for eight seconds to indicate power up.

XXX11AA22B833CCXX

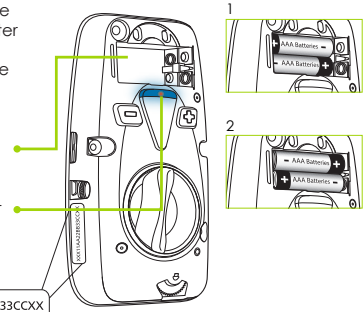

- 8** Use provided screwdriver to press the button for 3 sec. to launch the Smart-Lock auto-learning process. The Smart-Lock will cycle through a series of movements to learn about your deadbolt and optimize future locking / unlocking.

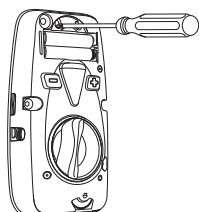

A green light will flash three times to indicate successful alignment.

This aligns your lock to the correct direction of locking and unlocking the deadbolt. If unsuccessful, try again.

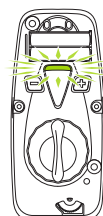

- 9** After a 5 sec. pause, the Smart-lock is ready to test.

- The **+** button will move the bolt to the right.
- The **-** button will move the bolt to the left.

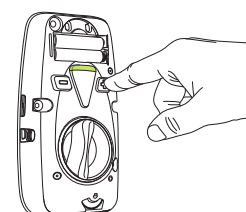

- 10** Choose the cover that best compliments your door or existing hardware.

Replace the Smart-Lock cover.

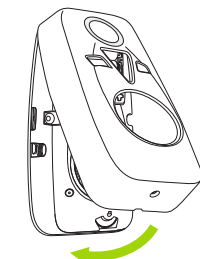

Note: Installation continues on back.