



All products are trademarks of Nostalgia Products LLC.  
Worldwide design & utility patented or patents pending.  
© 2014 Nostalgia Products LLC.

[www.nostalgiaproducts.com](http://www.nostalgiaproducts.com)

(rev. 12/10/14)



**KPM508  
SERIES**

**Vintage Collection™ Kettle Popcorn Maker**  
**Machine à Popcorn de la Collection Vintage**  
**Fábrica de Palomitas de Maíz con Olla**

Instructions and Recipes  
Instructions et Recettes  
Instrucciones y Recetas



Make every day a party!  
Visit [www.nostalgiaproducts.com](http://www.nostalgiaproducts.com) for more fun products.

## CONTENTS

IMPORTANT PRECAUTIONS . . . . .	3
IMPORTANT SAFEGUARDS . . . . .	3
INTRODUCTION . . . . .	4
PARTS & ASSEMBLY . . . . .	5
HOW TO OPERATE . . . . .	6
HELPFUL TIPS . . . . .	7
CLEANING & MAINTENANCE . . . . .	7
RECIPES . . . . .	8
RETURNS & WARRANTY . . . . .	10

## SAFETY

Your safety and the safety of others is very important.

We have provided many important safety messages in this manual and on your appliance. Always read and obey all safety messages.



This is the safety alert symbol.

This symbol alerts you to potential hazards that can kill or hurt you and others.

All safety messages will follow the safety alert symbol.

All safety messages will tell you what the potential hazard is, tell you how to reduce the chance of injury, and tell you what can happen if the instructions are not followed.

### **Appliance Specifications:**

120 Volts, 60 Hertz

390 Watts, ETL Approved

THIS PRODUCT IS FOR USE IN 120V AC OUTLET ONLY.

## IMPORTANT PRECAUTIONS

1. NEVER immerse in water.
2. NEVER use near water.
3. NEVER use an abrasive sponge or cloth.
4. NEVER use a scouring pad on the appliance.
5. NEVER leave appliance unattended while in use.
6. NEVER force Kettle in or out of the brackets as this may cause gears to become misaligned and appliance will not operate properly.
7. Unplug unit from outlet when not in use and during cleaning.
8. DO NOT operate this appliance with a damaged cord or plug, nor if the appliance ever malfunctions.
9. DO NOT clean any parts of this appliance in a dishwasher.
10. Keep out of reach of children.
11. This appliance is NOT A TOY.
12. Unsupervised young children and cognitively challenged individuals should never operate this appliance.
13. Young children should be supervised while in proximity of the appliance to ensure that they do not play with it.

## IMPORTANT SAFEGUARDS

Basic safety precautions should always be followed when using electrical appliances, including the following:

1. Read all instructions before operating this appliance.
2. Keep door of Main Unit closed while operating. Do not touch Kettle while operating; it gets very HOT.
3. To protect against electrical shock do not immerse cord, plug or any part of this appliance in water or other liquids.
4. Close supervision is necessary when any appliance is used near children.
5. Unplug from outlet when not in use, before removing parts and before cleaning.
6. DO NOT operate any appliance with a damaged cord or plug, nor if the appliance has been damaged in any manner. Return the appliance to the nearest repair shop for examination or repair.
7. The manufacturer does not recommend the use of accessory attachments. Use of accessory attachments may cause injuries.
8. Do not attempt to service this appliance yourself, as opening or removing covers may expose you to dangerous voltage or other hazards. Refer all servicing to qualified service personnel.
9. DO NOT use outdoors; for household use only.

10. Position the appliance as close to the outlet as possible to prevent injury due to tripping over cord.
11. DO NOT leave Kettle motor running once popping has ceased.
12. Extreme caution must be used when moving this appliance.
13. DO NOT use the appliance for other than its intended use.
14. An appliance that is plugged into an outlet should not be left unattended while in operation.
15. Check Kettle for presence of foreign objects prior to use.
16. Make sure the Kettle is properly attached to brackets before operating and that the motor plug is plugged into the Kettle.
17. A short power supply cord is provided to reduce the risk resulting from becoming entangled or tripping over a long cord.
18. Longer detachable power supply cords can be used if care is exercised in their use.
19. The marked electrical rating of an extension cord should be at least as great as the electrical rating of the appliance.
20. This appliance has a polarized plug (one blade is wider than the other). To reduce the risk of electrical shock, this plug is intended to fit into a polarized outlet only one way. If the plug does not fit fully into the outlet, reverse the plug. If it still does not fit, contact a qualified electrician. Do not attempt to modify the plug in any way.

## SAVE THESE INSTRUCTIONS!

### INTRODUCTION

Thank you for purchasing the VINTAGE COLLECTION™ KETTLE POPCORN MAKER. With its unique style, reminiscent of large vendor carts from the early 1900s, this popcorn popper will be the hit of every party! It features a stainless steel Kettle with a built-in stirring system and pops up to 10 cups of popcorn per batch. It includes a Measuring Spoon for oil and a Measuring Cup for popcorn kernels, so every batch pops perfectly. A tempered window and light allows you to watch the popcorn popping. With the VINTAGE COLLECTION™ KETTLE POPCORN MAKER, popcorn has never tasted so good at home!

# PARTS & ASSEMBLY

## ASSEMBLY

Your VINTAGE COLLECTION™ KETTLE POPCORN MAKER comes fully assembled. Simply insert the Kettle into brackets and screw in the Crank Handle by turning crank handle counter-clockwise to tighten.

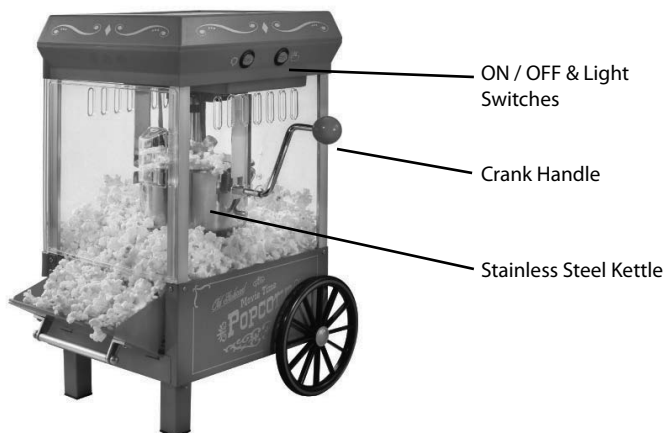

## PARTS

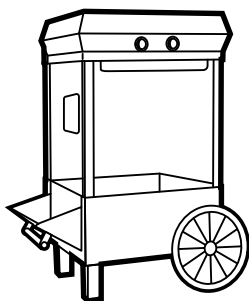

(A) Main Unit

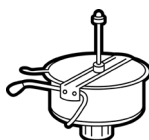

(B) Kettle



(C) Kernel  
Measuring Cup ( $\frac{1}{4}$   
cup = 2 oz)



(D) Oil Measuring  
Spoon (1 tbsp)

## HOW TO OPERATE

Before first use, clean the inside of the unit by wiping with a moist, non-abrasive sponge, towel or cloth and then wipe with a non-abrasive dry towel. Wipe down the inside of the Kettle and be sure it is properly placed in the brackets before starting.

1. First, find a flat surface near an electrical outlet before starting. Make sure your cord is away from any water source. It is acceptable to use an extension cord if needed.
2. Gather your popcorn making supplies: popcorn, seasonings, bowls or bags for holding the popcorn, cooking oil, Kernel Measuring Cup and Oil Measuring Spoon. (Kernel Measuring Cup and Oil Measuring Spoon are included with your unit)
3. Plug in the appliance while switch is flipped to OFF position.
4. Make sure Kettle is properly secured in support brackets.
5. Make sure Kettle motor is fully plugged into the outlet located on the bottom side of the kettle. **NOTE:** Kettle will not heat if plug is not fully inserted.
6. Turn appliance ON by flipping the switch on the top of the machine. Allow the appliance to run 3-5 minutes to heat up Kettle.
7. Turn unit OFF.
8. Use the Oil Measuring Spoon supplied with your VINTAGE COLLECTION™ KETTLE POPCORN MAKER to add 1 tablespoon of your favorite popcorn cooking oil to the Kettle. For best popping results, it is suggested to use vegetable oil.
9. Add ¼ cup (2 oz) popcorn kernels to the Kettle using supplied Kernel Measuring Cup.
10. Turn the unit ON and close the door. In no time at all, you will hear the popping begin. Fresh, hot popcorn will begin to burst out of the flip lids on the Kettle - just like at the theater!
11. Once the kernels have stopped popping, tip the Kettle using the red knob on the Crank Handle to release the popcorn.



## HELPFUL TIPS



**NEVER leave the unit unattended while operating.**

### SMOKING

If your VINTAGE COLLECTION™ KETTLE POPCORN MAKER begins to smoke during cooking, it may be due to grease build up. In order to reduce smoking, make sure that you clean the inside of the Kettle between uses.

### POPCORN

For best results, use an all natural soft-shelled popping corn. Some brands of kernels have a harder outer shell and may result in fewer popped kernels.

## CLEANING & MAINTENANCE

1. Make sure appliance is unplugged and completely cooled before cleaning. Unplug the outer plug to the outlet as well as the Kettle motor plug inside the Main Unit.
2. Use slightly damp, non-abrasive sponge, towel or cloth to wipe down the inside and outside of Main Unit, then wipe with a non-abrasive towel to dry.
3. After Kettle motor has been unplugged and Kettle has completely cooled, turn Crank Handle clockwise to loosen and remove from Kettle.
4. Remove Kettle from support brackets.
5. Take Kettle out of the Main Unit. After removing Kettle from Main Unit, fill  $\frac{2}{3}$  of Kettle with hot, soapy water.
6. Let the Kettle sit for 15 – 20 minutes to cut the grease. (time may vary – use your own judgment depending on the amount of cleaning necessary)
7. Empty water. If necessary, use the scrubber side of a cleaning sponge to scrub inside of Kettle.
8. Rinse inside carefully and dry.
9. Wipe outside of Kettle with damp cloth and dry.
10. Reattach Kettle to Main Unit and then reattach the Crank Handle by inserting Crank Handle into the Kettle. Turn the Crank Handle counter-clockwise to tighten.

**NOTE:** To protect the motor plug from getting wet, **never immerse the Kettle in any liquid.** Never place any parts in the dishwasher. Always wash by hand.

# RECIPES

The VINTAGE COLLECTION™ KETTLE POPCORN MAKER makes hot, fresh, theater style popcorn anytime! Enjoy your freshly popped corn in a variety of ways:

- Regular theater style popcorn – add butter and salt.
- Add a pinch of sugar and salt to popcorn for a sweet kettle corn taste.
- Flavored popcorn – add seasoning from any gourmet popcorn seasoning kit.
- Try some of these fun recipes

**NOTE:** 1 Gallon = 16 Cups

## PARMESAN POPCORN

- 1 Gallon Popped Corn      Pop corn kernels using the VINTAGE COLLECTION™ KETTLE POPCORN MAKER as directed on page 6.
- 1 Tsp. Garlic Powder
- 3 Green Onions, finely chopped      Combine garlic powder, green onions, cracked pepper, sea salt and parmesan cheese. Set aside.
- ½ Tsp. Cracked Pepper      In a large mixing bowl, drizzle hot olive oil over popcorn.
- 1 Tsp. Sea Salt      Toss until well coated.
- 1 Cup Parmesan Cheese, grated (more or less to taste)      Slowly add in dry ingredients while continuously stirring popcorn until well coated.
- 3 Tbsp. Olive Oil, heated      You may also shake the dry ingredients over popcorn in a large paper or muslin bag.

## TRADITIONAL POPCORN BALLS

- ½ Cup Unpopped Popcorn      Pop corn kernels using the VINTAGE COLLECTION™ KETTLE POPCORN MAKER as directed on page 6.
  - ½ Cup Corn Syrup
  - ½ Cup Granulated Sugar
  - ½ Tsp. Salt
  - 1 Stick of Butter, softened
- Mix corn syrup, sugar and salt together in pot and dissolve over medium heat for about 3 minutes.
- Add popcorn to pot, stirring and tossing consistently until popcorn is evenly coated at low heat.
- Remove from heat.
- Use softened butter to form balls while popcorn mixture is still warm.
- Wrap individual balls in plastic wrap, tie and store at room temperature.

**CHUNKY MONKEY**

- 1 Gallon Popped Corn  
Pop corn kernels using the VINTAGE COLLECTION™ KETTLE POPCORN MAKER as directed on page 6.
- 1 (12-oz.) Bag Semi-Sweet Chocolate Chips  
Melt chocolate chips and peanut butter morsels over stove, as packaging recommends.
- 1 (12-oz.) Bag Peanut Butter Morsels  
Line cookie sheet with wax paper.
- 1 (4.2-oz.) Bag Banana Chips, broken into small pieces  
Toss together popcorn and banana chips.  
Spread popcorn and banana chip mixture evenly over cookie sheet.
- 1 (11-oz.) Bag Peanuts  
Drizzle melted chocolate and peanut butter mixture over popcorn and banana chips.  
Sprinkle peanuts over chocolate and peanut butter mixture.  
Allow to cool.  
When chocolate and peanut butter has hardened, break up the Chunky Monkey into pieces.  
Can be stored in plastic freezer bags.

**POPCORN PEPPERMINT BARK**

- 1 Gallon Popped Corn  
Pop corn kernels using the VINTAGE COLLECTION™ KETTLE POPCORN MAKER as directed on page 6.
- 1 (12-oz.) Bag Semi-Sweet or Dark Chocolate Chips  
Melt chocolate chips over stove, as packaging recommends.
- 1¼ Cup Peppermint Sticks, crushed  
Line cookie sheet with wax paper.  
Spread popcorn evenly over cookie sheet.  
Drizzle melted chocolate over popcorn.  
Sprinkle crushed peppermints over chocolate.  
Allow to cool.  
When chocolate has hardened, break up Popcorn Peppermint Bark into pieces.  
Can be stored in plastic freezer bags.

# RETURNS & WARRANTY

SHOULD YOUR UNIT NOT WORK OR IF DAMAGED WHEN YOU FIRST TAKE IT OUT OF THE BOX, PLEASE RETURN IT TO THE PLACE OF PURCHASE IMMEDIATELY.

## VINTAGE COLLECTION™ KETTLE POPCORN MAKER / KPM508 SERIES

Should you have any questions, please contact us via email or at the customer service number listed below between the hours of 8:00 AM and 5:00 PM, Monday through Friday, Central Standard Time.

### Distributed by:

Nostalgia Products LLC  
1471 Partnership Dr.  
Green Bay, WI 54304-5685  
Customer Service  
Phone: (920) 347-9122  
Web: [www.nostalgiaproducts.com](http://www.nostalgiaproducts.com)

### Customer Service Inquiry

To submit a Customer Service inquiry, go to [www.nostalgiaproducts.com](http://www.nostalgiaproducts.com) and fill out the Customer Service Inquiry form and click the Submit button.

A representative will contact you as soon as possible.

### Product Warranty Terms

Nostalgia Products LLC (the "Company") hereby warrants that for a period of one (1) year from the date of original purchase, this product will be free of defects in material and workmanship under normal home use, provided that the product is operated and maintained in accordance with the operating instructions. As the sole and exclusive remedy under this warranty, the Company will at its discretion either repair or replace the product found to be defective, or issue a refund on the product during the warranty period. This warranty is only available to the original retail purchaser of the product from the date of initial retail purchase, and is only valid with the original sales receipt, as proof of purchase date is required to obtain warranty benefits. All warranty claims must be brought to the attention of the Company within the warranty period and no later than 30 days of the failure to perform. This warranty does not cover normal wear or damage caused by shipping, mishandling, misuse, accident, alteration, improper replacement parts, or other than ordinary household use. You may be required to return the product (with shipping prepaid by you) for inspection and evaluation. Return shipping costs are not refundable. The Company is not responsible for returns damaged or lost in transit. Unless otherwise specifically permitted by the operating instructions, this warranty applies to indoor household use only. In order to obtain service under this warranty, please contact the Company at the telephone number listed above or by filling out the Customer Service Inquiry Form located at [www.nostalgiaproducts.com](http://www.nostalgiaproducts.com). Warranty valid only in USA and Canada.

This warranty is in lieu of all other warranties, expressed or implied, including warranties of merchantability and fitness for a particular purpose, which are hereby excluded to the extent permitted by law. In no event shall the Company be liable for any indirect, incidental, consequential, or special damages arising out of or in connection with this product or the use thereof. Some states, provinces or jurisdictions do not permit the exclusion or limitation of incidental or consequential damages, so the foregoing exclusion or limitation may not apply to you.

### This warranty does not apply to re-manufactured merchandise.

Please read the operating instructions carefully. Failure to comply with the operating instructions will void this warranty.

### For more information, visit us online at [www.nostalgiaproducts.com](http://www.nostalgiaproducts.com).

Like us on Facebook at [www.facebook.com/NostalgiaElectrics](http://www.facebook.com/NostalgiaElectrics).

Follow our boards on Pinterest at [www.pinterest.com/nostalgiaelctrx](http://www.pinterest.com/nostalgiaelctrx).

Tweet along with us on Twitter at [www.twitter.com/NostalgiaElctrx](http://www.twitter.com/NostalgiaElctrx).