

IMPORTANT INSTRUCTIONS & OPERATING MANUAL

FRIGIDAIRE®

Monaco

Wall Mount Vertical Style LED Fireplace

Item No: MWF-1/0304



Read these instructions carefully before attempting to assemble, install, operate or maintain the product. Protect yourself and others by observing all safety information. Failure to comply with instructions could result in personal injury and / or property damage. Retain instructions for future reference.



GENERAL SAFETY INFORMATION

When using this fireplace, basic precautions should always be taken to reduce the risk of fire, electric shock and injury to persons, including the following:

CAUTION – Due to the high temperature, keep electrical cords, drapery and other furnishings at least 3 feet from the front, side and rear of the fireplace.

1. Carefully read all instructions before using the fireplace and retain for future reference.
2. Remove the unit from its packaging and check to make sure it is in good condition before use.
3. Do not let children play with any parts of the packing (such as plastic bags, etc.).
4. Check the household voltage to ensure that it matches the fireplace's rated specification.
5. Before using the fireplace, carefully check the power cord and plug for any damage.
6. Be sure that the room is equipped with a working smoke detector.
7. Before unplugging the power cord, turn off the power. When touching the unit, keep your hands dry to prevent electric shock.
8. Do not place the fireplace near curtains or other inflammable objects. Keep combustible materials, such as pillows, bedding, papers, clothes, and curtains at least 3 feet away from the front, side and rear of the fireplace.
9. Do not block air intakes or exhaust in any manner to prevent fire.
10. Do not use on soft or uneven surfaces, like a bed, where openings may become blocked.
11. Exhibit extreme caution when any fireplace is in the vicinity of children and infants.
12. Never leave children or infants unattended while the fireplace is on or plugged in.
13. When not in use, always unplug the fireplace.
14. Prevent water from entering the housing of the fireplace during operation or while in storage.
15. Always store the fireplace in a dry area free from any moisture. This fireplace is not intended for use in bathrooms, laundry areas, or similar indoor locations. Never place the fireplace where it may fall into a bath tub or get exposed to water in any way.
16. Do not use in places where gasoline, paint, or other inflammable liquids are used or stored.
17. Do not run the cord under carpets. Do not cover the cord with throw rugs, runners, or similar products. Arrange the cord away from traffic areas such that it will not be tripped over by anyone.
18. Do not operate any fireplace with a damaged cord, a damaged plug, after the fireplace malfunctions, or if it has been dropped or damaged in any manner. Return the fireplace to an authorized service facility for examination, electrical or mechanical adjustment, or repair.
19. Do not insert fingers or allow foreign objects to enter any ventilation or exhaust opening as this may lead to an electric shock or fire, or may even damage the fireplace.
20. This fireplace becomes hot during use. To avoid burns, do not let bare skin touch hot surfaces. If necessary, use the handles when moving this fireplace.
21. Use this fireplace only as described in this manual. Any other uses not recommended by the manufacture may cause fire, electric shock, or personal injury and may void warranty privileges.
22. Always plug fireplaces directly into a wall outlet. Never use an extension cord, power strip, surge protector, multiple outlet adapter, cord reel or outlet-type air freshener. The use of such devices creates a fire hazard.

23. Faulty wall outlet connections may cause the wall outlet to overheat. Be sure that the fireplace plug properly fits into the outlet before each use. During use, make sure the fireplace plug does not overheat. If necessary, have a qualified electrician check and / or replace the wall outlet.
24. Do not place the fireplace near a bed for objects such as pillows or blankets can fall off the bed and be ignited by the fireplace.
25. Never clean this fireplace while it is plugged in. To disconnect, turn control to OFF, then remove the plug from the outlet. Never pull the cord. Always hold the plug firmly and then remove from the outlet.
26. This fireplace is intended for supplemental heat and / or decorative purposes. Continuous use for several hours can impact the performance and life of the fireplace.
27. It is not intended to be used in commercial, industrial or agricultural settings.
28. Do not use outdoors.

Getting Started

- Remove the fireplace from the box.
- Remove the packaging. Place it inside the box or safely dispose elsewhere.

Package Contents

- Electric Fireplace
- Wall Mount Bracket
- Screws and Screw Anchors
- Pebble Pack
- Remote Control
- Instruction Manual

Features

- Vertical style wall mount electric fireplace
- Dual heat settings (750Watts / 1500Watts)
- Realistic LED flames with adjustable flame brightness
- Flames operate with & without heat
- Black, heat resistant, tempered flat glass panel
- 1500 Watts
- Built-in overheating protection, auto safety shut-off

Quick Reference Guide

- Prior to installation, please ensure that the voltage and capacity of your power outlet is compatible with your fireplace.
- Your fireplace may emit a slight, harmless odor during its first use. This odor is a normal reaction caused by the initial heating of internal fireplace parts and it will not occur again.
- It is normal for fireplace to make a rattling sound for a short duration of time during its first use.
- If your fireplace does not emit heat, please ensure the fireplace switch is on. For further information, please refer to the Troubleshooting section of this manual.

| Sr. No | Item Description | Quantity |
|--------|--------------------|----------|
| 001 | Power Cord | 1 |
| 002 | Remote Control | 1 |
| 003 | Screw Anchors | 7 |
| 004 | Support Bracket | 1 |
| 005 | Polyfoam (Left) | 1 |
| 006 | Screws | 7 |
| 007 | Screws | 2 |
| 008 | Electric Fireplace | 1 |
| 009 | Polyfoam (Right) | 1 |
| 010 | Wall Bracket | 1 |
| 011 | Carton | 1 |
| | | |
| | | |

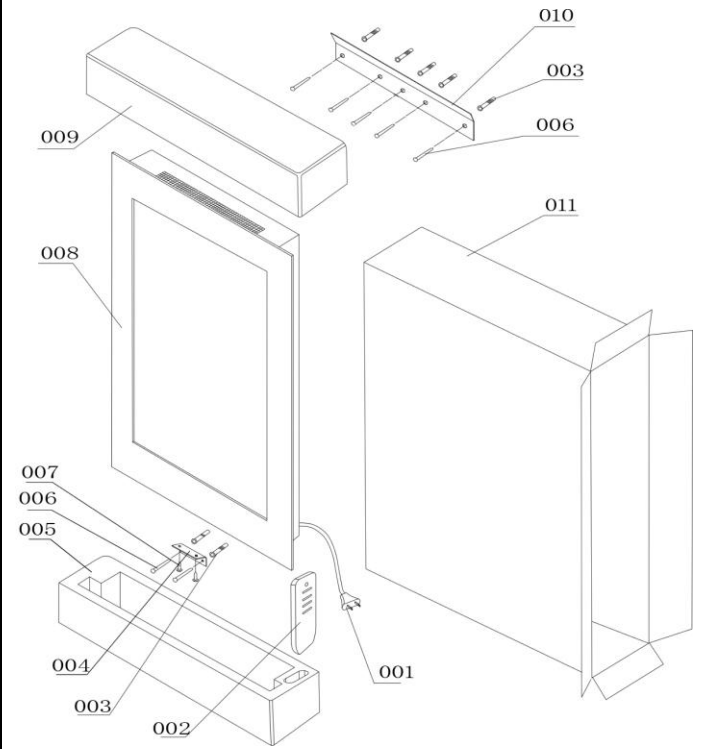

Helpful Advice Before Installation

- Please retain all packaging until all the parts and other package contents are accounted for.
- The fixing pack contains small items which should be kept away from young children.
- We suggest that you move all the smaller parts into a container to reduce the risk of losing them.

Installation

- Do not connect the fireplace to the power supply until properly fixed to the wall and the instructions are carefully read.
- The minimum distances must be observed as shown in the diagrams below.
- Always ensure the area to be drilled is free from hidden electrical wires, water and gas pipes.
- For installation of the fireplace, care must be taken not to damage concealed cables.
- Please be careful while drilling holes.
- This fireplace is designed to be permanently fixed to a wall. Ensure the wall is sufficiently strong enough to hold the weight of the fireplace. Brick or breeze block walls are ideal. If positioning on plasterboard wall, it must be fixed to studs. If you are not sure if the wall is stable enough, then consult a hardware expert. The wall bracket must be fixed horizontally and the cable routed to the bottom right of the fireplace.
- A height of 2 feet from bottom of fireplace to floor is recommended for optimum viewing of flame effect (see below figure for recommended fixed dimensions).

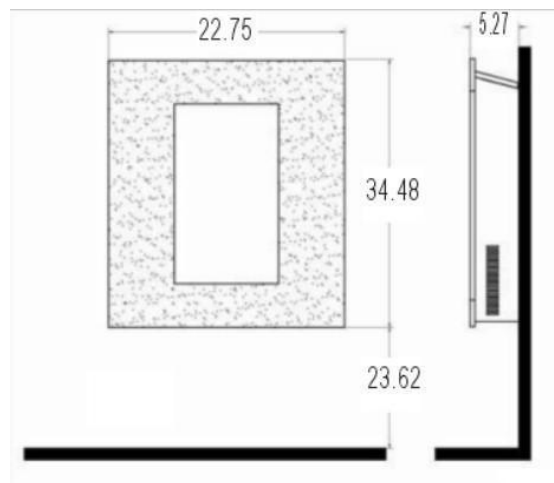

- Keep top of fireplace at least 3 feet away from ceiling or other objects for optimum heat ventilation.
- For optimum viewing, mark the top four screws fixing positions on wall in accordance with the recommend fixing dimensions. (See figure on the next page. Drill holes with a six drill bit.)

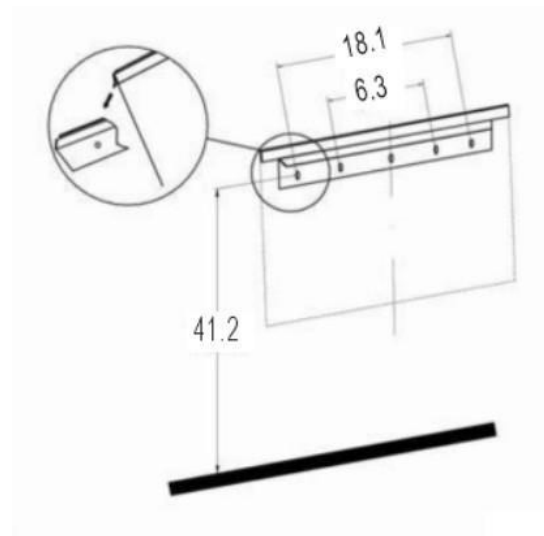

- Fix the wall bracket using the anchors and screws provided.
- Remove the front frame from the fireplace and place it away safely so that it does not become damaged.
- Carefully lift up the fireplace onto the top rear ledge of the fireplace. (See below figure.)

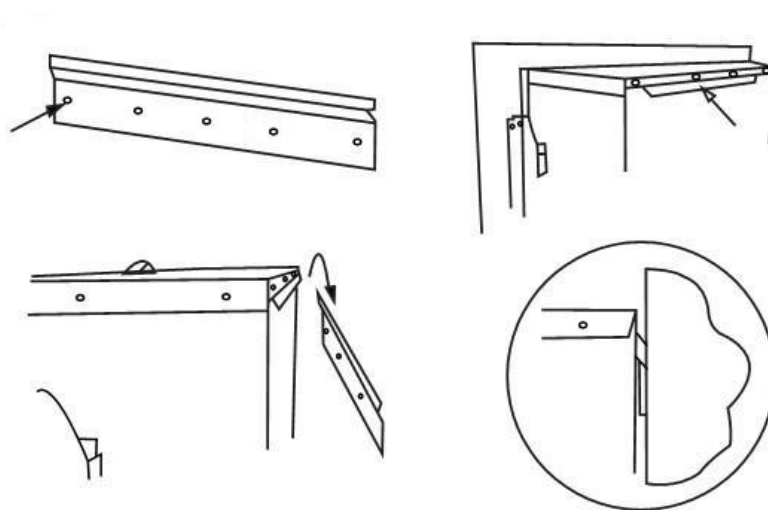

- Once the ledge latches onto the wall bracket and is evenly balanced, gently bring the fireplace down against the wall.
- Mark the bottom holes position (see figure on the next page), remove the fireplace ensuring that the bottom fixing bracket is rotated up.

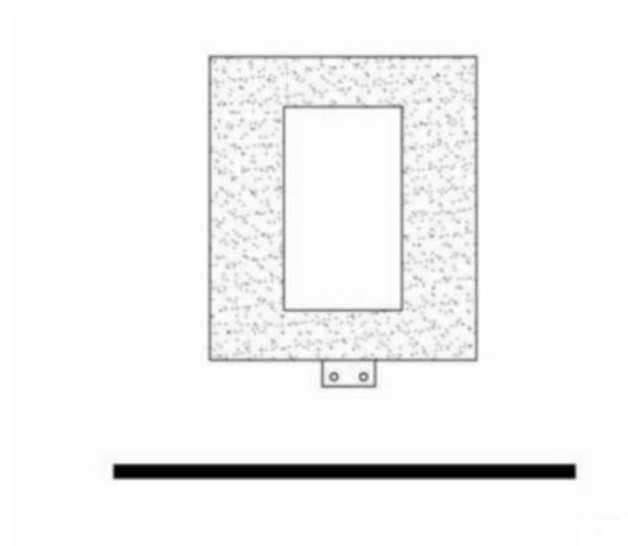

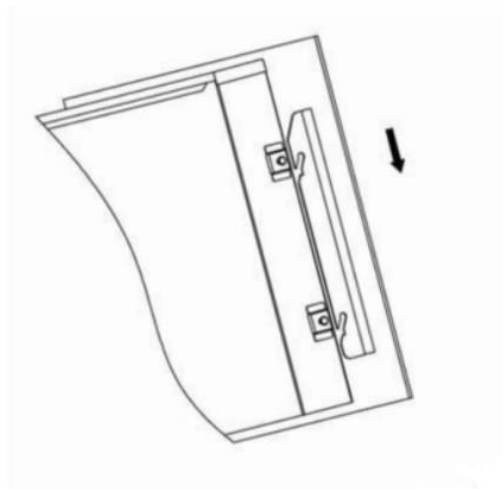

- Drill and fit the screw anchors.
- Refit the fireplace to the wall fixing bracket and rotate the bottom fixing bracket down again and use the screw provided to permanently fix the fireplace in place.
- Place the front frame over the front of the fireplace aligning the slots in the bracket at each side of the glass panel with the lugs on the sides of the fire (see figure below). Again, two people will be required for this operation.





Instructions for Use

This fireplace can be operated either by the switches located on the top right hand side of the fireplace or by supplied remote control.

Manual Operation

- The switches are located on the top right hand side of the fireplace. The standby switch must first be turned on.
- Press the  button once to turn on the fireplace and flame effect. A red indicator light will appear to indicate that the function is ON.
- Press the  button for 3 seconds to operate the automatic color change function. The flame colors will change every 10 seconds.
- Press the 750W button once for low heat setting; press twice to turn off the heat.
- Press the 1500W button once for high heat setting; press twice to turn off the heat.

Remote Control Operation

- The power switch  located at the right hand side of the fireplace must first be switched on; the fireplace will beep to indicate that it is powered up.
- Insert 2 x 1.5V AAA batteries (not included) into the battery compartment of the remote control. Make sure they are inserted with the correct polarity. (The -/+ signs placed in the proper position.) Securely close the battery compartment cover.
- It takes some time for the receiver to respond to the transmitter. Do not press any buttons on the remote control more than once within two seconds in order for the fireplace to operate properly.
- Press the standby button  on the remote control once to turn on the fireplace with flame effect.
- Press the “750W” button once for low heat setting. Press the button again to switch off the heat.
- Press the “1500W” button once for high heat setting. Press the button again to switch off the heat.
- Press the “DIMMER” button to operate the dimmer.

Auto Safety Shut-Off Mechanism

- This fireplace is equipped with a safety shut-off feature which initiates if the fireplace overheats (e.g. Due to blocked air vents). For safety reasons, the fireplace will NOT automatically reset, and will need to be manually turned ON.
- To restart the fireplace, unplug the fireplace from the power outlet for at least 15 minutes. Next, reconnect to the power outlet and turn on the fireplace.

Troubleshooting

| Problem | Possible Solution |
|------------------------------------|---|
| Unit does not work / does not heat | <ul style="list-style-type: none">• Check if the unit is plugged in the power outlet.• Check if the unit is in Standby mode. If so, turn the unit ON.• Check if the heat is turned OFF.• Check for safety cut-off operation. |
| No flame effect | <ul style="list-style-type: none">• Check if the unit is plugged in the power outlet.• Check if the unit is in Standby mode. Turn the unit ON. |

Cleaning & Maintenance

- Disconnect from the power supply before attempting any maintenance or cleaning in order to reduce the risk of fire, electric shock to persons or damage to property.
- **Warning** - Always disconnect from the power supply before cleaning fireplace.
- For general cleaning, use a soft, clean duster. Never use abrasive cleaners. The glass viewing screen should be cleaned thoroughly with a soft cloth. Do **NOT** use proprietary glass cleaners.
- Periodically check all fixings and tighten if necessary.
- The LED bulbs inside can NOT be replaced.

Technical Specification

- Supply: 120V~ 60Hz
- Rated Power: 1500W
- Bulb: LED (cannot be replaced)