



Dual Citrus Juicer

welcome booklet

Please visit Storebound.com
Toll Free 1-800-898-6970



Dual Citrus Juicer

welcome booklet

Table of contents	pg 1-2
Safety information	pg 3
Items supplied	pg 4
Assembly	pg 5-6
Taste the difference	pg 7-8
How to	pg 9-10
Cleaning	pg 11-12
Troubleshooting	pg 13-14
Recipes	pg 15-16
Warranty information	pg 17-18



Safety Information

Thoroughly read and save this user manual prior to initial use.

For product support, warranty and maintenance related questions (other than cleaning) please contact StoreBound directly at: 1-800-898-6970 from 7AM - 7PM PST Monday – Friday, or by email at info@storebound.com.

This appliance is intended for household use only; please use only as instructed.

The Dual Citrus Juicer is exclusively designed to extract juice from citrus fruits. The device is designed for use in private households. The device must only be used indoors.

This device must not be used for commercial purposes.

How to Use

Remove all packing material.

Check to ensure that all parts are present and undamaged.

Clean the device prior to its first use (see the “Cleaning” section).

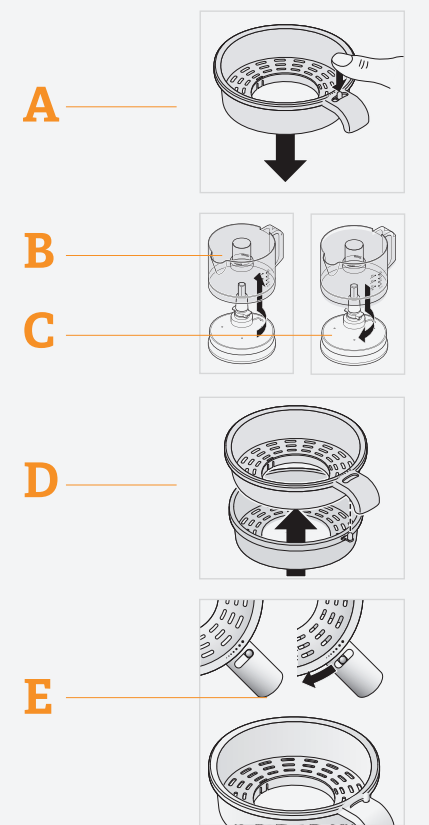
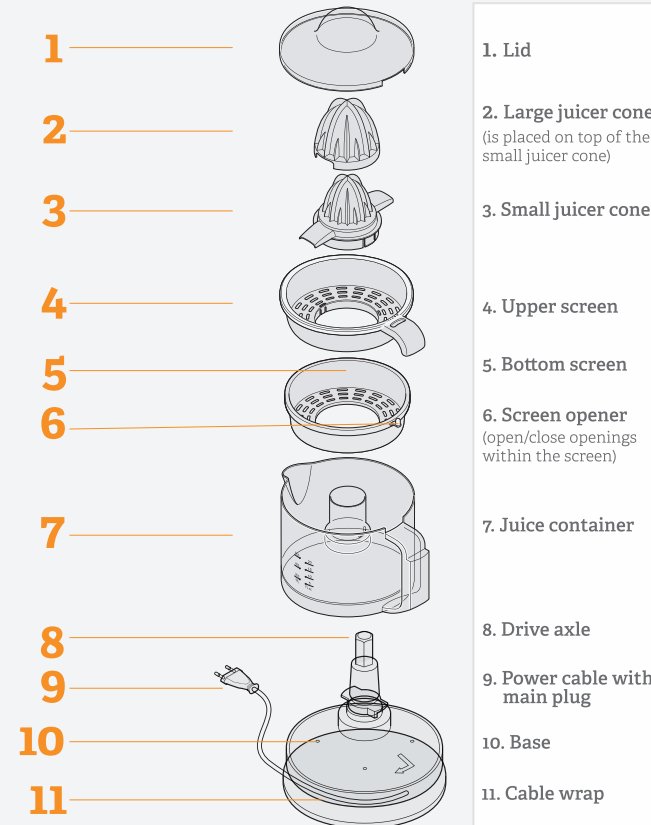



Assembling the Dual Citrus Juicer

CAUTION: The cord length is designed to reduce the hazards associated with tangling with external objects and/or tripping over a longer cord. If an extension cord is necessary, the electrical rating of the extension cord must be equal to or greater than the rating of the Dual Citrus Juicer. Please exercise extreme caution when using an extension cord – in order to avoid personal injury and/or product damage due to tripping, tangling or pulling by children.

1. Uncoil the power cable (9) from the cable wrap (11) to the desired length.
2. Place the base (10) on a dry, solid and level surface.
3. **Figure C:** place the juice container (7) on the base (10) with the handle above the arrow and turn it clockwise until it locks into place.
4. **Figure D:** place the upper screen (4) on the bottom screen (5) so that the screen opener (6) sticks through the opening, and the screens lock into place.

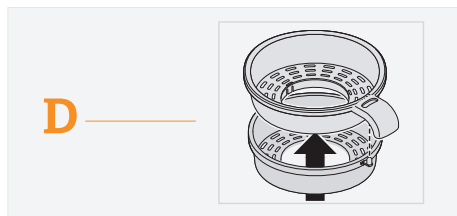
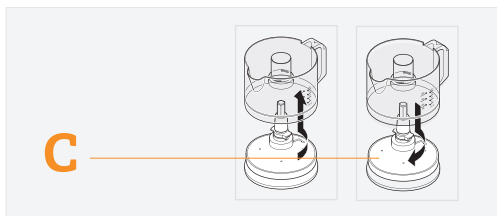

5. Place the assembled screen (4/5) on the juice container (7) so that the handles fit perfectly one on top of the other.
6. Place the small juicer cone (3) on the drive axle (8). In the process, the small juicer cone (3) must lock into the screen (4/5). For large citrus fruits (e. g. oranges, grapefruit) place the large juicer cone (2) on the small juicer cone (3) so that the wings of the small juicer cone (3) fit into the recesses of the large juicer cone (2).
7. Insert the main plug (9) into a wall socket corresponding to the technical data.

Storage

You can easily wind-up the power cable (9) in the cable wrap (11).

Place the lid (1) on the device as a protection against dust. Ensure that the recess in the edge of the lid is above the handle.

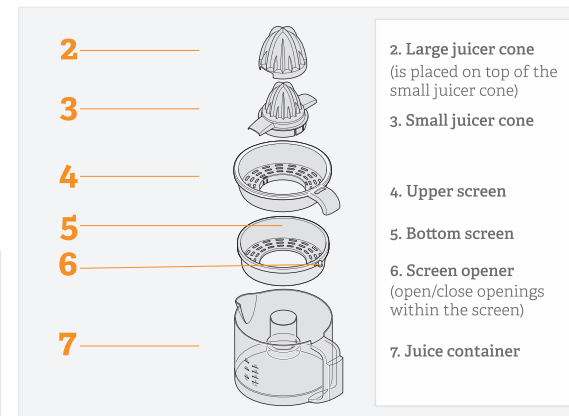
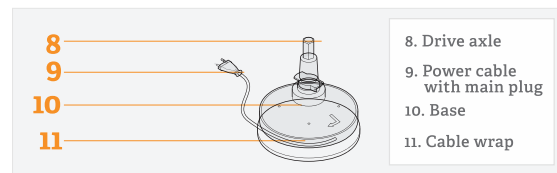



health fact!

Did you know most juices you get at the grocery store contain ingredients you can't even pronounce? Juice at home, and get all the nutrients **without** all the junk.

WHY FRESH SQUEEZED CITRUS?



The proof is in the color. While they might not look *that* different, the Dual Citrus Juicer is the winner.

Take a closer look at the ingredients your drinking.
You might be surprised.

DUAL CITRUS JUICER

INGREDIENTS

100% PURE ORANGE JUICE



STORE BOUGHT ORANGE JUICE

INGREDIENTS

WATER, HIGH FRUCTOSE CORN SYRUP AND 2%
OR LESS OF EACH OF THE FOLLOWING: CONCENTRATED
JUICES (ORANGE, TANGERINE, APPLE, LIME, GRAPEFRUIT),
CITRIC ACID, ASCORBIC ACID (VITAMIN C), THIAMIN
HYDROCHLORIDE (VITAMIN B1), NATURAL FLAVORS,
MODIFIED CORNSTARCH, CANOLA OIL. SODIUM
CITRATE, CELLULOSE GUM, XANTHAN GUM, SODIUM
HESAMETAPHOSPHATE, SODIUM BENZOATE TO PROTECT
FLAVOR, YELLOW #5, YELLOW #6.





How to

Important tips, before you juice

Always use fresh, firm fruit.

Always wash fruits before juicing.

Ensure that no foreign body is on the screen **(4/5)** or in the device when operating it.

Do not put excessive pressure on the juicer cone **(2/3)**.

Empty the juice container **(7)** when juice reaches the 600 ml mark. Do not exceed the 600 ml mark.

In order to achieve the largest juice yield possible, the juicer cone changes the direction of rotation after several starts and stops.

Setting the pulp content

Figure E: Using the screen opener **(6)**, you can influence the amount of pulp content in your juice.

High pulp content: Set the screen opener **(6)** to the large dot mark so that the openings in the screen **(4/5)** are open wide.

Low pulp content: Set the screen opener **(6)** to the small dot mark so that the openings in the screen **(4/5)** are closed.

Preparing citrus fruits and juicing

1. Cut the citrus fruits in half.
2. Exert slight pressure on the halves of the citrus fruit when pushing the cut surface down onto the juicer cone **(2/3)**. The juicer cone **(2/3)** starts turning, and the juice flows into the juice container **(7)**.
3. As soon as you stop pressing on the juicer cone **(2/3)**, the device stops.
4. If the juicer cone **(2/3)** is not turning, check if there are fruit pips/seeds between the juicer cone and the screen **(4/5)** and remove them.

Removing the Juice

CAUTION: Pull out the main plug **(9)** before removing the juice container **(7)** from the base **(10)**.

1. **Figure B:** Turn the juice container **(7)** counterclockwise and lift it from the base **(10)**.
2. Pour the juice out of the juice container **(7)**.
3. In order to remove pulp and pips/seeds, you can remove the screens **(4/5)** and the juicer cone **(2/3)** together with the juice container **(7)**.
4. Clean the device after each use as soon as possible so the pulp does not dry and stick to the surface.



DASH

go™



health fact!

In approximately one glass of fresh squeezed orange juice you're getting **vitamins A, C, E, K and B6** – along with **calcium, iron, potassium and protein**.

Cleaning

Clean the device prior to its first use!

Pull out the main plug **(9)** from the wall socket before cleaning the citrus juicer.

The base **(10)**, the power cable and the main plug **(9)** must **never** be immersed in water or any other liquids.

Do not clean the Dual Citrus Juicer or any of its accessories with boiling hot water.

Do not use any astringent or abrasive cleaning agents.

NOTE: Clean the device after each use as soon as possible so the pulp does not dry and stick to the surface.

1. Remove the lid **(1)**, if necessary.
2. Remove the juicer cones **(2/3)** and disassemble them.
3. Remove the screens **(4/5)**.
4. **Figure A:** in order to disassemble the screens **(4/5)**, exert slight pressure on the screen opener **(6)**.
5. **Figure B:** turn the juice container **(7)** counterclockwise and lift it from the base **(10)**.
6. Wipe the base **(10)** with a damp cloth.
7. Wash all removable accessories by hand. Make sure to wash the small cavity in the handle with a sufficient amount of hot **(not boiling)** water.
8. Dry all parts carefully, before reassembling the device and storing it.

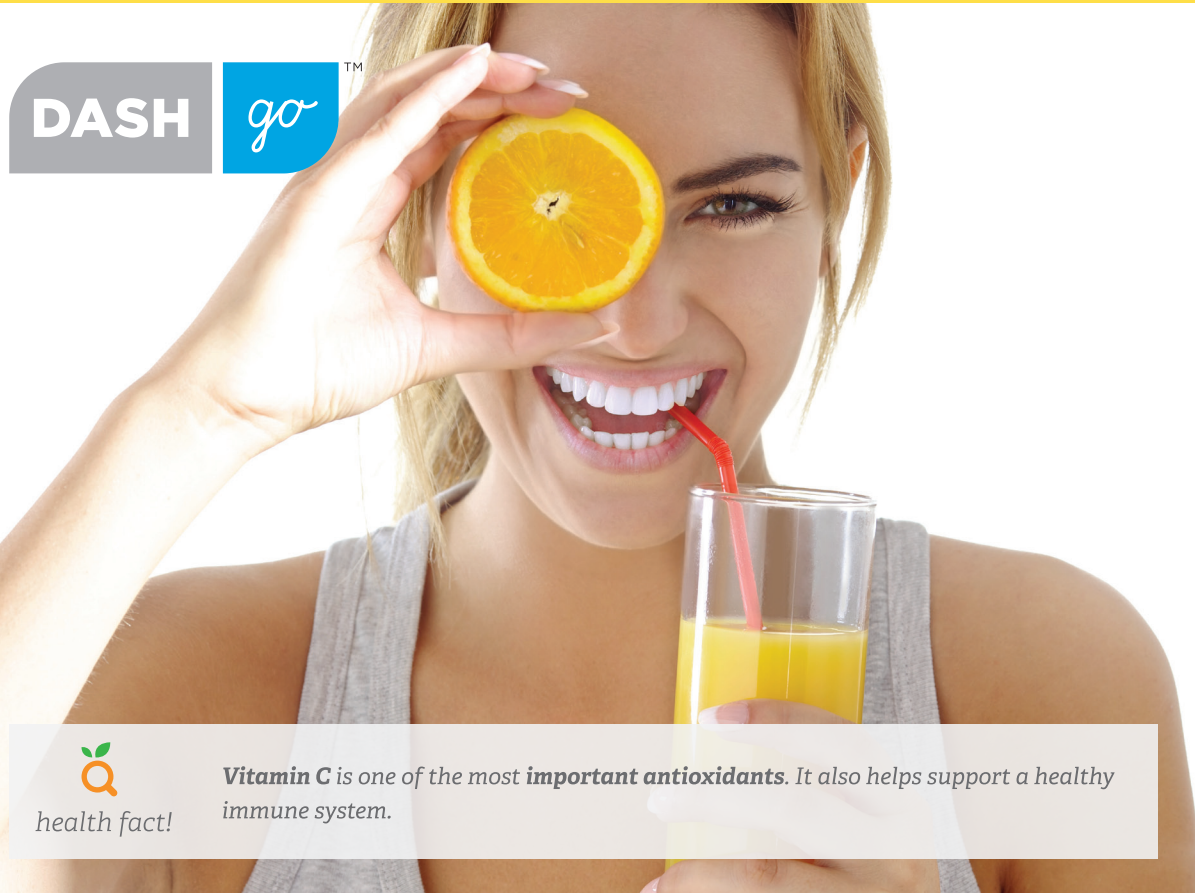

DASH



health fact!

Vitamin C is one of the most **important antioxidants**. It also helps support a healthy immune system.

Troubleshooting

If your device fails to function as required, please try this checklist first. Perhaps there is only a minor problem, and you can solve it yourself.

DANGER! Risk of electric shock! Do not attempt to repair the device yourself under any circumstances.

Problem/Solutions:

The juicer does not function

Is the device connected to the main power supply?

The juicer cone (2/3) stops turning

Have you exerted excessive pressure on the juicer cone (2/3)?

Is a foreign body located in the device?

Have fruit seeds/pips been caught between the juicer cones (2/3) and the screen (4/5)?

Customer Support Hotline

For product support, warranty and maintenance related questions (other than cleaning,) please contact StoreBound directly at: 1-800-898-6970 from 7AM - 7PM PST Monday – Friday, or by email at info@storebound.com.

Technical Specifications

Model: JB065 Series **Mains voltage:** 120 V ~ 60 Hz **Protection class:** II **Power rating:** 25 W
Subject to technical modification.



BLOOD ORANGE JUICE

Ingredients

2 Blood Oranges
4 Oranges

ORANGE GRAPEFRUIT JUICE

Ingredients

3 Grapefruits
5 Oranges

RASPBERRY TEA LEMONADE

Ingredients

1 Cup Raspberry Tea
3 Lemons
Add filtered water to taste

DIRECTIONS

Cut your citrus in half. Place each half on the juicer cone. You'll have fresh squeezed juice in no time!



Chef Tips!

To make your drink more refreshing add a couple mint sprigs or add some club soda to your freshen up your juice!



The StoreBound Promise



STOREBOUND, LLC - 1 YEAR LIMITED WARRANTY

Your Storebound product is warranted to be free from defects in material and workmanship for a period of one (1) year from the date of the original purchase when utilized for normal and intended household use. Should any defect covered by the terms of the limited warranty be discovered within one (1) year, StoreBound LLC will repair or replace or replace the defective part. To process a warranty claim, contact customer care agent at **1-800-898-6970** for further assistance and instruction. A customer care agent will conduct troubleshooting in an attempt to fix any minor problems. If troubleshooting fails to fix the problem, a return authorization will be issued. Proof of purchase indicating date and place of purchase is required and should accompany the return. You must also include your full name, shipping address, and telephone number. We are unable to ship returns to a PO Box. Storebound will be responsible for delays or unprocessed claims resulting from a purchaser's failure to provide any or all of the necessary information. Freight costs must be prepaid by the purchaser.

Send all inquiries to: info@storebound.com

There are no express warranties except as listed above

Repair or replacement as provided under this warranty is the exclusive remedy of the customer. Storebound shall not be liable for any incidental or consequential damages for breach of any express or implied warranty on this product except to the extent prohibited by applicable law. Any implied warranty of merchantability or fitness for a particular purpose on this product is limited in duration to the duration of this warranty.

Some states do not allow the exclusion or limitation of incidental or consequential damages, or limitations on how long an implied warranty lasts, so the above exclusions or limitations may not apply to you. This warranty gives you specific legal rights and you may also have other rights, which vary from state to state.

Evan Dash, CEO

