



CITRUS JUICER

instruction manual & recipe guide

DASH



™

bydash.com





CITRUS JUICER

Safety Guidelines	4-5
What's Inside	6
Using Your Citrus Juicer	7-9
Taste the Difference	10-11
Cleaning Your Citrus Juicer	12-13
Recipes	14-15
Customer Support	16
Warranty	17

IMPORTANT SAFETY GUIDELINES

Thoroughly read this user manual prior to initial use and save it to refer back to. For product support, warranty and maintenance related questions (other than cleaning) please contact StoreBound directly at: 1-800-898-6970 from 7AM - 7PM PST Monday - Friday, or by email at info@storebound.com

When using electrical appliances, basic safety precautions should always be followed, especially the following:

1. To guard against risk of electric shock, always remove the plug from the outlet rather than pulling on the cord. Do not use appliance in or near water or other liquid.
2. This appliance is not intended for use by persons (including children) with reduced physical, sensory or mental capabilities, or lack of experience and knowledge unless they have been given supervision or instruction concerning use of the appliance by a person responsible for their safety. Children should be supervised at all times to ensure that they do not play with the appliance.
3. Do not let the cord hang over the edge of a table, hang over the edge of a counter or use appliance in, near, or on hot surfaces.
4. The use of accessory attachments not recommended by Dash (a StoreBound Company) may cause injuries.
5. Unplug from outlet when not in use, during assembly, during disassembly and before cleaning.

6. Do not operate this appliance with a damaged cord, damaged plug after the appliance malfunctions, is dropped or damaged in any other manner.
7. Only use citrus fruit with this product, any other food may damage the product.
8. Avoid contact with moving parts.
9. Use only attachments recommended or sold by the manufacturer. Others may result in fire, electric shock or injury.
10. Do not use outdoors.
11. Do not leave Juicer unattended while the appliance is on.
12. Clean the Citrus Juicer before placing or removing the pressing cones.
13. Applying too much pressure to the Reamer while juicing may cause the motor to seize.
14. Place the Juicer on a level surface that will not be harmed by splashes of juice as splashing cannot always be avoided. The surface should be easy to clean.
15. Your Citrus Juicer is equipped with suction feet. The suction feet will adhere to any smooth surface. For them to adhere well, the surface must be flat and also free of dust or grease. The suction feet cannot adhere to a textured surface. Slightly moisten the suction feet before you press them onto the surface.
16. Do not affix the suction feet to fragile surfaces. Some paints or synthetic coating may react adversely with the material of the suction feet causing them to soften and leave marks.

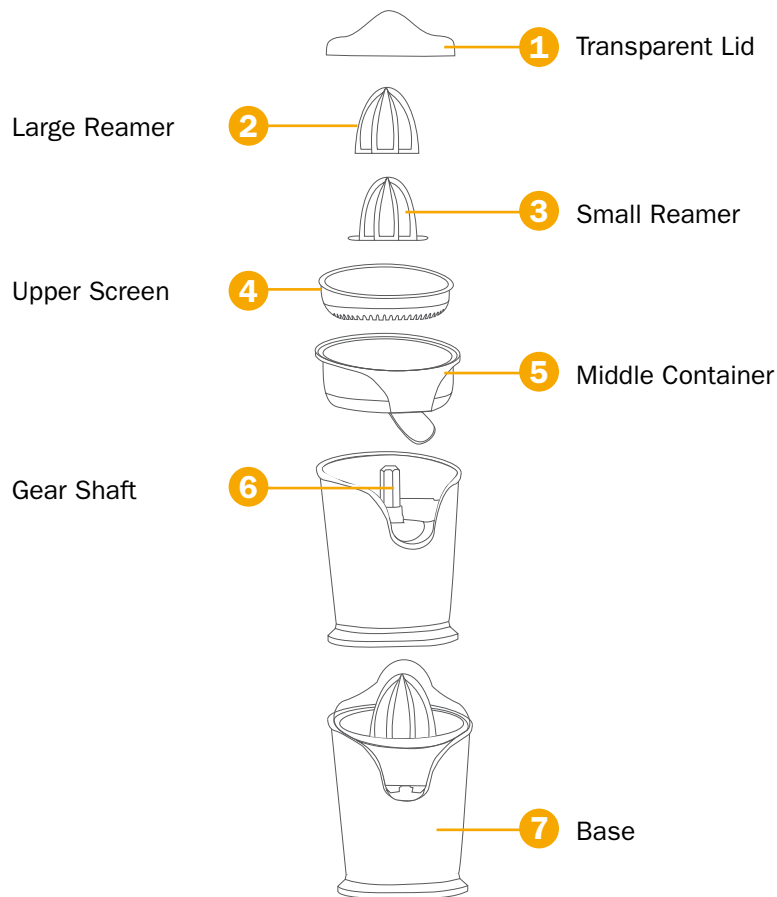

SETTING UP YOUR CITRUS JUICER

WARNING: Do not use the appliance near water, other liquids, with wet hands or while standing on a wet surface.

1. Set the Base on a clean, stable dry surface.
2. IMPORTANT: DO not connect the appliance to a power outlet before starting.
3. Place the Middle Container onto the Base. The Gear Shaft should come through the center of the Middle Container.
4. Place the Upper Screen above the Middle Container.
5. Place the Reamer on the Gear Shaft above the Upper Screen.
6. Lastly, place the Transparent Lid on top.
7. Unwind the power cord to the length you require and make sure the cord is intact before plugging in your Juicer.



BEFORE FIRST USE

IMPORTANT: You should clean the appliance thoroughly before using it for the first time. Always use fresh, firm fruit when juicing.

1. Unpack the Citrus Juicer and remove all of the packaging. Keep the packaging material away from children to avoid suffocation.
2. Examine the Citrus Juicer for visible damage and check that all of the parts are present.
3. Wipe the Base with a damp cloth.
4. Before using the Citrus Juicer for the first time, rinse the Reamer, Upper Screen, and Middle Container from the appliance and clean them.

AFTER USE

1. Remove Reamer, Upper Screen, Middle Container from the appliance and clean them.
2. Unplug the appliance and store.
3. Make sure the motor stops completely before disassembling.
4. Never use abrasive or chemical cleaning products on the unit, as these may cause damage to the surfaces.



health fact!

Vitamin C is one of the most important antioxidants. It also helps support a healthy immune system.

JUICING

CAUTION: If you apply too much pressure to the Reamer, the motor may seize. Juice gently.

- If you wish to collect the juice in the Middle Container, gently press the spout upwards to close it.
- If you want the juice to run straight into a glass, place a glass or jug underneath the spout, then gently press the spout downwards to open it.
- Cut a citrus fruit in half and press the cut end of one fruit-half onto the cone. The Juicer switches on automatically when you press the fruit down and the cone starts to turn. The Juicer automatically switches off as soon as you reduce pressure on the Reamer.
- The Reamer scrapes the pulp out and squeezes the juice from the fruit. The juice flows through the Upper Screen into the Middle Container where it can run into a glass (the spout must be open). The Upper Screen keeps back thick pulp and seeds.
- To maximize the quantity of juice extracted from a fruit, press each half onto the cone several times.



health fact!

Did you know most juices you get at the grocery store contain ingredients you can't even pronounce? Juice at home, and get all the nutrients without all the junk.

WHY FRESH SQUEEZED CITRUS?

The proof is in the color. While they might not look that different, the Dash Citrus Juicer is the winner.

Take a closer look at the ingredients you're drinking.
You might be surprised.

DASH CITRUS JUICER

INGREDIENTS

100% PURE ORANGE JUICE



STORE BOUGHT ORANGE JUICE

INGREDIENTS

WATER, HIGH FRUCTOSE CORN SYRUP AND 2% OR LESS OF EACH OF THE FOLLOWING: CONCENTRATED JUICES (ORANGE, TANGERINE, APPLE, LIME, GRAPEFRUIT), CITRIC ACID, ASCORBIC ACID (VITAMIN C), THIAMINE HYDROCHLORIDE (VITAMIN B1), NATURAL FLAVORS, MODIFIED CORN STARCH, CANOLA OIL, SODIUM CITRATE, CELLULOSE GUM, XANTHAM GUM, SODIUM HESAMETAPHOSPHATE, SODIUM BENSOATE TO PROTECT FLAVOR, YELLOW #5, YELLOW#6





health fact!

In approximately one glass of fresh squeezed orange juice you're getting vitamins A, C, E, K and B6 - along with calcium, iron, potassium and protein.

MAINTENANCE

Make sure to clean the appliance carefully prior to first use.

- DANGER: Unplug the Citrus Juicer before you clean it.
- The Base must not be immersed in water or other liquids, or held under running water as that this could give you an electric shock.
- The Reamer, Upper Screen, and Middle Container can go in the dishwasher.
- Wipe the Base with a damp cloth.
- If you use the spout on the Middle Container frequently, pulp may build up in the spout. Therefore, it's best to clean the spout after each use.



A top-down view of a light-colored ceramic bowl filled with citrus fruits. Inside the bowl, there are two bright orange oranges and one green lime. A large, vibrant yellow lemon is positioned in the foreground, partially overlapping the bowl. Several green citrus leaves are scattered around the bowl and on the wooden surface. The background is a rustic, greyish-brown wooden plank surface. A semi-transparent orange rectangular box is overlaid on the center of the image, containing the text 'RECIPES' in large white letters and 'HEALTHY & TASTY JUICES' in smaller white letters below it.

RECIPES

HEALTHY & TASTY JUICES

BLOOD ORANGE JUICE	ORANGE GRAPEFRUIT JUICE	RASPBERRY TEA LEMONADE
2 blood oranges 4 oranges	3 grapefruits 5 oranges	1 cup raspberry tea 3 lemons add filtered water to taste

DIRECTIONS

Cut your citrus in half. Place each half on the Reamer. You'll have fresh squeezed juice in no time!



To make your drink more refreshing, add a couple mint sprigs or add some club soda to freshen up your juice!

CUSTOMER SUPPORT

If your device fails to function as required, please try this checklist first. There may only be a minor problem, and you can solve it yourself.

Problem/Solutions:

The motor won't start.

Is the main plug connected properly to the socket outside?

The motor stops running while juicing.

Are you pressing on the Reamer too hard?

Although the spout is closed, juice still drips out.

Are there any bits of pulp left in the spout?

DANGER! Risk of electric shock! Do not attempt to repair the device yourself under any circumstances.

Customer Support Hot line

For Product support, warranty and maintenance related questions (other than cleaning) please contact StoreBound directly at: 1

TECHNICAL SPECIFICATIONS

Model Number	JB085SS SERIES
Voltage	120V - 60 Hz
Power Rating	85 Watts

Subject to technical modifications.

WARRANTY

STOREBOUND, LLC – 1 YEAR LIMITED WARRANTY

Your StoreBound product is warranted to be free from defects in material and workmanship for a period of one (1) year from the date of the original purchase when utilized for normal and intended household use. Should any defect covered by the terms of the limited warranty be discovered within one (1) year, StoreBound will repair or replace the defective part. To process a warranty claim, contact Customer Care at 1-800-898-6970 for further assistance and instruction. A customer care agent will conduct troubleshooting in an attempt to fix any minor problems. If troubleshooting fails to fix the problem, a return authorization will be issued. Proof of purchase indicating date and place of purchase is required and should accompany the return. You must also include your full name, shipping address, and telephone number. We are unable to ship returns to a PO Box. StoreBound will not be responsible for delays or unprocessed claims resulting from a purchaser's failure to provide any or all of the necessary information. Freight costs must be prepaid by the purchaser.

Send All Inquires To: info@storebound.com

There are no express warranties except as listed above.

REPAIR OR REPLACEMENT AS PROVIDED UNDER THIS WARRANTY IS THE EXCLUSIVE REMEDY OF THE CUSTOMER. STOREBOUND SHALL NOT BE LIABLE FOR ANY INCIDENTAL OR CONSEQUENTIAL DAMAGES FOR BREACH OF ANY EXPRESS OR IMPLIED WARRANTY ON THIS PRODUCT EXCEPT TO THE EXTENT PROHIBITED BY APPLICABLE LAW. ANY IMPLIED WARRANTY OF MERCHANTABILITY OR FITNESS FOR A PARTICULAR PURPOSE ON THIS PRODUCT IS LIMITED IN DURATION TO THE DURATION OF THIS WARRANTY. *Some states do not allow the exclusion or limitation of incidental or consequential damages, or limitations on how long an implied warranty lasts, so the above exclusions or limitations may not apply to you. This warranty gives you specific legal rights and you may also have other rights, which vary from state to state.*



STOREBOUND™

STOREBOUND MAKES PRODUCTS
THAT MAKE PEOPLE'S LIVES HAPPIER,
HEALTHIER, AND EASIER.

IF YOU'VE GOT A GREAT IDEA FOR A
PRODUCT, WE WANT TO HEAR ABOUT IT.
GO TO OUR WEBSITE AT STOREBOUND.COM

© 2013 by StoreBound
StoreBound LLC, New York, 10038

visit bydash.com

Patent Pending