

DURACELL® Generators

Product Manual



Owner's Manual

Instructions for Assembly, Testing, Operation, Servicing, and Storage.

Portable Gas Generator:
For Outdoor Use Only!



DG65M-R62

5000 Watt Rated
6000 Watt Surge

**Owner's Manual for
DG65M-R62 Series
Portable Generator**

Welcome



Thank you for your purchase of this quality Duracell product. We wish you years of success using your new portable generator. This machine is designed to supply electrical power and must be operated outdoors only.

This manual contains general warnings about the risks of operating a portable generator and specific warnings about the operation and maintenance of this particular portable generator. In addition, it outlines important maintenance and storage procedures.

Please read it carefully before operating, maintaining, repairing, and storing your new portable generator. Keep this owner's manual handy so you can refer to it at any time. This owner's manual and included engine owner's manual are considered a permanent part of the portable generator and should remain with the generator if resold.

The information and specifications included in this publication were in effect at the time of approval for printing. IES reserves the right, however, to discontinue or change specifications or design at any time without notice and without incurring any obligation whatsoever. No part of this publication may be reproduced without written permission.

Thank you for your business.

	WARNING:	
<p>READ and UNDERSTAND the <u>Owner's Manual</u> completely before using this portable generator.</p> <p>Assemble, test and use only in accordance with the Owner's Manual instructions.</p> <p>WEAR personal protective gear when filling, using, cleaning, and servicing the portable generator.</p> <p>DO NOT START the generator until you have read, understood, and followed the instructions in this manual.</p> <p>Improper use of the portable generator could result in serious injury or illness to the operator or nearby persons/animals, and cause property damage.</p>		

Customer Service

Consult an Authorized Service Dealer regarding maintenance or repair procedures.

Please contact us with service-related questions regarding operating and assembling your new generator, including parts you may be missing.

1-888-980-4938

TechSupport@DuracellGenerators.com

www.DuracellGenerators.com

Retain for your records

Record your generator's model number and serial number as well as the date you purchased the generator below. This information can be found on the box and the product information label on the generator, see sample below.

Retain this information for your records. You'll need to refer to this information when ordering parts and contacting customer service about maintaining your generator and its warranty.

Model number:

Serial number:

Date purchased:

_____ Month _____ Day _____ Year

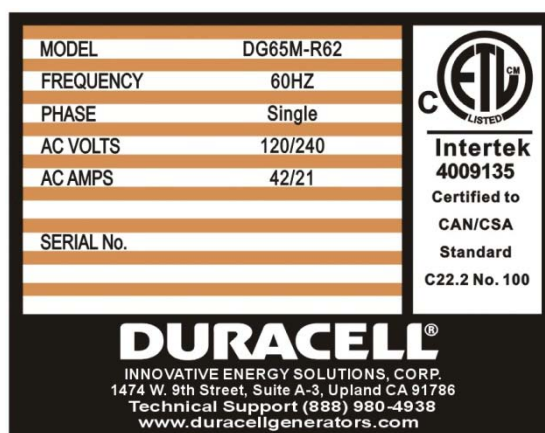

Sample information label for DG65M-R62

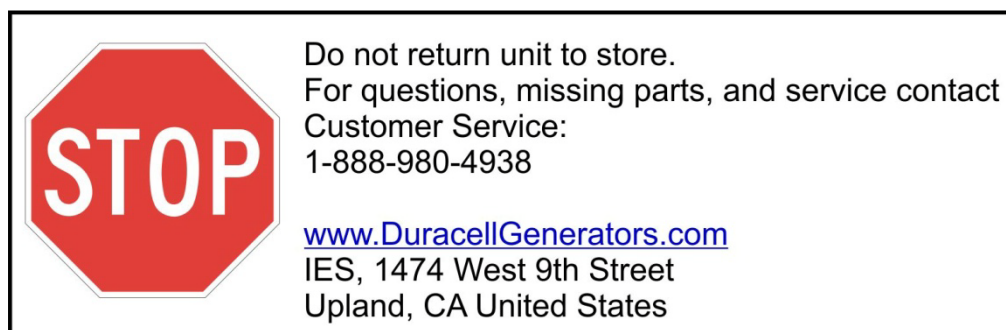

Table of Contents

Welcome	0
Customer Service.....	0
Important safety precautions.....	3
Generator Safety Labels:	4
Safety warnings.....	6
Carbon Monoxide WARNINGS	6
Electrical system WARNINGS	8
Burn and fire WARNINGS.....	8
Reference manual contains critical information	9
Orientation to your generator	9
Major components.....	9
AC receptacles	10
Package contents.....	11
Unpacking and Assembly.....	12
Select Suitable Location.....	17
Pre-operation check and Safety Rules	19
Pre-operational Checks.....	22
Starting the Generator.....	25
Monitoring the fuel level	26
Using caution when refueling the tank	26
Shutting Down the Generator.....	27
Maintenance.....	27
Importance of maintenance.....	27
Maintenance safety precautions	28
Maintenance schedule	29
Engine Maintenance	30
Emission Control System Information.....	31
Storing and transporting your generator	31
Troubleshooting	33
Generator Specifications: DG65M-R62	35
Wiring diagram DG65M-R62.....	36
Parts list DG65M-R62:	37
Contact information for Technical and Customer Assistance	42
Wattage Reference Chart	43
Limited Warranty	44

Important safety precautions

This manual contains critical safety information. Please read the entire manual closely.

Because safety is paramount and using a generator carries significant responsibilities, we have outlined warnings and the general hazards of operating generators. In addition, we have summarized the recommended procedures for operating, repairing, maintaining, and storing your specific generator to keep you and others safe.

Not following instructions or using poor judgment when using and maintaining your generator can cause you or someone else to be **KILLED** or **SERIOUSLY INJURED**.

It would be impossible for us to warn you of each risk and all of the hazards involved in the use of generators. Therefore, it's essential that you use your best judgment and take precautions when using, maintaining, repairing, and storing your generator.

There are many safety warnings in this manual and on the generator itself to guide you:

Generator safety labels: The safety labels on your generator warn of potential danger. It's critical that you read them. If any labels become difficult to read or have been removed, contact your dealer for a replacement label.

Manual safety messages: This manual contains specific instructions and severe warnings about the ramifications of using poor judgment and not following the instructions outlined in this manual. The ramifications range from serious injury and losing consciousness to death.

Manual headings and sections: We've devoted several sections of this manual to outline the risks, hazards, and warnings when using, repairing, maintaining, and storing your generator.

Pay attention to cautions such as, "**Carbon monoxide WARNINGS**" or "**Electric shock WARNINGS**" or "**Burn and fire WARNINGS**."



Read manual before operating unit

Generator Safety Labels:

⚠ DANGER

Using a Generator indoors CAN KILL YOU IN MINUTES!
Generator Exhaust Contains Carbon Monoxide.
This is a Poison You CANNOT See or Smell.



Never use Inside a Home or Garage, EVEN IF doors and Windows are open.



ONLY use Outside and Far Away from Windows, Doors, and Vents.

CARBON

⚠ DANGER

Fire/Explosion Hazard



- 1) Fuel is flammable and explosive. Exhaust is very HOT. Overloading the generator can cause fire.
- 2) Liquid propane and natural gas hookup must be completed by a certified gas technician.
- 3) NEVER fuel a running or hot engine.
- 4) Ensure there are no fuel leaks before starting.
- 5) Keep unit away from sparks and flames.
- 6) Clean any spilled fuel immediately.
- 7) Keep unit 7 feet away from combustible and flammable objects.
- 8) DO NOT overload the generator.
- 9) OPERATE the unit in a ventilated area, allow for adequate air flow.
- 10) Always keep a fire extinguisher nearby.

G20152

⚠ WARNING

Burn Hazard



Do not touch hot muffler.
Muffler may be hot even if the unit is stopped.
Allow unit to cool before servicing.



20137

⚠ WARNING

Operation of this equipment may create sparks that can start fires around dry vegetation. A spark arrestor may be required. The operator should contact local fire agencies for laws and regulations relating to fire prevention requirements.

Per California Public Resources Code 4442.6

⚠ WARNING

Improper connections to a building can allow electrical current to backfeed into the utility lines, creating an electrocution hazard.

Connecting to a building must isolate the generator power from utility power and comply with all applicable laws and electrical codes.

The generator is a potential source of ELECTRICAL SHOCK if not kept dry.

- Do not expose the generator to moisture, rain, or snow.
- Do not touch the generator with wet hands.

GBUILD

⚠ WARNING





1) Risk of Fire and Explosion. Do not add fuel when engine is running or still hot.

2) Breathing Hazard. Poisonous fumes from engine can kill you. Do not operate indoors, even if ventilated.

3) Risk of Electrocution. Keep water away from electrical outlets and electrical devices.

4) Read owner's manual. Serious injury or death can result if safety instructions are not followed.

G201388

Generator Fuel Related Safety and Information Labels:

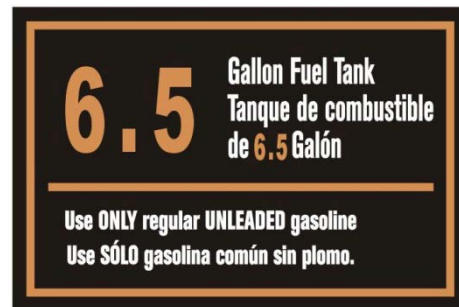

**Fuel Tank Label for:
DG65M-R62**



**Fuel On/Off
Valve Label**

Generator Operating Safety Labels:

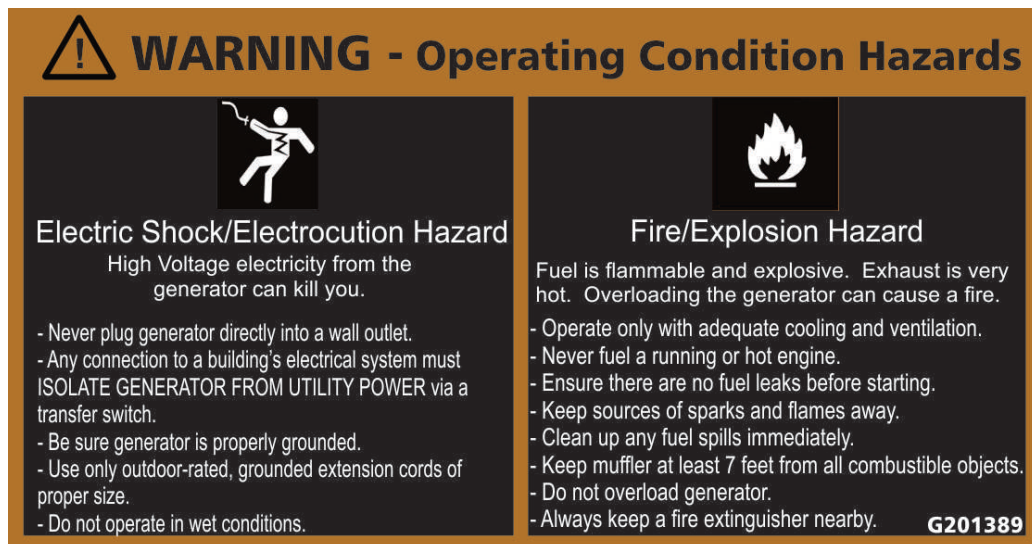

Safety warnings

Carbon Monoxide WARNINGS

The exhaust from your generator contains carbon monoxide.

Breathing this poisonous gas, which is odorless and colorless, can cause unconsciousness and could even kill you.

Only operate your generator outdoors.

Operating a generator carries serious responsibility. There are precautions that you need to take when operating a generator:

- Never operate your generator indoors or near any windows or doors.
- Never operate your generator in an enclosed or a partially enclosed area such as a garage.
- Do not let the exhaust from your generator build up to dangerous levels.
- Do not breathe the poisonous gas in your generator's exhaust.
- Become familiar with your generator. Understand all of your generator's controls, connections, and output receptacles. Know how to quickly stop your generator in case of an emergency.
- If anyone else operates your generator, be sure he/she is properly instructed.
- Do not let children play with or operate your generator.
- Keep your generator at least seven feet away from flammable materials.



WARNING!!

The engine exhaust from this product contains chemicals known to the State of California to cause cancer, birth defects or other reproductive harm.

Electrical shock WARNINGS



Your generator produces significant electrical power.

It could cause electric shock or even electrocution if not used properly.

- Keep your generator dry.
- Do not operate your generator when your hands are wet.
- Do not operate your generator in wet conditions such as rain, snow or fog. Do not use it near a pool or sprinkler.
- Store your generator in a dry place. If your generator is stored outdoors and is not protected from the weather, check the electrical components on the Control Panel before each use. Look for moisture and ice, which could cause your generator's electrical components to malfunction or short circuit. This could result in electric shock or electrocution.
- Do not exceed your generator's wattage or amperage capacity. Exceeding these limits could damage your generator and any device attached to it.
- If you use your generator on highly conductive areas such as metal decking or steel work, use a ground fault circuit interrupter.
- Do not use electrical cords that are damaged, worn, bare or frayed.
- Do not touch your generator's bare receptacles or wires.
- Always properly ground your generator. Failing to ground your generator could result in electric shock or electrocution.

Your generator is equipped with a system that connects its frame components to the ground terminals in the AC output receptacles.

This system and the AC neutral wire are not connected.

Therefore, if you test your generator with a receptacle tester, it will not produce the same ground circuit condition as would be the case for a home receptacle.

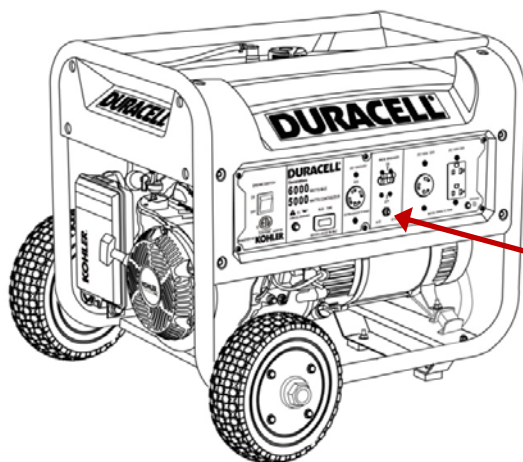

System Ground Terminal Location

Electrical system WARNINGS

When connecting to a building's electrical system for standby power, this connection must be made by a qualified electrician. This connection must isolate your generator's power from the utility's power and remain in compliance with all electrical codes and applicable laws.

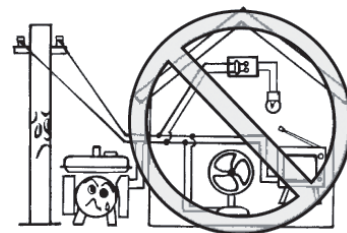

- Do not connect your generator to a commercial power outlet such as a building's electrical system unless an isolation switch is used, and that switch was installed by a qualified electrician.
- Improperly connecting your generator to a building's electrical system could allow electrical current from your generator to backfeed into the utility's lines. This could electrocute utility employees and others who make contact with the lines during a power outage. Your generator could also explode, burn, or cause fires when the power is restored. Consult a qualified electrician and/or the utility company before proceeding.

Burn and fire WARNINGS

Your generator's exhaust system becomes hot enough that it could ignite some materials and cause severe burns.

Gasoline is highly flammable and can be explosive, so use extreme caution when refueling and operating your generator.

- Stop engine when refueling.
- Do not smoke when refueling your generator.
- Keep your generator at least seven feet (or 2 meters) away from buildings and equipment.
- Keep flammable materials away from your generator.
- Do not allow sparks or flames near your generator when it's refueled and keep them away from your stored gasoline.
- Fuel vapors are highly flammable, so they could ignite after your generator is started. Wipe up any spilled fuel before you restart your generator.
- Do not operate your generator in enclosed or partially enclosed areas.
- Avoid touching your generator's muffler. It becomes extremely hot when your generator is in use. It remains hot for quite a while after you turn your generator off, so wait to move your generator into storage until the muffler has completely cooled to avoid severe burns.

Reference manual contains critical information

It's recommended that you keep this Owner's Manual near your generator, so you can refer to it while operating and maintaining it. If you resell your generator, this manual is considered to be a part of the generator and should be passed along with it to the new owner.

The information contained in this manual as well as the specifications outlined in it were in effect upon approval for publishing this manual. Duracell Generators reserves the right to change the specifications and instructions. Duracell Generators also reserves the right to discontinue and modify the design of the generator at any point without incurring any obligation and without providing notice. This document may not be reproduced in whole or in part without written permission from Duracell Generators.

Orientation to your generator

Major components

Below are diagrams of your generator's major components and its Control Panel:

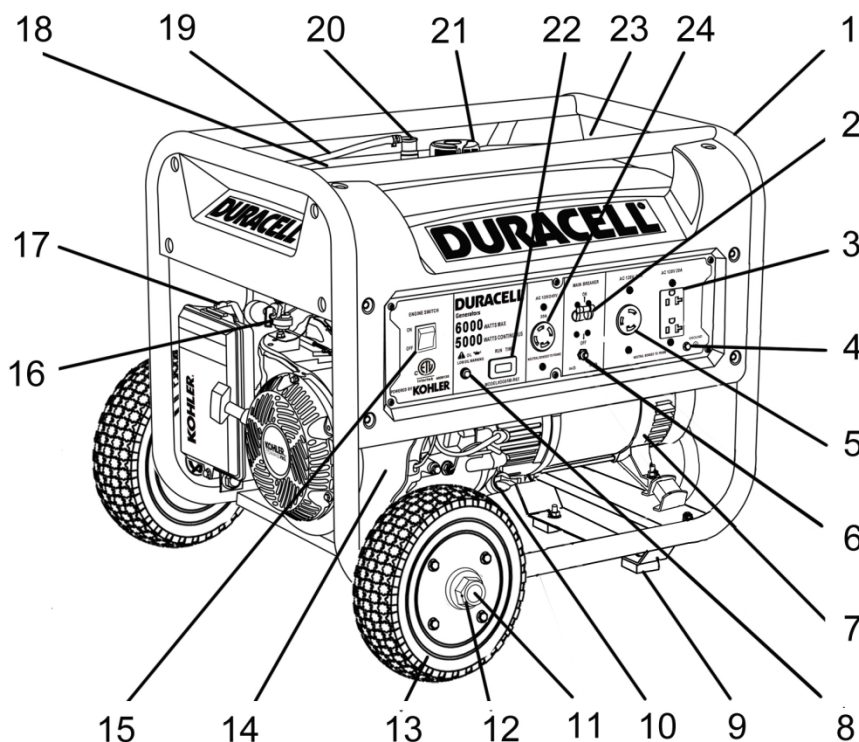

Models DG65M-R62:

1 FRAME COMP	13 WHEEL 10'
2 AC CIRCUIT BREAKER 30A	14 ENGINE
3 MAIN BREAKER	15 ENGINE SWITCH

4 GROUND TERMINAL	16 FUEL SWITCH
5 L5-30 RECEPTACLE	17 CHOKE
6 AC CIRCUIT BREAKER	18 TANK
7 ALTERNATOR	19 FUEL TUBE
8 LOW OIL LAMP	20 CHECK VALVE
9 FOOT	21 FUEL TANK CAP
10 OIL FILLER CAP	22 HOUR METER
11 AXLE	23 MUFFLER COMP
12 NUT	24 L14-30 RECEPTACLE

AC receptacles

This generator is equipped with the following receptacles:

5-20R:125 Volt, 20 Amp Duplex Receptacles (NEMA)

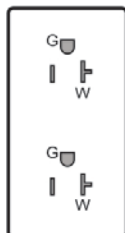

NEMA 5-20R

You can use the receptacle to operate 120 Volt AC, single-phase, 60Hz electrical loads that require up to a maximum of 2,400 watts (1.8 kW) at 20 Amps of current or greater.

Use only power cords rated for 125 Volt AC loads at 15 Amps, or greater.

L5-30R: 120Volt, 30Amp Twist Lock Receptacle

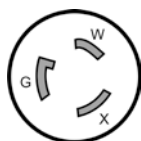

L5-30R

Use this receptacle to operate 120 Volt AC, single-phase, 60 Hz electrical loads that require up to a maximum of 3,600 watts (3.6 kW) at 30 Amps of current or greater.

Use only power cords rated for 125 Volt AC loads at 30 Amps, or greater.

L14-30R: 240/120Volt, 30Amp Twist Lock Receptacle

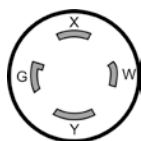

L14-30R

Use this receptacle to operate 240/120 Volt AC, single-phase, 60 Hz electrical loads that require up to a maximum of 5,000 watts (5.0 kW) at 21 Amps of current or greater.

Use only power cords rated for 125/250 Volt AC loads at 30 Amps, or greater.

Warning: Do not use electrical cords that are damaged, worn, bare or frayed. Your generator produces significant electrical power. Using damaged, worn, bare or frayed power cords could cause electric shock or even electrocution.

Only use electrical cords that support the amount of wattage outlined above for each receptacle.
Inspect power cords before each use.

Package contents

Below is a summary of the components included in your generator set. It's recommended that you review the items listed below and confirm they were all included in your purchase.

<u>Name of Component</u>	<u>Quantity</u>
Generator Set	1
Mobility and Assembly Kit	1
Generator Manual	1
Engine Manual	1

Mobility and Assembly Kit Includes:

The mobility kit will include:

Generator Leg (1)

Handles (2)

Tools and Axles: axles and nuts (2 each),
wrenches (2), screwdriver (1)

Leg and Handle assembly hardware



Unpacking and Assembly



WARNING: LIFTING HAZARD



The portable generator is heavy. Ensure that proper lifting equipment is available to unload and move this portable generator. The generator can crush and cause serious injury if it rolls out of control or tips over. Two or more adults are required for assembly.

Upon receipt, inspect generator for missing or damaged parts. Verify that it is the generator you ordered.

See “*Component Identification*” section of this manual for a diagram of the generator and its components.

- For *missing components*, contact Duracell Support at 1-888-980-4938.
- For *damaged components*, contact the freight company that delivered the unit and file a claim.
- If complete, fill out the product serial number information. See *Limited Warranty* section of this manual.
- **IMPORTANT NOTE:** This generator is heavy and at least 2 (two) adults will be required to unpack and assemble the unit.
- Additional tools to aid assembly: Rubber Mallet, #3 or #2 Phillips head screwdriver, wrenches (2-10 mm or 2-3/8 inch, 1 – 22mm or 7/8 inch, 1-19mm or ¾ inch, 1-18mm or 11/16).

UNPACK:

- a) Carefully cut the straps and tape on the top of the box and open.
- b) Remove the cardboard cover and place it on the floor, this will be used as an assembly base for the next steps.
- c) Remove the box containing the Mobility & Assembly kit and set it aside.



- d) With the help of another person (at least two people are required for this step), carefully remove the generator main unit from the box and set it upon the cardboard cover.



- e) Unpack the Mobility and Assembly Kit as shown.



ASSEMBLY:

Following are the steps for assembling the wheel kit and attaching it to the generator:

1. Locate the Wheel assembly kit:

The kit includes:

Number	Description	QUANTITY
1	Portable Generator	1
2	KOHLER ENGINE MANUAL	1
3	Wrench 10mm × 12mm	1
	Wrench 14mm × 17mm	1
	Flathead screw driver	1
4	Axle 16×114mm	2
	Sleeve 17×22×9mm	2
	M16×1.5 nut	2
	Washer 16×30×2	2
5	Generator foot with rubber	2
	M8×16 screw	2
	M8 nut	2
6	10" Rubber foam wheel	2
7	Handle (360MM)	2
	M8×50 screw	2
	M8 nut	6
	M8×35 screw	2
	M8×16 screw	2
	Handle bracket	2
	Bolt 8×48	2
	Open ring	2
	Washer 8	2

2. First, you'll place the wheels on the frame.

To do this, place the washer on the axle and insert it from the inside of the frame toward the outside of the frame as shown at right;



Then, install the spacer as shown;



Place wheel onto axle;



Secure wheel with nut and then repeat the steps above on the other wheel: *Use M16 x 1.5 nuts



3. Next, attach the front support. On the handle side of the generator, lift and support the bottom of the frame to enable the assembly of the front support: *Use M8 x 16 bolts and M8 nuts.



Then, fasten the foot bar onto the generator by threading the bolts into the holes in the frame of the generator at the points shown. Tighten the bolts.



4. The last step is attaching the handle.

Please note there are two different length bolts; the longer bolt will go through the upper hole and the short bolt through the lower hole:



Start by installing the upper bolt and nut to hold the handle in place, only tighten by hand at this point. We will tighten the bolt later: * Use M8 x 35 bolts and M8 nuts.



Now partially remove the handle pivot bolt as shown to allow the insertion of the lower bolt. This bolt is an M8 x 50.



Next secure the upper and lower bolts by tightening them with the wrenches or sockets as shown.



Now reassemble the handle pivot bolt and tight enough that the handle moves freely and will drop down from its' own weight. Then repeat these steps for the other handle. When complete the handles should look like the photo.



Handle Operation:

These handles have a self locking mechanism that must be set before raising the handle. Simply raise the locking pin up and away from the frame into this position. Then raise the handle, the handle should lock with the locking pin moving forward and dropping into the locking slot. To lower the handles just pull up on the locking pins and the handles will drop.



Now your generator should look like the picture below, which is ready for the next step of adding engine oil.



5. Add engine oil and check the engine:

IMPORTANT NOTE!

Engine is shipped without engine oil! Before operation, engine must be filled with the appropriate type and quantity of oil as specified by the engine manufacturer. Damage to the engine will result in running the engine without the proper type and quantity of oil. The warranty does NOT cover engine damage as a result of operating the engine without oil as specified by the manufacturer. Please refer to the engine owner's manual for the type, quantity and proper method for filling the engine with oil.

- Engine is shipped without oil. You must add oil before first use.
- Check the oil level (see engine manual). To avoid the inconvenience of an unexpected shutdown by the Oil Sentry system, always check the engine oil level before startup.



Do not return unit to store.
For questions, missing parts, and service contact
Customer Service:
1-888-980-4938

www.DuracellGenerators.com
IES, 1474 West 9th Street
Upland, CA United States

Select Suitable Location



WARNING: LOCATION HAZARDS



Choose a suitable site for operating your generator to prevent possible death from carbon monoxide poisoning or injury from fire/explosion, hot surfaces, or equipment tip-over. Your generator can crush and cause serious injury if it rolls out of control or tips over. Follow the instructions for safely moving the generator.

Moving and Handling

To move the generator around:

- Make sure the generator is turned off and has cooled down.
- Lock the handles and use them to manually move the generator.
- Lift the handles and push the generator in front of you as you walk.
- To turn, pivot the generator on its wheels as you push it.

Elevating or lowering your generator:

- To reduce risk of injury, it is recommended that at least two adults lift the generator.
- The generator must be off and cooled to ambient temperature (room temperature).
- Only lift the generator by the front and rear tubular frame. Do not use the alternator or engine as a lifting point.

For Outdoor Use ONLY

Select a Suitable Outdoor Location:

1. Never run the generator in an enclosed or partially enclosed location such as a building, garage, barn, shed, or house. These spaces can trap poisonous gases. Running a fan or opening windows will not provide adequate ventilation to prevent dangerous carbon monoxide build-up.
2. Only use the generator outdoors and far away from open windows, doors, and building or vehicle vents.
3. Place the generator so that the exhaust fumes will not be directed towards people or building air leaks and at least 7 feet away from combustible materials.
4. Do not locate and use the generator in the presence of flammable vapors, dust, gases, or other potentially combustible materials.
5. Ensure that working, battery-operated or battery back-up carbon monoxide alarms are used in any dwelling/structure that is in close proximity to the running generator.
6. Note that this generator is NOT designed or approved for use in vehicles or marine applications. Never run the generator inside RV's or other vehicles, on boats, or on pick-up truck beds.

Positioning:

1. The generator should be positioned on a firm, level (less than 3 degree slope), heat-resistant surface with good drainage and a nearby water supply.
2. Ensure that the generator sits level and will not slide or shift during operation. If applicable, block the generator's wheels to prevent movement.
3. Situate the unit so there is adequate pulling room for starting the engine using the recoil starter of the engine. Attempting to pull at an odd angle or in confined space could rip off the cord grip and/or cause muscular injuries to the operator.

Airflow:

1. Situate the unit so there is adequate clearance around the generator to allow for proper airflow – at least 7 feet from any non-combustible wall or obstruction.
2. Do not operate with a tarp, blanket, or cover surrounding the generator.
3. Do not place any objects against or on top of the machine.
4. The generator needs adequate, unobstructed airflow to allow for proper combustion and adequate cooling. Proper combustion can only be obtained when there is a sufficient supply of oxygen available for the amount of fuel being burned. Cooling ventilation is required to prevent overheating of the engine and pressure pump and/or the possibility of fire.
5. Situate the machine away from other heat generating equipment and do not allow debris to accumulate or block airflow to the engine or alternator.

Exhaust:**WARNING: Exhaust Modification Hazard**

Never attempt to attach ductwork to the muffler system to allow for installation inside an enclosure. This could cause heat build-up and increased exhaust back-pressure, resulting in possible exhaust leakage or damage to the Generator.

1. Place the unit so that the exhaust fumes will not be directed towards people or building air intakes.
2. Keep a fire extinguisher rated "ABC" nearby which is properly charged. Be familiar with its use.
3. The exhaust gas from your generator is extremely hot and can cause combustible materials to catch on fire.
4. Make sure the engine is at least 7 feet from all combustible materials and buildings/structures during operation.

Install Spark Arrestor (if Required)

Equip engine with spark arrestor if machine will be used near any ignitable forest, brush, or grassy land. (See engine Owner's Manual provided to determine if the engine is already equipped.) Make sure you comply with applicable local, state, and federal codes.



DANGER: Carbon Monoxide Hazard



Exhaust fumes from the engine contain carbon monoxide (CO), a poisonous gas you cannot see, smell, or taste. The CO generated by the engine can rapidly accumulate, even in areas that appear to be well ventilated, resulting in dangerous and fatal concentrations within minutes. NEVER run air inside any enclosed or semi-enclosed spaces, including homes, garages, basements, sheds, boxes, pick-up truck beds, RV's, or boats. These spaces can trap poisonous gases, EVEN if you run a fan or open windows. If you start to feel sick, dizzy, or weak while using the generator, shut off the engine and get to fresh air RIGHT AWAY. See a doctor. You may have carbon monoxide poisoning.

Pre-operation check and Safety Rules

Your safety is your responsibility. A little time spent in preparation will significantly reduce your risk of injury.

Knowledge

Read and understand this manual. Know what the controls do and how to operate them. Familiarize yourself with the generator and its operation before you begin using it. Know what to do in case of emergencies. Before starting the generator, review the safety rules found below and throughout the manual.



WARNING:



READ and UNDERSTAND this owner's manual completely before using the portable generator. Improper use of the portable generator could result in serious injury or illness for the operator or nearby persons/animals, or cause damage to the environment. Failure to follow safety rules may result in serious injury or death to the operator or bystanders.

Follow Safety Rules for Operation:

Instruct Operators

Owner must instruct all operators in safe set-up and operation. Do not allow anyone to operate the generator who has not read the Owner's Manual and been instructed on its safe use.

Safety Equipment/Controls

Always operate with all safety covers, guards, and barriers in place and in good working order, and all controls properly adjusted for safe operation. Wear safety apparel during operation and maintenance, including safety glasses with side and top protection. Use of hearing protection may be required if operator is in close-range for extended periods.

Moving Parts

Keep hands, feet, hair and apparel away from moving parts. Air vents may cover moving parts and should be avoided as well. Never remove any guards while the unit is operating.

Ear Protection

Hearing can be damaged from prolonged, close-range exposure to the type of noise produced by the engine. The use of ear plugs or other hearing protection device is recommended for persons working within 10-20 feet of the running generator for an extended period of time.

Eye Protection

Wear ANSI/OSHA required “Z87.1” safety glasses when operating or servicing the generator. Safety glasses should be used when refueling or performing service on the generator.

Conditions for Use:

Know How to Stop the Machine

Be thoroughly familiar with proper use of the equipment and all controls and connections. Know how to stop the generator safely and quickly if needed, such as in an emergency situation.

Instruct All Operators

The generator’s owner must instruct all operators and potential renter in safe set-up and operation. Do not allow anyone to operate the generator who has not read the Owner’s Manual and been instructed on its safe use.

Adult Control Only

Only trained adults should set up and operate the generator. Do not let children operate this generator. Generator operation and set up can require judgment beyond what can be expected of children.

Under the Influence

Never operate, or let anyone else operate, the generator while fatigued or under the influence of alcohol, drugs, or medication.

Safety Equipment / Controls in Place

Do not operate the generator unless all safety covers, guards, and barriers are in place and in good working order, and all controls are properly adjusted for safe operation.

Damaged

Do not operate the generator with damaged, missing, or broken parts. Never attempt to repair it with a part that is not rated at or above the rating of the machine. Always replace damaged or missing parts with parts designed specifically for this machine. Please contact Duracell Generators customer service to get replacement parts.

Modifications

Do not modify the generator in any way or deactivate any safety device. Do not change or add to fuel tank, fuel line, or exhaust system. Modifications can result in hazards related to carbon monoxide poisoning, fuel leaks, fire, explosion or other serious safety hazards, and will also VOID the warranty.

Conditions during Use:

Stay Alert

Watch what you are doing at all times and be aware of your environment and what is going on around you.

Clear Work Area

Keep a clear work area and make sure no bystanders are in the work area.

Keep Children and Pets Away from the Work Area.

Keep Spray Away From Electrical Wiring

Spray contact with electrical wiring will likely result in severe electrical shock or electrocution. Keep spray away from electrical outlets, devices, and equipment.

Hot Exhaust Parts

Stay clear of engine exhaust and other hot surfaces or casing during operation. Never touch hot engine exhaust muffler, or other hot surfaces. All are very hot and will burn you.

Do Not Direct Spray at This Machine

Do not attempt to clean this machine with a spray hose or pressure washer. Engine damage will result. Cleaning should be done with a damp sponge and cloth with the engine off and cool.

Let the engine cool at least three minutes before refueling.

Avoid Inhalation of Exhaust

This product emits carbon monoxide and chemicals known to the State of California to cause cancer, birth defects or other reproductive harm.

No Load Bearing

Do not use the generator to support other items of equipment that impose unacceptable loads on the generator. Do not attempt to use this machine as a prop.

Leaving Unattended



Always turn off the generator before leaving the generator unattended.

Seek Medical aid for suspected carbon monoxide poisoning

The running engine gives off carbon monoxide, a poisonous gas that can kill you. If you start to feel sick, dizzy, or weak while using the generator, shut off the engine and get to fresh air RIGHT AWAY. See a doctor. You may have carbon monoxide poisoning.

Pre-operational Checks

For your safety, and to maximize the service life of your equipment, it is very important to take a few moments before you operate the generator to check its condition. Be sure to take care of any problem you find, or have your servicing dealer correct it, before you operate the generator. Make sure that any regular maintenance has been performed as described in "Maintenance and Repair" section.



	WARNING:	
<p>Improperly maintaining this portable generator, or failure to correct a problem before operation, could cause a malfunction in which you could be seriously injured.</p> <p>Always perform a pre-operation inspection before each operation, and correct any problem.</p>		

To prevent a possible fire, keep the portable generator at least 7 feet (2 meters) away from building walls and other equipment during operation. Do not place flammable objects close to the engine.

Before beginning your pre-operation checks, be sure the generator is on a level surface and the ignition switch is in the OFF position.

1. Check the General Condition of the Generator

- Look around and underneath the generator for signs of oil or gasoline leaks.
- Remove any excessive dirt or debris, especially around the engine, muffler, and recoil starter.
- Look for signs of damage.
- Check that all nuts, bolts, screws, hose connectors, and clamps are tightened.
- Refer to the engine Owner's Manual for engine maintenance instructions.
- Check oil level in the engine. See engine owner's manuals.
- Ensure the area around the generator is free from rags, tools, debris, and flammable or explosive materials.
- Ensure any belt guards and covers are securely in place.
- Ensure the alternator ventilation holes are not blocked.

	WARNING: Entanglement Hazard	
<p>Do NOT operate with protective covers or guards removed. Doing so could expose high speed moving components which could allow for the operator or bystander to become entangled. Entanglement in this equipment may result in serious injury, amputation, or death.</p>		

2. Check/Add Oil to Engine

CAUTION: Inadequate Lubrication Hazard

Never operate Generator with inadequate lubricant in the engine. This will cause overheating and severe damage to the engine.

Engine: See engine Owner's Manual for capacity and recommended oil type for your expected ambient conditions.

3. Check tools, appliances, and cords

Plugging faulty power cords and appliances
into your generator can cause electric shock.

Before connecting any tool, appliance, or power cord to your generator, examine it closely. Confirm that they are in good working order. Do not use electrical cords that are damaged, worn, bare or frayed. This can cause electric shock.

Never exceed your generator's maximum power rating. Confirm that the electrical rating of any tool or appliance that you plug into your generator does not exceed your generator's rating.

Note: Often you can find ratings near model or serial numbers on appliances and tools.

If an appliance operates abnormally, seems sluggish, or stops, immediately unplug it from your generator. Then, determine the source of the problem such as an appliance that exceeds your generator's load capacity.

4. Stay within your generator's power limit

Never overload your generator.

Confirm that any device you plug into your generator is single-phase 60Hz.
Never connect 50 Hz devices or three-phase loads to your generator.

Continuous output: DG65M-R62 is rated at 5,000 watts

Maximum power: DG65M-R62 is rated at 6,000 watts

Tools, appliances, and other electrical devices with power levels between the rated and maximum levels should not be powered by your generator for more than five minutes.

Overloading your generator substantially could trigger its AC circuit protector. Exceeding the five minute limit or slightly exceeding your generator's capacity may not switch off your generator's AC circuit protector. However, doing either shortens your generator's service life. Take into account the total requirements of all appliances, tools, and other electrical devices powered by your generator when considering requirements and limits. Estimate the amount of surge (i.e. starting) watts needed for each electrical device that you plug into your generator.

The surge wattage is the short burst of power needed to start these tools, appliances, and other electrical devices.

5. Fuel requirements

Use only high quality unleaded gasoline to help minimize combustion chamber deposits.

Use only clean gasoline and oil. Never use gasoline or oil that is stale, contaminated, or poor quality. This could damage your generator's engine. Keep your fuel tank and oil cup clear of impurities (e.g. dirt, dust, water).

6. Use only the recommended fuel

Please refer to the engine owner's manual for the recommended type of fuel and follow these recommendations in order to comply with the warranty requirements. Failure to follow the engine owner's manual may void the engine warranty.

7. Use only the recommended engine oil

Please refer to the engine owner's manual for the recommended type and quantity of engine oil and follow these recommendations in order to comply with the warranty requirements. Failure to follow the engine owner's manual may void the engine warranty.

Although there is a "low oil warning" indicator that will warn you when the oil level is critically low this is not for maintenance, it is a warning indicator of a problem. It is recommended that you check the oil level routinely to ensure that the engine has sufficient oil at all times.

Do not run your generator without oil. This would damage the engine and void your warranty.

Starting the Generator

For safety, do not operate your generator indoors or in partially enclosed areas.

The generator's exhaust contains toxic carbon monoxide gas and can collect rapidly in even partially enclosed areas such as a garage.

Breathing this poisonous gas can cause severe illness and even death.

1. Perform the Pre-Operation Check (page 19-24.)
2. Confirm that no appliances are connected to your generator's AC receptacles



3. Turn the Fuel Valve to ON position



4. If the engine is cold, move the Choke Lever to on position as shown by the arrow.
If the engine is warm, move the Choke Lever to the closed/off position.
5. Start the Generator Engine:
(Refer to the engine owner's manual for more details on starting the engine)



Begin by turning on the engine switch:



Push the switch to the "ON" position:

Pull the Starter Grip gently until you feel slight resistance, then pull briskly.





Warning: Avoid damaging the starter and its housing.
Don't let the Starter Grip snap back into place.
Gently guide it back into position.

6. As the engine warms up, move the Choke Lever to Closed/Off position as shown by the arrow:



7. Allow the engine to warm up for 2 minutes before plugging electrical devices into your

	WARNING:	
<p>The engine exhaust from this product contains carbon monoxide gas. Breathing this poisonous gas, which is odorless and colorless, can cause unconsciousness and even death.</p>		

generator.

8. Confirm that each electrical device has been turned OFF *before* plugging it into your generator.

Monitoring the fuel level

Check the level of your generator's fuel tank every time before starting it. The fuel level must be between the minimum and maximum capacity lines.

When adding fuel, turn the generator off and let it cool at least 2 minutes before removing the gas cap.

After waiting for 2 minutes, remove the fuel tank cap and check the fuel level.

Refill the fuel tank if the fuel level is low but do not fill above the upper level mark.

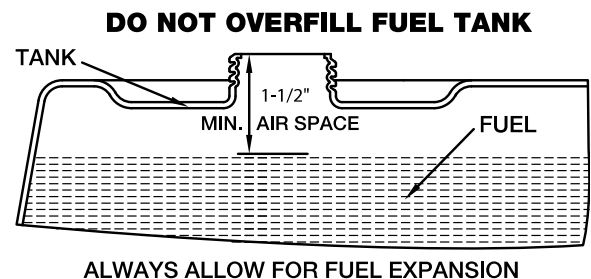

Using caution when refueling the tank

Fuel vapor is highly flammable and could ignite after your generator is started. After refueling, wipe up any spilled fuel before restarting your generator. Store your gasoline away from sparks and flames.

After refueling, tighten the fuel tank cap securely and wipe up any gasoline that may have spilled:

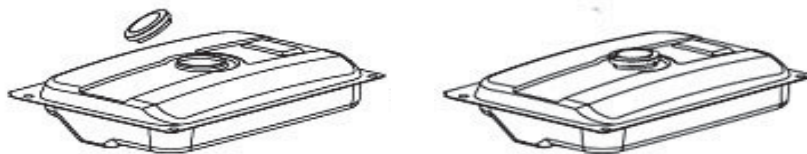

Fuel can damage components of your generator such as metal, rubber, paint, and plastic.

Note: Damage caused by spilled fuel is not covered under warranty.

Shutting Down the Generator

1. Unplug any electrical device that's currently plugged into the AC outlet before turning off your generator.

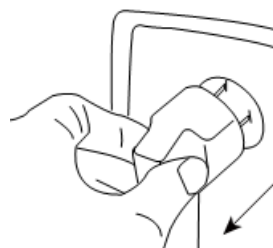

2. Run the generator at “no-load” for several minutes to stabilize the internal temperatures of the engine and generator.

3. Turn the Engine Switch to the OFF position.



Recoil Start Model

4. Turn Fuel Valve to OFF position.

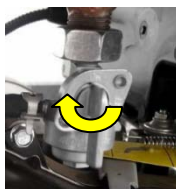

In case of an emergency, turn the engine switch to the OFF position!

Note: Before transporting and storing your generator, first drain all fuel and turn the Engine Switch to the OFF position.

Maintenance

Importance of maintenance

Proper maintenance is critical for smooth operation of your generator and safety.

Below are guidelines including a maintenance schedule and inspection procedures. There are additional procedures that are more complicated or require special tools that are best performed by certified technicians and qualified mechanics.

Improperly maintaining your generator or failing to correct a problem before use can cause malfunction that could cause serious injury or even death. Always follow the maintenance procedures and schedule.

The maintenance procedures and schedule apply to “normal” operating conditions. If your generator is used more heavily or in extreme conditions (e.g. sustained high-load, high-temperature, dusty or wet environments), consult your Service Dealer for recommendations that are applicable to your specific needs and usage. Maintenance, replacement, and repair of your generator's emission control devices

and its systems can be performed by any engine repair establishment or repair person, using parts that are certified to EPA standards.

Note: Your Authorized Service Dealer is knowledgeable about your generator, and is best equipped to maintain and repair it. To ensure smooth, economical, and trouble-free operations, use only new, genuine Duracell generator parts or their equivalents when repairing your generator and replacing its parts.

Maintenance safety precautions

Critical safety precautions are summarized below. Read the maintenance instructions before you begin and confirm that you have the necessary skills and proper tools to perform the procedures.

Since we couldn't possibly warn you of every possible hazard that could arise while maintaining your generator, it's essential that you use good judgment when deciding which procedures should be performed and use care when performing the procedures.

Turn generator off before servicing: Confirm that your generator's Engine Switch is turned to the OFF position before beginning any maintenance and repairs.

Exhaust contains carbon monoxide: Never operate your generator in an enclosed or partially enclosed area. Be sure there is adequate ventilation. The engine exhaust contains carbon monoxide, a poisonous gas that is odorless and colorless. Be sure to have adequate ventilation when operating your generator and never allow the gas to build up.

Generators get extremely hot: To avoid severe burns always allow the engine and the exhaust system to completely cool before touching, moving, and storing.

Gasoline is flammable: Use extreme care when working with gasoline to avoid the possibility of fires and explosions. Use only nonflammable solvents when cleaning parts. DO NOT use gasoline to clean your generator's parts. Keep sparks, cigarettes, and flames away from all fuel, your generator, and any fuel-related components.

Check cooling holes: There are cooling holes on your alternator. If these cooling holes become blocked, your generator could overheat and cause damage to the engine, inverter, or windings. So, when you inspect your generator before and during use, it's critical that you keep these cooling holes open and clear of mud, water, paper, or other debris.

Keep your generator upright: Never lay your generator on its side while moving, storing, or using it. Oil could leak and damage your generator's engine and surrounding areas.

Comply with local and current regulations: There may be local codes, ordinances, or federal or state Occupational Safety and Health Administration (OSHA) regulations that apply to the use of your generator. Consult a qualified electrician, electrical inspector, or your local agency. For example, some areas require that generators be registered with the utility companies. There may be additional regulations that apply if your generator is used on construction sites.

Failure to follow maintenance precautions, procedures, and guidelines can cause you to be seriously injured or killed.

Maintenance schedule

Perform at indicated intervals		Regular service period (1)					
		Before each use	Weekly	First month	Every three months	Every six months	Every year
Start engine			●				
Engine oil*	Check	● (5)					
	Change			● (5)		● (5)	
Air filter*	Check	● (5)					
	Clean				● (2)		
Spark plug*	Clean/adjust					● (5)	
	Replace						● (5)
Idle speed*	Check/adjust					● (3)	
Spark arrestor* (optional part)	Clean					● (3)	
Fuel tank and filter*	Clean					● (3)	
Valve clearance	Check/adjust						● (3)
Combustion chamber*	Clean/adjust						● (3)
Cylinder*	Clean					● (3)	
Fuel line*	Serviced	● (4)					

NOTE: PLEASE REFER TO ENGINE MANUAL FOR DETAILED MAINTENANCE SCHEDULE FOR ALL ENGINE MAINTENANCE.

* Emission-related items

Information about refueling can be found in the “Fuel Requirements” section.

Important maintenance considerations:

- (1) When used for commercial or heavier use, maintenance may be required at more frequent intervals.
- (2) Service more frequently when used in dusty areas.
- (3) These items should be serviced by an Authorized Service Dealer.
- (4) This should be serviced by an Authorized Service Dealer every three years.
- (5) Refer to engine manual for service of this item.

NOTE: Failure to follow this maintenance schedule could result in non-warrantable failures



NOTICE:



Dispose of used motor and pump oil in a manner that is compatible with the environment and in accordance with local, state, and federal laws and regulations.

- Take used oil in a sealed container to your local recycling center or service station for reclamation.
- Do NOT throw it in the trash, pour it on the ground, or pour it down the drain.

No Modifications. Never modify or alter the generator in any way. Modifications can create serious safety hazards and will also void the warranty.

Engine Maintenance

Perform engine maintenance as specified in the engine owner's manual. Items include:

- Change oil after the first 5 operating hours, and at least every 100 hours of use after that. Please refer to the engine owner's manual for details.



WARNING: Burn Hazard



Never open oil port while generator is running. Hot oil can spray over face and body.

- Air filter check/replacement.
- Spark plug cleaning/replacement.
- Fuel filter check/replacement.
- Fuel tank cleaning.
- Inspect and clean spark arrestor as needed.
- Read and follow any required emissions control system inspections and maintenance procedures.

Emission Control System Information

Please refer to the engine owner's manual regarding the emission control system information and any maintenance requirements to keep your equipment in compliance with regulations.

You may also consult your Authorized Service Dealer for maintenance and repair procedures that are applicable to your specific needs and usage.

Storing and transporting your generator

- Keep your generator upright at all times.
- Never lay your generator on its side while moving, storing, or using it.
- Oil could leak and damage your generator's engine and surrounding areas.

Allow to cool: Your generator can get very hot when in use. A hot engine and exhaust system could cause severe burns and even ignite some materials. So, allow it to cool for at least fifteen minutes before moving or storing it.

Keep upright: To avoid damaging your generator and spilling fuel, the generator should remain in an upright position at all times.

Turn OFF: Confirm that the Engine Switch is in the OFF position and that the Fuel Tank Cap is closed.

Protect your generator: Never drop your generator and protect it from getting damaged when using, transporting, or storing it. Never lay heavy objects on your generator.

Carefully select storage area: While in storage, your generator needs to be free of dust and not exposed to high-humidity conditions. So, examine the storage area closely to be sure it's an appropriate storage area.

Storage procedures

Storage time	Recommended storage procedures to prevent hard starting
Less than one month	Make sure fuel valve is closed. No other preparation necessary. You can store your generator as is. Remove the generator from storage and start it once a week during this period.
More than one month	Drain gasoline from the Fuel Tank and the carburetor*. Remove Oil Filter Cap and Drain Plug. Drain the oil. Then, tighten Oil Drain Plug and refill with fresh oil up to the Filter's neck.

* Following are the procedures for draining gasoline from your generator before storing it:

- Unscrew the fuel tank cap.
- Remove the debris screen.
- Use a hand siphon (commercially available) to empty tank.
- Reinstall the debris screen and fuel tank cap.
- Remove the side panel and loosen the carburetor drain screw.
- Drain the gasoline from the carburetor into a container as per the engine owner's manual.
- Please refer to the engine owner's manual for preparing the engine for storage.

You can get severely burned or injured when handling gasoline. Fuel is highly flammable and can be explosive.

Only handle fuel outdoors and keep sparks, heat, and flames away. Immediately wipe up any spills.

Troubleshooting

Problem	Cause	Solution
Generator will not start	Fuel tank is empty	Refill gasoline to proper level
	Defective or dirty spark plug	Replace spark plug
	An electrical device is plugged into the generator	Unplug device and restart generator
Generator will not start or it starts but runs roughly	Oil level is too low	Refill oil to the proper level Place generator on a flat, level surface
	Choke isn't in proper position	Adjust choke
	Spark plug has loose wire	Tighten wire connecting spark plug
Generator starts but then immediately shuts off	Fuel tank is too low or empty	Refill gasoline to proper level
	Oil level is too low	Refill oil to the proper level Place generator on a flat, level surface
Generator isn't supplying enough power or the generator is overheating	Generator is overloaded	Confirm electrical device plugged into your generator is single-phase 60 Hz. Confirm total requirements of all devices plugged into your generator do not exceed the power limit of your generator. Refer to "Stay within your generator's power limit" section of manual (page 23).
	Cooling holes are blocked	Check the cooling holes on the side panel and bottom of the generator. Clear away any mud, water, paper or other debris.
Note: Troubleshooting continues on following page		
Generator has no AC output	Cable isn't properly connected	Reattach all connections

or it doesn't appear to be generating electricity	Circuit breaker is open	Reset circuit breaker
	Capacitor is defective	Contact your Authorized Service Dealer to replace capacitor
	Brush assembly is faulty	Contact your Authorized Service Dealer to replace brush assembly
	AVR is faulty	Contact your Authorized Service Dealer to replace AVR
	Wiring is loose	Inspect and tighten wiring connections
	AC output is fine. Electrical device or power cord that's plugged into generator is damaged or defective.	Unplug cord or device immediately
	Other	Contact customer service
Generator surges or gallops	Engine governor may be defective	Contact customer service
Repeated circuit breaker tripping	Generator is overloaded	Review load and adjust. See "Stay within your generator's power limit", page 23.
	Power cord or electrical device is defective or damaged	Unplug cord or device immediately

Generator Specifications: DG65M-R62

Model		DG66M-R62
Generator	Type	Portable Generator
	AC Voltage(s)	120V/240V Single Phase
	Frequency	60Hz
	Maximum output	6,000 Watts
	Rated output	5,000 Watts
	Power factor	1.0
Engine	Model	Kohler CH395 Command Pro
	Cooling system	Air-cooled, 4-cycle
	Bore x Stroke	3.1 in x 2.3 in (78 mm x 58 mm)
	Displacement	16.9 cu. In (277 cc)
	Maximum output	9.5 hp (7.1 kW)
	Engine speed (rpm)	3600
	Fuel	Unleaded
	Fuel Tank capacity	6.5 gallon
	Rated continuous operation	8 hours at 100% load 12 hours at 50% load
	Starting system	Recoil starter with auto decompression.
	Ignition system	Electronic intelligent ignition
	Spark plug: type	Champion RC12YC or equivalent
Dimensions	Height	27 inches (69 cm)
	Width	27.5 inches (70 cm)
	Length	32 inches (81 cm)
	Weight	180 lbs. (82 kg)

Wiring diagram DG65M-R62

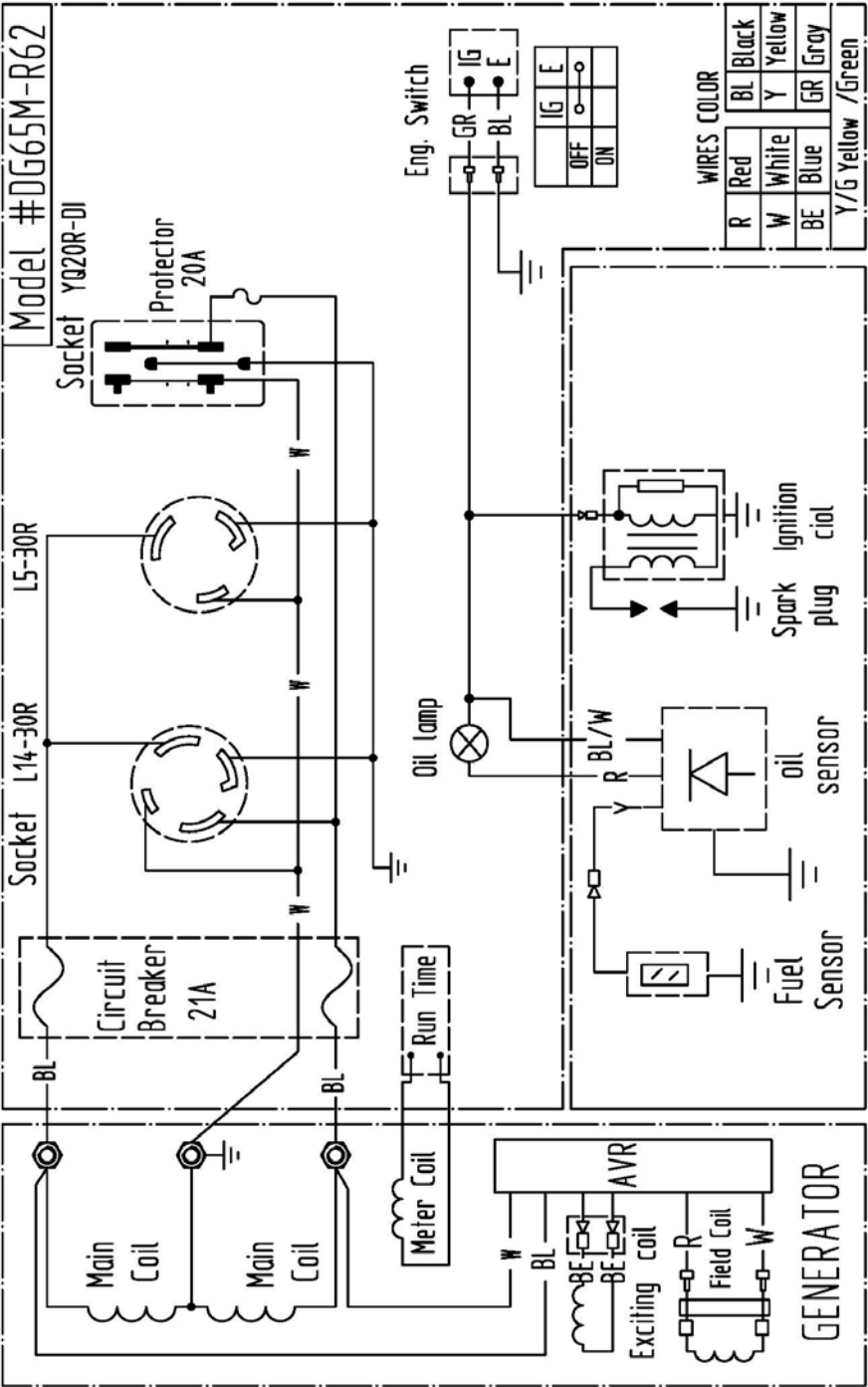

Parts list DG65M-R62:

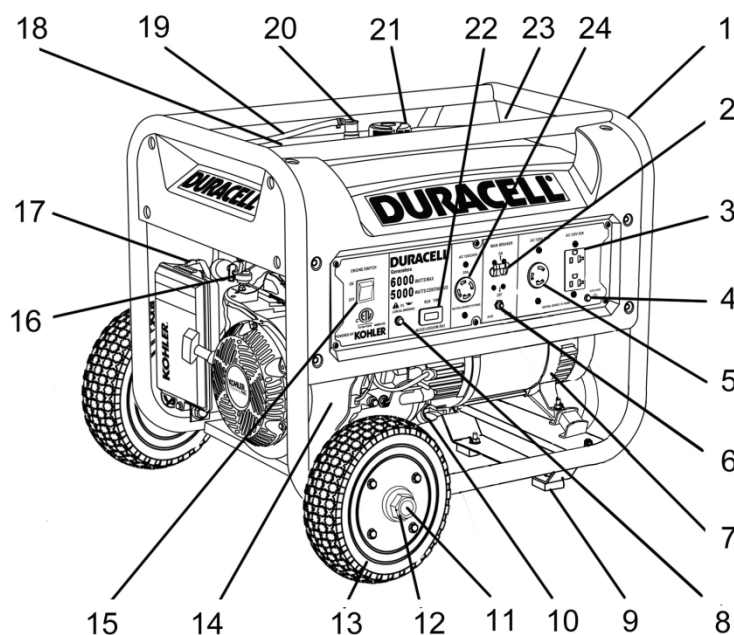

1 FRAME COMP (DG6XR-1000)	13 WHEEL 10' (DG6XX-1021)
2 AC CIRCUIT BREAKER 30A (DG6XX-1012)	14 ENGINE CH395 (DG6XX-CH395)
3 WY-20R RECEPTACLE (DG6XX-1014)	15 ENGINE SWITCH (DG6XR-1022)
4 GROUND TERMINAL (DG6XX-1018)	16 FUEL SWITCH (DG6XX-1023)
5 L5-30 RECEPTACLE (DG6XX-1015)	17 CHOKE
6 AC CIRCUIT BREAKER 20A (DG6XX-1013)	18 TANK (DG65X-1024)
7 ALTERNATOR (DG65X-1017)	19 FUEL TUBE (DG6XX-1025)
8 LOW OIL LAMP (DG6XX-1019)	20 CHECK VALVE (DG6XX-1026)
9 FOOT (DG6XX-1009)	21 FUEL TANK CAP (DG6XX-1027)
10 OIL FILLER CAP	22 HOUR METER (DG6XX-1028)
11 AXLE (DG6XX-1035)	23 MUFFLER COMP (DG6XX-1029)
12 AXLE NUT (DG6XX-1020)	24 L14-30 RECEPTACLE (DG6XX-1030)

GENERATOR

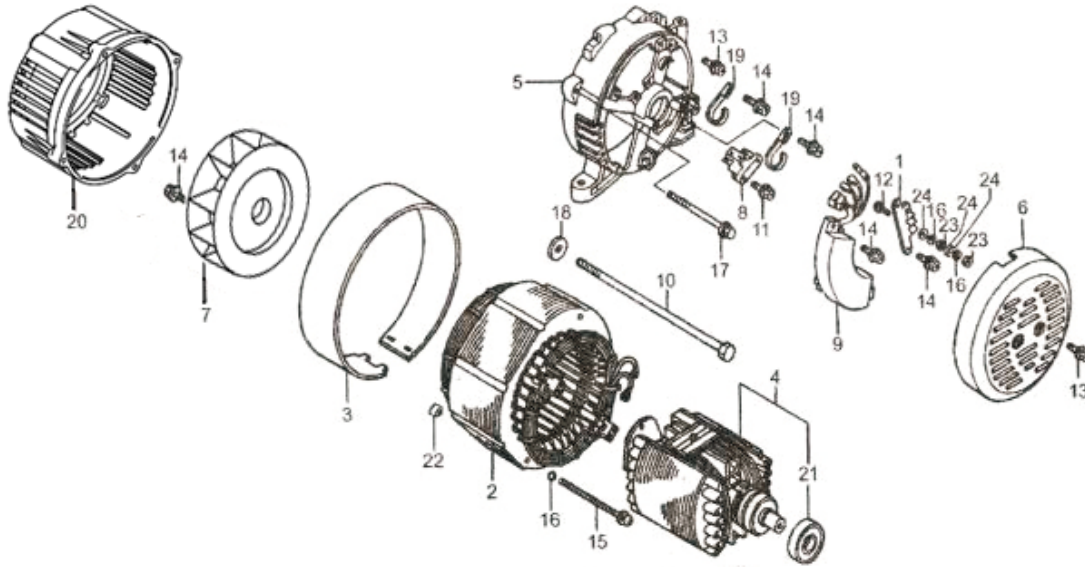

NUMBER	PART NUMBER	DESCRIPTION	QTY
1	DGG65-1100	CONNECTION FLAT	1
2	DGG65-1101	STATOR COMP	1
3	DGG65-1102	STATOR COVER	1
4	DGG65-1103	ROTOR,COMP	1
5	DGG65-1104	GENERATOR STAY	1
6	DGG65-1105	BRACKET,RR.,MOTOR(BLACK)	1
7	DGG65-1106	GENERATOR FAN	1
8	DGG65-1107	BRUSH ASSY	1
9	DGG65-1108	VOLTAGE REGULATOR (5KW)	1
10	DGG65-1109	FASTNESS BOLT(ROTOR)8x255	1
11	DG516-1110	BOLT,FLANGE 5x16	1
12	DG516-1110	BOLT,FLANGE 5x16	2
13	DG516-1110	BOLT,FLANGE 5x16	2
14	DG516-1110	BOLT,FLANGE 5x16	2
15	DG5225-1111	FLANGE BOLT(STATOR) 5x225	2
16	DGM5-1112	FLANGE BOLT(STATOR) M5	2

17	DG8185-1113	FLANGE BOLT(STATOR) 8x185	4
18	DGSW8-1114	WASHER,SPRING(ROTOR) 8MM	1
19	DGBW3-1115	BAND'WIRE(SINGLE) 300mm	2
20	DG65X-1116	GENERATOR FRONT STAY	1
21	DG65X-1117	BEARING 6204RS	1
22	DGM05-1118	NUT (STATOR) M5	2
23	DGSW5-1119	WASHER,SPRING 5MM	4
24	DGPW5-1120	WASHER,PLAIN	4

FUEL TANK ASSEMBLY

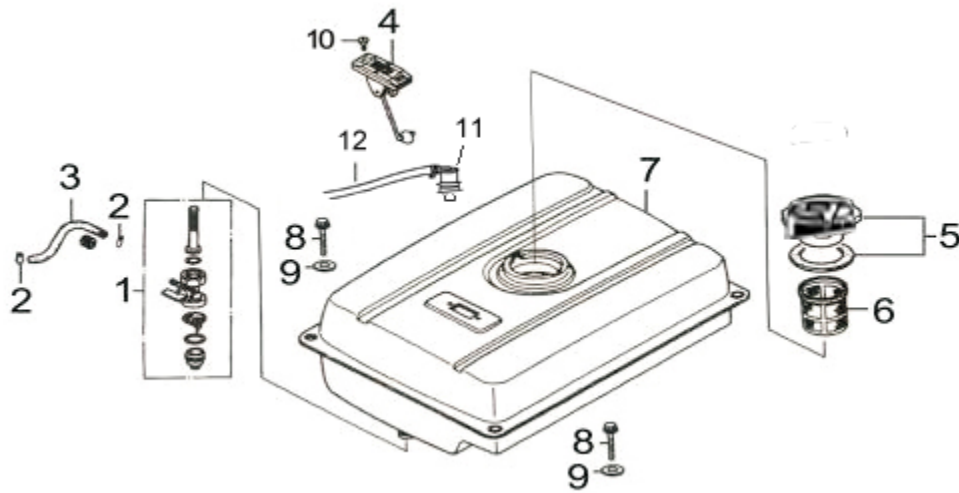

NUMBER	PART NUMBER	DESCRIPTION	QTY
1	DG6XX-1200	COCK ASSY.FUEL	1
2	DG6XX-1201	CLIP,TUBE (B8)	4
3	DG6XX-1202	TUBE,FUEL 4.5x205	1
4	DG6XX-1203	FUEL SENSOR ASSY	1
5	DG6XX-1204	CAP COMP,FUEL FILLER	1
6	DG6XX-1205	FUEL FILLER	1
7	DG665-1206	TANK COMP,FUEL(COPPER) 6.5 GALLON	1
8	DG612-1008	BOLT,FLANGE M6X12	4
9	DG622-1207	BOLT,FLANGE 6x22x2.0	4
10	DG510-1208	SCREW 5x10	2
11	DG6XX-1209	CHECK VALVE	1
12	DG6XX-1210	TUBE,FUEL 4.5x700	1

FRAME & CONTROL PANEL

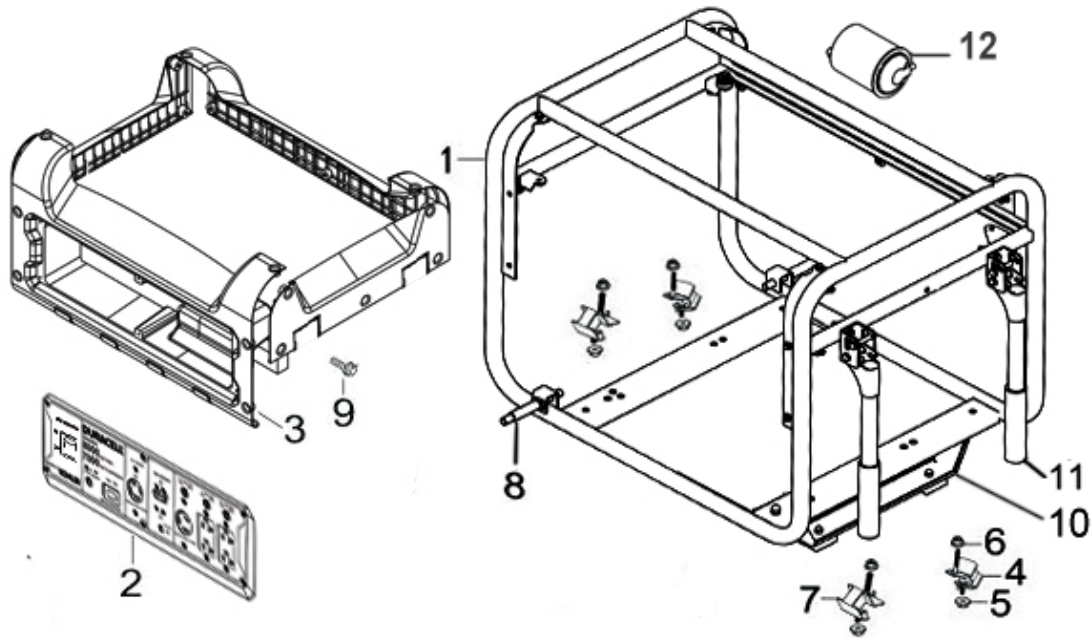

NUMBER	PART NUMBER	DESCRIPTION	QTY
1	DG6XB-1000	FRAME COMP	1
2	DG65B-1001	CONTROL PANEL ASSY	1
3	DG6XX-1002	CONTROL PANEL CASE	1
4	DG6XX-1003	BOTTOM RUBBER A	2
5	DGM08-1004	NUT FLANGE M8	4
6	DGM10-1005	NUT FLANGE M10	4
7	DG6XX-1006	BOTTOM RUBBER B	2
8	DG6XB-1007	AXLE	1
9	DG612-1008	BOLT FLANGE,6X12	18
10	DG6XX-1009	FOOT	1
11	DG6XX-1010	HANDLE	2
12	DG6XB-1000	CHARCOAL CANISTER	1

Engine assembly and parts list:

(Please refer to the engine owner's manual for the parts list and assembly diagram.)

Contact information for Technical and Customer Assistance

Locate an Authorized Service Dealer

For assistance in finding an Authorized Service Dealer, contact Duracell Generators Customer Service at 888-980-4938 or TechSupport@DuracellGenerators.com. Visit our web site at www.DuracellGenerators.com.

Registration Card

Please fill out the registration card, and return it within 30 days of the purchase date. Registration card can be found in the same plastic bag as your manual.

Customer assistance

Authorized Service Dealers are trained professionals who are familiar with your generator. They can answer most of your questions and help you with any problems that you may encounter. If you are not satisfied with the service you received from your representative, ask to personally speak with the Service Manager or the Dealer's General Manager. The majority of questions and issues are resolved at the Local Dealership.

However, if you are not satisfied with the information or the response you received from your Service Dealer, you may contact Duracell Generators Customer Service office:

Duracell Generators
1474 West 9th Street, Suite A3
Upland, CA 91786

www.DuracellGenerators.com

Toll free: 888-261-5397

When you contact us, please provide the following so that we may help you most effectively:

Your generator's model and serial numbers

Name of Service Dealer who sold the generator to you initially

Name and address of the Service Dealer who services your generator

Date you initially purchased your generator

Your name, address, and phone number

A detailed summary of the issue

Wattage Reference Chart

Do not exceed your generator's capacity: Exceeding the wattage or amperage capacity can damage your generator and any devices attached to it.

1. Identify all of the devices you would like to power by your generator at the same time.
2. Calculate the total watts for all items (amps x volts = watts).
3. Note that electric motors typically require substantially more wattage (2 – 3 times more) to start the devices than the rated wattage required to run the devices.

Below is a chart to help you estimate the required wattage for starting and running appliances:

WATTAGE CHART		
Appliance	Running Wattage	Startup Wattage
Portable Heater	1500	1800
Small Refrigerator	500	2000
Television	400	0
Microwave	750	0
Air Conditioner (20,000 BTU)	3300	0
Coffee Maker	1200	0
Furnace Fan	1100	2000
Refrigerator/Freezer	1200	3000
3/8" Hand Drill	500	750
7 1/4" Circular Saw	1500	1900

Limited Warranty

Duracell Generators are manufactured and distributed by Innovative Energy Solutions, Corp. Innovative Energy Solutions, Corp. (IES) shall warranty any piece of equipment manufactured, or parts of equipment manufactured, to be free from defects in material or workmanship for a period of:

Limited Warranty Period

Component/Model	Within United States, Canada, & Mexico	
	Consumer use	Commercial use
Kohler CH395 Engine (Warranty by Kohler Company)	Three (3) years from the date of purchase by the user.	Three (3) years from the date of purchase by the user.
Duracell Generator (except engine)	Two (2) years from the date of purchase by the user.	Two (2) years from the date of purchase by the user.

The limited warranty period begins on the date of initial purchase by the first retail consumer or commercial user from an IES authorized retailer, and continues for the period of time stated in the table above.

“Consumer use” refers to personal, residential household use by a retail customer.

“Commercial use” means all other uses, including commercial, income-producing, or rental purpose. Once the engine has experienced commercial use, it shall thereafter be considered as a “Commercial use” engine for purposes of this warranty.

This limited warranty period is for product purchased from an IES authorized retailer only, products purchased from an unauthorized retailer will not be covered by this limited warranty.

The limited warranty of the engine will expire 4 years from the date of manufacture of the unit, unless IES extends the warranty in writing. The limited warranty of the generator (except for the engine) will expire 3 years from the date of manufacture of the unit, unless IES extends the warranty in writing.

This limited warranty applies to the original purchaser of the equipment and is non transferable. Verification of purchase is the responsibility of the buyer in the form of a sales receipt for the specific product. Parts will be replaced or repaired at no charge, except when the equipment has failed due to lack of proper maintenance or abuse. Shipping charges on parts submitted for repair or replacement under this Warranty must be borne by purchaser. Any misuse, abuse, alteration or improper installation or operations will void warranty. Determining whether a part is to be replaced or repaired is the sole decision of Innovative Energy Solution, Inc.

NOTE: Some services performed by parties other than IES may void warranty. Always contact Duracell Generators Customer Support at 1-888-980-4938 prior to having any service or warranty work performed, as some services performed by parties other than IES approved service centers may void warranty.

Limited Warranty continued

This warranty covers parts only. It will not provide for replacement of complete products due to defective parts. Components not manufactured by IES such as engines are guaranteed by their manufacturer and can be serviced at factory-authorized locations near you. The engine warranty is covered under the terms and conditions as outlined by the engine manufacturer's warranty contained herein and is the sole responsibility of the engine manufacturer. Normal engine maintenance such as spark plugs, air filters, adjustments, fuel system cleaning and obstructions due to build up are not covered by this IES warranty. IES will not provide for replacement of complete products due to defective parts.

Any costs incurred due to replacement or repair of items outside of an IES approved facility are the responsibility of the buyer and not covered under warranty. Transportation costs to and from service center are the responsibility of the buyer/customer. IES can supply you with the service center location in your area by contacting Duracell Generators customer support at the number below.

For warranty service, find the nearest Authorized Service Dealer by calling: 888-980-4938.

This warranty specifically excludes the following; failure of parts due to damage caused by accident, fire, flood, windstorm, acts of God, applications not approved by IES in writing, corrosion caused by chemicals, use of replacement parts which do not conform to manufacturer's specifications, damage related to rodent and/or insect infestation, and damage caused by vandalism. Additional exclusions: loss of running time, inconvenience, loss of income, or loss of use, including any implied warranty of merchantability of fitness for a specific use. Also, outdoor power equipment needs periodic parts and service to perform well, and this warranty does not cover instances when normal use has exhausted the life of a component or the engine.

Warranty does not cover items subject to normal wear such as tires, receptacles or any part subject to direct physical contact by the public. This warranty does not cover any personal injury or damage to surrounding property caused by failure of any part. Repair or replacement of parts does not extend the warranty period.

THIS WARRANTY IS IN LIEU OF ANY OTHER WARRANTY EXPRESSED OR IMPLIED AND INNOVATIVE ENERGY SOLUTIONS CORP. ASSUMES NO OTHER RESPONSIBILITY OR LIABILITY OUTSIDE THAT EXPRESSED WITHIN THIS WARRANTY.

THERE IS NO OTHER EXPRESSED WARRANTY. ANY AND ALL IMPLIED WARRANTIES ARE EXCLUDED. LIABILITY FOR CONSEQUENTIAL DAMAGES UNDER ANY AND ALL WARRANTIES ARE EXCLUDED TO THE EXTENT EXCLUSION IS PERMITTED BY LAW.

Please fill in the following information and have it on hand when you call in a warranty claim.

Customer Number:

Date of Purchase:

Serial Number:

Model Number:

DURACELL[®]

Customer Service 1-888-980-4938

www.DuracellGenerators.com

© 2014 Duracell, a division of The Gillette Company, Bethel, CT 06801 USA

DURACELL is a registered trademark of The Gillette Company, used under license. All rights reserved.