

Serial Number \_\_\_\_\_



# GTM2000

# Owner's Manual

Rev001



# Table Of Contents

## 1.0 INTRODUCTION

|  |   |
|--|---|
| Introduction .....                     | 1 |
| About this Manual .....                | 1 |
| General Information.....               | 1 |
| Safety Information .....               | 1 |
| Safety Precautions .....               | 2 |
| Specifications .....                   | 2 |
| Safety & Warning Placard Diagram ..... | 3 |

## 2.0 PREP-ASSEMBLY

|                                    |   |
|------------------------------------|---|
| Set-up Instructions .....          | 5 |
| Assembly Tools.....                | 5 |
| <b>OxCart™</b> Assembly Parts..... | 6 |

## 3.0 ASSEMBLY

|                                      |    |
|--------------------------------------|----|
| Assembly Instructions.....           | 7  |
| Bed Frame Assembly .....             | 7  |
| Gas Spring Bracket Installation..... | 7  |
| Tow Bar Installation.....            | 8  |
| Tow Bar Bumper Installation .....    | 8  |
| Bed Latch Assembly.....              | 8  |
| Axle/Bed Frame Installation.....     | 9  |
| Gas Spring Installation .....        | 9  |
| Axles/Wheels Installation .....      | 10 |

## 4.0 **OxCart™** OPERATION

|                                  |    |
|----------------------------------|----|
| Operating Instructions.....      | 11 |
| Operation Safety .....           | 11 |
| Using your <b>OxCart™</b> .....  | 11 |
| Rear Dump Function.....          | 11 |
| Side Dump Function .....         | 11 |
| Bed Latch .....                  | 12 |
| Maintenance .....                | 12 |
| Obtaining Spare Parts.....       | 12 |
| Clean-Up.....                    | 12 |
| Warranty .....                   | 13 |
| Warranty Registration Card ..... | 13 |
| Contact Information.....         | 14 |



## Introduction

Congratulations on purchasing one of the finest manufactured project carts on the market today! If this is your first **OxCart™** product, you will not be disappointed. If you have previously owned **OxCart™** products, you will find the same high quality and dependability you have come to expect.

### About this Manual

The purpose of this manual is to inform the owner and/or operators of the **OxCart™** to safely operate the equipment, and bring attention to possible hazards. It also contains important information regarding assembly, set-up, operation, and maintenance. It is the owner/operator's responsibility to ensure anyone who uses the **OxCart™** or operates the tow vehicle understands all safety warnings. If you do not understand any items in this manual, please contact us at [info@OxCart.com](mailto:info@OxCart.com). Keep the manual available for reference wherever the project cart is to be used.

#### NOTICE

In this manual the **OxCart™** is commonly referred to as “project cart”, “cart”, or “trailer”.

### General Information

Illustrations in this manual might show details or components that may not be the same as your project cart. Continuing improvements to the design may have caused changes that are not reflected in the manual. The information in this document is subject to change without notice.

The content in this publication is based on information available at the time of publication, and may be changed at any time. Contact us at [info@OxCart.com](mailto:info@OxCart.com) to obtain the latest revision of this publication.

### Safety Information

The following safety symbols and signal words will be used throughout this manual and on the product; for your safety and the safety of others, please become familiar with their meaning and heed all warnings.



The “Safety Alert Symbol” shown above is used throughout this publication to indicate a potential personal injury hazard. Provided instructions must be followed to reduce the possibility of personal injury and/or property damage.

The “Safety Alert Symbol” will be followed by a signal word such as “DANGER”, “WARNING”, or “CAUTION” to indicate the probability or severity of harm that will result from not following the safety message. ANSI publications provide an explanation indicating the probability of death or injury.

#### ⚠ DANGER

**DANGER:** Signal word identifying a hazard if not avoided, could result in serious injury or death.

#### ⚠ WARNING

**WARNING:** Signal word identifying a hazard if not avoided, could result in serious injury or property damage.

#### ⚠ CAUTION

**CAUTION:** Signal word identifying possible hazardous situation if not avoided could result in minor or moderate injury or property damage.

#### NOTICE

**NOTICE:** Identifies operations that may cause product damage, and will be followed by a message that explains how to avoid causing product damage or potential premature failure.

## Safety Precautions

The warnings in this manual and safety placards on the product are not all inclusive. If a tool, procedure, work method, or operating technique is used that is not specifically recommended by **OxCart™** in this manual, the operator is responsible for personal safety and those in the vicinity of the equipment. Ensure the product will not be damaged due to operation, lubrication, maintenance, or repair procedures.

### ⚠ WARNING

When replacement parts are required for this product, **OxCart™** recommends using parts with equivalent specifications including, but not limited to, physical dimensions, type, strength and material. Failure to heed this warning can lead to premature failures, product damage, personal injury or death.

- Read and understand owner's manual before using any **OxCart™** product.
- Anyone operating the project cart or tow vehicle should be thoroughly familiar with its safe operating procedures. Keep all people, especially children, away from the cart while in use.
- Never use the project cart or operate a tow vehicle while under the influence of alcohol, drugs, or medications.
- The **OxCart™** has been designed to be attached to a tow vehicle, and should not be used for anything other than its intended purpose.
- Stay clear of moving parts while operating the dump function of the cart.

| Model                     | Empty Weight        | Bed Max. Capacity     |
|---------------------------|---------------------|-----------------------|
| <b>OxCart™</b><br>GTM2000 | 71 lb.<br>(32.2 kg) | 750 lb.<br>(340.0 kg) |

- Refer to vehicle manufacturer's specifications to ensure load capacity is not exceeded.
- Always check axles and tires before towing the **OxCart™**.
- Never attempt to ride in the cart.
- Always ensure cotter pins are used as recommended to secure each retainer pin and axles.

- Avoid breathing dust produced while dumping material from the cart. Dust may contain harmful particles and could cause serious health problems.
- Do not use the cart near combustible materials or to transport said materials.
- Always know the location of nearest first aid kit, and emergency personnel phone numbers in case of emergency.

### ⚠ CAUTION

Failure to obey the following safety instructions could result in MINOR or MODERATE INJURY.

- Inspect all fasteners, bolts and welds for nicks, cracks, cuts, damage, wear, or looseness before each use.
- Always wear safe apparel, including gloves when operating the project cart.
- Do not use the project cart as a step-stool device, or with accessories or attachments not recommended by **OxCart™**, as damage to property or injury may occur.

## Specifications

|                                   |   |
|-----------------------------------|---|
| <b>Model:</b>                     | GTM2000   |
| <b>Maximum Load:</b>              | 750 lb. (340 kg)                                |
| <b>Maximum Towing Speed:</b>      | 8 mph (12 kph)                                  |
| <b>Bed Capacity (Heep):</b>       | 12 cubic feet                                   |
| <b>Maximum Tongue Weight:</b>     | 70 lb. (32 kg)                                  |
| <b>Tire Size:</b>                 | 15 x 6.00-6                                     |
| <b>Wheel Bushing Size (I.D.):</b> | .75 in (1.91 cm)                                |
| <b>Tire Inflation Pressure:</b>   | See Tire Manufacturer<br>For Suggested Pressure |

## Safety & Warning Placard Diagram

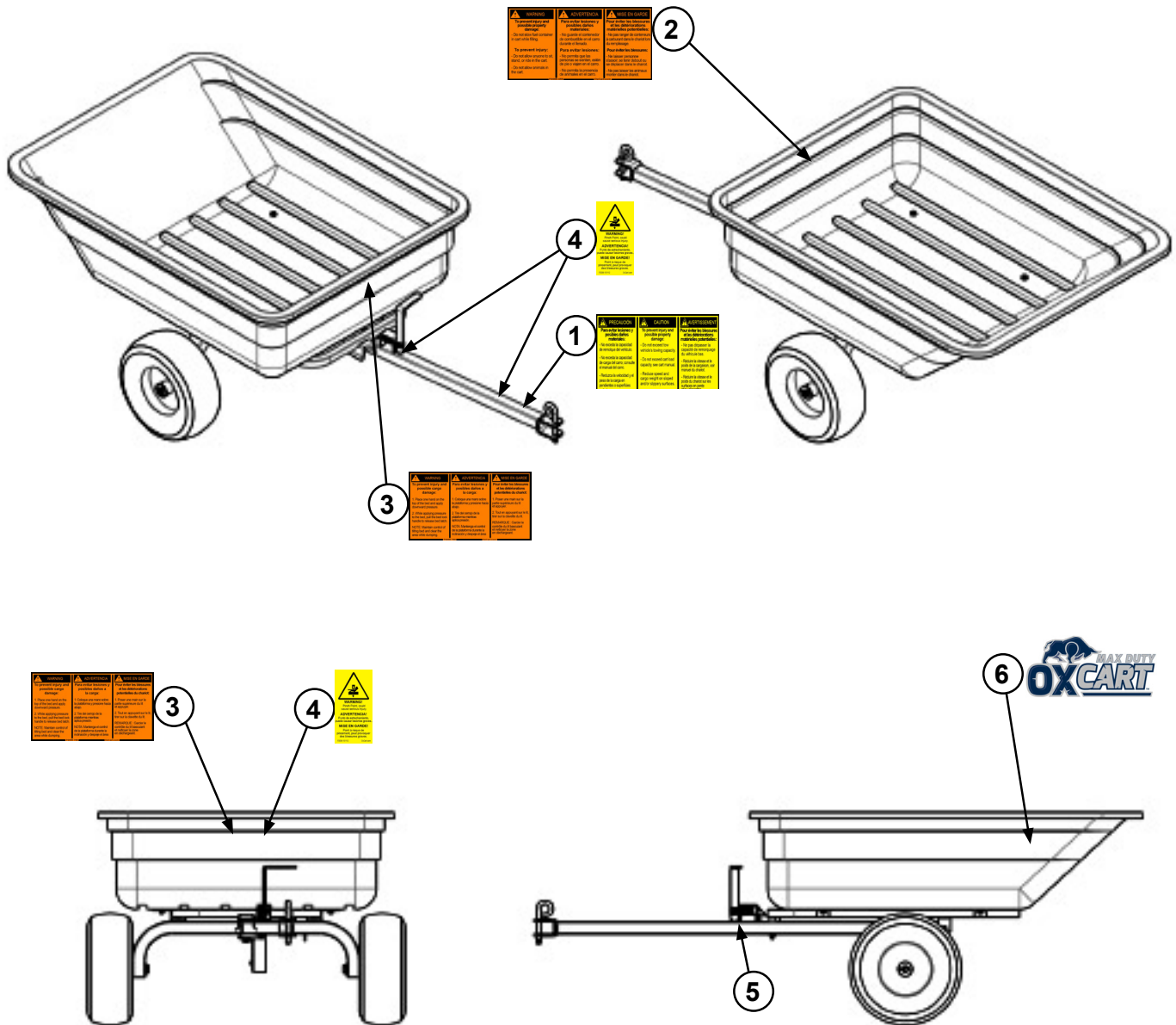

| ITEM | PART NUMBER  | DESCRIPTION                     | QTY |
|------|--------------|---------------------------------|-----|
| 1    | P2000-123    | CAUTION - Tow Warning (English) | 1   |
| 2    | P2000-456    | WARNING - Bed Warning (English) | 1   |
| 3    | P2000-789    | WARNING - Dump Instruction      | 1   |
| 4    | P2000-101112 | WARNING - Pinch Warning         | 3   |
| 5    | P2000-9      | Product I.D. Tag                | 1   |
| 6    | P2000-OC     | OxCart™ Decal                   | 2   |

### NOTICE

Replace any missing or damaged warning placards by calling 1-800-936-3340.





## Set-up Instructions

Before use, the **OxCart™** may have to be unpacked and parts inventoried. The cart assembly parts are shipped in a box which weighs 71 lb. (32.2 kg). Enlist help of others, and use safe lifting practices when moving the product while in box. *Refer to Figure 2.1*

### WARNING

Use a dolly, furniture mover, or cart when moving the box to the assembly area. Do not attempt to lift more than capable. Practice safe lifting techniques.

Remove all parts from the shipping box and inspect each component to verify there are no missing or damaged pieces before beginning installation.

The **OxCart™** is equipped with a tow bar (2), bed frame (6), axle frame (1), two wheels (19), gas spring bracket (4), gas spring (15), bed (17), and a blister card. *Refer to Figure 2.1* for parts and *Figure 2.3* for hardware references.

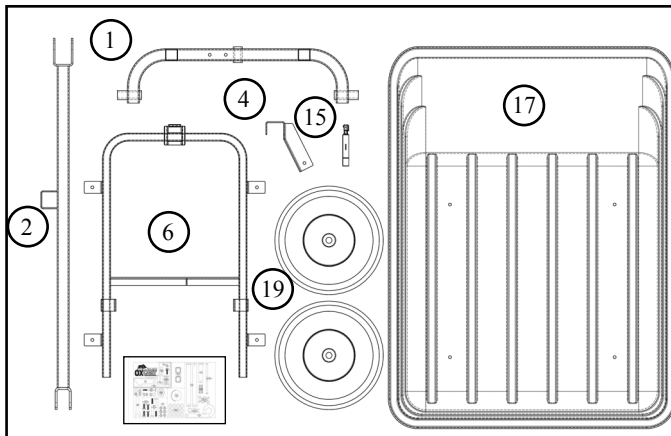

Figure 2.1 - Shipping Box Contents

The **OxCart™** utilizes a blister card which is shipped with the cart. The blister card contains hardware used during cart assembly. Use the blister card to identify hardware referenced in the assembly instructions. *Refer to Figure 2.2*

### NOTICE

A 13mm open-end wrench is provided to aid cart assembly, and is included in the Blister Card.

## Assembly Tools

- Phillips Head Screw Driver
- Pliers
- 1/4" & 5/16" Wrench
- 13mm Gas Spring Wrench (Included)

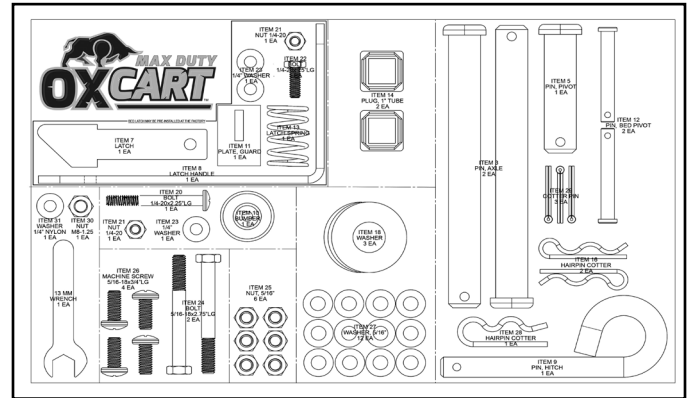

Figure 2.2 - Blister Card

| ITEM | PART NUMBER | DESCRIPTION               | QTY |
|------|-------------|---------------------------|-----|
| 3    | GTM2017     | Pin, Axle                 | 2   |
| 5    | GTM2035     | Pin, Pivot                | 1   |
| 7    | GTM2051     | Latch                     | 1   |
| 8    | GTM2052     | Handle, Latch             | 1   |
| 9    | GTM2044     | Pin, Hitch                | 1   |
| 10   | GTM2071     | Bed Bumper                | 1   |
| 11   | GTM2072     | Plate, Guard              | 1   |
| 12   | GTM2021     | Pin, Bed Hinge            | 2   |
| 13   | GTM2045     | Spring, Latch             | 1   |
| 14   | GTM2070     | Plug, 1 Inch Tube         | 2   |
| 16   | GTM2022     | Hairpin Cotter, Bed Hinge | 2   |
| 18   | GTM2018     | Washer, Axle              | 3   |
| 20   | GTM2026     | Bolt, 1/4-20 x 2.25" LG   | 1   |
| 21   | GTM2024     | Nut, 1/4-20               | 2   |
| 22   | GTM2027     | Bolt, 1/4-20 x .75" LG    | 1   |
| 23   | GTM2033     | Washer, 1/4"              | 3   |
| 24   | GTM2023     | Bolt, 5/16-18 x 2.75" LG  | 2   |
| 25   | GTM2028     | Nut, 5/16-18              | 6   |
| 26   | GTM2025     | Bolt, 5/16-18 x .75" LG   | 4   |
| 27   | GTM2036     | Washer, 5/16"             | 12  |
| 28   | GTM2030     | Hairpin Cotter, Hitch Pin | 1   |
| 29   | GTM2019     | Cotter Pin                | 3   |
| 30   | GTM2031     | Nut, M8-1.25              | 1   |
| 31   | GTM2034     | Washer, 1/4" Nylon        | 1   |

Figure 2.3 - Hardware Schedule (Table)

## OxCart™ Assembly Parts

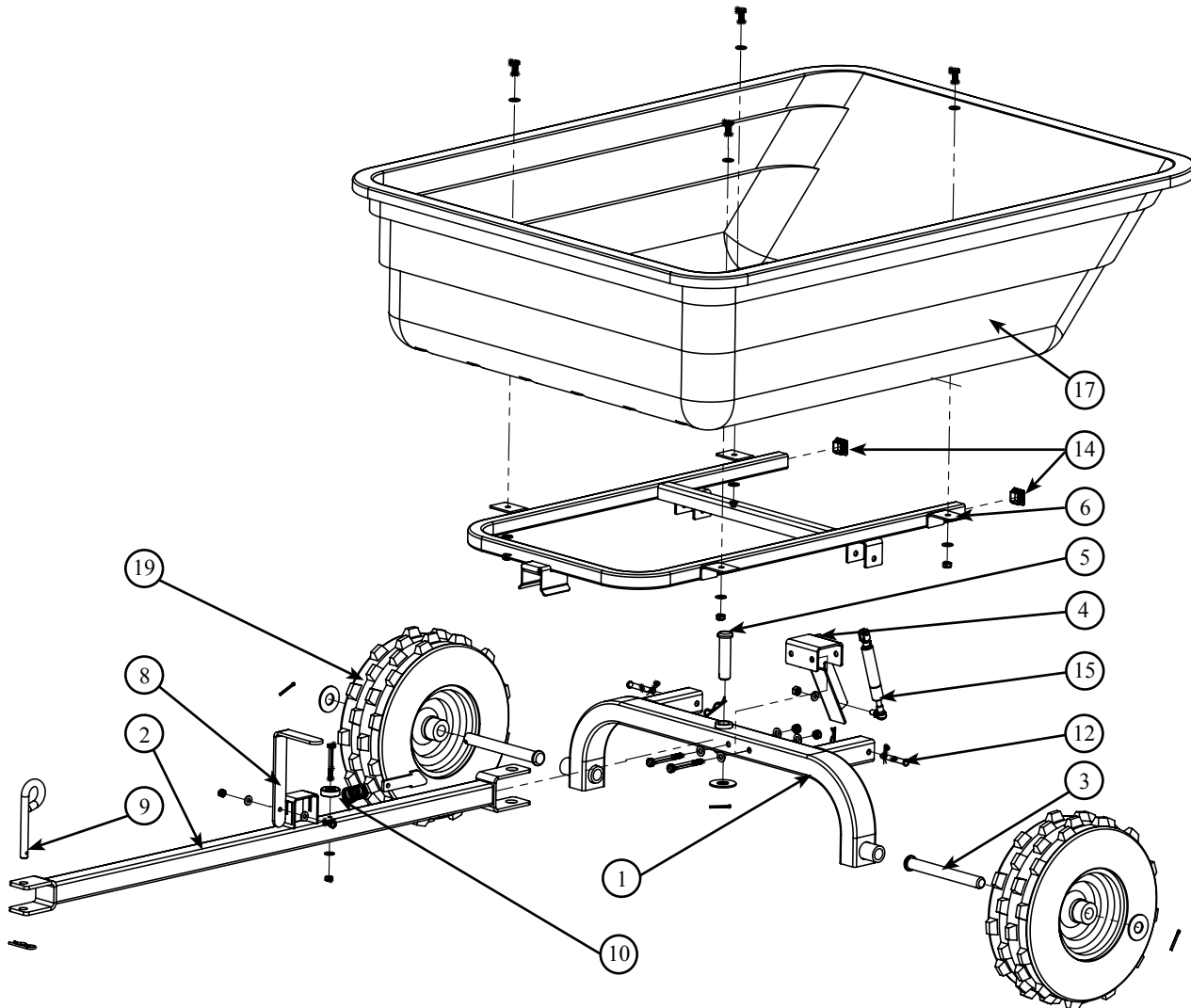

Figure 2.4 - Assembly Parts

| ITEM | PART NUMBER | DESCRIPTION        | QTY |
|------|-------------|--------------------|-----|
| 1    | GTM2002     | Axle Support Frame | 1   |
| 2    | GTM2006     | Tow Bar            | 1   |
| 3    | GTM2017     | Pin, Axle          | 2   |
| 4    | GTM2067     | Gas Spring Bracket | 1   |
| 5    | GTM2035     | Pin, Pivot         | 1   |
| 6    | GTM2009     | Bed Frame          | 1   |
| 8    | GTM2052     | Bed Latch Handle   | 1   |

| ITEM | PART NUMBER | DESCRIPTION    | QTY |
|------|-------------|----------------|-----|
| 9    | GTM2044     | Pin, Hitch     | 1   |
| 10   | GTM2071     | Bed Bumper     | 1   |
| 12   | GTM2021     | Bed Hinge Pin  | 2   |
| 14   | GTM2070     | 1" Tube Plug   | 2   |
| 15   | GTM2029     | Gas Spring     | 1   |
| 17   | GTM2020     | Bed            | 1   |
| 19   | GTM2001     | Wheel Assembly | 2   |

# Assembly Instructions

## Bed Frame Assembly

### NOTICE

It is best to use the aid of another person during the installation.

1. Insert tube plugs (14) into the ends of the bed frame tube (6) openings. Refer to Figure 3.1

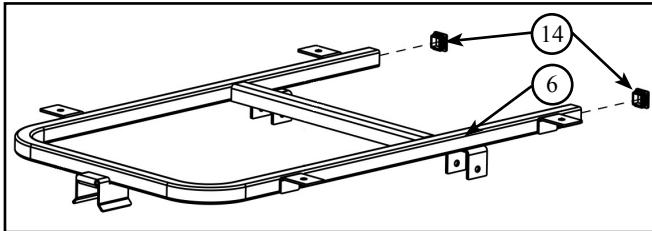

Figure 3.1 - Gas Spring Bracket

2. Have an assistant stand the bed on its side. Refer to Figure 3.2

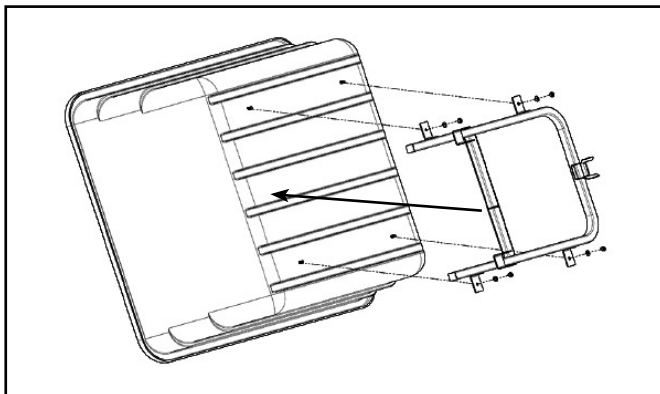

Figure 3.2 - Bed Frame Assembly

3. Have the assistant hold a bolt (26) and washer (27) through the inside of the bed (17). Refer to Figure 3.3
4. Align the bed frame with the bottom-side of the bed and the inserted bolt. Refer to Figure 3.3
5. Install a washer (27) and nut (25), hand tighten. Refer to Figure 3.3
6. Repeat steps 2 through 5 to secure the remaining bed frame mounting bolts.
7. Using a 5/16" wrench and Phillips head screwdriver, tighten the nuts once all bolts have been started and the bed frame is aligned.

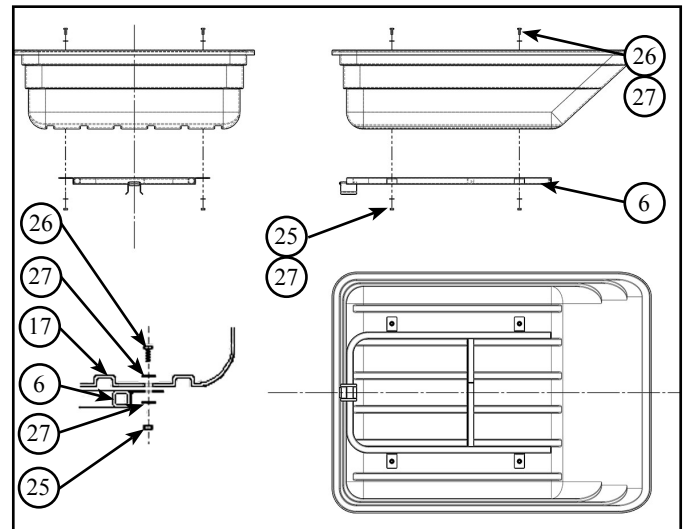

Figure 3.3 - Bed Frame Alignment

## Gas Spring Bracket Installation

1. Slide the gas spring bracket (4) over the top of the axle frame (1), align with bolt holes in the axle frame. Refer to Figure 3.4

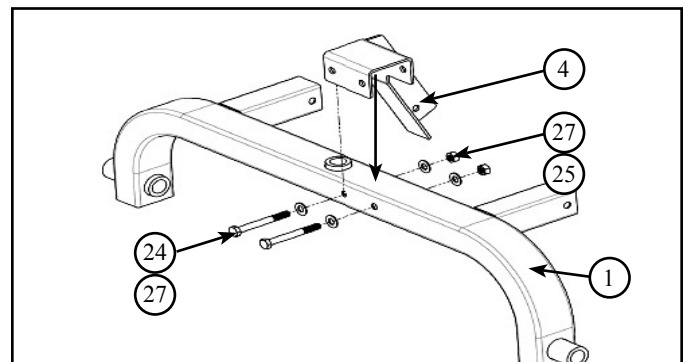

Figure 3.4 - Gas Spring Bracket

2. Ensure gas spring bracket flange is located on the same side as the bed frame mounts. Insert bolts (24) and washers (27). Refer to Figure 3.3
3. Install washers (27) and tighten nuts (25). Do NOT over-tighten nuts. Refer to Figure 3.5

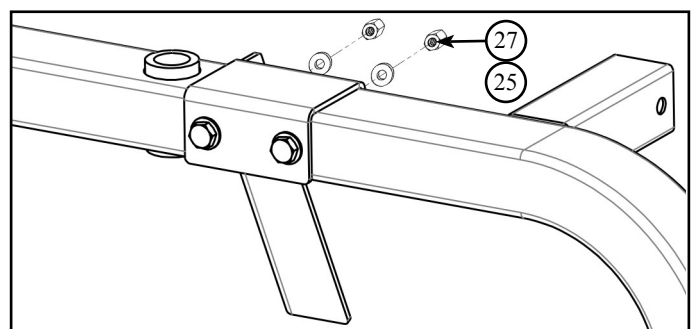

Figure 3.5 - Gas Spring Bracket

## Tow Bar Installation

1. Slide the tow bar (2) onto axle frame (1), align with pivot hole. *Refer to Figure 3.6*

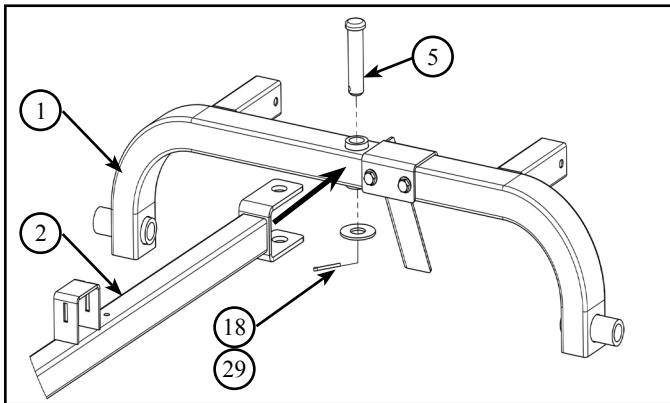

Figure 3.6 - Tow Bar/Axle Frame

2. Insert pivot pin (5) through the top of the tow bar and axle frame. *Refer to Figure 3.6*
3. Secure pivot pin with washer (18) and cotterpin (29), use pliers to bend the cotter pin ends to secure. *Refer to Figure 3.6*

## Tow Bar Bumper Installation

4. Insert bolt (20) through bumper (10) and tow bar. *Refer to Figure 3.7*

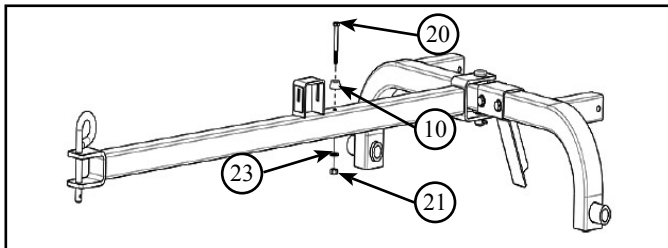

Figure 3.7 - Tow Bar/Bed Bumper

5. Install washer (23) and tighten lock nut (21), do NOT over-tighten. *Refer to Figure 3.7*

## Bed Latch Assembly

The bed latch assembly may be pre-installed at the factory, if assembled on your project cart, move onto the next section.

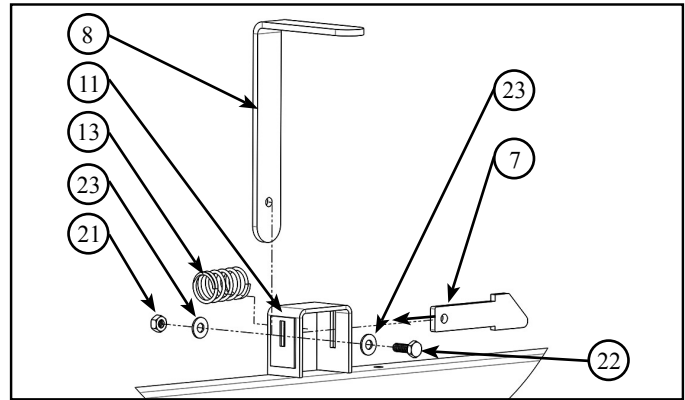

Figure 3.8 - Bed Latch Assembly Parts

6. Position spring (13) inside the bed latch bracket, and insert latch (7) through the back-side of the slot, spring, and the front-side slot. *Refer to Figure 3.9*

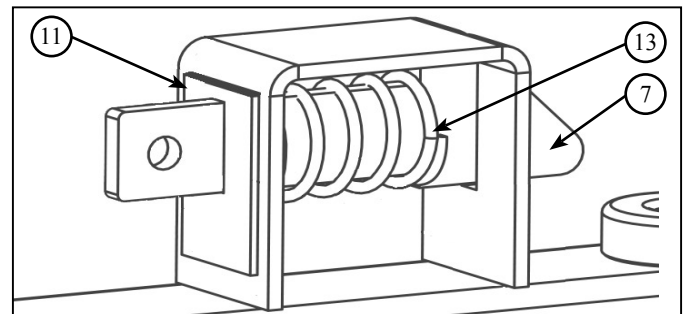

Figure 3.9 - Bed Latch Spring

7. Slide guard plate (11) onto latch. *Refer to Figure 3.9*
8. Apply pressure to the latch bar to expose the latch hole. *Refer to Figure 3.10*
9. Align latch handle (8) with latch hole and insert bolt (22) and washer (23). *Refer to Figure 3.10*

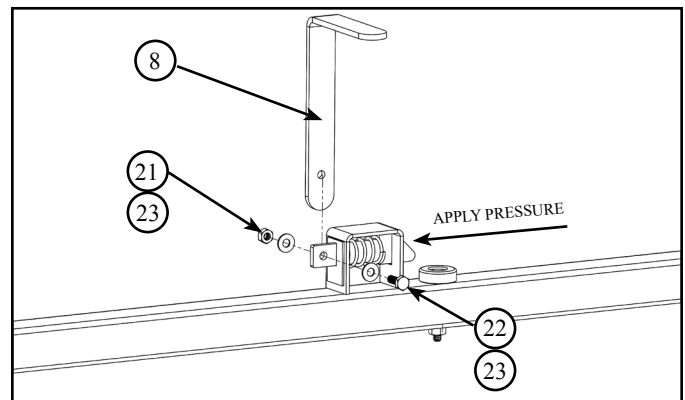

Figure 3.10 - Bed Latch Hole Alignment

10. Install a washer (23) and nut (21) onto bolt, do NOT over-tighten. *Refer to Figure 3.11*

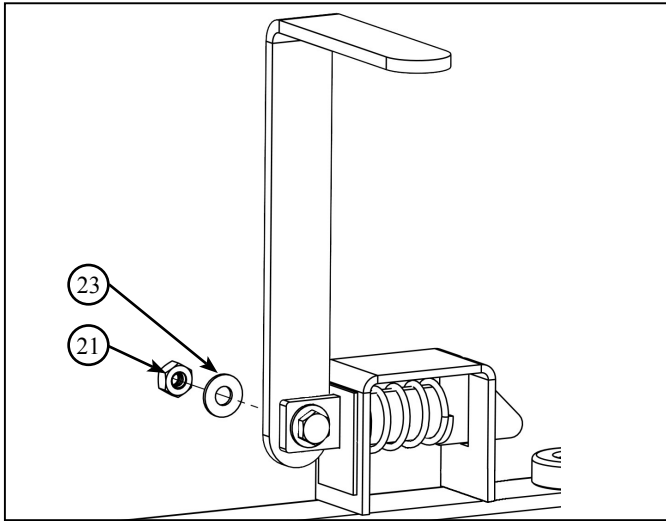

Figure 3.11 - Bed Latch Handle

## Axle/Bed Frame Installation

Position the bed with open-side down on the ground. Turn frame upside-down for the following procedures.

### ⚠ CAUTION

Pinch Hazard: Ensure area between bed and cart frame is clear of obstructions and the frame is supported during assembly.

### ⚠ WARNING

The axle frame and tow bar will swing if not secured, and could cause injury or property damage.

1. Align axle frame (1) with bed frame (6) pivot holes. *Refer to Figure 3.12*

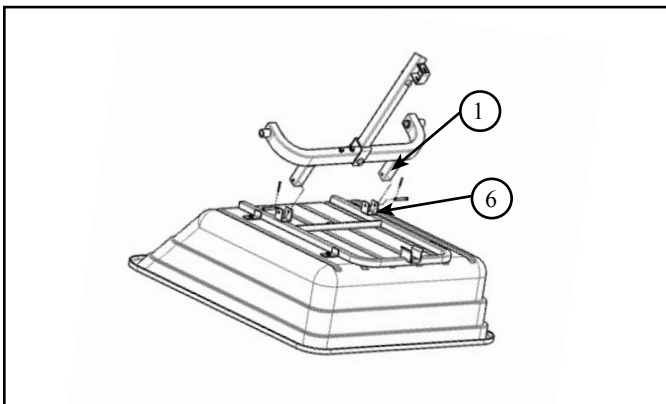

Figure 3.12- Align Axle Frame With Bed Frame

2. Insert hinge pin (12) through each pivot bracket and secure each with a hairpin cotter (16). *Refer to Figure 3.13*

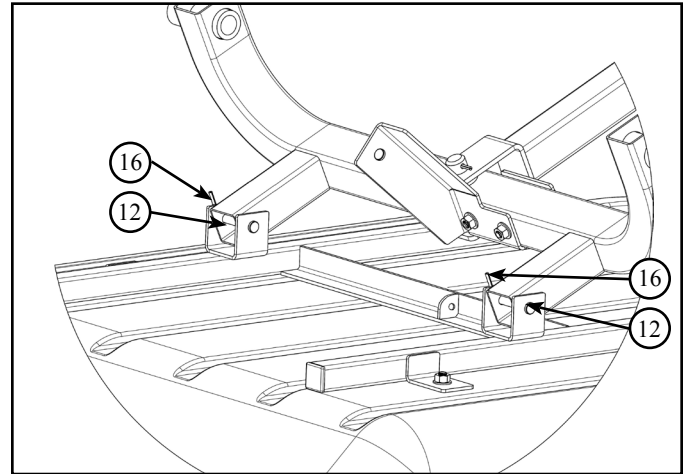

Figure 3.13- Secure Axle Frame to Bed Frame

## Gas Spring Installation

Before installation, it is necessary to remove the quick connect clip/pin. *Refer to Figure 3.14*

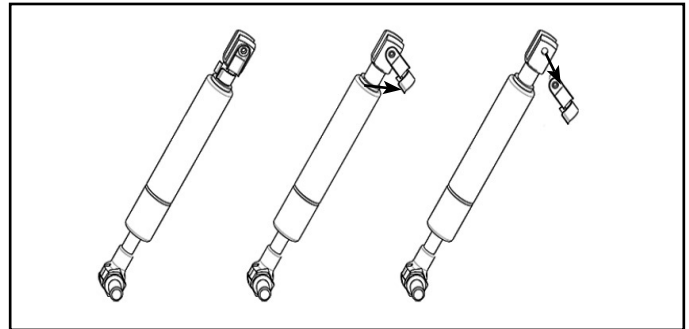

Figure 3.14 - Gas Spring Quick Connect Clip/Pin

1. Align fork end of the gas spring (15) with bed frame (6) mount hole, secure with quick connect clip/pin. *Refer to Figure 3.15*

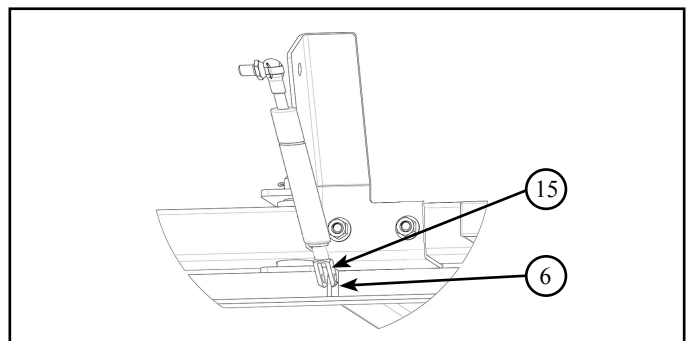

Figure 3.15 - Gas Spring / Bed Frame



## NOTICE

The two ends of the gas spring must be oriented in the same direction for installation. Twist the gas spring until bolt is aligned with the gas spring bracket mounting hole.

## WARNING

The tow bar will swing if not secured, and could cause injury or property damage.

## WARNING

The gas spring has a high pressure rating. Do not puncture casing.

- Align the gas spring with gas spring bracket mounting hole. The tow bar may have to be raised or lowered to aid in alignment.
- Insert the bolt end of the gas spring (15) into the gas spring bracket (4) hole. Refer to Figure 3.16
- Install nylon washer (31) and lock nut (30) onto gas spring bolt (15). Refer to Figure 3.16
- Using the 13mm wrench provided, hold the gas spring bolt while tightening the lock nut.

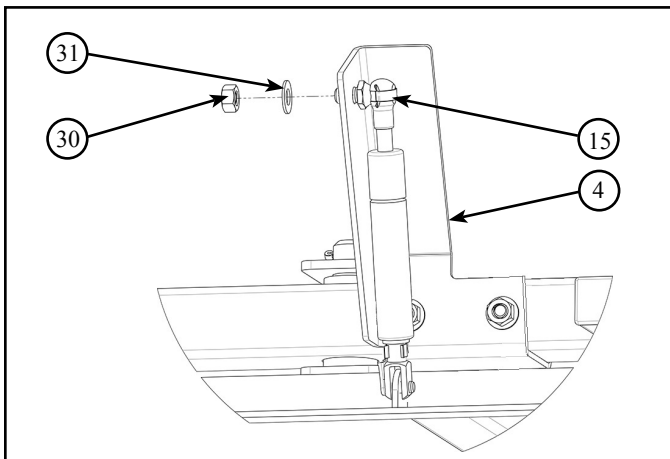

Figure 3.16 - Gas Spring Bracket

## CAUTION

Ensure the tow bar is supported during this process.

## Axles/Wheels Installation

Before proceeding, secure the tow bar to the bed. Carefully align and lower the tow bar into the receiver until the tow bar latches to the bed frame. Refer to Figure 3.17

## CAUTION

Pinch Hazard: Ensure area between bed and tow bar is clear of obstructions and that all personnel are at a safe distance when securing frame.

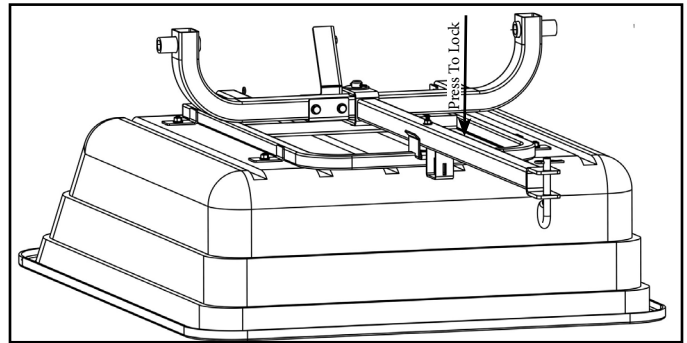

Figure 3.17 - Secure Tow Bar To Bed Frame

- Insert the axles (3) through the axle bushings. Refer to Figure 3.18

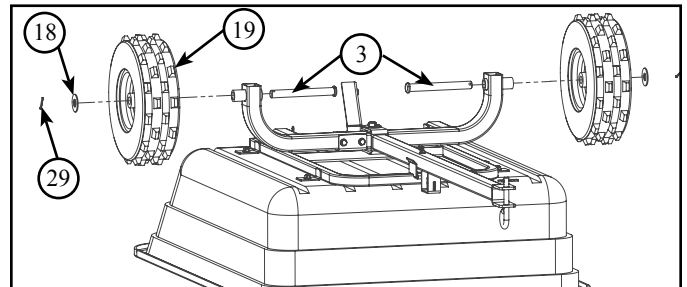

Figure 3.18 - Axle/Wheel Assembly

- Install wheels (19) onto axles (3). Refer to Figure 3.18
- Secure each wheel with a washer (18), and cotter pin (29) on each axle, use pliers to bend the cotter pin ends to secure. Refer to Figure 3.18

## Operating Instructions

### ⚠ WARNING

Load shift occurs during transportation, never disconnect the project cart from the tow vehicle when the cart is loaded.

## Operation Safety

The **OxCart™** has been designed and built as a dump cart to be attached to a tow vehicle, and should not be used unless the tow bar is securely fastened to the tow vehicle.

- Read and fully understand the tow vehicle operator's manual before using the project cart.
- Tow the cart at a low speed when traveling on uneven grading and unpredictable surface materials.
- Do not tow the cart with the bed in the raised position.
- Verify, and never exceed tow vehicles' towing capacity. Heavy loads may cause the tow vehicle brakes to fail.
- **OxCart™** (s) are not DOT approved and should not be used on public roads or highways.
- Maximum towing speed should not exceed 8 mph.

## Using your **OxCart™**

- Do not exceed the recommended cart capacity rate of 750 lb. (340.0 kg).
- Only use the **OxCart™** while it is attached to a tow vehicle.
- Do not overfill cart bed, contents shift during transportation and could become unstable.
- Do not make sharp turns causing contact between tow vehicle rear wheels and the project cart tow bar.
- Maintain safe travel distances from steep hills, holes and ditches.
- Do not step over or straddle the tow bar.

## Rear Dump Function

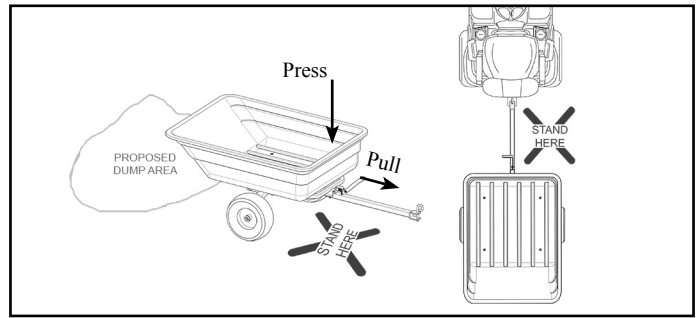

Figure 4.1 - Rear Dump Function

Always ensure the dump area and project cart are clear of obstruction and personnel, during the dumping process.

### ⚠ WARNING

Ensure the dump area and cart are clear of obstruction and personnel, during the dumping process.

1. Release the bed latch by applying constant downward pressure to the top edge of the bed with one hand.
2. While applying downward pressure to the bed, move the bed latch handle towards the tow vehicle until the bed latch releases.
3. Once the bed latch releases, use both hands to maintain control, slowly dump-out bed contents. *Refer to Figure 4.1*

### ⚠ WARNING

Ensure the bed is secure to the tow bar before moving tow vehicle. The axle must be secure while in-tow.

## Side Dump Function

Always ensure the dump area and project cart are clear of obstruction and personnel, during the dumping process.

1. Face the bed latch handle in the same direction as the proposed dump area.

**⚠ CAUTION**

To prevent injury, before releasing the bed latch, ensure to establish a position that does not require stepping over the tow bar to dump in desired location, side.

2. Release the bed latch by applying downward pressure on the bed with one hand, while moving the bed latch handle toward the tow vehicle until the bed releases from the tow bar.
3. Once the bed latch releases, use both hands to maintain control of the rotate and dump process. *Refer to Figure 4.2*

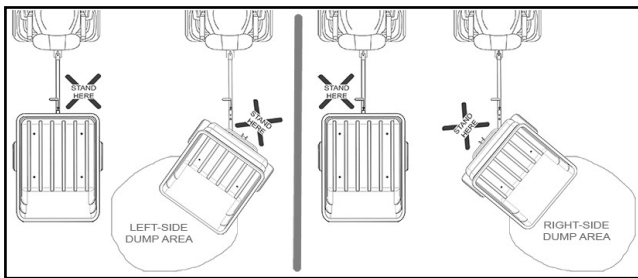

**Figure 4.2 - Side Dump Function**

4. Slowly dump-out bed contents.

**⚠ WARNING**

Ensure the bed is secure to the tow bar before moving tow vehicle. The axle must be secure while in-tow.

**Bed Latch**

It is recommended to never travel with the bed in the upright position, unlatched. Always secure the bed onto the cart frame before moving the **OxCart™**.

1. After unloading bed contents; inspect area under the bed and around the cart frame area, remove any obstructions.
2. With two hands, rotate bed to center on cart.

**⚠ CAUTION**

**Pinch Hazard:** Ensure area between bed and cart frame is clear of obstructions and all personnel are at a safe distance when securing bed.

3. With two hands, grip the top edge of the bed and with constant downward force, push bed until bed latches to tow-bar. *Refer to Figure 4.3*

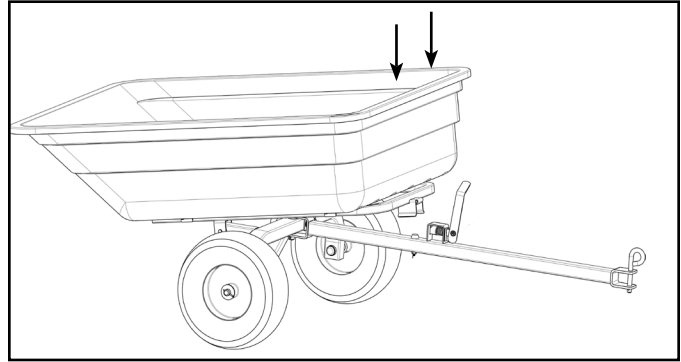

**Figure 4.3 - Bed Latch**

**Maintenance**

1. Check and lubricate wheel hubs as needed. Grease fittings are located on the inside of each wheel hub.
2. If rust becomes apparent, sand lightly and touch-up with enamel paint.
3. Check all welds. If a cracked weld is found, do not operate the **OxCart™** until the damage is repaired by qualified personnel.
4. Check and tighten any loose bolts.
5. Check tire pressure regularly. Proper inflation prolongs tire life. Refer to tire sidewall for manufacturer's inflation recommendation.

**Obtaining Spare Parts**

Spare parts for the **OxCart™** may be obtained by the following procedure:

1. Record the information from the ID tag. See page 3 for tag location.
2. Using the parts reference table in this manual, record the part number and description.
3. Visit [OxCart.com](http://OxCart.com) to locate the nearest retailer, or phone at 1-800-936-3340 with the information recorded.

**Clean-Up**

- For maximum longevity, thoroughly clean the **OxCart™** after each day's use. Do not allow build-up of materials.
- Grease axle fittings as needed.
- If possible, when not in use, store the **OxCart™** out of inclement weather and direct sun exposure.



## Limited Warranty

Warranty provisions for the **OxCart™** are handled directly through the manufacturer. To register your **OxCart™** product for warranty, all information below must be completed and sent with a copy of your purchase receipt to the address below within thirty (30) days of purchase. Or, email your warranty information and digital copy of your receipt to the email address below. Or, complete the warranty registration on-line at [OxCart.com](http://OxCart.com).

If within one (1) year from the date of purchase the product fails, due to defect in material or workmanship, **OxCart™** will repair or replace the product free of charge. However, this warranty does not apply to parts and hardware failure caused by normal wear and tear. Nor is **OxCart™** responsible for damage to cart, property, or personal safety if the **OxCart™** is used in any way other than expressed in the owners manual. The owner is responsible for damage to the cart if any tool or accessory is used with the cart that is not recommended by **OxCart™**. This warranty applies only to the original purchaser.

Please provide a copy of your receipt for any warranty related issues.

Effective August 30, 2013

To register your cart online, visit [OxCart.com/Warranty](http://OxCart.com/Warranty)  
**OxCart™** Products, P.O. Box 782167, Wichita, Kansas 67278  
 Email: [warranty@OxCart.com](mailto:warranty@OxCart.com)

Cut along line and mail to the address below

## Warranty Registration Card

Please take a moment to completely fill-out your warranty registration card.

Name: \_\_\_\_\_

Address: \_\_\_\_\_

City: \_\_\_\_\_ State: \_\_\_\_\_ Zip: \_\_\_\_\_ Phone: (\_\_\_\_) \_\_\_\_\_ Email: \_\_\_\_\_

Purchased Date: \_\_\_\_\_ Model Number \_\_\_\_\_ Serial Number \_\_\_\_\_

1. Where did you hear about **OxCart™**? (Check One)

☐ Friend ☐ Website ☐ Online Ad ☐ News Article

2. What influenced you to buy? (Check One)

☐ Load Capacity ☐ Upcoming Project ☐ Innovative Design ☐ Easy To Unload

3. On what types of projects will you use your **OxCart™**? \_\_\_\_\_

4. Would you like to be featured in **OxCart™** marketing materials? If yes, please provide the best way to reach you. Contact Information: \_\_\_\_\_

5. What brand/model tractor will you be operating with your **OxCart™**? \_\_\_\_\_

6. What types of accessories would you like to see for your **OxCart™**? \_\_\_\_\_

Once you have completed the warranty registration card, please cut along the dashed line and mail to the address above. **Thank you!**



# OxCart™ Products LLC

P.O. Box 782167  
Wichita, Kansas 67278  
warranty@OxCart.com  
info@OxCart.com  
1-800-936-3340

Carry More, Lift Less with our innovative Power Assist Lift, Side Dump Capabilities, and High Quality Tires (Run Flat, optional). **OxCart™** is your project solution to previously underperforming dump carts.

Visit our webpage for valuable project solutions, **OxCart™** accessories, and to download a digital version of this manual.



Join us on-line to learn more about **OxCart™** Products  
#OxCartProducts

