

ZERO BARROW

Patented



WWW.FOREST-MASTER.COM

No Strain, Self Levelling Barrow



IMPORTANT: Read this manual fully before assembly and use and observe all safety rules and operating instructions



Contents

| | |
|-------------------------|----|
| Technical Specification | 2 |
| Exploded Diagram | 3 |
| Parts List | 4 |
| Assembly | 5 |
| Operation | 11 |
| Safety | 14 |
| Warranty | 15 |

Technical Specification

| | | |
|------------------------|-----------------|-----------|
| Length | 1400 mm | 55 ins |
| Width | 750 mm | 29.5 ins |
| Height (excluding tub) | 650 mm | 26 ins |
| Weight (excluding tub) | 14 kg | 31 lbs |
| Wheel Size | 4.80 / 4.00 x 8 | |
| Max Tyre Pressure | 2.5 bar | 36 p.s.i. |



WWW.FOREST-MASTER.COM

Exploded Diagram

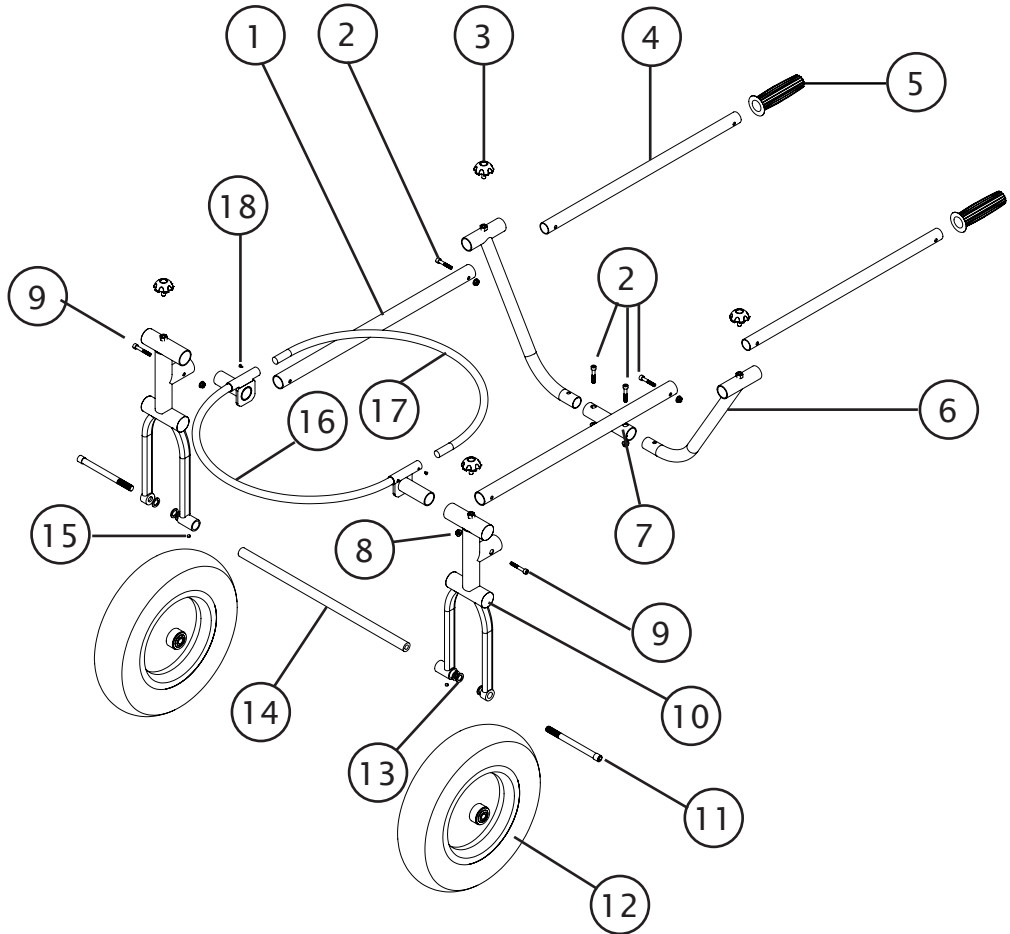



| Item | Description | Qty |
|------|-------------------------|-----|
| 1 | 30 mm handle tube | 2 |
| 2 | M6 x 35 cap head bolt | 4 |
| 3 | M8 hand wheel | 4 |
| 4 | 25 mm handle tube | 2 |
| 5 | Hand grip | 2 |
| 6 | Brace | 2 |
| 7 | Sleeve | 1 |
| 8 | M6 flange nut | 6 |
| 9 | M6 x 40 cap head bolt | 2 |
| 10 | Fork | 2 |
| 11 | M12 axle bolt | 2 |
| 12 | Wheel | 2 |
| 13 | M12 plain washer | 6 |
| 14 | Axle | 1 |
| 15 | M6 x 5 grub screw | 2 |
| 16 | Lifting ring front part | 1 |
| 17 | Lifting ring rear part | 1 |
| 18 | Self tapping screw | 2 |



STEP 1:

Place a wheel (12) between the legs of a fork (10). Insert an axle bolt (11) through the outside (narrower) guide and through a plain washer (13) placed between the outside guide and the wheel. Locate a second plain washer (13) between the wheel and the inside guide then insert the axle bolt all the way through. Note that the outside guide is recessed so that the bolt head is a flush fit.

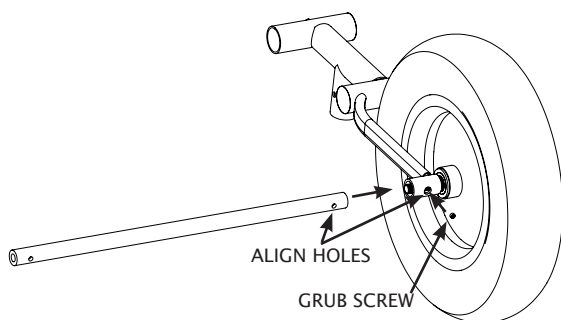
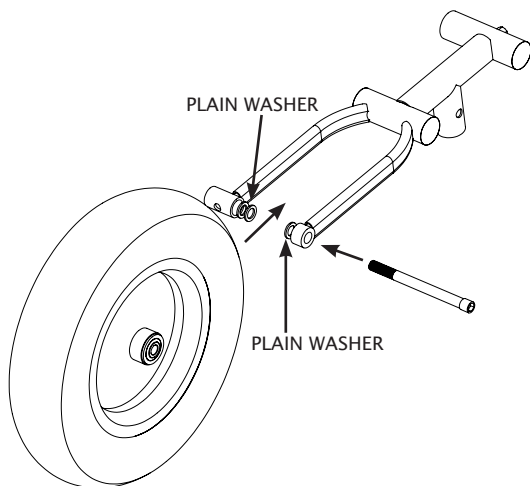

STEP 2:

Insert one end of the axle (14) into the inner guide and locate on the axle bolt. Screw in but do not fully tighten the axle bolt using an Allen key. Ensure that the hole in the end of the axle aligns with the hole in the underside of the inner guide then while holding the axle steady, tighten the bolt.



IMPORTANT: The barrow is supplied with 6 plain washers as depending on the fit of the wheel, it may be necessary to fit 2 washers on one side to space the wheel correctly.

STEP 3:

Repeat the procedure for the second wheel, ensuring that plain washers are used each side of the wheel to correctly space it and that the grub screw is correctly located and tightened.

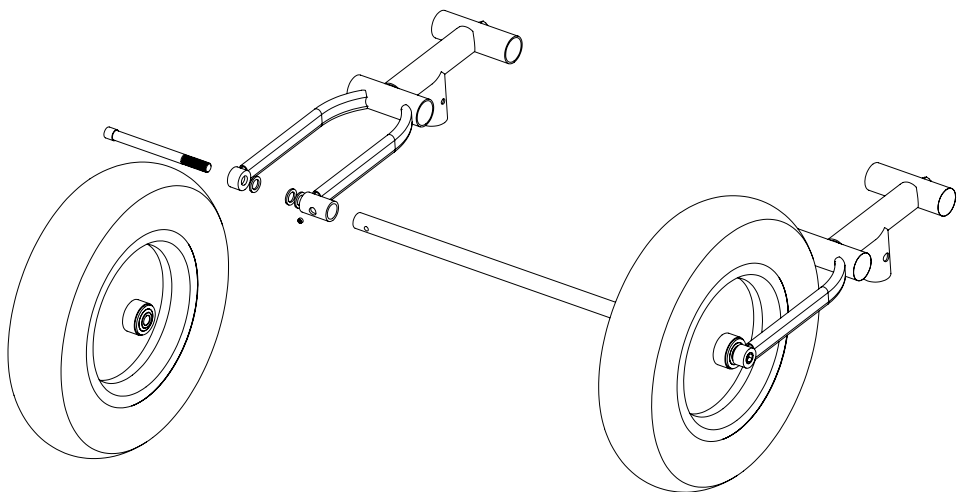

STEP 4:

Insert a 30 mm diameter handle (1) into the locating tube on the back of one of the forks. Insert an M6 x 40 cap head bolt (9) into the larger hole in the outside of the locating tube and through the locating tube and the handle tube. Secure with an M6 flange nut (8). Note that the head of the cap head bolt should sit inside the large hole in the locating tube. See note on Page 7.

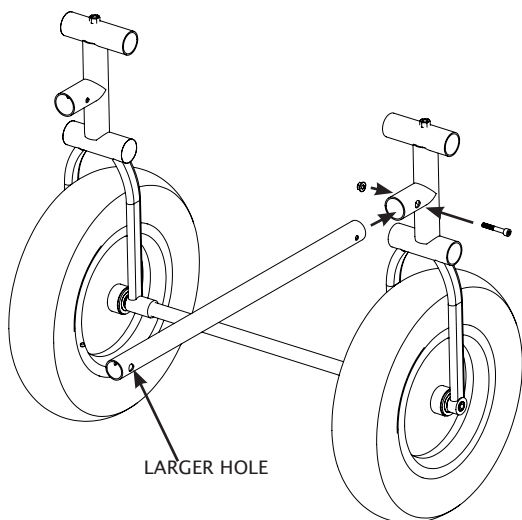



STEP 5:

Repeat for the other 30 mm handle tube and fork.

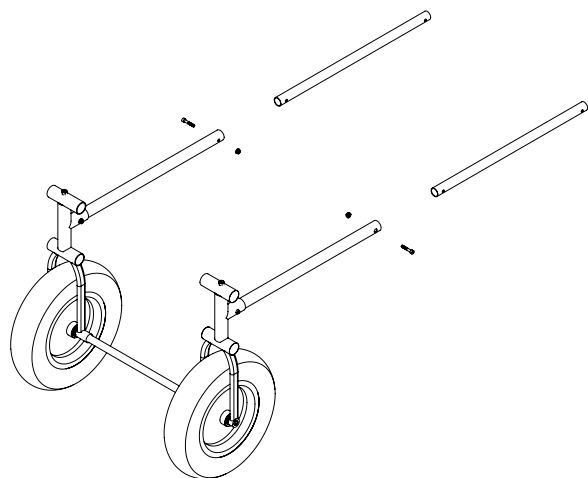
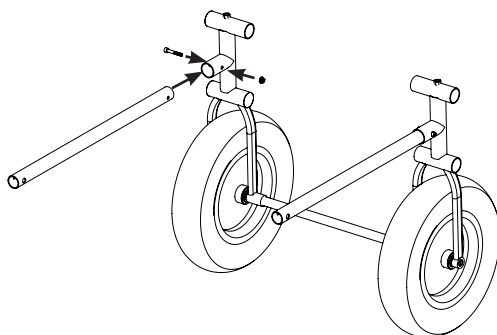

STEP 6

Insert each of the 25 mm diameter handle tubes (4) into a 30 mm diameter handle and secure with an M6 x 35 mm cap head bolt (2) and an M6 nut (8). Note that the head of the bolt should sit inside the larger hole in the 30 mm handle tube.



NOTE: One end of the 30 mm handle tube has two equal diameter holes and the other has a large and small hole. In Steps 4 & 5 you must insert the end with two equal diameter holes into the mount on the fork. In addition, the larger of the two holes at the other end should be oriented to the outside of the handle.

STEP 7:

Insert a brace (6) into one end of the sleeve (7) and secure with an M6 x 35 cap head bolt (2) and M6 nut (8). Note the larger diameter holes in the sleeve should be uppermost and the head of the bolt should sit in the large hole. Repeat for the second brace.

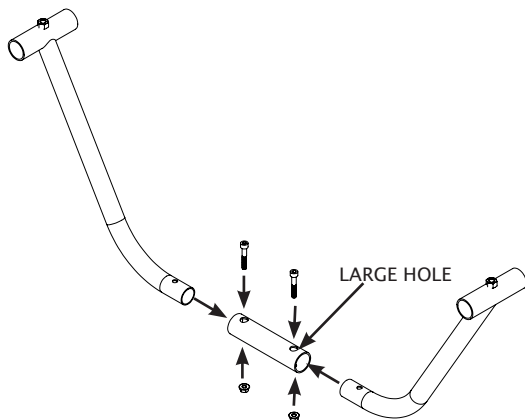

STEP 8:

Slide the brace top tubes over both 25 mm handle tubes so that the brace rests against the ends of the 30 mm handle tubes. Insert an M8 handwheel (3) into the nut on top of each brace top tube and tighten to secure the brace.

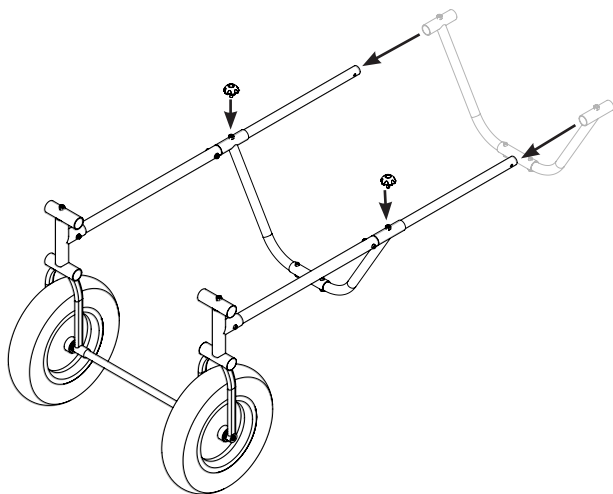



STEP 9:

If your barrow was purchased without a tub or the tub was packaged separately then it will be necessary to join the two halves of the lifting ring. Insert the ends of the ring half (17) into the connecting tubes of ring half (16) and secure with the self tapping screws (18). The ends of the half ring (17) are pre-drilled for the screws.

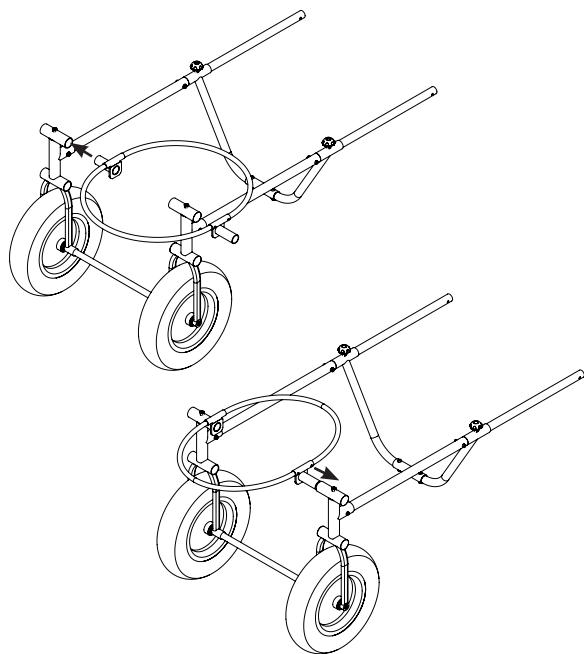
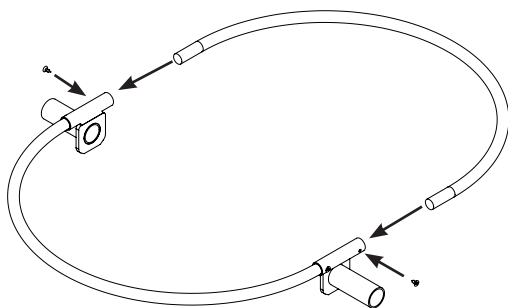

STEP 10:

Insert one of the lifting ring pivot tubes into one of the fork top tubes then compress the ring and insert the opposite pivot tube into the opposite fork top tube.



STEP 11:

Screw the two remaining M8 handwheels (3) into the nuts on the top of the fork top tubes but do not tighten.

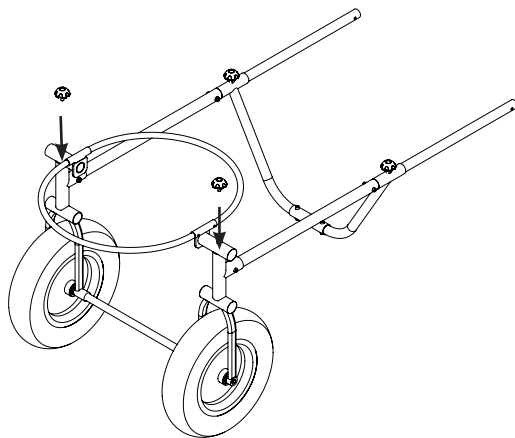

STEP 12:

Push a handgrip (5) over the end of each of the 25 mm handle tubes. Ensure they are fully located on the handles.

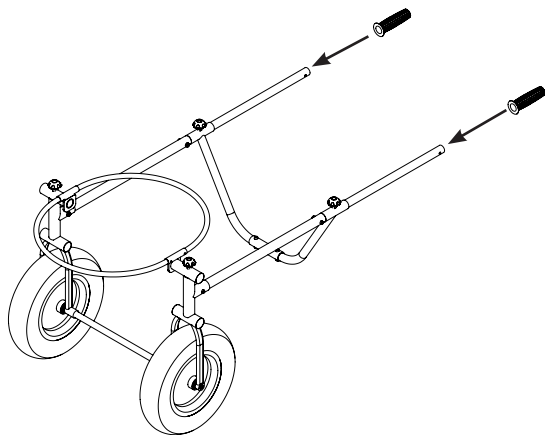

Lifting a tub

STEP 1:

Position the barrow behind the tub with the handles tipped forward so that the ring sits on the ground.



STEP 2:

Drag or lift the tub over the front of the ring so it sits within the ring.



NOTE: The M8 handwheels on top of the forks should be loose so that the lifting ring is free to pivot.



Step 3:

Place a foot on the axle and pull back on the handles.



Step 4:

Lower the handles so that the tub is over the axle.



NOTE: To lower a tub to the ground, place a foot on the axle and lift the handles up and forward to lower the ring to the ground. It is important to place a foot on the axle to avoid the barrow moving backwards into the user. To remove the tub simply lift or drag it clear of the ring.

Emptying a Tub

It is possible to empty the tub without removing it from the barrow, in a number of different ways depending on which is most convenient to the user.

For lighter loads, the tub can be tipped from behind while still holding the barrow.



With heavier loads the brace can be rested on the ground and the tub tipped from the side using two hands.

It is also possible to tighten the hand wheels on top of the forks, to stop the tub pivoting. The tub can then be emptied by raising the handles as in a conventional barrow, this however is generally the least convenient.



Loading the Tub

Generally the tub is loaded on the ground ready positioned within the ring or then lifted or dragged into the ring as shown on Page 11. However the tub can be filled when already raised in the ring. It is advisable when loading liquids this way to lock the tub by tightening the handwheels however the handwheels must be loosened before raising the handles.

IMPORTANT SAFETY INFORMATION

Please read these instructions carefully. Note the safe operational requirements, warnings & cautions. Use the product correctly and with care for the purpose for which it is intended. Failure to do so may cause damage and/or personal injury and will invalidate the warranty. Please keep these instructions safe for future use.

Before using the barrow always check that all nuts and bolts are secure and that the barrow is not damaged.

Check that the tyres are evenly inflated to a suitable pressure for the load you are carrying. Do not exceed the maximum pressure of 2.5 bar / 36 p.s.i.



Warranty

This product carries a one (1) year limited warranty against defects in workmanship and materials. Should this product become defective within the stated warranty period, return it to the store with proof of purchase, and it will be replaced or repaired free of charge.

Should this product become defective, contact the store where it was purchased and either replacement parts will be issued, it will be repaired or it will be replaced free of charge.

**IMPORTANT: NO RESPONSIBILITY IS ACCEPTED FOR
INCORRECT USE OF THIS PRODUCT.**



WWW.FOREST-MASTER.COM

NOTE: It is our policy to continually improve products and as such we reserve the right to alter data, specifications and component parts without prior notice.

Manufactured under license for Forest Master Limited.

Registered Office:

Forest Master Ltd, Industry Road, Heaton, Newcastle Upon Tyne,
NE6 5XB, United Kingdom.

Tel: +44 191 2966939

email: info@forest-master.com - web: www.forest-master.com