

Operator's Manual

CRAFTSMAN®

BRUSH GUARD

Model No. 486.246283



DO NOT RETURN TO STORE
For Missing Parts or Assembly
Questions Call 1-866-576-8388

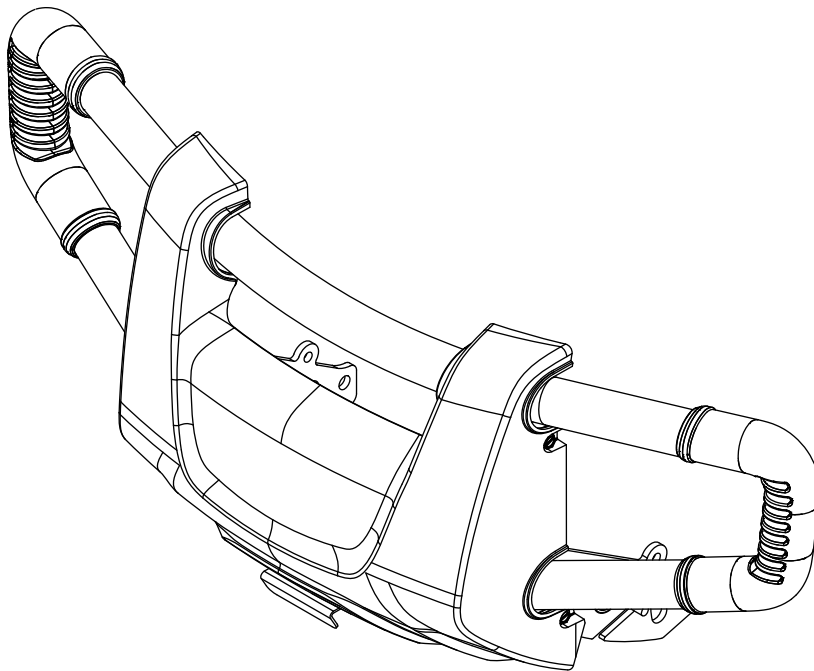

CAUTION:

Before using this product, read this manual and follow all Safety Rules and Operating Instructions.

- Safety
- Assembly
- Operation
- Maintenance
- Parts

Sears, Roebuck and Co., Hoffman Estates, IL 60179 U.S.A.
www.sears.com/craftsman

TABLE OF CONTENTS

WARRANTY	2	ASSEMBLY	4
SAFETY RULES.....	2	OPERATION.....	5
CARTON CONTENTS.....	3	REPAIR PARTS	6
FULL SIZE HARDWARE CHART	3	PARTS ORDERING/SERVICE	BACK PAGE

WARRANTY

CRAFTSMAN FULL WARRANTY

When operated and maintained according to all supplied instructions, if this Craftsman product fails due to a defect in material or workmanship within one year from the date of purchase, return it to any Sears store or other Craftsman outlet in the United States for free replacement.

This warranty applies for only 90 days from the date of purchase if this product is ever used for commercial or rental purposes.

This warranty does not include items considered to be expendable parts that can wear out from normal use within the warranty period.

This warranty gives you specific legal rights, and you may also have other rights which vary from state to state.

Sears, Roebuck and Co., Hoffman Estates, IL 60179

DO NOT RETURN TO STORE for Missing Parts or Assembly Questions

Call 1-866-576-8388 Attachment Hotline

SAFETY RULES

Any power equipment can cause injury if operated improperly or if the user does not understand how to operate the equipment. Exercise caution at all times when using power equipment.

- Refer to your tractor owners manual for "**Rules For Safe Operation**".



Look for this symbol to point out important safety precautions. It means — **Attention!! Become alert!! Your safety is involved.**

The model number and serial numbers will be found on a decal attached to the Brush Guard.

You should record both the serial number and the date of purchase and keep in a safe place for future reference.

MODEL NUMBER: 486.246283

SERIAL NUMBER: _____

DATE OF PURCHASE: _____

CARTON CONTENTS

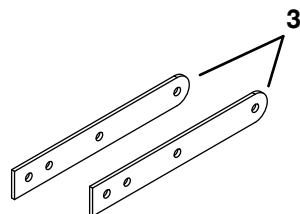
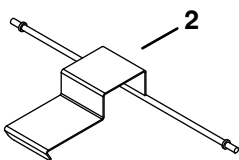
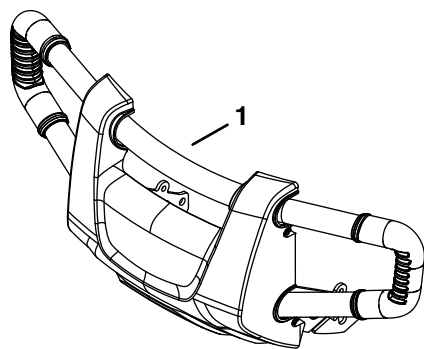

REF	QTY	DESCRIPTION
1	1	Brush Guard
2	1	Latch
3	2	Frame Brace

FULL SIZE HARDWARE CHART

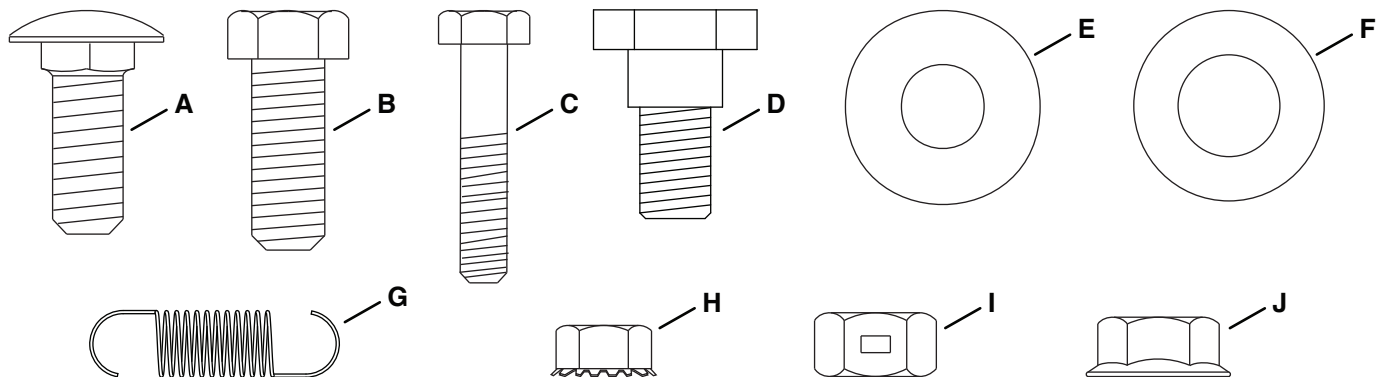

REF	QTY	PART NO.	DESCRIPTION	REF	QTY	PART NO.	DESCRIPTION
A	4	43350	Carriage Bolt, 3/8-16 x 1"	F	2	R19171616	Washer, 1/2" (.5312 x 1 x .0598)
B	2	43001	Hex Bolt, 3/8-16 x 1"	G	2	42117	Spring
C	2	1509-90	Hex Bolt, 1/4-20 x 1-1/4"	H	4	46978	Hex Nut (SIMS), 1/4"
D	2	48106	Shoulder Bolt, 3/8-16	I	4	43082	Lock Nut, 3/8"
E	2	43070	Washer, 3/8"	J	4	44072	Whizlock Nut, 3/8"

ASSEMBLY

TOOLS REQUIRED FOR ASSEMBLY

- (2) 7/16" Wrenches
- (2) 9/16" Wrenches
- (1) 3/4" Wrench



CAUTION! Muffler is hot! Allow engine to cool down before proceeding with bumper installation.

STEP 1: (SEE FIGURE 1)

- Slide the ends of the latch into the slots located on the bottom of the bumper.
- Push the front of the latch down past plastic shroud of bumper. Latch will be under the shroud and should appear as shown in figure 3 when assembled correctly.
- Attach one spring onto the rod on each side of the latch.

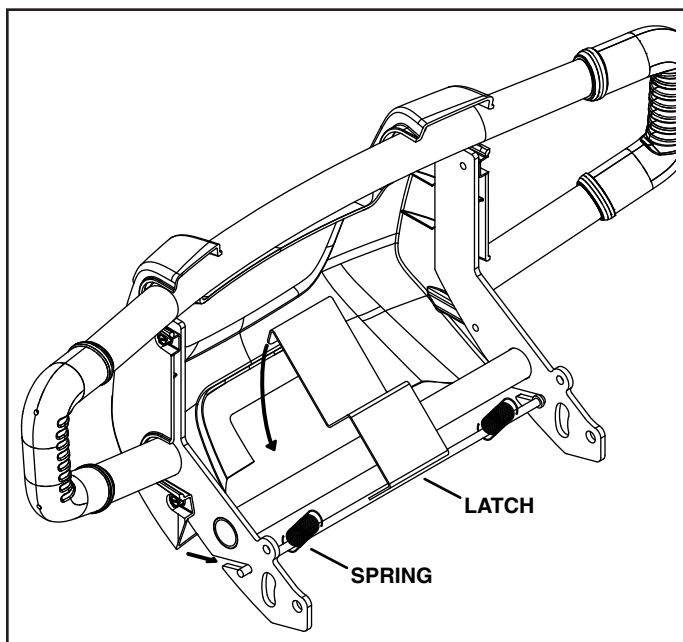

FIGURE 1

STEP 2: (SEE FIGURE 2)

- Insert 1/4 x 1-1/4" hex bolt through one of the springs.
- Assemble 1/4 x 1-1/4" hex bolt onto the bumper using two 1/4-20 hex nuts (SIMS) with end of bolt extending slightly through outside nut.
- Repeat for spring on other side.

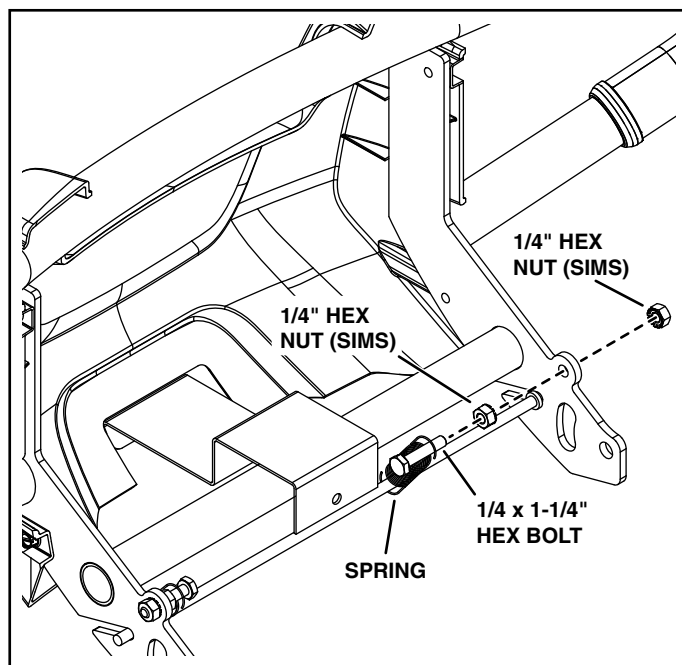

FIGURE 2

STEP 3: (SEE FIGURE 3)

- Assemble a 3/8 x 1" hex bolt, 3/8" washer, frame brace and 3/8" lock nut to the rear hole of the bumper.

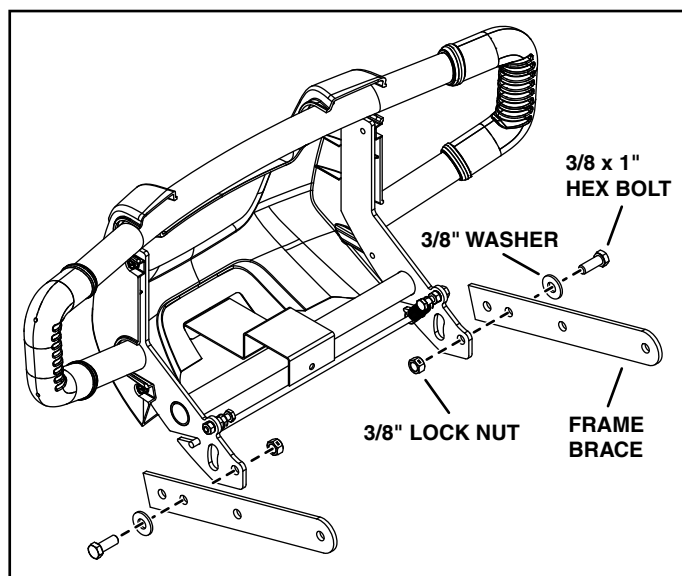

FIGURE 3

STEP 4: (SEE FIGURE 4)

- Assemble a shoulder bolt, 1/2" washer and 3/8" lock nut to the frame brace and slotted hole on each side of the bumper.

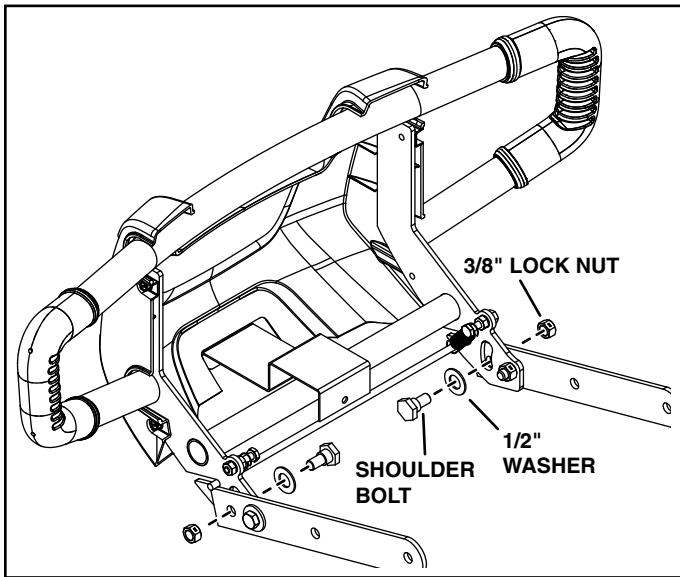

FIGURE 4

STEP 5: (SEE FIGURE 5)

- Fasten the frame braces to the tractor frame using four 3/8-16 x 1" carriage bolts and 3/8" whizlock nuts.

NOTE: Only tractor frame shown for clarity.

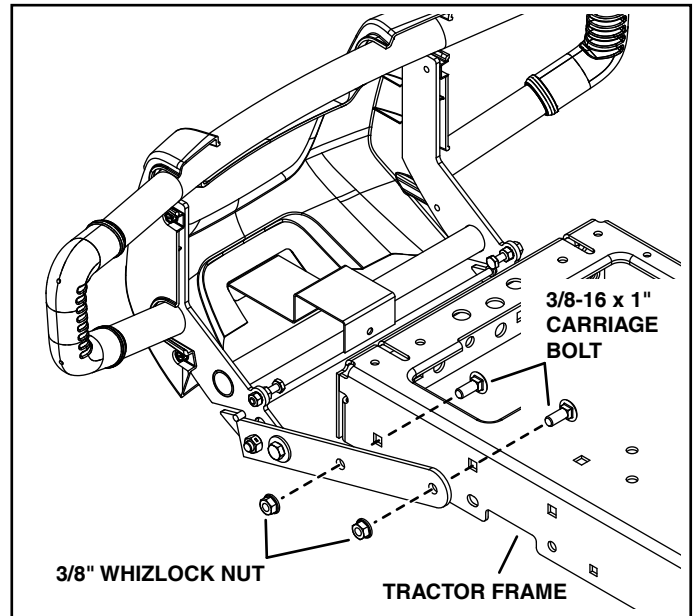

FIGURE 5

OPERATION

TILT BUMPER DOWN BEFORE RAISING TRACTOR HOOD: (SEE FIGURE 6)

- While pushing in lightly on top of bumper, pull latch under front of bumper.
- Keep latch pulled out and pull down on bumper.

LOCK BUMPER INTO UP POSITION: (SEE FIGURE 6)

- Push bumper up into position. Latch will lock bumper into place.

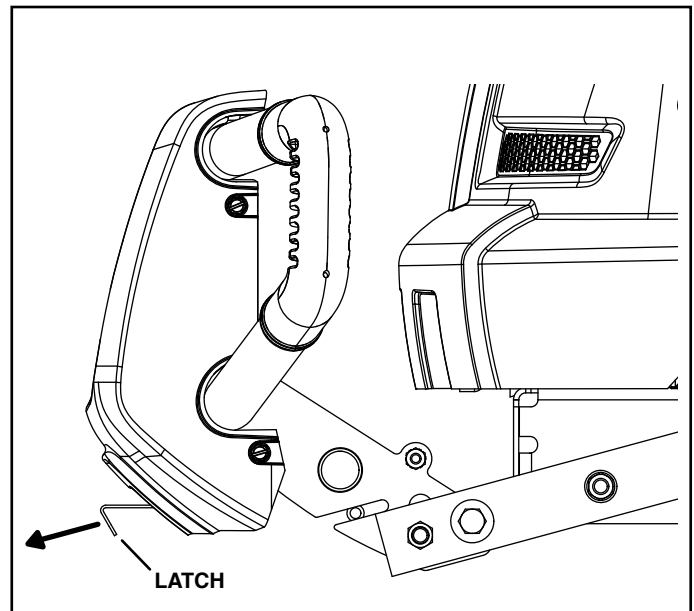
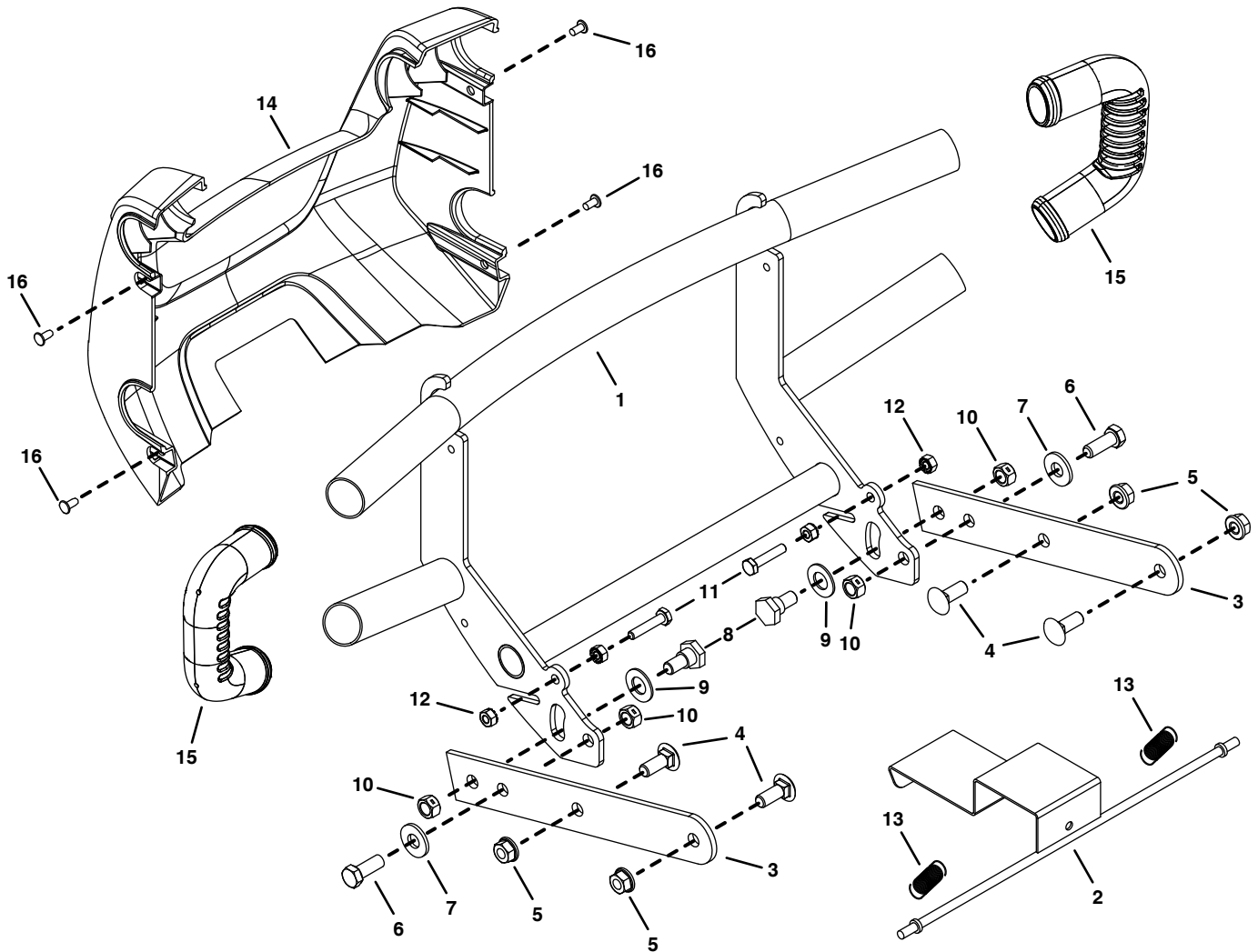

FIGURE 6

REPAIR PARTS

MODEL NO. 486.246283 BRUSH GUARD



REF	QTY	PART NO.	DESCRIPTION	REF	QTY	PART NO.	DESCRIPTION
1	1	421265	Brush Guard Assembly	10	4	43082	Lock Nut, 3/8"
2	1	66696	Latch	11	2	1509-90	Hex Bolt, 1/4-20 x 1-1/4"
3	2	26729	Frame Brace	12	4	46978	Hex Nut (SIMS), 1/4"
4	4	43350	Carriage Bolt, 3/8-16 x 1"	13	2	42117	Spring
5	4	44072	Whizlock Nut, 3/8"	14	1	422754	Shroud
6	2	43001	Hex Bolt, 3/8-16 x 1"	15	2	422752	End Cap
7	2	43070	Washer, 3/8"	16	4	C-9M5732	Rivet
8	2	48106	Shoulder Bolt, 3/8-16		1	41727	Owners Manual
9	2	R19171616	Washer, .5312 x 1 x .0598"				

CRAFTSMAN®

Product questions or problems?

1-888-331-4569

Customer Care Hot Line

**Get answers to questions, troubleshoot problems,
order parts, or schedule repair service.**

Para respuestas a preguntas o problemas, y ordenar
piezas o pedir servicio para la reparación de su equipo.

To help us help you, register your product at www.craftsman.com/registration

Para poderte ayudar mejor, registra tu producto en www.craftsman.com/registration

Join the Craftsman Club today!

CRAFTSMAN® CLUB

www.craftsman.com/signup

**Receive exclusive member benefits including special pricing and offers,
project sharing, expert advice, and SHOP YOUR WAY REWARDS!**

Como miembro exclusivo, recibe diversos beneficios como ofertas, precios especiales, proyectos nuevos, consejos de expertos y nuestro programa de puntos SHOP YOUR WAY REWARDS!