

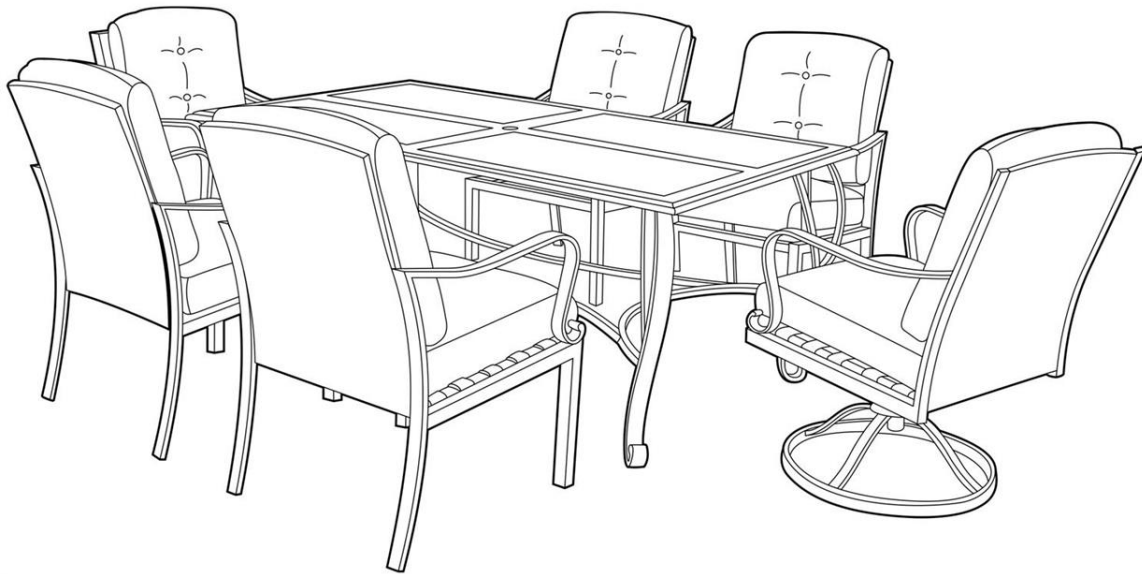

*Live life Comfortably.™*



# USE AND CARE GUIDE

## Sears Peyton 7pc Dining set

### \* Dining Table

Product Code: D71 M80905

UPC Code: 7-22938-07954-4

Date of Purchase: \_\_ / \_\_ / \_\_

La-Z-Boy® is a registered trademark of La-Z-Boy Incorporated and is used under license to BJI, Inc.

© 2015 La-Z-Boy Incorporated.

# Thank you for your purchase

---

## THANK YOU FOR YOUR PURCHASE!

We are pleased that you have chosen Sears for your outdoor furniture purchase. We hope that you enjoy the unmatched quality, comfort, and style of your new patio set. Every piece is meticulously considered all the way down to the smallest details, exclusively for you, by our world class design team. We know you have a choice when it comes to your patio furniture needs, so from our team to yours, thank you for letting us be a part of your outdoors.

## Table of Contents

---

<b>Table of Contents.....</b>	<b>2</b>
<b>Safety Information .....</b>	<b>3</b>
Set up your furniture properly.....	3
Examine your furniture .....	3
<b>Warranty .....</b>	<b>3</b>
What is covered .....	3
What is not covered .....	3
<b>Care and Maintenance .....</b>	<b>4</b>
<b>Pre-Assembly .....</b>	<b>5</b>
Planning assembly.....	5
Observe weight limits .....	5
Hardware included .....	5
Package contents .....	6
<b>Assembly Instruction .....</b>	<b>7</b>
<b>Customer Service .....</b>	<b>10</b>

## Safety Information

### SET UP YOUR FURNITURE PROPERLY

- Ensure that all parts are assembled properly and fully tightened as per the instructions.
- When placing in the desired location, ensure that all legs are resting on the same surface. You may adjust the legs levelers as required to ensure that the item stands in a rigid position.

### EXAMINE YOUR FURNITURE

- Examine occasionally to ensure that there are no loose parts. If loose parts are found, they must be retightened fully before additional use.

**WARNING:**

1. Do not crawl, stand, or sit on tile table tops.
2. Do not set or lay heavy items on tile table tops.
3. Avoid extreme hot & cold items being placed on tile table tops.



**CAUTION:** Read all of the instructions in this manual before you begin assembly. Failure to do so may result in faulty assembly and potential injury!

## Warranty

**THIS IS A RESIDENTIAL WARRANTY AND DOES NOT APPLY FOR COMMERCIAL USE.**

**7 YEARS WARRANTY FOR FRAME, 1 YEAR WARRANTY FOR RESIN WICKER AND CUSHIONS**

### WHAT IS COVERED

We warrant the frame to be free of Manufacturing defects to the original purchaser for 7 years, and resin wicker for 1 year.

### WHAT IS NOT COVERED

It remains the customer's responsibility for freight and packaging charges to and from our service center.

This warranty does not cover commercial use, hardware, acts of nature, fire, freezing and abusive use.

Discoloration or fading of the finish or fabrics as a result of chemicals or spills is not covered.

Glass table top breakage and corrosion or rusting of hardware are not covered.

In addition, purchase parts are not covered under this warranty.

## Warranty (continued)

---

Proof of purchase (dated register receipt) is required for warranty claims.

We reserve the right to make substitutions with similar merchandise, if the model in question is no longer in production.

For a copy of our full limited warranty, please contact our customer service team below.

Contact the Customer Service Team at 1-866-391-4868 or visit [www.bjifurniture.com](http://www.bjifurniture.com).

## Care and Maintenance

---

- Do not allow water to build up in frames. This will cause corrosion and possible freezing damage in cold climates.
- Use a mild soap and water for normal cleaning. DO NOT use janitorial or alcohol based cleaners. Some cleaners may be marked as natural, but some ingredients can cause discoloration or have adverse reaction to your finish.
- Rinse with clean water and dry with a soft, absorbent cloth towel.
- Cushions, slings, and/or an umbrella may be cleaned by hand with a solution of soap and water with a clean water rinse. Never machine wash as this will result in shrinking or damage. After cleaning, tip on end and allow to drip dry. Never use a commercial or home dryer to tumble dry fabric goods.
- Treat frames with liquid wax for maximum protection against UV rays and /or salty, damp air.
- Umbrella should be closed when not in use. Umbrella should be removed and stored in the event of wind, rain, hail, sleet, snow, or any other inclement weather. To prevent damage to your table, always use an umbrella base with your umbrella. Store indoors during winter months.
- Use and operation: To prolong the life of your outdoor furniture, cover when not in use. Store indoors during winter months.

# Pre-Assembly

## PLANNING ASSEMBLY

PLEASE READ COMPLETE USE AND CARE GUIDE PRIOR TO ASSEMBLY!

Identify all parts packed in the carton against the parts list. Remove all protective materials and place the parts on a nonabrasive surface to avoid scratching. It takes about 45 minutes for 3 persons to complete all the assembly.



**NOTE:** More than one person may be required to complete the assembly of this product.

## OBSERVE WEIGHT LIMITS

The recommended weight limit for each item is listed below:

- Dining Chair: 300 lbs
- Swivel Rocker: 300lbs

## HARDWARE INCLUDED



**NOTE:** Hardware not shown to actual size.



Part	Description	Quantity
AA	M6*15mm hex bolt	16
BB	M6*30mm hex bolt	4
CC	M6 washer	20
DD	M6 hex bolt cap	20
EE	Hex wrench	2

## Pre-Assembly (continued)

### PACKAGE CONTENTS

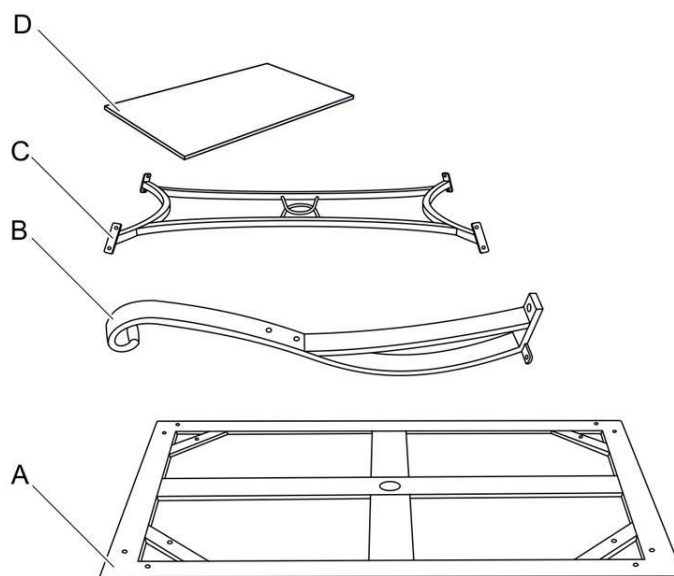

Part	Description	Quantity
A	Table rim	1
B	Table leg	4
C	Connector ring	1
D	Ceramic tile	4



### Safety Information

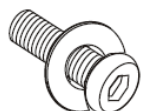

- EVERY BOLT NEEDS TO BE USED WITH A WASHER.
- DO NOT FULLY TIGHTEN BOLT UNTIL INDICATED IN **STEP 2**.

## Assembly Instruction

### 1 Attaching the table leg

- Remove the plastic clamps from the table rim (A), and remove the ceramic tile top (D) from the table rim (A), and carefully place the ceramic top (D) on a soft surface.
- Carefully place the table top upside down on a soft, flat and non-abrasive surface.
- Attach the leg (B) to the table rim (A) using hex bolt (AA) & (BB) and washers (CC).

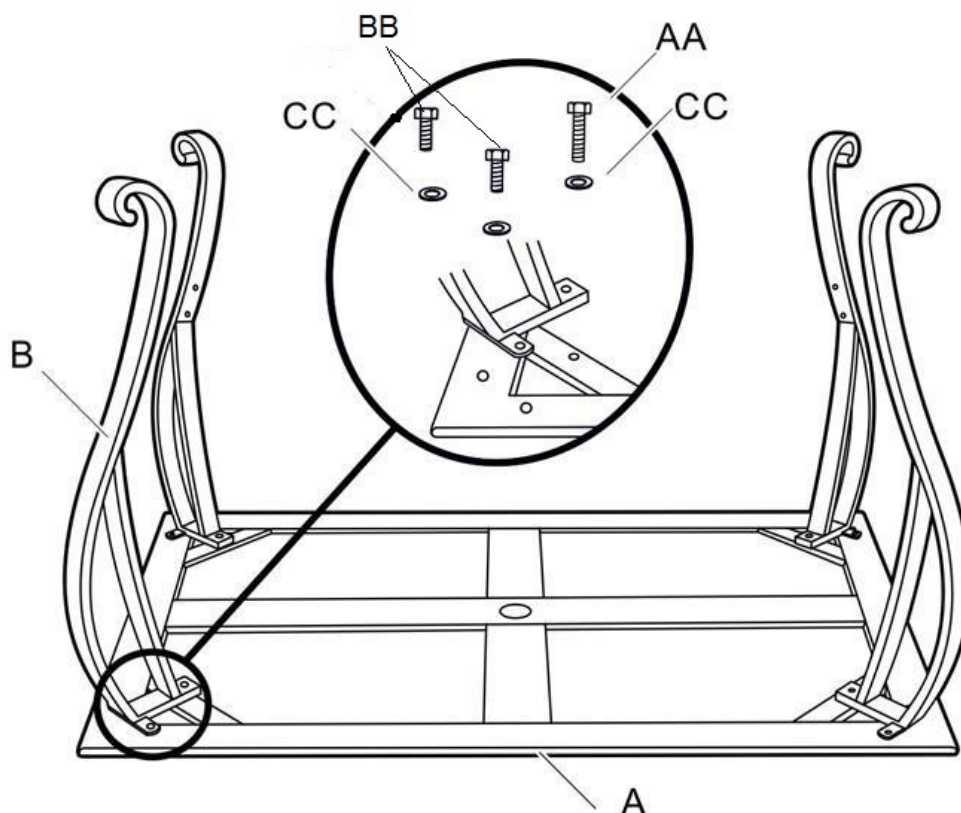
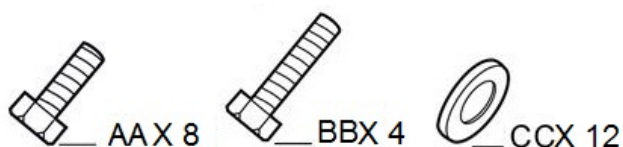

## Assembly Instruction (continued)

### 2 Attaching the connector ring

- Attach the connector ring (C) to the leg (B) using hex bolt (AA) and washer (CC).
- Ensure all bolts are aligned and assembled correctly
- Tighten all hex bolts (AA) and (BB) with the hex wrench (EE). Attach the hex bolt caps (DD)

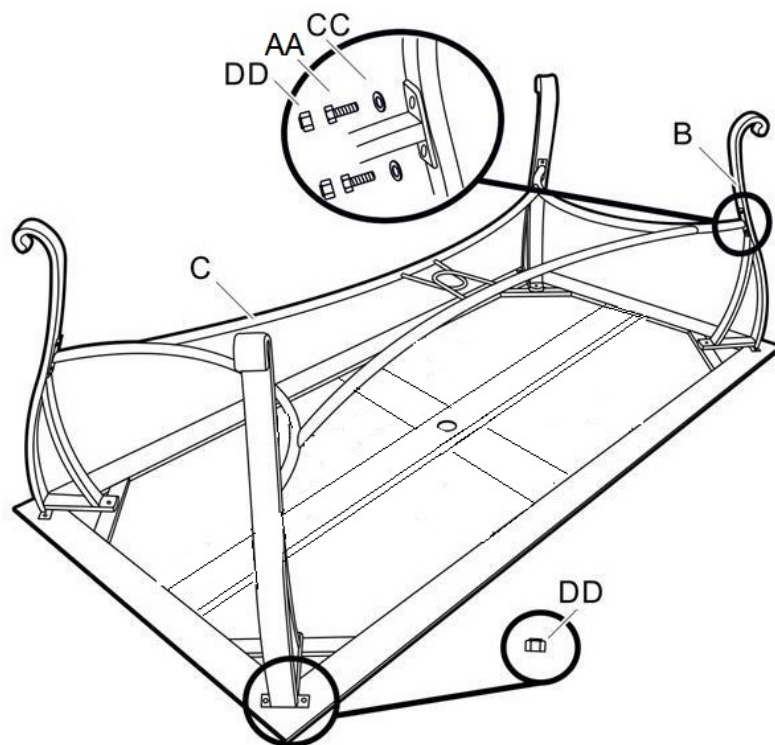



## Assembly Instruction (continued)

### 3 Replacing the ceramic tile top

**WARNING:**



1. Do not crawl, stand, or sit on tile table tops.
2. Do not set or lay heavy items on tile table tops.
3. Avoid extreme hot & cold items being placed on tile table tops.

- With the assistance of another person carefully turn the table over and set it down on its legs.
- Place the Ceramic tile top (D) onto the table.
- The dining table is ready for your enjoyment.

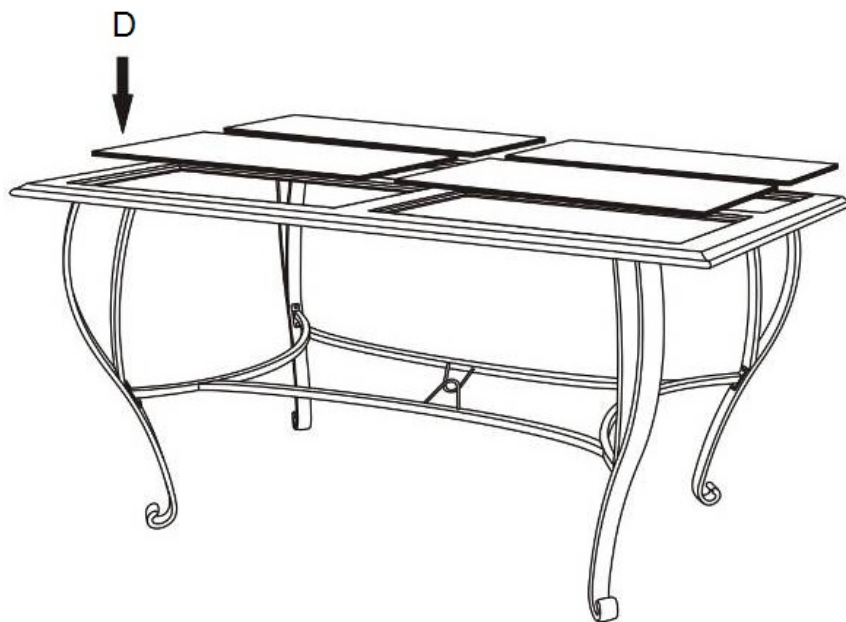



Please refer to part number when reordering

Questions, problems, missing parts? Before returning to the store,  
call our Customer Service

8 a.m. - 5 p.m., EST, Monday-Thursday

8 a.m. – 4 p.m., EST, Friday

**1-866-391-4868**

Made in/ Hecho en CHINA

Distributed by Sears, Roebuck and Co., Hoffman Estates, IL60179

See our extensive assortment of outdoor living products on-line

at [www.sears.com](http://www.sears.com) and [www.kmart.com](http://www.kmart.com)

Retain this manual for future use.



*Live life Comfortably.™*

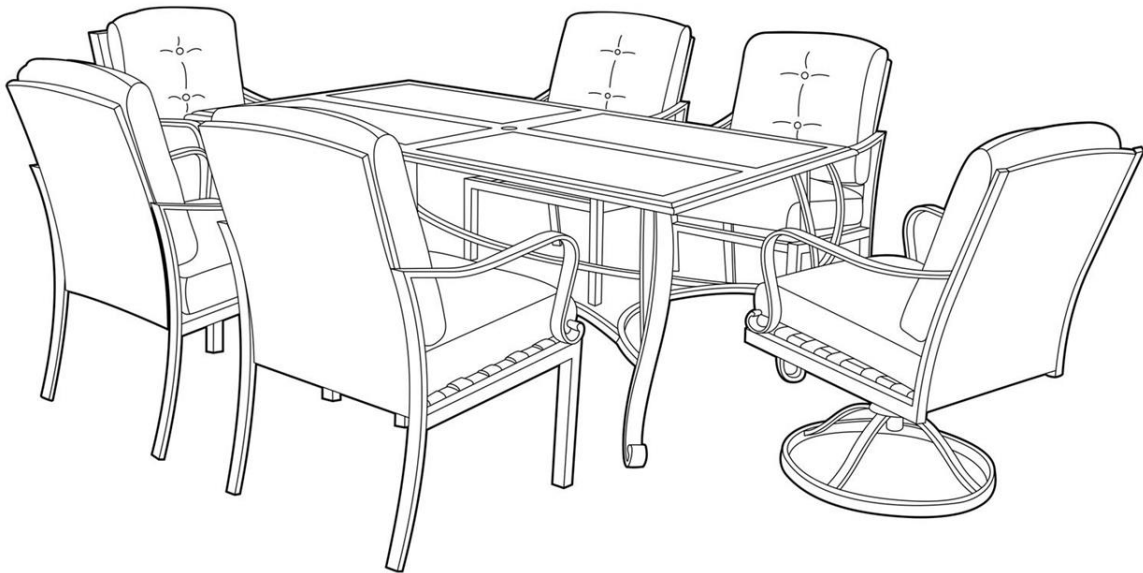

# USE AND CARE GUIDE

## Sears Peyton 7pc Dining set

### \* Swivel Rocker

Product Code: D71 M80905

UPC Code: 7-22938-07954-4

Date of Purchase: \_\_ / \_\_ / \_\_

La-Z-Boy® is a registered trademark of La-Z-Boy Incorporated and is used under license to BJI, Inc.

© 2015 La-Z-Boy Incorporated.

# Thank you for your purchase

---

## THANK YOU FOR YOUR PURCHASE!

We are pleased that you have chosen Sears for your outdoor furniture purchase. We hope that you enjoy the unmatched quality, comfort, and style of your new patio set. Every piece is meticulously considered all the way down to the smallest details, exclusively for you, by our world class design team. We know you have a choice when it comes to your patio furniture needs, so from our team to yours, thank you for letting us be a part of your outdoors.

## Table of Contents

---

<b>Table of Contents.....</b>	<b>2</b>
<b>Safety Information .....</b>	<b>3</b>
Set up your furniture properly.....	3
Examine your furniture .....	3
<b>Warranty .....</b>	<b>3</b>
What is covered .....	3
What is not covered .....	3
<b>Care and Maintenance .....</b>	<b>4</b>
<b>Pre-Assembly .....</b>	<b>5</b>
Planning assembly.....	5
Observe weight limits.....	5
Hardware included .....	5
Package contents .....	6
<b>Assembly Instruction .....</b>	<b>7</b>
<b>Customer Service .....</b>	<b>11</b>

## Safety Information

### SET UP YOUR FURNITURE PROPERLY

- Ensure that all parts are assembled properly and fully tightened as per the instructions.
- When placing in the desired location, ensure that all legs are resting on the same surface. You may adjust the legs levelers as required to ensure that the item stands in a rigid position.

### EXAMINE YOUR FURNITURE

- Examine occasionally to ensure that there are no loose parts. If loose parts are found, they must be retightened fully before additional use.

**WARNING:**

1. Do not crawl, stand, or sit on tile table tops.
2. Do not set or lay heavy items on tile table tops.
3. Avoid extreme hot & cold items being placed on tile table tops.



**CAUTION:** Read all of the instructions in this manual before you begin assembly. Failure to do so may result in faulty assembly and potential injury!

## Warranty

**THIS IS A RESIDENTIAL WARRANTY AND DOES NOT APPLY FOR COMMERCIAL USE.**

**7 YEARS WARRANTY FOR FRAME, 1 YEAR WARRANTY FOR RESIN WICKER AND CUSHIONS**

### WHAT IS COVERED

We warrant the frame to be free of Manufacturing defects to the original purchaser for 7 years, and resin wicker for 1 year.

### WHAT IS NOT COVERED

It remains the customer's responsibility for freight and packaging charges to and from our service center.

This warranty does not cover commercial use, hardware, acts of nature, fire, freezing and abusive use.

Discoloration or fading of the finish or fabrics as a result of chemicals or spills is not covered.

Glass table top breakage and corrosion or rusting of hardware are not covered.

In addition, purchase parts are not covered under this warranty.

## Warranty (continued)

---

Proof of purchase (dated register receipt) is required for warranty claims.

We reserve the right to make substitutions with similar merchandise, if the model in question is no longer in production.

For a copy of our full limited warranty, please contact our customer service team below.

Contact the Customer Service Team at 1-866-391-4868 or visit [www.bjifurniture.com](http://www.bjifurniture.com).

## Care and Maintenance

---

- Do not allow water to build up in frames. This will cause corrosion and possible freezing damage in cold climates.
- Use a mild soap and water for normal cleaning. DO NOT use janitorial or alcohol based cleaners. Some cleaners may be marked as natural, but some ingredients can cause discoloration or have adverse reaction to your finish.
- Rinse with clean water and dry with a soft, absorbent cloth towel.
- Cushions, slings, and/or an umbrella may be cleaned by hand with a solution of soap and water with a clean water rinse. Never machine wash as this will result in shrinking or damage. After cleaning, tip on end and allow to drip dry. Never use a commercial or home dryer to tumble dry fabric goods.
- Treat frames with liquid wax for maximum protection against UV rays and /or salty, damp air.
- Umbrella should be closed when not in use. Umbrella should be removed and stored in the event of wind, rain, hail, sleet, snow, or any other inclement weather. To prevent damage to your table, always use an umbrella base with your umbrella. Store indoors during winter months.
- Use and operation: To prolong the life of your outdoor furniture, cover when not in use. Store indoors during winter months.

# Pre-Assembly

## PLANNING ASSEMBLY

PLEASE READ COMPLETE USE AND CARE GUIDE PRIOR TO ASSEMBLY!

Identify all parts packed in the carton against the parts list. Remove all protective materials and place the parts on a nonabrasive surface to avoid scratching. It takes about 45 minutes for 3 persons to complete all the assembly.



**NOTE:** More than one person may be required to complete the assembly of this product.

## OBSERVE WEIGHT LIMITS

The recommended weight limit for each item is listed below:

- Dining Chair: 300 lbs
- Swivel Rocker: 300 lbs

## HARDWARE INCLUDED



**NOTE:** Hardware not shown to actual size. Quantity below is for one chair only.

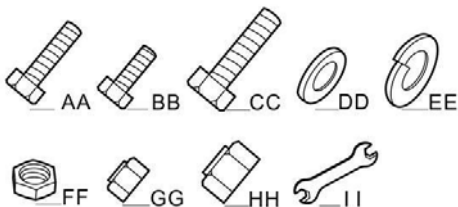

Part	Description	Quantity
AA	M6*45mm hex bolt	4
BB	M6*20mm hex bolt	4
CC	M8*45mm hex bolt	4
DD	M6 washer	8
EE	M8 washer	4
FF	M8 nut	4
GG	M6 hex bolt cap	8
HH	M8 hex bolt cap	4
II	Hex wrench	2

## Pre-Assembly (continued)

### PACKAGE CONTENTS

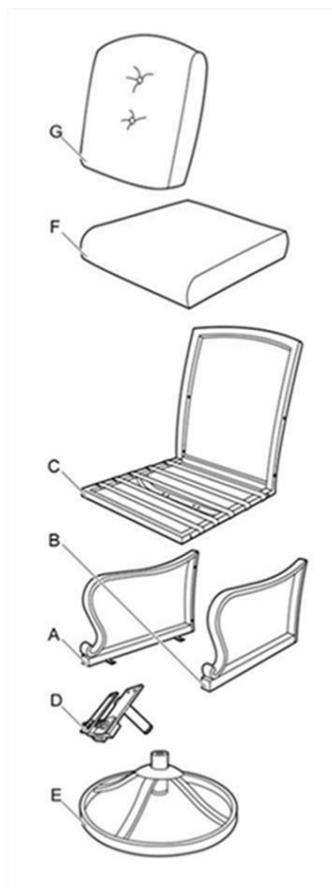

Part	Description	Quantity
A	Right arm	2
B	Left arm	2
C	Back and Seat frame	2
D	T-Rocker	2
E	Base	2
F	Seat cushion	2
G	Back cushion	2



### Safety Information

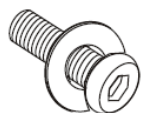

- EVERY BOLT NEEDS TO BE USED WITH A WASHER.
- DO NOT FULLY TIGHTEN BOLT UNTIL INDICATED IN **STEP 1 AND 2.**



# Assembly Instruction

## 1 Adding the arms

- Attach the right arm (A) to the back using M6 hex bolts (AA) and M6 washers (DD).
- Attach the right arm (A) to the seat using M6 hex bolts (BB) and M6 washers (DD).
- Repeat these instructions to attach the left arm (B) to the seat & back frame (C).
- Tighten all the M6 hex bolts (AA) & (BB) with the hex wrench (II). Attach the M6 bolts caps (GG).

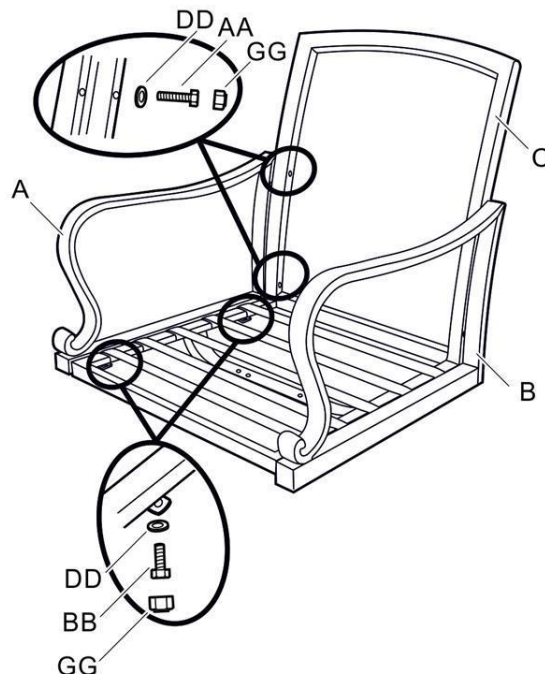
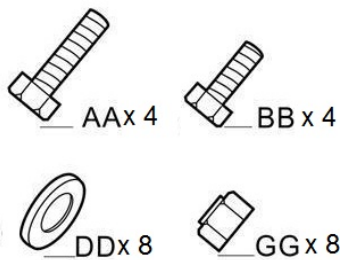

## Assembly Instruction (continued)

### 2 Attaching the T-Rocker

- Attach the T-Rocker (D) to the seat bucket (C) using M8 hex bolts (CC), M8 washers (EE) and M8 nuts (FF).
- Tighten all the M8 hex bolts (CC) and M8 nut (FF) with the hex wrench (II). Attach the M8 bolt caps (HH).

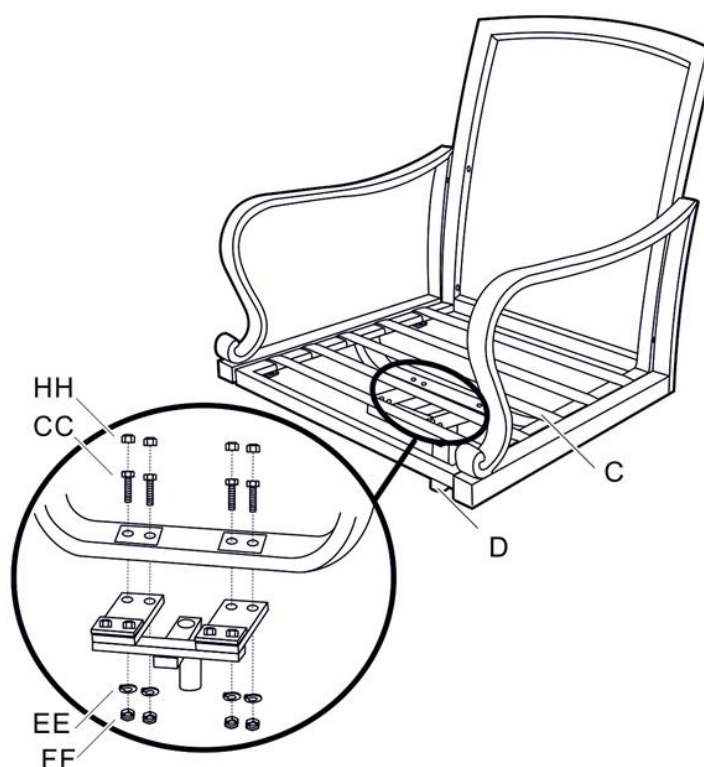

## Assembly Instruction (continued)

### 3 Inserting the T-Rocker

- Insert the T-Rocker (D) into the base (E). Make sure the seat bottoms out in the base for safety.

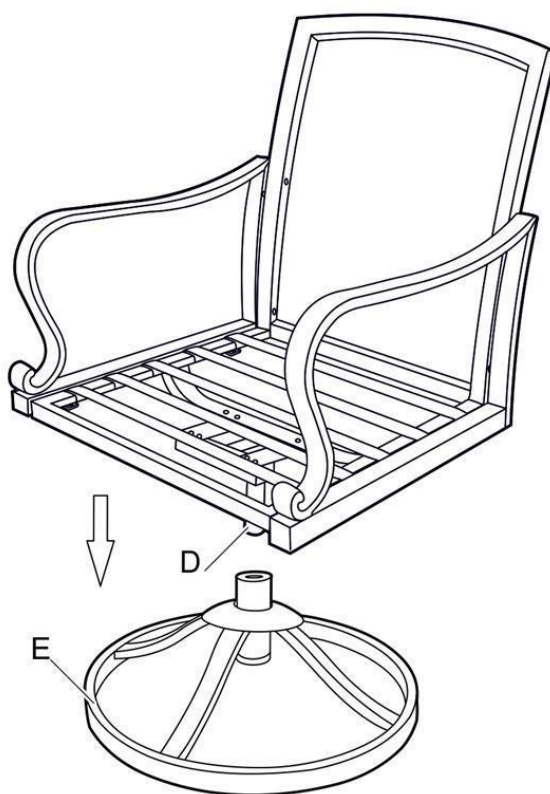

## Assembly Instruction (continued)

### 4 Adding the cushions

- Place the seat cushion (F), back cushion (G) onto the swivel rocker.
- Repeat these instructions to assembly the other swivel rocker.
- The swivel rockers are ready for enjoyment.

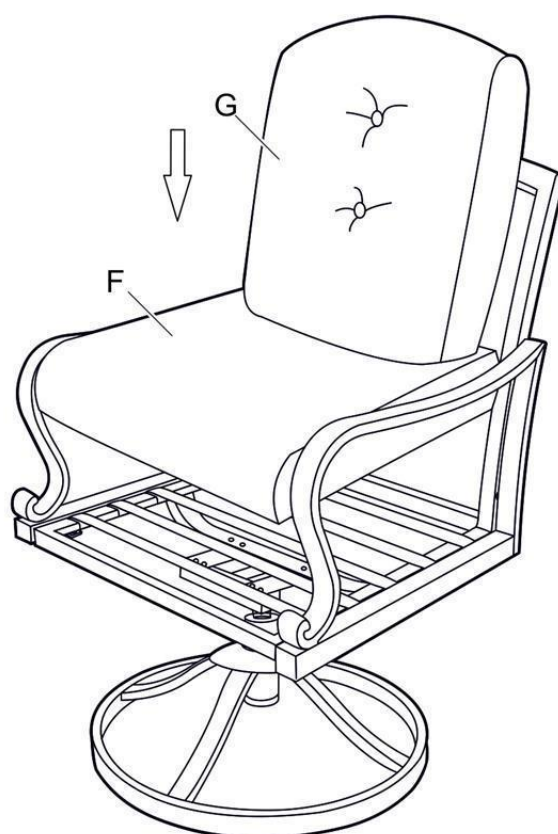



Please refer to part number when reordering

Questions, problems, missing parts? Before returning to the store,  
call our Customer Service

8 a.m. - 5 p.m., EST, Monday-Thursday

8 a.m. – 4 p.m., EST, Friday

**1-866-391-4868**

Made in/ Hecho en CHINA

Distributed by Sears, Roebuck and Co., Hoffman Estates, IL60179

See our extensive assortment of outdoor living products on-line

at [www.sears.com](http://www.sears.com) and [www.kmart.com](http://www.kmart.com)

Retain this manual for future use.



*Live life Comfortably.™*

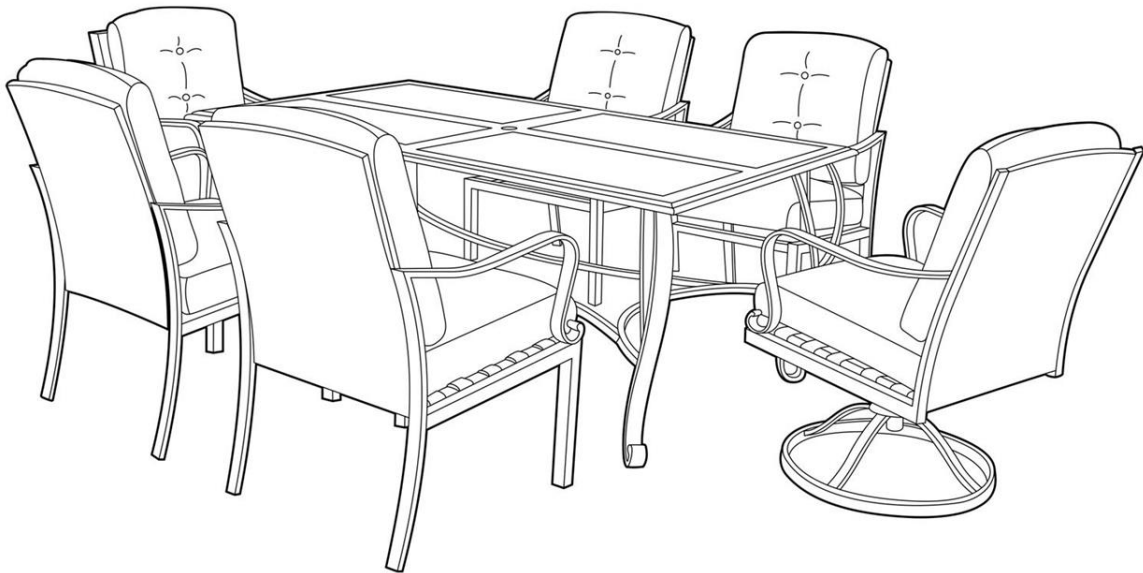

# USE AND CARE GUIDE

## Sears Peyton 7pc Dining set

### \* Stationary Dining Chair

Product Code: D71 M80905

UPC Code: 7-22938-07954-4

Date of Purchase: \_\_ / \_\_ / \_\_

La-Z-Boy® is a registered trademark of La-Z-Boy Incorporated and is used under license to BJI, Inc.

© 2015 La-Z-Boy Incorporated.

# Thank you for your purchase

---

## THANK YOU FOR YOUR PURCHASE!

We are pleased that you have chosen Sears for your outdoor furniture purchase. We hope that you enjoy the unmatched quality, comfort, and style of your new patio set. Every piece is meticulously considered all the way down to the smallest details, exclusively for you, by our world class design team. We know you have a choice when it comes to your patio furniture needs, so from our team to yours, thank you for letting us be a part of your outdoors.

## Table of Contents

---

<b>Table of Contents.....</b>	<b>2</b>
<b>Safety Information .....</b>	<b>3</b>
Set up your furniture properly.....	3
Examine your furniture .....	3
<b>Warranty .....</b>	<b>3</b>
What is covered .....	3
What is not covered .....	3
<b>Care and Maintenance .....</b>	<b>4</b>
<b>Pre-Assembly .....</b>	<b>5</b>
Planning assembly.....	5
Observe weight limits.....	5
Hardware included .....	5
Package contents .....	6
<b>Assembly Instruction .....</b>	<b>7</b>
<b>Customer Service .....</b>	<b>9</b>

## Safety Information

### SET UP YOUR FURNITURE PROPERLY

- Ensure that all parts are assembled properly and fully tightened as per the instructions.
- When placing in the desired location, ensure that all legs are resting on the same surface. You may adjust the legs levelers as required to ensure that the item stands in a rigid position.

### EXAMINE YOUR FURNITURE

- Examine occasionally to ensure that there are no loose parts. If loose parts are found, they must be retightened fully before additional use.

**WARNING:**

1. Do not crawl, stand, or sit on tile table tops.
2. Do not set or lay heavy items on tile table tops.
3. Avoid extreme hot & cold items being placed on tile table tops.



**CAUTION:** Read all of the instructions in this manual before you begin assembly. Failure to do so may result in faulty assembly and potential injury!

## Warranty

**THIS IS A RESIDENTIAL WARRANTY AND DOES NOT APPLY FOR COMMERCIAL USE.**

**7 YEARS WARRANTY FOR FRAME, 1 YEAR WARRANTY FOR RESIN WICKER AND CUSHIONS**

### WHAT IS COVERED

We warrant the frame to be free of Manufacturing defects to the original purchaser for 7 years, and resin wicker for 1 year.

### WHAT IS NOT COVERED

It remains the customer's responsibility for freight and packaging charges to and from our service center.

This warranty does not cover commercial use, hardware, acts of nature, fire, freezing and abusive use.

Discoloration or fading of the finish or fabrics as a result of chemicals or spills is not covered.

Glass table top breakage and corrosion or rusting of hardware are not covered.

In addition, purchase parts are not covered under this warranty.



## Warranty (continued)

---

Proof of purchase (dated register receipt) is required for warranty claims.

We reserve the right to make substitutions with similar merchandise, if the model in question is no longer in production.

For a copy of our full limited warranty, please contact our customer service team below.

Contact the Customer Service Team at 1-866-391-4868 or visit [www.bjifurniture.com](http://www.bjifurniture.com).

## Care and Maintenance

---

- Do not allow water to build up in frames. This will cause corrosion and possible freezing damage in cold climates.
- Use a mild soap and water for normal cleaning. DO NOT use janitorial or alcohol based cleaners. Some cleaners may be marked as natural, but some ingredients can cause discoloration or have adverse reaction to your finish.
- Rinse with clean water and dry with a soft, absorbent cloth towel.
- Cushions, slings, and/or an umbrella may be cleaned by hand with a solution of soap and water with a clean water rinse. Never machine wash as this will result in shrinking or damage. After cleaning, tip on end and allow to drip dry. Never use a commercial or home dryer to tumble dry fabric goods.
- Treat frames with liquid wax for maximum protection against UV rays and /or salty, damp air.
- Umbrella should be closed when not in use. Umbrella should be removed and stored in the event of wind, rain, hail, sleet, snow, or any other inclement weather. To prevent damage to your table, always use an umbrella base with your umbrella. Store indoors during winter months.
- Use and operation: To prolong the life of your outdoor furniture, cover when not in use. Store indoors during winter months.

# Pre-Assembly

## PLANNING ASSEMBLY

PLEASE READ COMPLETE USE AND CARE GUIDE PRIOR TO ASSEMBLY!

Identify all parts packed in the carton against the parts list. Remove all protective materials and place the parts on a nonabrasive surface to avoid scratching. It takes about 45 minutes for 3 persons to complete all the assembly.



**NOTE:** More than one person may be required to complete the assembly of this product.

## OBSERVE WEIGHT LIMITS

The recommended weight limit for each item is listed below:

- Dining Chair: 300 lbs
- Swivel Rocker: 300 lbs

## HARDWARE INCLUDED



**NOTE:** Hardware not shown to actual size. Quantity below is for one chair only.

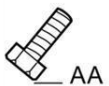

Part	Description	Quantity
AA	M6*45mm hex bolt	8
BB	M6 washer	8
CC	M6 hex bolt cap	8
DD	Hex wrench	1

## Pre-Assembly (continued)

### PACKAGE CONTENTS

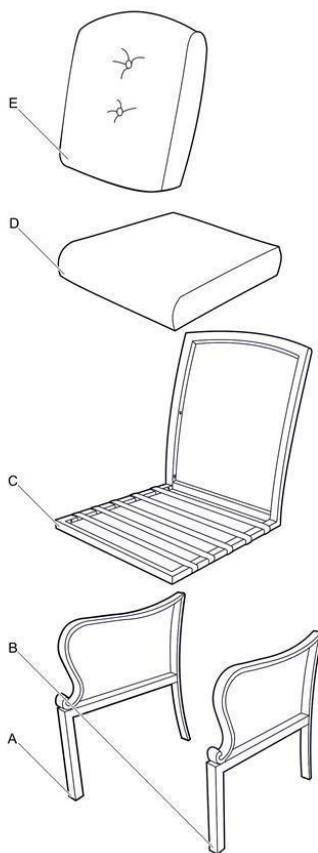

Part	Description	Quantity
A	Right arm	4
B	Left arm	4
C	Seat & back frame	4
D	Seat cushion	4
E	Back cushion	4



### Safety Information

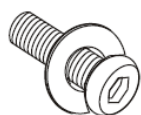

- EVERY BOLT NEEDS TO BE USED WITH A WASHER.
- DO NOT FULLY TIGHTEN BOLT UNTIL INDICATED IN **STEP 1**.

# Assembly Instruction

## 1 Adding the arms

- Attach the right arm (A) to the seat & back frame (C) using M6 hex bolts (AA) and M6 washers (BB).
- Repeat these instructions to attach the left arm (B) to the seat & back frame (C).

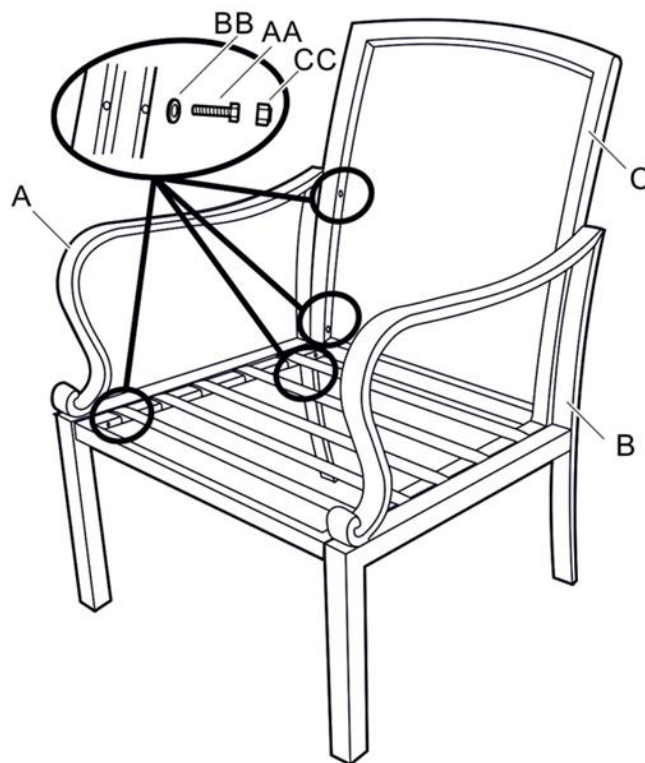

## Assembly Instruction (continued)

---

### 2 Adding the cushions

- Place the seat cushion (D), back cushion (E) onto stationary dining chair.
- Repeat these instructions to assemble the other three stationary dining chairs.
- The dining chairs are ready for enjoyment.

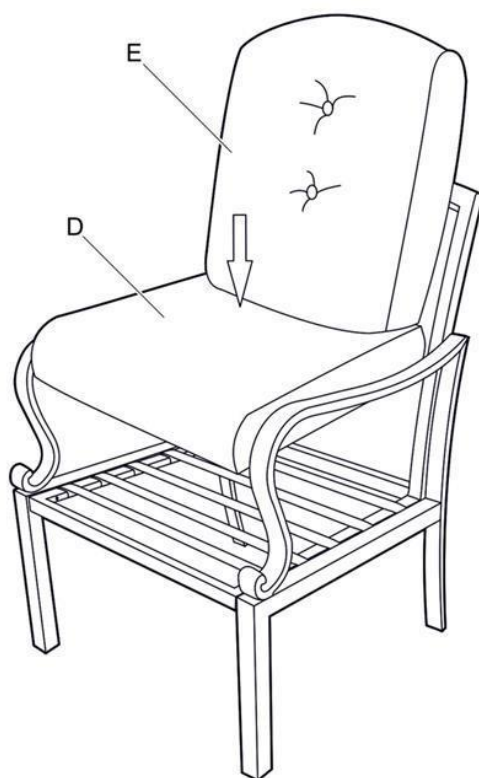



Please refer to part number when reordering

Questions, problems, missing parts? Before returning to the store,  
call our Customer Service  
8 a.m. - 5 p.m., EST, Monday-Thursday  
8 a.m. – 4 p.m., EST, Friday

**1-866-391-4868**

Made in/ Hecho en CHINA

Distributed by Sears, Roebuck and Co., Hoffman Estates, IL60179

See our extensive assortment of outdoor living products on-line

at [www.sears.com](http://www.sears.com) and [www.kmart.com](http://www.kmart.com)

Retain this manual for future use.