

USE & CARE GUIDE

REPLACEMENT CANOPY FOR 11.5' ROUND O: FSET UMBRELLA

Product Code: 02620584-9

UPC Code: 8-48681-03014-1

Date of Purchase: ____ / ____ / ____

Thank you for your purchase

Thank you for your purchase!

We are pleased that you have chosen Sears for your outdoor furniture purchase. We hope that you enjoy the unmatched quality, comfort, and style of your new patio set. Every piece is meticulously considered all the way down to the smallest details, exclusively for you, by our world class design team. We know you have a choice when it comes to your patio umbrella needs, so from our team to yours, thank you for letting us be a part of your outdoors.

Table of Contents

Table of Contents	2
Safety information	3
Umbrella Replacement Set Up	3
Examine Your Umbrella Replacement	3
Warranty	3
What is Covered	3
What is Not Covered	3
Care and Maintenance	3
Pre- Assembly	4
Planning Assembly	4
Package Contents	5
Assembly Instruction	6
Customer Service	7

Safety Information

Umbrella Replacement Set Up

- ☐ Ensure that all parts are assembled properly and fully tightened as per the instructions.
- ☐ When replacing the canopy, ensure that the umbrella stands on flat ground.

Examine Your Umbrella Replacement

- ☐ Examine occasionally to ensure that there are no loose parts. If loose parts are found, they must be retightened fully before additional use.

Warranty

1 YEAR WARRANTY FOR FRAME AND FABRIC

WHAT IS COVERED

We warrant the frame and fabric to be free of manufacturing defects to the original purchaser for 1 year.

WHAT IS NOT COVERED

It remains the customer's responsibility for freight and packaging charges to and from our service center. This warranty does not cover commercial use, hardware, acts of nature, fire, freezing, and abusive use. In addition, purchase part(s) are not covered under this warranty. We reserve the rights to make substitutions with similar merchandise, if the model is no longer in production.

Customer service: 1-866-905-4107

Care and Maintenance

- ☐ Wipe the fabric lightly with a mild solution of soap and water, rinse with clean water, and dry thoroughly.
- ☐ Use and operation: To improve the lifespan of this umbrella canopy, cover when not in use and store in a cool dry place during the off season.

Pre-Assembly

PLANNING ASSEMBLY

To prevent damage, place all parts on a soft surface during assembly. Remove all protective caps before beginning assembly. It takes about 20 minutes for one person to complete all the assembly.



CAUTION: This is a spare part and can only be used for Sears 11.5' Steel Round Offset Umbrella With Plastic Base.

Package Contents

A



PART	DESCRIPTION	QUANTITY
A	 UMBRELLA CANOPY	1

Assembly Instruction

1 Removing the old canopy

- TEAR OPEN THE VELCRO STRIP ON THE OLD UMBRELLA CANOPY AND PULL DOWN THE ZIPPER TO OPEN THE CANOPY COVER.
- REMOVE THE OLD CANOPY FROM THE UMBRELLA FRAME.

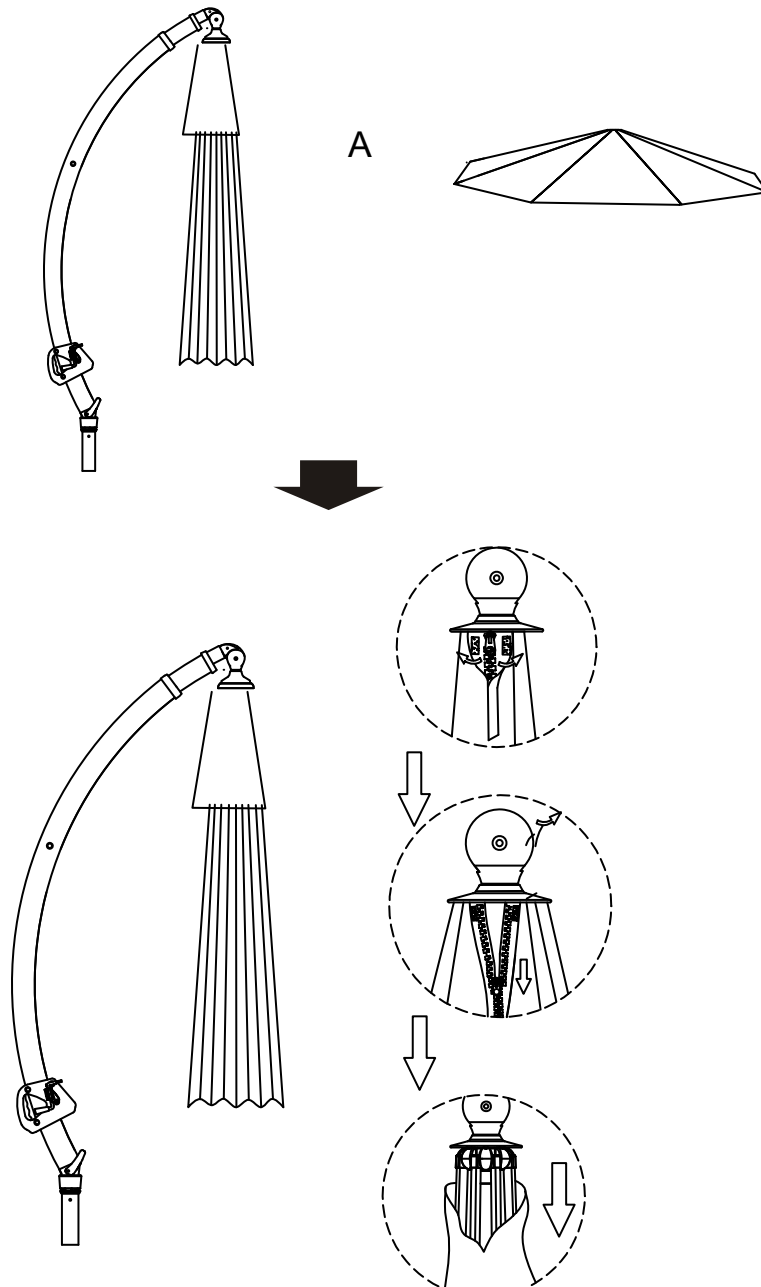

Assembly Instruction (continued)

2 Attaching the new umbrella canopy to the umbrella frame

- PLACE THE NEW UMBRELLA CANOPY “A” AND PULL THE NEW CANOPY TO THE TOP OF THE UMBRELLA FRAME.
- ZIP THE ZIPPER AND ATTACH THE VELCRO TOGETHER.
- TIDY THE SEAM FINISH OF THE UMBRELLA CANOPY AND PRESS IT UNDER THE RAIN CAP.
- PLACE EVERY UMBRELLA RIB INTO THE CANOPY.

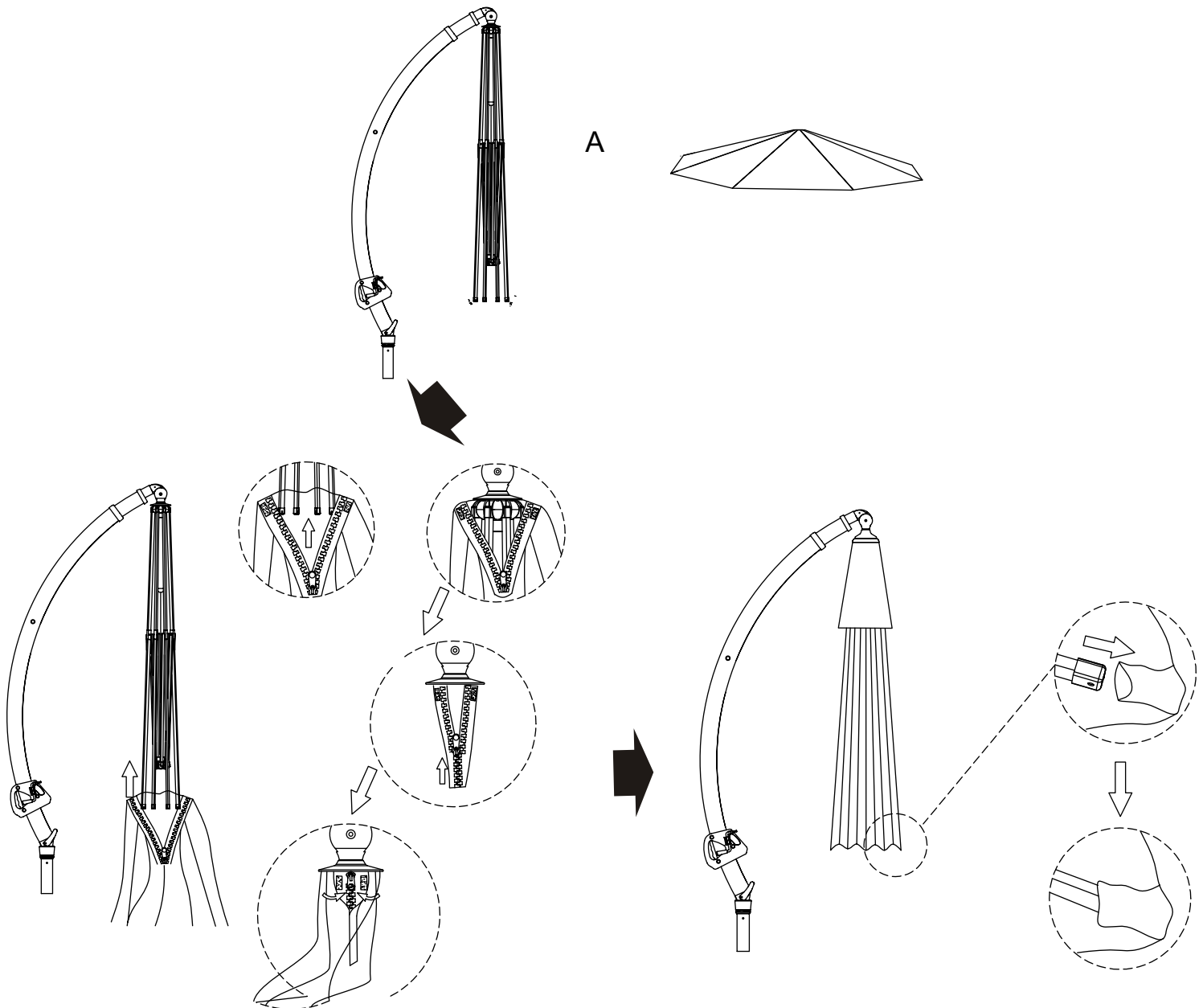



HOME OFFICE: 1100 Coiner Ct., City of Industry, CA 91748

FAX: 1-626-269-6399

CUSTOMER SERVICE HOT LINE: 1-866-905-4107

SEVICE HOURS: MONDAY-FRIDAY 8:30 AM TO 5:00 PM PST
/ 11:30 AM TO 8:00PM EST

E-MAIL: customerservice@yotrious.com

sears

Please refer to part numbers when reordering

For questions or comments about product:

Email: customerservice@yotrious.com or Call toll-free: 1-866-905-4107

Made in CHINA / Hecho en CHINA

Distributed by Sears, Roebuck and Co., Hoffman Estates, IL 60179

See our extensive assortment of outdoor living products
on-line at www.sears.com and www.kmart.com