

## 12 VOLT DC POWER ADAPTOR FUSE REPLACEMENT

To replace fuse unscrew retainer ring.

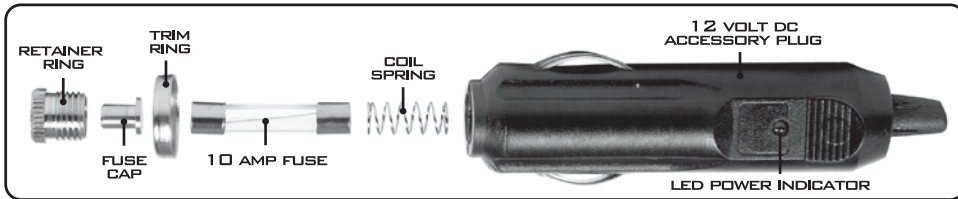

## SPECIFICATIONS

|                                               |                                              |
|-----------------------------------------------|----------------------------------------------|
| A. POWER AND CURRENT DRAW .....               | APPROX. 40 WATT/3.1-3.3 AMP                  |
| B. FUSE PROTECTION .....                      | 10 AMP FUSE                                  |
| C. NET WEIGHT (lb.) .....                     | 11.055 lb.                                   |
| D. DIMENSIONS (in.) .....                     | 7 1/2 in.(W)-X-18 1/4 in.(D)-X-10 1/2 in.(H) |
| E. TEMPERATURE RANGE @ ROOM TEMPERATURE ..... | 40° F TO 158° F                              |

## CLEANING INSTRUCTIONS

### ⚠ CAUTION

DO NOT submerge unit in water. Ensure unit is disconnected and the Mode & Power Selector switch is in the OFF position. Wipe unit with a clean damp cloth. Use mild soap and water—DO NOT use abrasive cleaners or scrubbers.

### STORAGE

This unit may be stored in any position at ambient room temperature. Ensure the unit 12 Volt DC power adaptor is disconnected and properly stored. Also, ensure that the unit Mode & Power Selector switch is in the OFF position.

## TWO YEAR LIMITED WARRANTY

Rally Manufacturing is dedicated to making high quality products for every consumer. We are so confident in the quality of our merchandise that we offer a two year limited warranty with this product. That means should you find any defects with the item you purchased, we will repair it or replace it. Please mail all defective products to Rally Manufacturing Inc., 7600 Corporate Center Drive, Suite 400, Miami, FL 33126. Attn: Customer Service.

REPAIR OR REPLACEMENT OF THE DEFECTIVE PRODUCT OR COMPONENT PROVIDED UNDER THIS WARRANTY SHALL NOT APPLY IF THE PRODUCT: (a) IS USED FOR COMMERCIAL PURPOSES AND/OR FROM IMPROPER USE IN AN UNSUITABLE ENVIRONMENT (b) IS MODIFIED OR TAMPERED WITH EITHER INTERNALLY OR EXTERNALLY; (c) IS DAMAGED RESULTING FROM MISUSE, NEGLIGENCE, LACK OF REASONABLE MAINTENANCE AND CARE, OR BY OTHER CAUSES UNRELATED TO DEFECTIVE MATERIAL OR WORKMANSHIP; (d) IF THE PRODUCT HAS BEEN SUBJECTED TO FIRE, WATER, OR GENERAL CORROSION.

This warranty gives you specific legal rights, and you may also have other rights which vary from State to State in the U.S.A. or province to province in Canada.

**WARNING:** This product may contain chemicals known to the state of California to cause cancer, birth defects, or other reproductive harm. Wash hands after handling!



**CUSTOMER SERVICE**  
Monday-Friday 8:30 am - 5:30 pm Eastern Standard Time  
For Questions or comments contact us at:  
[www.rallymfg.com](http://www.rallymfg.com) or call 1-800-965-4407

© 2012 RALLY MANUFACTURING, INC.

Made in China.



No. 7509

# HEAVY DUTY 12 VOLT DC THERMOELECTRIC TRAVEL COOLER AND WARMER

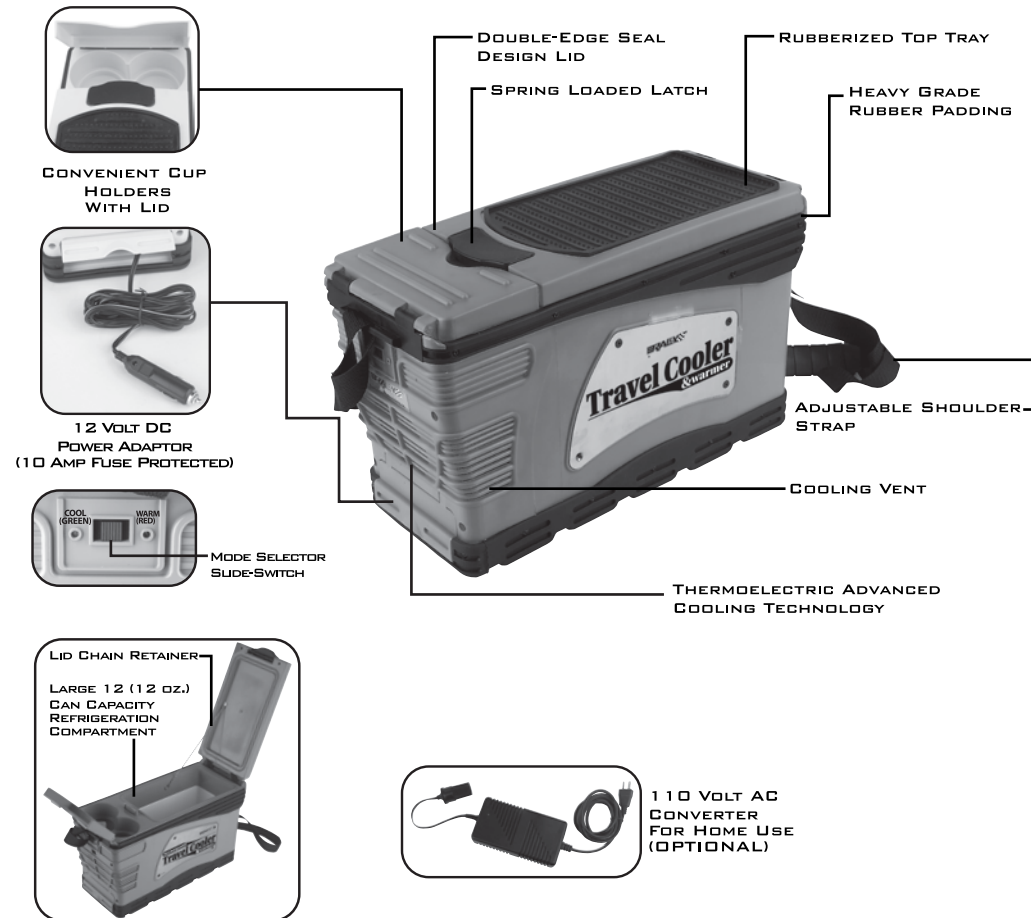

## IMPORTANT SAFETY INSTRUCTIONS

**IMPORTANT:** PRIOR TO USE, READ AND UNDERSTAND ALL WARNINGS, CAUTIONS AND INSTRUCTIONS INCLUDED IN THIS INSTRUCTION MANUAL.

### ⚠ WARNINGS

- ENSURE that the unit power cable does not obstruct or interfere with the motor vehicle mechanical or electronic controls.
- RUPTURE HAZARD!**—DO NOT place unopened vacuum pressure sealed containers into the unit Refrigeration Compartment during the WARM operational mode.
- DO NOT operate this device or place this product near flammable materials or any location, which accumulate flammable fumes.
- Do not connect to 6 or 24 Volt batteries.

### ⚠ CAUTIONS

- DO NOT expose this unit to heavy moisture or submerge unit in water.
- ALLOW at least 30 minutes break period before switching operational mode function.
- This unit will deplete the vehicle battery—DO NOT leave this unit connected to the vehicle cigarette lighter or 12 Volt DC socket for prolonged periods while vehicle engine is not running.
- Operate this unit in a well ventilated area.

- DO NOT obstruct or cover the unit cooling vents—Allow free air flow.
- DO NOT leave any perishable item within the refrigeration compartment while unit is not powered.
- When connecting or disconnecting the 110 Volt AC Converter (OPTIONAL) or 12 Volt DC power adaptor, pull on the plugs not on the cables.
- Use only the provided 110 Volt AC Converter (OPTIONAL) and 12 Volt DC power adaptor cables—Unauthorized parts may damage the unit.
- DO NOT touch the 12 Volt DC power adaptor accessory plug tip immediately after disconnecting.
- SHOCK HAZARD!—ENSURE that any electrical outlet, located in a wet or moist area, and is to be used to power this unit, is protected by a Ground Fault Circuitry Interrupt fuse.
- This product has no consumer serviceable parts except the replaceable fuse.
- This is not a toy. KEEP OUT OF REACH OF CHILDREN!
- Avoid touching unit Heating Plate (internal side wall) during warm operation.
- Save these instructions for future reference.

FEATURES

**A. DEEP WELL DUAL-CUP HOLDER COMPARTMENT**  
Top Mount Cup Holder compartment with Lid

**B. LARGE CAPACITY REFRIGERATION COMPARTMENT**  
7.2 liter—12 (12 oz.) Can capacity aluminum refrigeration compartment

**C. COOLER LID WITH SPRING LOADED LATCH**  
Lid double-edge design ensures a tight seal.

**D. PROFESSIONAL GRADE RUBBERIZED TOP TRAY**  
Cooler lid doubles as a tray when closed.

**E. PADDED CARRYING STRAP**  
Fully adjustable shoulder strap for mobile applications

**F. ADVANCED THERMOELECTRIC CHIP COOLING TECHNOLOGY (ATT)**  
Durable, non-volatile and environmental friendly thermoelectric chip cooling and heating technology.

**G. MODE SELECTOR SLIDE SWITCH**  
Cool and Warm operational mode selector with RED and GREEN LED indicators.

**H. POLYMER HOUSING WITH HEAVY GRADE RUBBER PADDING**  
Durable weather resistant housing with impact shock mitigating rubber padding.

TROUBLESHOOTING GUIDE

| TROUBLE                                        | CAUSE                                                                                                                    | SOLUTION                                                                                                                                                                                                                |
|------------------------------------------------|--------------------------------------------------------------------------------------------------------------------------|-------------------------------------------------------------------------------------------------------------------------------------------------------------------------------------------------------------------------|
| Unit failed to power ON using auxiliary power. | 1. No output power at the vehicle 12 Volt DC socket.                                                                     | 1. Turn vehicle ignition to accessory ON position.                                                                                                                                                                      |
|                                                | 2. Bad connection to the 110 Volt AC Converter socket (optional) or 12 Volt DC socket and/or the 110 Volt AC receptacle. | 2. Connect the unit 12 Volt DC power adaptor Accessory plug properly into the 110 Volt AC Converter socket or 12 Volt DC socket and/or properly connect the 110 Volt AC Converter plug into the 110 Volt AC Receptacle. |
|                                                | 3. The 110 Volt AC Converter (optional) socket or the vehicle 12 Volt DC socket dirty.                                   | 3. Properly clean the 110 Volt AC Converter socket or the 12 Volt DC socket.                                                                                                                                            |
|                                                | 4. Vehicle or 12 Volt DC power source battery defective.                                                                 | 4. Replace battery.                                                                                                                                                                                                     |
|                                                | 5. Unit 12 Volt DC Power adaptor fuse blown.                                                                             | 5. Replace fuse. (See <i>12 Volt DC Power adaptor Fuse Replacement</i> )                                                                                                                                                |
| Unit failed to cool-down or warm-up properly.  | 1. Vehicle or 12 Volt DC power source battery is depleted.                                                               | 1. Charge the vehicle or 12 Volt DC power source battery.                                                                                                                                                               |
|                                                | 2. Unit air extraction vents clogged.                                                                                    | 2. Remove air obstruction article(s).                                                                                                                                                                                   |
|                                                | 3. Unit refrigeration compartment door opened.                                                                           | 3. Close refrigeration compartment door latch securely.                                                                                                                                                                 |

AUXILIARY POWER OPERATION

1. 12 VOLT DC POWER ADAPTOR CONNECTION

- a. Car Connection: Connect the 12 Volt DC Power adaptor Accessory plug into the vehicle 12 Volt DC Socket.
- b. Home Connection (OPTIONAL): Connect the 12 Volt DC Power adaptor Accessory plug into the 110 Volt AC Power Converter Socket. Connect the 110 Volt AC Converter to a 110 Volt AC receptacle.

2. COOL MODE OPERATION

- a. Load the unit refrigeration compartment with the pre-cooled consumable (s).
- b. Close the refrigeration compartment door securely.
- c. Slide the Mode Selector Switch Left to the COOL operating position.

3. WARM MODE OPERATION

- a. Load the unit refrigeration compartment with the pre-heated consumable (s).
- b. Close the refrigeration compartment door securely.
- c. Slide the Mode Selector Switch Right to the WARM operating position.

4. TO POWER OFF THE UNIT

- a. Slide the Mode Selector Switch to the CENTER/OFF position.

