

Minnesota FATS®

We strive to ensure that our products are of the highest quality and free of manufacturing defects or missing parts. However, if you have any problems with your new product,

DO NOT RETURN IT TO THE STORE,

please contact us toll free @:

1-866-556-2757

FAX: 1-866-873-3531

pooltables@escaladesports.com

Or write to:

Escalade Sports
Customer Service Department
P.O. Box 889
Evansville IN 47706

Please visit our Web site at:

www.escaladesports.com

Please have your model number when inquiring about parts.

When contacting Escalade Sports please provide your model number, date code (if applicable) and part number if requesting a replacement part. These numbers are located on the product, packaging, and this owners manual.

Your Model Number **MFT901-TBL**

Date Code **2-MFT901-TBL- -DO**

Purchase Date _____

PLEASE RETAIN THIS INSTRUCTION MANUAL FOR FUTURE REFERENCE

**IMPORTANT! READ EACH STEP
IN THIS MANUAL BEFORE YOU
BEGIN THE ASSEMBLY.**

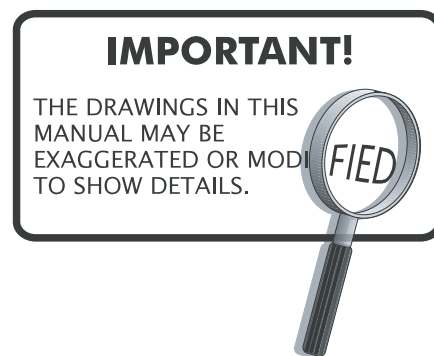

TWO ADULTS ARE REQUIRED TO ASSEMBLE THIS THIS MINNESOTA FATS 7.5FT FULLERTON POOL TABLE

Tools Required:

Allen Wrench T1 & Wrench T2 Included with the Hardware Kit
Furniture Polish and Cloth

An electric screwdriver is helpful in assembly. However, please set at low torque and use extreme caution with an electric screwdriver because you could overtighten the hardware and strip the screws.

Assembly Tips

Make sure you understand the following tips before you begin to assemble your pool table.

1. Start all bolts by hand before tightening.
2. Some drawings or images in this manual may not look exactly like your product. Please read and understand the text before starting each assembly step.



ATTENTION:

**READ AND FOLLOW ALL ASSEMBLY, OPERATION, AND
SAFETY INSTRUCTIONS CAREFULLY. AT LEAST TWO
ADULTS ARE NEEDED TO PUT THIS POOL TABLE
TOGETHER.**

HARDWARE IDENTIFIER

(To Scale)

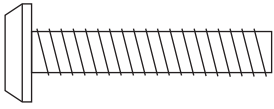

H1 - 1/4" x 1-1/4"
Allen Head Bolt (16)

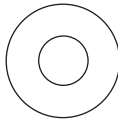

H2 - 1/4"
Flat Washer (16)



H3 - 1/4"
Lock Washer (16)

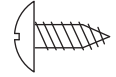

H4 - 4mm x 10mm
Phillips Round
Head Screw (16)

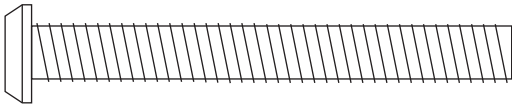

H5 - 5/16" x 2-1/4"
Allen Head Bolt (12)

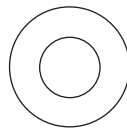

H6 - 5/16"
Flat Washer (36)



H7 - 5/16"
Lock Washer (24)



H8 - 5/16"
Nut (12)

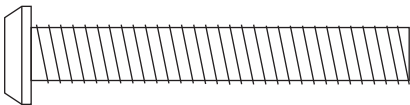

H9 - 5/16" x 1-1/2"
Allen Head Bolt (12)

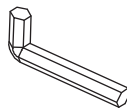

(Not to Scale)

T1 - Allen Wrench (1)



(Not to Scale)

T2 - Wrench (1)

PARTS IDENTIFIER

(Not To Scale)

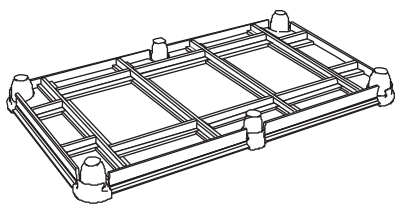

P1 - Pool Table Cabinet (1)

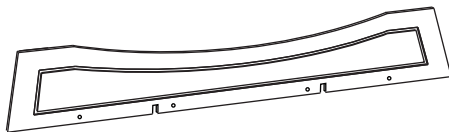

P2 - Side Apron (2)

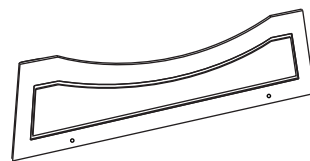

P3 - End Apron (2)



P4 - Corner Post (4)

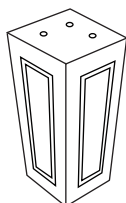

P5 - Leg (4)

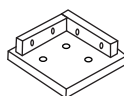

P6 - Leg Support Brace (4)

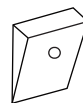

P7 - Wooden Block (12)

ACCESSORIES IDENTIFIER

(Not To Scale)

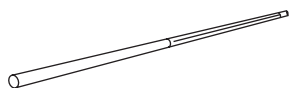

A1 - Cue Stick (2)

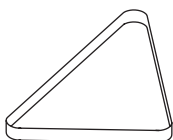

A2 - Triangle (1)

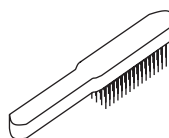

A3 - Playfield Cloth Brush (1)

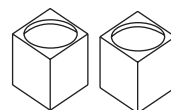

A4 - Cue Chalk (2)

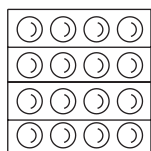

A5 - Billiard Ball Set (1)

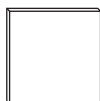

A6 - Leveling Shim (10)
** Use under legs
only as required **



PARTS REQUIRED:

1 pc - **P1** Pool Table Cabinet

2 pcs - **P3** End Apron

2 pcs - **P2** Side Apron

4 pcs - **P4** Corner Post

STEP 1:

With the help of another adult, install **P2** Side Aprons and **P3** End Aprons onto **P1** Pool Table Cabinet with **P4** Corner Posts attach as shown in **FIGURE 1**.

IMPORTANT NOTE: SLIDE P4 CORNER POSTS WITH ARROW POINTING DOWN.

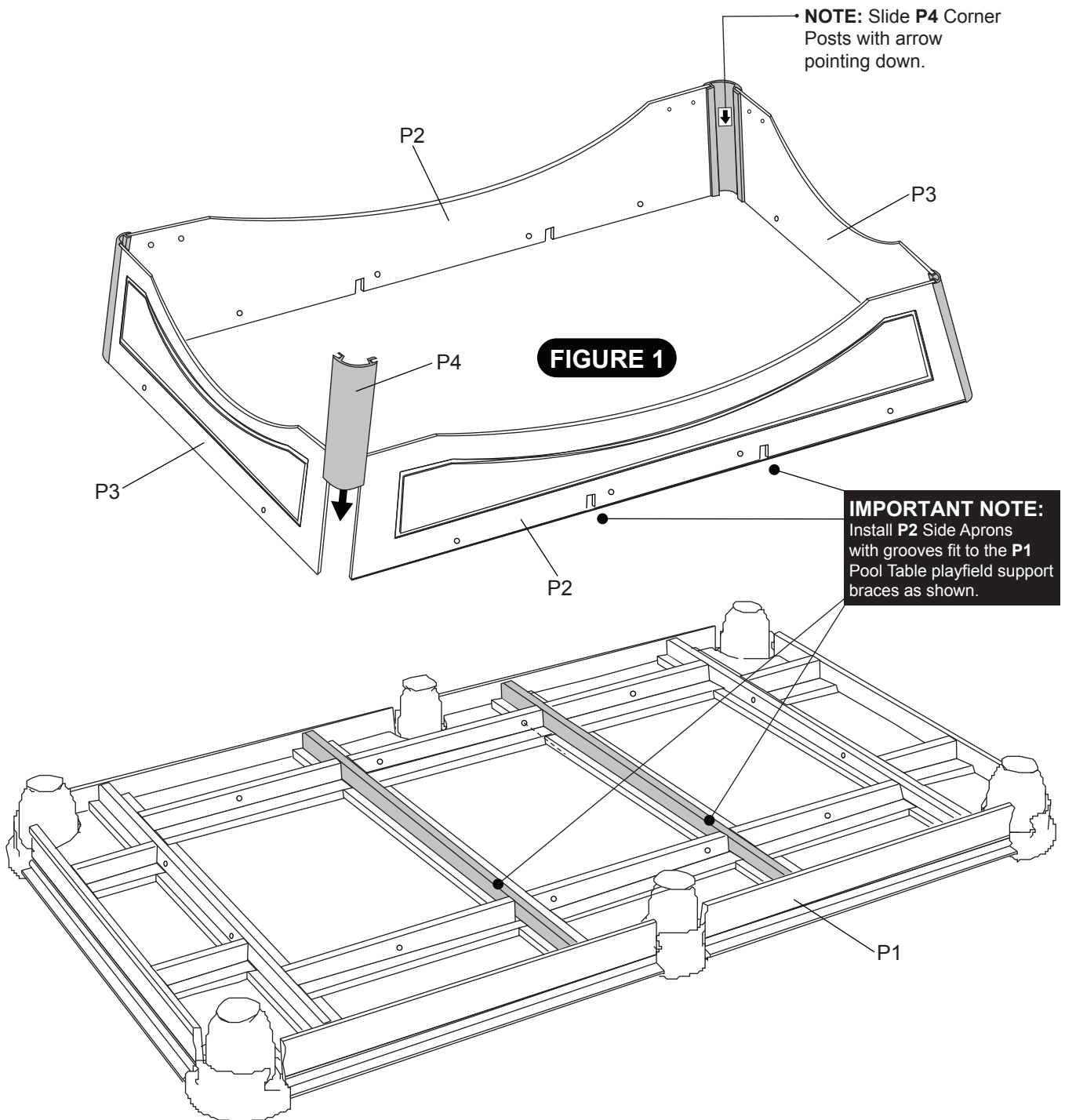

PARTS REQUIRED:

| | |
|------------------------------------|--|
| 16 pcs - H1 Allen Head Bolt | 16 pcs - H4 Phillips Round Head Screw |
| 16 pcs - H2 Flat Washer | 4 pcs - P6 Leg Support Brace |
| 16 pcs - H3 Lock Washer | 1 pc - T1 Allen Wrench |

STEP 2:

Install **P6** Leg Support Braces using **H1** Allen Head Bolts with **H2** Flat Washers and **H3** Lock Washers as shown in **FIGURE 2**. Use **T1** Allen Wrench to tighten all **H1** Allen Head Bolts.

Secure **P4** Corner Posts using **H4** Phillips Round Head Screws as shown in **FIGURE 2**.

IMPORTANT NOTE: TIGHTEN, BUT DO NOT STRIP OUT H4 SCREWS.

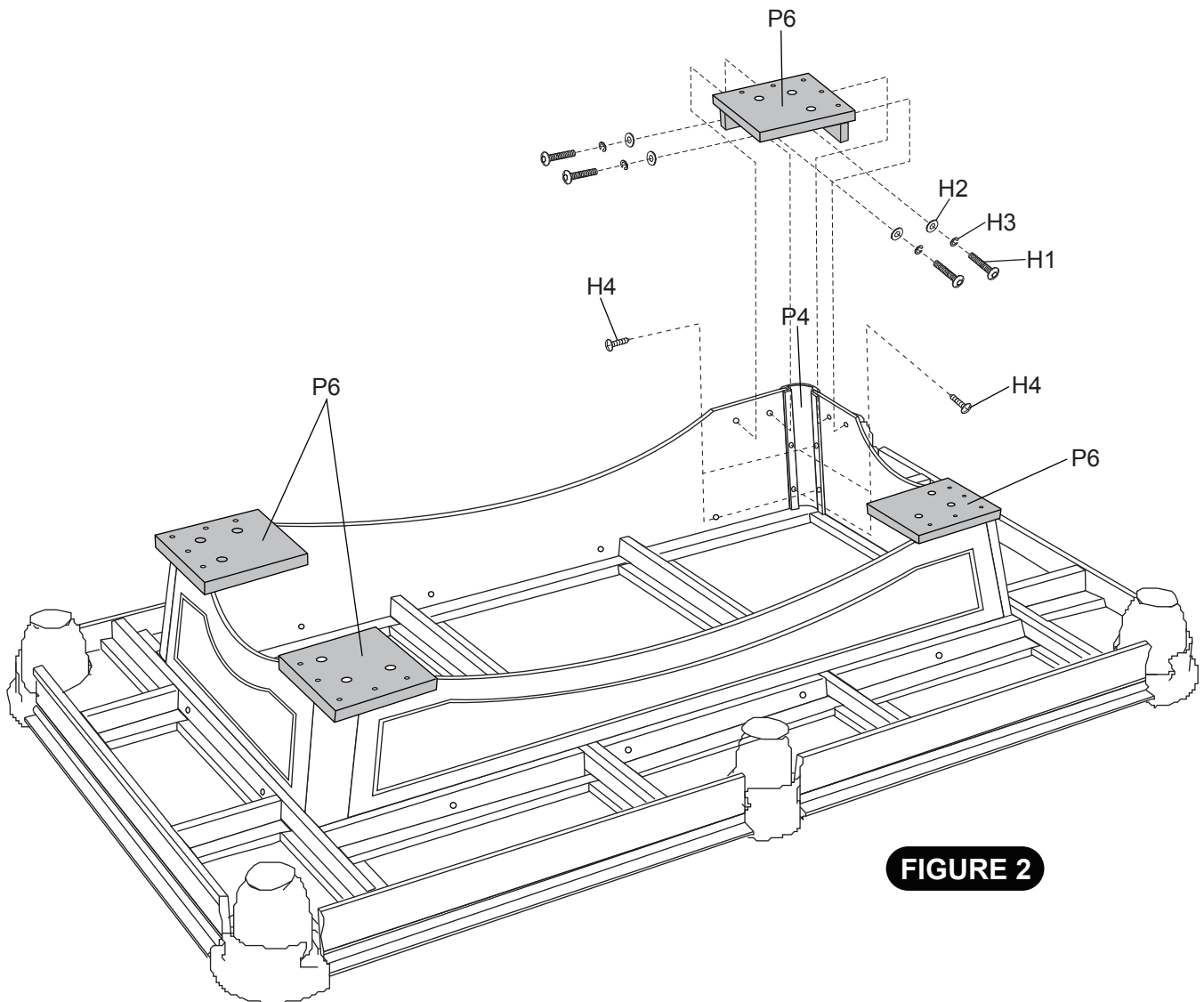

FIGURE 2

PARTS REQUIRED:

| | |
|------------------------------------|---------------------------------|
| 12 pcs - H5 Allen Head Bolt | 12 pcs - H8 Nut |
| 24 pcs - H6 Flat Washer | 12 pcs - P7 Wooden Block |
| 12 pcs - H7 Lock Washer | 1 pc - T1 Allen Wrench |
| | 1 pc - T2 Wrench |

STEP 3:

Install **P7** Wooden Blocks using **H5** Allen Head Bolts with **H6** Flat Washers, **H7** Lock Washers and **H8** Nuts as shown in **DETAIL A** and **FIGURE 3**. Use **T1** Allen Wrench and **T2** Wrench to tighten all **H5** Allen Head Bolts.

IMPORTANT NOTE:
Place **P7** Wooden Blocks
between table support
frames and **P3** End Aprons.

IMPORTANT NOTE:
Place **P7** Wooden Blocks
between table support
frames and **P2** Side Aprons.

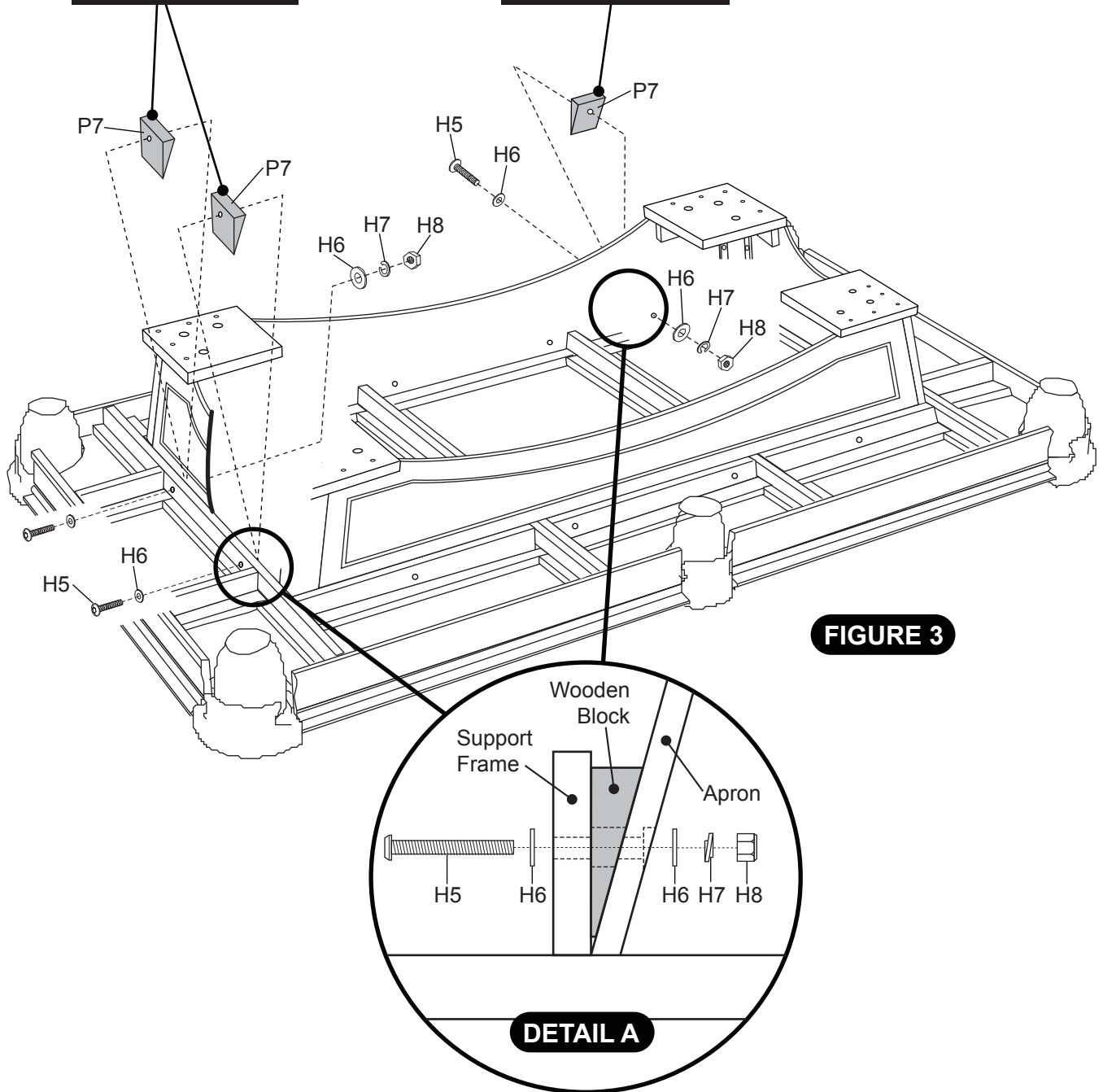

FIGURE 3

DETAIL A

PARTS REQUIRED:

| | |
|------------------------------------|-------------------------------|
| 12 pcs - H6 Flat Washer | 4 pcs - P5 Leg |
| 12 pcs - H7 Lock Washer | 1 pc - T1 Allen Wrench |
| 12 pcs - H9 Allen Head Bolt | |

STEP 4:

Install **P5** Legs to each **P6** Leg Support Brace using **H9** Allen Head Bolts, **H6** Flat Washers and **H7** Lock Washers as shown in **FIGURE 4**. Use **T1** Allen Wrench to tighten all **H9** Bolts.

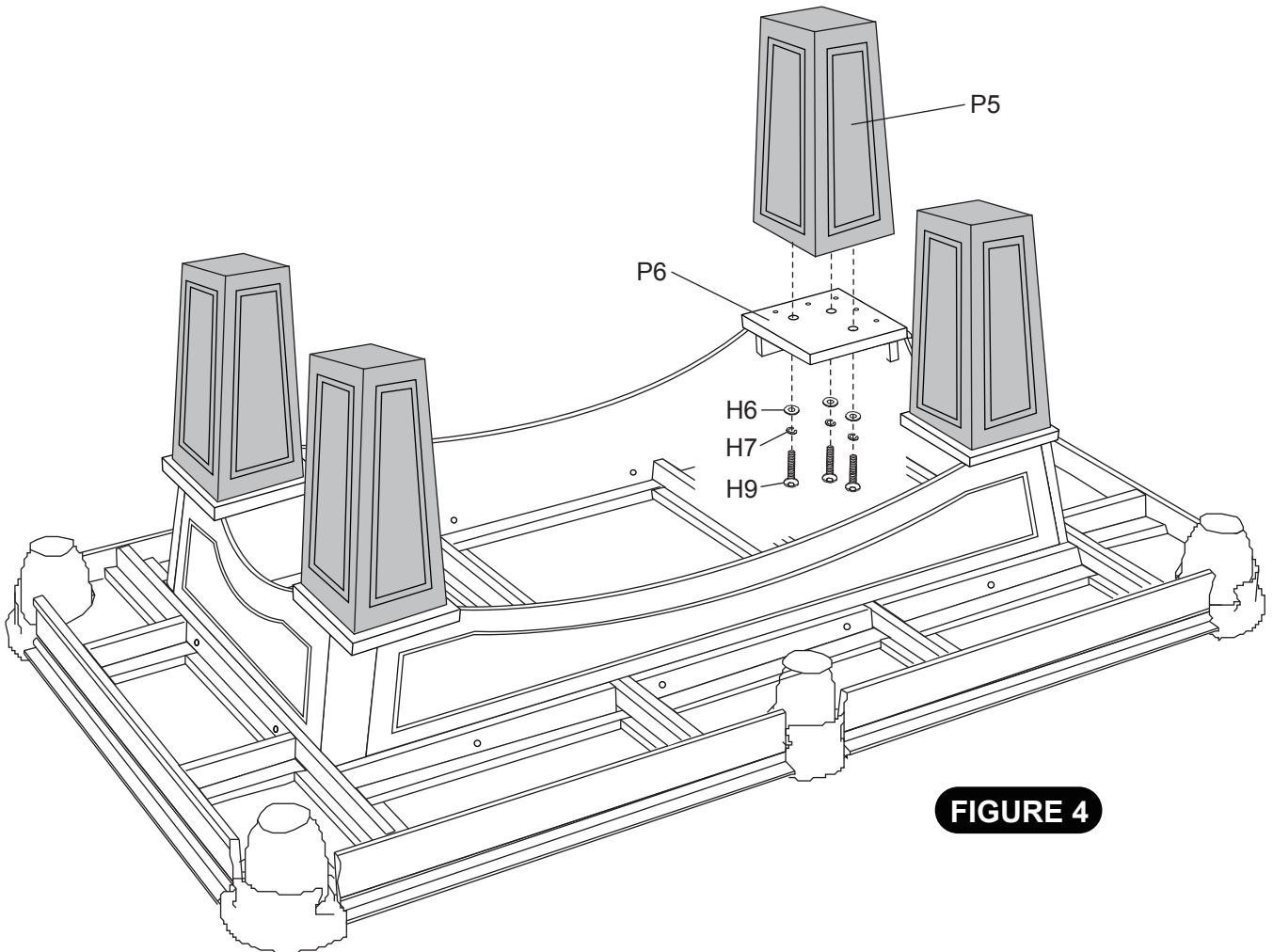

FIGURE 4

! ATTENTION:

THIS STEP REQUIRES FOUR OR MORE ADULTS.

VERY CAREFULLY TURN THE TABLE OVER AND SET IT ON ITS LEGS. BE CAREFUL. THE TABLE IS VERY HEAVY.

DO NOT REST TABLE ON THE TWO SIDE LEGS WHILE TURNING THE TABLE UPRIGHT AS THIS COULD DAMAGE THE LEGS.

INSTRUCTIONS FOR LEVELING A POOL TABLE

- Assemble pool table according to the instruction.
- Any type of level would be sufficient to perform this procedure. However, a two-foot level is recommended.
- Before leveling, make sure level is placed on the playing surface, not the rails.
- Level the ends between the corner pockets: Place the level on the playing surface between the two corner pockets and adjust the height by placing shims (A6) underneath the leg apposite of which the bubble in the level favors until the bubbles rests in the middle of the level.

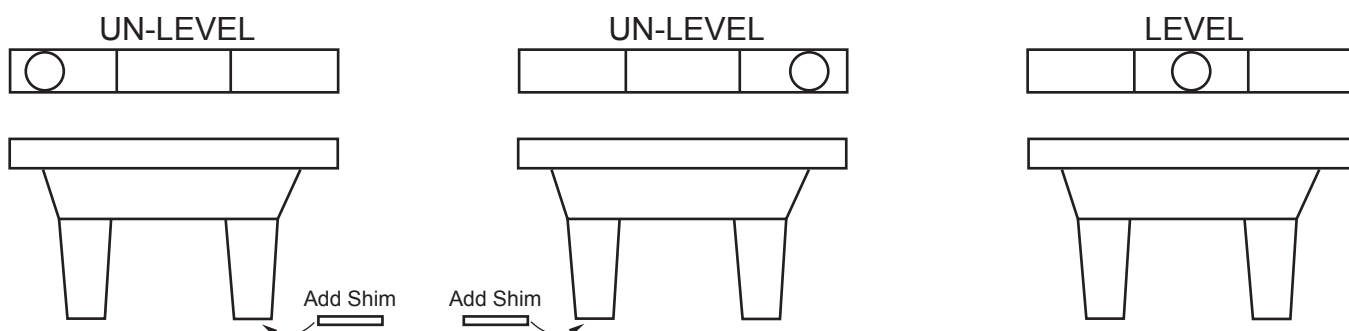

- Repeat the step above to the opposite corner pockets.
- Next, level the length of the table. Place the level next to the side pocket and adjust the height to position the bubble in the middle of the level, using the shims beneath the leg opposite of which the bubble in the level favors.
- Repeat the step above to the opposite length of the table.
- Recheck both short ends to ensure bubble is in the middle on the level.
- Depending on the surface the pool table sits, especially deep pile carpeting, the pool table needs to settle for 24 hours. Recheck the level on each side of the table after 24 hours.

Congratulations! You have now assembled your pool table. Please note the Care and Use instructions below to insure many years of trouble free use of your pool table.

CARE AND USE OF YOUR TABLE

1. Use spray furniture polish to clean all exterior surfaces of your pool table.
2. Use the table brush provided to clean the cloth on the table.
3. This product is intended for **INDOOR** use only.
4. **DO NOT** sit, climb or lean on the table.
5. **DO NOT** drag the table when moving it. This will damage the legs.
6. **DO NOT** set drinks on the table.
7. The purchase of a pool table cover will both protect and help keep clean the entire top of the pool table.

MFT901-TBL PRODUCT PARTS LISTS

| Part# | Key# | Description | Qty |
|----------------|------|--|-----|
| MFT901-TBLDOH1 | H1 | 1/4" x 1-1/4" Allen Head Bolt | 16 |
| MFT901-TBLDOH2 | H2 | 1/4" Flat Washer | 16 |
| MFT901-TBLDOH3 | H3 | 1/4" Lock Washer | 16 |
| MFT901-TBLDOH4 | H4 | 4 mm x 10 mm Phillips Round Head Screw | 16 |
| MFT901-TBLDOH5 | H5 | 5/16" x 2-1/4" Allen Head Bolt | 12 |
| MFT901-TBLDOH6 | H6 | 5/16" Flat Washer | 36 |
| MFT901-TBLDOH7 | H7 | 5/16" Lock Washer | 24 |
| MFT901-TBLDOH8 | H8 | 5/16" Nut | 12 |
| MFT901-TBLDOH9 | H9 | 5/16" x 1-1/2" Allen Head Bolt | 12 |
| MFT901-TBLDOT1 | T1 | Allen Wrench | 1 |
| MFT901-TBLDOT2 | T2 | Wrench | 1 |
| MFT901-TBLDOP1 | P1 | Pool Table Cabinet | 1 |
| MFT901-TBLDOP2 | P2 | Side Apron | 2 |
| MFT901-TBLDOP3 | P3 | End Apron | 2 |
| MFT901-TBLDOP4 | P4 | Corner Post | 4 |
| MFT901-TBLDOP5 | P5 | Leg | 4 |
| MFT901-TBLDOP6 | P6 | Leg Support Brace | 4 |
| MFT901-TBLDOP7 | P7 | Wooden Block | 12 |
| MFT901-TBLDOA1 | A1 | Cue Stick | 2 |
| MFT901-TBLDOA2 | A2 | Triangle | 1 |
| MFT901-TBLDOA3 | A3 | Playfield Cloth Brush | 1 |
| MFT901-TBLDOA4 | A4 | Cue Chalk | 2 |
| MFT901-TBLDOA5 | A5 | Billiard Ball Set | 1 |
| MFT901-TBLDOA6 | A6 | Leveling Shim | 10 |
| MFT901-TBLDOK1 | K1 | Hardware Kit | 1 |
| MFT901-TBLDOM1 | M1 | Owner's Manual | 1 |

90 DAY LIMITED WARRANTY

This customer warranty extends to the original owner, on the purchase of any ESCALADE SPORTS Product (hereinafter referred as the "Product").

WARRANTY DURATION: This Product is warranted to the original owner, for a period of 90 days from the original purchase.

WARRANTY COVERAGE: ESCALADE SPORTS warrants to the original owner, this product to be free from defects in material and workmanship when used for the intended purpose under normal use and conditions. THIS WARRANTY IS VOID IF THE PRODUCT HAS BEEN DAMAGED BY ACCIDENT, UNREASONABLE USE, NEGLIGENCE, IMPROPER SERVICE, FAILURE TO FOLLOW INSTRUCTIONS PROVIDED WITH THE PRODUCT OR OTHER CAUSES NOT ARISING OUT OF DEFECTS IN MATERIAL AND WORKMANSHIP.

WARRANTY REPLACEMENT: During the above 90 day warranty period, ESCALADE SPORTS shall provide replacement components or replace with a comparable product at our choosing. If product is defective under normal use and proper care, please contact our Customer Service Dept.

1-866-556-2757 / Customer Service Dept.

Or Write us at:

Escalade® Sports, Inc. - P.O. Box 889, Evansville, IN 47706

Attn: Customer Service Dept.

Or E-mail us at:

customerservice@escaladesports.com

Other than shipping requirements no charge will be made for such replacement of in-warranty Products.

WARRANTY DISCLAIMERS: ANY IMPLIED WARRANTIES ARISING OUT OF THIS SALE, INCLUDING BUT NOT LIMITED TO THE IMPLIED WARRANTIES OF MERCHANTABILITY AND FITNESS FOR A PARTICULAR PURPOSE, ARE LIMITED IN DURATION TO THE ABOVE 90 DAY PERIOD. ESCALADE SPORTS SHALL NOT BE LIABLE FOR LOSS OF USE OF THE PRODUCT OR OTHER CONSEQUENTIAL OR INCIDENTAL COSTS, EXPENSES OR DAMAGES INCURRED BY THE CONSUMER OF ANY OTHER USE.

Some states do not allow the exclusion or limitation of implied warranties or consequential or incidental damages, so the above limitations or exclusions may not apply to you.

LEGAL REMEDIES: This warranty gives you specific legal rights and you may also have other rights which may vary from state to state.