



Sure Cut™ Can Opener

READ BEFORE USE

Ouvre-boîtes Sure Cut™ À LIRE AVANT UTILISATION

Abrelatas Sure Cut™

LEA ANTES DE USAR

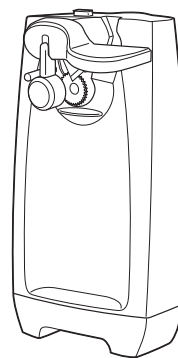

English 2

USA: 1-800-851-8900

Français 7

Canada : 1-800-267-2826

Español 12

En México: 01-800-71-16-100

Le invitamos a leer cuidadosamente este instructivo antes de usar su aparato.

840194801

IMPORTANT SAFEGUARDS

When using electrical appliances, basic safety precautions should always be followed, including the following:

1. Read all instructions.
2. To protect against risk of electrical shock, do not put can opener body, cord, or plug in water or other liquid.
3. Close supervision is necessary when any appliance is used by or near children.
4. Unplug from outlet when not in use, before putting on or taking off parts, and before cleaning.
5. Avoid contacting moving parts.
6. Do not operate any appliance with a damaged cord or plug, or after the appliance malfunctions or is dropped or damaged in any manner. Call our toll-free customer service number for information on examination, repair, or electrical or mechanical adjustment.
7. The use of attachments not recommended or sold by the appliance manufacturer may cause fire, electric shock, or injury.
8. Do not use outdoors.
9. Do not let cord hang over edge of table or counter, or touch hot surfaces.
10. Do not open pressurized (aerosol-type) cans.
11. Do not open cans of flammable liquids such as lighter fluid.

SAVE THESE INSTRUCTIONS!

OTHER CONSUMER SAFETY INFORMATION

This appliance is intended for household use only.

WARNING! Shock Hazard: This appliance has a polarized plug (one wide blade) that reduces the risk of electric shock. The plug fits only one way into a polarized outlet. Do not defeat the safety purpose of the plug by modifying the plug in any way or by using an adapter. If the plug does not fit, reverse the plug. If it still does not fit, have an electrician replace the outlet.

Parts and Features

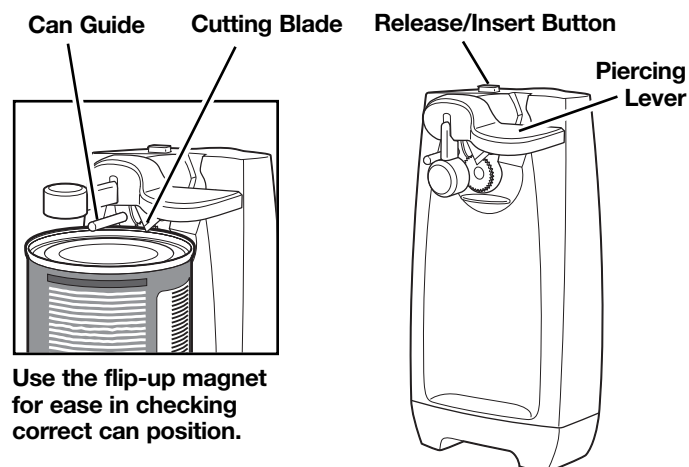

Using Your Can Opener

1. Place can opener on level surface.
2. Plug cord into electrical outlet.
3. Lift up piercing lever.
4. Place rim of can firmly under can guide and against geared wheel.
5. Tilt top of can in, to position cutting blade inside rim of can.
6. Press piercing lever all the way down.
7. The motor will begin turning can and cutting lid. (It is not necessary to hold the piercing lever down or to hold the can during the cutting action.)
8. The motor will stop automatically when the can is open.

Hints for Best Use

- The can opener will easily open all standard-size cans.
- On some models, it will be necessary to position can opener at edge of counter, allowing for clearance to open cans taller than the can opener. To ensure taller cans do not fall from can opener, place hand under can.
- If there is a bump, dent, or heavy seam in rim of can, open other end of can or start cutter just beyond it.
- Cans made with aluminum lids will not adhere to magnet.
- The motor of your can opener is permanently lubricated and will require no oiling.
- To use cord storage on back of opener, push in or pull out cord as needed.

Cleaning Your Can Opener

1. Unplug cord from electrical outlet.
2. To remove piercing lever: Push Release/Insert Button to right. Grasp magnetic lid holder and pull lever out.
3. Wash cutting assembly in hot, soapy water. Rinse and dry thoroughly.
4. Wipe body of can opener with damp cloth. NEVER immerse the can opener in water.
5. To insert piercing lever: Push Release/Insert Button to right and insert lever. Ensure lever is fully inserted into the can opener.

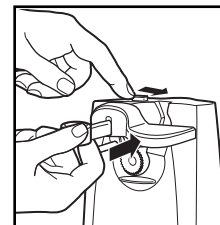
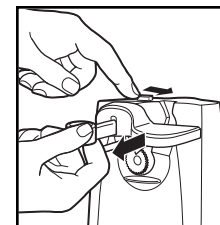

Sharpening Knives

This feature is on selected models.

1. Place cutting edge of knife in knife slot located on back of can opener.
2. Draw knife blade through slot several times.

NOTICE: To prevent damage to the can opener and knives, do not insert serrated blades into this unit.

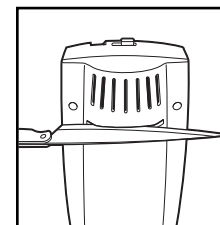

LIMITED WARRANTY

This warranty applies to products purchased in the U.S. and Canada. This is the only express warranty for this product and is in lieu of any other warranty or condition.

This product is warranted to be free from defects in material and workmanship for a period of one (1) year from the date of original purchase. During this period, your exclusive remedy is repair or replacement of this product or any component found to be defective, at our option; however, you are responsible for all costs associated with returning the product to us and our returning a product or component under this warranty to you. If the product or component is no longer available, we will replace with a similar one of equal or greater value.

This warranty does not cover glass, filters, wear from normal use, use not in conformity with the printed directions, or damage to the product resulting from accident, alteration, abuse, or misuse. This warranty extends only to the original consumer purchaser or gift recipient. Keep the original sales receipt, as proof of purchase is required to make a warranty claim. This warranty is void if the product is used for other than single-family household use.

We exclude all claims for special, incidental, and consequential damages caused by breach of express or implied warranty. All liability is limited to the amount of the purchase price. **Every implied warranty, including any statutory warranty or condition of merchantability or fitness for a particular purpose, is disclaimed except to the extent prohibited by law, in which case such warranty or condition is limited to the duration of this written warranty.** This warranty gives you specific legal rights. You may have other legal rights that vary depending on where you live. Some states or provinces do not allow limitations on implied warranties or special, incidental, or consequential damages, so the foregoing limitations may not apply to you.

To make a warranty claim, do not return this appliance to the store. Please call 1.800.851.8900 in the U.S. or 1.800.267.2826 in Canada or visit proctorsilex.com in the U.S. or proctorsilex.ca in Canada. For faster service, locate the model, type, and series numbers on your appliance.