



## Pressure Washer



OWNER'S MANUAL

MODEL NO.

**PW3200**

## Congratulations on your purchase of an All Power™ PW3200 Pressure Washer!

All Power™ designs and builds pressure washers with the consumer in mind. With proper use and maintenance, this Pressure Washer will bring years of service. This 'Owner's Manual' will provide you with a good basic understanding of the operation and maintenance of this machine. **Every effort has been made to ensure the accuracy and completeness of the information in this package. We reserve the right to change, alter and/or improve the product and this document at any time without prior notice.**

### IMPORTANT INFORMATION

This manual contains important notations that you need to know and understand to protect YOUR SAFETY and to PREVENT EQUIPMENT PROBLEMS.



This is a safety alert symbol. This is used to alert you to potential personal injury hazard. Obey all safety messages that follow this symbol to avoid possible injury or death.

#### **⚠ WARNING ⚠**

A **WARNING** indicates a hazardous situation which, if not avoided, could result in death or serious injury.



A **NOTE** indicates special precautions that must be taken to avoid damage to the machine or other property.

**READ AND UNDERSTAND ALL SAFETY PRECAUTIONS IN THIS MANUAL BEFORE OPERATING. FAILURE TO COMPLY WITH INSTRUCTIONS IN THIS MANUAL COULD RESULT IN PERSONAL INJURY, PROPERTY DAMAGE, AND/OR VOIDING YOUR WARRANTY. ALLPOWER™ AMERICA WILL NOT BE LIABLE FOR ANY DAMAGE DUE TO FAILURE OF COMPLYING THESE INSTRUCTIONS.**

**SAFETY INFORMATION .....4**  
 Important Safety Tips ..... 4 - 5  
 Safety Features..... 6  
 Removing Pressure Washer from Carton ..... 6

**COMPONENTS & FEATURES .....7**  
 Parts Included..... 7  
 Pressure Washer Features ..... 7

**INSTALLATIONS .....8**  
 Installing the Wheel Kit ..... 8  
 Pressure Hose to Pump ..... 8  
 Pressure Hose to Spray Gun..... 8  
 Connecting Spray Wand to Spray Gun ..... 8  
 Selecting the Right Nozzle ..... 8 - 9  
 Connecting Nozzles to Spray Wand..... 9  
 Connecting Water Supply to Pump ..... 9

**PRE-OPERATION .....10**  
 Adding Engine Oil..... 10  
 Adding Fuel..... 10

**TECHNICAL DATA .....10**

**OPERATION.....11**

Start-up Procedure ..... 11  
 Starting Engine..... 11  
 Using Detergents ..... 12  
 Cleaning Techniques ..... 12  
 Application of Soap or Degreaser..... 12 - 13  
 Application of Wax..... 13

**MAINTENANCE.....13**  
 Connections ..... 13  
 Nozzle..... 13  
 Engine Maintenance..... 13

**STORAGE .....14**  
 Pump Storage..... 14  
 Engine Storage..... 14

**NOTES .....15**

**TROUBLESHOOTING.....16 - 17**

**NOTES .....18 - 21**

**CONSUMER INFORMATION .....22**  
 Identification Number Records ..... 22

Read and understand all Safety Precautions in this manual before operating. Failure to comply with instructions in this manual could result in personal injury, property damage and/or voiding of your warranty. All Power will not be liable for and damage because of failure to follow these instructions.

### Pressure Washer

The following safety precautions apply whenever using, storing, or servicing your pressure washer to reduce the possibility of personal injury. Overlooking or ignoring these precautions can lead to personal injury or product damage.

### SAFETY GUIDELINES - DEFINITIONS

This manual contains important information that you need to know and understand in order to protect YOUR SAFETY and to PREVENT EQUIPMENT PROBLEMS. The following symbols help you recognize this information. Please read the manual and pay attention to these sections.

### SAVE THESE IMPORTANT SAFETY INSTRUCTIONS!

#### WARNING

A **WARNING** indicates a certainty or strong possibility of personal injury or death if instructions are not followed.

#### CAUTION

A **CAUTION** indicates a possibility of equipment damage if instructions are not followed.

 A **NOTE** indicates helpful information.

#### WARNING

IMPROPER OPERATION OR MAINTENANCE OF THIS PRODUCT COULD RESULT IN SERIOUS INJURY AND PROPERTY DAMAGE. READ AND UNDERSTAND ALL WARNINGS AND OPERATING INSTRUCTIONS BEFORE USING THIS EQUIPMENT. WHEN USING PRESSURE WASHER, BASIC SAFETY PRECAUTIONS SHOULD ALWAYS BE FOLLOWED TO REDUCE THE RISK OF PERSONAL INJURY.

### IMPORTANT SAFETY TIPS

- This equipment is designed for specific applications. Do not modify or use for any application other than which it is designed for.
- Store the pressure washer in a well ventilated area with the fuel tank empty. Fuel should not be stored near the pressure washer.
- Never operate pressure washer under these conditions:
  - a. A noticeable change in engine speed.
  - b. A noticeable loss of pressure.
  - c. Engine misfires.
  - d. Smoke or flames are present.
  - e. Enclosed area.
  - f. Excessive vibration.
  - g. Rain or bad weather.
- Water spray must never be directed towards people, pets, electric wiring or directly towards the pressure washer.
- Do not allow the hose to come in contact with the hot muffler.

**IMPORTANT SAFETY TIPS (cont'd)**

- Equipment must be placed on a firm supporting surface.
- Remove the spark plug or cable from the spark plug to prevent accidental starting when not in use, or prior to detaching the high pressure hose.
- Keep the pressure washer clean and free of oil, mud and other foreign matter.
- Do not wear loose clothing, jewelry or anything that may be caught in the engine.
- Never direct spray at people or animals.
- Never allow children to operate pressure washer at any time.
- Use both hands to control the wand.
- Do not touch the nozzle or water spray while operating.
- All hose connections must be properly sealed.
- In extremely cold conditions, prior to starting, be sure ice has not formed in any part of the pressure washer. Do not operate under 40° fahrenheit.
- Use only recommended chemicals.
- Outdoor use only.
- Place pressure washer away from cleaning site during operation.
- To prevent accidental discharge, the spray gun should be secured by locking the trigger when not in use.
- Do not run the pressure washer more than 5 minutes without depressing the trigger or damage to the pump may occur.
- Check the pressure washers periodically for damage, leaks or signs of deterioration. All defects should be corrected before operating the pressure washer.
- Do not touch hot muffler.
- Service, operate and refuel under the following conditions:
  - a. Good ventilation
  - b. Refuel the pressure washer in a well lit area.
  - c. Avoid fuel spills and never refuel while the pressure washer is running.
  - d. Avoid any ignition source when refueling.
  - e. Use unleaded gasoline with a pump octane rating of 90 or higher.
- Do not smoke near pressure washer.

### SAFETY FEATURES

#### Thermal Relief Valve

A thermal relief valve is provided to protect the pump from overheating if the spray gun is closed for an extended amount of time or the nozzle becomes plugged. However, it is intended to be used as a backup system and every effort should be made to not permit the pump to heat up.

We recommend to turn the pressure washer OFF if it will not be used for more than 5 minutes. This saves wear on the unit, reduces fuel consumption and extends the life of the pump by avoiding overheating.

#### Safety Lock Latch

To prevent accidental discharge of high pressure water, the safety latch on the trigger should be engaged whenever the pressure washer is not in use.

#### Low-Oil Shutdown

Some engines are equipped with low-oil shutdown systems. If the engine oil level becomes lower than required, the pressure washer will automatically shut off. Refer to the engine manual for this feature. This protects your pressure washer engine from operating without proper lubrication.

If the pressure washer engine shuts off and the oil level is according to specification, check to see if the pressure washer is sitting on an angle that forces the oil to shift. Place on even surface to correct this. If the engine fails to start, there may not be enough oil to deactivate the low oil level switch.

#### **⚠ WARNING ⚠**

**Pump will overheat and may be damaged, or cause damage if allowed to circulate more than 5 minutes.**

#### Before Operation

**i NOTE: The engine and pump on your pressure washer will often have improved performance after a break-in period of several hours.**

Your Pressure Washer requires some assembly. This unit ships from our factory without oil. It must be properly service with fuel and oil before operation.

If you have any questions regarding the assembly of your Pressure Washer or missing parts, call our Customer Care Center at **1-888-896-6881**. Please have your serial number and model number available.

#### Removing the Pressure Washer from the Shipping Carton

1. Set the shipping carton on a solid, flat surface.
2. Remove everything from the carton except the pressure washer.
3. Carefully cut each corner of the box from top to bottom. Fold each side flat on the ground to provide a surface area.
4. Inspect for completeness of all loose parts and components.

**PARTS INCLUDED**

Check all loose parts against the following list:

- 10 in. Wheel.....2
- Frame Support.....2
- Axle.....2
- Carriage Bolt.....4
- Flat Washer 10 mm.....4
- Wingnut.....4

**Other:**

- Oil .....0.63 qt. (0.6 L)
- Oil Funnel.....1
- Spark Plug Socket.....1

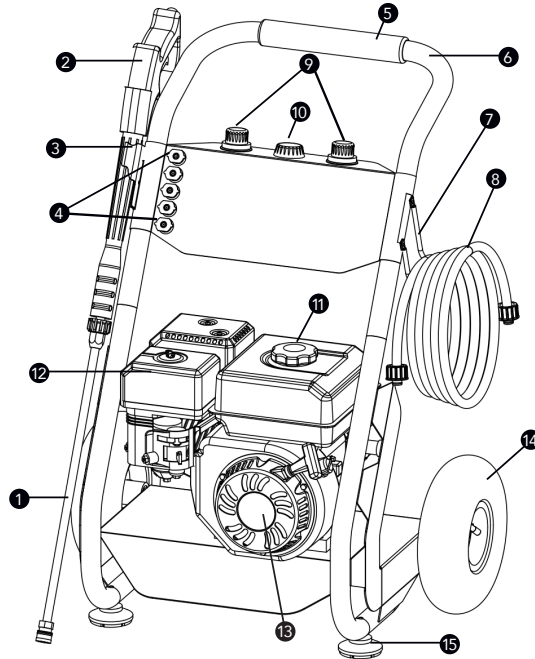

**PRESSURE WASHER FEATURES:**

1. Spray Wand
2. Spray Gun
3. Gun Holder
4. Pressure Nozzles (5)
5. Handle Grip
6. Handle
7. High Pressure Hose Holder
8. High Pressure Hose
9. Detergent Bottle Cap
10. Detergent Bottle Switch
11. Fuel Tank Cap
12. Air Filter
13. Recoil Starter
14. Wheel Kit
15. Feet

### Installing the Wheel kit

1. Before adding oil to the engine, carefully tip the pressure washer forward and place on its front side.
2. Slide the axle through the washer and front of wheel.
3. Slide another washer to the back of wheel and through the mount point on the frame.
4. Repeat steps 2 and 3 to attach the second wheel.
5. Assemble the handle to the frame tubing.

**i NOTE:** Align threaded connections carefully to prevent damaging threads during assembly. Tighten connections securely to prevent leaks during operation.

### PRESSURE HOSE TO PUMP

Connect the pressure hose to the pump outlet and **FIRMLY** tighten the nut by hand.

**i NOTE:** Do not use pressure hose from another manufacturer.

### PRESSURE HOSE TO SPRAY GUN

Connect the hose to the spray gun and **FIRMLY** tighten the nut by hand.

### CONNECTING SPRAY WAND TO SPRAY GUN

Remove the protective plastic cap at the inlet of the wand.

Connect the spray wand to the spray gun and **FIRMLY** tighten the nut by hand.

### SELECTING THE RIGHT NOZZLE

**i NOTE:** To prevent damage to your surface and to select an appropriate nozzle size for your application, always start with lowest pressure nozzle size (White) and continue changing to the higher nozzle size until the best work result is achieved.

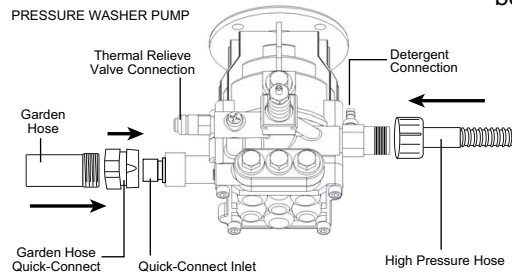

The Pressure Washer comes furnished with five spray nozzles. Each nozzle is color coded and delivers a specific spray pattern and pressure for a particular cleaning job. The size of the nozzle determines the size of the fan spray and the pressure out of the nozzle.

#### 0° Nozzle - Red: Cutting

This nozzle delivers a pinpoint stream of pressurized water and is extremely powerful. It covers only a small area of cleaning. This nozzle should only be directed at surfaces that can withstand high pressure such as metal or concrete. Do not use this nozzle to clean wood.

#### 15° Nozzle - Yellow: Chiseling

This nozzle delivers a powerful 15 degree spray pattern for intense cleaning of small areas. This nozzle should only be used on areas and materials that can withstand high pressure.

#### 25° Nozzle - Green: Flushing

This nozzle delivers a 25 degree spray pattern for intense cleaning of larger areas. This nozzle should only be used on areas that can withstand pressure from this nozzle.

#### 40° Nozzle - White: Washing

This nozzle delivers a 40 degree spray pattern and a less powerful stream of water. This nozzle can cover a wide area and should be used for most general cleaning jobs.

#### Chemical Nozzle - Black: Detergent Application

This nozzle is used to apply special chemicals and cleaning solutions. This nozzle produces the weakest pressure stream of the five nozzles.

### CONNECTING NOZZLES TO SPRAY WAND

#### ⚠ WARNING ⚠

Never place hands in front of nozzle.  
Never grasp hose or fittings during Pressure Washer operation. Never attempt to attach or remove spray wand or hose fittings while Pressure Washer system is pressurized. **Turn off Pressure Washer and lock the Gun Trigger** before attempting to change pressure nozzles.

1. To attach, insert nozzle into female quick-disconnect spray wand and press to snap in the nozzle.

2. To detach, slide down slip ring on female quick-disconnect to eject the nozzle.

### CONNECTING WATER SUPPLY TO PUMP

1. Connect the garden hose to the water supply and turn water supply on to fill the hose with water and also remove any debris in the hose. Turn OFF water supply.
2. Make sure that the filter inside Pressure Washer water inlet is clean and undamaged. Thread the garden hose fitting into water hose inlet. **FIRMLY** hand tighten the inlet nut.
3. Turn on water supply.

**i NOTE:** The Pressure Washer requires a minimum of 20 PSI and flow rate of 4 GPM.

**Add Engine Oil**

Oil is a major factor affecting performance and service life. Use 4-stroke automotive detergent oil.

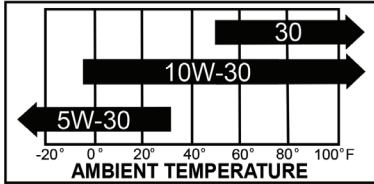

**Recommended Oil**

The SAE oil viscosity and service classification are in the API label on the oil container. The manufacture recommends that you use API SERVICE category SJ or SL oil.

**⚠ CAUTION ⚠**

**Do not attempt to start the pressure washer engine without filling the engine crank case with the proper amount of oil. Your pressure washer has been shipped without oil in the crankcase. Operating the pressure washer without oil will ruin the engine. Use oil that is recommended (10W-30). DO NOT OVERFILL!**

1. Place the Pressure Washer OUTSIDE on a flat and level surface.
2. Remove oil fill cap/dipstick to add oil.
3. Add the supplied engine oil and replace oil dipstick.
3. Hand tighten oil dip stick and wipe off any spilled oil.
4. Check engine oil level daily and add as needed.

**Add Fuel**

1. Use clean, fresh, regular fuel with a pump octane rating of 90 or higher.
2. DO NOT mix oil with fuel.
3. Clean the area around the fuel cap.
4. Remove the fuel cap.
5. Slowly add fuel to the tank. DO NOT overfill. Allow approximately 1/4 inch of space for fuel expansion.
6. Screw on the fuel cap and wipe away any spilled fuel.

**⚠ CAUTION ⚠**

- Use regular unleaded gasoline with a pump octane rating of 90 or higher.
- Do not mix oil and gasoline.
- Fill tank to approximately 1/4" below the top of the tank to allow for fuel expansion.
- Do not fill fuel tank indoors.
- Do not fill fuel tank when the engine is running or hot.
- Do not overfill the fuel tank.
- Do not light cigarettes or smoke when filling the fuel tank.

**TECHNICAL DATA**

<b>Max. Pressure:</b>	3200 PSI
<b>Rated Flow:</b>	2.7 GPM
<b>Engine Model:</b>	GE208
<b>Displacement:</b>	208 cc
<b>RPM:</b>	3400 RPM
<b>Fuel Tank:</b>	1 gallon
<b>Temp. of Pumped Fluids:</b>	Up To 104°F
<b>Discharge Ports:</b>	M22*1.5 φ14mm
<b>Weight:</b>	91.30 lbs
<b>Engine Oil:</b>	10W-30 (SJ or SL)
<b>Fuel:</b>	Unleaded Gas with pump octane rating of 90 or higher

### Start-up Procedure

1. Make sure water supply is connected and turned on.
2. Release gun safety if locked.
3. To allow air to escape from the hose, squeeze trigger on the gun until there is a steady flow of water coming out from the nozzle.

### Starting Engine

1. Check oil and gas.
2. Connect hose and turn on water.
3. Squeeze and hold trigger.
4. Make sure the engine switch is on the ON position (Fig 1).

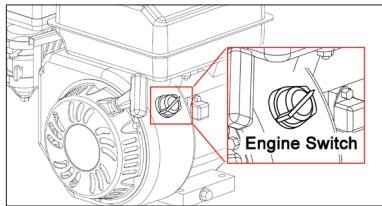

Fig 1. Engine Switch

### Starting Engine (cont'd)

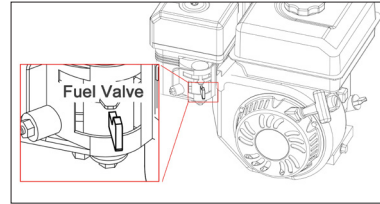

Fig 2. Fuel Valve

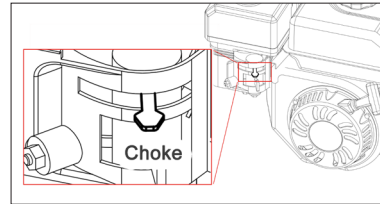

Fig 3. Choke

5. Set the fuel valve to open (Fig 2).
6. Set choke to CLOSE position (Fig 3) & set throttle to slow (Fig 4).

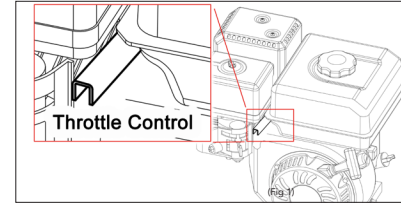

Fig 4. Throttle Control

7. When starting engine, pull cord slowly until resistance is felt, then pull rapidly.
8. If engine starts and fails to continue running or if increase resistance is felt during starting pull attempts, repeat step 3 - 7.

### ⚠ CAUTION ⚠

The pressure washer can be used for a variety of applications including washing cars, boats, patios, decks, garages etc. where high pressure is necessary to remove dirt and debris. High-pressure water flow can damage the work surface if not used properly! See the section titled "Operating Instructions" for more details. Always test the spray in an open area first.

This pressure washer is intended for use only with liquid car wash detergents, developed specifically for pressure washers and with mild soaps. Only use chemicals compatible with the aluminum and brass parts. Powdered soaps may clog the injection system. Always use chemicals according to the manufacturers directions. We assume no responsibility for any damages caused by chemicals injected through this pressure washer.

1. Attach injection tube assembly to the detergent connection on the pump.
2. Open a container of chemicals and place next to the unit near the injection tube.
3. Visually inspect strainer at the end of the injection tube to verify that it is not clogged
4. Insert the injection tube into the container all the way to the bottom.
5. Remove the high pressure nozzle from the wand and install the black injection nozzle.

The solution will automatically mix with the water and discharge through the nozzle.

**i NOTE: For certain models, if the engine throttle is not in the fast position, the injection of the solution may be decreased or stopped.**

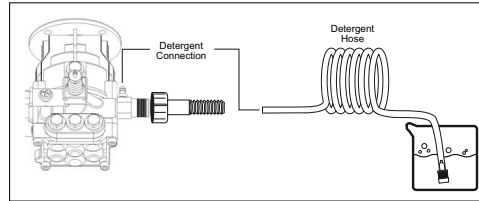

Fig 7

## CLEANING TECHNIQUES

When cleaning with the pressure washer, many cleaning tasks can be solved with water alone, but for most tasks, it is advantageous to use a detergent. A detergent ensures a quick soaking of the dirt allowing the high pressure water to penetrate and remove the dirt more effectively.

## Application of Soap Or Degreaser

1. Apply the solution to the dry work surface.  
On a vertical surface, apply horizontally from side to side starting from bottom to avoid streaking.

**i NOTE: Wetting the surface first is not recommended, it dilutes the detergent and reduces its cleaning effects.**

Please disconnect the Detergent Hose from the Pressure Washer when not in use.

Avoid working on hot surfaces or in direct sunlight to minimize the chances of the chemical damaging painted surfaces. Damage may occur to painted surfaces if the chemical is allowed to dry on the surface. Hold the nozzle far enough away from surface to prevent damage to the surface.

2. Allow chemical to remain on the surface for a short time before rinsing.

**Application of Soap Or Degreaser (cont'd)**

3. Rinse with clean water under high pressure. On a vertical surface, first rinse from the bottom up, then rinse from top down. Hold nozzle 6 to 8 inches from the work surface at a 45° angle using the flat spray as a peeling tool rather than a scrub brush.

**Application of Wax**

1. Immediately after cleaning, apply wax. Place injection tube in container of wax.
  2. Apply the wax sparingly in an even layer. Apply to wet surfaces from bottom up for even distribution and to avoid streaking.
  3. Remove the suction tube from the wax bottle rinse off the surplus wax.
- i** **NOTE:** If surplus wax is not removed, a hazy finish may result.
4. Wipe dry to reduce water spotting.

**End of Operation**

When you have completed use of chemical injection system, remove tube from container. Continue to run in low pressure position and

inject clean water through the tube and injection system by placing end of tube in a container of clean water. Continue to run until it is thoroughly cleaned.

**MAINTENANCE****Connections**

Connection on pressure washer hoses, gun and spray wand should be cleaned regularly and lubricated with the manufacturers recommended grease to prevent leakage and damage to the O-ring.

**Nozzle**

Clogging of the nozzle causes the pump pressure to be too high, cleaning is immediately required.

**▲ WARNING ▲**

**A nozzle cleaner must only be used when the spray wand is disconnected from the gun or personal injury may occur.**

1. Separate the wand from the gun.
2. Clear the nozzle with a small rigid piece of wire such as a paper clip.
3. Flush the nozzle backwards with water.

4. Reconnect the wand to the gun.

Restart the pressure washer and depress the trigger on the spray gun. If the nozzle is still plugged or partially plugged, repeat above instructions 1-4.

If the previous procedure does not clear the nozzle, replace with a new nozzle.

**Engine Maintenance**

During the winter months, rare atmospheric conditions may develop which will cause an icing condition in the carburetor. If this develops, the engine may run rough, lose power and may stall. This temporary condition can be overcome by deflecting some of the hot air from the engine over the carburetor area.

**STORAGE****Pump Storage**

If you must store your pressure washer in a location where the temperature is below 32° F, you can minimize the chance of damage to your machine by utilizing the following procedure:

1. Shut off water supply and relieve pressure to the spray gun by depressing the trigger. Disconnect the garden hose from the pressure washer, but leave the high pressure hose connected.
2. Tip the unit on its side with the inlet connection pointing up.
3. Insert a small funnel (to prevent spilling) into the inlet and pour in approximately 1/4 cup of antifreeze.
4. Disconnect spark plug wire.
5. Without connecting garden hose pull the recoil several times to circulate the antifreeze in the pump system.
6. Reconnect spark plug wire.

**⚠ CAUTION ⚠**

Prior to starting, thaw out any possible ice from the pressure washer hoses, spray gun and wand.

**MAINTENANCE**

Another method of reducing risks of freeze damage is to drain your pressure washer as follows:

1. Stop the pressure washer and detach supply hose and high pressure hose. Squeeze the trigger of the discharge gun to drain all water from the wand and hose.
2. Restart the pressure washer and let it run briefly about 5 seconds) until water no longer discharges from the high pressure outlet.

**Engine Storage**

When the pressure washer is not being used or is being stored for more than a month follow these instructions:

1. Replenish engine oil to upper level.

**Engine Storage (cont'd)**

2. Drain gasoline from fuel tank, fuel line, fuel valve and carburetor.
3. Pour about one teaspoon of engine oil through the spark plug hole. Pull the recoil starter slowly until you feel increase pressure which indicates the piston is on its compression stroke. Leave it in the position. This closes both the intake and exhaust valves to prevent the inside of the cylinder from rusting.
4. Cover the pressure washer and store in a clean, dry place that is well ventilated away from open flame or sparks.

**i NOTE:** The use of a fuel additive, such as STA-BIL, or an equivalent, will minimize the formulation of fuel gum deposits during storage.



**TROUBLESHOOTING GUIDE**

The following troubleshooting guide is recommended for basic or common problems; if there's an issue with the Pressure Washer that is not listed, **please call 1-888-896-6881.**

**i NOTE:** Troubleshooting problems may have similar causes and solutions.

Problem	Probable Cause	Solution
Engine will not start	Low oil shutdown	Fill engine with oil
	Engine switch not in "ON" position	Turn engine switch to the "ON" position
	Pressure built up in hose	Squeeze trigger while starting
Engine is overloaded	Nozzle partially blocked	Clean nozzle
	Excessive pressure	Shorten the spring coil on the reflux valve
Pressure increases when gun is locked	Bypass valve blocking	Clean the bypass valve
Engine is running but pump won't build maximum pressure or has irregular pressure.	Faucet closed partially	Open faucet fully
	Unit has been stored in freezing temperatures	Thaw out unit completely
	Inadequate water supply	Provide a minimum of 4 GPM at 20 PSI
	Water inlet screen clogged	Clean screen
	Kink in garden hose	Straighten garden hose
	Wand nozzle worn or damaged	Replace nozzle
	Air in pump	Run with gun open & wand removed until steady stream of water is released.
	Adjustable pressure knob not set to maximum position	Set to maximum position
	Suction or discharge valves clogged or worn out	Clean the suction or discharge valves
	Bypass valve not operating effectively	Clean the bypass valve

**TROUBLESHOOTING GUIDE**

The following troubleshooting guide is recommended for basic or common problems; if there's an issue with the Pressure Washer that is not listed, **please call 1-888-896-6881**.

**i NOTE:** Troubleshooting problems may have similar causes and solutions.

Problem	Probable Cause	Solution
No intake of chemicals	Injection tube not securely inserted into unit	Push firmly into injector
	Tube cracked or split	Replace tube
	Wrong nozzle	Switch to low pressure nozzle
	Injector turned off	Turn collar counterclockwise
Trigger will not move	Gun safety lock engaged	Release safety lock
Water in crankcase	High humidity	Change oil more frequently
	Worn seals	Change the oil seals
Noisy operation	Worn bearings	Change the bearings
	Air mixed with water	Check inlet lines for restrictions and/or proper sizing
Rough/pulsating, operating with pressure drop	Inlet restriction	Check system for stoppages, air leaks, correctly sized inlet plumbing to pump
	Unloader	Check unloader for proper operation
	Air mix in water	Check inlet lines for restrictions and or proper sizing
High crankcase temperatures	Wrong grade of oil	Use recommended oil
	Improper amount of oil in crankcase	Adjust oil to proper amount









## CONSUMER INFORMATION

MODEL NO.	<input type="text" value="PW3200"/>
SERIAL NO.	<input type="text"/>
DATE OF PURCHASE	<input type="text"/>
PLACE OF PURCHASE	<input type="text"/>

Record your Pressure Washer's model number, serial number, date of purchase and place of purchase in the spaces provided. Have this information available when ordering parts and when making technical or warranty inquiries.

A parts list for your pressure washer can be found at  
**[www.allpoweramerica.com/parts](http://www.allpoweramerica.com/parts)**



