



# Smart Lawn Connect Kit

## Installation Instructions

Congratulations on purchasing a Craftsman Smart Lawn Connect Kit. The **Craftsman Smart Lawn Connect Plug** will easily plug in to the back side of your Craftsman Rider's **Ignition Switch** located on the dashboard.

These instructions apply to **Craftsman Zero Turn** riding mowers (model #247.XXXXX) Please read through entire instruction sequence before beginning installation.



**WARNING** Before performing any maintenance or repairs and to reduce the risk of injury, disengage PTO, set parking brake, stop engine and remove key to prevent unintended starting.

### Installation Guide:

- 1 Using socket wrench, remove (2) bolts between fender and seat with 5/16" socket - extender required, and (1) Torx screw in front with T30 driver from drivers right Fender (see illustration below).

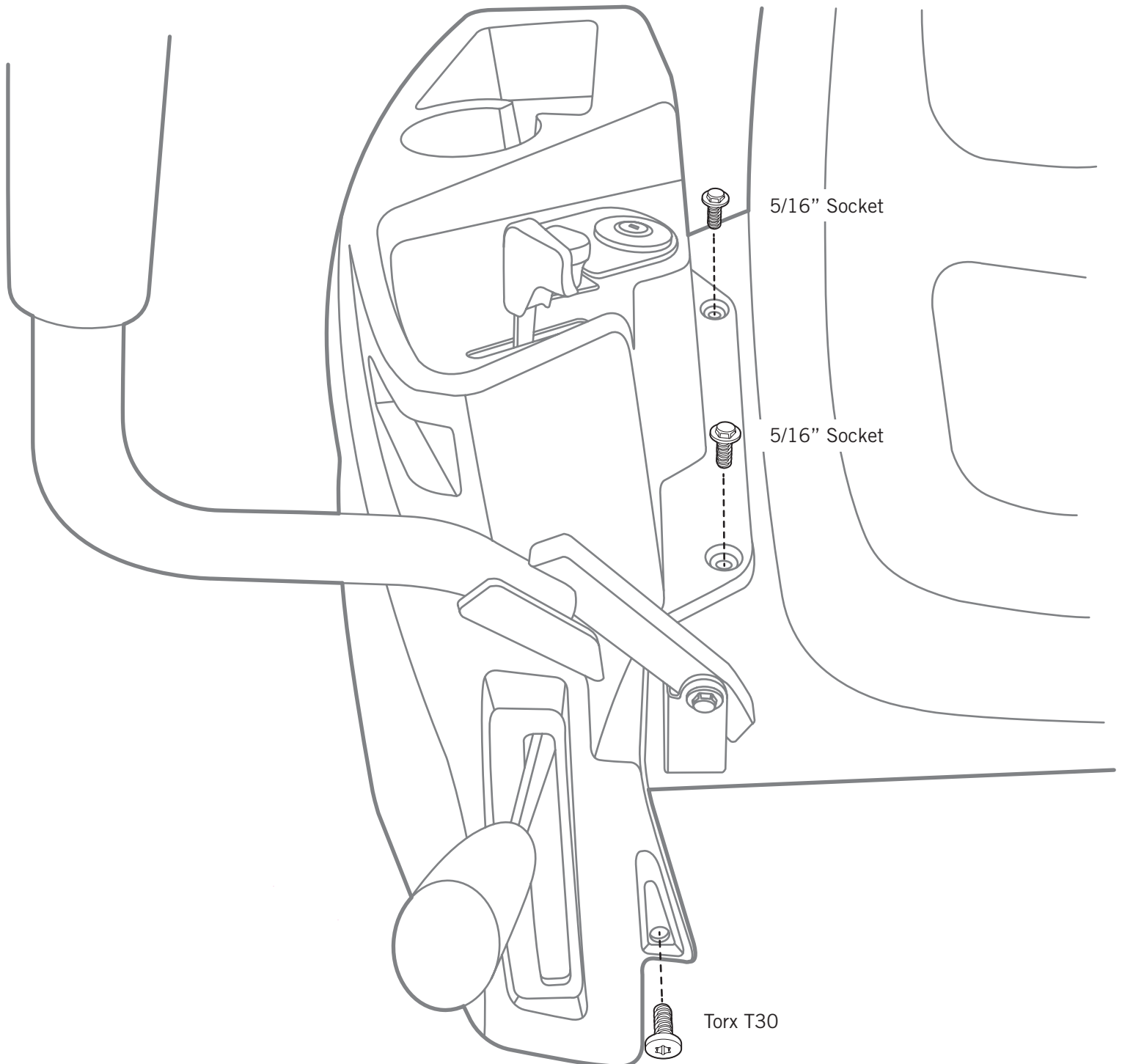



# Smart Lawn Connect Kit Installation Instructions

- 2 Remove final (2) bolts with 3/8" socket and ratchet underneath the Fender in order to disengage it. The Fender can now be tilted upward to gain access to the back side of the **Ignition Switch** and **Wire Harness Connector**. The **Wire Harness Connector** can now be unplugged (see illustration below).

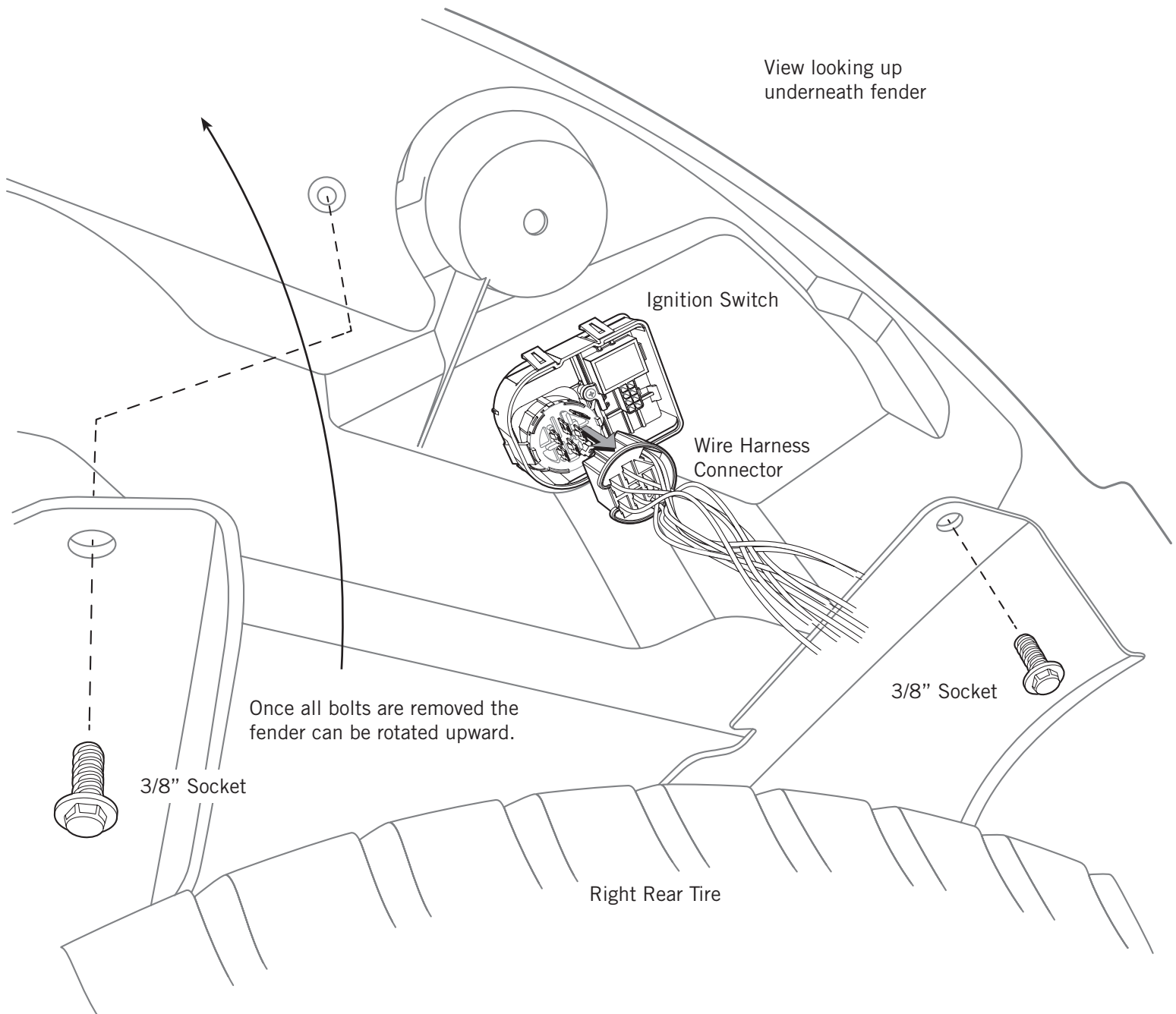



# Smart Lawn Connect Kit

## Installation Instructions

- 3 Note prong configuration and install the **Craftsman Smart Lawn Connect Plug** onto the **Ignition Switch**. Then plug the **Wire Harness Connector** into the **Craftsman Smart Lawn Connect Plug** (refer to illustration below).

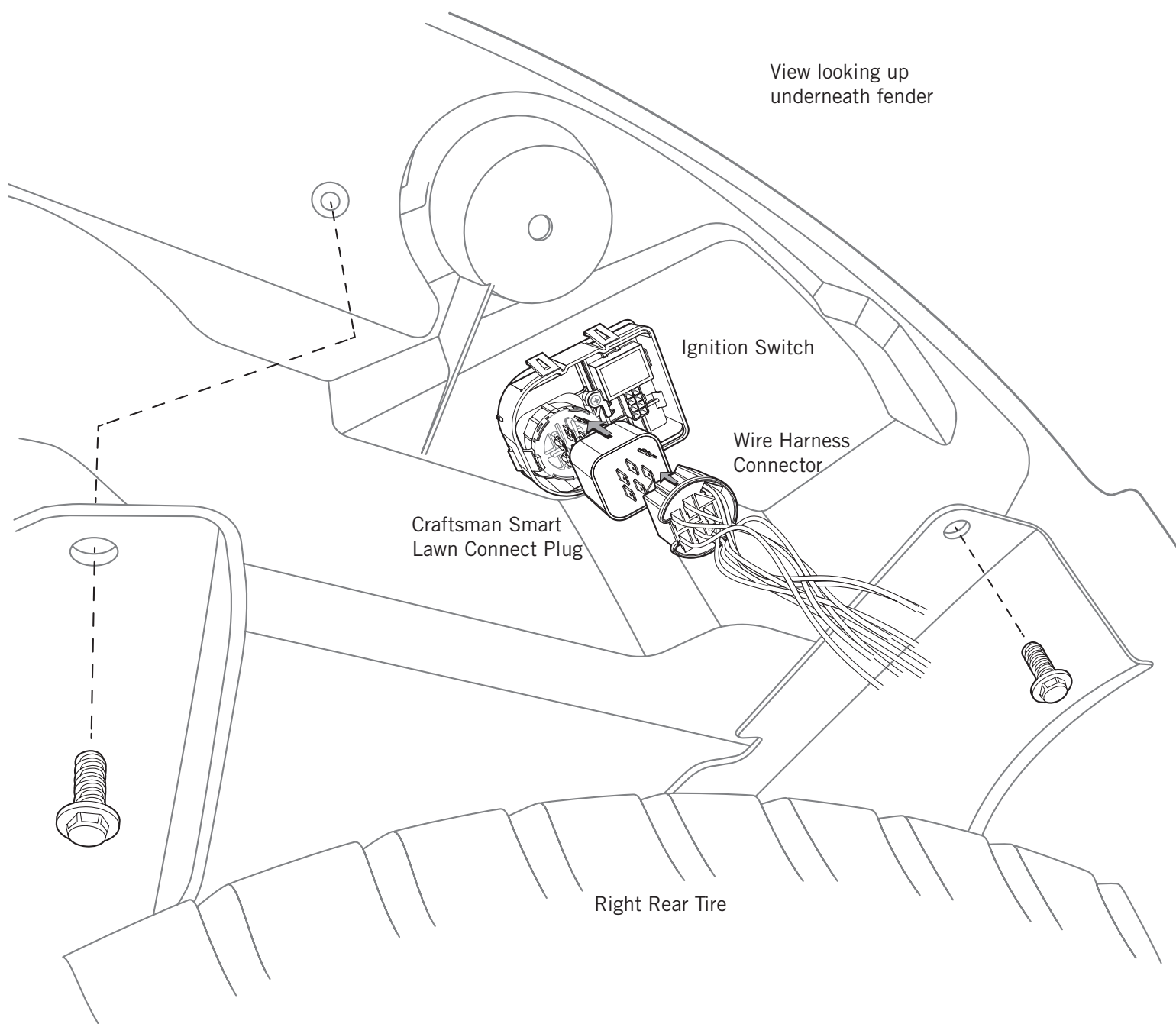



# Smart Lawn Connect Kit

## Installation Instructions

Assembly is complete when the Craftsman Smart Lawn Connect Plug is sandwiched between the other two components.

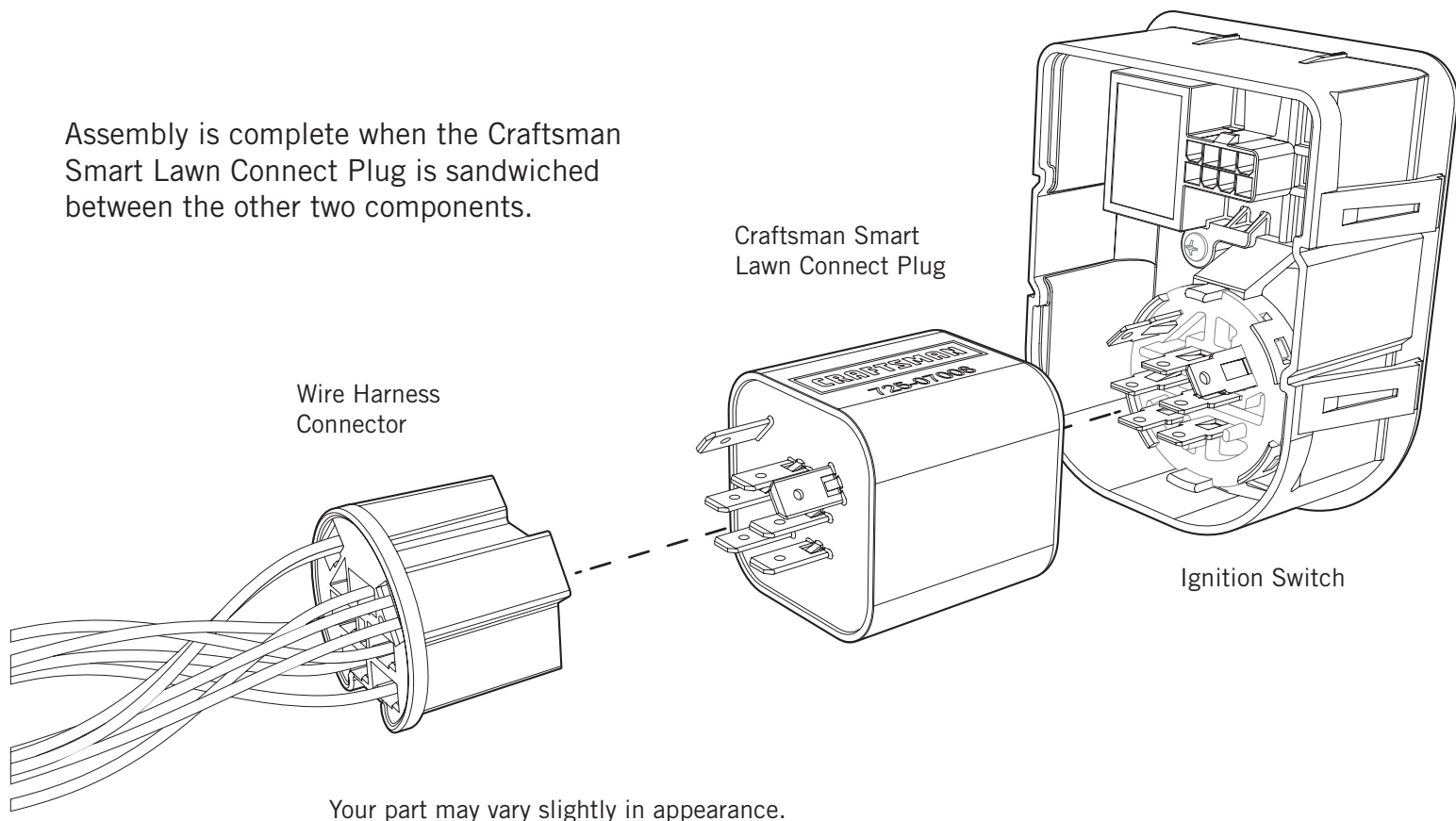

- 4 When all three components are plugged together this is how the plug assembly looks (refer to illustration below). NOTE: The base of the **Ignition Switch** prongs will be visible in the gap between the **Ignition Switch** and the **Craftsman Smart Lawn Connect Plug**. This is intentional, and allows for proper plug functionality.

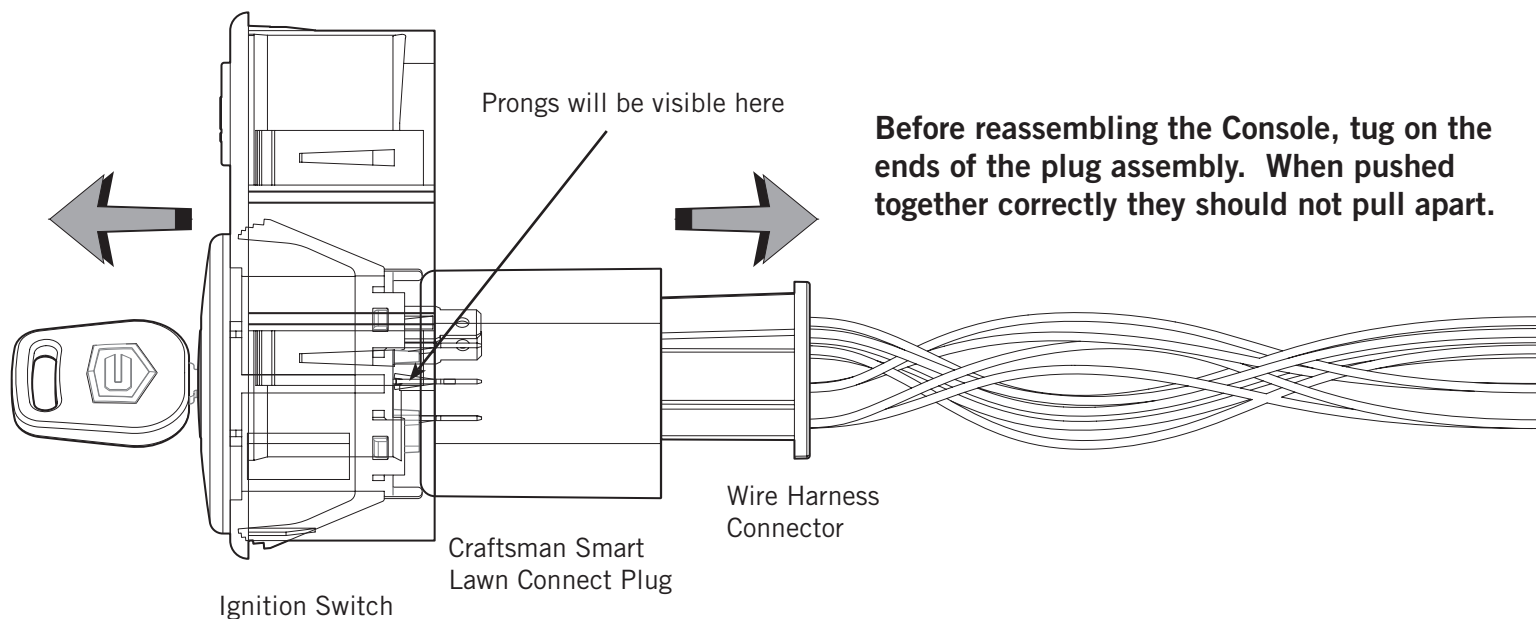



# Smart Lawn Connect Kit

## Installation Instructions

- 5 Once the Plug assembly is secure, move the fender back into place and secure with (5) bolts (1 in front, 2 between fender and seat, and 2 underneath fender) to complete installation (see illustration below).

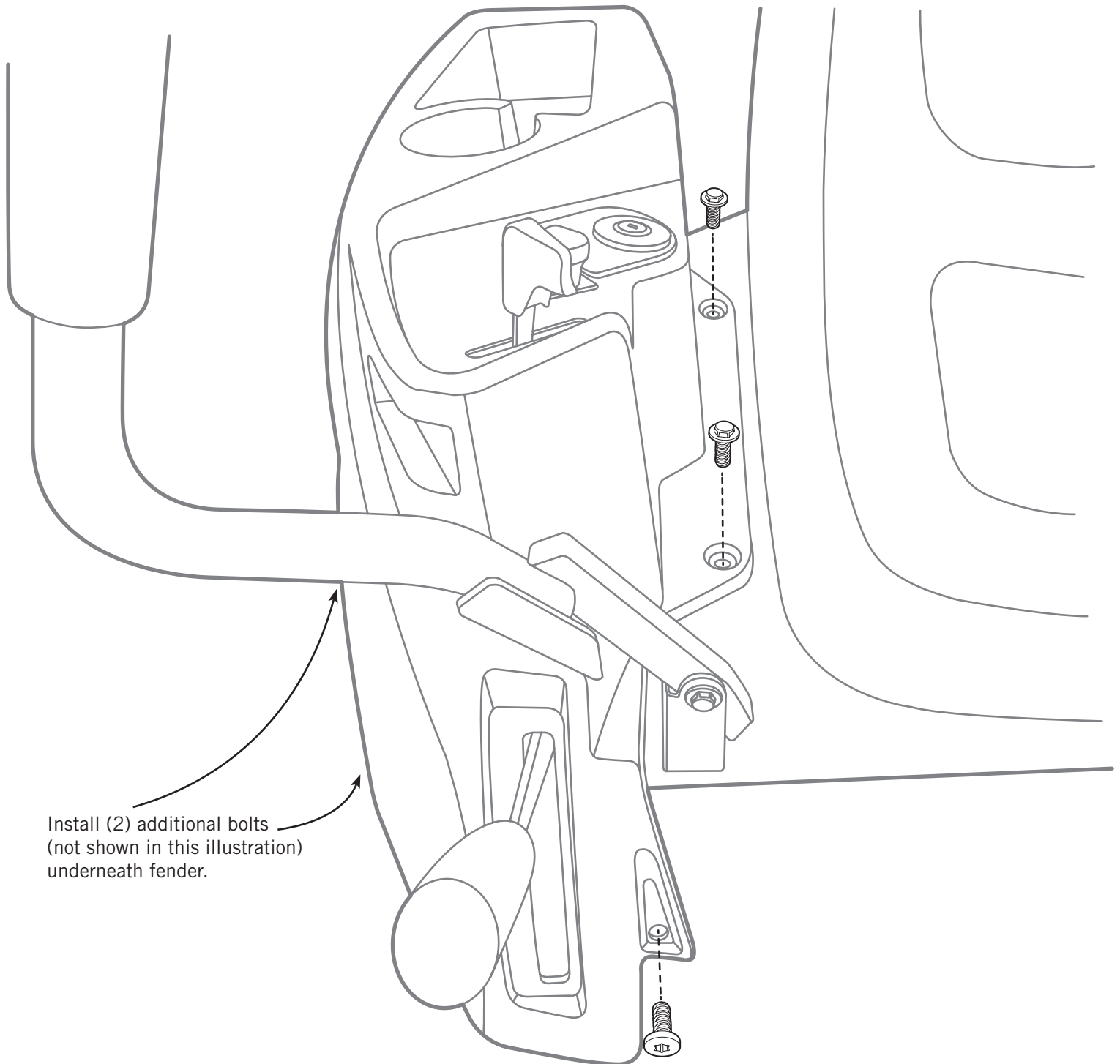

For additional information please refer to: [craftsman.com/connectkit](http://craftsman.com/connectkit)

If you have further questions, call the Craftsman help line at **1-888-331-4569**

Once assembly is complete please download the FREE Craftsman Smart Lawn App to begin using all of the new connectivity features of your Craftsman rider!

