

3M Ergonomics
Office Supplies Division — Full Line Product Catalogue



Solutions You Need
Comfort You Deserve



Your Health. Your Environment. Our Expertise.

The facts are simple - when you feel healthy and free of pain and discomfort you can't help but enjoy a better quality of life, both at work and home. At 3M our goal is to help create the work environment you need.



Are you interested in creating a healthier work environment for yourself?

If so, visit our Interactive Virtual Office where you can learn about Ergonomics in the workplace and see the innovative solutions that 3M Ergonomics Products offer to support your workplace needs.

To find out more, visit us on-line at

www.3m.ca/ergo



In order for you to enjoy the comfort you deserve. It starts with your workspace design, and that starts right here.

Table of Contents

Monitor Arms	3
Monitor Stands	4
Notebook Risers	5
Adjustable Keyboard Trays	7
Adjustable Keyboard Tray Accessories	11
Keyboard Drawers	11
Document Holders	12
Foot Rests	13
Ergonomic Mouse	13
Wrist Rest Technology	14
Wrist Rest Platforms	14
Gel Wrist Rests	15
Mouse Pads	16
Task Lighting	16
Office Air Cleaners	17
Organization Solutions	18
Surface Computer Cleaners	18
Privacy Filters	19
Privacy & Anti-Glare/ Radiation Filters	19
Workstation Guidelines	21

Monitor Arms

MA260MB Easy-Adjust Dual Monitor Arm

- Highly adjustable arms move up, down, forward and back with just a touch
- Provides 22" of height adjustability and 25 ½" extension from base
- Clamp mount hardware fits desk up to 2 5/8" thick and grommet mount hardware fits desks up to 3" thick
- Weight capacity of 20 lbs. per arm
- VESA MIS-D Compliant
- Contains 45% recycled content



Two screens are better than one!

A study by the University of Utah demonstrated that worker productivity increased with the use of two displays compared to using just one.

Productivity benefits: multi-monitor vs. single display

- 33%** Fewer errors
- 18%** Faster in errorless editing of multiple tasks
- 16%** Faster edits throughout task
- 10%** More errorless edits generated
- 7%** Faster to perform tasks
- 6%** Quicker to access tasks (opening, sizing, aligning windows, etc.)

Source: NEC Display Solutions, University of Utah and ATI Technologies, Productivity and Multi-Screen Displays, October 2003.



MA240MB Easy-Adjust Monitor Arm

- Highly adjustable arm moves up, down, forward and back with just a touch
- Provides 22" of height adjustability and 25 ½" extension from base
- Clamp mount hardware fits desk up to 2 5/8" thick and grommet mount hardware fits desks up to 3" thick
- Weight capacity of 20 lbs.
- VESA MIS-D Compliant
- Contains 45% recycled content



MA140MB Dual-Swivel Monitor Arm

- Provides 7 ½" of height adjustability and extends 19 ½" from the base
- Clamp mount hardware fits desks up to 4 ¼" thick and grommet mount hardware fits desks up to 2 ¼" thick
- Weight capacity of 30 lbs
- VESA MIS-D Compliant



MA120MB Single-Swivel Monitor Arm

- Provides 7 ½" of height adjustability and extends 11 ½" from the base
- Clamp mount hardware fits desks up to 4 ¼" thick and grommet mount hardware fits desks up to 2 ¼" thick
- Weight capacity of 30lbs
- VESA MIS-D Compliant



Monitor Stands

MS110MB Easy Adjust Monitor Stand

- Provides 5" of vertical height adjustment
- 270° swivel capability and 30° of forward and back tilt
- Weight capacity of 16 lbs
- Fits both 75 mm x 75 mm and 100 mm x 100 mm VESA-D monitor bolt hole patterns
- 3 year warranty



MS90B Adjustable Monitor Stand - Extra Wide MS80B Adjustable Monitor Stand

- Contemporary design with stacking columns raises monitor from 1" to 5.875" in increments of 1.625"
- Features ample storage space underneath
- Weight capacity of 40 lbs
- 16" clearance between columns
- Non-skid base



MS80B

Notebook Risers

LX600MB Easy Adjust Notebook & Projector Riser

- Doubles as an LCD projector riser
- Provides 4" of vertical height adjustment, 360° swivel, and 40° forward and back tilt capability.
- Adjustment is achieved quickly and smoothly with a single touch
- Weight capacity of 14lbs.
- Includes attachment system for docking stations for quick and easy notebook connectivity
- 3 year warranty



LX500 Adjustable Notebook Riser

- Height adjustable from 4" to 6" in 0.5" increments
- Cooling slots in platform help keep notebook ventilated
- Weight capacity of 14lbs.
- includes side shelves for accessories and an adapter for the 3M™ DH445 Document Holder (sold separately)
- Compatible with docking stations
- Supports up to 15 lbs.
- 30 day warranty.



LX550 Vertical Notebook Riser

- Space saver riser provides ideal viewing position.
- Features 3" of vertical height adjustment
- Includes a non-skid base and holding ledge with a cable management feature to keep your cords organized.
- 30 day warranty.



Comparison Chart

Monitor Arms	MA260MB	MA240MB	MA140MB	MA120MB
				
Features Easy Adjust Technology	Yes	Yes	No	No
Monitor Weight Capacity	20 lbs	20 lbs	30 lbs	30 lbs
Notebook Weight Range	20 lbs	20 lbs	-	-
Height Range of Adjustable Segments	12.75"	12.75"	7.5"	7.5"
Tilt Range Forward/Backward	+55°/-90°	+55°/-90°	+15°/-90°	+15°/-90°
Swivel Left/Right	90°/90°	90°/90°	90°/90°	90°/90°
Rotation Portrait/Landscape	360°	360°	360°	360°
VESA MIS-D 75mm and 100mm Compatability	Yes	Yes	Yes	Yes
Clamp Mount Max Surface Thickness	2.625"	2.625"	4.25"	4.25"
Clamp Mount Min Surface Thickness	.5"	.5"	.8"	.8"
Grommet Mount Max Surface Thickness	3"	3"	2.25"	2.25"
Grommet Mount Min Hole Size	.5"	.5"	.4"	.4"
Grommet Mount Max Hole Size	2"	2"	2.25"	2.25"
Max Extension Length	25.5"	25.5"	19.5"	11.5"
Max Mount Plate Height From Surface	27"	27"	18.5"	15"
Min Mount Plate Height From Surface	5"	5"	10.5"	7.375"
Recycled content	45%	45%	0%	0%
Warranty Years	5	5	3	3

	Monitor Stand			Notebook Risers		
	MS110MB	MS90B	MS80B	LX600MB	LX550	LX500
						
Features Easy Adjust Technology	Yes	No	No	Yes	No	No
Monitor Weight Range lbs (kg)	6-16 (2.7-7.3)	0-40 (0-18.1)	0-80 (0-36.3)	N/A	5-20 (2.3-9.1)	5-20 (2.3-9.1)
Notebook Weight Range lbs (kg)	N/A	N/A	N/A	0-14 (0-6.3)	0-20 (0-9.1)	0-20 (0-9.1)
Height Range of Adjustable Segment Inches (mm)	5" (127)	4" (102)	4" (102)	4.3" (109)	3" (76)	2" (51)
Height Adjustable Increments Inches (mm)	Infinite	1.625" (41.3)	1.625" (41.3)	Infinite	Infinite	0.5"
Tilt Range Forward/Backward	+25°/-5°	N/A	N/A	+40°/-40°	N/A	N/A
Pan Left/Right	360°	N/A	N/A	180°	N/A	N/A
Rotation Portrait/Landscape	90°	N/A	N/A	N/A	N/A	N/A
VESA MIS-D 75 mm and 100 mm Compatibility	Yes	N/A	N/A	N/A	N/A	N/A
Max Mount Plate Height From Desk Surface Inches (mm)	13.5" (343)	N/A	N/A	N/A	N/A	N/A
Min Mount Plate Height from Desk Surface Inches (mm)	8.187" (208)	N/A	N/A	N/A	N/A	N/A
Warranty Years	3	30 days	30 days	3	30 days	30 days

Adjustable Keyboard Trays

The Keyboard Tray you need.
The features you want.
3M Adjustable Keyboard Trays offer a broad line of solutions with innovative features and thoughtful design to fit almost any workstation environment.

AKT150LE Easy Adjust Keyboard Tray

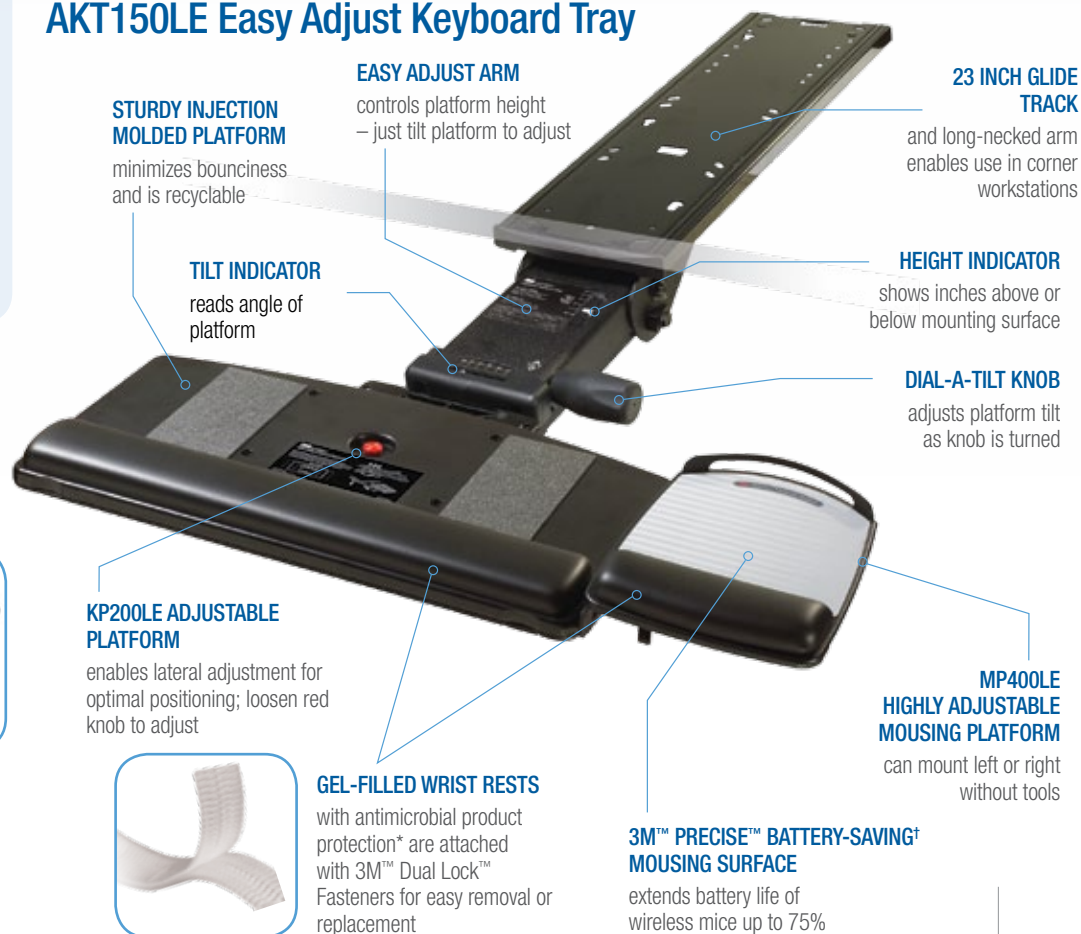

AKT60LE Knob Adjust Keyboard Tray



*Antimicrobial product protection
Gel-filled wrist rests with antimicrobial protection inhibits the growth of microorganisms, such as bacteria, on the product surface, that can cause stains, odours and product degradation.

†Battery Saving Mousepad Designs Products identified by this symbol feature 3M™ Precise™ Optical Mousing Surfaces with battery saving designs which extend the battery life of wireless optical mice up to 75%. Our lab testing has shown that these surfaces draw less current and thus offer 75% more battery life. The lab tests were done using mice from the leading manufacturers in the marketplace (Microsoft and Logitech) in conjunction with batteries from the leading battery manufacturers in the US (Energizer, Duracell and Rayovac). Our battery saving mousing surfaces feature the 3M micro-textured technology used to make 3M™ Precise™ Optical Mousing Surfaces.

3M™ Keyboard Trays are manufactured using preconsumer recycled material. The ♻️ and corresponding number indicates the percentage of recycled content by volume in a given product.

Choose the 3M™ Keyboard Tray that's right for you in 2 easy steps:

1 Select the arm type and track length

- Corner workstations require a long track – 21.75-23"
- Regular shallow workstations (18-22" under-desk depth) require a short track – 17-17.75"
- Regular deep workstations (23" + under-desk depth) can accept short or long-tracked keyboard trays

Sit/Stand Easy Adjust Arm

Easy to adjust, raises up to 10" above mounting surface for sitting for standing posture for optimal ergonomic benefit.



23" Track
Fits Corners

Easy Adjust Arm

Easy to adjust – just tilt platform, adjust, then release to lock in height. Tilt is adjusted by dialing tilt knob to desired angle. Includes height and tilt read-outs.

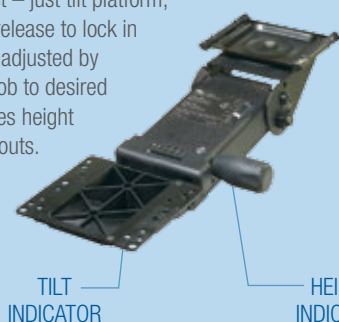

23" Track
Fits Corners

17.75"
Track

TILT
INDICATOR

HEIGHT
INDICATOR

Lever Adjust Arm

Lever handle ensures positive lock on platform height. Just flip lever to right, adjust height, then move lever back to lock in place. Tilt is adjusted with separate pull lever.



21.75" Track
Fits Corners

17.75"
Track

Knob Adjust Arm

Knob adjusts both height and tilt. Just loosen knob, set height and tilt, then re-tighten. While more awkward to adjust, simple design is cost effective. AKT65LE can be installed without tools!



17.0"
Track

2 Select the platform type



KP200LE Highly Adjustable Platform

(Lifetime Warranty)

Sturdy platform has patented left/right lateral adjustment for getting the keyboard exactly where you want it. Articulating mousing platform adjusts up, down, left, right, forward and back, and tilts forward and back, too.



KP100LE Standard Platform

(5 year Warranty)

Standard all-in-one platform with wooden construction minimizes bouncing. Mousing surface can be placed left or right.



AKT170LE**

70%



AKT150LE**

25%



AKT90LE**

70%



AKT151LE**

25%



AKT91LE**

70%



AKT100LE**

25%



AKT70LE**

70%



AKT101LE**

25%



AKT71LE**

70%



AKT80LE**

25%



AKT65LE**

70%



AKT60LE**

70%

** Use of this product helps contribute to LEED® Green Building Certification EB O&M Credit 2.2 Sustainable Purchasing: Durable goods because 3M™ Adjustable Keyboard Trays contain a minimum of 20% preconsumer recycled content, exceeding the recycled content required in Credit 2.2.

Keyboard Trays

Product Number	AKT180LE	AKT150LE	AKT151LE	AKT100LE	AKT101LE	AKT80LE
Platform Type	 <p>KP200LE</p>					
Articulating Arm Type	Sit/Stand Easy Adjust	Easy Adjust	Easy Adjust	Lever Adjust	Lever Adjust	Knob Adjust
						
Track Length	23" (584 mm)	23" (584 mm)	17.75" (451 mm)	21.75" (552 mm)	17.75" (451 mm)	17" (432 mm)
Tilt Range Forward/Backward	+15° / -15°	+10° / -15°	+10° / -15°	+10° / -15°	+10° / -15°	+15° / -15°
Height Above Mounting Surface	10" (254 mm)	4" (102 mm)	3" (76.2 mm)	1" (25.4 mm)	1" (25.4 mm)	1.5" (38.1 mm)
Depth Below Mounting Surface	5" (127 mm)	6" (152 mm)	5" (127 mm)	4.5" (114 mm)	4.5" (114 mm)	4.5" (114 mm)
Swivel	360°	360°	360°	360°	360°	360°
Platform Width	19.5" (495 mm)	19.5" (495 mm)	19.5" (495 mm)	19.5" (495 mm)	19.5" (495 mm)	19.5" (495 mm)
Minimum Width of Keyboard and Mousing Platforms	23.5" (597 mm)	23.5" (597 mm)	23.5" (597 mm)	23.5" (597 mm)	23.5" (597 mm)	23.5" (597 mm)
Maximum Width of Keyboard and Mousing Platforms	26.5" (673 mm)	26.5" (673 mm)	26.5" (673 mm)	26.5" (673 mm)	26.5" (673 mm)	26.5" (673 mm)
Platform Depth	10.625" (270 mm)	10.625" (270 mm)	10.625" (270 mm)	10.625" (270 mm)	10.625" (270 mm)	10.625" (270 mm)
Required Depth Under Mounting Surface	23.25" (591 mm)	23.25" (591 mm)	18" (457 mm)	22" (559 mm)	18" (457 mm)	18" (457 mm)
Required Width Under Mounting Surface	24" (610 mm)	24" (610 mm)	24" (610 mm)	24" (610 mm)	24" (610 mm)	24" (610 mm)
Suitable for Corner Workstations	Yes	Yes	No	Yes	No	No
Required Minimum Length for Diagonal Corner	17" (432 mm)	17" (432 mm)	-	17" (432 mm)	-	-
Required Minimum Radius for Curved Corner	12" (305 mm)	12" (305 mm)	-	12" (305 mm)	-	-
Stows Completely Under Mounting Surface	No, extends 1" (25.4 mm) when fully stowed	Yes	No, extends 1.5" (38.1 mm) when fully stowed	Yes	Yes	Yes
Height Indicator	Yes	Yes	Yes	No	No	No
Tilt Indicator	Yes	Yes	Yes	No	No	No
Tool Free Installation	No	No	No	No	No	No
Gel-filled Wrist Rests with antimicrobial product protection*	Yes	Yes	Yes	Yes	Yes	Yes
3M™ Precise™ Battery Saving Mousing Service	Yes	Yes	Yes	Yes	Yes	Yes
Meets BIFMA Specifications (x 5.5-1998)	Yes	Yes	Yes	Yes	Yes	Yes
Warranty Years	Lifetime on Keyboard Arm. 5 years on keyboard Tray. 1 year on Gel Wrist Rests.					
 % Preconsumer Recycled Content	25	25	25	25	25	25

*Antimicrobial product protection
Gel-filled wrist rests with antimicrobial protection inhibits the growth of microorganisms, such as bacteria, on the product surface, that can cause stains, odours and product degradation.

Applies to all keyboard trays (pages 12-13). Use of this product helps contribute to LEED® Green Building Certification EB O&M Credit 2.2 Sustainable Purchasing: Durable goods because 3M™ Adjustable Keyboard Trays contain a minimum of 20% preconsumer recycled content, exceeding the recycled content required in Credit 2.2.

Comparison Chart

Product Number	ATK170LE	AKT90LE	AKT91LE	AKT70LE	AKT71LE	AKT65LE	AKT60LE
Platform Type	 KP100LE						
Articulating Arm Type	Sit/Stand Easy Adjust	Easy Adjust	Easy Adjust	Lever Adjust	Lever Adjust	Knob Adjust	Knob Adjust
							
Track Length	23" (584 mm)	23" (584 mm)	17.75" (451 mm)	21.75" (552 mm)	17.75" (451 mm)	17" (432 mm)	17" (432 mm)
Tilt Range Forward/Backward	+15°/-15°	+10° / -15°	+10° / -15°	+10° / -15°	+10° / -15°	+15° / -15°	+15° / -15°
Height Above Mounting Surface	10" (254 mm)	4" (102 mm)	3" (76.2 mm)	1" (25.4 mm)	1" (25.4 mm)	1" (25.4 mm)	1.5" (38.1 mm)
Depth Below Mounting Surface	5" (127 mm)	6" (152 mm)	5" (127 mm)	4.5" (114 mm)	4.5" (114 mm)	4.5" (114 mm)	4.5" (114 mm)
Swivel	360°	360°	360°	360°	360°	360°	360°
Platform Width	25.5" (648 mm)	25.5" (648 mm)	25.5" (648 mm)	25.5" (648 mm)	25.5" (648 mm)	25.5" (648 mm)	25.5" (648 mm)
Minimum Width of Keyboard and Mousing Platforms	-	-	-	-	-	-	-
Maximum Width of Keyboard and Mousing Platforms	-	-	-	-	-	-	-
Platform Depth	12" (305 mm)	12" (305 mm)	12" (305 mm)	12" (305 mm)	12" (305 mm)	12" (305 mm)	12" (305 mm)
Required Depth Under Mounting Surface	23.25" (591 mm)	23.25" (591 mm)	18" (457 mm)	22" (559 mm)	18" (457 mm)	17.25" (438 mm)	17.25" (438 mm)
Required Width Under Mounting Surface	26" (660 mm)	26" (660 mm)	26" (660 mm)	26" (660 mm)	26" (660 mm)	26" (660 mm)	26" (660 mm)
Suitable for Corner Workstations	Yes	Yes	No	Yes	No	No	No
Required Minimum Length for Diagonal Corner	17" (432 mm)	17" (432 mm)	-	17" (432 mm)	-	-	-
Required Minimum Radius for Curved Corner	12" (305 mm)	12" (305 mm)	-	12" (305 mm)	-	-	-
Stows Completely Under Mounting Surface	No, extends 1" (25.4 mm) when fully stowed	Yes	No, extends 1" (25.4 mm) when fully stowed	Yes	Yes	Yes	Yes
Height Indicator	Yes	Yes	Yes	No	No	No	No
Tilt Indicator	Yes	Yes	Yes	No	No	No	No
Tool Free Installation	No	No	No	No	No	Yes	No
Gel-filled Wrist Rests with antimicrobial product protection*	Yes	Yes	Yes	Yes	Yes	Yes	Yes
3M™ Precise™ Battery Saving Mousing Service	Yes	Yes	Yes	Yes	Yes	Yes	Yes
Meets BIFMA Specifications (x 5.5-1998)	Yes	Yes	Yes	Yes	Yes	Yes	Yes
Warranty Years	Lifetime on Keyboard Arm. 5 years on Keyboard Tray. 1 year on Gel Wrist Rests.						
 % Preconsumer Recycled Content	70	70	70	70	70	70	70

*Antimicrobial product protection:
Gel-filled wrist rests with antimicrobial protection inhibits the growth of microorganisms, such as bacteria, on the product surface, that can cause stains, odours and product degradation.

Adjustable Keyboard Tray Accessories

CM100MB Corner Maker

- Transform a 90° corner workstation into a bridged corner so a keyboard tray can be mounted in the corner
- 17"-wide front edge is compatible with all 3M™ Adjustable Keyboard Trays
- Fits track lengths of 21.75" or greater
- Fits workstations from 0.75" to 1.5" thick
- 2 year warranty



MP400LE Mousing Platform

- Add a second mousing platform to your keyboard tray (equipped with KP200LE adjustable platform) or replace your old mousing platform



Keyboard Drawers

KD95CG Adjustable Desktop Keyboard Drawer

- Provides excellent flexibility that works great in laboratories and for mobile workstations
- 4 distinct height adjustment levels up to 3.75" below desk level with unlimited tilt
- Wide platform provides a spacious mousing surface next to the keyboard for comfort
- Includes a full length soft leatherette gel wrist rest with antimicrobial product protection*
- Steel reinforced construction
- No installation required
- Accommodates keyboards with a maximum height of 1.5"
- 5 year warranty.



KD85CG Desktop Keyboard Drawer

- Extra-wide drawer, built to fit virtually all keyboard styles
- Full-size mousing area on the platform adds comfort and convenience
- Includes a leatherette gel wrist rest with antimicrobial product protection*
- Built with sturdy steel reinforced construction
- No installation required
- 5 year warranty.



KD90 Adjustable Under-Desk Keyboard Drawer

- Easy to install, under-desk version of the KD95CG
- Keyboard tray provides height adjustments and unlimited tilt to create a personal fit
- Wide platform places the mouse directly beside the keyboard for added comfort and convenience
- Leatherette gel wrist rest with antimicrobial product protection*
- Installation depth required: 20"; width required: 30"
- 5 year warranty.



KD45 Adjustable Under-Desk Keyboard Drawer

- Featuring three distinct height positions to ensure the ideal working posture
- Includes an extra-wide tray to match virtually all keyboards
- Steel ball bearings provide smooth operation and movement
- Includes a leatherette gel wrist rest and a retractable mousing pad with the 3M™ Precise™ mousing surface.
- Ready to assemble. 24-2/5"W x 16-2/5"D x 2-1/4"H.



*Antimicrobial product protection: Gel-filled wrist rests with antimicrobial protection inhibits the growth of microorganisms, such as bacteria, on the product surface, that can cause stains, odours and product degradation.

Document Holders

Desktop Mounted

DH640 In-Line Document Holder



- Simple height and adjustment features place items in the optimal viewing location for any user
- Weighted base provides excellent stability and allows the holding ledge to be placed below the edge of the desk
- Place your documents directly in-line with your monitor and keyboard without blocking your view of the monitor screen.
- 18" wide back plate
- Hold books, catalogues, manuals, or just a single reference sheet



DH630 Compact In-Line Document Holder

- Provides same functionality and adjustability while taking up less space
- 14"-wide backplate
- Easy to adjust, with elastic line guide
- Can stand alone on desktop or hang over edge with 3M™ Command™ Adhesive
- Sheet capacity:** 150 sheets
- 2-yr warranty.



DH340MB Desktop Document Holder

- Keep your documents upright and improve their viewing position
- Height-adjustable clip secures documents in portrait or landscape view
- Non-skid base ensures the holder remains just where you need it
- Holds letter or legal-sized documents and folds flat for easy storage
- Sheet capacity - 150 sheets.



DH140 Document Wedge

- Secures documents up to legal size
- Keeps paper in easy-to-read, upright position
- Weighted base prevents tipping
- Compact, portable design.
- Sheet capacity:** 20 sheets.



Monitor Mounted



DH445 Flat Panel Document Holder

Sleek design works with flat panel or traditional desktop CRT monitors. Height-adjustable clip secures sheets in portrait or landscape. Sheet capacity:** 35 sheets.



DH440MB CRT Mount Document Holder

Height-adjustable clip can secure legal or landscape oriented documents. Designed for CRT monitors. Sheet capacity:** 35 sheets.

Position documents at eye level, right next to your monitor on either the right or left side. All models easily fold away when not in use.

DH240MB Document Clip

Lets you slide in up to 5 sheet one-handed or securely clip up to 30 sheets. Sheet capacity:* 30 sheets.



3M™ Command™ Adhesive Attachment System

DH630, DH445, DH440MB and DH240MB feature 3M™ Command™ Adhesive to hold securely yet remove cleanly.



**Angle and height position can affect sheet capacity. Test before using.

*** Use of this product helps contribute to LEED® Green Building Certification EB O&M Credit 2.2 Sustainable Purchasing: Durable goods because 3M™ Document Holder DH640 contains a minimum of 20% preconsumer recycled content, exceeding the recycled content required in Credit 2.2.

Foot Rests

Reduce strain and fatigue on legs, back and neck. Both models offer easy foot-controlled platform tilt adjustment and sturdy steel construction.

FR530CB Adjustable Foot Rest

- Extra-wide 22" platform provides ample space for both feet

- Height and tilt adjustable
- Heavy-duty steel construction for extra stability
- 3M™ Safety-Walk™ Slip-resistant Surface keeps feet from sliding
- 5 year warranty

FR330 Adjustable Foot Rest

- Contoured, 18" wide non-skid plastic platform with soft bumps to massage and soothe your feet

- Height and tilt adjustable
- Durable, heavy-duty steel base
- 2 year warranty.



Ergonomic Mouse

EM550 Wireless Ergonomic Mouse

It may feel a little different at first, but before you know it you'll begin to feel the benefits of using a mouse that truly displays Ergonomic design at its best.

- Ease-of-Use Commendation from the Arthritis Foundation®
- Keeps your hand and wrist at a neutral angle, while the mouse works as a regular optical mouse
- Optical sensor, wireless, USB compatible plug and play
- Soft-touch painted surface for added comfort
- For right-handed use only
- 2-year warranty



Sizes

EM550GPL - Large
EM550GPS - Small

EM500 Wired Ergonomic Mouse

With the same ergonomic benefits as the wireless model, this mouse also offers an optical sensor, USB/ PS2 plug and play compatibility and a 6.5 ft. cord for flexible use. Available in original black design. For right-handed use only. 2-year warranty.

Sizes

EM500GPL - Large
EM500GPS - Small

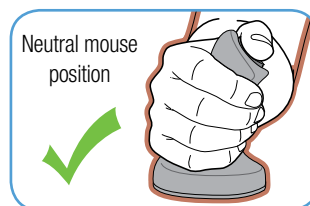
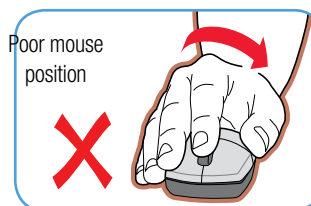
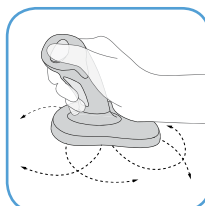

Operate by moving entire mouse around on mousing surface.

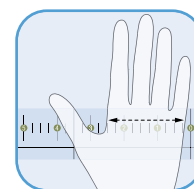
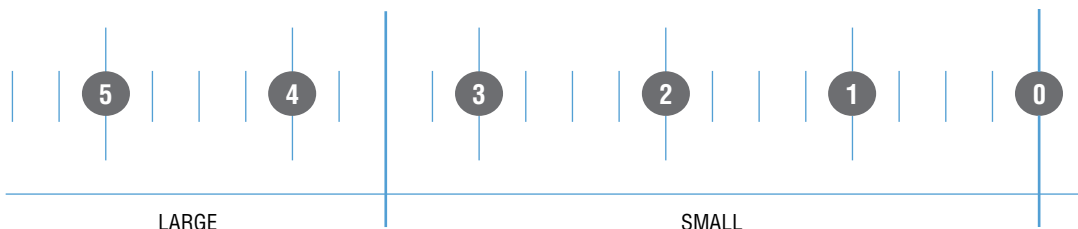

Wrist Rest Technology

Gel-filled comfort

3M's patented gel technology creates a wrist rest that is firm enough to provide the support you need, but soft enough for optimal comfort. 3M™ Gel-filled wrist rests are guaranteed not to leak and are puncture-resistant under normal use. All 3M™ Gel Wrist Rests are warranted for at least 1 year.

Antimicrobial protection

3M™ Gel Wrist Rests with black leatherette covers feature antimicrobial protection which inhibits the growth of microorganisms on the product surface that can cause stains, odors and product degradation.

Recycled content

3M™ Gel Wrist Rests with black leatherette coverings are manufactured using preconsumer recycled material. The and corresponding number indicates the percentage of recycled content by weight in a given product. All 3M™ Wrist Rests are packaged using recyclable materials for less environmental impact.

3M™ Precise™ Battery Saving† Mousing Surfaces

With a micro-grooved surface, the 3M™ Precise™ Battery Saving† Mousing Surface helps extend the life of wireless mice up to 75%†. Dually beneficial, this surface also enhances the precision of optical mice at fast speeds.



The way you hold your wrists while working at a keyboard

directly impacts your level of comfort for an extended period of time. Placing a soothing, comfortable 3M™ Wrist Rest in position helps you stay comfortable throughout your workday and helps contribute to the health of your hands and wrists. 3M™ Wrist Rests offer a variety of soft, supple materials and adjustable platforms to allow for precise positioning and optimal comfort.

Gel Wrist Rest Platforms

Sleek in appearance and operation, these platforms are designed with tapered wrist rests and rounded corners for comfort beyond compare. Includes incredibly soft gel wrist rests and 3M™ Precise™ Battery Saving† Mousing Surface. Leatherette wrist rests are easy to clean and feature antimicrobial product protection*.

WR422LE Tilt-Adjustable Platform

For Keyboard and Mouse. Mousing surface repositionable for left handed mousing. 2 year warranty.

WR420LE Tilt-Adjustable Platform

For Keyboard. 2 year warranty.

WR421LE Tilt-Adjustable Platform

For Mouse. 2 year warranty.



*Antimicrobial product protection: Gel-filled wrist rests with antimicrobial protection inhibits the growth of microorganisms, such as bacteria, on the product surface, that can cause stains, odours and product degradation.

†See page 10

Gel Wrist Rests

WR310LE**

- Leatherette Gel Wrist Rest with antimicrobial product protection*
- Can use as replacement wrist rest on keyboard trays with KP200LE adjustable platform.
- 1 year warranty.



WR309LE**

- Leatherette Gel Wrist Rest with antimicrobial product protection*
- Can use as replacement wrist rest on the keyboard drawer KD45
- 1 year warranty.



WR315LE**

- Leatherette Thin Profile Gel Wrist Rest for "Curvy" Keyboards with antimicrobial product protection*
- 3M™ Dual Lock™ system attaches to keyboard
- 1 year warranty.



WR314LE**

- Leatherette Thin Profile Gel Wrist Rest for Ergonomic Split-design Keyboards with antimicrobial product protection*
- 3M™ Dual Lock™ system attaches to keyboard
- 1 year warranty.



WR340LE**

- Leatherette Gel Wrist Rest with antimicrobial product protection*
- Can use as replacement wrist rest on keyboard trays featuring KP100LE standard platform and KDs 85, 90 and 95
- 1 year warranty.



WR314LE

WR305LE**

- Leatherette Gel Wrist Rest for Mouse or Trackball with antimicrobial product protection*
- Can use as replacement wrist rest on keyboard trays equipped with KP200LE platform and WR421LE. Leatherette
- 1 year warranty.



*Antimicrobial product protection:
Gel-filled wrist rests with antimicrobial protection inhibits the growth of microorganisms, such as bacteria, on the product surface, that can cause stains, odours and product degradation.

**Use of this product helps contribute to LEED® Green Building Certification EB O&M Credit 2.2 Sustainable Purchasing: Durable goods because 3M™ Gel Wrist Rests with black leatherette coverings (LE) contain a minimum of 20% preconsumer recycled content, exceeding the recycled content required in Credit 2.2.

Mouse Pads

MW310LE** Mouse Pad Wrist Rest - Large 25%

- Leatherette Gel Mouse Pad Wrist Rest with antimicrobial product protection*
- 3M™ Precise™ Battery Saving† Mousing Surface
- 1 year warranty.



MW309LE** Mouse Pad Wrist Rest - Small 25%

- Leatherette Gel Mouse Pad Wrist Rest with antimicrobial product protection*
- 3M™ Precise™ Battery Saving† Mousing Surface
- 1 year warranty.



MP200PS Precise™ Battery Saving† Mousing Surface

- Ultra-thin, portable mouse pad with 3M™ repositionable adhesive
- Stows conveniently on back of notebook computers
- Battery saving design extends battery life of wireless mice up to 75%
- 1 year warranty



Task Lighting

TL1000 (C/S) Glare Reducing Task Lights

- Polarizing filter technology reduces reflective and veiling glare on reading materials and work surfaces by 50-80%†
- Attractive, high-performance task lights deliver excellent light quality (1750 lumens) exactly where you need it
- Available in Charcoal (C), or Silver (S)
- 5 year warranty.

TL1000C



TL27W Replacement Bulb for TL1000 Task Light†

High-performance replacement bulbs.
1750 lumens. 27 watts.



††Fluorescent bulb contains mercury. Do not discard bulb in trash. Dispose of bulb according to municipal, provincial or federal laws. See www.lamprecycle.org.



3M™ Polarizing Light Filter filters out the light that causes reflective glare



Without 3M™ Polarizing Light Filter Technology



With 3M™ Polarizing Light Filter Technology

††The amount of reflected glare reduction in reading materials is dependent on viewing angle. Glare reduction is reduced by 50% at a 30-degree reflection angle from light to eye, and reduced 80% at a 60-degree angle from light to eye.

Office Air Cleaners

3M™ Office Air Cleaners with Filtrete® Filters

OAC150 Office Air Cleaner - Offices OAC250 Office Air Cleaner - Conference Rooms

These compact-sized air cleaners help clean the air and reduce odours in your work area. 3M™ Office Air Cleaners have a three-stage filter design that includes both Filtrete® Filter media and ionization for airborne particulate removal, and carbon for odour reduction. Filter effectiveness lasts up to three months under normal conditions. 5-year warranty on unit.

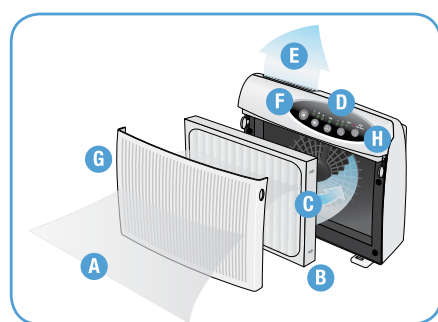

- A** Room air and particles are drawn into the air cleaner
- B** Filtrete® Air Cleaning Filter captures airborne particles and removes them from the air
- C** Built-in Activated Carbon Filter helps reduce odours
- D** Ionizer imparts charge to filtered air, enhancing cleaner efficiency
- E** Filtered air is released from the top of the unit, increasing air circulation in your office
- F** Three operating speeds : Hi, Med, Low
- G** Air Intake Grille releases easily for quick replacement filter changes
- H** Filter Reset Indicator Light reminds you when it's time to replace your filter

Products that earn the ENERGY STAR® prevent greenhouse gas emissions by meeting strict energy efficiency guidelines set by the U.S. Environmental Protection Agency and the U.S. Department of Energy. www.energystar.gov



Specifications

Cat #	Description	Clean-air deliver rate*	Room size (feet)	Power consumption (watts)	Fan speeds	Filter Change Reminder	Ionization on/off	Carrying handle	Warranty (years)
OAC150	Office Air Cleaner for offices	163/172/201	12 x 18	69	3	Yes	Yes	Yes	5
OAC250	Office Air Cleaner for conference rooms	254/236/284	16 x 20	110	3	Yes	Yes	Yes	5

* CADR - Dust/Tobacco Smoke/Pollen

Filtrete® Replacement Filters

Cat #	Description	Dimensions (inches)	Filtrete® Media Type	Activated Carbon Filter
OAC50RF	Filtrete® Replacement Filter for OAC50	4.25 x 10.25 x 1.75	G150	Yes
OAC150RF	Filtrete® Replacement Filter for OAC150	11.0 x 14.5 x 1.125	G150	Yes
OAC250RF	Filtrete® Replacement Filter for OAC250	11.875 x 18.75 x 1.625	G150	Yes
OAC100RF	Filtrete® Replacement Filter for OAC100 (not shown)	9.5 x 7.25 x 2.5	G100	Yes
OAC200RF	Filtrete® Replacement Filter for OAC200 (not shown)	13.0 x 7.25 x 2.5	G100	Yes



Organization Solutions

CS200MB Adjustable Under-desk CPU mount

Placing your CPU in a convenient, accessible place has never been easier. 360° swivel ensures easy access to the back of CPU. Mounts to the underside of your work surface on 17" glide track to keep it conveniently accessible. Sturdy steel construction. Great for mobile or rolling workstations. 5-year warranty.



CS100MB Adjustable CPU Stand

Access to your CPU quickly and easily without twisting or bending to reach near cables and ports. Simply roll CPU stand forward for access. Width adjustable from 3.75" to 9.25" to fit virtually all CPUs. Front wheels lock in place. Holds up to 50 lbs.



C91 Desktop Rotary Organizer C71 Desk Drawer Organizer* C50 Desktop Organizer

Convenience reaches a new level with these clutter reducing organizers. Choose from three styles. All hold Post-it® Notes, Post-it® Flags and Scotch® Tape, keeping office essentials within easy reach.



Surface & Computer Cleaners

573 Desk & Office Cleaner

- Excellent for all surfaces including desktops, office furniture, cabinets, painted surfaces, plastic surfaces, luggage, etc
- Foaming action prevents running on vertical surfaces.
- Non-abrasive formulation cuts through grease, dirt and grime
- Not recommended for computer screens or glass
- 15 oz. aerosol can



674 Keyboard Cleaning Kit

- Two depths on scrubbing tool to adapt to all types of keyboards
- Cleaning solution helps cut through grime, grease, fingerprints
- Fits into hard-to-reach places on keyboards, telephones and fax machines for better cleaning
- 4 finishing cloths included.



CL680 Screen and Keyboard Cleaner

- Antistatic cleaner for CRT Monitors, LCD and Laptop screens
- Easy, fast cleaning with fine bristles for brushing dust, lint, dirt and crumbs off screen and keyboard
- Wet cleaner side is equipped with chamois squeegee for wiping computer screens clean



* Use of this product helps contribute to LEED® Green Building Certification EB O&EM Credit 2.2 Sustainable Purchasing: Durable Goods because the Post-it® Desk Drawer Organizer C71 contains a minimum of 20% preconsumer recycled content, exceeding the recycled content required in Credit 2.2.

Privacy Filters

Excellent for use in high traffic areas, 3M™ Privacy Filters allow business professionals to work confidently – even on the go. Screen data is visible only to persons directly in front of the monitor; user sees no blurring or image distortion. Darkens on-screen information when viewed from the side. Frameless design fits notebook computers or LCD desktop monitors. Helps protect fragile LCD screens. Easy to attach and remove; filters can be left in place even when your notebook computer is closed. Sizes available to fit both widescreen and standard screen size formats. High quality. 1 year warranty.



Help protect confidential information from prying eyes

Available in various sizes for Notebooks, netbooks, and smartphones.



Available in Black and Gold

3M™ Privacy & Anti-Glare/Radiation Filters

Viewing Comfort and Protection

Lightweight LCD Privacy Filters

Extremely lightweight; will not affect monitor height or position. Patented removable attachment method requires no hanger arms and can be removed and replaced many times without affecting the attachment system strength. 3M™ Privacy Filters use nearly invisible microblow technology so blower lines don't interfere with your crisp, clear view of on-screen data. Onlookers see a darkened screen when viewed from the side. Only widescreen framed desktop privacy filter available. Sizes available to fit both widescreen and standard size formats. High quality, 1 year warranty.



PF317 Flat Frame Privacy for 17" Standard size LCD Monitor - Black
PF317W Flat Frame Privacy for 17" Widescreen LCD Monitor - Black
PF319 Flat Frame Privacy for 19" Standard size LCD Monitor - Black

PF319W Flat Frame Privacy for 19" Widescreen LCD Monitor - Black
PF322W Flat Frame Privacy for 22" Widescreen LCD Monitor - Black
PF324W Flat Frame Privacy for 24" Widescreen LCD Monitor - Black

3M™ Executive Anti-Glare Computer Screens

Unique two sided anti-reflective coating reduces glare up to 99%

- Reduce glare up to 99% to help prevent eyestrain and headaches related to computer monitor use.
- Block up to 99% of ELF/VLF E-field radiation, and reduce static and dust built up when properly grounded.
- Helps protect valuable LCD monitor screens from scratches and fingerprints.
- ISO 9241-7 Compliant.
- Experience sharper, clearer images and readability.

EF200L 13"-15" CRT & 15" LCD - Beige
EF200XL 16"-19" CRT & 17"-18" LCD - Beige
EF200XXL 19"-21" CRT & 19"-20" LCD - Beige

EF200LB 13"-15" CRT & 15" LCD - Black
EF200XLB 16"-19" CRT & 17"-18" LCD - Black
EF200XXLB 19"-21" CRT & 19"-20" LCD - Black



Comparison Chart

Model Number	Reduces Reflections	Anti-Static	Anti-Radiation	Light Tint Glass***	Privacy Feature	Reversible – Matte or Glossy Finish	Meets AOA Specification	Protects LCD Screen	Widescreen Format	Glare Reduction (Percentage)	Aspect Ratio	Fits Monitors Sized (Diagonal)	Filter Viewing Area (H x W)	Filter Viewing Area (Diagonal)	Frame Colour
--------------	---------------------	-------------	----------------	---------------------	-----------------	-------------------------------------	-------------------------	---------------------	-------------------	------------------------------	--------------	--------------------------------	-----------------------------	--------------------------------	--------------

Frameless Notebook/LCD Privacy Filters Frameless Mounting/In-Bezel Design

PF12.1	•										4:3	12.1" Standard Notebook	7.3125" x 9.75"	12.0625"	N/A
PF13.3	•										4:3	13.3" Standard Notebook	8" x 10.625"	13.625"	N/A
PF14.1	•										4:3	14.1" Standard Notebook	8.4375" x 11.25"	14.0625"	N/A
PF15.0	•										4:3	15.0" Standard LCD	9" x 12"	15.0"	N/A
PF17.0	•										5:4	17.0" Standard LCD	10.6875" x 13.3125"	17.0625"	N/A
PF18.1	•										5:4	18.1" Standard LCD	11.3125" x 14.125"	18.0625"	N/A
PF19.0	•										5:4	19.0" Standard LCD	11.875" x 14.7125"	19.0"	N/A
PF20.1	•										4:3	20.1" Standard LCD	12.125" x 16.125"	20.125"	N/A
PF21.3	•										4:3	21.3" Standard LCD	12.75" x 17"	21.3125"	N/A
PF8.9W	•								•		16:9	8.9" Widescreen Netbook	4.5" x 7.6875"	8.875"	N/A
PF10.1W	•								•		16:9	10.1" Widescreen Netbook	4.9375" x 8.8125"	10.0625"	N/A
PF11.6W9	•								•		16:9	11.6" Widescreen Netbook	5.6875" x 10.125"	11.625"	N/A
PF12.1W	•								•		16:10	12.1" Widescreen Notebook	6.4375" x 10.3125"	12.125"	N/A
PF12.5W9	•								•		16:9	12.5" Widescreen Notebook	6.125" x 10.9375"	12.5"	N/A
PF13.3W	•								•		16:10	13.3" Widescreen Notebook	7.0625" x 11.3125"	13.3125"	N/A
PF13.3W9	•								•		16:9	13.3" Widescreen Notebook	6.5" x 11.5625"	13.25"	N/A
PF14.0W	•								•		16:9	14.0" Widescreen Notebook	6.875" x 12.1875"	14.0"	N/A
PF14.1W	•								•		16:10	14.1" Widescreen Notebook	7.5" x 11.9375"	14.125"	N/A
PF15.4W	•								•		16:10	15.4" Widescreen Notebook	8.1875" x 13.0625"	15.4375"	N/A
PF15.6W	•								•		16:9	15.6" Widescreen Notebook	7.625" x 13.5625"	15.5625"	N/A
PF16.0W9	•								•		16:9	16.0" Widescreen Notebook	7.875" x 13.9375"	16.0625"	N/A
PF17.0W	•								•		16:10	17.0" Widescreen Notebook	9.0625" x 14.5"	17.0625"	N/A
PF17.3W	•								•		16:9	17.3" Widescreen Notebook	8.5" x 15.0625"	17.3125"	N/A
PF18.4W9	•								•		16:9	18.4" Widescreen Notebook	9.0625" x 16.0625"	18.5"	N/A
PF18.5W	•								•		16:9	18.5" Widescreen LCD	9.0625" x 16.125"	18.5625"	N/A
PF19.0W	•								•		16:10	19.0" Widescreen LCD	10.0625" x 16.0625"	18.9375"	N/A
PF20.0W9	•								•		16:9	20.0" Widescreen LCD	9.8125" x 17.4375"	20.0"	N/A
PF20.1W	•								•		16:10	20.1" Widescreen LCD	10.6875" x 17.125"	20.1875"	N/A
PF21.5W	•								•		16:9	21.5" Widescreen LCD	10.5625" x 18.75"	21.5625"	N/A
PF21.6W	•								•		16:10	21.6" Widescreen LCD	11.429" x 18.276"	21.5625"	N/A
PF22.0W	•								•		16:10	22.0" Widescreen LCD	18.67" x 11.21"	22.0"	N/A
PF23.0W9	•								•		16:9	23.0" Widescreen LCD	11.3125" x 20.0625"	23.0"	N/A
PF23.6W9	•								•		16:9	23.6" Widescreen LCD	11.5625" x 20.5625"	23.5625"	N/A
PF24.0W	•								•		16:10	24.0" Widescreen LCD	12.75" x 20.4375"	24.125"	N/A
PF24.0W9	•								•		16:9	24.0" Widescreen LCD	11.8125" x 20.9375"	24.0"	N/A
PF25.0W9	•								•		16:9	25.0" Widescreen LCD	12.25" x 21.8125"	25.0"	N/A
PF26.0W	•								•		16:10	26.0" Widescreen LCD	13.5625" x 21.6875"	25.5625"	N/A
PF27.0W	•								•		16:10	27.0" Widescreen LCD	14.3125" x 22.9375"	27.0625"	N/A
PF27.0W9	•								•		16:9	27.0" Widescreen LCD	13.25" x 23.5625"	27.0625"	N/A
PF28.0W	•								•		16:10	28.0" Widescreen LCD	14.625" x 23.375"	27.5625"	N/A
PF30.0W	•								•		16:10	30.0" Widescreen LCD	15.75" x 25.1875"	29.75"	N/A

Order the Correct 3M™ Privacy Filter

Choose from widescreen or standard size to assure the correct fit for your notebook or LCD monitor

NOTE: Measure height and width of viewable area only.

For proper fit, do not include the plastic monitor or laptop frame in your measurement.

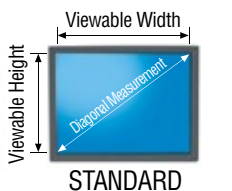
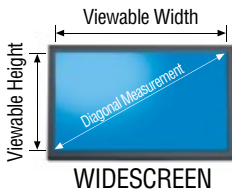

Frameless Gold Netbook/Notebook Privacy Filters

GPF17.0											5:4	17.0" Standard LCD	10.6875" x 13.9375"	17.0625"	N/A
GPF19.0											5:4	19.0" Standard LCD	11.875" x 14.8125"	19.0"	N/A
GPF8.9W											16:9	8.9" Widescreen Netbook	4.5" x 7.6875"	8.875"	N/A
GPF10.1W											16:9	10.1" Widescreen Netbook	4.9375" x 8.8125"	10.0625"	N/A
GPF11.6W9											16:9	11.6" Widescreen Netbook	5.6875" x 10.125"	11.625"	N/A
GPF12.1W											16:10	12.1" Widescreen Notebook	6.4375" x 10.3125"	12.125"	N/A
GPF12.5W9											16:9	12.5" Widescreen Notebook	6.125" x 10.9375"	12.5"	N/A
GPF13.3W											16:10	13.3" Widescreen Notebook	7.0625" x 11.3125"	13.3125"	N/A
GPF13.3W9											16:9	13.3" Widescreen Notebook	6.5" x 11.5625"	13.25"	N/A
GPF14.0W											16:9	14.0" Widescreen Notebook	6.875" x 12.1875"	14.0"	N/A
GPF14.1W											16:10	14.1" Widescreen Notebook	7.5" x 11.9375"	14.125"	N/A
GPF15.4W											16:10	15.4" Widescreen Notebook	8.1875" x 13.0625"	15.4375"	N/A
GPF15.6W											16:9	15.6" Widescreen Notebook	7.625" x 13.5625"	15.5625"	N/A
GPF17.0W											16:10	17.0" Widescreen Notebook	9.0625" x 14.5"	17.0625"	N/A
GPF19.0W											16:10	19.0" Widescreen Notebook	10.0625" x 16.0625"	18.9375"	N/A

Frameless MacBook® Air, MacBook® Pro and iMac® Privacy Filters *MacBook Pro filters fit models 2009 to present

PFMA11	•										16:10	11.0" Widescreen MacBook® Air	5.6875" x 10.125"	11.625"	N/A
PFMA13	•										16:10	13.3" Widescreen MacBook® Air	7.0625" x 11.3125"	13.3125"	N/A
PFMP13*	•										16:10	13.3" Widescreen MacBook® Pro	8.375" x 12.5625"	15.125"	N/A
PFMP15*	•										16:10	15.4" Widescreen MacBook® Pro	9.25" x 14.125"	16.875"	N/A
PFMP17*	•										16:10	17.0" Widescreen MacBook® Pro	9.9375" x 15.25"	18.1875"	N/A
PFMI27	•										16:9	27.0" Widescreen iMac®	15.25" x 25.5625"	29.75"	N/A
GPMA11											16:10	11.0" Widescreen MacBook® Air	5.6875" x 10.125"	11.625"	N/A
GPMA13											16:10	13.3" Widescreen MacBook® Air	7.0625" x 11.3125"	13.3125"	N/A
GPMP13											16:10	13.3" Widescreen MacBook® Pro	8.375" x 12.5625"	15.125"	N/A
GPMP15											16:10	15.4" Widescreen MacBook® Pro	9.25" x 14.125"	16.875"	N/A
GPMP17											16:10	17.0" Widescreen MacBook® Pro	9.9375" x 15.25"	18.1875"	N/A

Framed Desktop LCD Privacy Filters

PF317	•									95%	5:4	17.0" Standard LCD	10.9375" x 13.5625"	17.4375"	N/A
PF319	•									95%	5:4	18.1" – 19.0" Standard CRT	12.375" x 15.9375"	19.6875"	N/A
PF317W	•									95%	16:10	16.9" – 17.0" Widescreen LCD	9.5" x 14.6875"	17.6875"	N/A
PF319W	•									95%	16:10	18.4" – 19.0" Widescreen LCD	10.5625" x 16.625"	19.75"	N/A
PF320W	•									95%	16:9	20.0" – 20.1" Widescreen LCD	10.9375" x 17.6875"	20.8125"	N/A
PF322W	•									95%	16:10	21.5" – 22.0" Widescreen LCD	12.125" x 19.125"	22.625"	N/A
PF324W	•									95%	16:10	23.6" – 24.0" Widescreen LCD	13.125" x 20.875"	24.625"	N/A

***Light tint glass offers 45% transmission, which means more light passes through than with standard tint glass (31% transmission).

Workstation Guidelines

For Optimal Personal Comfort

Use these guidelines to set up your workspace to ensure good ergonomic posture and to attain optimal personal comfort.

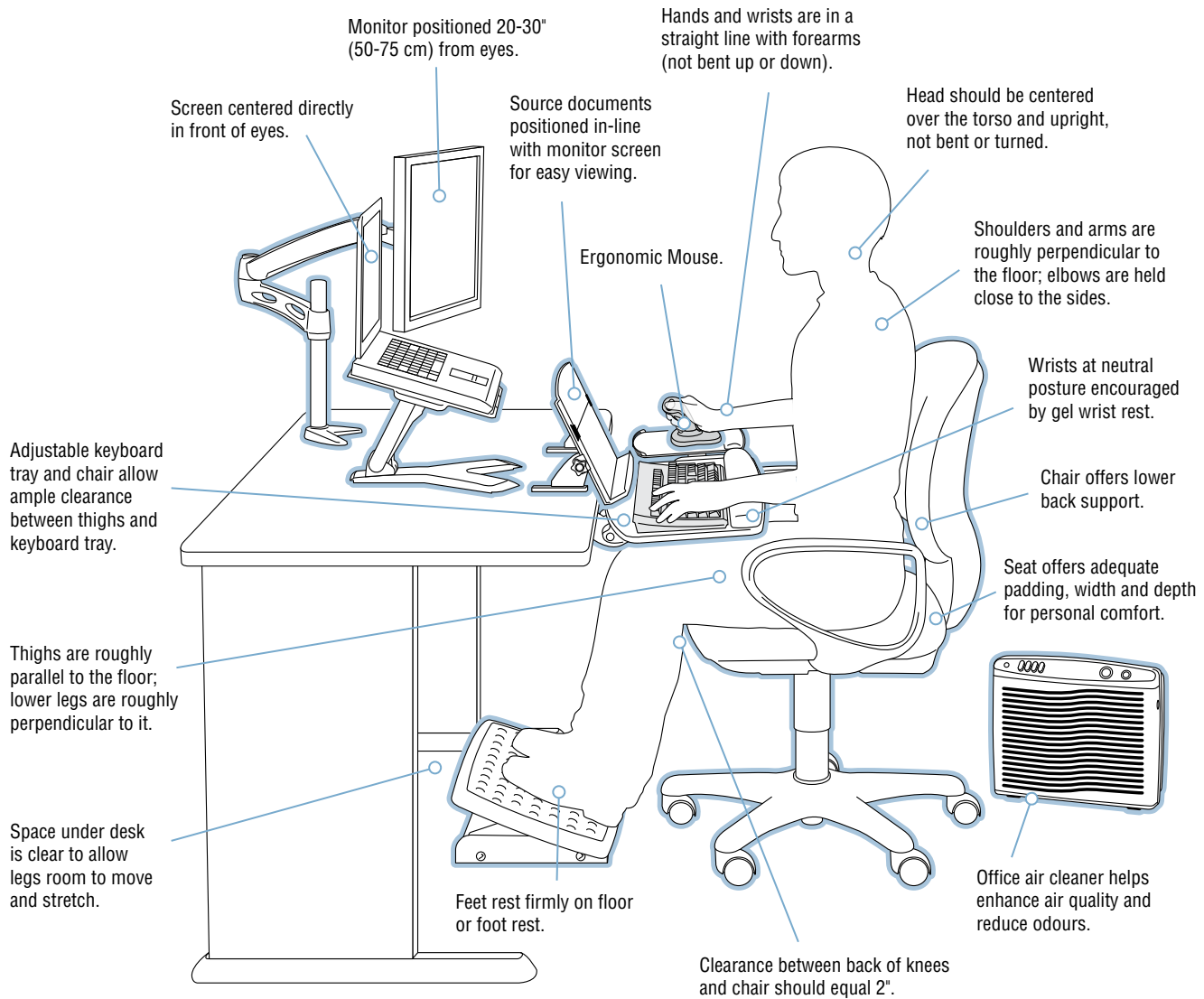

Recommended Positioning

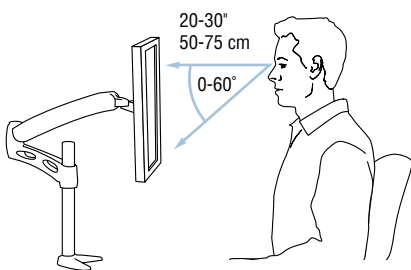

To avoid eyestrain, position your monitor within a comfortable viewing distance, at or below eye level, and within your 60° viewing field.

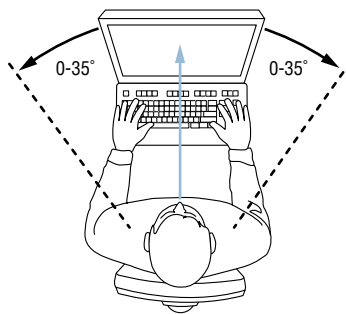

Position source documents in line with your screen, and no more than 35° to either side, to avoid excessive turning or bending of your neck.

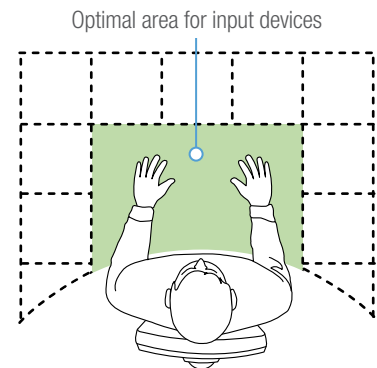

Place input devices within the recommended area to avoid strain on your wrists, arms and hands.

Exercises

To Promote Ergonomic Comfort

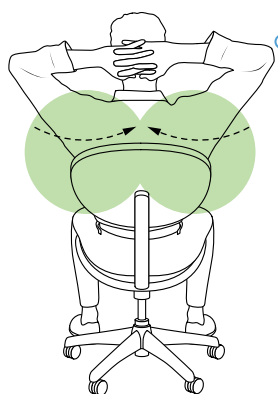

Executive Stretch - for upper back, chest and shoulders
Sit upright in your chair. Clasp your hands behind your head, keeping your elbows in line with your ears. Press your elbows back as far as possible, squeezing your shoulder blades together. Relax, then repeat 3 times.



Focusing Technique - for eye relaxation
Focus on an object at least 20' away or as far from your work area as possible, then move your eyes around and look at other objects. Look back at your computer screen. Repeat throughout the work day.

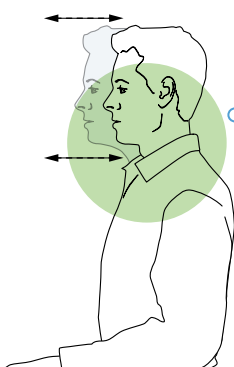

Neck Glide - for neck
Sit comfortably upright and look straight ahead. Keeping your head and ears level, glide your head back as far as it will go. Now glide your head forward. Repeat 3 times.

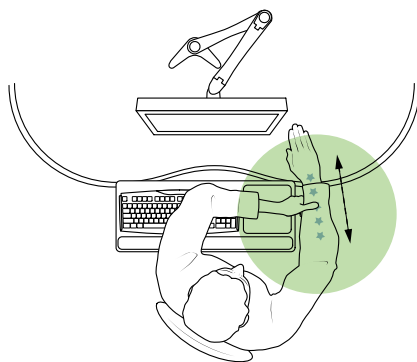

Arm Massage - for forearms
Sit at a desk or table. Place your arm in front of you with your hand palm-down. Use your thumb to press firmly on your opposite arm, moving it slowly from your wrist to elbow and back down. Repeat 3 times.

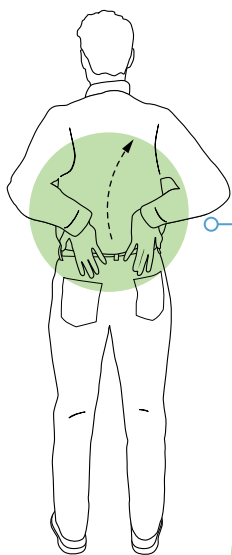

Reverse the Curve - for back and hips
Stand with your feet slightly apart. Place your palms in the curve of your lower back. Keep your chin down and focus on an object in front of you. Bend backward, supporting your lower back with your hands. Don't lock your knees. Hold for 5 to 10 seconds. Repeat 3 to 5 times.

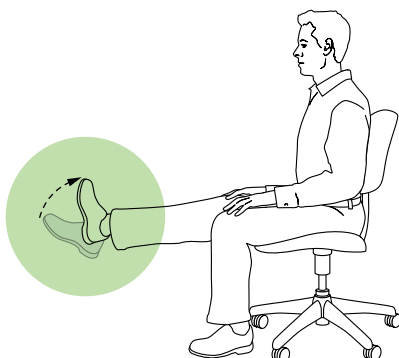

Leg Extension - for legs and lower back
Sit in a chair and straighten one leg directly in front of you. Flex your foot by pointing your toes toward the ceiling. Flex hard for 5 seconds, then release. Repeat 3 to 5 times. Return foot to floor and switch legs.

There are many possible causes for physical discomfort. If you are experiencing symptoms that persist for more than two weeks or are severe enough to interfere with your job or personal activities, consider seeking medical assistance.

Making Greener Solutions A Priority



Preconsumer Recycled Content



3M Ergonomics offers products that include percentages of preconsumer recycled content. While you help increase your office comfort, you can decrease your impact on the environment.

100%

Preconsumer

C91
C71

3M™ Desktop Organizers



25%

Preconsumer

WR315LE
WR314LE
WR310LE
WR309LE
WR305LE
WR340LE
MW310LE
MW309LE

3M™ Gel Wrist Rests



3M™ Adjustable Keyboard Trays

25%

Preconsumer

AKT180LE
AKT151LE
AKT150LE
AKT101LE
AKT100LE
AKT80LE

70%

Preconsumer

AKT170LE
AKT91LE
AKT90LE
AKT71LE
AKT70LE
AKT65LE
AKT60LE



40%

Preconsumer

DH640

3M™ Document Holders



15%

Preconsumer

WR422LE
WR421LE
WR420LE

3M™ Gel Wrist Rest Platforms



3M™ Easy-Adjust Monitor Arms

45%

Preconsumer

MA260MB
MA240MB



3M

Office Supplies Division Consumer & Office Business

3M Canada

P.O. Box 5757
London, ON N6A 4T1
1-800-3M HELPS
www.3M.com

3M, Post-it, Safety-Walk, Scotch, Command, Precise, Dual Lock and Filtrite are trademarks of 3M.

Used under license in Canada.

All other trade names referenced are the service marks, trademarks, or registered trademarks of their respective companies. Please recycle. Printed in Canada.

© 2012, 3M. All rights reserved.

1210-02874E

*Antimicrobial product protection:

Gel-filled wrist rests with antimicrobial protection inhibits the growth of microorganisms, such as bacteria, on the product surface, that can cause stains, odors and product degradation

** Use of this product helps contribute to LEED® Green Building Certification EB O&M Credit 2.2 Sustainable Purchasing: Durable goods because 3M Gel Wrist Rests with black leatherette coverings (LE) contain a minimum of 20% preconsumer recycled content, exceeding the recycled content required in Credit 2.2.

Battery Saving Mousepad Designs Products identified by this symbol feature 3M Precision Optical Mousing Surfaces with battery saving designs which extend the battery life of wireless optical mice up to 75%. Our lab testing has shown that these surfaces draw less current and thus offer 75% more battery life. The lab tests were done using mice from the leading manufacturers in the marketplace (Microsoft and Logitech) in conjunction with batteries from the leading battery manufacturers in the US (Energizer, Duracell and Rayovac). Our battery saving mousing surfaces feature the 3M micro-textured technology used to make 3M Precision Optical Mousing Surfaces.