



OWNER'S MANUAL

PRODUCT NAME 14"CHARCOAL GRILL-RED

Product code: 680045331006

UPC code: 182995000286

Date of purchase: ____/____/____



EXPLODED VIEW

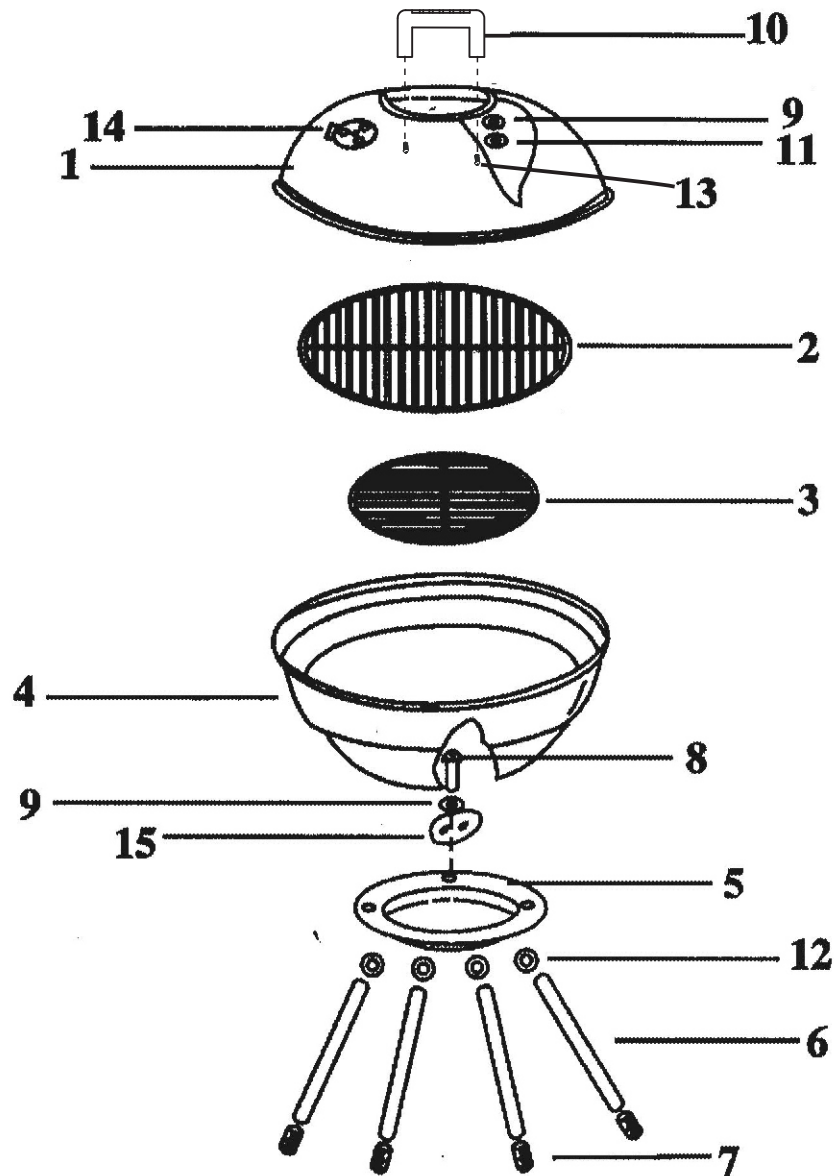

PARTS LISTING

PART NO.	DESCRIPTION	QUANTITY	PART NO.	DESCRIPTION	QUANTITY
1	GRILL TOP	1	9	WASHERS	2
2	GRILL	1	10	PHENOLIC HANDLE	1
3	GRATE	1	11	HEX NUT	2
4	GRILL BOTTOM	1	12	INSULATED WASHER	4
5	ASH TRAY	1	13	SCREW FOR HANDLE	2
6	LEG	4	14	SCREW NUT AND VALVE	1
7	LEG CAP	4	15	ASH LEAK	1
8	SCREW FOR LEG	4			



ASSEMBLY INSTRUCTIONS

TOOLS NEEDED:

5/16" OPEN END WRENCH
PLIERS

SLOTTED SCREWDRIVER
PHILLIPS HEAD SCREWDRIVER

PRE-ASSEMBLY CHECK LIST:

1. To assure fast and easy assembly, follow the instructions below in their proper sequence.
2. Check all parts carefully and compare them to the parts list.

ASSEMBLY INSTRUCTION:

1. Attach the legs (6) onto grill bottom (4), using screws (8) with washer (9) on inside of grill. Insulated washers (12) should be on outside of grill bottom. put leg through hole of ash tray before attaching to grill bottom. Finger tighten to hold them together, one by one.
2. Tighten the screws using a screwdriver. Do not twist leg to tighten.
3. Place small grate (3) into small recess of bottom unit.
4. Place grill (2) on unit.
5. Attach the phenolic handle (10) to the grill top (1) and secure with screws (13), washers (9) and nuts (11). (As Per Figure II).

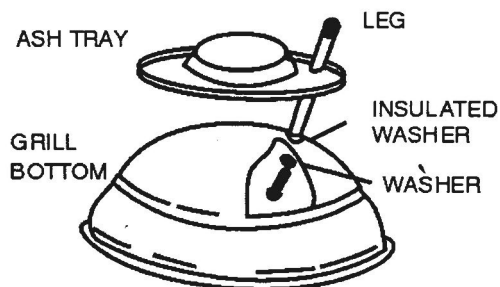

FIG.I

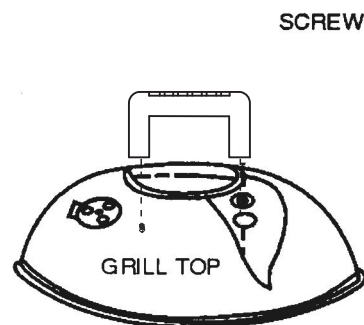

FIG.II

IMPORTANT: AS WITH ANY TABLE-TOP GRILL, CARE MUST BE TAKEN TO PREVENT HEAT DAMAGE TO ANYTHING AROUND OR UNDER THE GRILL.
DO NOT USE WATER ON BBQ WHILE HOT AS THIS WILL DAMAGE THE FINISH.
CLOSE ALL VENTS TO EXTINGUISH COALS.

WARNING

Great Care has been taken during production to remove sharp edges but you should handle all components with care to avoid possible injury.



WARNING: Combustion byproducts produced when using this product include carbon monoxide, a chemical known to the State of California to cause birth defects or other reproductive harm. For more information go to www.P65Warnings.ca.gov



ADVERTENCIA: Los subproductos de la combustión producidos al usar este producto incluyen monóxido de carbono, un químico conocido en el Estado de California como causante de defectos de nacimiento u otros daños reproductivos. Para obtener más información, vaya a www.P65Warnings.ca.gov



Made in / Hecho en CHINA

Distributed by Kmart Corporation, Hoffman Estates, IL 60179

See our extensive assortment of outdoor living products
on-line at www.sears.com and www.kmart.com