

Standard Olympic Weight Bench



IMPORTANT: Read all instructions carefully before using this product. Retain this owner's manual for future reference. The specifications of this product may vary from this photo and, subject to change without notice.



PLEASE DO NOT RETURN THIS PRODUCT TO THE STORE.

STOP. Contact customer service if you have any questions regarding assembly or proper operation of the machine.

Email us at:

Service@paradigmhw.com

Or call us at:

1-844-641-7920

Hours:

8:00 am to 5:00 pm (PST) Daily

TABLE OF CONTENTS

| | |
|---------------------------|----|
| SERVICE----- | 2 |
| LABEL PLACEMENT----- | 3 |
| PRODUCT SAFETY----- | 4 |
| ASSEMBLY PREPARATION----- | 5 |
| PRODUCT DRAWING----- | 6 |
| OVERVIEW----- | 7 |
| HARDWARE PACK----- | 9 |
| PART LIST----- | 10 |
| STEP 1----- | 12 |
| STEP 2----- | 14 |
| STEP 3----- | 16 |
| STEP 4----- | 18 |
| STEP 5----- | 20 |
| STEP 6----- | 22 |
| STEP 7----- | 24 |
| STEP 8----- | 26 |
| ADJUSTMENTS----- | 28 |
| LUBRICATION----- | 31 |
| WARRANTY----- | 32 |
| PARTS REQUEST FORM----- | 33 |

IMPORTANT: FOR NORTH AMERICA ONLY

For damaged or defective product, questions, replacement parts or any other service support, please contact our customer service department by the below methods:

For The Best Service, please Email:
service@paradigmhw.com

Response Time: 1-2 Business Days

Emailing us with the information above will be the best method to receive a response during peak business hours

Website:
www.paradigmhw.com

Toll-Free:

1-844-641-7920

(8:00 AM - 5:00 PM Pacific Standard Time, Daily)

Response time may vary via calling

Please have the following information ready when requesting for service:

- Your name
- Phone number
- Model number
- Serial number
- Part number
- Proof of Purchase

For damaged or defective product please contact our customer service before returning to the store.

Paradigm Health & Wellness, Inc.

1189 Jellick Ave.

City of Industry, CA 91748, USA

LABEL PLACEMENT

| | |
|---|--|
| <p>UNDER PENALTY OF LAW THIS TAG NOT TO BE REMOVED EXCEPT BY THE CONSUMER</p> <p>ALL NEW MATERIAL CONSISTING OF POLYURETHANE FOAM PAD_100%</p> | <p>NOTICE</p> <p>This article does not meet the flammability requirements of California Bureau of Home Furnishings technical bulletin 117. Care should be exercised near open flame or with burning cigarettes.</p> |
| <p>REGISTRY NO. VA25302 (CN)</p> | |
| <p>Certification is made by the manufacturer that the materials in this article are described in accordance with law.</p> | |
| <p>Paradigm Health and Wellness, Inc. 1189 Jellick Ave. City of Industry CA 91748, USA</p> | <p>AVIS</p> <p>Ce produit ne satisfait pas aux critères d'inflammabilité spécifiés à l'article 117 du devis technique du California Bureau of Home Furnishings. Ne pas utiliser près d'une source de chaleur ou d'une flamme nue (cigarettes, etc.)</p> |
| <p>SOUS PEINE DE SANCTION LÉGALE, CETTE ÉTIQUETTE NE PEUT ÊTRE ENLEVÉE PAR UNE PERSONNE AUTRE QUE LE CONSOMMATEUR</p> <p>ENTIÈREMENT FABRIQUÉ DE MATÉRIAUX NEUFS REMBOURRAGE DE MOUSSE DE POLYURÉTHANE 100 %</p> | |
| <p>NO D'ENREGISTREMENT VA25302 (CN)</p> | |
| <p>Cette étiquette est apposée conformément aux lois Canadiennes.</p> | <p>NOTIFICACIÓN</p> <p>Este artículo no se ajusta a la inflamabilidad requisitos de Oficina de Mobiliario boletín técnico 117. Cuidado de California deben ejercerse cerca de una llama abierta o con cigarets ardientes.</p> |
| <p>Paradigm Health and Wellness, Inc. 1189 Jellick Ave. City of Industry, CA 91748 USA</p> | |
| <p>SE SANCIÓNARÁ LEGALMENTE A QUIENES QUITEN ESTA ETIQUETA. SOLO EL CONSUMIDOR PODRÁ QUITARLA.</p> <p>MATERIAL COMPLETAMENTE NUEVO COMPUESTO DE 100% REllENO DE ESPUMA DE POLIURETANO.</p> | |
| <p>NO. DE REG VA25302 (CN)</p> | <p>El fabricante certifica que los materiales de este artículo se describen según las leyes.</p> |
| <p>Paradigm Health and Wellness, Inc. 1189 Jellick Ave. City of Industry CA 91748, USA</p> | |
| <p>Paradigm Health and Wellness, Inc. 1189 Jellick Ave. City of Industry CA 91748, USA</p> | |

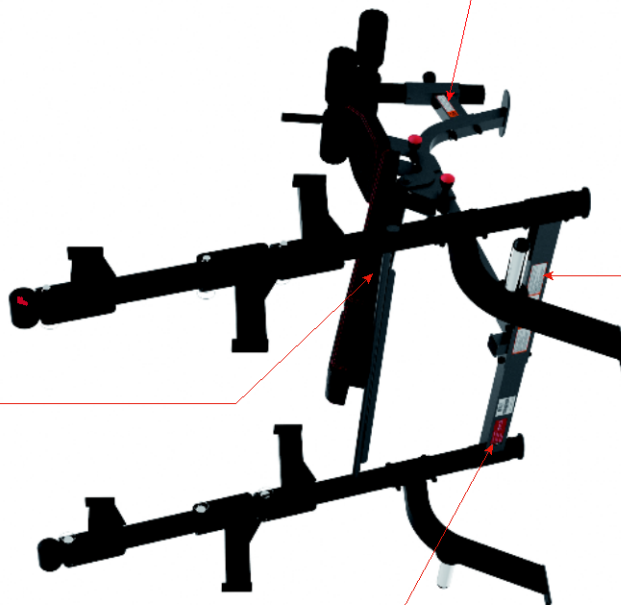

Always be sure that the pin is fully engaged into the hole you select. Failure to do so may result in serious injury.

Assurez-vous toujours que la goupille est pleinement engagée dans le trou que vous sélectionnez. Ne pas le faire peut entraîner des blessures graves.

Asegúrese siempre de que el pasador esté completamente enganchado en el agujero que usted selecciona. El no hacerlo puede resultar en lesiones graves.

WARNING
AVERTISSEMENT
ADVERTENCIA

Fitness Reality

For customer assistance, daily:
Pour le service à la clientèle composer le, tous les jours:
Para servicios al cliente, llame al, diario:

1-844-641-7920
8 am - 5 pm PST

ATTENTION: Veuillez à s'assurer toutes les clés de sécurité et débrancher le cordon d'alimentation avant d'effectuer les procédures de maintenance sur les équipements électriques.

- Inspectez et serrez soigneusement (écrous, boulons, Tapis en caoutchouc, supports en acier, etc.).
- Remplacez les rouleaux usés ou endommagés.
- Vérifiez les niveaux d'huile et les niveaux de lubrification.
- Vérifiez les niveaux de réglage pour être bien serrés.
- Vérifiez les niveaux de réglage pour être bien serrés.
- Utilisez un chiffon humide pour nettoyer le processus et l'humidité de l'équipement.
- Vérifiez l'équipement / bois / assemblage contre de la structure métallique.
- Lubrification: Voir le Manuel des propriétaires.

PRECAUCIÓN: Asegúrese de entrar las llaves de seguridad y desconectar el cable eléctrico antes de realizar cualquier procedimiento de mantenimiento del equipo eléctrico.

- Revise y apriete bien (tornillos, pernos, pasillos de caucho, soportes de acero, etc.).
- Reemplaz los rodillos dañados o desgastados.
- Verifique los niveles de aceite y los niveles de lubricación.
- Verifique los niveles de ajuste para que estén bien apretados.
- Verifique los niveles de ajuste para que estén bien apretados.
- Use un paño húmedo para limpiar el polvo y la humedad del equipo.
- Verifique el equipo / madera / ensamblaje contra el equipo.
- Lubricación: ver el Manual del usuario.

CAUTION: Make sure to remove any safety keys and unplug the power cord before performing any maintenance procedures on Electrical Equipment.

- Inspect and tighten securely (Nuts, Bolts, Rubber Pads, Steel Brackets, etc.).
- Replace rollers that are worn or damaged.
- Check to ensure the machine is leveled.
- Check Adjustment knobs to be Securely Tightened.

WEEKLY:

- Use a damp cloth to clean dust and moisture from equipment.
- Clean and Wipe Lubrication Rollers, Track Wheels, Walking Belt.
- Lubrication: See Owner's Manual.

MAINTENANCE SCHEDULE

HORARIO DE MANTENIMIENTO

PRODUCT SAFETY

Read all instructions carefully before assembling and operating this product. Retain this owner's manual, do not remove any safety labels from the machine, and keep the original purchase receipt for future reference.

This Standard Olympic Weight Bench was designed and built for optimum safety. However, certain precautions apply whenever you operate the exercise equipment. Be sure to read the entire manual before assembling and operating this equipment. Also, please note the following safety instructions:

1. Consult your physician or other health care professionals before using the Bench.
2. Always wear proper exercise apparel when using the equipment. Use care when getting on or off the unit.
3. If any time you feel faint, light-headed or dizziness while operating the equipment, stop exercising immediately. You should also stop exercising if you are experiencing pain or any kind of discomfort.
4. Keep children and pets away from the equipment at all times.
5. Only one person should use the equipment at a time.
6. Make sure your equipment is correctly assembled before you use it. Be sure all screws, nuts, and bolts are tightened prior to use.
7. Do not operate this or any exercise equipment if it is damaged.
8. Wait 2 hours after eating before using the exercise equipment. If you get nauseous, stop exercising as soon as you feel queasy.
9. Always use this equipment on a clear and level surface. Do not use outdoors or near water.
10. Keep hands and feet away from any moving parts. Do not insert any object into any openings.
11. Keep loose clothes, jewelry, limbs and long hair away from moving parts.
12. Children under the age of 12 should not use this fitness equipment.
13. Children from 12 to 18 should have adult supervision.

WARNING: Before using this equipment you should consult with your personal physician to see if the Standard Olympic Weight Bench is appropriate for you. Do not use this equipment without your physician's approval. Do not use this equipment if you have any of the following conditions or ailments:

- Extreme obesity
- Glaucoma, retinal detachment or conjunctivitis
- Pregnancy
- Spinal injury, Cerebral Sclerosis, or acutely swollen joints
- Middle ear infection
- High blood pressure, Hypertension, Recent stroke or Transient ischemic attack
- Heart or circulatory disorders for which you are being treated
- Hiatus hernia or Ventral hernia
- Bone weaknesses including Osteoporosis, Unhealed fractures, Modularly pins, or Surgically implanted orthopedic supports
- Use of anti-coagulants including Aspirin in high doses

The Maximum Weight Capacity for this product is 1500lbs/680kgs.

ASSEMBLY PREPARATION

1. **Warning:** It is highly recommend that you have assistance during the assembly of the strength equipment.
2. Tools for assembly:
General tools needed for the assembly of the strength equipment.
 - Metric Allen Key Set
 - Metric Wrench Set or Adjustable Wrench
 - Flat Screwdriver
 - Phillips Screwdriver)
 - Rubber Mallet
 - Silicone Spray Oil
3. Insert bolts into the frame as illustrated in the drawing of each of the steps.
4. **Warning: Do NOT tighten the bolts, nuts, and screws until instructed to do so.**
Hand-tighten the bolts, nuts, and screw during assembly. Hand-tightening will allow for easily aligning the parts during assembly ,
5. It is highly recommended that a professional installer assembles the strength equipment. But, with the proper assistance, the right tools, and strictly following the assembly steps, and given enough time; the assembly of the unit can be achieved without professional help.
6. Thoroughly read each step before proceeding to assemble the items of that step.
7. To aid in assembly of the equipment, the hardware pack (bolts, nuts, washer...etc.) have been presorted according to their corresponding steps. **See Hardware Pack page.**
8. When the equipment is fully assembled check all the functions for correct operation. Consult the manual if you experience any issues, or for further help please contact our service department.
See page 2.

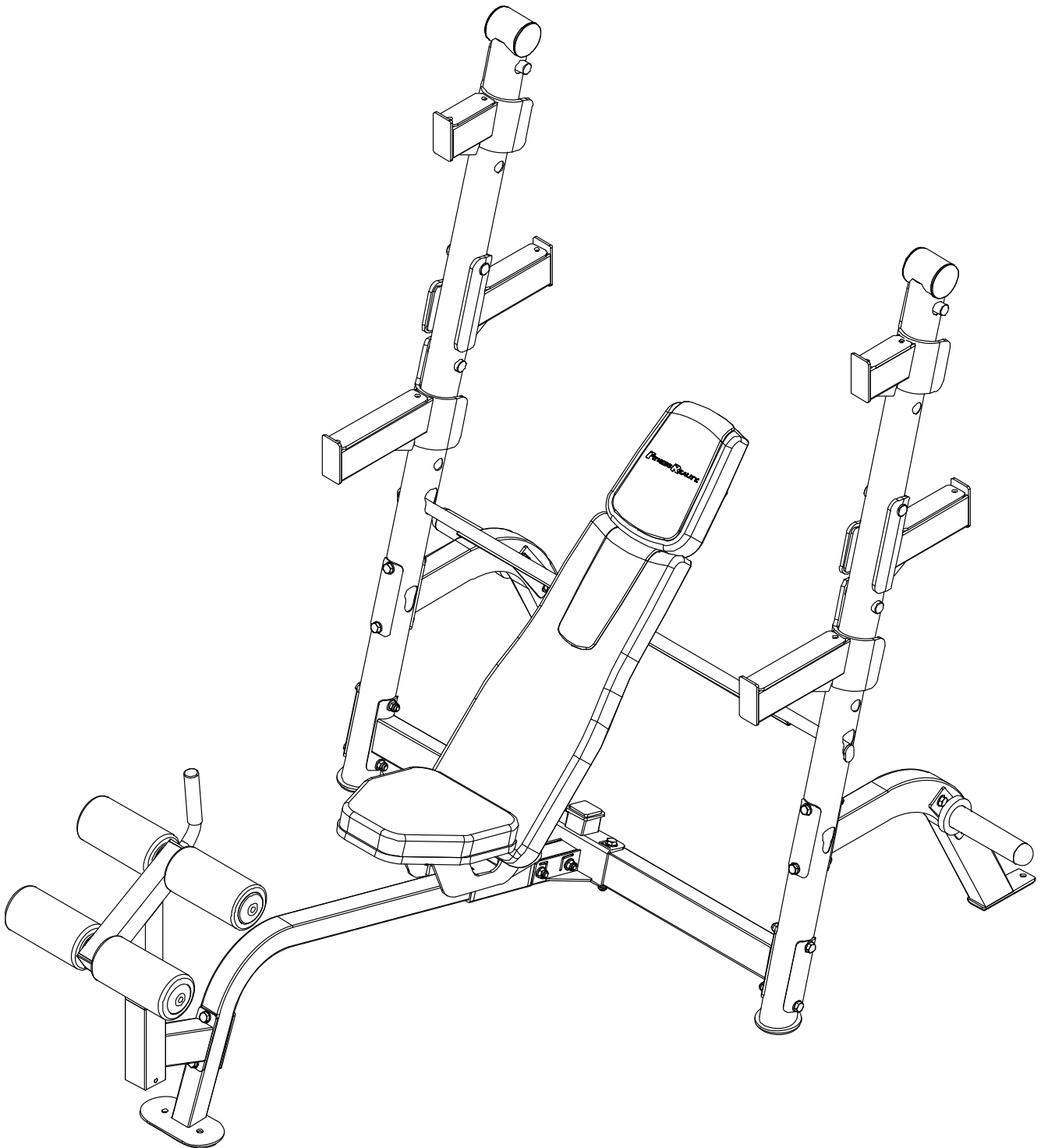

OVERVIEW DRAWING

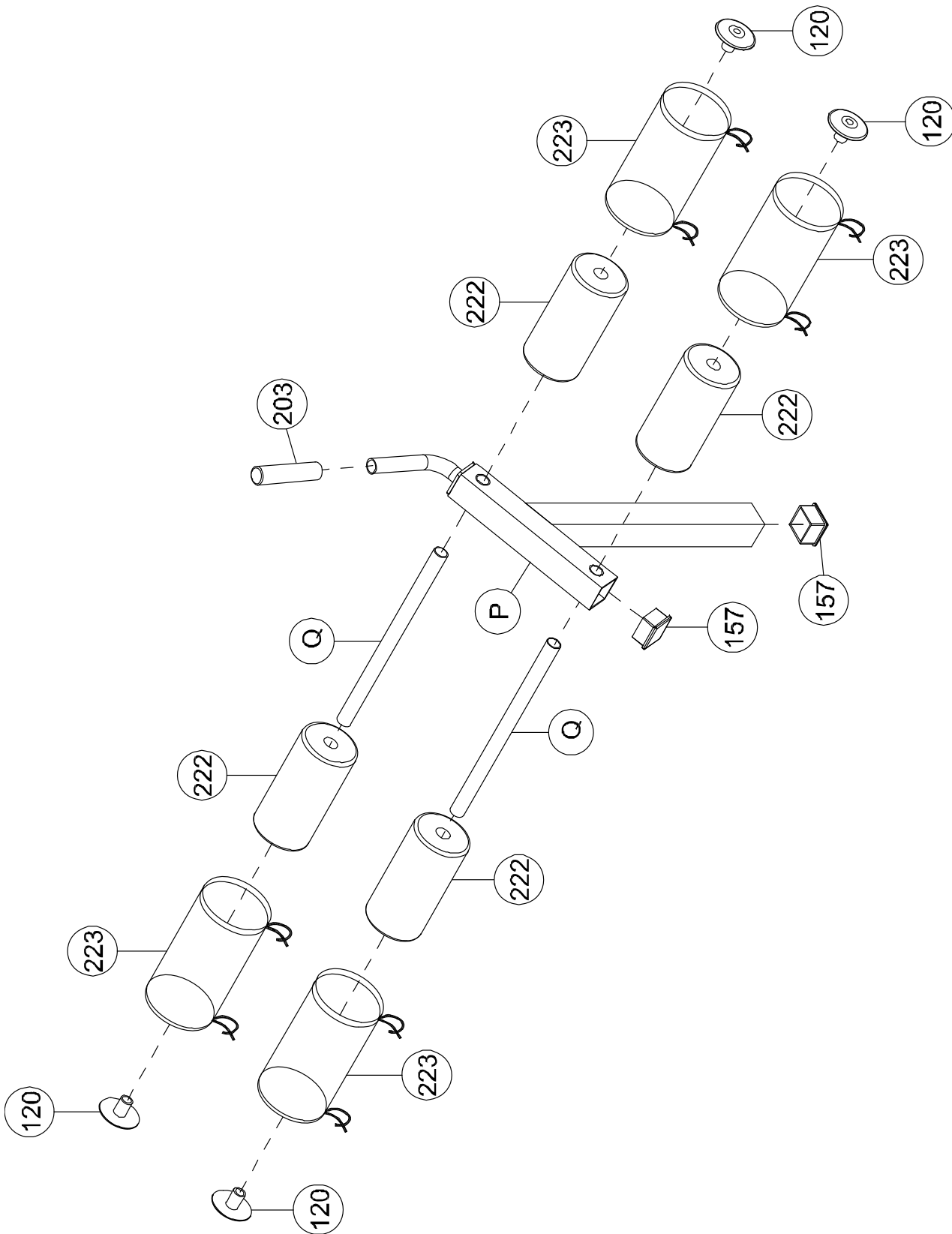

HARDWARE PACK

2863

STEP 1

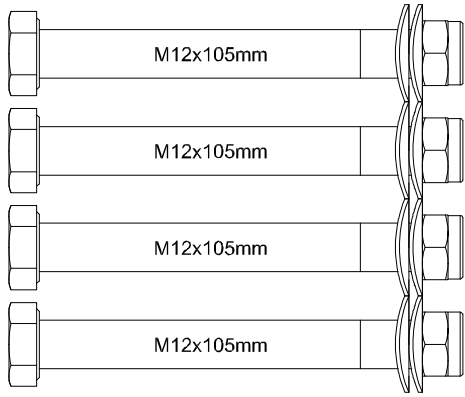

M12x105mm

M12x105mm

M12x105mm

M12x105mm

①⑥ X 4pcs ⑤⑨ X 8pcs ⑦⑥ X 4pcs

STEP 2

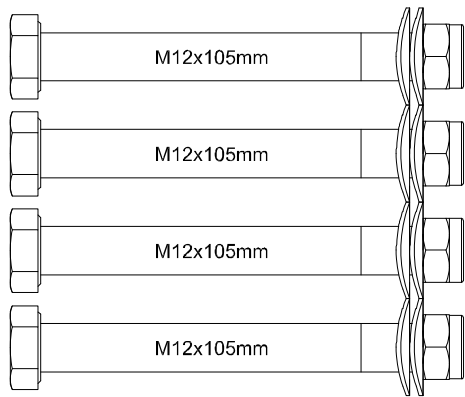

M12x105mm

M12x105mm

M12x105mm

M12x105mm

①⑥ X 4pcs ⑤⑨ X 8pcs ⑦⑥ X 4pcs

STEP 3

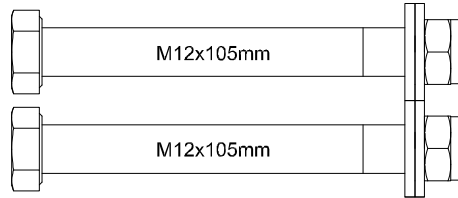

M12x105mm

M12x105mm

①⑥ X 2pcs ⑤② X 4pcs ⑦⑥ X 2pcs

STEP 4

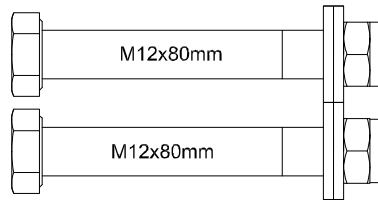

M12x80mm

M12x80mm

⑦ X 2pcs ⑤② X 4pcs ⑦⑥ X 2pcs

STEP 5

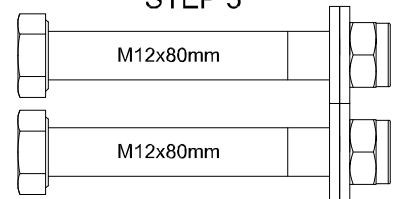

M12x80mm

M12x80mm

⑦ X 6pcs ⑤② X 12pcs ⑦⑥ X 6pcs

STEP 6

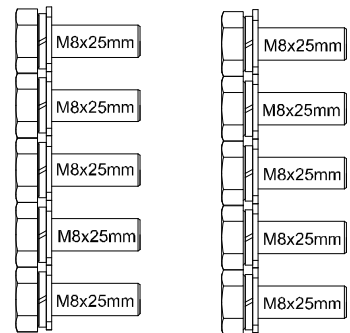

M8x25mm

M8x25mm

M8x25mm

M8x25mm

M8x25mm

③ X 10pcs ⑤⑥ X 10pcs ⑤⑦ X 10pcs

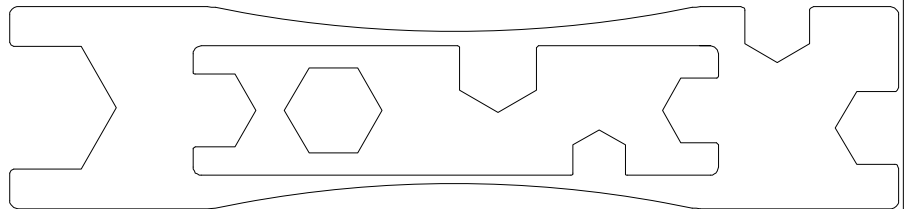

Wrench x 2PCS

PART LIST

| Part# | Description | Q'ty. | Part# | Description | Q'ty. |
|-------|-------------------------|-------|-------|---------------------------------|-------|
| A | Vertical Post | 2 | R | Flat Mounting Plate | 1 |
| B | Foot Beam | 2 | S | Seat Pad | 1 |
| C | Crossbeam | 1 | T | Backrest Pad | 1 |
| D | Short Safety Catch | 2 | U | Headrest Pad | 1 |
| E | Long Safety Catch | 2 | P | Leg Hold Down | 1 |
| F | Rear Safety Catch | 2 | Q | Foam Roller Tube | 2 |
| G | Backrest Adjustment Rod | 1 | 3 | Hex Bolt M8x1.25x25L | 10 |
| H | Main Frame Bracket | 1 | 7 | Hex Bolt M12x1.75x80L | 8 |
| I | Main Frame | 1 | 15 | Screw M6x10L | 12 |
| J | Seat Assembly Bracket | 1 | 16 | Hex Bolt M12x1.75x105L | 10 |
| K | Seat Plate | 1 | 23 | Hex Bolt M12x1.75x50L | 2 |
| L | Backrest Frame | 1 | 52 | Washer D24xD13.5x2.5 | 24 |
| M | Attachment Holder | 1 | 56 | Washer D8.4xD16x1.6 | 10 |
| N | Weight Horn | 2 | 57 | Spring Washer D8.1xD12.3x2.1 | 10 |
| O | Flat Mounting Plate | 2 | 59 | Curve Washer D21xD13x1 | 16 |
| V | Curved Mounting Plate | 4 | 76 | Nylon Nut M12 | 20 |

PART LIST

| Part# | Description | Q'ty. | Part# | Description | Q'ty. |
|-------|-------------------------------------|-------|-------|---|-------|
| 102 | Ball Knob D50xM16x22xD8 | 3 | 198 | Rubber Washer 50x180xt5.0 | 2 |
| 120 | Big End Cap D70xD21x38 | 4 | 199 | Rubber Washer 50x250xt5.0 | 2 |
| 130 | Round End Cap D76x2 | 4 | 203 | Rowing Bar Holder Φ24xΦ32x125 | 1 |
| 132 | Footbar End Cap D50x2 | 2 | 222 | Foam Roller ϕ 100x ϕ 25x200 | 4 |
| 153 | Square End Cap 50x50x2 | 4 | 223 | Sleeve D100x200 | 4 |
| 157 | Square End Cap 50x50x20 | 2 | 225 | Square Bushing 60x60x205 | 1 |
| 192 | Rubber Donut D80xD50x16 | 2 | 229 | Square Bushing 60x60x164 | 1 |
| 193 | Rubber Bumper 145x45xt5.0 | 2 | 273 | Powder Bushing ϕ 24x ϕ 20.8x ϕ 12.5x10x3 | 4 |
| 194 | Rubber Bumper D90x5 | 2 | 480 | Rubber Washer 100x187xt4.0 | 6 |
| 195 | Weight Horn Buffer ϕ 80x ϕ 50x16 | 2 | 481 | Rubber Washer 50x50xt5.0 | 1 |
| 196 | Rubber Bumper 90x190xt5.0 | 1 | 483 | Safety Catch Bumper 650x45xt5.0 | 1 |
| 197 | Rubber Bumper 50x120xt5.0 | 2 | | | |

STEP 1

1A. Attach Crossbeam (C) and two Curved Mounting Plate (V) parts to the Vertical Post (A) by using:

4 - (16) Hex Bolt M12x1.75x105L

8 - (59) Curve Washer D21xD13x1

4 - (76) Nylon Nut M12

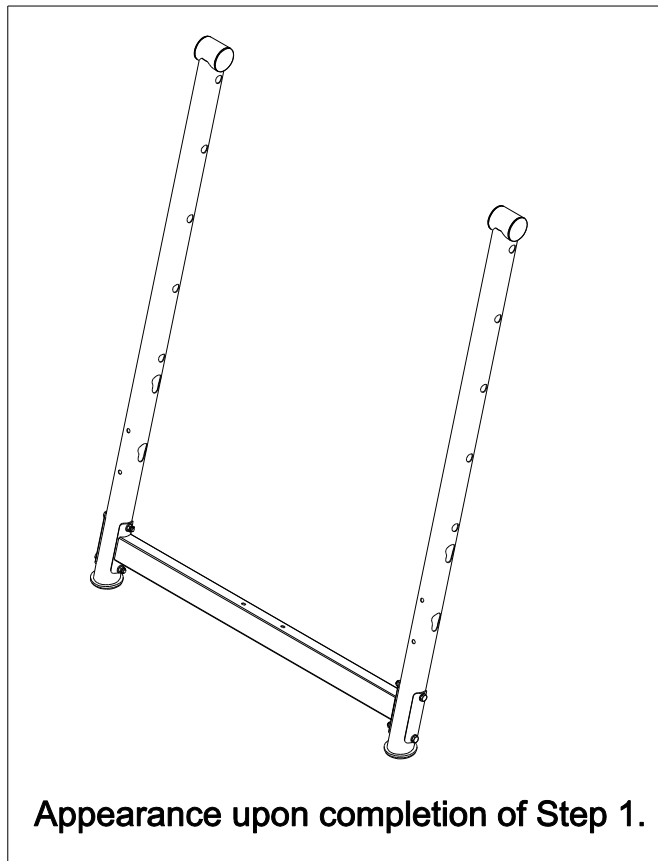

STEP 1

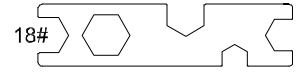
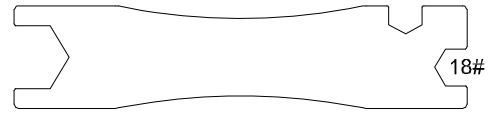

Wrench 2PCS

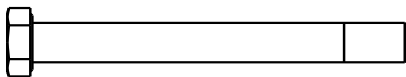
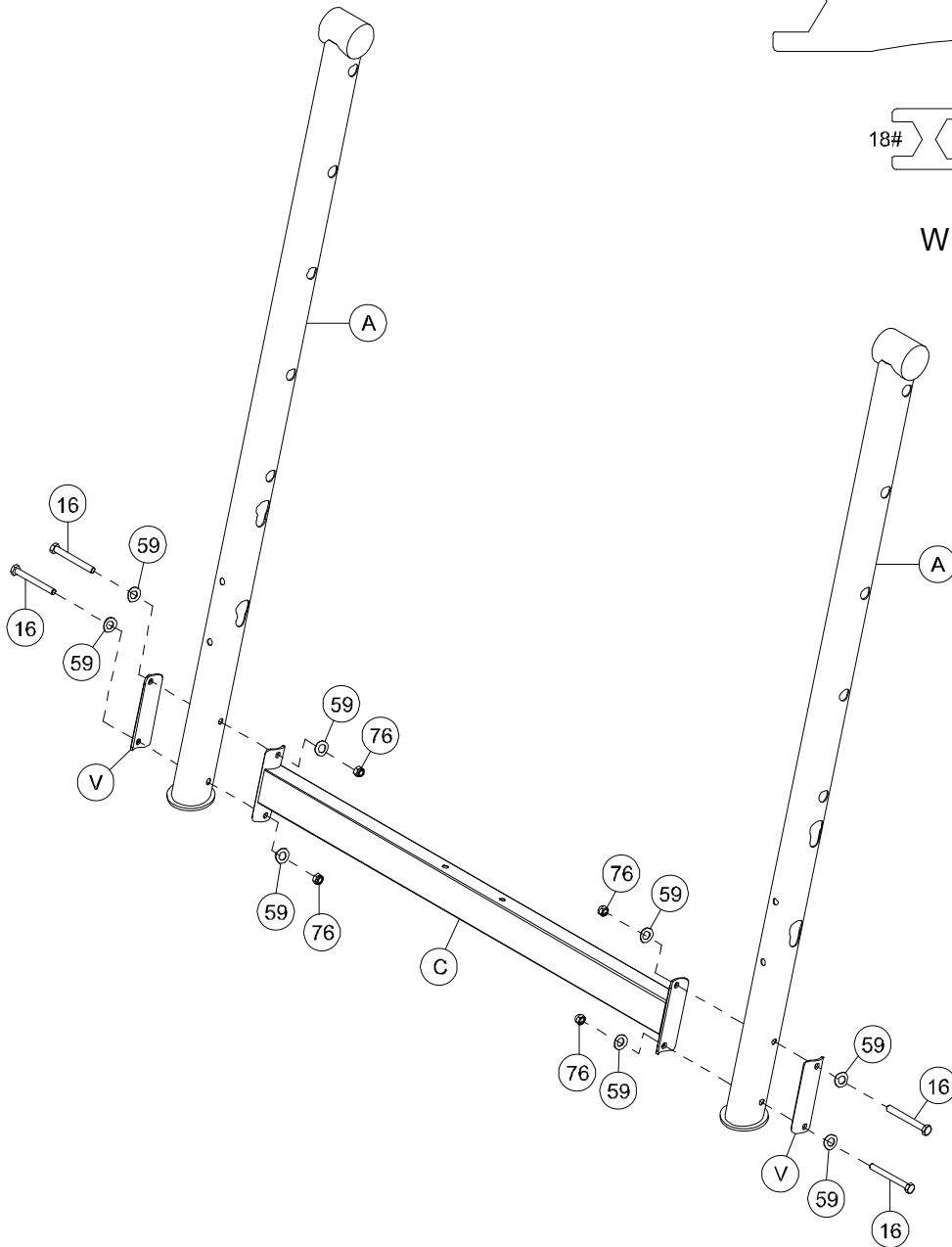

NO.16 Hex Bolt
M12x1.75x105
4PCS



NO.76 Nylon Nut
M12 4PCS



NO.59 Curve Washer
D21xD13x1
8PCS

STEP 2

2A. Attach the two Foot Beam (B) and two Curved Mounting Plate (V) parts to the Vertical Post (A) parts by using:

4 - (16) Hex Bolt M12x1.75x105L

8 - (59) Curve Washer D21xD13x1

4 - (76) Nylon Nut M12

With all four feet flat on the ground, proceed to thoroughly tight all the bolts

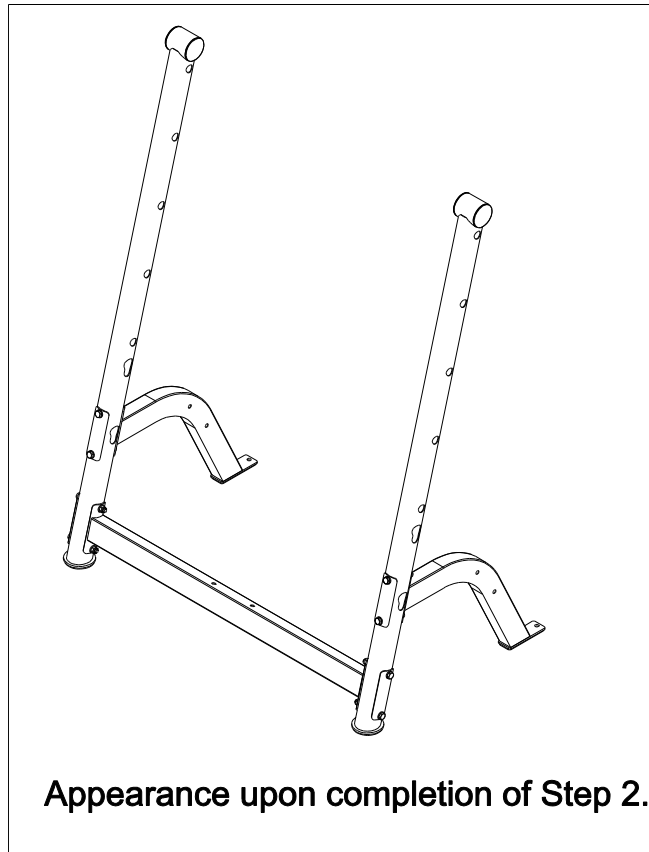

STEP 2

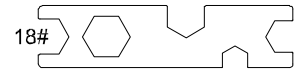
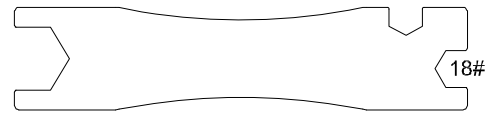

Wrench 2PCS

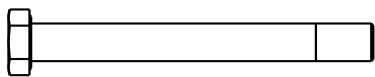
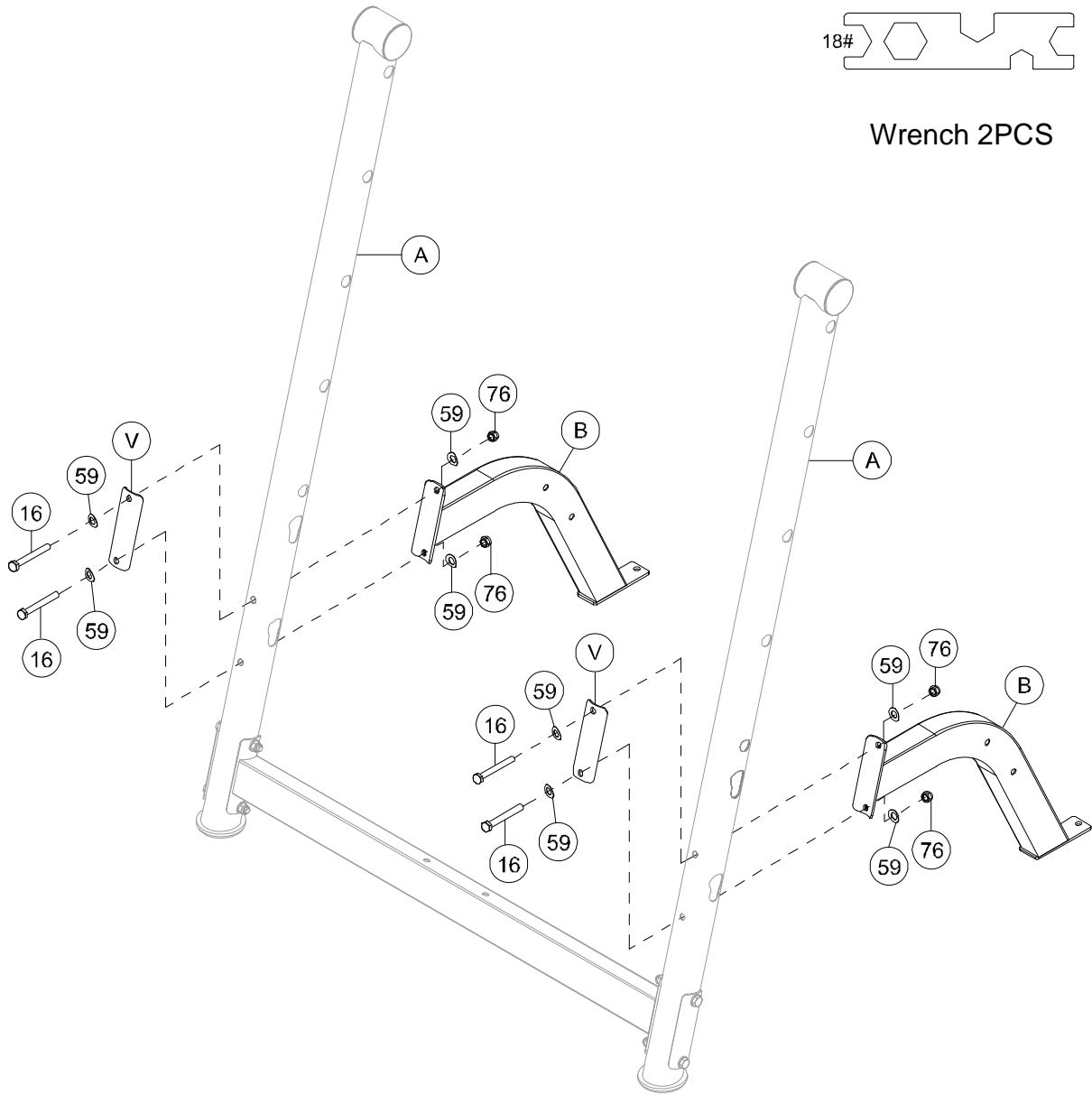

NO.16 Hex Bolt
M12x1.75x105
4PCS



NO.76 Nylon Nut
M12 4PCS



NO.59 Curve Washer
D21xD13x1
8PCS

STEP 3

3A. Attach Main Frame Bracket (H) to Crossbeam (C) by using:

2 - (16) Hex Bolt M12x1.75x105L

4 - (52) Washer D24xD13.5x2.5

2 - (76) Nylon Nut M12

3B. Insert the Backrest Adjustment Rod (G) into both of the Vertical Post (A) by aligning the tabs of the Backrest Adjustment Rod (G) with the stamped metal holes on Vertical Post (A) of the same shape.

Tip: The Backrest Adjustment Rod (G) can be inserted from the outer facing sides of the two Vertical Post (A), but we recommend inserting the Backrest Adjustment Rod (G) from the inner sides of the two Vertical Post (A).

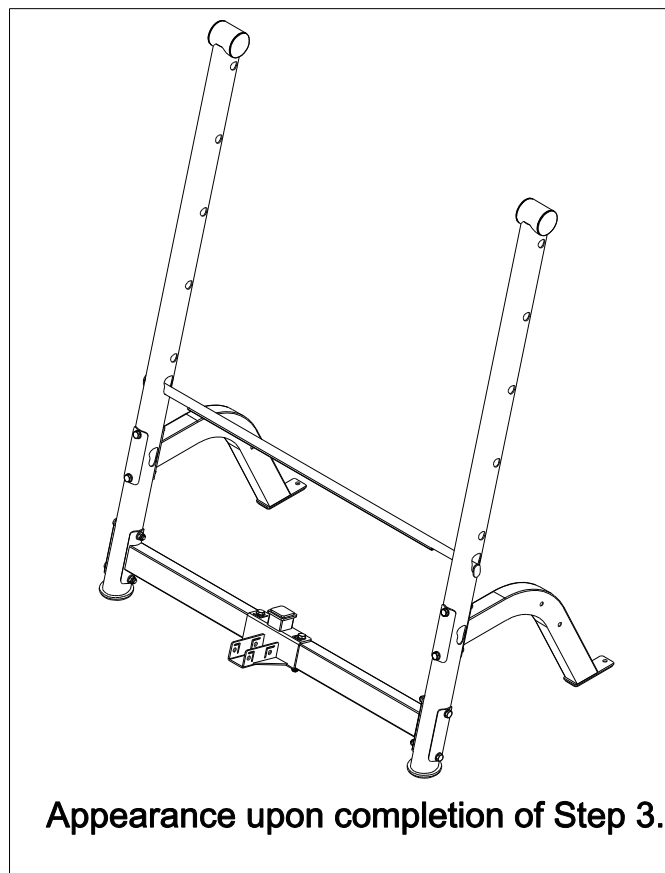

STEP 3

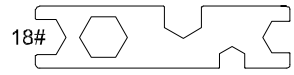
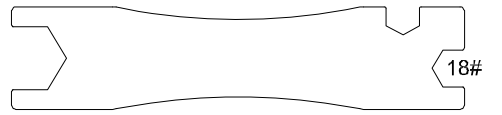

Wrench 2PCS

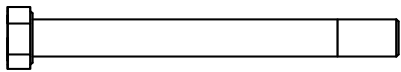
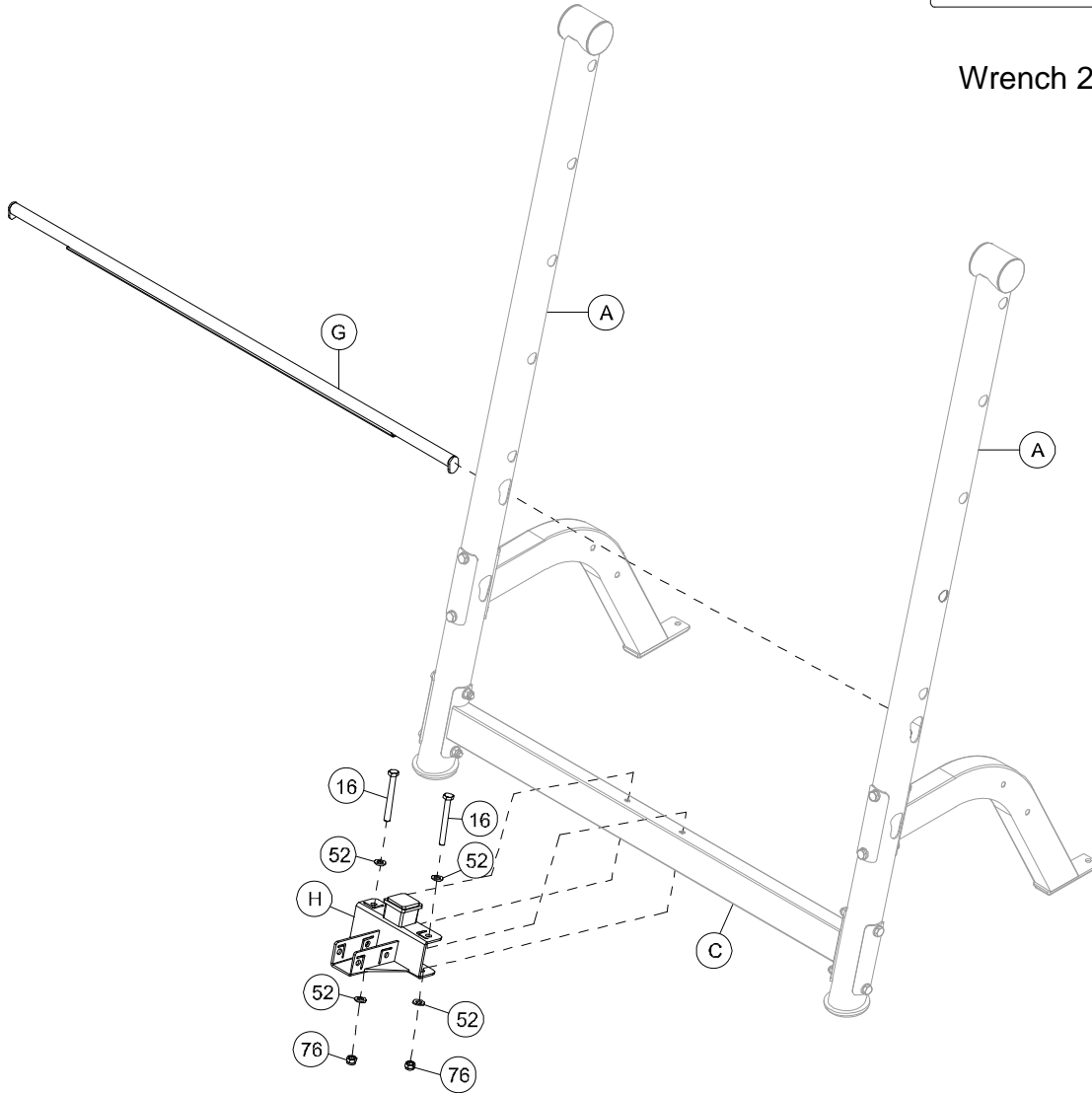

NO.16 Hex Bolt
M12x1.75x105L
2PCS



NO.76 Nylon Nut
M12 2PCS



NO.52 Flat Washer
D24xD13.5x2.5
4PCS

STEP 4

4A. Slide Seat Assembly Bracket (J) on to the Main Frame (I).

4B. Fasten the Seat Assembly Bracket (J) by installing two Ball Knob (102) parts, as shown in image AA-1.

4C. Once the Ball Knob (102) parts are installed, the Seat Assembly Bracket (J) can be locked into place along the shaft of the Main Frame (I) by aligning the Ball Knob (102) with the holes on the Main Frame (I).

4B. Attach Main Frame (I) to Main Frame Bracket (H) by using:

2 - (7) Hex Bolt M12x1.75x80L

4 - (52) Washer D24xD13.5x2.5

2 - (76) Nylon Nut M12

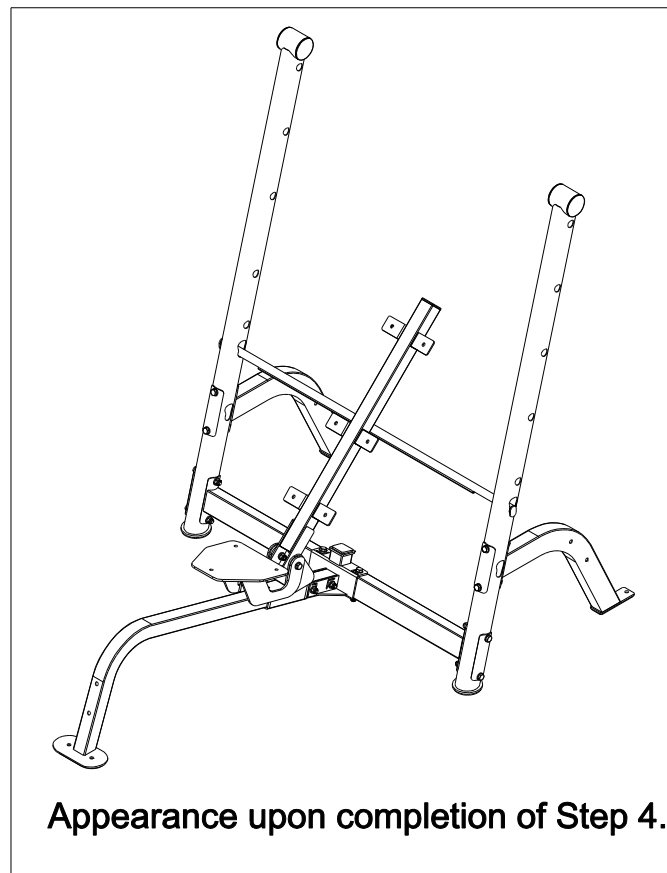

STEP 4

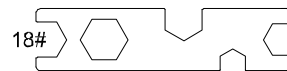
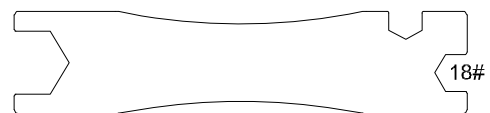

Wrench 2PCS

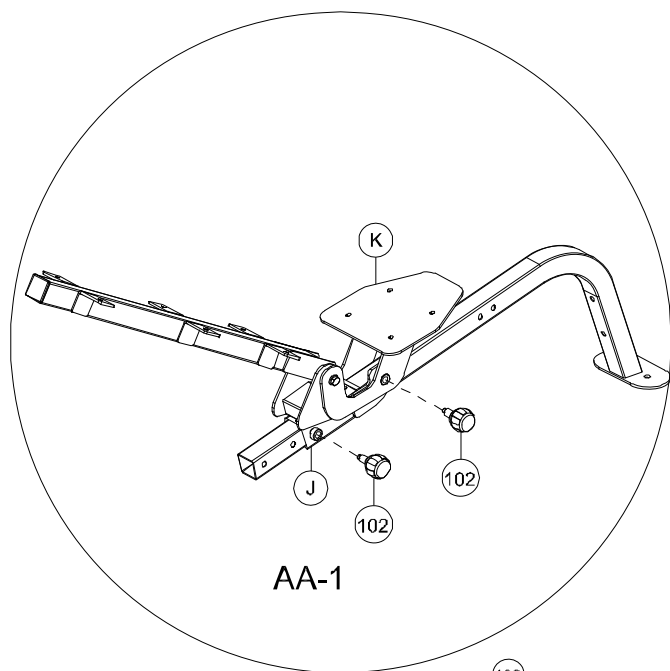

AA-1

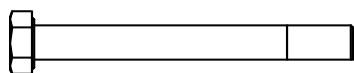
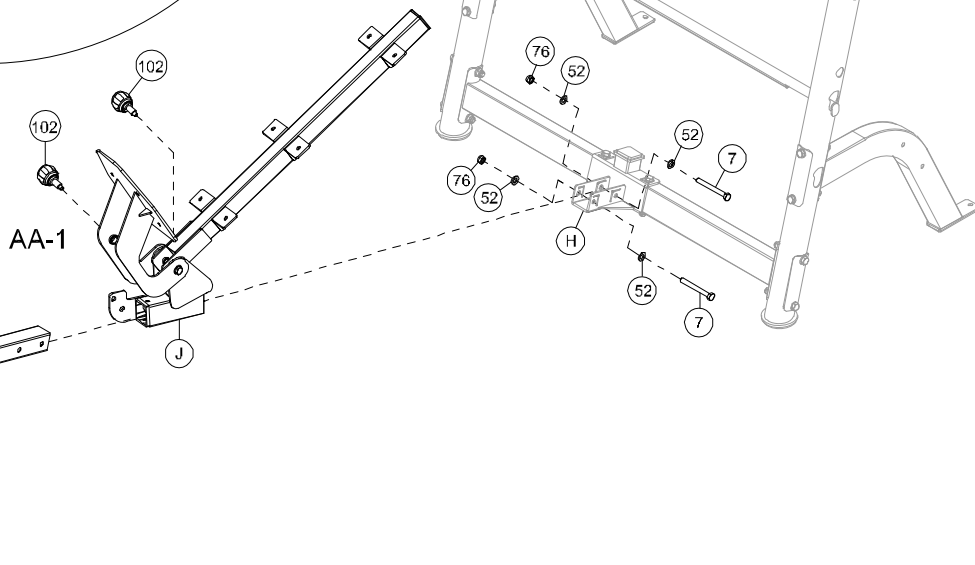

NO.7 Hex Bolt
M12x1.75x80L
2PCS



NO.76 Nylon Nut
M12 2PCS



NO.52 Flat Washer
D24xD13.5x2.5
4PCS

STEP 5

5A. Attach the two Weight Horn (N) and the two Flat Mounting Plate (O) parts to the two Foot Beam (B) parts by using:

4 - (7) Hex Bolt M12x1.75x80L

8 - (52) Washer D24xD13.5x2.5

4 - (76) Nylon Nut M12

5B. Mount the Attachment Holder (M) and the Flat Mounting Plate (R) to the two Main Frame (I) parts by using:

2 - (7) Hex Bolt M12x1.75x80L

4 - (52) Washer D24xD13.5x2.5

2 - (76) Nylon Nut M12

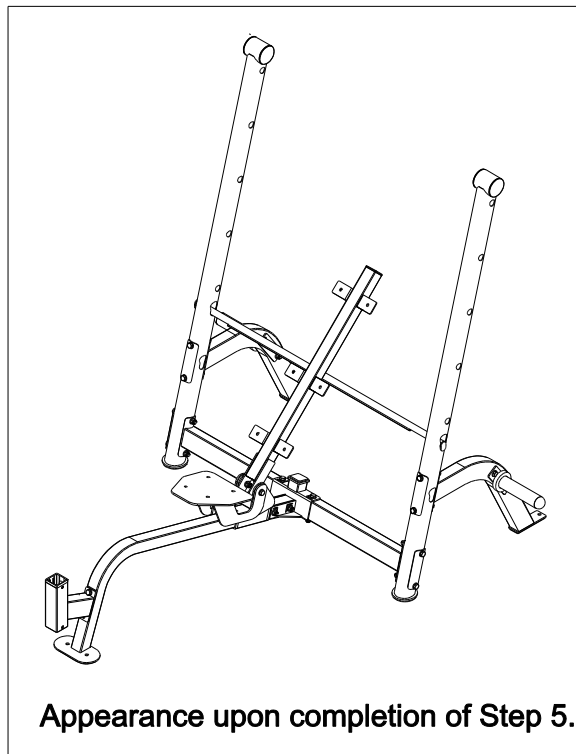

Appearance upon completion of Step 5.

STEP 5

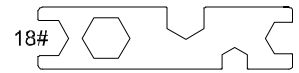
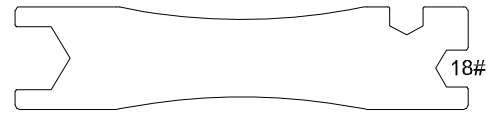

Wrench 2PCS

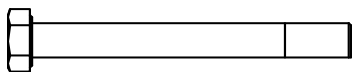
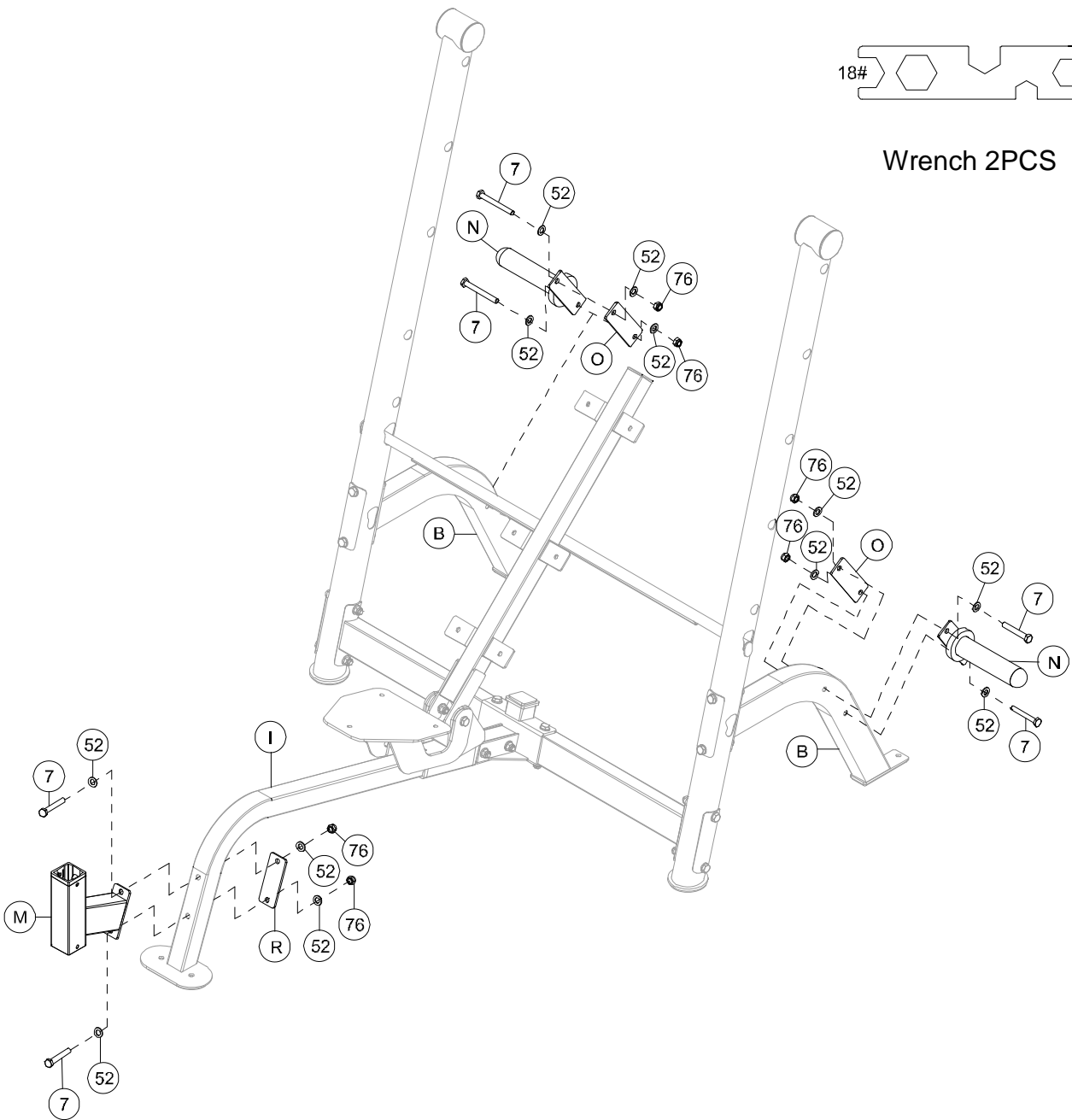

NO.7 Hex Bolt
M12x1.75x80L
6PCS



NO.76 Nylon Nut
M12 6PCS



NO.52 Flat Washer
D24xD13.5x2.5
12PCS

STEP 6

6A. Attach the Backrest Pad (T) to Backrest Frame (L) by first hand tightening the hardware listed below, then once all bolts are aligned, tightly fasten the Backrest Pad (T) into place using:

- 4 - (3) Hex Bolt M8x1.25x25L**
- 4 - (56) Washer D8.4xD16x1.6**
- 4 - (57) Spring Washer D8.1xD12.3x2.1**

6B. Attach the Headrest Pad (U) to Backrest Frame (L) by first hand tightening the hardware listed below, then once all bolts are aligned, tightly fasten the Headrest Pad (U) into place using:

- 2 - (3) Hex Bolt M8x1.25x25L**
- 2 - (56) Washer D8.4xD16x1.6**
- 2 - (57) Spring Washer D8.1xD12.3x2.1**

6C. Attach the Seat Pad (S) to Seat Plate (K) by first hand tightening the hardware listed below, then once all bolts are aligned, tightly fasten the Seat Pad (S) into place using:

- 4 - (3) Hex Bolt M8x1.25x25L**
- 4 - (56) Washer D8.4xD16x1.6**
- 4 - (57) Spring Washer D8.1xD12.3x2.1**

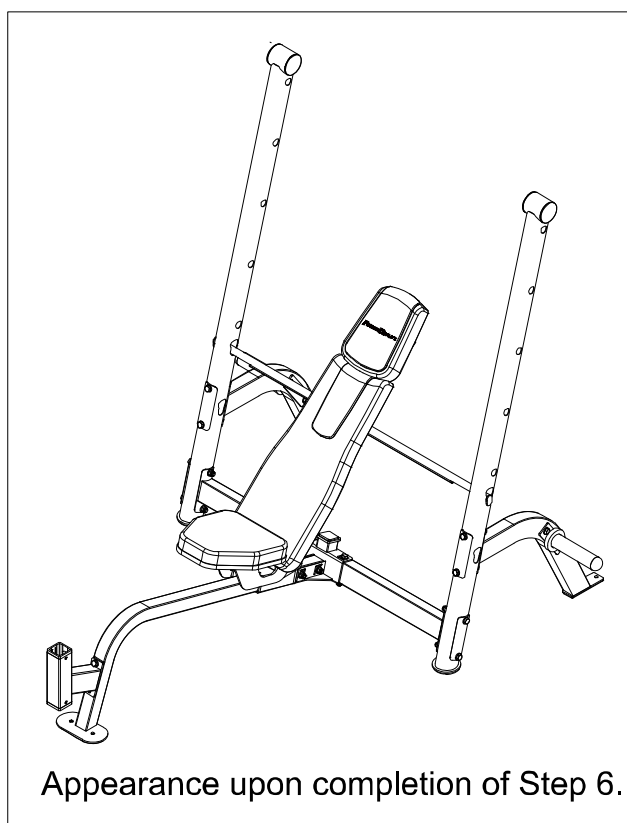

STEP 6

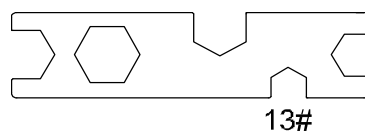

Wrench 1PC

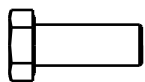
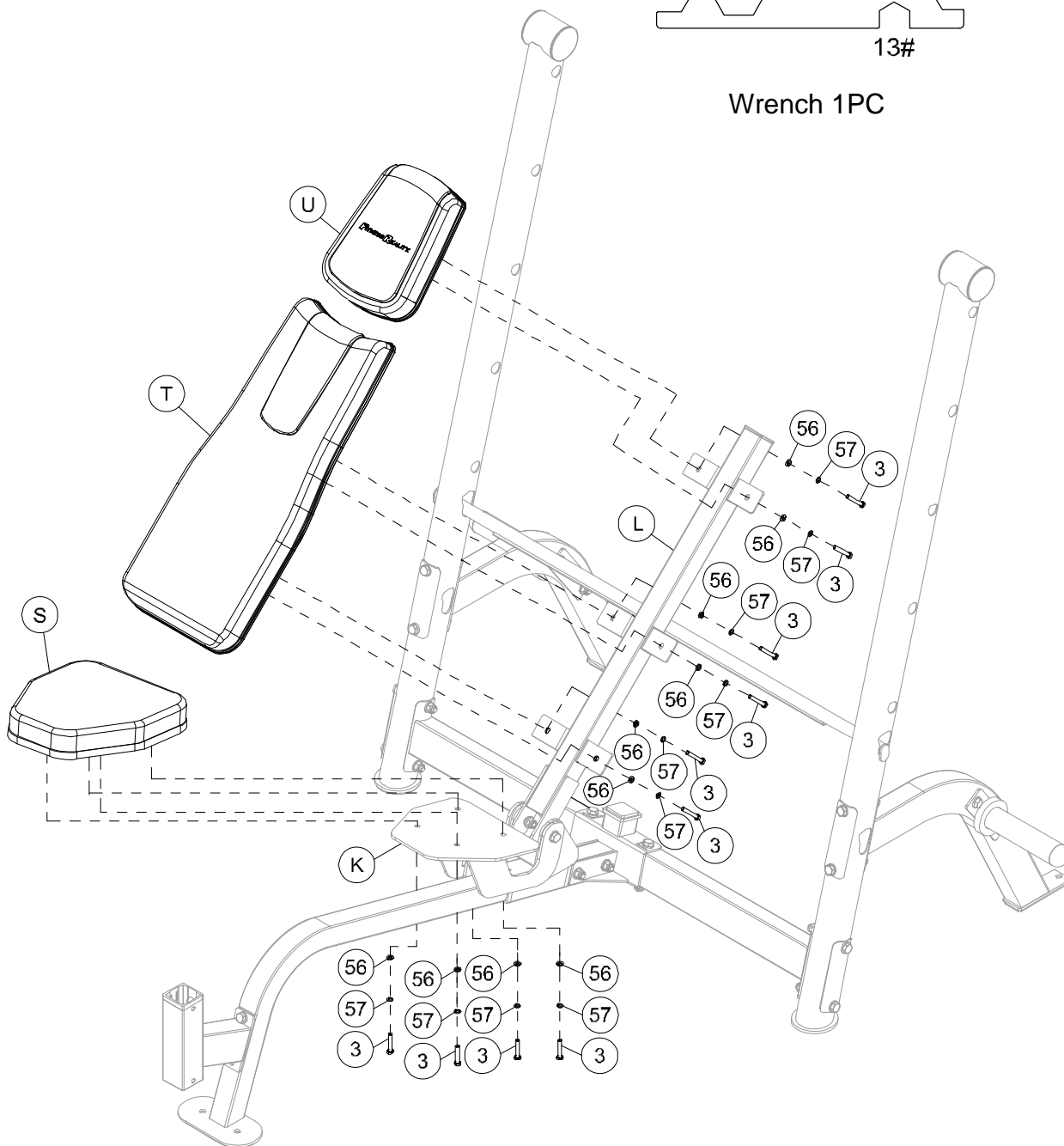

NO. 3 Hex Bolt
M8x1.25x25L
10PCS



NO.57 Spring Washer
D8.1xD12.3x2.1
10PCS



NO.56 Washer
D8.4xD16x1.6
10PCS

STEP 7

7A. The Short Safety Catch (D) parts are meant to be used on the front side of the Standard Olympic Weight Bench. They can be inserted into any of the available holes along the top portion of the Vertical Post (A)

7B. The Long Safety Catch (E) parts are meant to be used on the front side of the Standard Olympic Weight Bench. They can be inserted into any of the available holes along the top portion of the Vertical Post (A)

7C. The Rear Safety Catch (F) parts are meant to be used on the back side of the Standard Olympic Weight Bench. They can be inserted into any of the available holes along the top portion of the Vertical Post (A)

With the foot of Main Frame (I) flat on the ground proceed to thoroughly tighten all of the bolts.

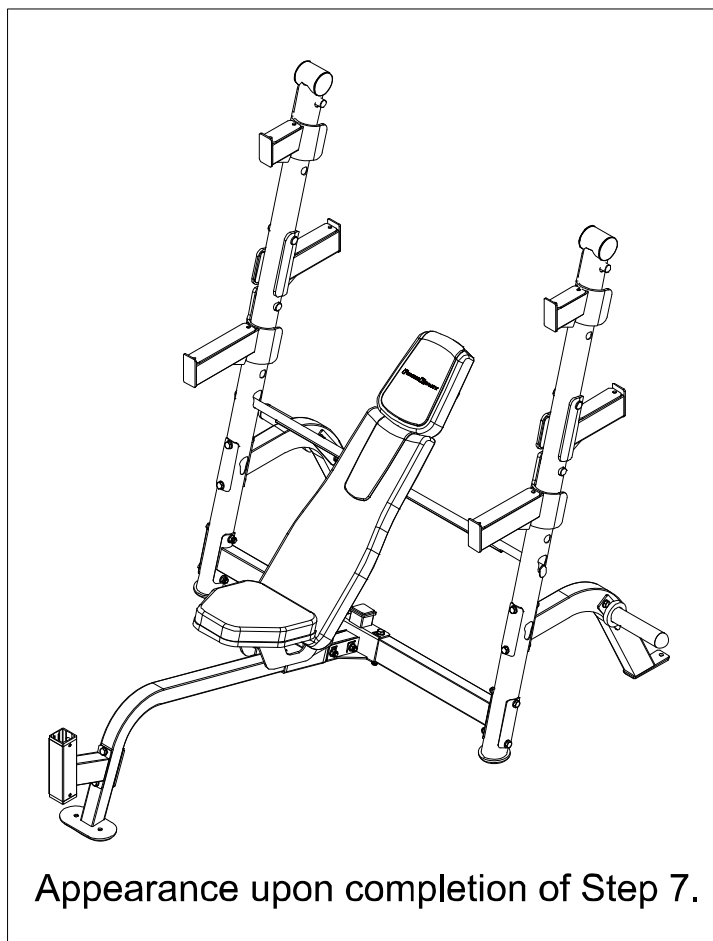

STEP 7

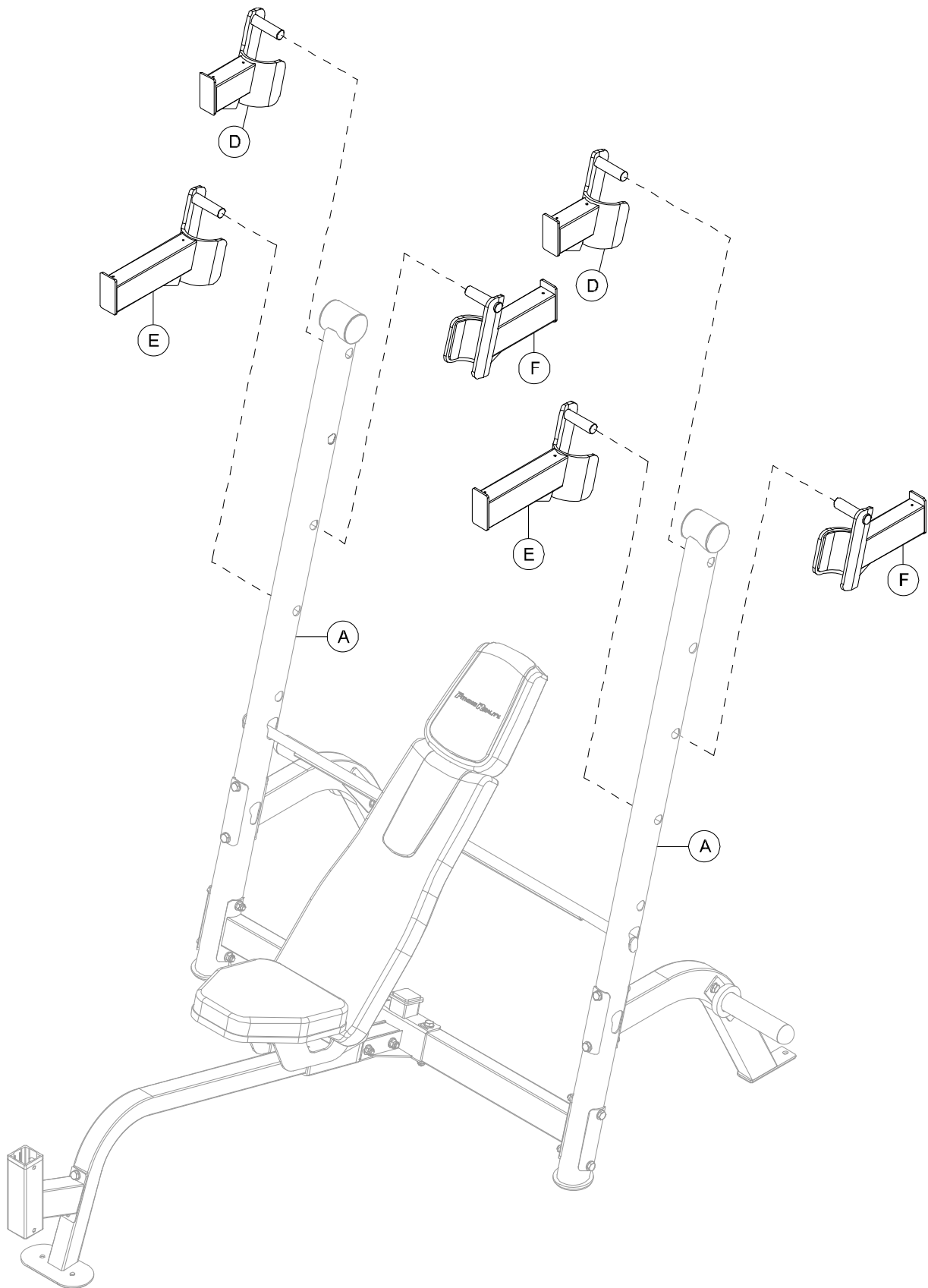

STEP 8

8A. Screw in the Ball Knob (102) into the back side of the Attachment Holder (M).

8B. Insert the Leg Hold Down (P) into the Attachment Holder (M). Adjust the Ball knob (102) to allow the Leg Hold down (P) to slide down enough to allow the Ball Knob (102) to lock the Leg Hold Down into place.

8C. Insert the two Foam Roller Tube (Q) parts midway along their length into the Leg Hold Down (P).

8D. Slide a Foam Roller (222) on to each of the exposed shafts of the two Foam Roller Tube (Q) parts. Try to keep the Foam Roller Tube centered during this step, so that each side remains equal in length. In total four Foam Rollers (222) will be installed.

8E. Insert a Big End Cap (120) into each of the ends of the Foam Roller Tube (Q). Make sure you have completed step 8E before inserting the four Big End Cap (120) parts.

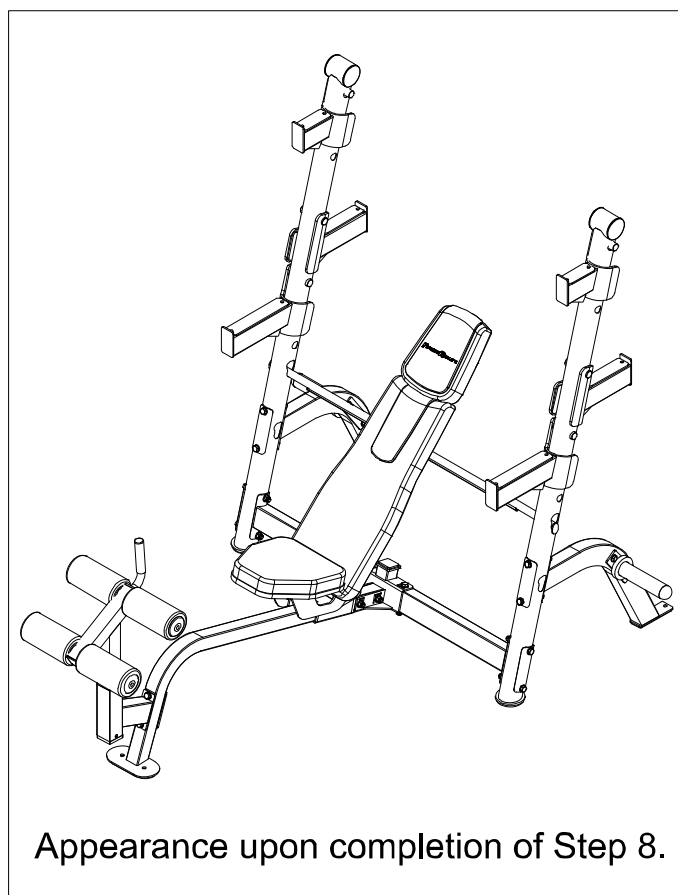

STEP 8

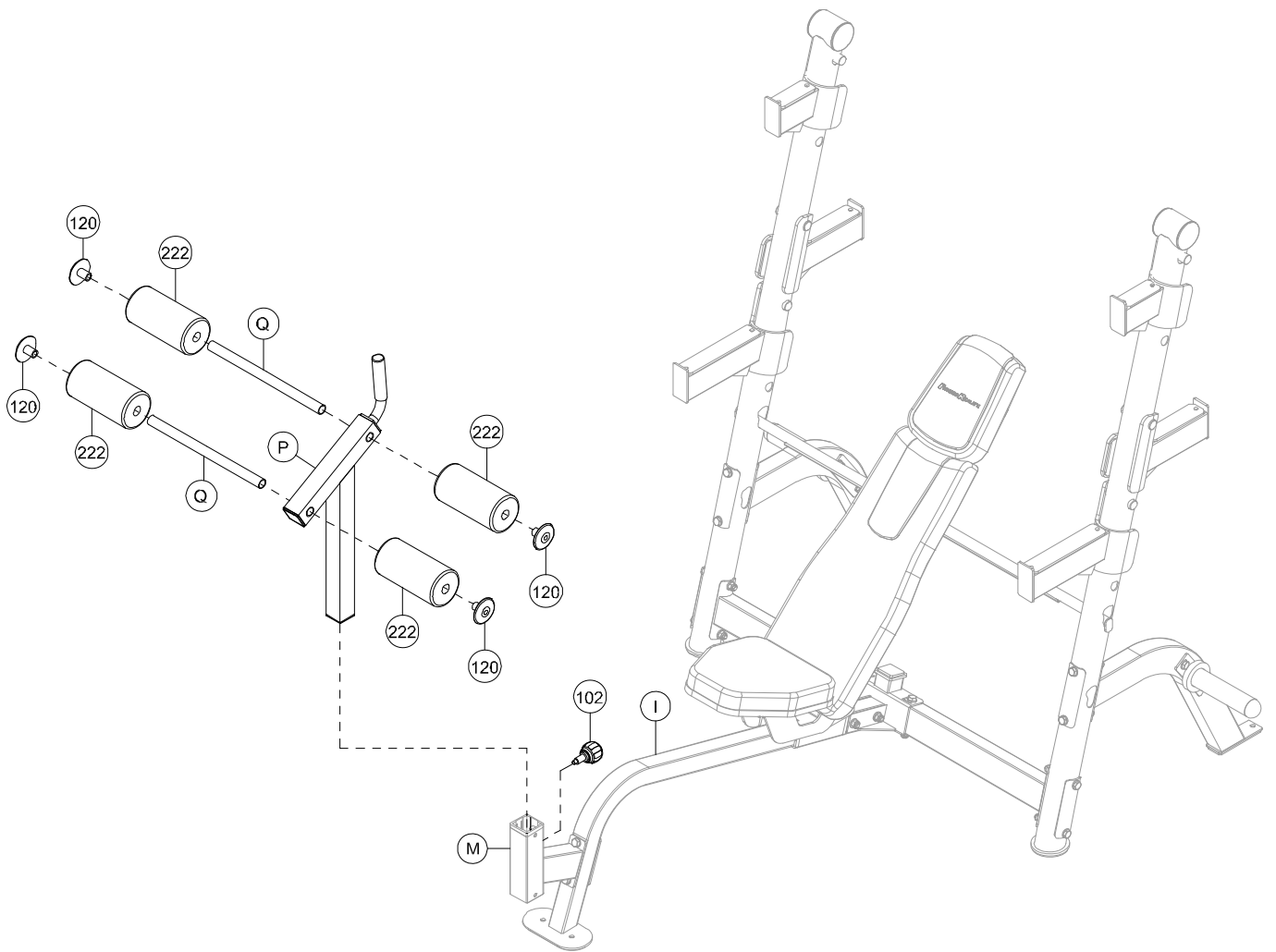

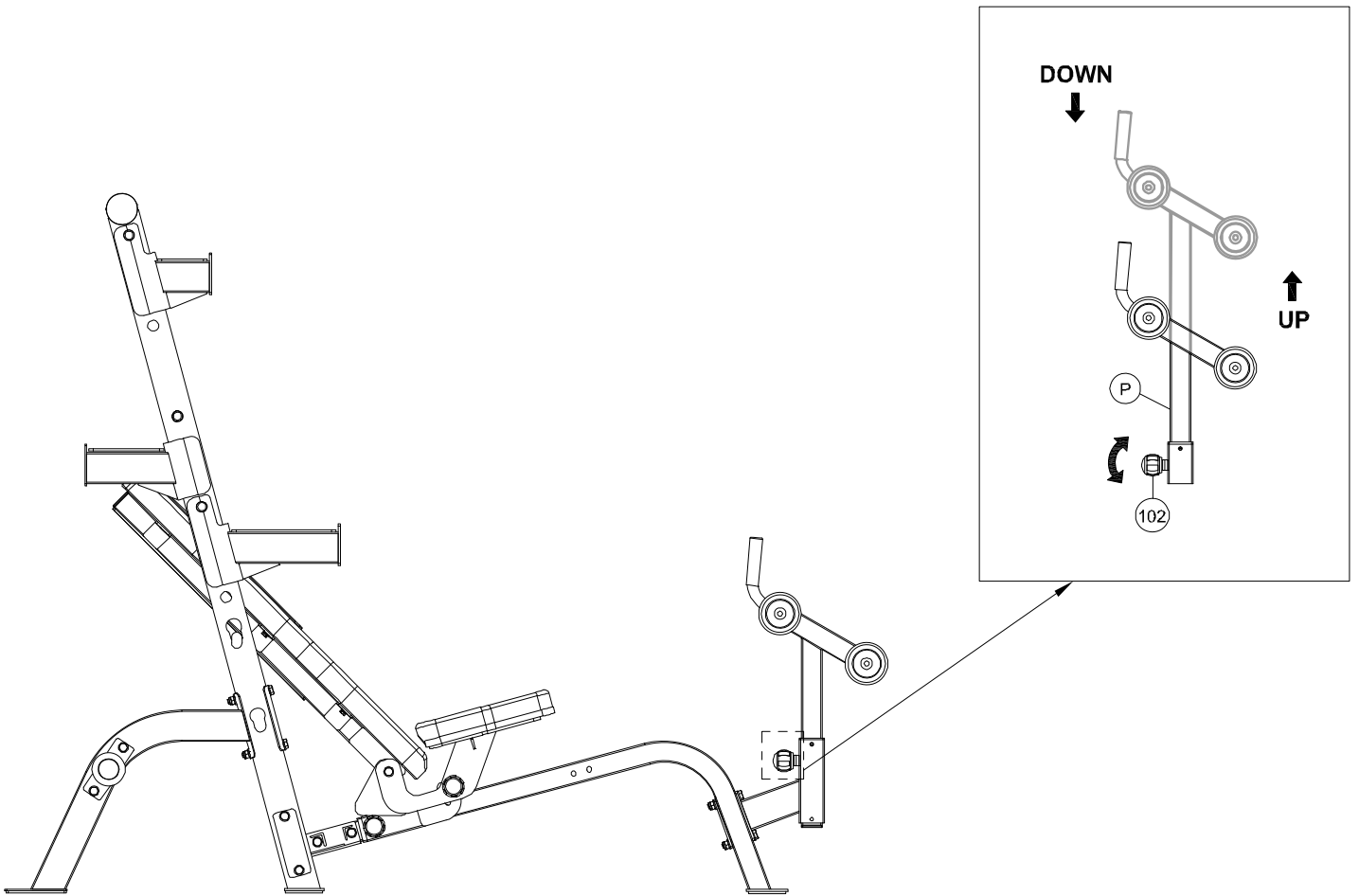

Leg Hold Down Adjustment

Lift or lower the Leg Hold Down (P) to desired position and secure it in place with Ball Knob Pop Pin (102) before using the Multi-angle Utility Bench.

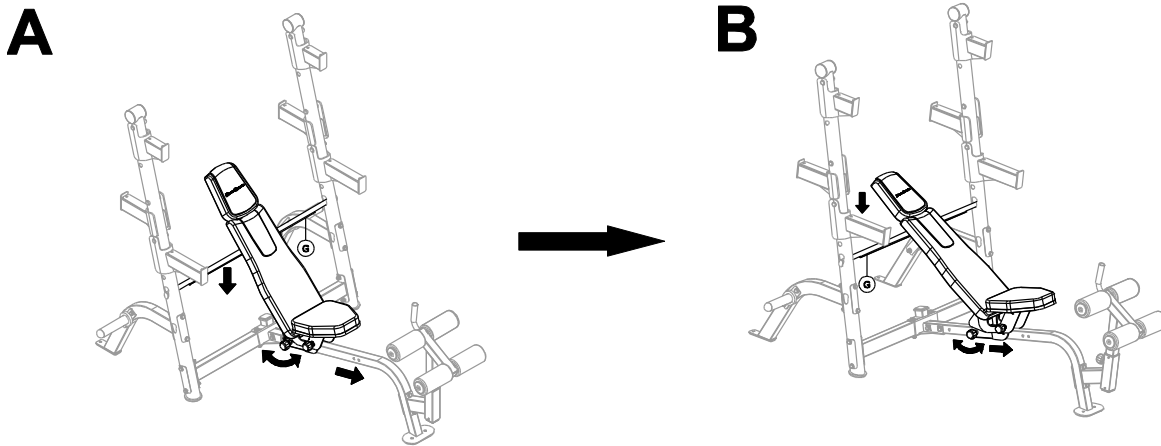

Backrest Adjustment

- A) For high incline bench press position adjust the seat to the rear most locking position and place the Backrest Adjustment Rod (G) in the highest hole it can rest in.
- B) For low incline bench press position adjust the seat to the second to the rear locking position and place the Backrest Adjustment Rod (G) in the highest hole it can rest in.

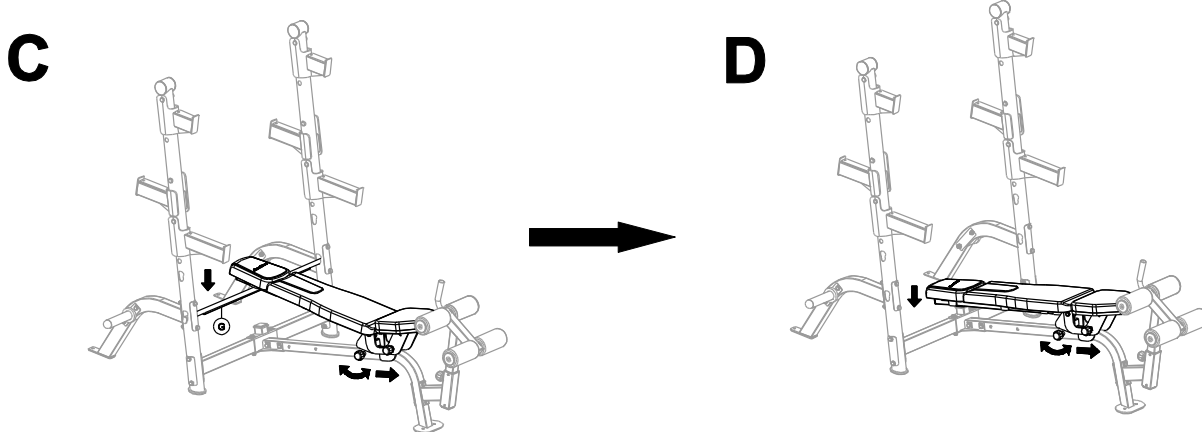

- C) For flat bench press position adjust the seat to the third to the rear locking position and place the Backrest Adjustment Rod (G) in the lowest hole it can rest in.
- D) For decline bench press position adjust the seat to the furthest most locking position from the rear and remove the Backrest Adjustment Rod (G) entirely.

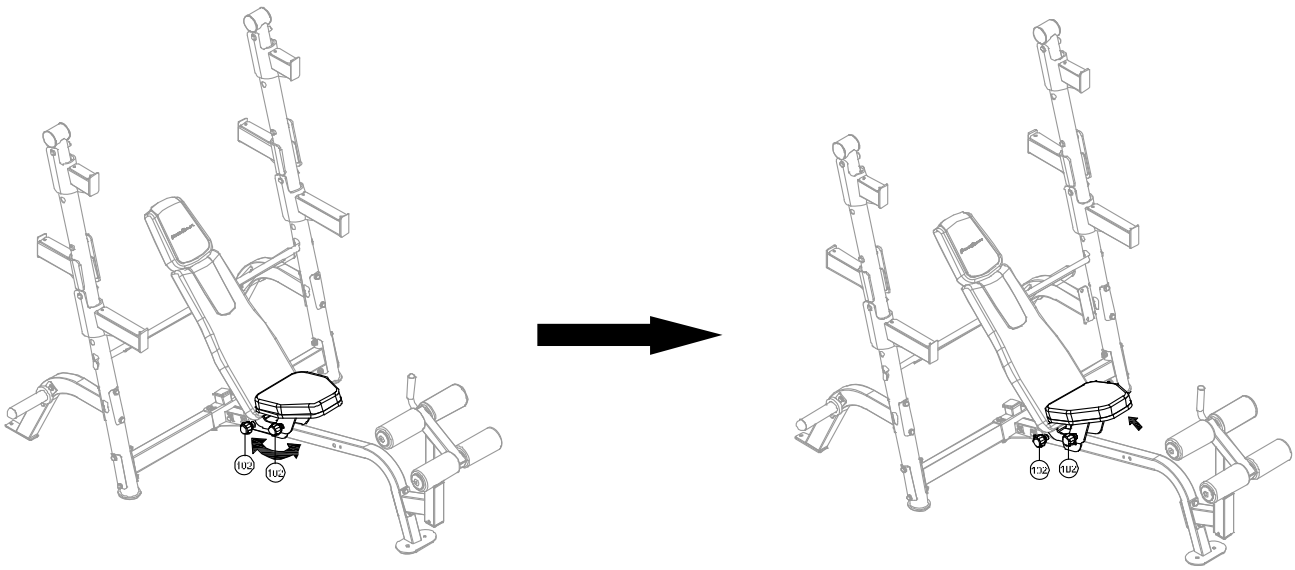

Seat Adjustment

- A) For a flat seat position loosen the Ball Knob (102) and lock the seat into the lower seat adjustment hole.

- A) For an incline seat position loosen the Ball Knob (102) and lock the seat into the upper seat adjustment hole.

LUBRICATION

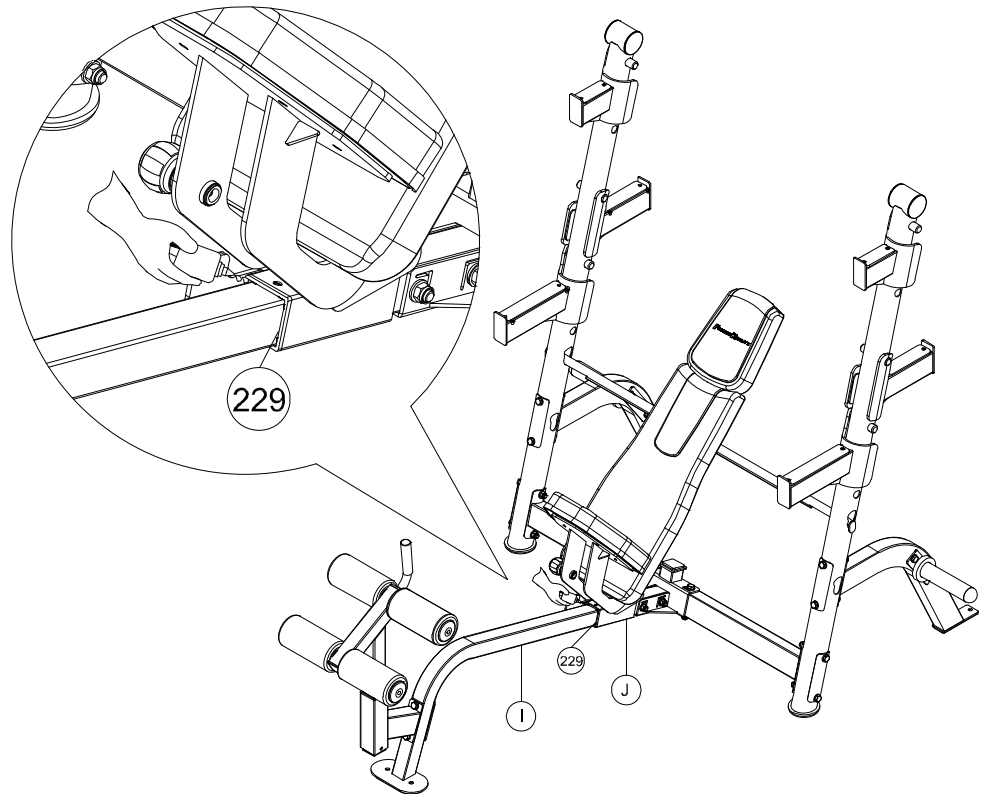
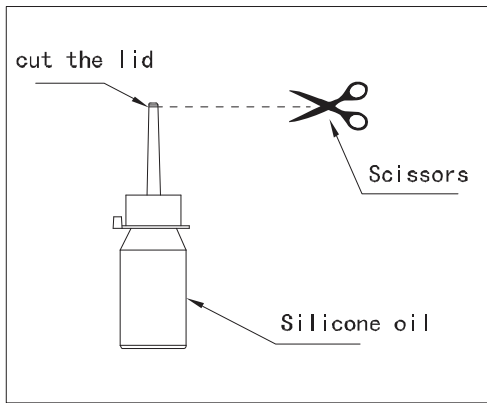

Lubrication

The machine must be lubricated periodically. ONLY USE SILICONE OIL when lubricating the Main Frame (I).

- A) Wipe the Main Frame (I) clean using a dry cloth. Remove the Silicone Oil from the Manual pack and cut the lid off using a pair of scissors.
- B) Apply the Oil generously across the Main Frame (I) and indie the Squire Bushing (229). Slide the Seat Slide Bracket (J) back and forth to spread the oil.

WARRANTY

MANUFACTURER'S LIMITED WARRANTY

Paradigm Health & Wellness guarantees to the original purchaser that this product is free from defects in material and workmanship when used for the purpose intended, under the conditions that it has been installed and operated in accordance with Paradigm's Owner's Manual. Paradigm's obligation under this warranty applies to the following:

| <u>COMPONENT</u> | <u>LENGTH OF WARRANTY</u> | |
|------------------|---------------------------|-------------------------|
| Structural Frame | 10 | years For Home Use Only |
| Parts | 3 | years For Home Use Only |
| Wearable Parts | 2 | years For Home Use Only |

Exclusions from Warranty Coverage:

Paradigm does not warrant against and is not responsible for, and no implied warranty shall be deemed to cover, any product failure, product malfunction, or damages attributable to:

1. Improper installation and/or failure to abide by Paradigm's installation guidelines;
2. Use of this product beyond normal home use, or in an application for which it was not designed.
3. All exchanged parts and Products replaced under this limited warranty will become the property of Paradigm Health and Wellness.
4. Damage caused by vandalism, accidents, inadequate maintenance, or by animals.
5. Any act of Nature (such as fire, flooding, snow, ice, hurricane, earthquake, lightning or other natural disaster), environmental condition (such as air pollution, mold, mildew, etc.), or staining from foreign substances (such as dirt, grease, oil, etc.).
6. Normal weathering due to exposure to sunlight, weather and atmosphere which can cause colored surfaces to, among other things, flake, rust, accumulate dirt or stains.
7. Improper operation, alteration, handling, storage, abuse or neglect of the product.

Paradigm, using its sole discretion, will either repair or replace free of charge any part(s) proven to be defective under normal home use. Any repair or replacement shall provide no new warranty coverage, but shall retain only the remaining portion of the original product's warranty. This warranty is offered only to the original purchaser and is not transferable. Proof of original purchase is required.

Ordering Replacement Parts

Replacement parts can be ordered by emailing our customer service department:

Service@paradigmhw.com

Open Daily 8:00 AM - 5:00 PM (PST).

When ordering replacement parts please have the following information ready:

1. **Owner's Manual**
2. **Model Number**
3. **Description of Parts**
4. **Part Number**
5. **Date of Purchase**

