

Quick Start Guide for Model:IMW575

1. Make sure the following items are included in your package.

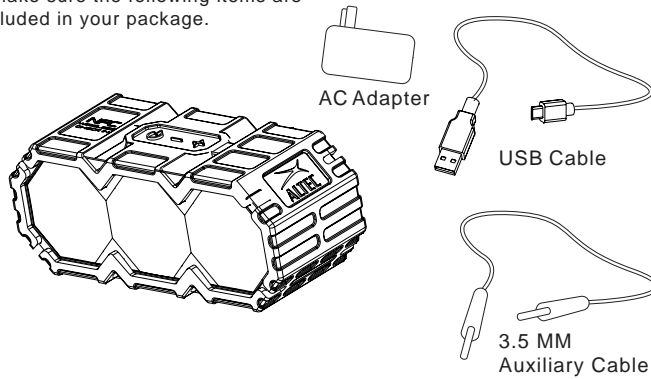

2. Connect the included USB Cable to the included AC adapter to charge your speaker's internal battery. A full charge takes approximately 4 hours.

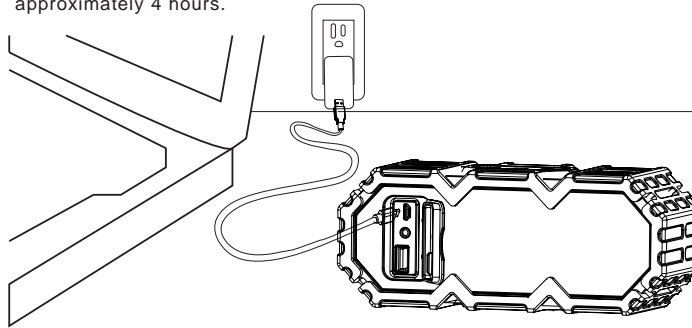

3. **Charging:** When charging, an orange LED light will illuminate. The orange light will turn off when your unit is fully charged.

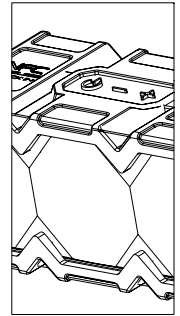
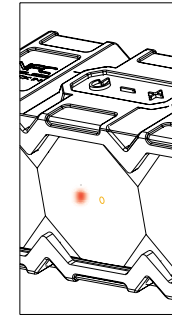

4. For a look at the various buttons on your speaker, view the graphic below.

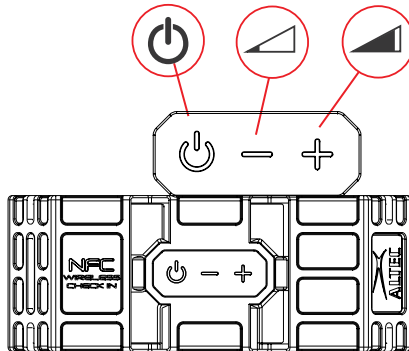

5. To power on your speaker, press and hold the "⏻" ON/OFF button for about 2 seconds.

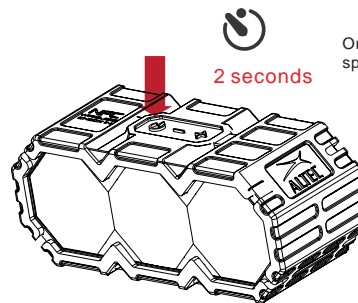

Once powered on, you will hear your speaker audibly say "Powering ON."

Pair the Speaker Using NFC

With Near Field Communication (NFC), you can easily pair and connect your speaker to your compatible device. Just hold your NFC enabled device directly against the wireless check in spot on your speaker.

Power on your speaker. Go to the Bluetooth Manager of your Bluetooth device. Search Bluetooth devices and select "IMW575" to start connecting.

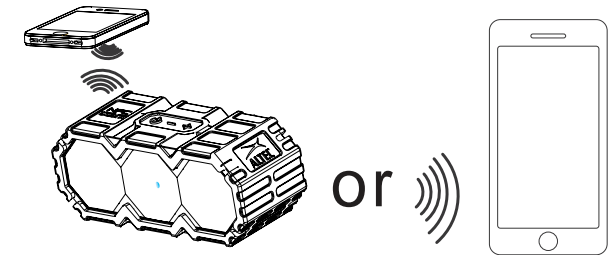

Once paired, you will hear your speaker audibly say: "You are now paired, enjoy."

6. While audio is playing, press and hold the "-" and "+" buttons simultaneously to disconnect the Bluetooth pairing between your speaker and your audio source.

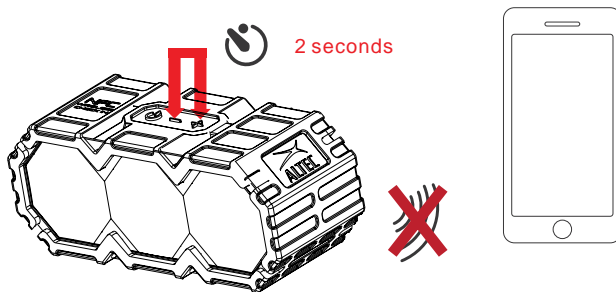

7. You can also use the included 3.5mm Auxiliary Cable to connect audio devices through the AUX In port on your speaker.

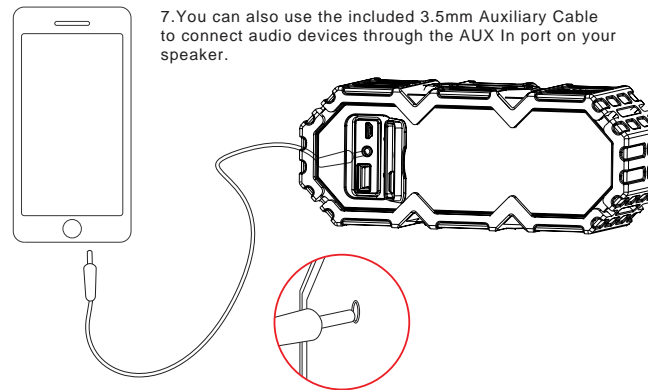

Technical Support

For technical support issues please visit our website at www.alteclansing.com. You can find manuals, software and FAQ's at the website. Can't find what you are looking for? Call 1-855-292-4087 to access our technical support information on the phone.