



Inflate Your Fun™



DO NOT RETURN TO YOUR RETAILER
QUESTIONS, PROBLEMS, MISSING PARTS WITH THIS PRODUCT?
Bestway (USA) Inc.
Tel: 1-855-838-3888 Fax: 1-480-838-1888
Email: info@bestway-northamerica.com
For FAQ, Manuals or Spare Parts please visit www.bestway-service.com

STEEL PRO™ & POWER STEEL™ FRAME POOLS OWNER'S MANUAL

Email: aftersales@bestway-northamerica.com

Shanghai

Bestway Inflatables & Material Corp.
No.3065 Cao An Road,
Shanghai, 201812, China
Tel: 86 21 6913 5588
Fax: 86 21 5913 8383
E-mail: info@bestway-shanghai.com

Hong Kong

Bestway (Hong Kong) International Ltd.
Suite 713, 7/Floor, East Wing, Tsim Sha Tsui Centre,
66 Mody Road, Kowloon, Hong Kong
Tel: 852 2997 7169
Fax: 852 2997 7869
E-mail: info@bestway-hongkong.com

Europe

Bestway (Europe) S.r.l.
Via Resistenza 5,
20098 San Giuliano M.se (Mi) - Italy
Tel: 39 02 9884 881
Fax: 39 02 9884 8828
E-mail: info@bestway-europe.com

Central & South America

Bestway Central & South America Ltda
Salar Ascotan 1282, Parque Enea,
Pudahuel, Santiago, Chile
Tel: 562 2365 0315
Fax: 562 2365 0323
E-mail: info@bestway-southamerica.com

U.S.A.

Bestway (USA) Inc.
3249 E. Harbour Drive, Phoenix, Arizona 85034,
United States of America
Tel: 1 480 838 3888
Fax: 1 480 304 3349
E-mail: sales@bestway-northamerica.com

Australia

Bestway Australia Pty Limited
Unit 10/71-83 Asquith Street,
Silverwater, NSW 2128, Australia
Tel: 61 2 9037 1388
Fax: 61 2 9737 9423
E-mail: info@bestway-australia.com

www.bestway-global.com
www.bestway-service.com



WARNING

smooth out the bottom

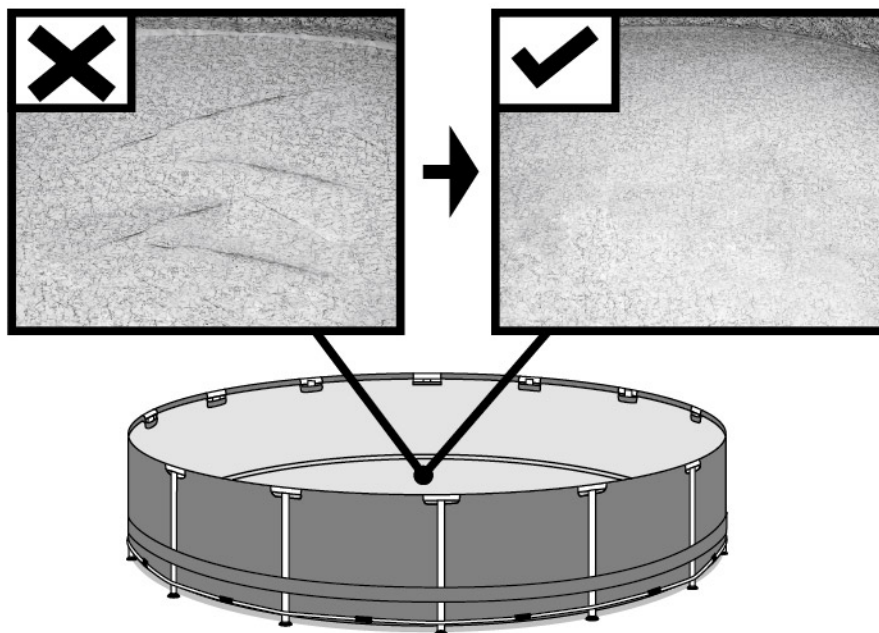

Put 1" to 2" water in the pool to cover the floor. Once pool floor is slightly covered, gently smooth out all wrinkles. Start in the center of the pool and work your way clockwise to the outside.

Thank you for buying a Bestway pool. In order to ensure that you gain maximum enjoyment and safe use of your pool please follow the installation instructions in the DVD enclosed (except for 2.44m x 61cm / 8' x 24" pool) in your retail box along with the important safety guidelines in your owner's manual. Assembly usually takes approximately 20 minutes with 2-3 people.

IMPORTANT SAFETY INSTRUCTIONS

Read and Follow All Safety Information and Instructions.

Keep for future reference.

Failure to follow these warnings and instructions can result in serious injury or death to users, especially children.

WARNING

WARNING

Prevent Drowning



Closely watch children who are in or near this pool!
Children under 5 are at highest risk for drowning!

WARNING

Stay away from drains & suction fittings



Your hair, body & jewelry can get sucked into drain!
You could be held under water & drown!

WARNING

No Diving



You can break your neck and be paralyzed!

The safety of your children depends entirely on you! Children, especially children younger than five years, are at high risk of drowning. Drowning occurs silently and quickly and can occur in as little as 2 in. (5cm) of water. Keep children in your direct sight, stay close, and actively supervise them when they are in or near this pool and when you are filling and emptying this pool. When searching for a missing child, check the pool first, even if child is thought to be in the house. Empty pool completely after each use and store the empty pool in such a way that it does not collect water from rain or any other source. Assign at least one person in charge of safety. Increase supervision if there are several people in the swimming pool. Teach your children to swim if possible. Test the water temperature before entering the pool by splashing water on your neck, arms and legs. Prohibit running and playing games near the swimming pool. Pool and accessories should only be assembled by competent adults.

Your pool should be filled by low pressure water flow in order to prevent undue stress to the liner. Bestway will not be responsible for damage to the pool due to filling via water-truck. (See FAQ's) Do not straddle, sit, lean over or put pressure onto the top rail, doing so could result in collapse of the pool and flooding, causing serious personal injury and/or damage to personal property. Do not swim alone. Store chemicals and accessories out of the reach of children. Never add chemicals to pool while it is occupied. Consult a specialist pool supply retailer to ensure correct chemical usage. Pool water should be tested regularly to ensure it is optimal for safe and enjoyable use throughout the season. Household pets should be kept clear of pool area to avoid structural damage to pool. Remove cover completely when in use. A working electronic detector should be installed to alert you if someone has entered the pool area. Under no circumstances should this equipment replace an adult's nearby supervision. The pools shall be set up so that they comply with local safety and building codes. Only use Bestway accessories with Bestway pools. Properly maintain your pool in order to increase life span and safe use. (See Pool Maintenance Section) Always keep the pool clean and clear. The bottom of the pool shall be visible at all times from the outside perimeter of the pool. Use artificial lighting during nighttime pool use, to illuminate all safety signs, ladders, steps, pool floor and walks. All equipment should be inspected frequently to detect and avoid deterioration, corrosion, broken parts or other hazards, which may cause injury. Remember to reapply sunscreen protection regularly and always after swimming.

Only persons older than 18 years of age can manipulate electrical accessories; they must conform to the appropriate safety principles of occupational safety and must be qualified to carry out the tasks on the electrical installation in accordance with any corresponding national regulations and standards. Do not bathe at night or if there is poor lighting. Fighting and violence is forbidden in the swimming pool. Under no circumstances modify parts of the swimming pool. Do not make holes in the swimming pool, are in the steps of the ladder.

Drowning Risk:

- Keep unsupervised children from accessing the pool by installing fencing or other approved barrier around all sides of the pool. State or local laws or codes may require fencing or other approved barriers. Check state or local laws and codes before setting up the pool. Refer to the list of barrier recommendations and guidelines as described in CPSC Publication No.362.
- Remove pool ladders before leaving the pool. Children as young as 2 years have climbed up ladders and into pools and drowned.
- Do not leave toys inside pool when finished using, since toys and similar items might attract a child to the pool.
- Position furniture (for example, tables, chairs) away from pool and so that children cannot climb on it to gain access to the pool.
- Locate pumps and filters in such a way that children cannot climb on them and gain access to the pool.
- If a drain or suction outlet cover is missing or broken, do not use the pool. Suction can cause body part entrapment, hair and jewelry entanglement, evicseration, or drowning. Repair or replace the drain or suction outlet cover before allowing the pool to be used.
- After using the pool, remove water to a level of 1/2 in. (1cm) or less.

Diving Risk:

- Do not dive into the pool. Diving into shallow water can result in a broken neck, paralysis, or death.

Electrocution Risk:

- Keep all electrical lines, radios, speakers and other electrical appliances away from the pool.

- Do not place pool near or under overhead electrical lines.
- Do not operate pump while pool is in use.

First Aid:

- Keep a working phone and a list of emergency numbers near the pool.

Post emergency numbers including:

- Fire
- Police
- Ambulance
- Poison Control Hotline
- Full home address

- Become certified in cardiopulmonary resuscitation (CPR). In the event of an emergency, immediate use of CPR can make a life-saving difference.
- Rescue equipment should be located near the pool and the supervising adult should be fully trained to use it.
- Rescue equipment should include but not limited to items such as coastguard approved ring buoy with attached rope and strong, rigid Rescue Pole of at least 3.66m (12').
- Learn the necessary rescue operations, especially those relating to rescuing children.

In case of an accident:

- Take all the children out of the water immediately.
- Call for emergency support and follow their instruction/advice.
- Replace wet clothing with dry clothing.

For further safety tips check out the following websites:

www.homesafetycouncil.org
<http://www.safety-council.org/info/child/water.html>
www.safekids.org
www.nspi.org

Safety Barrier Guidelines for Residential Swimming Pool

Section I: Outdoor swimming pool

- An outdoor swimming pool, including an inground, aboveground, or onground pool, hot tub, or spa, should be provided with a barrier which complies with the following:
- The top of the barrier should be at least 48 inches above grade measured on the side of the barrier which faces away from the swimming pool. The maximum vertical clearance between grade and the bottom of the barrier should be 4 inches measured on the side of the barrier which faces away from the swimming pool. Where the top of the pool structure is above grade, such as an aboveground pool, the barrier may be at ground level, such as the pool structure, or mounted on top of the pool structure. Where the barrier is mounted on top of the pool structure, the maximum vertical clearance between the top of the pool structure and the bottom of the barrier should be 4 inches.
 - Openings in the barrier should not allow passage of a 4-inch diameter sphere.
 - Solid barriers, which do not have openings, such as a masonry or stone wall, should not contain indentations or protrusions except for normal construction tolerances and tooled masonry joints.
 - Where the barrier is composed of horizontal and vertical members and the distance between the tops of the horizontal members is less than 45 inches, the horizontal members should be located on the swimming pool side of the fence. Spacing between vertical members should not exceed 1-3/4 inches in width. Where there are decorative cutouts, spacing within the cutouts should not exceed 1-3/4 inches in width.
 - Where the barrier is composed of horizontal and vertical members and the distance between the tops of the horizontal members is 45 inches or more, spacing between vertical members should not exceed 4 inches. Where there are decorative cutouts, spacing within the cutouts should not exceed 1-3/4 inches in width.
 - Maximum mesh size for chain link fences should not exceed 1-3/4 inch square unless the fence is provided with slats fastened at the top or the bottom which reduce the openings to no more than 1-3/4 inches.
 - Where the barrier is composed of diagonal members, such as a lattice fence, the maximum opening formed by the diagonal members should be no more than 1-3/4 inches.
 - Access gates to the pool should comply with Section I, Paragraphs 1 through 7, and should be equipped to accommodate a locking device. Pedestrian access gates should open outward, away from the pool, and should be self-closing and have a self-latching device. Gates other than pedestrian access gates should have a self-latching device. Where the release mechanism of the self-latching device is located less than 54 inches from the bottom of the gate, (a) the release mechanism should be located on the pool side of the gate at least 3 inches below the top of the gate and (b) the gate and barrier should have no opening greater than 1/2 inch within 18 inches of the release mechanism.
 - Where a wall of a dwelling serves as part of the barrier, one of the following should apply:
 - All doors with direct access to the pool through that wall should be equipped with an alarm which produces an audible warning when the door and its screen, if present, are opened. The alarm should sound continuously for a minimum of 30 seconds within 7 seconds after the door is opened. Alarms should meet the requirements of UL2017 General-Purpose Signaling Devices and Systems, Section 77. The alarm should have a minimum sound pressure rating of 85 dBA at 10 feet and the sound of the alarm should be distinctive from other household sounds, such as smoke alarms, telephones, and door bells. The alarm should automatically reset under all conditions. The alarm should be equipped with manual means, such as touchpads or switches, to temporarily deactivate the alarm for a single opening of the door from either direction. Such deactivation should last for no more than 15 seconds. The deactivation touchpads or switches should be located at least 54 inches above the threshold of the door.
 - The pool should be equipped with a power safety cover which complies with ASTM F1346-01 listed below.
 - Other means of protection, such as self-closing doors with self-latching devices, are acceptable so long as the degree of protection afforded is not less than the protection afforded by (a) or (b) described above.
 - Where an aboveground pool structure is used as a barrier or where the barrier is mounted on top of the pool structure, and the means of access is a ladder or steps, then (a) the ladder to the pool or steps should be capable of being secured, locked or removed to prevent access, or (b) the ladder or steps should be surrounded by a barrier which meets Section I, Paragraphs 1 through 9. When the ladder or steps are secured, locked, or removed, any opening created should not allow the passage of a 4-inch diameter sphere.

Section II: Barrier Locations

Barriers should be located so as to prohibit permanent structures, equipment or similar objects from being used to climb the barriers.

SAVE THESE INSTRUCTIONS

Pool Items:

#B56017; #B56026; #B56030; #B56045; #B56260.

Components list:

Heavy-duty repair patch	A	B	C
D	E	F	G
Hose adaptor #F4D019B-03B	I	J	

Drawings may not reflect actual product, not scaled to size. Please see FAQ for additional information.

Ref#	Description	Pool Size & Quantity				
		2.44 m x 61 cm (8' x 24")	3.05 m x 76 cm (10' x 30")	3.66 m x 76 cm (12' x 30")	3.66 m x 1.00 m (12' x 33.5")	4.57 m x 91 cm (15' x 36")
A	Top Rail	8	10	12	12	14
B	Vertical Pool Leg	8	10	12	12	14
C	T-Connector	8	10	12	12	14
D	Pin	18	22	26	26	30
E	Footing	8	10	12	12	14
F	Gasket	18	22	26	26	30
G	Drain Valve	1	1	1	1	1
H	Hose Adaptor	1	1	1	1	1
I	Stopper Plug	2	2	2	2	2
J	Liner	1	1	1	1	1

CHOOSE THE CORRECT LOCATION

NOTE: The pool must be set up on a completely flat and level surface. Please do not install the pool if the surface is inclined or slope.

Correct condition to set up the pool:

- The selected location has to be capable of uniformly supporting the weight for the entire time the pool is installed, moreover the location must be flat and must be cleared of all objects and debris including stones and twigs.
 - We recommend positioning the pool away from any objects kids could use to climb into the pool.
- NOTE:** Position the pool near an adequate drainage system to deal with overflow or to discharge the pool.
- NOTE:** Position the pool near an AC power outlet protected by a GFCI (Ground Fault Circuit Interrupter).

Incorrect conditions to set up the pool:

- On uneven ground the pool may collapse causing serious personal injury and/or damage to personal property and will void the warranty and prevent any service claims.
 - Sand should not be used to create a level base; the ground must be dug out if necessary.
 - Directly under overhead power lines or trees. Be sure the location does not contain underground utility pipes, lines or cables of any kind.
 - Do not set up the pool on driveways, decks, platforms, gravel or asphalt surfaces. The selected location should be firm enough to withstand the pressure of the water; mud, sand, soft / loose soil or tar are not suitable.
 - Grass or other vegetation under the pool will die and may cause odors and slime to develop, therefore we recommend removing all grass from the selected pool location.
 - Avoid areas prone to aggressive plant and weed species that may grow through the ground cloth or liner.
- NOTE:** Check with your local city council for by-laws relating to fencing, barriers, lighting and safety requirements and ensure you comply with all laws.
- NOTE:** If have a filter pump, refer to the pump's manual for instructions.
- NOTE:** The ladder must match the pool size and should be used only for entering and exiting the pool. It is forbidden to exceed the permitted payload of the ladder. Check regularly if the ladder is properly assembled.

Installation

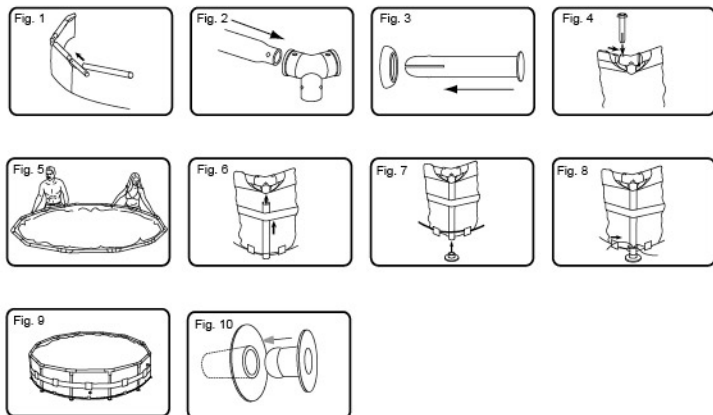

Assembly of the Frame pool can be completed without tools.

Bestway Inflatables will not be responsible for damage caused to the pool due to mishandling or failure to follow these instructions.

- Lay out all parts and check that you have the correct quantities as listed in the components list. If you are missing any part do not assemble the pool, contact Bestway Customers Service.
- Spread out the pool and make sure the pool is right side up, let it sit exposed to direct sunlight for 1 hour or more so that the pool is more flexible during set up.
- Place the pool near an adequate drainage system to deal with overflow water and ensure the pool's inlet A and outlet B are correctly positioned to allow your filter pump to connect to a power source.
Note: Do not use extension power cords to power your pump.
ATTENTION: Do not drag the pool on the ground, this can damage the pool.
- Insert the stopper plugs into inlet A and outlet B on the wall from the inside of the pool. (See Fig. 10)
- Insert top rail (A) into the pole pockets at the top of the pool. (See Fig. 1)
- Connect top rail (A) with T-Connector (C) at each of corner and insert pins (D) into gasket (F) first and then into pre-drilled holes of the frame.
NOTE: The gasket cups should face downwards to prevent water leaking into the top rails. (See Fig. 2,3,4)
- Repeat steps 5 and 6 until all top rails (A) are connected with T-Connectors (C) and the top frame is set up. For ease of assembly slightly raise the last 2 rails to an inverted V shape and insert into the last T-Connectors (C). Slowly lower until fully connected taking care not to pinch your fingers. (See Fig. 5)
- Put all vertical pool legs (B) inside the bottom rope and the pool wall band. Connect vertical pool leg (B) into the bottom of the T-Connector (C). Make sure the vertical pool leg (B) has the spring loaded pins at the top when connecting the T-Connector (C). (See Fig. 6)
NOTE: For 2.44m x 61cm (8' x 24") pools, no bottom rope and wall band. For 3.05m x 76cm (10' x 30"), 3.66m x 76cm (12' x 30") pools, no bottom rope.
- Attach all footings (E) to the bottom of the vertical pool legs (B). (See Fig. 7)
- Tighten the rope at the bottom of the pool until the legs are straight. (See Fig. 8)
- Pull the frame from different directions to ensure all rails, pool legs and connectors are firmly jointed. (See Fig. 9)
- Ensure drain valve is firmly closed. Smooth out the bottom.
- Put 1" to 2" (2.5cm to 5cm) water in the pool to cover the floor. Once pool floor is slightly covered, gently smooth out all wrinkles. Start in the center of the pool and work your way clockwise to the outside.

Filling Pool with Water

ATTENTION: Do not leave pool unattended while filling with water

- Fill pool just below the fill line on the pool's interior. Do not exceed the fill line on the pool's interior.
DO NOT OVERFILL as this could cause the pool to collapse. In times of heavy rainfall you may need to empty some of the water to ensure the level is correct. (See Fig. 12)
- When filling the pool is completed, check that the water is not collecting on any side to ensure the pool is level.
IMPORTANT: If pool is not level, drain water and re-level ground by digging out (See Fig. 11). Never attempt to move the pool with water in it, serious personal injury or damage to the pool may result.
WARNING: Your pool may contain up to xxxxx liters/xxxxx gallons which equals xxxxx pounds of pressure. If your pool has any bulge or uneven side then the pool is not level, the sides may burst and the water may discharge suddenly causing serious personal injury and/or damage to property.
- Check pool for any leaks at valves or seams, check ground cloth for any evident water loss. Do not add chemicals until this has been done.
NOTE: In the event of a leak, patch your pool using the Heavy-duty repair patch provided. Refer to the FAQ's for further information.

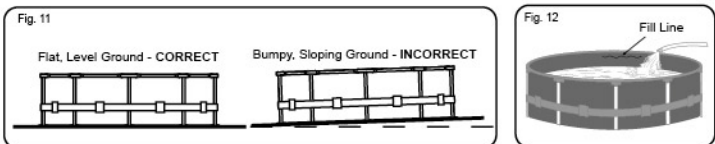

NOTE: Drawings for illustration purpose only. May not reflect actual product. Not to scale.

Pool Maintenance

If you do not adhere to the maintenance guidelines below, your health might be at risk, especially that of your children.

NOTE: The filter pump is used to circulate the water and to filter small particles to keep your water free of suspended dirt particles. In order to keep your pool water clean and hygienic you must add chemicals.

Refer to filter pump manual to install, operate and maintain the filter pump.

The following table lists the sequence of the tests that should be carried out for the ideal values and possible actions. Regularly check the pH value and chlorine concentration weekly and adjust to the ideal values.

TEST	IDEAL VALUES
pH value	7.4 – 7.6
Cyanuric acid	30 – 50 ppm
Free chlorine	2 – 4 ppm
Chlorine compound	0
Algae	None visible
Calcium hardness	200 – 400 ppm

To keep your pool clean:

- Contact your local pool supply shop for advice and purchase of chemicals and pH kits.
 - Locate a bucket of water next to pool to clean users' feet before entering pool.
 - Cover the pool when not in use.
 - Skim pool regularly to avoid settled dirt.
 - Change filter cartridge in filter pump every 2 weeks.
 - Gently clean any scum from the side with a clean cloth.
- Proper maintenance can maximize the life of your pool.

ATTENTION: Ensure you run your filtration system everyday for 7-8 hours, but no more than 8 hours as overheating and damage to your pump may occur. Do not use pump when pool is in use.

Repair

If your pool is damaged, use the repair patch. -see FAQ's for instructions.

Dismantling

- Unscrew the drain valve cap on the outside of the pool counter clockwise and remove.
 - Connect the adaptor to the hose and put the other end of the hose in the area where you are going to drain your pool. (Check local regulations for drainage by-laws).
 - Screw control ring of the hose adaptor onto the drain valve clockwise. The drain valve will be open and water will start to drain automatically.
ATTENTION: Water flow can be controlled with the control ring.
 - When draining is finished, unscrew the control ring to close the valve.
 - Disconnect the hose.
 - Screw the cap back onto the drain valve.
 - Air dry pool.
- ATTENTION:** Do not leave the drained pool outside.

Storage

- Once pool is completely dry, sprinkle with talcum powder to prevent pool from sticking together, fold pool carefully. If pool is not completely dry, mould may result and will damage the pool liner.
- Store liner and accessories in a dry place with a moderate temperature between 5°C / 41°F and 38°C / 100°F.

Frequently Asked Questions

1. What is a suitable base for the Frame Set pool?

Almost any completely flat, solid, level surface can be used. Do not use sand as a leveling material as it is prone to shifting under the pool. The ground should be dug out until it is perfectly level. Do not set up on driveways, decks, platforms, gravel or asphalt. The ground should be firm enough to withstand the weight and pressure of the water; mud, sand, soft/loose soil or tar are not suitable. A concrete base can be used but care should be taken not to drag the pool across the surface as abrasions could tear the liner. If the pool is to be set up on a lawn, it is recommended that the grass is removed from where the pool will sit as it will die and may cause odors / slime. Certain types of hardy grass can grow through the liner as can aggressive bushes / plants by the side of the pool. Ensure adjacent vegetation is cut back where necessary. Use of a ground cloth assists in protecting the base of the pool.

2. How will I know if my pool is set up on unlevelled ground?

If your pool appears to be bulging on one side it is not set up on level ground. It is important that you empty your pool and move the pool to a level site. If the pool is not on level ground it will place undue stress on the seams and could result in the seams bursting which will cause flooding, property damage and potentially personal injury or death.

Fill your pool following the instructions in the owner's manual carefully. This will ensure that you do not waste water and the pool can be moved easily so that the ground can be leveled at an appropriate time and not after you have completely filled it with water.

3. Can I have my pool filled by a water service?

We recommend using a garden hose under low pressure for filling your pool. If it is necessary to use a water delivery service, it is best to fill the pool with one inch of water by hose and smooth wrinkles first. Use a water service that is able to regulate the flow of water to prevent damage. Ensure you stop at each step as noted in the instruction manual to ensure your pool is level. Bestway will not be held responsible for pools damaged or weakened by water delivery services.

4. What is the maximum fill height of the pool?

Fill pool just below the fill line on the pool's interior. Do not exceed the fill line on the pool's interior. We recommend leaving extra room to account for water displacement when occupants are inside the pool. You may have to top up the water during the season which has been lost through evaporation or normal use.

5. My pool is leaking, what do I do to fix it?

The pool does not need to be emptied to fix any holes. Self-adhesive underwater repair patches can be purchased at your local pool / hardware store. For external use, use the repair patch provided. For internal holes, clean the hole on the inside of the pool to wipe off any oils and algae. Cut a circle large enough to cover the hole and apply the patch securely onto the side in the water. Cut a second patch and apply to the outside of the pool for extra strength. If the hole is in the base of the pool use one patch only and weigh it down with a heavy object while it bonds. If you have patched the pool when it is empty we recommend you leave it at least 12 hours before filling.

6. Where can I buy filter cartridges and how often should I change them?

Filter cartridges to fit your filter pump should be available from the store where you purchased your pool. If not, most mass retailers sell filter cartridges as an accessory. If you are unable to obtain replacements please call our toll-free number and we will assist you in finding a source local to you. The cartridges should be changed every 2 weeks dependent upon use of the pool. Check the filter on a weekly basis and clean by hosing down any debris and particles.

Note: Ensure your pump is disconnected from the electrical supply before checking the filter cartridge.

7. How many times a year should I change the water?

This is dependant on the amount of use the pool receives, and the attention paid to covering the pool and keeping chemicals properly balanced. If maintained correctly the water should last a full summer season. Please contact your local pool chemical supplier for detailed information regarding chemicals, they will be able to advise you how to best maintain the cleanliness of your water.

8. Do I need to take my pool down for the winter?

Yes, Above-ground pools may collapse under the weight of ice and snow and the PVC walls will be damaged. We recommend taking the pool down when temperatures fall below 8°C / 45°F. The pool should be stored indoors in a moderate temperature between 5°C / 41°F and 38°C / 100°F. Please store away from chemicals and rodents and out of the reach of children.

9. My pool is fading – why is that?

Excessive use of chemicals can cause the color of the inside of the liner to fade; this is similar to a swimsuit fading over time from repeated contact with chlorinated water.

10. How many years will the pool last?

There is no set time limit for the pool to last; following the instructions in the owner's manual and with proper care, maintenance and storage you can considerably increase the life of your pool. Improper set-up, use or care can result in failure of the pool.

Limited BESTWAY® Manufacturer's Warranty

The product you have purchased comes accompanied by a limited warranty. Bestway® stands behind our quality guarantee and assures, through a replacement warranty, your product will be free from manufacturer's defects that result in leaks.
If a Manufacturer defect is found within:
90 days from the original date of purchase
Please contact your Bestway After Sales Center before sending any documents. They will provide full instructions of what is needed for your claim. Bestway® is not responsible for economic loss due to water or chemical costs, and will not replace any products deemed to have been neglected or having been used outside of the owner's manual guidelines. To enact a warranty claim, this form must be completed and supplied with a copy of your purchase receipt and photos of the defects to the Bestway After Sales Center.
Bestway's warranty covers manufacturing defects discovered whilst unpacking the product or during use, as recommended within the user manual. This warranty applies only to products which must not have been modified by any 3rd parties. The product must be stored and handled in accordance with the technical recommendations.
If a product is deemed to be defective by Bestway®, the warranty covers the repair or replacement the defective part only. Replacements and repairs don't extend the duration of warranty. The original receipt/purchase invoice is required and will determine the start and the end dates of the warranty.

PLEASE HAVE THE FOLLOWING INFORMATION ON HAND BEFORE CALLING OUR AFTER SALES SERVICE CENTER:

Name: _____ **Telephone:** _____

Address: _____ **Mobile:** _____

City: _____ **State:** _____ **Fax:** _____

Zip/Postal Code: _____ **Country:** ☐ US ☐ Canada ☐ **E-mail:** _____





ORIGINAL RECEIPT PURCHASE DATE: _____ **RETAILER:** _____

POOL ITEM NUMBER: _____ **BATCH NUMBER:** _____

Please copy the batch number placed near the drain valve

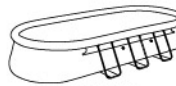
Please clear write your item code: _____

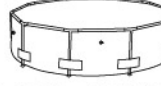
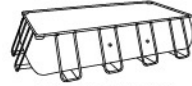

 FAST SET™	 STEEL PRO™	 POWER STEEL™	 STEEL PRO™		 POWER STEEL™	 STEEL PRO™
8ft x 26in	16ft x 10ft x 42in	16ft x 10ft x 42in	8ft x 20in	130in x 40in	113in x 79in x 39.5in	87in x 59in x 17in
9ft x 30in	18ft x 12ft x 48in		8ft x 24in	14ft x 48in	159in x 79in x 39.5in	94in x 59in x 23in
10ft x 30in	20ft x 12ft x 48in		10ft x 30in	16ft x 48in	162in x 79in x 48in	102in x 67in x 24in
12ft x 30in			10ft x 39.5in	18ft x 52in	16ft x 9ft x 48in	118in x 79in x 26in
12ft x 36in			12ft x 30in		18ft x 9ft x 48in	157in x 83in x 32in
14ft x 36in			12ft x 39.5in		22ft x 12ft x 52in	
15ft x 36in			12ft x 48in		24ft x 12ft x 52in	
15ft x 42in			14ft x 39.5in		31.3ft x 16ft x 52in	
15ft x 48in			15ft x 36in			
16ft x 42in			15ft x 42in			
18ft x 48in			15ft x 48in			
			16ft x 42in			
			18ft x 42in			
			18ft x 48in			

Description of problem

- ☐ Item tears / Leaking
 ☐ Faulty welding
 ☐ Faulty upper ring
 ☐ Faulty drain valve
 ☐ Others, please describe
 ☐ Missing part - Please use the code for the missing part, this can be found in the owner's manual.

Bestway does not warranty items which have been subject to:

- Improper or abnormal use
- Failure to follow the instructions as provided by Bestway
- Negligence
- Commercial use
- Accident
- Vandalism
- Terrorist Activity
- Improper use of chemicals
- Exposure to extreme weather conditions
- Negligence during pool set-up or disassembly
- Damages beyond Bestway's control, and acts of nature (force majeure)

This warranty is void if any unauthorized repair, change or modification has been made to any part of the equipment.

This product is designed in accordance with standards for a specific use. Any modifications or transformations greater than that indicated by the manufacturer could result in serious risks for the user and will void the warranty.

IMPORTANT: ONLY THE DAMAGED PART WILL BE REPLACED, NOT THE COMPLETE SET.

Bestway reserves the right to request photographic evidence of defective parts, or to require the return of the item for additional testing.

IN ORDER TO BETTER ASSIST YOU, WE REQUEST THAT ALL INFORMATION PROVIDED IS COMPLETE.

Bestway (USA) Inc.
Tel: 1-855-838-3888 Fax: 1-480-838-1888
info@bestway-northamerica.com
For FAQ, Manuals or Spare Parts please visit www.bestway-service.com





Authorized Service Centers
Centros de Assistência Autorizados
Centros de Asistencia Técnica autorizados
Autorisierte Kundendienstzentren
Valtuutetut Palvelukeskukset / Geautoriseerde Servicecentra
Centri di Assistenza Autorizzati
Centres de Service Après-vente Agréés
ΕΞΟΥΣΙΟΔΟΤΗΜΕΝΑ ΚΕΝΤΡΑ ΕΞΥΠΗΡΕΤΗΣΗΣ
Авторизованные Сервисные Центры
Autoryzowane Centra Serwisowe / Hivatalos Szervizközpontok
Auktoriserade Servicecenter / 官方售后服务中心

Albania

Phone: (+355) 682003429
Fax: (+386) 56621203
E-mail: servis@bestway.si

Argentina

Phone: (+54) 56223650315
E-mail: argentina@bestway-southamerica.com

Australia

Phone: (+61) 290371388
Fax: (+61) 297379423
E-mail: aftersales@bestway-australia.com

Austria

Phone: (+43) 720882434
Fax: (+43) 720882435
E-mail: austria@bestway-service.com

Belgium

Phone: 0 800 20 132
Fax: (+32) 026104411
E-mail: belgiumservice@bestway-europe.com

Bosnia

Phone: 0 39670935
Fax: (+386) 56621203
E-mail: servis@bestway.si

Brasil

Phone: (+55) 1156412193
E-mail: sac@bestway-brazil.com

Bulgaria

Phone: (+359) 879012892
Fax: (+359) 29250232
E-mail: bulgaria@bestway-service.com

Canada

Phone: 1 855 838 3888
Fax: 1 480 838 1888
E-mail: info@bestway-northamerica.com

Chile

Phone: (+56) 23650315
Fax: (+56) 23650323
E-mail: info@bestway-southamerica.com

Croatia

Phone: 099 7930168
Fax: (+386) 56621203
E-mail: servis@bestway.si

Cyprus

Phone: (+357) 22 426803
& +357 22 423824
Fax: (+357) 22 495137
E-mail: cyprus@bestway-service.com

Czech Republic

Phone: (+420) 0387020573
E-mail: pomocservis@bestway-service.com

Denmark

Phone: (+45) 33321019
Fax: (+45) 33321036
E-mail: denmark@bestway-service.com

Finland

Phone: (+358) 24363600
E-mail: finland@bestway-service.com

France

Phone: 892707709 (0,34 TTC/MINUTE)
Fax: (+33) 0489069991
E-mail: sav@bestway-france.com

Germany

Phone: (+49) 6946001281
Fax: (+49) 6946001282
E-mail: kundendienst@bestway-europe.com

Greece

Phone: 00.800.391.275.300
Fax: (+39) 0291390361
E-mail: aftersales@bestway-europe.com

Hungary

Phone: (+36) 0640204624
E-mail: hungary@bestway-service.com

Iceland

Phone: (+46) 8 506 691 90
Fax: (+46) 506 690 99
E-mail: sweden@bestway-service.com

Ireland

Phone: 8006120457
Fax: (+44) 01626835736
E-mail: aftersales@bestway-uk.com

Italy

Phone: (+39) 0236265839
Fax: (+39) 0291390361
E-mail: assistenza@bestway-europe.com

Macedonia

Phone: 032 386235
Fax: 032 304235
E-mail: servis@bestway.si

Malta

Phone: (+356)27438201
Fax: (+356)21496206
E-mail: info@model-toys.com

Mexico

Phone: (+52) 8183463416
Fax: (+52) 8183463416
E-mail: mexico@bestway-southamerica.com

Moldova

Phone: (+373) 68535552
E-mail: Moldova@bestway-service.com

Netherlands

Phone: 8002378929
Fax: (+31) 887878969
E-mail: dutchservice@bestway-europe.com

Norway

Phone: (+47) 22650122
Fax: (+47) 22721127
E-mail: norway@bestway-service.com

Peru

Phone: (+51) 2541119
E-mail: peru@bestway-southamerica.com
morales@globalamerica.com.pe

Poland

Phone: (+48) 322705320 / 322326040
Fax: (+48) 32705330
E-mail: serwis@bestway-service.com

Portugal

Phone: (+351) 707506692
Fax: (+34) 902602705
E-mail: sac@bestwayiberica.com

Romania

Phone: (+40) 212525354 / 213362858
Fax: (+40) 212525353 / 213362854
E-mail: suportclienti@bestway-service.com

Russia (Россия)

Phone: +7 (495) 978-90-88
E-mail: info@bestway-service.ru

Serbia and Montenegro

Phone: (+386) 656644962 / 56621206
Fax: (+386) 56621203
E-mail: servis@bestway.si

Slovak Republic

Phone: (+421) 0415078833
Fax: (+421) 0415078808
E-mail: pomocservis@bestway-service.com

Slovenia

Phone: (+386) 56621206
Fax: (+386) 56621203
E-mail: servis@bestway.si

Spain

Phone: (+34) 902351045
Fax: (+34) 902602705
E-mail: sac@bestwayiberica.com

Sweden

Phone: (+46) 8 506 691 90
Fax: (+46) 506 690 99
E-mail: sweden@bestway-service.com

Switzerland

Phone: (+41) 719290000
Fax: (+41) 0719290090
E-mail: switzerland@bestway-service.com

Turkey

Phone: (+90) 02126444545
Fax: (+90) 02125550224
E-mail: teknikservis@bestway-service.com

United Kingdom

Phone: 08455760116
Fax: (+44) 01626835736
E-mail: aftersales@bestway-uk.com

USA

Phone: 1 855 838 3888
Fax: 1 480 838 1888
E-mail: info@bestway-northamerica.com