

OPERATOR'S MANUAL MANUEL DEL OPERADOR

CRAFTSMAN

2 Speed - 8 Amp Electric Blower

xxxxxxxxxxxxxxxxxxxxxxxxxxxxxxxxxxxx
xxxxxxxxxxxxxxxxxxxx

Model No.
151.30382

Número de modelo
151.30382

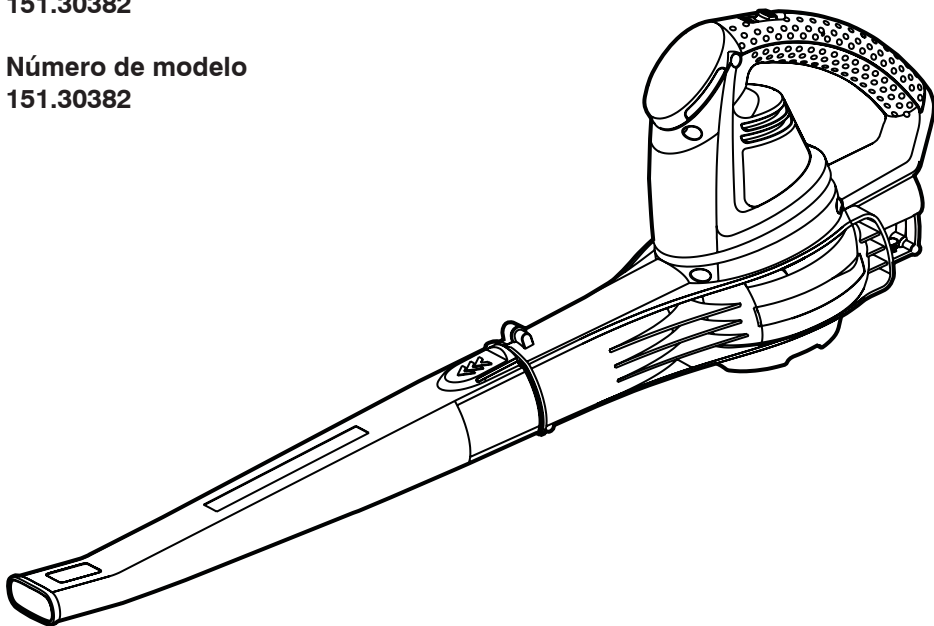

⚠ CAUTION: To reduce the risk of injury, the user must read and understand the operator's manual before using this product.

⚠ ADVERTENCIA: Para reducir el riesgo de lesiones, el usuario debe leer y comprender el manual del operador antes de usar este producto.

Sears Brands Management Corporation, Hoffman Estates, IL 60179 USA
Visit the Craftsman web page: www.craftsman.com
Visite el sitio web de Craftsman: www.craftsman.com

Save this manual for future reference
Guarda este manual para futuras consultas



TABLE OF CONTENTS / ÍNDICE DE CONTENIDO

ENGLISH

■ Warranty	2
■ Introduction	2
■ Important safety instructions	3-4
■ Specific safety rules	5
■ Symbols	6
■ Features	7
■ Electrical information	8
■ Assembly	9
■ Operation	10
■ Care and maintenance	11
■ Troubleshooting	11
■ Illustrated parts list	12-13

SPANISH

■ Garantía	Sección de Inglés pág. 2
■ Introducción	Sección de Inglés pág. 2
■ xxxxxxxxxxxxxxxxxxxxxxxxxxxx	3-4
■ xxxxxxxxxxxxxxxxxxxxxxxxxxxx	5
■ xxxxxxxxxxxxxxxxxxxxxxxxxxxx	6
■ xxxxxxxxxxxxxxxxxxxxxxxxxxxx	7
■ xxxxxxxxxxxxxxxxxxxxxxxxxxxx	8
■ xxxxxxxxxxxxxxxxxxxxxxxxxxxx	9
■ xxxxxxxxxxxxxxxxxxxxxxxxxxxx	10
■ xxxxxxxxxxxxxxxxxxxxxxxxxxxx	11
■ xxxxxxxxxxxxxxxxxxxxxxxxxxxx	11
■ Figura numeras (ilustraciones)	i-ii

CRAFTSMAN LIMITED WARRANTY

FOR TWO YEARS from the date of sale, this product is warranted against defects in material or workmanship.

WITH PROOF OF SALE, a defective product will be replaced free of charge.

For warranty coverage details to obtain free replacement, visit the web page: www.craftsman.com/warranty

This warranty is void if this product is ever used while providing commercial services or if rented to another person.

This warranty gives you specific legal rights, and you may also have other rights which vary from state to state.

Sears Brands Management Corporation, Hoffman Estates, IL 60179

★ ★ ★

XX

[illegible][illegible][illegible]

XX

XX

ΛΛΛΛΛΛΛΛΛΛΛΛΛΛΛΛΛΛΛΛΛΛΛΛΛΛΛΛΛΛΛΛΛΛΛ

[illegible]

~~~~~

## INTRODUCTION / INTRODUCCIÓN

This tool has many features for making its use more pleasant and enjoyable. Safety, performance, and dependability have been given top priority in the design of this product making it easy to maintain and operate.

\* \* \*

Esta herramienta ofrece numerosas características para hacer más agradable y placentero su uso. En el diseño de este producto se ha conferido prioridad a la seguridad, el desempeño y la fiabilidad, por lo cual se facilita su manejo y mantenimiento.

# IMPORTANT SAFETY INSTRUCTIONS

## **⚠ WARNING!**

READ AND UNDERSTAND ALL INSTRUCTIONS. Failure to follow all instructions listed below may result in electric shock, fire, and/or serious personal injury.

## **⚠ WARNING!**

TO REDUCE THE RISK OF FIRE,  
ELECTRIC SHOCK OR INJURY:

- Do not operate power tools in explosive environments (such as in the presence of flammable liquids, gases, or dust), or use to pick up flammable or combustible liquids. Power tools create sparks which may ignite the dust or fumes.

- To reduce the risk of electric shock, this tool has a polarized plug ( one blade is wider than the other ) and will require the use of a polarized extension cord. The plug will fit into a polarized extension cord only one way. If the plug does not fit fully into the extension cord, reverse the plug. If the plug still does not fit, obtain a correct polarized extension cord. A polarized extension cord will require the use of a polarized wall outlet. This plug will fit into the polarized wall outlet only one way. If the plug does not fit fully into the wall outlet, reverse the plug. If the plug still does not fit, contact a qualified electrician to install the proper wall outlet. Do not change the equipment plug, extension cord receptacle, or extension cord plug in any way.

- Avoid body contact with grounded surfaces such as pipes, radiators, ranges, and refrigerators. There is an increased risk of electric shock if your body is grounded.

- Don't expose power tools to rain or wet conditions. Water entering a power tool will increase the risk of electric shock.

- Do not handle plug or tool with wet hands.

- Use outdoor extension cords marked W-A, W, SW-A, SOW-A, STW-A, STOW-A, SJW-A, SJTW-A, or SJTOW-A. These cords are rated for outdoor use and reduce the risk of electric shock.

- Never allow children to operate the equipment. Never allow adults to operate the equipment without proper instruction.

- Wear eye protection with side shields which is marked to comply with ANSI Z87.1 as well as hearing protection when operating this product.

- Always use face or dust mask if operation is dusty.

- Use extra care when cleaning on stairs.

- Do not leave appliance plugged in. Unplug from outlet when not in use and before servicing.

- Do not expose to rain, store indoors.

- Use only as described in this manual. Use only manufacturer's recommended attachments.

- Keep hair, loose clothing, fingers and all body parts away from openings and moving parts.

- Wear heavy long pants, long sleeves, boots, and gloves. Avoid loose garments or jewelry that could get caught in moving parts of the machine or its motor.

- Do not force tool. Use the correct tool for your application. The correct tool will do the job better and safer at the rate for which it is designed.

- Do not operate the equipment while barefoot or when wearing sandals or similar lightweight footwear. Wear protective footwear that will protect your feet and improve your footing on slippery surfaces.

- Do not use on steps, a ladder, roof top, tree, or other unstable support. Stable footing on a solid surface enables better control of the blower in unexpected situations.

- Secure long hair so it is above shoulder level to prevent entanglement in any moving parts.

- Keep firm footing and balance. Do not overreach. Overreaching can result in loss of balance.

# IMPORTANT SAFETY INSTRUCTIONS

- Turn off all controls before unplugging.
- Do not allow to be used as a toy. Close attention is necessary when used by or near children.
- Avoid accidental starting. Be sure the power switch is not on before plugging in. Turn off power switch before unplugging.
- Do not use tool if switch does not turn it on or off. Any tool that cannot be controlled with the switch is dangerous and must be repaired.
- Do not use with damaged plug. If tool is not working as it should or has been dropped, damaged, left outdoors, or dropped into water, take it to a qualified service dealer for inspection and possible repair.
- Do not leave the tool when plugged in. Unplug from the power outlet when not in use, before servicing, and before storing the tool. Such preventative safety measures reduce the risk of starting the tool accidentally.
- Keep all bystanders, children, and pets at least 50 ft. away.
- Do not operate this unit when you are tired, ill, upset or under the influence of alcohol, drugs, or medication.
- Do not operate in poor lighting.
- Keep all parts of your body away from any moving parts and all hot surfaces of the unit.
- Do not put any object into openings. Do not use with any opening blocked; keep openings free of dust, lint, hair, and anything that may reduce air flow.
- Check the work area before each use. Remove all objects such as rocks, broken glass, nails, wire, or string which can be thrown or become entangled in the machine.
- Never use blower near fires, fireplaces, hot ashes, barbecue pits, etc., which may cause fire to spread.
- Do not pull or carry by cord, use cord as a handle, close a door on a cord, or pull cord around sharp edges or corners. Do not run appliance over cord. Keep cord away from heated surfaces.
- Do not unplug by pulling on cord. To unplug, grasp the plug, not the cord.
- Do not handle plug or appliance with wet hands.
- Use only identical manufacturer's replacement parts and accessories. Use of any other parts may create a hazard or cause product damage.
- In a double insulated appliance, two systems of insulation are provided instead of grounding. No grounding means is provided on a double insulated appliance, nor should a means for grounding be added to the appliance. Servicing a double insulated appliance requires extreme care and knowledge of the system and should be done only by qualified service personnel. Replacement parts for a double insulated appliance must be identical to the parts they replace.
- For household use only.

# SPECIFIC SAFETY RULES



- Make sure your extension cord is in good condition. When using an extension cord, be sure to use one heavy enough to carry the current your product will draw. A wire gauge size (A.W.G.) of at least 14 is recommended for an extension cord 50 feet or less in length. If in doubt, use the next heavier gauge. The smaller the gauge number, the heavier the cord. An undersized cord will cause a drop in line voltage resulting in loss of power and overheating.
- Do not point the blower nozzle in the direction of people or pets.
- Never place blower on any surface, except a hard, clean surface when motor is running. Gravel, sand, and other debris can be picked up by the air inlet and thrown at the operator or bystanders, causing possible serious injuries.
- Never run the unit without the proper equipment attached. Always ensure the blower tubes are installed.
- When not in use, blower should be stored indoors in a dry, locked up place—out of the reach of children.
- Maintain tool with care. Keep fan area clean for best and safest performance. Follow instructions for proper maintenance.
- Do not attempt to clear clogs from tool without first unplugging it.
- Do not pull or carry by cord, use cord as a handle, or pull cord around sharp edges or corners. Keep cord away from heated surfaces.
- Do not unplug by pulling on cord. To unplug, grasp the plug, not the cord.
- To reduce the risk of electrical shock, do not expose to rain, do not use on wet surfaces. Store indoors.
- If the power supply cord is damaged, stop using the unit. Take the unit to a qualified service dealer for inspection and possible repair.
- Protect your lungs. Wear a face or dust mask if the operation is dusty. Following this rule will reduce the risk of serious personal injury.

## ■ Save these instructions.









Refer to them frequently and use them to instruct others who may use this power tool. If you loan someone this power tool, loan them these instructions also.

# SYMBOLS

The following signal words and meanings are intended to explain the levels of risk associated with this product.

| SYMBOL                                                                            | SIGNAL          | MEANING                                                                                                      |
|-----------------------------------------------------------------------------------|-----------------|--------------------------------------------------------------------------------------------------------------|
|  | <b>DANGER:</b>  | Indicates an imminently hazardous situation, which, if not avoided, will result in death or serious injury.  |
|  | <b>WARNING</b>  | Indicates a potentially hazardous situation, which, if not avoided, could result in death or serious injury. |
|  | <b>CAUTION:</b> | Indicates a potentially hazardous situation, which, if not avoided, may result in minor or moderate injury.  |
|                                                                                   | <b>CAUTION:</b> | (Without Safety Alert Symbol) Indicates a situation that may result in property damage.                      |

Some of the following symbols may be used on this product. Please study them and learn their meaning. Proper interpretation of these symbols will allow you to operate the product better and safer.

| SYMBOL                                                                              | NAME                       | DESIGNATION/EXPLANATION                                                                                       |
|-------------------------------------------------------------------------------------|----------------------------|---------------------------------------------------------------------------------------------------------------|
| V                                                                                   | Volts                      | Voltage                                                                                                       |
| A                                                                                   | Amperes                    | Current                                                                                                       |
| Hz                                                                                  | Hertz                      | Frequency (cycles per second)                                                                                 |
| W                                                                                   | Watt                       | Power                                                                                                         |
| min                                                                                 | Minutes                    | Time                                                                                                          |
| ~                                                                                   | Alternating Current        | Type of current                                                                                               |
| ≡                                                                                   | Direct Current             | Type or a characteristic of current                                                                           |
|    | Class II Construction      | Double-insulated construction                                                                                 |
|    | Safety Alert               | Indicates a potential personal injury hazard.                                                                 |
|   | Read The Operator's Manual | To reduce the risk of injury, user must read and understand operator's manual before using this product       |
|  | Eye and Hearing Protection | Always wear eye protection with side shields marked to comply with ANSI Z87.1, along with hearing protection. |
|  | Wet Conditions Alert       | Do not expose to rain or use in damp locations.                                                               |
|  | Keep Bystanders Away       | Keep all bystanders at least 50 ft. away.                                                                     |
|  | Long Hair                  | Failure to keep long hair away from the air inlet could result in personal injury                             |
|  | Blower Tubes               | Do not operate without tubes in place.                                                                        |
|  | Loose Clothing             | Failure to keep loose clothing from being drawn into air intake could result in personal injury               |

# FEATURES

## PRODUCT SPECIFICATIONS

|                  |                                    |
|------------------|------------------------------------|
| Voltage.....     | 120V~ 60Hz                         |
| Amp .....        | 8 A                                |
| Air Speed .....  | Low = 125 MPH / High = 160 MPH Max |
| Air Volume ..... | Low = 145 CFM / High = 180 CFM Max |
| Weight .....     | 1.8 kg (4 lbs)                     |

## KNOW YOUR BLOWER

This product has many features for making its use more pleasant and enjoyable. Safety, performance, and dependability have been given top priority in the design of this product making it easy to maintain and operate.

The safe use of this product requires an understanding of the information on the tool and in this operator's manual as well as a knowledge of the project you are attempting. Before use of this product, familiarize yourself with all operating features and safety rules.

## BLOWER TUBE

The blower tube can be easily installed on the blower without any additional tools.

## CORD RETAINER

A convenient cord retainer helps keep the extension cord connection secure during blower operation.

## TWO SPEEDS

This Blower is designed with two speeds to assist in varying jobs.

# ELECTRICAL INFORMATION

## DOUBLE INSULATION

Double insulation is a concept in safety in electric power tools, which eliminates the need for the usual threewire grounded power cord. All exposed metal parts are isolated from the internal metal motor components with protecting insulation. Double insulated tools do not need to be grounded.

**⚠ WARNING!** The double insulated system is intended to protect the user from shock resulting from a break in the tool's internal insulation. Observe all normal safety precautions to avoid electrical shock.

**NOTE:** Servicing of a product with double insulation requires extreme care and knowledge of the system and should be performed only by a qualified service technician. Take the unit to a qualified service dealer for inspection and possible repair using only identical replacement parts.

### ELECTRICAL CONNECTION

This product has a precision-built electric motor. It should be connected to a **power supply that is 120 volts, AC only (normal household current), 60 Hz.**

Do not operate this product on direct current (DC). A substantial voltage drop will cause a loss of power and the motor will overheat. If your product does not operate when plugged into an outlet, double-check the power supply.

### GFCI

Ground Fault Circuit Interrupter (GFCI) protection should be provided on the circuit(s) or outlet(s) to be used for the product. Receptacles are available having built-in GFCI protection and may be used for this measure of safety.

### GUIDELINES FOR USING EXTENSION CORDS

**USE THE PROPER EXTENSION CORD.** Make sure your extension cord is in good condition. When using an extension cord, be sure to use one heavy enough to carry the current your product will draw. An undersized cord will cause overheating. The table below shows the correct size to use depending on cord length and nameplate ampere rating. If in doubt, use the next heavier gauge. The smaller the gauge number, the heavier the cord.

**Minimum Gauge for Extension Cords (AWG)**  
(when using 120V only)

| Ampere Rating |               | Total Length of Cord in Feet (meters) |              |                 |               |
|---------------|---------------|---------------------------------------|--------------|-----------------|---------------|
| More Than     | Not More Than | 25' (7.6 m)                           | 50' (15.2 m) | 100' (30.4 m)   | 150' (45.7 m) |
| 0             | 6             | 18                                    | 16           | 16              | 14            |
| 6             | 10            | 18                                    | 16           | 14              | 12            |
| 10            | 12            | 16                                    | 16           | 14              | 12            |
| 12            | 16            | 14                                    | 12           | Not recommended |               |

Make sure your extension cord is properly wired and in good electrical condition. Always replace a damaged extension cord or have it repaired by a qualified person before use.

Keep extension cords away from sharp objects, excessive heat and damp or wet areas.

Use a separate electrical circuit for your tools. This circuit should comprise a wire of at least 12 gauge and should be protected with a 15 A time-delayed fuse. Before connecting the motor to the power line, make sure the switch is in the OFF position and the electric current is identical to that stamped on the motor nameplate. Running at a lower voltage will damage the motor.

**⚠ WARNING!** ALTHOUGH THIS TOOL IS DOUBLE INSULATED, THE EXTENSION CORD AND RECEPTACLE MUST STILL BE GROUNDED WHILE IN USE TO PROTECT THE OPERATOR FROM ELECTRICAL SHOCK.

**⚠ WARNING!** Check extension cords before each use. If damaged replace immediately. Never use product with a damaged cord since touching the damaged area could cause electrical shock resulting in serious injury.

# ASSEMBLY

## UNPACKING

This product requires assembly.

■ Carefully remove the product and any accessories from the box. Make sure that all items listed in the packing list are included.

 **WARNING!** Do not use this product if any parts on the Packing List are already assembled to your product when you unpack it. Parts on this list are not assembled to the product by the manufacturer and require customer installation. Use of a product that may have been improperly assembled could result in serious personal injury.

- Inspect the product carefully to make sure no breakage or damage occurred during shipping.
- Do not discard the packing material until you have carefully inspected and satisfactorily operated the product.
- If any parts are damaged or missing, do not operate the blower. Return it for replacement to the retailer from which it was purchased.

## PACKING LIST

Blower  
Blower Tube  
Operator's Manual

 **WARNING!** If any parts are damaged or missing do not operate this product until the parts are replaced. Use of this product with damaged or missing parts could result in serious personal injury.

 **WARNING!** Do not attempt to modify this product or create accessories not recommended for use with this product. Any such alteration or modification is misuse and could result in a hazardous condition leading to possible serious personal injury.

 **WARNING!** Do not connect to power supply until assembly is complete. Failure to comply could result in accidental starting and possible serious personal injury.

## ASSEMBLING THE BLOWER TUBE

See Figure 2.

Slide blower tube forward until the lock button clicks into the top of the tube.

# OPERATION

**⚠ WARNING!** Do not allow familiarity with products to make you careless. Remember that a careless fraction of a second is sufficient to inflict serious injury.

**⚠ WARNING!** Always wear eye protection with side shields marked to comply with ANSI Z87.1, along with hearing protection. Failure to do so could result in objects being thrown into your eyes, resulting in possible serious injury.

**⚠ WARNING!** Do not use any attachments or accessories not recommended by the manufacturer of this product. The use of attachments or accessories not recommended can result in serious personal injury.

## APPLICATIONS

You may use this product for the purposes listed below:

- Clearing leaves and other yard debris from your lawn
- Keeping decks, patios, garages and driveways free from leaves, pine needles and other debris

## STARTING/STOPPING THE BLOWER

See Figure 3-4.

- Attach the outlet end of an extension cord to the plug on the rear of the blower.

**NOTE:** Use only an approved outdoor extension cord as described previously in this manual.

- Route the extension cord through the side of the loop located on the rear of the blower housing and place underneath the cord retainer.
- To start the blower, place the power switch in the I position (If more power is desired, push power button forward to second position(II) for more power).
- To stop the blower, place the power switch in the **OFF** position.
- Use low speed for jobs requiring better control and less air flow.
- High speed best suitable for jobs requiring more air speed and volume.

## OPERATING THE BLOWER

See Figure 5.

- To keep from scattering debris, blow around the outer edges of a debris pile. Never blow directly into the center of a pile.
- To reduce sound levels, limit the number of pieces of equipment used at any one time.
- Use rakes and brooms to loosen debris before blowing. In dusty conditions, slightly dampen surfaces when water is available.
- Watch out for children, pets, open windows, or freshly washed cars, and blow debris safely away.
- Hold the blower with the handle in your right hand. (Proper operating position is shown in figure 5.)
- Operate power equipment at reasonable hours only — not early in the morning or late at night when people might be disturbed. Comply with the times listed in local ordinances.
- After using blowers or other equipment, **CLEAN UP!** Dispose of debris properly.

## CARE AND MAINTENANCE

**⚠ WARNING!** When servicing, use only identical replacement parts. Use of any other parts may create a hazard or cause product damage.

**⚠ WARNING!** Always wear eye protection with side shields marked to comply with ANSI Z87.1, along with hearing protection. Failure to do so could result in objects being thrown into your eyes, resulting in possible serious injury.

**⚠ WARNING!** Before inspecting, cleaning or servicing the machine, unplug the power cord and wait for all moving parts to stop. Failure to follow these instructions can result in serious personal injury or property damage.

### GENERAL MAINTENANCE

Avoid using solvents when cleaning plastic parts. Most plastics are susceptible to damage from various types of commercial solvents and may be damaged by their use. Use clean cloths to remove dirt, dust, oil, grease, etc.

**⚠ WARNING!** Do not at any time let brake fluids, gasoline, petroleum-based products, penetrating oils, etc., come in contact with plastic parts. Chemicals can damage, weaken or destroy plastic, which may result in serious personal injury.

### STORAGE (1 MONTH OR LONGER)

- Clean all foreign materials from the blower.
- Store indoors in a place that is out of reach of children. Keep away from corrosive agents such as garden chemicals and de-icing salts.

## TROUBLESHOOTING

| PROBLEM                                        | CAUSE                                                                                         | REMEDY                                            |
|------------------------------------------------|-----------------------------------------------------------------------------------------------|---------------------------------------------------|
| Motor fails to start when switch is turned on. | Power cord is not plugged in or connection is loose.<br>Household circuit breaker is tripped. | Plug in the power cord.<br>Check circuit breaker. |

**2 Speed - 8 Amp Blower – MODEL NUMBER 151.30382**

The model number will be found on a label attached to the motor housing.

**TO PURCHASE REPLACEMENT PARTS, CALL 1-888-331-4569**

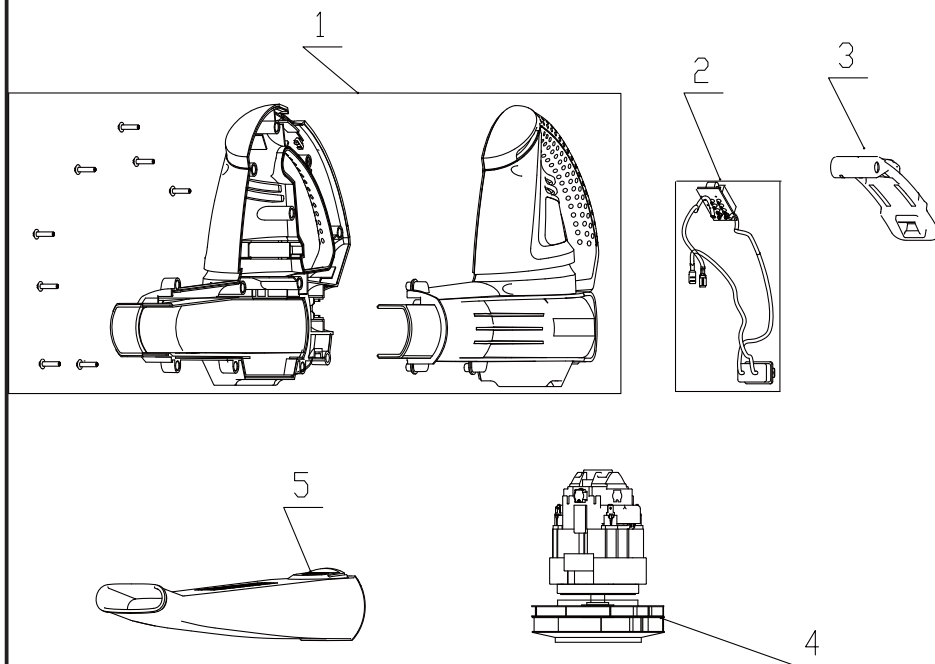

**2 Speed - 8 Amp Blower – MODEL NUMBER 151.30382**

The model number will be found on a label attached to the motor housing.

**TO PURCHASE REPLACEMENT PARTS, CALL 1-888-331-4569**

| ITEM NO. | PART NO.           | DESCRIPTION          | QTY |
|----------|--------------------|----------------------|-----|
| 1        | GF26BL.10.01.X1.02 | Motor Shell Assembly | 1   |
| 2        | GF27BL.10.20       | Power Cord Assembly  | 1   |
| 3        | GF27BL.10.10       | Switch Button        | 1   |
| 4        | GF26BL.X0.01       | Motor Assembly       | 1   |
| 5        | GF26BL.00.01       | Blower Tube          | 1   |

**See this section for all of the figures referenced in the operator's manual.**

**Consulte esta sección para ver todas las figuras a las que se hace referencia en el manual del operador.**

Fig. 1

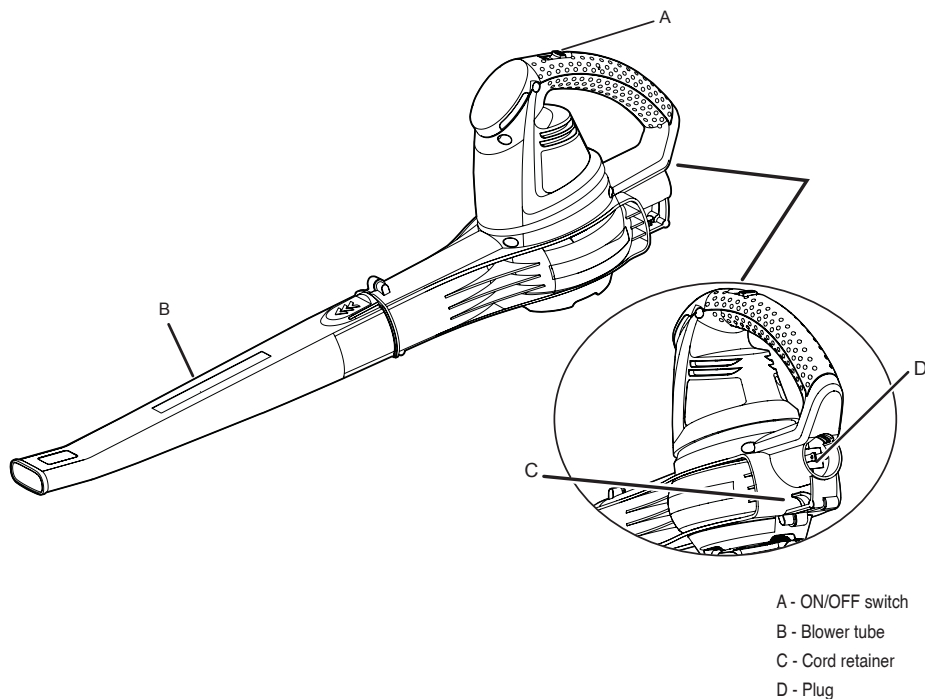

Fig. 2

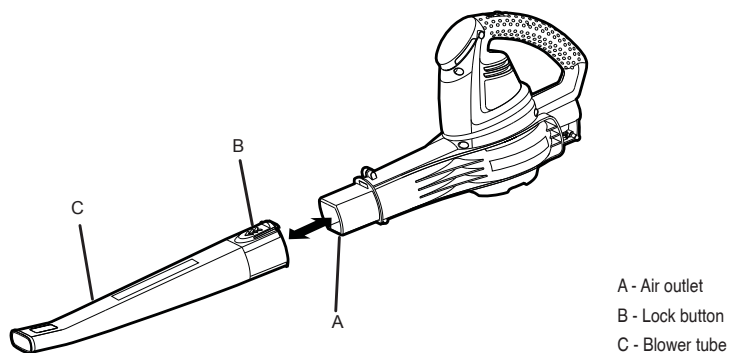

Fig. 3

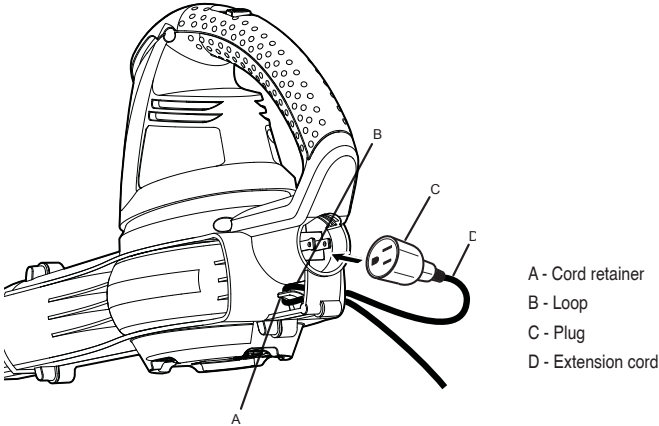

Fig. 4

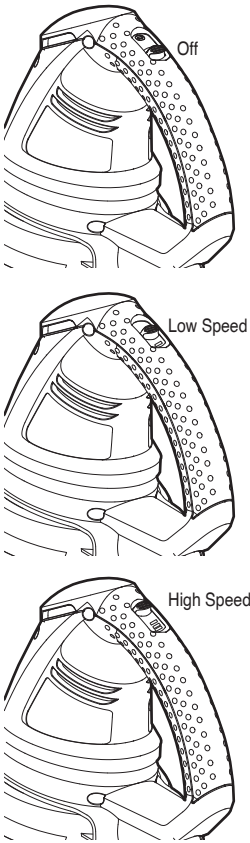

Fig. 5



# **CRAFTSMAN®**

**Product questions or problems?**

## **1-888-331-4569**

### **Customer Care Hot Line**

**Get answers to questions, troubleshoot problems,  
order parts, or schedule repair service.**

Para respuestas a preguntas o problemas, y ordenar  
piezas o pedir servicio para la reparación de su equipo.

**To help us help you, register your product at [www.craftsman.com/registration](http://www.craftsman.com/registration)**

Para poderte ayudar mejor, registra tu producto en [www.craftsman.com/registration](http://www.craftsman.com/registration)

---

**Join the Craftsman Club today!**

## **CRAFTSMAN® CLUB**

**[www.craftsman.com/signup](http://www.craftsman.com/signup)**

**Receive exclusive member benefits including special pricing and offers,  
project sharing, expert advice, and SHOP YOUR WAY REWARDS!**

Como miembro exclusivo, recibe diversos beneficios como ofertas, precios especiales, proyectos  
nuevos, consejos de expertos y nuestro programa de puntos SHOP YOUR WAY REWARDS!