

# Brine Tank Assembly Instructions



## Components:

Brine Tank  
Tank Cover  
Salt Grid  
3 Legs  
Float Assembly  
Float Tube Assembly  
Brine Hose



Snap Legs into base



Bend tabs on the base away from the legs to allow for easier installation.



Insert float tube into base with the hole for the tubing facing the outward edge.



Install base and float tube into the brine tank aligning the hole in the tube with the hole in the tank.



Put the salt grid and float into the brine tank.

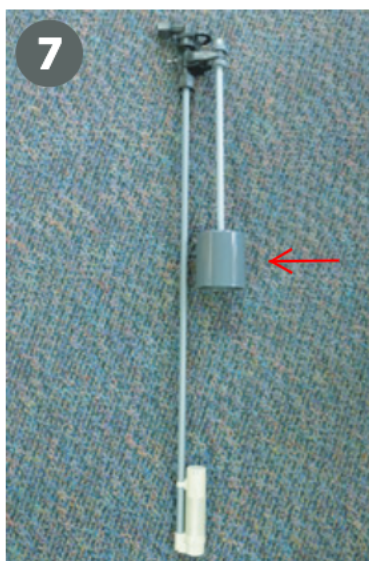

Adjust Float Level by sliding the rubber grommet to the desired height.

The recommended height for the float is 8 - 10 inches from the bottom.



Remove the nut and sleeve from the top of the float assembly.



Put float assembly into the float tube.

Continue to Next Page >

## Brine Tank Assembly Instructions (continued)



10 Insert hose through the hole into the brine tank.



14 Install the cover on the float tube.



11 Slide nut onto hose.



15 Add salt into the brine tank. (2 bags max.)

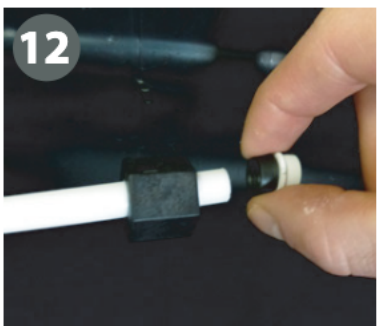

12 Insert support sleeve into the hose.



16 Install cover on the brine tank.



13 Insert hose into elbow fitting. Thread nut onto elbow hand tightened only.

Verify it is aligned as shown.