

WARRANTY

Koolatron Corporation warrants that this product will be free from defects in materials or workmanship under normal household use for a period of 1 year from the date of retail purchase. During this time, defective products will be repaired or replaced at the discretion of the retailer and/or Koolatron Corporation.

This warranty covers normal household usage and does not cover damage which occurs in shipment or results from accident, misuse or abuse, unauthorized repair or alteration, improper maintenance, commercial use, or use with a voltage converter or aftermarket accessories. A Koolatron Master Service Centre must perform all warranty work.

WARRANTY AND SERVICE PROCEDURE

Keep your original, dated, sales receipt with this manual. If this product proves to be defective within the warranty period, please contact Koolatron Corporation at 1-800-265-8456 (North America) or email service@koolatron.com for assistance.

Register online at www.koolatron.com and add another 6 months of warranty protection.

Koolatron™
Elite Series

7-bottle Wine Cellar



KBWC7SS
User Manual

Koolatron™

www.koolatron.com

©2023 Koolatron, Inc. All rights reserved.

All specifications are subject to change without notice.

H1S363

9/2023 - v3

Please Read These Instructions Carefully Before Use!

IMPORTANT SAFEGUARDS

- Household use only. This unit is an indoor appliance. DO NOT use OUTDOORS.
- Place unit on a flat surface, away from heat sources.
- Do not use the appliance if the plug or cable is damaged. If the power cord is damaged and/or is malfunctioning, please have it replaced by an authorized service center.
- Never unplug the appliance by pulling the power cord. Always grip the plug firmly and pull straight out from the receptacle.
- Do not touch the plug with wet hands.
- Never clean appliance parts with flammable fluids. Do not store or use gasoline or any other flammable vapors and liquids in the vicinity of this or any other appliance. The fumes can create a fire hazard or explosion.
- Unplug the appliance when not in use.

Electrical connection

WARNING! Improper use of the grounded plug can result in the risk of electrical shock.

- This appliance should be properly grounded for your safety. The power cord of this appliance is equipped with a three-prong plug which mates with standard three prong wall outlets to minimize the possibility of electrical shock. Do not under any circumstances cut or remove the third ground prong from the power cord supplied. For personal safety, this appliance must be properly grounded.
 - This appliance requires a standard 115V/60Hz electrical ground outlet with three-prong. Have the wall outlet and circuit checked by a qualified electrician to make sure the outlet is properly grounded. When a standard 2-prong wall outlet is encountered, it is your responsibility and obligation to have it replaced with a properly grounded 3-prong wall outlet. The cord should be secured behind the appliance and not left exposed or dangling to prevent accidental injury.
 - The appliance should always be plugged into its own individual electrical outlet which has a voltage rating that matches the rating label on the appliance. This provides the best performance and also prevent overloading house wiring circuits that could cause a fire hazard from overheated.
 - Repair or replace immediately all power cords that have become frayed or otherwise damaged.
- Do not use a cord that shows cracks or abrasion damage along its length or at either end.
- When moving the appliance, be careful not to damage the power cord.

WARNING! FLAMMABLE REFRIGERANT GAS

DANGER - Risk of fire or explosion. Flammable refrigerant used.

- DO NOT puncture refrigerant tubing.
- To be repaired only by trained service personnel.
- Dispose of property in accordance with federal or local regulations.

Use of extension cords

Because of potential safety hazards under certain conditions, we strongly recommend against the use of an extension cord. However, if you must use an extension cord, it is absolutely necessary that it is a UL listed (in the United States) or a CSA-listed (in Canada), 3-wire grounding type appliance extension cord having a grounding type plug and outlet and that the electrical rating of the cord is 13 amperes (minimum) and 115 volts.

Power bar with surge protection

Most electrical appliances use a series of electric control boards to operate. These boards are very susceptible to power surges and could be damaged or destroyed. If the appliance is going to be used in an area or if your city / country is prone to power surges / outages; it is suggested that you use a power surge protector for all electrical devices / appliances you use. The surge protector that you select must have a surge block high enough to protect the appliance it is connected to. If you have any questions regarding the type and size of surge protector needed contact a licensed electrician in your area. Damages due to power surges are not considered a manufacturer covered defect and will void your product warranty.

INSTALLATION

BEFORE USING YOUR WINE CELLAR

- Remove the exterior and interior packing.
- Clean the interior surface with lukewarm water using a soft cloth.
- Before connecting the appliance to the power source, let it stand upright for approximately 2 hours. This will reduce the possibility of a malfunction in the cooling system from handling during transportation.

INSTALLATION

- This appliance is designed for free standing or built-in installation.
- The unit should be placed where the ambient temperature is between 19°C to 24°C (66°F to 75°F). If the ambient temperature is above or below this range, the performance of the unit may be affected. Placing the unit in extreme cold or hot conditions may cause interior temperatures to fluctuate.
- Locate it away from direct sunlight and sources of heat (stove, heater, radiator, etc.). Direct sunlight may affect the acrylic coating and heat sources may increase electrical consumption. Extreme cold ambient temperatures may also cause the unit not to perform properly.
- Avoid locating the unit in moist areas.
- Place the unit on a floor that is strong enough to support it when it is fully loaded. To level the unit, adjust the front leveling leg at the bottom.
- Plug the unit into an exclusive, properly installed-grounded wall outlet. Do not under any circumstances cut or remove the third (ground) prong from the power cord. Any questions concerning the power and/or grounding should be directed toward a certified electrician or an authorized products service center.

BUILT-IN INSTALLATION

See below the size of the unit and the space you need to be able to do a built-in installation of the unit.

Unit dimension (WxDxH) : 145 x 475 x 866 mm (5.7" x 18.7" x 34.1")

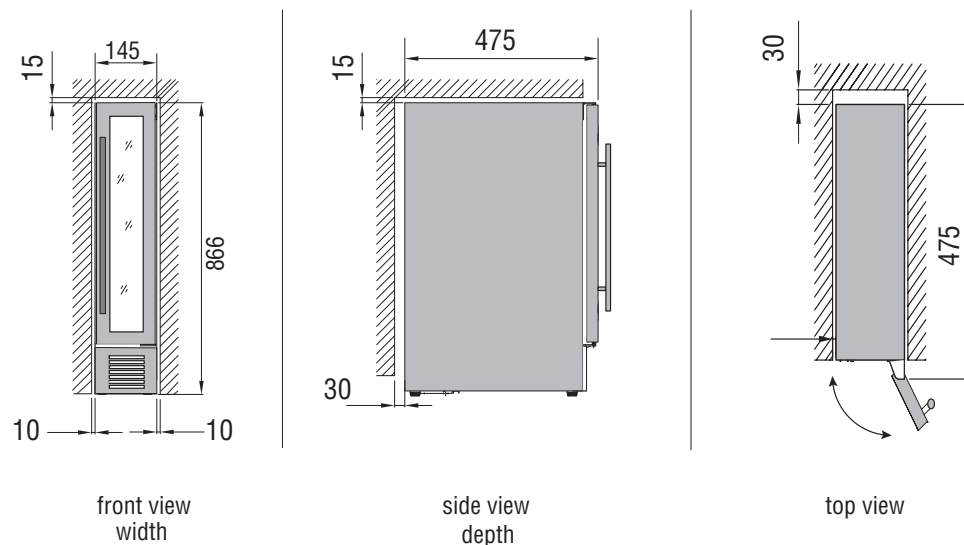

INSTALLATION

DOOR HANDLE INSTALLATION

- 1) Pull away the door gasket in the area where the handle is to be installed on the left side as shown below in Fig. 1. The gasket is easily displaced by hand, no tools are necessary.
- 2) Align the handle with the screws installed. Tighten the screws using a Phillips head screwdriver until the handle sets both flush and secured tightly against the door frame. (DO NOT over tighten as this will cause damage to the handle assembly).
- 3) Replace the door gasket to its original position.

1. door gasket
2. screws
3. Phillips screwdriver
4. handle

Fig. 1

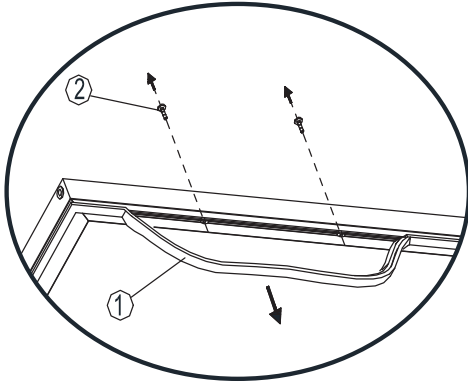
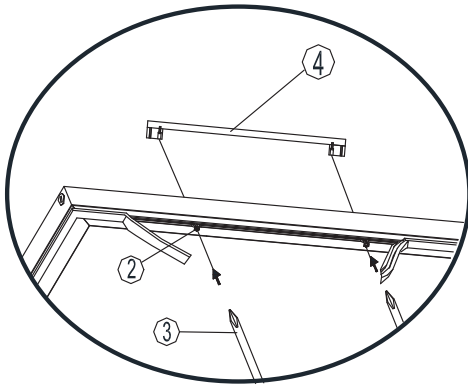

Fig. 2



OPERATING INSTRUCTIONS

Recommended temperature settings

Wine conservation	12°C - 14°C (53°F - 57°F)
Rose and sparkling	5°C - 8°C (41°F - 46°F)
Dry/White	9°C - 12°C (48°F - 53°F)
Red	14°C - 18°C (59°F - 65°F)

*Temperature °C may varies between <+ 2°C

CONTROL PANEL

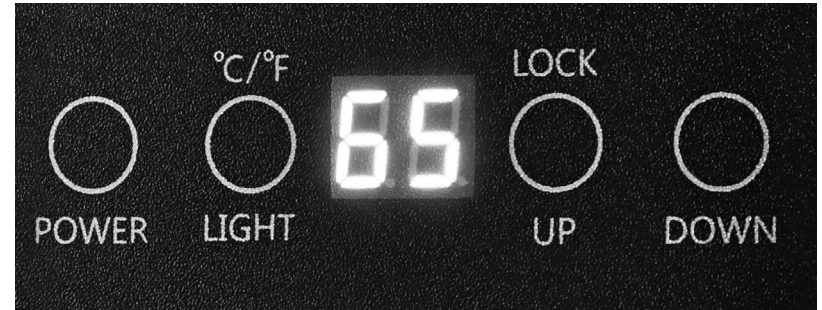

POWER

- Turn the machine on or off
- Press this key for 3 seconds to turn it on or off

°C/°F LIGHT

- Press this key for 3 seconds to select your choice of temperature scale, Celsius to Fahrenheit
- Turn the interior light on and off by pressing this key

LED

Temperature Display Window

LOCK UP

- Press this key for 3 seconds to unlock (15 seconds will lock automatically without any action)
- Press this key to increase the temperature setting by one unit °C / °F

DOWN

- Press this key to lower the temperature setting down by one unit °C / °F
- Long press this key, first ring, and then ring two times, is the working mode of the lamp: the lights will be on for 10 minutes, the lights will automatically go out
- Press this key, first ring, and then three ring continuously, is the working mode of the lamp two: The lights will be long bright
- The two modes can be cyclically switched

- It is normal that the preset temperature and display temperatures are different when using for the first time. It will take approximately 1 hour for the unit to stabilize the temperature. Fill the unit with your choice of wine bottles. Allow 2-3 hours of operation before they reach the desired temperature.
- The temperatures may fluctuate depending on whether the interior light is ON or OFF or the bottles are located on the upper/middle/lower section.
- If the appliance is powered off suddenly, wait for 5 minutes before turning the unit on. It will return to the settings applied, the temperature setting is with automatic memory function.

MAINTENANCE

CLEANING YOUR WINE CELLAR

- Turn off the power, unplug the appliance, and remove all items including shelves and rack.
- Wash the inside surfaces with warm water and baking soda solution. The solution should be about 30 ml (2 tbs) baking soda to 1L (1 quart) of water.
- Wash the shelves with a mild detergent solution.
- Wring excess water out of the sponge or cloth when cleaning area of the controls, or any electrical parts.
- Wash the outside cabinet with warm water and mild liquid detergent.
- Rinse well and wipe dry with a clean soft cloth.

POWER FAILURE

Most power failures are corrected within a few hours and should not affect the temperature of your appliance if you minimize the number of times the door is opened. If the power is going to be off for a longer period of time, you need to take the proper steps to protect your contents.

VACATION TIME

- Short vacations: Leave the Beverage Centre operating during vacations of less than three weeks.
- Long vacations: If the appliance will not be used for several months, remove all items and turn off the appliance. Clean and dry the interior thoroughly. To prevent door and mold growth, leave the door open slightly, blocking it open if necessary.

MOVING YOUR WINE CELLAR

- Remove all items.
- Securely tape down all shelves inside your appliance.
- Turn the adjustable leg up to the base to avoid damage.
- Tape the door shut.
- Be sure the appliance stays secure in the upright position during transportation and protected on the outside of the appliance with a blanket, or similar item.

ENERGY SAVING TIPS

The Wine Cellar should be located in the coolest area of the room, away from heat producing appliances, and out of the direct sunlight.



WARNING! This product contains chemicals known to the State of California to cause cancer, and birth defects or other reproductive harm. www.P65Warnings.ca.gov

TROUBLESHOOTING GUIDE

You can solve many common appliance problems easily, saving you the cost of a possible service call. Try the suggestions below to see if you can solve the problem before calling the servicer.

PROBLEM	POSSIBLE CAUSE
Appliance does not operate.	Not plugged in. The circuit breaker tripped or a blown fuse.
Appliance is not cold enough.	Check the temperature control setting. External environment may require a higher setting. The door is opened too often. The door is not closed completely. The door gasket does not seal properly.
The compressor turns on and off frequently.	The room temperature is hotter than normal. The door is opened too often. The door is not closed completely. The temperature control is not set correctly. The door gasket does not seal properly.
The fans turn on and off frequently.	In order to circulate the air and maintain the set temperature inside the cabinet the fans must cycle on and off even when the compressor is off. The fans will cycle ON and OFF while the compressor is off approximately every 10 seconds, this is called "Semi-speed status". This cycle is normal and meant both to circulate the air as well as ensure the continued operational status of the fans. If the fan stops completely and does not complete this cycle the fan is non-operational.
The light does not work.	Not plugged in. The circuit breaker tripped or a blown fuse. The bulb has burned out.
Vibrations	Check to assure that the appliance is level.
The appliance seems to make too much noise.	Contraction and expansion of the inside walls may cause popping and crackling noises. The appliance is not level.
The door will not close properly.	The appliance is not level. The door was reversed and not properly installed. The gasket is dirty. The shelves are out of position.
Error Code: E1-E2-E3-E4-E7-E8	A sensor has failed. Contact Koolatron Customer Service.