

Quick Start Guide

Cleaning can be overwhelming, so we kept things simple. In just a few easy steps, bObi will be ready to work!

Here's What You'll Need:

All parts are included in bObi's box.



Philips Head
Screwdriver

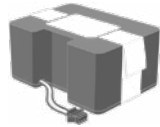

Battery

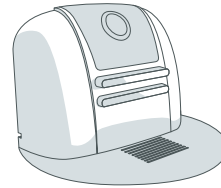

Charging Station

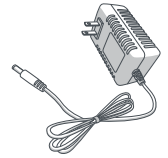

Charging Adapter

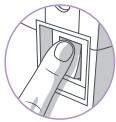

Before starting, remove the clear plastic on bObi's power switch and flip the power switch ON.

Step 1: Install the Battery

Remove the battery cover. Plug the battery in at the circuit junction. Tuck the wire into the side of the compartment and slide the battery in.

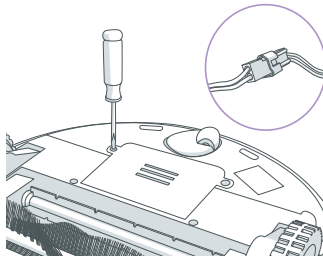

Step 2: Charge bObi

Place bObi on her charging station with the metal nodes on her front resting against the plates on her station and allow her to charge.

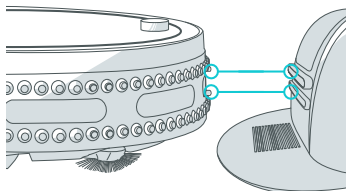

Step 3: Let bObi Sweep!

Press the GO! button on bObi's cover.

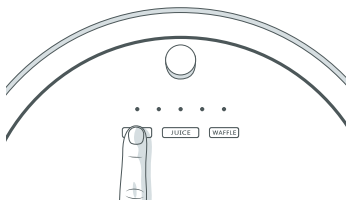

Important Note:

bObi automatically returns to her charging station when low on battery. If bObi is having trouble finding her station, you will need to sync it. Refer to the Charging section of bObi's manual.



When Charging:

The center light will blink to indicate that bObi is charging.



When Fully Charged:

The center light will remain solid.