

TURBRO

FP14TW /FP14CG /FP14BK

QUICK GUIDE

FIRESIDE TABLETOP FIRE PIT

SAFETY INSTRUCTIONS

Please carefully read these instructions before using the tabletop fireplace. Non- compliance with the safety rules can cause serious burns, or even a fire. The manufacturer accepts no liability for damage resulting from improper use and cannot be held liable for damage caused by improper or non-intended use.

● It's recommended to use >96.6% ethanol alcohol as fuel and highly recommended only to use it outdoors. If filled with isopropyl alcohol, or any other <96.6% alcohol, it may produce black smoke that can damage your home.

● The use of lamp oil, fuel paste or fuel gel is prohibited. And do not require electrical or gas connection.

*The manufacturer accepts no liability for the use of the prohibited fuels.

● Alcohols with different compositions may have combustion impurities. It is recommended to observe whether black smoke is produced when it burns. Please **STOP** using it if it produces smoke.

● Please fill the alcohol carefully and do not spill it, or it may in risk of producing fire outside of the firepit.

● The product is to be used exclusively outdoors or in well-ventilated rooms. If using indoors, please keep at least 4 feet away from the wall, and ensure the fire pit is away from the ceiling by at least 10 feet.

● The glass is hot when burning. Do not touch the glass directly.

● The FP14BK is made of stainless steel. The metal surface may expand slightly when it is burning, which is a normal phenomenon. It will recover after cooling down and will not affect use.

● Do not use the product in strong winds or drafts.

● Protect the product from direct exposure to weather conditions.

● Never leave children or pets unattended near the hot product.

● Never leave the product unattended when in use.

● The product is not intended to be operated by persons with reduced physical or mental capabilities.

● Never pour fuel into a product that is still warm or hot.

● Never pour fuel into a product that is still burning.

● Never pour fuel into an open flame.

● Never extinguish the flame with water!

● Keep a fire extinguisher or fire blanket at hand in case of an accident.

● If the product shows unusual burning behavior, extinguish the fire immediately.

● If there is damage to the product - primarily to the fuel tank - the unit can no longer be used.

● Do not move or transport the product during operation. If the product does need to be moved for unexpected reasons, be sure to extinguish the flame and use heat-insulated gloves to protect yourself from burns.

- Position the product at a minimum distance of 4 feet from flammable objects, surfaces, and walls.
- Do not operate the product around highly flammable or explosive substances.
- Ensure a safe stand and use the product only on horizontal surfaces.
- Do not place any objects on the product.
- Do not make any modifications to the product.

SPECIFICATIONS

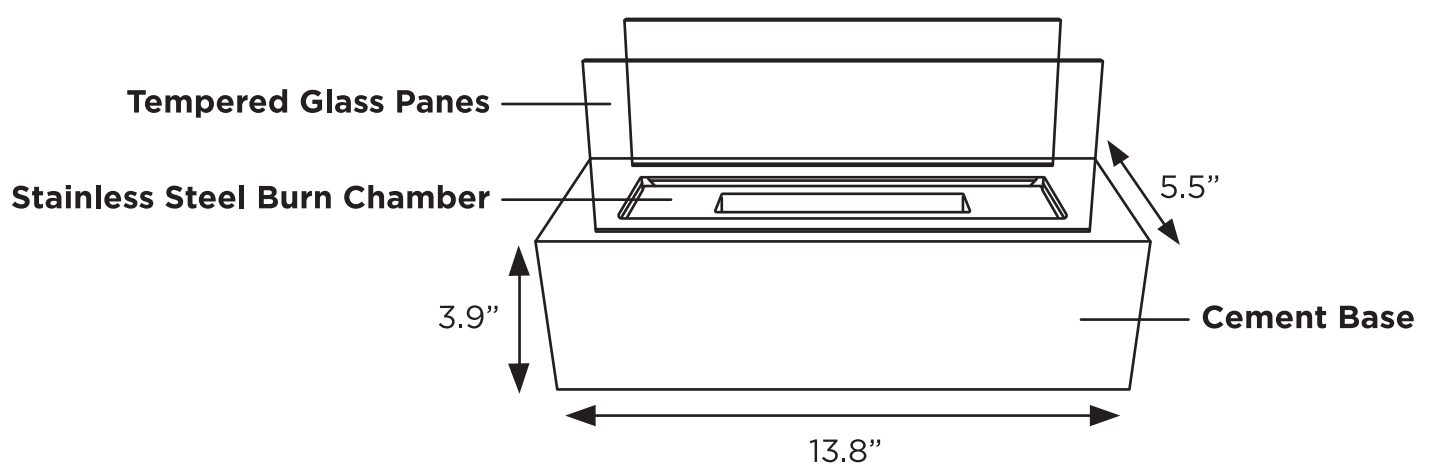

FP14TW /FP14CG

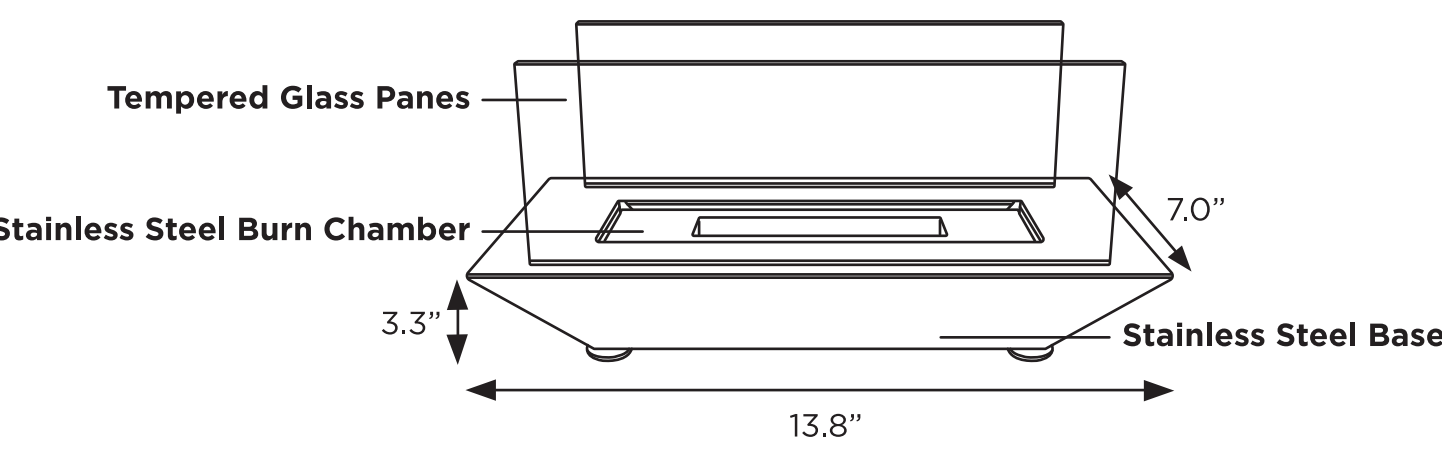

FP14BK

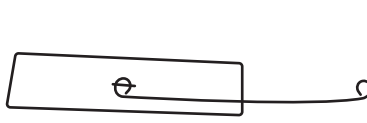

Flame Extinguisher



Ceramic Fiber Cotton Wick Sponge



Silicone Glove

ASSEMBLY INSTRUCTIONS

STEP1

Install the Burn Chamber into the Center of the base.

Note: Ensure the Ceramic Fiber Cotton Wick Sponge is inside the Burn Chamber.

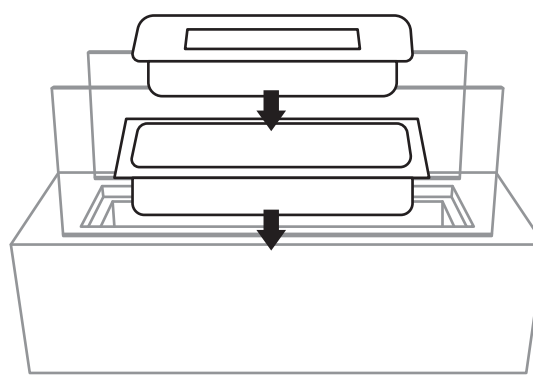

STEP2

Put the fire pit on a stable surface.

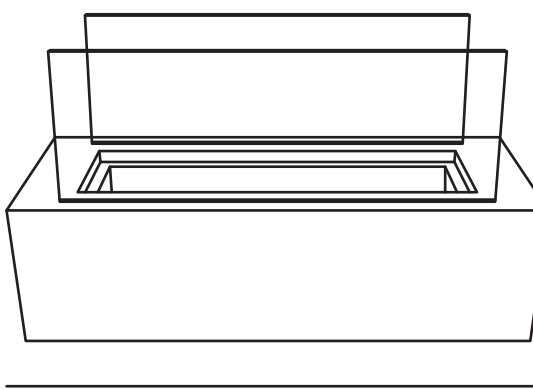

stable surface

STEP3

Add fuel from the top using ≥96.6% ethanol alcohol.

Note:

- Do not exceed the max fill line.
- Do not place fuel in front of the fire pit.

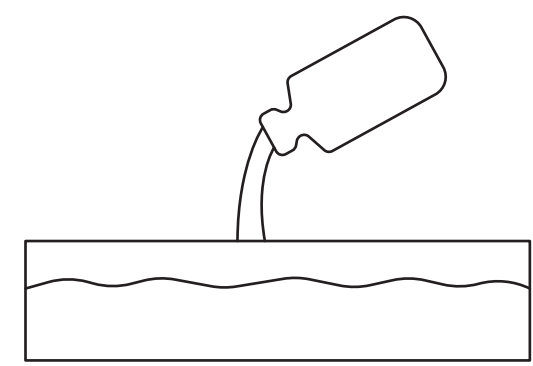

STEP4

Wipe up any spills. Any spills that happen when adding fueled must be wiped up before lighting.



STEP5

Install the Tempered Glass Panes on the two sides of the base.

Note:

Do not forcefully install the glass, be careful of breaking the glass.

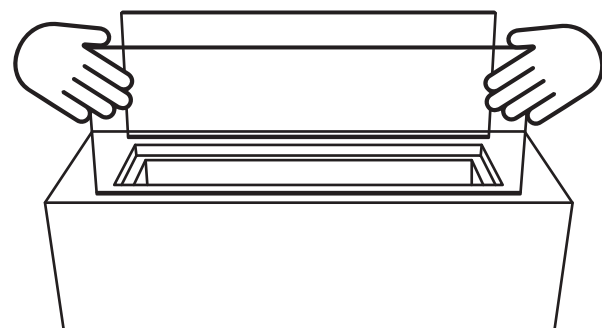

STEP6

Light it. Use only a long-handled lighter or match to light. This keeps your hands at a safe distance.

Note:

Please allow a few minutes to reach the optimum temperature and flame height.

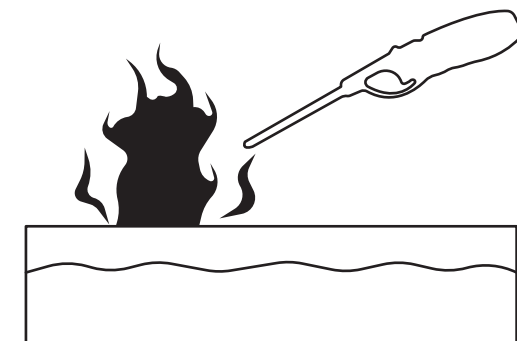

LIMITED WARRANTY

We provide one year warranty on this product. For more information, please visit www.turbro.com/warranty.

What's covered?

Defects due to faulty materials and/or workmanship of the product

What's not covered?

1. Damage caused by the owner when attempting to fix or altering the product by himself or herself.
2. Damage caused by misuse, abuse, neglect, alterations, or unauthorized repair.
3. Natural depreciation.

Warranty Period

Warranty becomes effective from the date of original purchase and will last for one year.

Who's covered?

This limited warranty is only effective for the original purchaser. It is non-transferable.

How to request warranty services?

To obtain the benefit of this warranty, please email support@turbro.com. Our customer service team will address your issue as soon as possible!



© Katmai Technology Limited

✉ support@turbro.com

🌐 www.turbro.com

☎ (323) 438-3334

A面

B面