

Easy Instruction Guide

Installation

- Cut out the work surface according to the sizes shown in the drawing.
- For the purpose of installation and use, a minimum of 1.97in space shall be preserved around the hole.
- Be sure the thickness of the work surface is at least 1.18in. Please select heat-resistant work surface material to avoid larger deformation caused by the heat radiation from the hotplate. As shown below: The work surface material must use the impregnated wood or other insulation material.
- Ensure the table supporting the surface unit on the metal frame edge, see below right drawing.

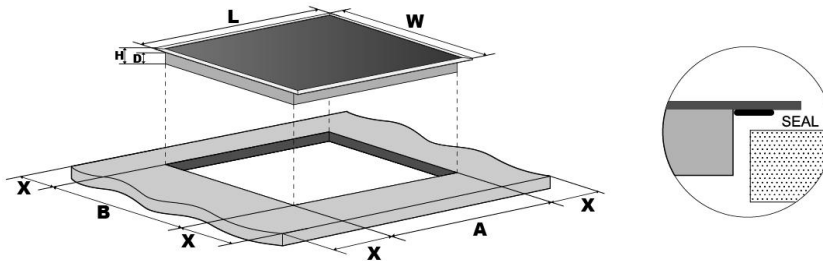

	L(in)	W(in)	H(in)	D(in)	A(in)	B(in)	X(in)
UI72358	29.92	20.47	2.28	2.13	28.74	19.29	1.97mini

Under any circumstances, make sure the cooktop is well ventilated and the air inlet and outlet are not blocked. Ensure the cooktop is in good work state. As shown below.

Note: The safety distance between the hotplate and the cupboard above the hotplate should be at least 30 inches (760mm).

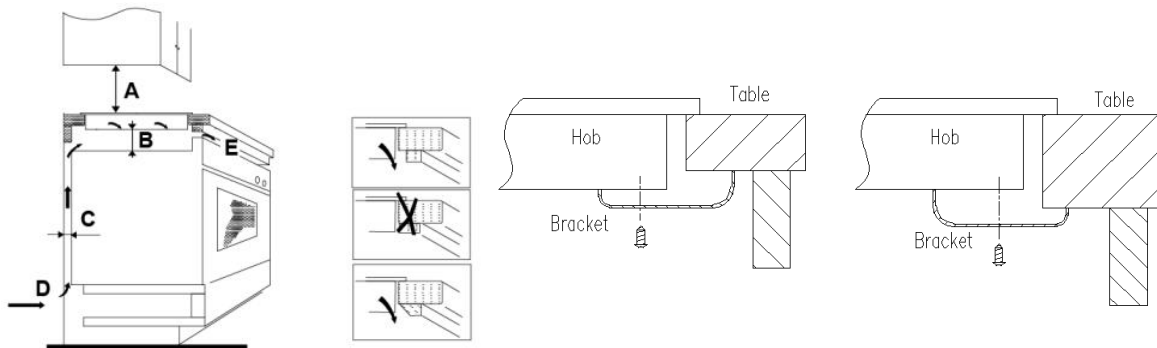

A(in)	B(in)	C(in)	D	E
30	1.97 mini	0.79 mini	Air intake	Air exit 0.20in

Locating the fixing brackets

- Fix the cooktop on the work surface by screw four brackets on the bottom of cooktop (see picture) after installation.
- Adjust the bracket position to suit for different work surface's thickness.

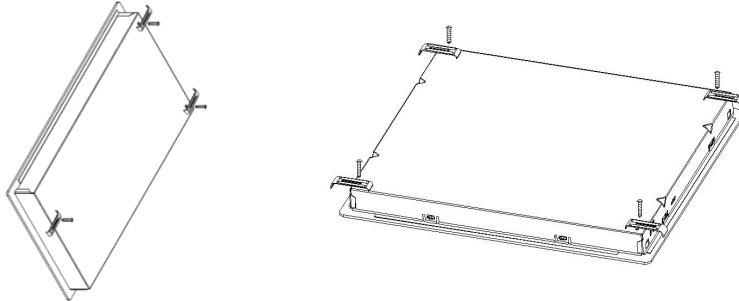

Connecting the cooktop to the main power supply

For 4-wire cable from home power supply

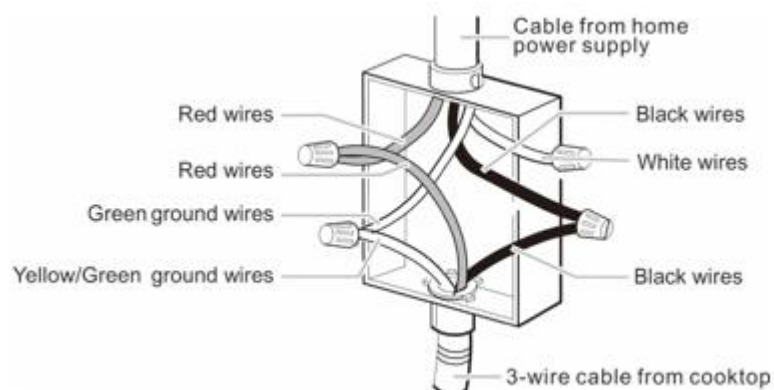

For 3-wire cable from home power supply

