

## Owner's Manual

# CRAFTSMAN®

## 15 GALLON 35 PSI SPRAYER

Model No. 486.245315



DO NOT RETURN TO STORE  
For Missing Parts or Assembly  
Questions Call 1-866-576-8388

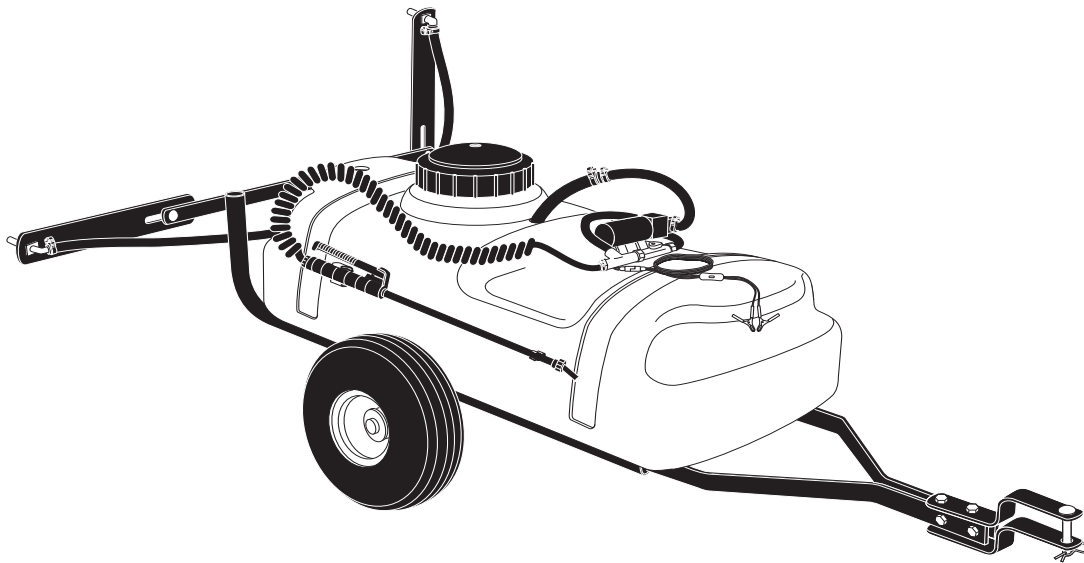

### CAUTION:

Before using this product, read this manual and follow all Safety Rules and Operating Instructions.

- Safety
- Assembly
- Operation
- Maintenance
- Parts

Sears Brands Management Corporation, Hoffman Estates, IL 60179 U.S.A.  
[www.sears.com/craftsman](http://www.sears.com/craftsman)

## TABLE OF CONTENTS

SAFETY RULES.....	2	STORAGE .....	8
FULL SIZE HARDWARE CHART .....	3	SPRAYING CHARTS.....	9
CARTON CONTENTS.....	3	REPAIR PARTS ILLUSTRATION.....	10
ASSEMBLY.....	4	REPAIR PARTS LIST.....	11
OPERATION.....	7	PARTS ORDERING/SERVICE .....	Back Page
MAINTENANCE .....	8		

## WARRANTY

### CRAFTSMAN LIMITED WARRANTY

FOR ONE YEAR from the date of sale this product is warranted against defects in material or workmanship.

WITH PROOF OF SALE a defective product will be replaced free of charge.

For warranty coverage details to obtain free replacement, visit the web page: [www.craftsman.com/warranty](http://www.craftsman.com/warranty)

To obtain warranty coverage, return a defective product with proof of sale to the retailer from which it was purchased for free replacement.

This warranty is void if this product is ever used while providing commercial services or if rented to another person.

This warranty gives you specific legal rights, and you may also have other rights which vary from state to state.

**SEARS BRANDS MANAGEMENT CORPORATION, Hoffman Estates, IL 60179**

DO NOT RETURN TO STORE for Missing Parts or Assembly Questions

Call 1-866-576-8388 Attachment Hotline

The model number and serial numbers will be found on a decal attached to the sprayer.

You should record both the serial number and the date of purchase and keep in a safe place for future reference.

MODEL NUMBER: 486.245315

SERIAL NUMBER: \_\_\_\_\_

DATE OF PURCHASE: \_\_\_\_\_



## SAFETY



Any power equipment can cause injury if operated improperly or if the user does not understand how to operate the equipment. Exercise caution at all times when using power equipment.

- Read this owners manual carefully before attempting to assemble or operate this sprayer.
- Read your vehicle owners manual for operating and safety rules before using this equipment.
- Never allow children to operate this sprayer, and do not allow adults to operate without proper instructions.
- Do not allow anyone to ride on or sit on this sprayer.
- Do not allow passengers on the towing vehicle.
- Keep the area of operation clear of all persons, particularly small children. Also keep area clear of pets.
- Read the chemical label carefully for instructions and caution notes on handling and mixing of chemicals.
- Wear eye and hand protection and wear protective clothing when handling and applying lawn chemicals.
- Do not spray on windy days.
- Attachment of this sprayer may affect your tractor's braking and stability. Be aware of your tractor's capabilities. Refer to the safety rules in the vehicle owner's manual concerning safe operation on slopes. Be aware of changing conditions on slopes. **STAY OFF OF STEEP SLOPES.**
- Operate at reduced speed on rough terrain, along ditches and on hillsides to prevent loss of control.
- Follow maintenance and lubrication instructions as outlined in this manual.



Look for this symbol to point out important safety precautions. It means — **Attention!! Become alert!! Your safety is involved.**

# HARDWARE PACKAGE AND CARTON CONTENTS

## SHOWN FULL SIZE

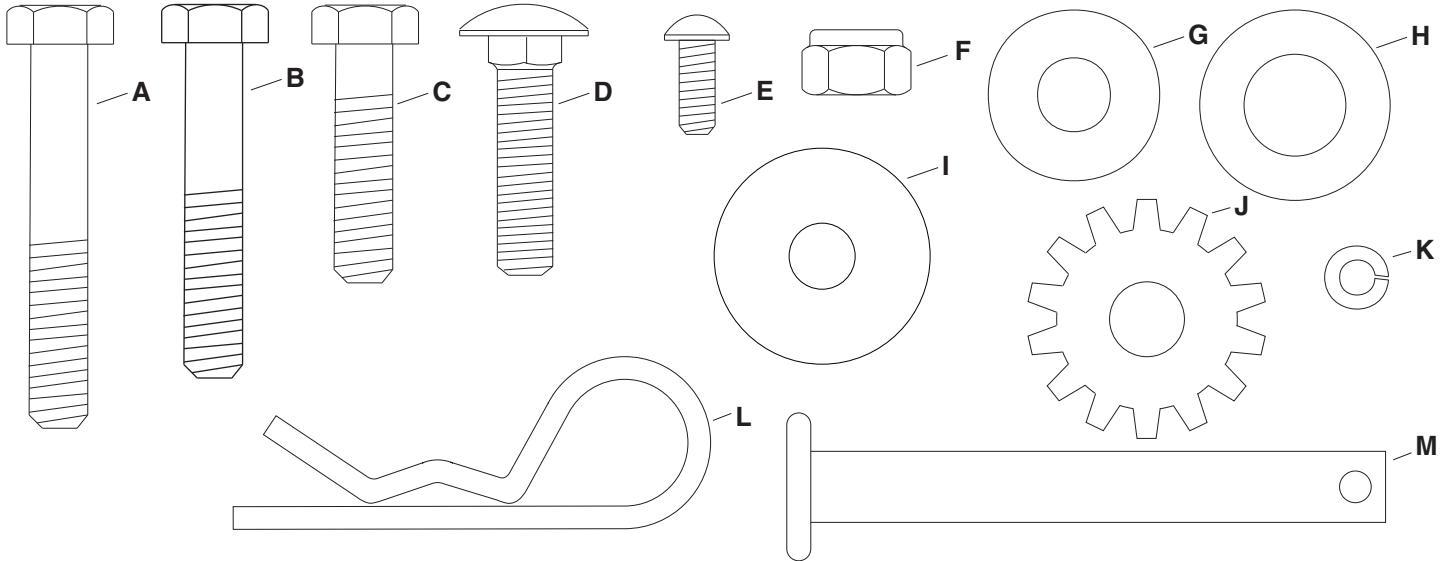

## NOT SHOWN FULL SIZE

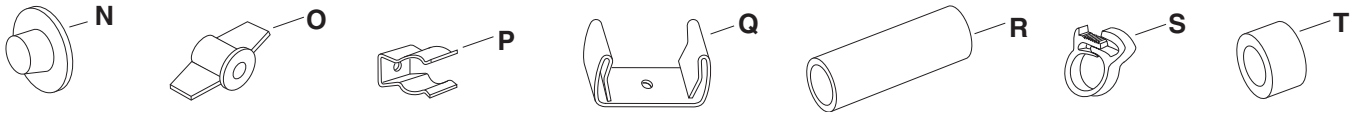

KEY	PART NO.	QTY	DESCRIPTION	KEY	PART NO.	QTY	DESCRIPTION
A	44180	8	Hex Bolt, 5/16" x 2"	K	736-0722	2	Lock Washer, #10
B	43084	4	Hex Bolt, 5/16 x 1-3/4"	L	43343	1	Hair Cotter Pin
C	43840	2	Hex Bolt, 5/16" x 1-1/4"	M	47623	1	Hitch Pin
D	43682	2	Carriage Bolt, 5/16" x 1-1/4"	N	44166	2	Palnut
E	46677	2	Screw, #10 x 3/8"	O	712-0421	2	Knob
F	47810	14	Nylock Nut, 5/16"	P	45180	1	Spray Gun Clip, Small
G	43081	10	Flat Washer, 5/16"	Q	47397	1	Spray Gun Clip, Large
H	R19171616	4	Flat Washer, 1/2"	R	46578	2	Spacer, Long
I	736-0231	4	Thick Washer	S	42767	1	Coiled Hose Clamp
J	44732	2	Washer, 5/16" Tooth Lock	T	27231	2	Spacer, Short

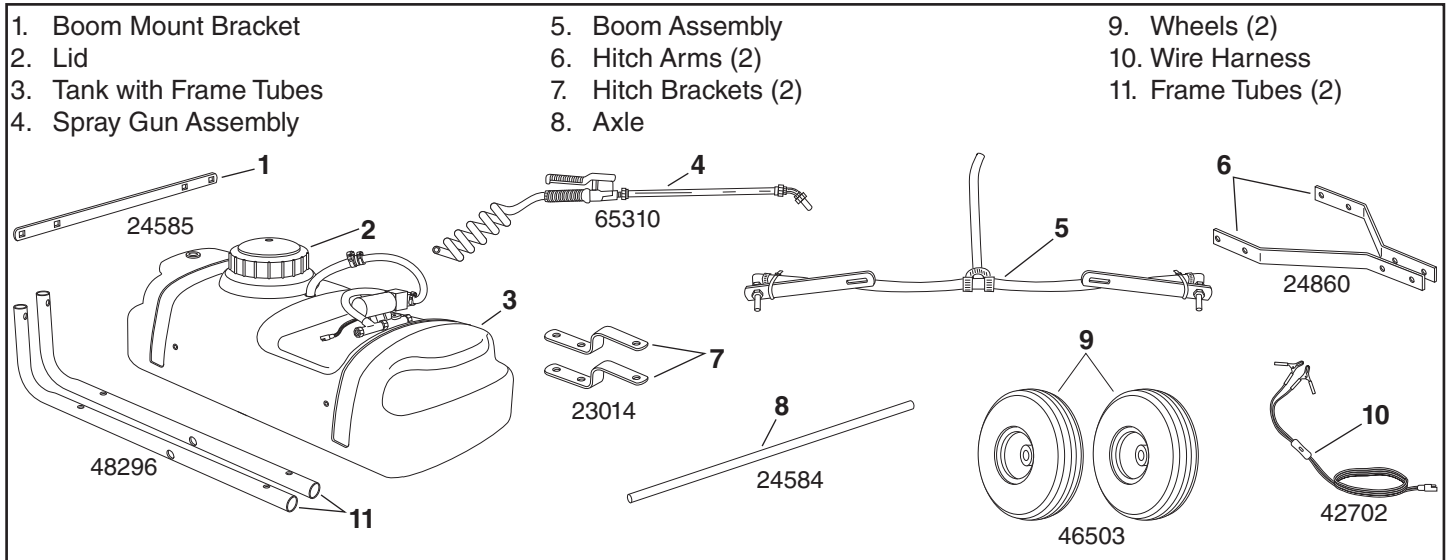

## ASSEMBLY

### TOOLS REQUIRED FOR ASSEMBLY

- (2) 1/2" Wrenches
- (1) Screwdriver
- (1) Pliers
- (1) Hammer

- Attach mounting plates to frame tubes using four 5/16 x 1-3/4" hex bolts, 3/8" washers, thick washers placed between the mounting plates and frame tubes, 3/8" washers, and 5/16" nylock nuts. **Tighten** the bolts.

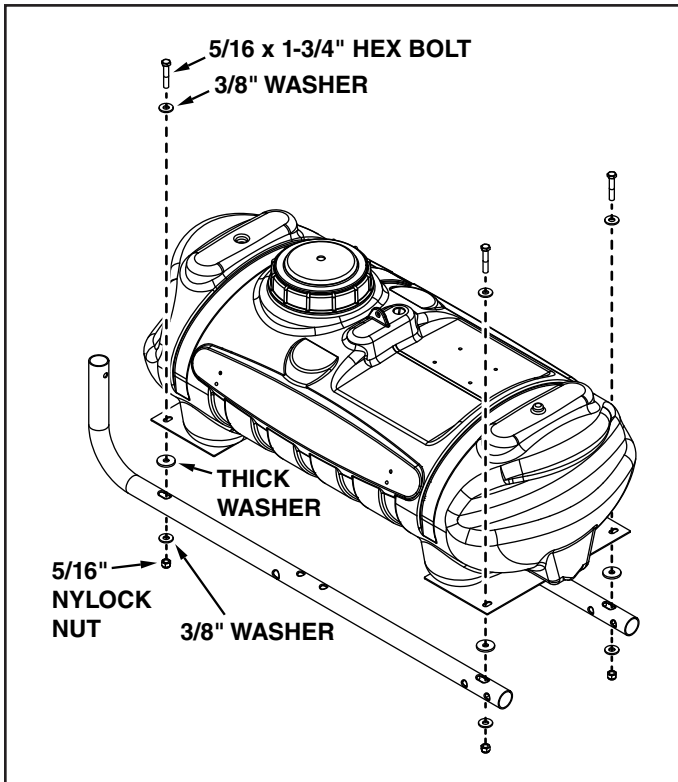

FIGURE 1

- Assemble axle through holes in frame tubes. You may need to slightly loosen bolts in frame tubes to make the axle fit. Retighten bolts only enough to flatten the lock washers.
- Assemble a 1/2" flat washer, a short spacer, a long spacer, a wheel, and another 1/2" flat washer onto the axle. Lightly tap a palnut onto the end of the axle. Repeat on other end of axle.

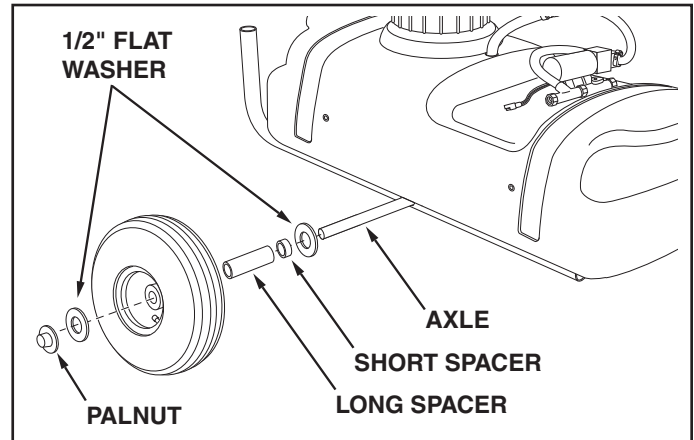

FIGURE 2

- Assemble a hitch arm to the inside of a frame tube underneath the tank. Use two 5/16" x 2" hex bolts and 5/16" nylock nuts as shown in figure 3. **Do not tighten yet.** Repeat for other side.

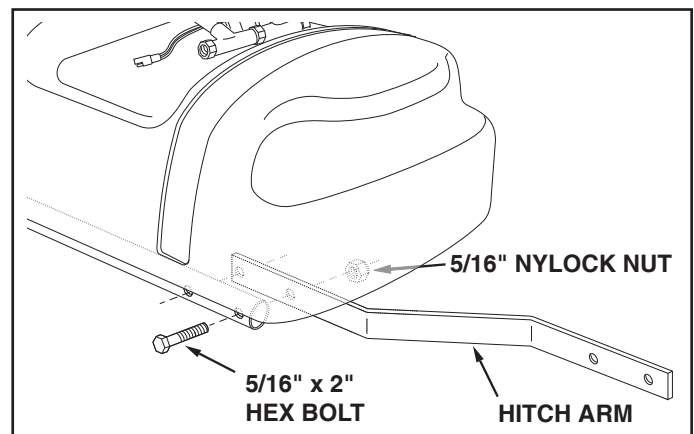

FIGURE 3

- Fasten ends of hitch arms together using two 5/16" x 1-1/4" hex bolts and 5/16" nylock nuts. **Do not tighten yet.**
- Assemble hitch brackets to hitch arms using two 5/16" x 2" hex bolts and 5/16" nylock nuts. Position each bolt behind one of the cross bolts in the hitch arms. **Do not tighten yet.**
- At this time **tighten all bolts** starting with the bolts in figure 3, then the bolts in figure 4.

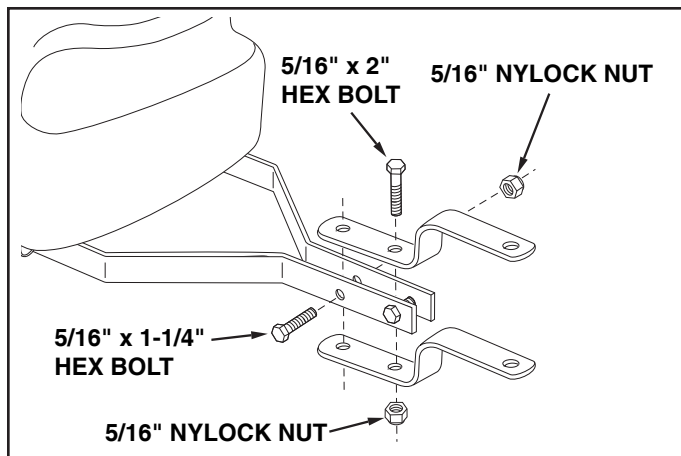

FIGURE 4

- Assemble boom mount bracket to rear of hitch tubes using two 5/16" x 2" hex bolts and 5/16" nylock nuts.

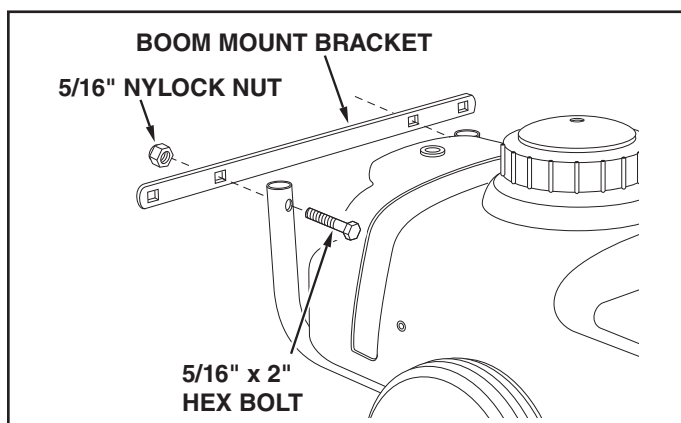

FIGURE 5

- Assemble boom bars to boom mount bracket using two 5/16" x 1-1/4" carriage bolts, tooth lock washers (between bar and bracket), 5/16" flat washers and knobs. Boom connecting hose should extend upward.

**NOTE:** Make sure nozzle openings face straight down when boom bars are in the horizontal operating position.

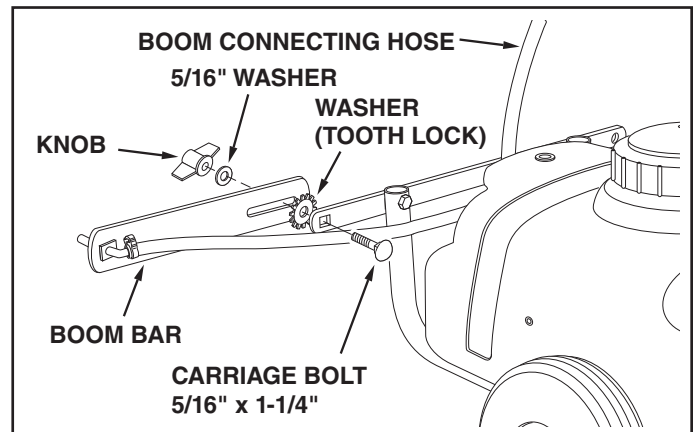

FIGURE 6

- Assemble large and small spray gun clips to side of tank using two #10 x 1/2" screws and #10 lock washers.

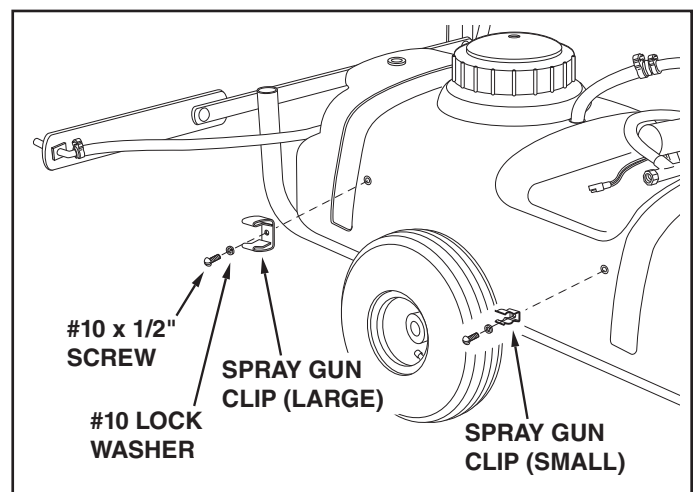

FIGURE 7

- 
- WIRE HARNESS**

### FIGURE 8

- 
- Diagram illustrating the assembly of a boom sprayer, showing the connection of various components:
- 3/8" HOSE CLAMPS**: Indicated by arrows pointing to the clamps securing the main boom hose.
  - COILED HOSE CLAMP**: Points to the clamp securing the coiled spray gun hose.
  - SPRAY GUN HOSE**: Points to the hose connected to the spray gun.
  - 1/4" TEE**: Points to the tee fitting used to connect the spray gun hose to the main line.
  - ON - OFF VALVE**: Points to the valve mechanism on the boom.
  - CONDUIT CLAMP**: Points to the clamp securing the electrical conduit.
  - BOOM CONNECTING HOSE**: Points to the hose connecting the boom to the spray gun.

### FIGURE 9

**VIEWED FROM FRONT**

- 
- A schematic diagram of a battery-powered circuit. On the right, a rectangular box labeled "BATTERY" has a positive terminal (+) at the top and a negative terminal (-) at the bottom. Two wires, one red and one black, extend from the battery terminals to the left. The red wire passes through a component labeled "SWITCH" (a small rectangle with a horizontal line through it). After the switch, the red wire passes through a component labeled "QUICK COUPLER" (two interlocking rectangular shapes). The black wire also passes through the "QUICK COUPLER". To the left of the quick coupler, the red wire is labeled "RED" and the black wire is labeled "BLACK".

### FIGURE 10

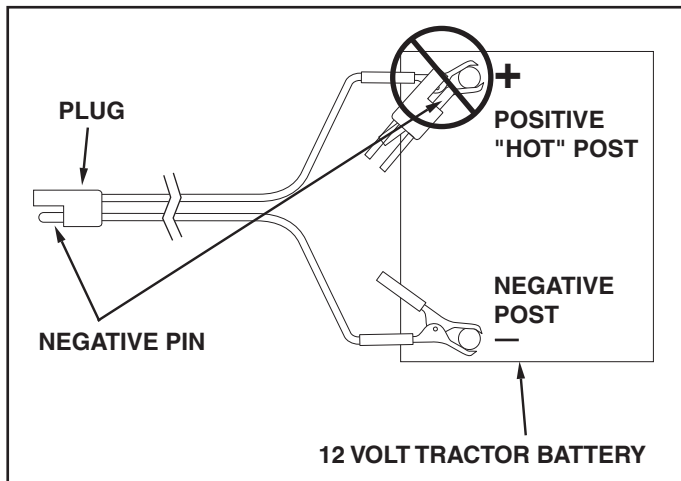
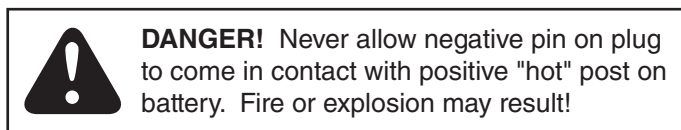
**FIGURE 11**

# OPERATION

## KNOW YOUR SPRAYER

**Read this owner's manual and safety rules before operating your sprayer.**

Compare the illustration below with your sprayer to familiarize yourself with the various controls and their locations.

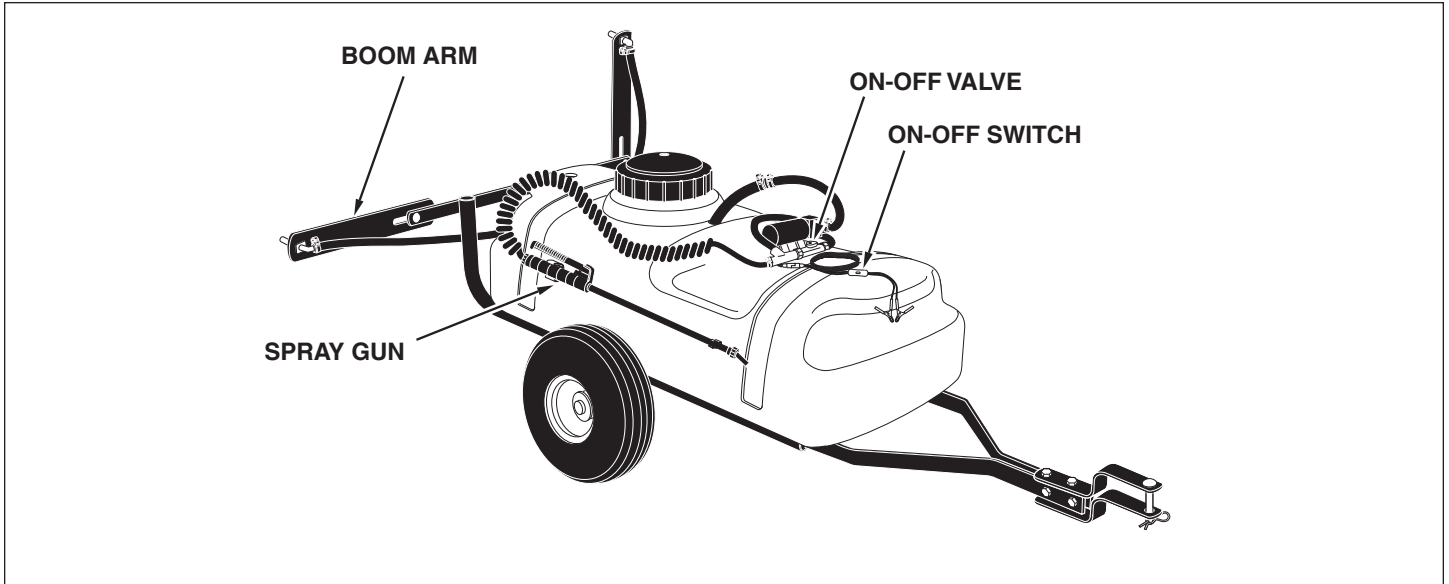

**ON-OFF VALVE** Turns the flow on or off from the pump to the boom nozzles.

**ON-OFF SWITCH** Turns pump/motor on or off.

**BOOM ARM** Swivels up and down and adjusts in and out to obtain proper nozzle positioning.

**SPRAY GUN** Unhooks from tank for spraying shrubs, small trees or areas inaccessible to the towed sprayer.

## BEFORE STARTING

**It is important** to test the boom and spray gun with plain water before attempting actual spraying. This will enable you to check the sprayer for leaks and to set the spray pattern and nozzle pressure. If a leak should occur, thread tape may be used to better seal the fitting.

## PUMP PRESSURE SWITCH

The pump is equipped with a pressure switch. The pressure switch senses outlet pressure of the pump and will turn off the electrical power to the pump at a predetermined high pressure point (35 PSI). If the flow demand is very low, the pump may reach this high pressure point and the switch will cause "cycling" (the pump cycles on and off rapidly). This is not a problem unless the pump is subject to continuous cycling within one second intervals for long periods of time.

## ON-OFF ADJUSTMENT OF BOOM NOZZLES

The sprayer is equipped with an "On-Off" valve for the boom which allows the flow to the boom nozzles to be shut off.

## ADJUSTING SPRAY GUN NOZZLE

Turn the nozzle on the spray gun to adjust the spray from a cone shaped fine mist to a straight stream. Maximum gun pressure is attained with the ON-OFF valve shut off.

## SETTING THE BOOM FOR SPRAYING

The correct positioning of the boom places the nozzles approximately 40" apart and 14" above the ground. This gives a spray width of approximately 80" with a slight center overlap. See figure 12.

- Slide the boom bars out to the ends of the slots.
- Swivel the boom bars until the nozzles are approximately 14" above the ground.
- Make sure the nozzles are adjusted so that the openings point straight down.

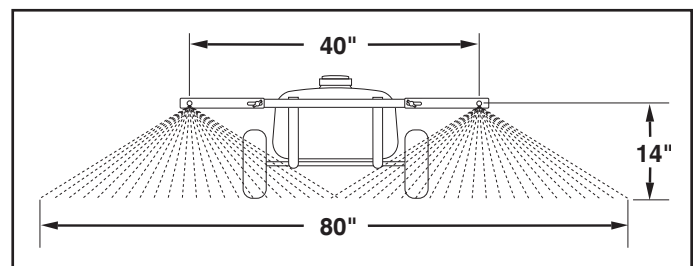

**FIGURE 12**



## HOW TO USE YOUR SPRAYER

- Determine the approximate square footage of the area to be sprayed. Use this amount to estimate the number of gallons that will be required, based on product recommendations. This can help avoid unneeded solution left in the tank.
- Determine the application rate (gallons per 1,000 sq. feet or gallons per acre) based on the chemical manufacturers recommendations.
- Use the tip chart on page 9 to determine what ground speed will achieve the recommended application rate.
- To determine the throttle setting for attaining the desired ground speed, mark off 100, 200 and 300 feet intervals. The speed chart at the bottom of page 9 indicates the number of seconds it takes to travel these distances. Set the throttle and, with a running start, travel the distances in the number of seconds indicated by the speed chart. Once you have determined the throttle and gear settings needed, mark the throttle location so that you can easily resume the same speed after stopping.
- Add the chemical solution to the tank, following the product instructions.

- Drive to the starting place for spraying.
- Set the boom in position for spraying.
- Set the throttle at the position determined in the 4th step. Reach back and flip the pump/motor switch to the "ON" position to start spraying.
- Stay clear of flowers, shrubs and evergreen trees when spraying weed control solutions to prevent contact of the solution with these sensitive plants.

### ATTENTION!

**Do not** allow chemicals to sit in pump for extended times of idleness. Some chemicals will damage the pump valve if allowed to soak untreated for a length of time. Always flush the pump with water after each use. See the instructions for cleaning the tank in the maintenance section for flushing and disposal of chemicals.



**CAUTION:** Wear eye protection, gloves and protective clothing when handling and working with lawn chemicals.

## MAINTENANCE/STORAGE

### CUSTOMER RESPONSIBILITIES

- Read and follow the maintenance schedule and the maintenance procedures listed in this section.

MAINTENANCE SCHEDULE														
Fill in dates as you complete regular service.														
	Before each use				After each use				Every season				Before storage	
Check for loose fasteners	X													
Clean tank		X												
Lubrication			X											

### CHECK FOR LOOSE FASTENERS

- Before each use make a thorough visual check of the sprayer for any bolts and nuts which may have loosened. Retighten any loose bolts and nuts.

### CLEANING TANK

- After use, fill the tank part way with water, start the sprayer and allow clear water to be pumped through the plumbing system and out through the boom assembly and the handgun. Use the handgun to thoroughly wash all internal parts of the tank, the outside of the tank and the boom.
- Refill the tank about half full with plain water and a chemical neutralizer and repeat the cleaning instructions above. Flush the entire sprayer with the neutralizing agent. Follow the chemical manufacturers instructions for disposal of all wash or rinsing water.

### LUBRICATION

- Oil the wheels at least once a season.

### CLEANING STRAINERS

- Periodically clean the strainer in the end of the intake hose at the bottom of the tank. Remove the nylon swivel nut from the hose, pull out the screen and flush it with clear water.
- Periodically clean the strainers in the boom nozzles. Remove the nozzle, pull out the screen and flush it with clear water.

### STORING

- Drain all water out of the sprayer, paying special attention to the pump and handgun. These items are especially prone to damage from chemicals and freezing weather.
- The sprayer should be winterized before storage by pumping a 50-50 solution of water and R. V. antifreeze through the entire plumbing. Proper care and maintenance will prolong the life of the sprayer.



### U.S. GALLON TIP CHART

Tip No.	Spray Width Inches	Pressure PSI	Tip Capacity US Gallons Per Minute	GALLONS PER ACRE (BASED ON WATER)						
				1 MPH	2 MPH	3 MPH	4 MPH	5 MPH	7.5 MPH	10 MPH
#3	80"	25	.36	53	26.5	17.7	13.3	10.6	7.1	5.3
Tip No.	Spray Width Inches	Pressure PSI	Tip Capacity U.S. Gallons Per Minute	GALLONS PER 1000 SQ. FT. (BASED ON WATER)						
				1 MPH	2 MPH	3 MPH	4 MPH	5 MPH	7.5 MPH	10 MPH
#3	80"	25	.36	1.22	0.6	0.41	0.31	0.24	0.16	0.12

### IMPERIAL GALLON (LITER) TIP CHART

Tip No.	Spray Width Inches (mm)	Pressure PSI (Bar)	Tip Capacity Imperial Gallons per minute (liters per minute)	IMPERIAL GALLONS (Liters) PER ACRE (BASED ON WATER)						
				1 MPH 1.6 K/H	2 MPH 3.2 K/H	3 MPH 4.8 K/H	4 MPH 6.4 K/H	5 MPH 8 K/H	7.5 MPH 12 K/H	10 MPH 16 K/H
#3	80" (2032 mm)	25 (1.75)	.30 (1.36)	44.2 (201.0)	22.1 (100.5)	14.8 (67.8)	11.1 (50.5)	8.9 (40.5)	5.9 (26.8)	4.4 (20.0)
Jet Size	Spray Width Inches (mm)	Pressure PSI (Bar)	Tip Capacity Imperial Gallons per minute (liters per minute)	IMPERIAL GALLONS (Liters) PER 1000 SQ. FT. (BASED ON WATER)						
				1 MPH 1.6 K/H	2 MPH 3.2 K/H	3 MPH 4.8 K/H	4 MPH 6.4 K/H	5 MPH 8 K/H	7.5 MPH 12 K/H	10 MPH 16 K/H
#3	80" (2032 mm)	25 (1.75)	.30 (1.36)	1.0 (4.54)	0.50 (2.27)	0.34 (1.55)	0.26 (1.18)	0.20 (0.91)	0.14 (0.64)	0.10 (0.54)

### GROUND SPEED CHART

M.P.H. (K/H)	Time Required in Seconds to Travel a Distance of:		
	100 ft (30.5 M)	200 ft (61 M)	300 ft (91.5 M)
1.0 (1.6)	68	136	205
2.0 (3.2)	34	68	102
3.0 (4.8)	23	45	68
4.0 (6.4)	17	34	51
5.0 (8.0)	14	27	41
6.0 (9.7)	11	23	34
7.0 (11.3)	9.7	19	29
8.0 (12.9)	8.5	17	26
9.0 (14.5)	7.6	15	23
10.0 (16.1)	6.8	14	20

## PARTS

## REPAIR PARTS FOR 15 GALLON SPRAYER MODEL 486.245315

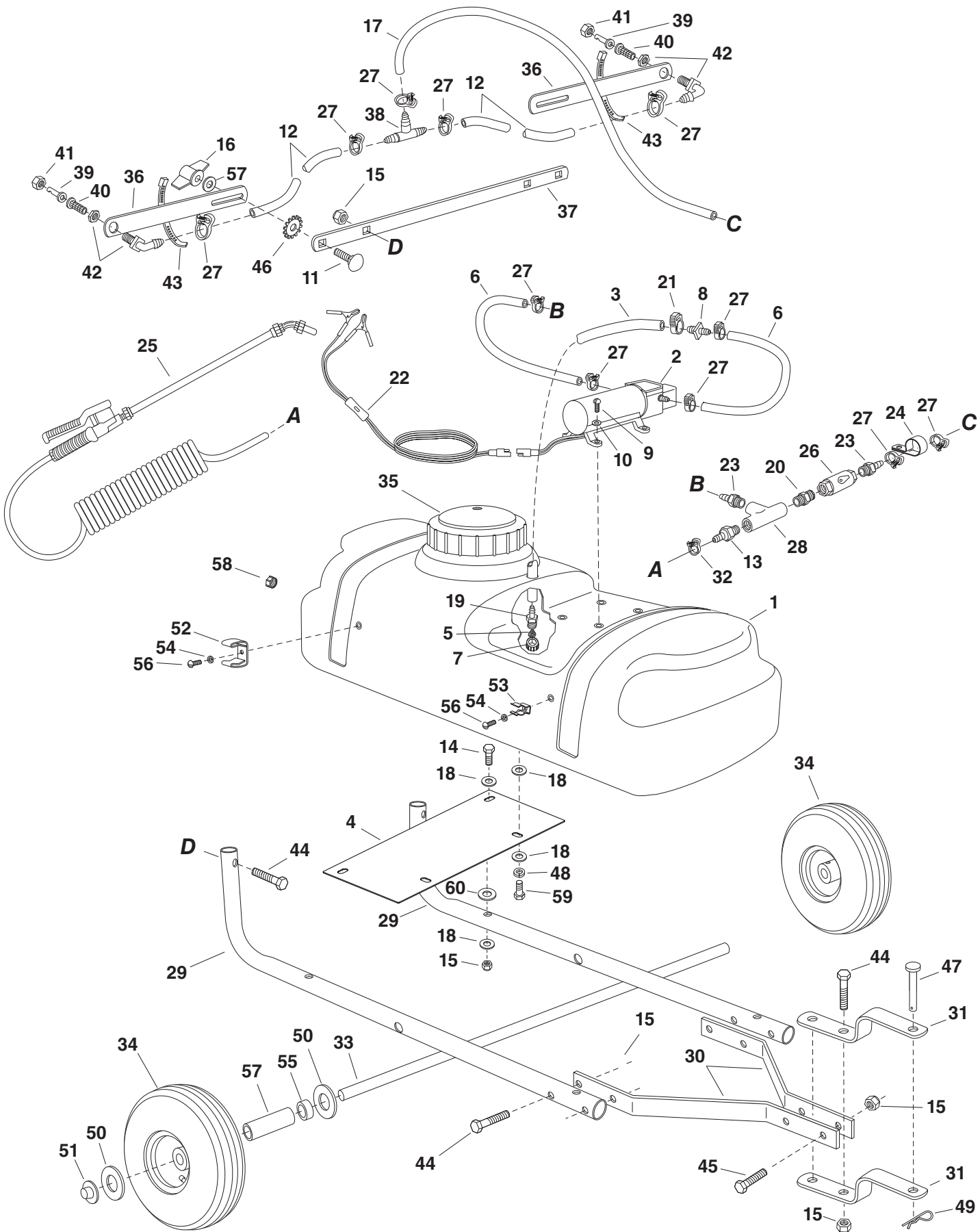

## REPAIR PARTS FOR 15 GALLON SPRAYER MODEL 486.245315

REF. NO.	PART NO.	QTY.	DESCRIPTION	REF. NO.	PART NO.	QTY.	DESCRIPTION
1	41667	1	Tank (15 Gal.)	32	42767	1	Clamp, Coiled Hose
2	42701	1	Pump and Motor	33	24584	1	Axle, 1/2"
3	45022	1	Hose, 1/2" ID (14" Lg.)	34	46503	2	Wheel
4	27778	2	Mounting Plate	35	46700	1	Lid
5	45024	1	Strainer, Cap Type 1"	36	24122	2	Boom Bar
6	47002	2	Hose, 3/8" ID (10" Lg.)	37	24585	1	Bracket, Boom Mount
7	45032	1	Nut, Swivel 3/4" Garden Hose	38	47394	1	Tee, Plastic 3/8" Hose
8	47005	1	Reducer, Hose Mender 1/2" x 3/8"	39	45028	2	Nozzle, SS Floodjet
9	47078	4	Screw, Pan Hd. 10-24 x 3/4" Lg.	40	45029	2	Strainer, Screen Type
10	43910	4	Washer, Flat #10 SAE	41	45037	2	Nut, Screen Body
11	43682	2	Bolt, Carriage 5/16-18 x 1-1/4"	42	47396	2	Elbow, Plastic 11/16" Thd.
12	47392	2	Hose, 3/8" ID (21" Lg.)	43	726-0178	2	Nylon Tie
13	47414	1	Adapter, 1/4" NPT x 1/4" Barb	44	44180	8	Bolt, Hex 5/16-18 x 2"
14	43084	4	Bolt, Hex 5/16-18 x 1-3/4"	45	43840	2	Bolt, Hex 5/16-18 x 1-1/4"
15	47810	14	Nut, Hex 5/16-18 (Nylock)	46	44732	2	Washer, Tooth Lock 5/16"
16	712-0421	2	Knob	47	47623	1	Hitch Pin
17	47421	1	Hose, 3/8" ID (28" Lg.)	48	43086	8	Lock Washer, 5/16"
18	43081	22	Washer, 5/16" Std. Wrt.	49	43343	1	Pin, Hair Cotter #4 (1/8")
19	46276	1	Adapter, 3/4" GH x 1/2" Barb	50	R19171616	4	Washer, 17/32" x 1"
20	47411	1	Nipple (nylon) 1/4"	51	44166	2	Hub Cap (1/2" Palnut)
21	45025	1	Clamp, 1/2"	52	47397	1	Clip (Large), Spray Gun
22	42702	1	Wiring Harness	53	45180	1	Clip (Small), Spray Gun
23	47412	2	Adapter (nylon) 1/4" x 3/8"	54	736-0722	2	Lock Washer, #10
24	47413	1	Clamp, Conduit	55	27231	2	Spacer
25	65310	1	Spray Gun	56	46677	2	Screw, Phillips Hd. #10-24 x 3/8"
26	47416	1	Valve, Nylon 1/4"	57	46578	2	Spacer
27	41486	11	Clamp, 3/8" (Schedule-E)	58	48719	1	Drain Cap
28	47415	1	Tee, Nylon 1/4" NPT.	59	43182	8	Hex Bolt, 5/16-18 x 3/4"
29	48296	2	Frame Tube	60	736-0231	4	Washer, 0.344 x 1.125 x .12"
30	24860	2	Hitch Arm	61	41612	1	Owners Manual
31	23014	2	Hitch Bracket				

# **CRAFTSMAN®**

**Product questions or problems?**

## **1-888-331-4569**

### **Customer Care Hot Line**

**Get answers to questions, troubleshoot problems,  
order parts, or schedule repair service.**

Para respuestas a preguntas o problemas, y ordenar  
piezas o pedir servicio para la reparación de su equipo.

**To help us help you, register your product at [www.craftsman.com/registration](http://www.craftsman.com/registration)**

Para poderte ayudar mejor, registra tu producto en [www.craftsman.com/registration](http://www.craftsman.com/registration)

---

**Join the Craftsman Club today!**

## **CRAFTSMAN® CLUB**

**[www.craftsman.com/signup](http://www.craftsman.com/signup)**

**Receive exclusive member benefits including special pricing and offers,  
project sharing, expert advice, and SHOP YOUR WAY REWARDS!**

Como miembro exclusivo, recibe diversos beneficios como ofertas, precios especiales, proyectos nuevos, consejos de expertos y nuestro programa de puntos SHOP YOUR WAY REWARDS!