

# ABOVE GROUND RING QUICK SET® SWIMMING POOL OWNER'S MANUAL

To order parts, accessories, or answers to frequently asked questions about your product please visit [WWW.POLYGROUPSTORE.COM](http://WWW.POLYGROUPSTORE.COM)

Customer Service: (888) 919-0070

To watch how to setup your product please visit:  
[WWW.POLYGROUP.COM/VIDEO](http://WWW.POLYGROUP.COM/VIDEO)

**DO NOT RETURN PRODUCT TO STORE**

DISTRIBUTED BY: POLYGROUP LIMITED (MCO)  
Avenida Xian Xing Hai, Centro Golden Dragon, 11 Andar M, Macau



## For Quick Set® Pool of all Sizes and Depths.

Check out our  
**ONLINE SET UP VIDEO!**  
[www.polygroup.com/video/quickset](http://www.polygroup.com/video/quickset)

SAFETY INFORMATION	2
CONSUMER AWARENESS BOOKLETS	3
1. SITE PREPARATION	4
2. POOL INSTALLATION	4
3. DISASSEMBLY AND STORAGE	5
POOL COVER SAFETY	6

**WARNING:** DO NOT overfill the pool and / or allow people to lay over or sit on pool wall - DOING SO CAN CAUSE PERMANENT INJURY!  
DRAIN pool to the proper level after a heavy rain.

**NOTE:** DO NOT attempt to assemble this pool in adverse weather conditions, windy conditions or when the temperature is below 60°F.

**NOTE:** This is a storable pool, which should be disassembled and stored when temperatures are expected to fall below 32°F.

Should you encounter a problem with your Polygroup Product, please do not return the product to the place of purchase. All Warranty claims must be made directly to Polygroup. Prior to contacting Customer Service, please first review the Troubleshooting Guide in the Installation Manual, or review the FAQ at [www.polygroup.com](http://www.polygroup.com). Please review setup instruction videos on [www.polygroup.com/video](http://www.polygroup.com/video). If you are still unable to correct the problem, please contact Polygroup customer service at (888) 919-0070. Have the product type and your purchase receipt ready. Our Customer Service Representative will assist you in resolving the problem. You may be asked to return all or part of the product for inspection and/or repair. Do not return any product to Polygroup without a Return Authorization number.

084-120376 - 2014 **1**

## Read and Follow All Safety Information and Instructions. Keep for Future Reference.

Failure to follow these warnings and instructions can result in serious injury or death to user, especially children.



<b>! DANGER</b>
<b>PREVENT DROWNING</b> Watch children at all times. Observe all Safety Rules.
<b>NO DIVING! NO JUMPING!</b> Shallow Water - You can be permanently injured.

<b>! WARNING</b>
<b>DO NOT SIT ON OR LAY OVER POOL WALL</b> You can be permanently injured
<b>Avoid ENTRAPMENT</b> Stay away from suction fittings - You may drown

1. Children, especially children younger than five years, are at high risk of drowning. Drowning occurs silently and quickly and can occur in as little as 2 in. (5 cm) of water.
2. Keep children in your direct sight, stay close, and actively supervise them when they are in or near this pool and when you are filling and emptying this pool.
3. When searching for a missing child, check the pool first, even if the child is thought to be in the house.
4. Very Important: Swimming pool barriers, which restrict access to the pool by small children, may be required by law. A barrier is necessary to provide protection against potential drowning and near drowning. Barriers are not a substitute for constant supervision of children. Check state or local laws and codes before setting up pool.
5. The use of artificial pool lighting is at the discretion of the pool owner. Lighting, when installed, should be in accordance with Article 680 of the National Electrical Code (NEC) or its latest approved edition and in consultation with a licensed electrical professional.
6. During nighttime pool use, artificial lighting shall be used to illuminate all safety signs, ladders, steps, deck surfaces and walks.
7. The floor of the pool shall be visible at all times from the outside perimeter of the pool.
8. Local building codes may require obtaining a building or electrical permit. Installer shall follow regulations on setback, barriers, devices and other conditions.
9. Post a list of emergency telephone numbers such as the nearest available police, fire, ambulance and/or rescue unit. These numbers are to be kept near the telephone, which is closest to the pool.
10. Toys, chairs, tables or similar objects that a young child could climb shall be at least four feet (4') [121.92 cm] from the pool. The pump filter system shall be positioned so as to prevent it being used as a means of access to the pool by young children. Do not leave toys inside pool when finished using, since toys and similar items might attract a child to the pool.
11. Basic lifesaving equipment, including one of the following should be on hand at all times:
  - \* A light, strong, rigid pole (shepherds crook) not less than twelve feet (12') [365.76 cm] long.
  - \* A minimum one-fourth inch (1/4") [6.35 mm] diameter rope as long as one and one half (1-1/2) times the maximum width of the pool or fifty feet (50') [15.24 meters], whichever is less, which has been firmly attached to a Coast Guard-approved ring buoy having an outside diameter of approximately fifteen inches (15") [38.1cm], or similarly approved flotation device.
12. **Entrapment Avoidance:** There shall be no protrusions or other obstruction in the swimming area, which may cause entrapment or entanglement of the user. If a suction outlet cover is missing or broken, do not use the pool. Suction can cause body part entrapment, hair and jewelry entanglement, evisceration, or drowning. Repair or replace the suction outlet cover before allowing the pool to be used.

- 13.The pool is subject to wear and deterioration. If not maintained properly, certain types of excessive or accelerated deterioration can lead to failure of the pool structure that might release large quanti ties of water that could cause bodily harm and property damage.
- 14.Above ground / onground residential swimming pools are for swimming and wading only. No diving boards, slides or other equipment are to be added to an above ground / onground pool that in any way indicates that an above ground / onground pool may be used or intended for diving or sliding purposes.
- 15.Never allow horseplay, diving or jumping into or around the pool. Serious injury, paralysis or death, could result when this rule is disregarded. DO NOT ALLOW anyone to swim alone without supervi- sion.
- 16.Safety signs shall comply with requirements of ANSI-Z535 and to use signal wording.
- 17.The pool is to be assembled by an adult; care should be taken in the unpacking and assembly of the pool, this pool may contain accessible potentially hazardous sharp edges or sharp points that are a necessary part of the function of the pool.
- 18.Become certified in cardiopulmonary resuscitation (CPR). In the event of an emergency, immediate use of CPR can make a lifesaving difference.
- 19.Keep all electrical lines, radios, speakers and other electrical appliances away from the pool.
- 20.Do not place pool near or under overhead electrical lines.
- 21.Remove pool ladders before leaving the pool. Children as young as 2 years have climbed up ladders and into pools and drowned.

**NOTICE:** CUSTOMERS THAT PURCHASE POOLS MAY BE REQUIRED BY LOCAL OR STATE LAW TO INCUR ADDITIONAL EXPENSES WHEN INSTALLING A POOL, IN ORDER TO COMPLY WITH STATE OR LOCAL LAWS REGARDING FENCING AND OTHER SAFETY REQUIREMENTS. CUSTOMERS SHOULD CON- TACT THEIR LOCAL BUILDING CODE ENFORCEMENT OFFICE FOR FURTHER DETAILS.

CONSUMER AWARENESS BOOKLETS

Contact: U.S. Consumer Product Safety Commission at [www.CPSC.gov/cpsc/pub/pubs/pool/pdf](http://www.CPSC.gov/cpsc/pub/pubs/pool/pdf), Pub. #362 "Safety Barrier Guidelines for Home Pools".  
Contact: ASSOCIATION OF POOL & SPA PROFESSIONALS ( formerly NSPI) at - [www.apsp.org/164/index.aspx](http://www.apsp.org/164/index.aspx)  
These titles are now available: "The Sensible Way To Enjoy Your Aboveground / Inground Swimming Pool", "Children Aren't Waterproof", "Pool and Spa Emergency Procedures For Infants', Layers of Protection", and the "ANSI / NSPI-8 Model Barrier Code for Residential Swimming Pools, Spas, and Hot Tubs".

DANGER:

Competent supervision and knowledge of the safety requirements is the only way to prevent drowning or permanent injury in the use of this product!  
Never leave young children unattended.

DANGER: POOL SET-UP

Do not attempt to assemble this pool in adverse weather conditions, such as in high winds, strong gusts or when the temperature is below 60°F.

RING POOL SETUP INSTRUCTION SHEET

1 SITE PREPARATION

WARNING - VERY IMPORTANT! SITE MUST BE LEVEL, STABLE, COMPACTED SOIL.

- The pool must be assembled on a smooth and level site of firm soil that is free of stones, gravel, sticks, black- top or other oil base compounds. Do not install pool on a wooden deck or any type of wooden surface. You can not use sand and/or uncompacted soil to provide a level surface for this pool; it will only wash out.
- **FAILURE TO FOLLOW THE INSTRUCTIONS BELOW WILL CAUSE POOL TO COLLAPSE AND WILL VOID THE WARRANTY!**

- A. Select a level area, and completely remove all debris, twigs, stones, etc. DO NOT select an area under overhead electrical lines, trees or within 15 feet of a house, building, etc.
- B. The pool shall be located a minimum distance of 6 ft (1.83 m) from any electrical receptacle.
- C. All 125 volt, 15 and 20 ampere receptacles located within 20 ft (6.0 m) of the pool shall be protected by a ground fault circuit interrupter (GFCI). The 20 ft (6 m) distance is measured via the shortest straight line distance the supply cord would follow without piercing a floor, wall, ceiling, doorway, window, or other permanent barrier.
- D. Contact your local utilities, checking that no underground cables, telephone lines, gas lines, etc. run beneath the area you have selected.

2 POOL INSTALLATION

**WARNING: DO NOT** overfill the pool and / or allow people to lay over or sit on pool wall doing so can cause permanent injury. **DRAIN** pool to the proper level after a heavy rain.  
**TIP:** It will be much easier to install your pool if you unfold it and let it lay in direct sunlight for about 2 hours prior to installation. This will help to insure a wrinkle-free fit because the pool material will be more pliable allowing it to stretch into shape during installation.

- A. Carefully unfold the Quick Set® pool and inspect seams for manufacturing defects. With the inflatable ring on the top side, lay out the pool in the area selected, making sure the bottom of the pool is both flat and round. If your pool included or you are going to purchase a filter/pump system, position the intake/ outlet fitting locations so they are 10 to 21 feet from the electrical outlet you plan to use for the pool pump.
- B. Inflate the top ring. Squeeze the base of the valve stem to open an internal check valve while inflating.
- C. If your pool included a filter/pump system, following the instructions under "Power Filter Installation" in the "Swimming Pool Filter System" owner's manual, install Pool Wall Fittings as described in Steps "A" - "C". Plug the return fitting (25) with the Return Fitting Plug (21). Install the Suction Fitting Cap (20) on the Suction Fitting (16). Make sure the drain fitting is plugged securely and the cap is in place. Start filling the pool with water.  
**NOTE: AFTER ABOUT 1- INCH OF WATER IS ON THE BOTTOM, STOP FILLING AND SMOOTH WRINKLES OUT OF THE BOTTOM OF THE POOL WORKING THEM FROM THE CENTER OUTWARD. BE SURE FLOOR OF POOL IS ROUND AND FLAT.** Next pull the outer wall out from under the top ring, all around the bottom of the pool, so that it fills evenly.  
**NOTE: IF MORE THAN 1-2 INCHES OF WATER COLLECTS ON ANY ONE SIDE BEFORE THE POOL STARTS FILLING IN THE CENTER, THE POOL IS NOT LEVEL ENOUGH, AND MUST BE CORRECTED, SEE "SITE PREPARATION", ABOVE.**
- D. **NOTE: THE WEIGHT OF THE WATER WILL PREVENT ADJUSTMENT AFTER THIS POINT.**
- E. Now, as you continue filling, the inflated ring will rise as the water deepens. Max. Water Level is the bottom seam of the inflatable ring; this information is printed on the ring. Once this is done, refer back to the "Swimming Pool Filter System" owner's manual, and continue from Step "D" on through the rest of the installation if you have a filter/pump system.

IF YOUR POOL INCLUDED A FILTER/PUMP SYSTEM, REFER TO FILTER SYSTEM OWNER'S MANUAL SECTION  
**IN THE SWIMMING POOL FILTER SYSTEM OWNER'S MANUAL, INSTALL POWER FILTER AND THE POOL WALL FITTINGS AS DESCRIBED**



3 DISASSEMBLY AND STORAGE

- GENERAL INFORMATION:** Pool must be stored if temperatures are expected to fall below 32°F.
- A. All parts should be cleaned with a mild soap and lukewarm water only - DO NOT use detergent or hot water.
  - B. Make sure all parts are dry before storing to help prevent mildew from forming.
  - C. Store all parts in a dry heated area where temperatures do not go below 32° F or above 125° F.
  - D. Failure to follow the proper storage instructions could cause damage to pool parts and void warranty.
  - E. YOU MUST FOLLOW THE ASSEMBLY INSTRUCTIONS TO REASSEMBLE YOUR POOL NEXT SEASON. Pool site must be cleared and leveled again before setting up your pool.

**QUICK-SET® POOL:**

- A. To drain the pool, locate the drain plug on the outside of the pool wall and remove the drain cap. A standard garden hose will thread onto the drain fitting. Extend the hose to the area where the water is to be drained. When you have placed the garden hose where desired, the drain plug on the inside of the pool can be opened.
- B. Once you have drained as much water as possible out of the pool, using the hose connected to the drain fitting, open the air valve and deflate the top ring. Then, carefully push the sides of the pool wall down to allow remaining water to run out.
- C. Remove any remaining water as you wash and completely dry pool using a soft cotton cloth. Push the drain plug into the fitting and replace the cap.
- D. Frame Pools: If your pool has metal frame work, disassemble those pieces by depressing the plastic buttons sliding those pieces apart or by removing the plastic pins holding them together again sliding those pieces apart, clean them and wipe them dry. If in doubt of proper disassembly refer to the pools set-up sheet and reverse those steps. Place them all together in a safe storage place for reassembly next season. Order replacement parts for any damaged, broken, or worn parts.
- E. Solar blankets, leaf covers, ladders, etc., should be cleaned and dried before storing.

**LIMITED WARRANTY**

Polygroup Limited (Macao Commercial Offshore), (hereinafter “Polygroup”) warrants to the original purchaser only, the Quickset® Above Ground Pool (liner) against defects in material and workmanship for 90 days from the date of purchase. Original Purchaser must retain proof of such purchase in the form of an original store sales receipt and must produce such upon request by Polygroup or its designated agents. Warranty claims cannot be processed without a valid proof of purchase.

This Limited Warranty applies only to the original purchaser of the product and is limited solely to the repair or replacement of the product, to be decided in Polygroup’s sole discretion. Consequential damages, including claims for loss of water, pool chemicals, damage, or labor are not covered under this Limited Warranty.

This Warranty will be declared invalid should the Purchaser modify or repair the product themselves or by unauthorized persons; use non-Polygroup parts or accessories with the product; use the product in contravention of the Manufacturers Instructions; use improper voltage; abuse the product in any way; or through accident or negligence. Normal wear-and-tear is not covered under this Warranty, nor are acts of God outside the control of Polygroup.

IN NO EVENT SHALL POLYGROUP, THEIR AUTHORIZED AGENTS, RELATED ENTITIES, OR EMPLOYEES BE LIABLE TO THE BUYER OR ANY OTHER PARTY FOR DIRECT OR CONSEQUENTIAL DAMAGES. Some states or countries, or others jurisdictions do not allow the exclusion or limitation of incidental or consequential damages, so the above limitation or exclusion may not apply to you.

POOL COVER SAFETY

IF YOU ARE GOING TO USE A POOL COVER, SOLAR COVER OR SOLAR BLANKET, PLEASE READ THIS INFORMATION.

POOL COVER WARNING  
SOLAR COVER WARNING



# WARNING

## AVOID DROWNING RISK

STAY OFF COVER - WILL NOT SUPPORT WEIGHT.  
KEEP CHILDREN AWAY. CHILDREN OR OBJECTS CAN NOT BE SEEN UNDER COVER.  
REMOVE STANDING WATER - CHILD CAN DROWN ON TOP OF COVER.  
REMOVE COVER COMPLETELY BEFORE ENTRY OF BATHERS - ENTRAPMENT POSSIBLE.  
NON-SECURED OR IMPROPERLY SECURED COVERS ARE A HAZARD.  
FAILURE TO FOLLOW ALL INSTRUCTIONS MAY RESULT IN INJURY OR DROWNING.  
THIS IS NOT A SAFETY COVER.  
TYPE OC COVER CLASSIFICATION.  
INSTALL COVER WITH LABELS FACING UP.  
USE DRAWSTRING TO SECURE COVER TO POOL.  
THIS COVER MEETS REQUIREMENTS DESCRIBED IN SPECIFICATION F-1346 (ASTM).

SOLAR BLANKET WARNING



# WARNING

## AVOID DROWNING RISK

STAY OFF COVER - WILL NOT SUPPORT WEIGHT.  
KEEP CHILDREN AWAY. CHILDREN OR OBJECTS CAN NOT BE SEEN UNDER COVER.  
REMOVE STANDING WATER - CHILD CAN DROWN ON TOP OF COVER.  
REMOVE COVER COMPLETELY BEFORE ENTRY OF BATHERS - ENTRAPMENT POSSIBLE.  
NON-SECURED OR IMPROPERLY SECURED COVERS ARE A HAZARD.  
FAILURE TO FOLLOW ALL INSTRUCTIONS MAY RESULT IN INJURY OR DROWNING.  
THIS IS NOT A SAFETY COVER.  
TYPE OC COVER CLASSIFICATION.  
INSTALL COVER WITH LABELS FACING UP.  
LAY COVER ON TOP SURFACE OF WATER.  
THIS COVER MEETS REQUIREMENTS DESCRIBED IN SPECIFICATION F-1346 (ASTM).

VERY IMPORTANT

DO NOT USE A POOL COVER, SOLAR COVER OR SOLAR BLANKET ON THIS POOL IF IT DOES NOT HAVE THIS TYPE OF WARNING LABEL ON THE COVER.

DANGER

Competent supervision and knowledge of the safety requirements is the only way to prevent drowning or permanent injury in the use of this product!  
Never leave young children unattended.

# RP TYPE SWIMMING POOL FILTER SYSTEM OWNER'S MANUAL FOR ABOVE GROUND SWIMMING POOLS

To order parts, accessories, or answers to frequently asked questions about your product please visit [WWW.POLYGROUPSTORE.COM](http://WWW.POLYGROUPSTORE.COM)

Customer Service: (888) 919-0070

To watch how to setup your product please visit:  
[WWW.POLYGROUP.COM/VIDEO](http://WWW.POLYGROUP.COM/VIDEO)

**DO NOT RETURN PRODUCT TO STORE**

DISTRIBUTED BY: POLYGROUP LIMITED (MCO)

Avenida Xian Xing Hai, Centro Golden Dragon, 11 Andar M, Macau

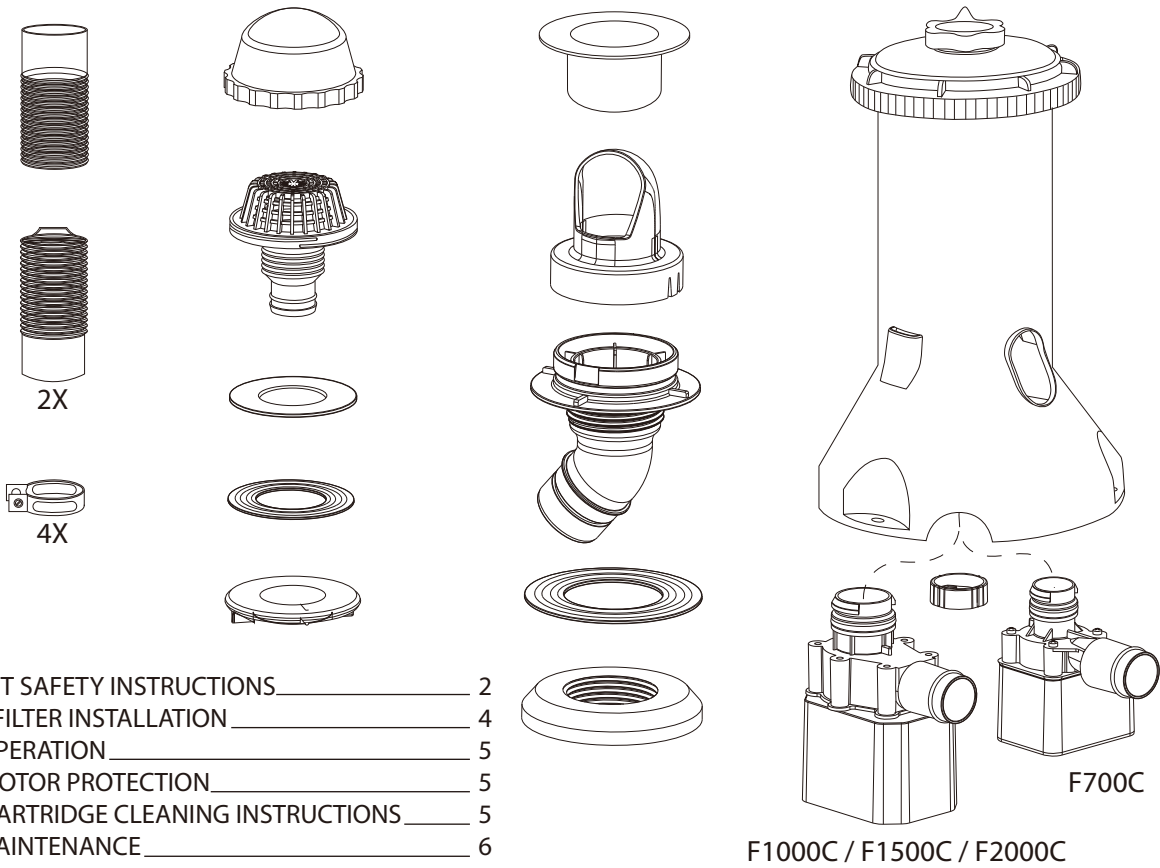

F1000C / F1500C / F2000C

F700C

IMPORTANT SAFETY INSTRUCTIONS	2
1. POWER FILTER INSTALLATION	4
2. PUMP OPERATION	5
3. PUMP MOTOR PROTECTION	5
4. FILTER CARTRIDGE CLEANING INSTRUCTIONS	5
5. POOL MAINTENANCE	6
6. POOL WATER CARE	6
7. TROUBLE SHOOTING GUIDE	7
8. POWER FILTER DISASSEMBLY AND STORAGE	8
PARTS LIST	9
ASME COMPLIANT SUCTION FITTING INFO	10

Should you encounter a problem with your Polygroup Product, please do not return the product to the place of purchase. All Warranty claims must be made directly to Polygroup. Prior to contacting Customer Service, please first review the Troubleshooting Guide in the Installation Manual, or review the FAQ at [www.polygroup.com](http://www.polygroup.com). Please review setup instruction videos on [www.polygroup.com/video](http://www.polygroup.com/video). If you are still unable to correct the problem, please contact Polygroup customer service at (888) 919-0070. Have the product type and your purchase receipt ready. Our Customer Service Representative will assist you in resolving the problem. You may be asked to return all or part of the product for inspection and/or repair. Do not return any product to Polygroup without a Return Authorization number.

## IMPORTANT SAFETY INSTRUCTIONS

When installing and using this electrical equipment, basic safety precautions should always be followed, including the following:

### READ AND FOLLOW ALL INSTRUCTIONS



**WARNING** - To reduce the risk of injury, do not permit children to use this product unless they are closely supervised at all times.  
**WARNING** - Risk of Electric Shock. Connect only to a grounding type receptacle. This product is provided with a ground-fault circuit-interrupter. If replacement of the plug or cord is needed, use only identical replacement parts.  
**WARNING** - To reduce the risk of electric shock, replace damaged cord immediately.  
**WARNING** - To reduce the risk of electric shock, do not use extension cord to connect unit to electric supply; provide a properly located outlet.



**CAUTION** - To reduce the risk of electric shock the pool must be installed no closer than 6 feet (1.8 m) from any electrical outlet. Do not place portable appliances closer than 5 feet (1.5 m) from the pool.  
**CAUTION** - This pump is for use with storable pools only. Do not use with permanently-installed pools. A storable pool is constructed so that it is capable of being readily disassembled for storage and reassembled to its original integrity. A permanently-installed pool is constructed in or on the ground or in a building such that it cannot be readily disassembled for storage.

Do not bury cord. Locate cord to minimize abuse from lawn mowers, hedge trimmers, and other equipment.

The unit is provided with a ground-fault circuit-interrupter (GFCI). To test the GFCI, push the test button. The GFCI should interrupt power. Push the reset button. Power should be restored. If the GFCI fails to operate in this manner, the GFCI is defective. If the GFCI interrupts power to the pump without the test button being pushed, a ground current is flowing, indicating the possibility of an electric shock. Do not use this pump. Disconnect the pump and have the problem corrected by a qualified service representative before using.

## SAVE THESE INSTRUCTIONS

### PRELIMINARY STEPS

1. **READ ALL INSTRUCTIONS CAREFULLY** and get a thorough understanding of what is required to assemble your Type RP Power Filter.
2. Before you begin to assemble the pool, identify, count, and check all parts needed for assembly.
3. It is recommended that you have some PETROLEUM JELLY on hand for lubricating the gaskets.

### POWER FILTER IMPORTANT NOTES:

1. Installer shall follow written instructions provided for operation of the circulation systems.
2. All electrical components shall be installed in accordance with Article 680 of the National Electrical Code (NEC) "Swimming Pools, Fountains and Similar Installations" or its latest approved edition.
3. The Filter Cartridge (15) 3-3/4" will hold as many as 2 of the 1" diameter chlorine tablets and the 8" will hold as many as 6 of the 1" diameter chlorine tablets. Check your chlorine levels to determine the proper number of chlorine tablets to add. The filter cartridge will automatically dispense chlorine into the pool as the pump runs. **You must have the type of Filter Cartridge (15) with a central core mesh divider (See page 3) to use the chlorine dispenser. DO NOT use this to dispense powdered chlorine, shock treatment or any other type of chemicals as damage to the pump, filter cartridge, and pool will occur.**
4. The RP Type pump/filter systems are manufactured by Polygroup and ETL control number 4000608 - double insulated and grounded - 115 V.A.C. - 60 Hz. (ALL Units must have a minimum of 105 V.A.C. to start and run properly.)



How to use the GFCI plug:

Press  
"RESET"  
Button  
To Start  
Pump  
Operation

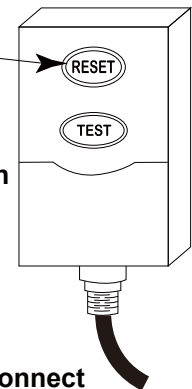

\*Do not connect  
to a timer device



Pump System	Wattage	Amperage
RP800 Filter System with F700C Pump	57 watts	1.1 amps
RP1000 Filter System with F1000C Pump	80 watts	2.2 amps
RP1000 Filter System with F1500C Pump	120 watts	2.2 amps
RP2000 Filter System with F2000C Pump	210 watts	2.2 amps

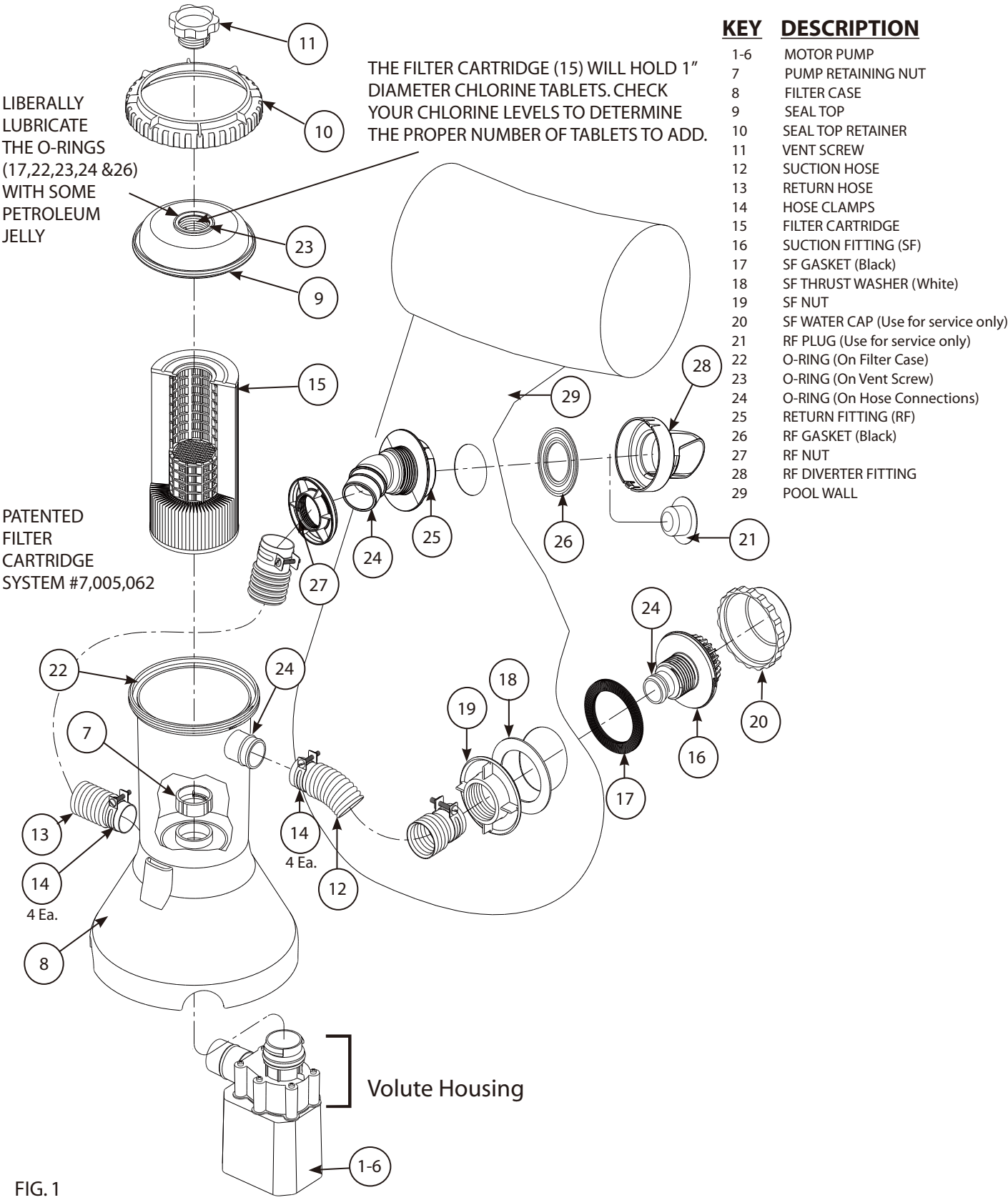

FIG. 1

Should you encounter any problems, contact the Customer Service at (888) 919-0070 from 8 AM to 5 PM Mon. thru Fri. EST. Extended operating days and hours during peak season requirements.

## 1 POWER FILTER INSTALLATION (Reference Page 3, Fig. 1)

A. First, remove the Seal Top Retainer (10), Seal Top (9), and Filter Cartridge (15) from the assembled Filter Case. Lubricate the pump O-ring with petroleum jelly. Hold the filter case (8) securely, and insert motor pump so that the outlet on the volute housing extends out of the opening in the side of the filter case. Insert the motor pump until the two ribs on the inlet of the volute housing protrude through the bottom of the filter case. Reach down inside the filter case and place the Pump Retaining Nut (7) over the top of the volute housing inlet. Twist the Nut (7) clockwise until it is snug. See Fig. 2.

B. Get the Suction and Return Hoses (12, 13), and remove two Hose Clamps (14), from the hardware bag. Loosen the hose clamps and slide them over one end of each hose. Lubricate O-rings (24) on the Filter Case (8) and Volute Housing liberally with petroleum jelly. Install one hose on the filter case suction inlet at the top, and one hose on the filter case return outlet at the base. Tighten both of the Hose Clamps (14).

C. Locate the Return Fitting assembly parts (21, 25-28). Lubricate the (black) RF Gasket (26) liberally with petroleum jelly and install it over the threads on the Return Fitting (25). Insert the Return Fitting (25) with the RF Gasket (26) through the pool return fitting hole in the wall from the inside of the pool, see Fig. 3 for correct location. Thread the RF Nut (27) onto the fitting until it is hand tight. DO NOT over tighten the RF Nut or the RF Gasket (26). Plug the pool's Return Fitting (25) with the RF Plug (21) from the inside of the pool. Set the RF Diverter Fitting (28) aside for later installation. Now locate the Pool Suction Fitting assembly parts (16-20). Lubricate the (black) SF Gasket (17) liberally with petroleum jelly and install it over the threads on the Suction Fitting (16). Insert the Suction Fitting (16) with SF Gasket (17) through the pool suction fitting hole in the wall from the inside of the pool. Place the (white) SF Thrust Washer (18) over the Suction Fitting and then thread the SF Nut (19) onto the fitting until it is hand tight. DO NOT over tighten the SF Nut or wrinkle the pool wall around the SF Thrust Washer (18) or the SF Gasket (17). Cap the pool's Suction Fitting (16) with the SF Water Cap (20). Only hand tighten the Water Cap (20). Start filling pool.

D. After the pool is filled, position the Filter Assembly between the two fittings on the side of the pool, about 6 inches out from the base. The suction hose (12), coming from the top of the filter case should be facing the right, and the return hose (13) coming from the pump, on the lower side of the case, should be facing the left; see Fig. 3.

E. Slip both of the remaining Hose Clamps (14) over the ends of the two hoses. Lubricate O-rings (24) on the wall fittings liberally with petroleum jelly then connect the hoses to the Suction and Return wall fittings located on the side of the pool. The Pool Suction Fitting is on the right, and the return fitting is on the left, see FIG. 3. Secure both of the hoses in place by tightening the two Hose Clamps (14).

F. Unscrew the Vent Screw (11) from the Seal Top (9) about 1-1/2 turns. NOTE: VENTING THE SYSTEM IS NECESSARY FOR AIR TO ESCAPE AS THE FILTER CASE FILLS WITH WATER.

G. Remove the RF Plug (21) from the return fitting (25) on the inside of the pool. Also remove the SF Water Cap (20) from the Suction Fitting (16). This allows the filter system to fill with water. DO NOT discard the RF Plug (21) and the SF Water Cap (20). You will need them when you change the Filter Cartridge or service the pump. When full, water should be coming out of the groove of the vent screw. Hand-tighten the vent screw into the seal top until the O-Ring seals around the screw and no more water is escaping.

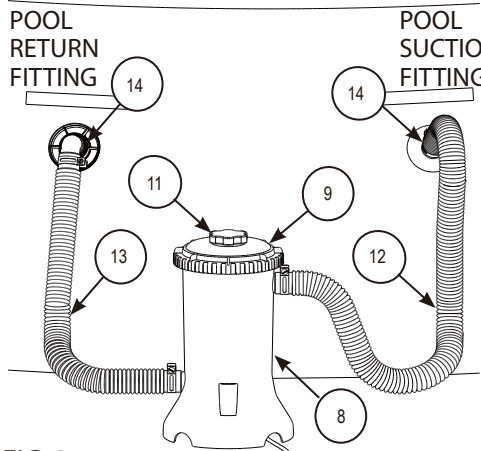
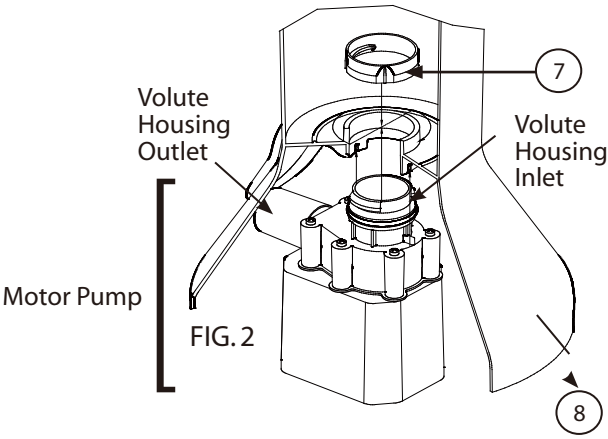

FIG. 3

Should you encounter any problems, contact the Customer Service at (888) 919-0070 from 8 AM to 5 PM Mon. thru Fri. EST. Extended operating days and hours during peak season requirements.

H. At this point, the filter system should be water-tight. Check all hoses and fittings, as well as the vent screw, to make sure there is no leakage. If any leaks are found, see #4 in Trouble Shooting guide on page 7. Now place the RF Diverter Fitting (28) on the Return Fitting (25).

2 PUMP OPERATION

IMPORTANT: PRESS “RESET” BUTTON ON THE GFCI PLUG TO START PUMP BEFORE USING.

IMPORTANT: FILTER CARTRIDGE MUST BE FIRMLY SEATED OVER THE PUMP INTAKE PORT TO FILTER THE POOL WATER EFFICIENTLY.

NOTE: ONLY FILTER CARTRIDGES WITH A 1-3/4” INCH DIAMETER HOLE WILL WORK PROPERLY. ANY OTHER SIZE HOLE WILL PREVENT PROPER FILTRATION. THE CARTRIDGE MUST SEAL TIGHTLY AROUND BOTH ENDS.

A. Plug the GFCI power cord of the filter assembly into a properly grounded receptacle, located at least 10 feet away from the pool.

B. Press the RESET Button to Start the Pump.

C. Check the return fitting on the inside of the pool for correct flow, it should feel like a solid stream of water returning to the pool. You can use the return flow as a gauge to determine when the filter needs cleaning and/or replacement. If you feel a reduction in flow, clean and/or replace filter.

D. Test water and adjust as needed, see “POOL WATER CARE”, page #6. **VERY IMPORTANT – PUMP AND FILTER ALONE WILL NOT PREVENT ALGAE FROM GROWING IN POOL WATER; THIS CAN ONLY BE DONE BY MAINTAINING PROPER CHLORINE AND pH LEVELS AT ALL TIMES!**

E. The filter may need to be cleaned and/or replaced several times at start up until the correct chlorine and pH levels are attained. We recommend that you keep at least one spare cartridge on hand at all times. Filter cartridges may be purchased at the store you purchased your pool from, or ordered from Polygroup.

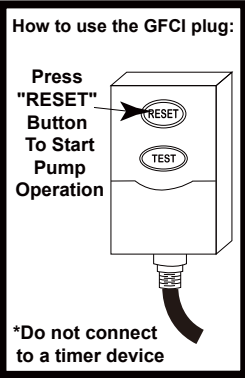

3 PUMP MOTOR PROTECTION

**IMPORTANT!** Your pump is protected by a thermal overload. This device senses the temperature of the pump and if it is getting too hot, it will open the electric circuit and the pump will stop running until it cools off. It will automatically turn back on when it has cooled down. This is a safety device to help prevent excessive pump damage. If your pump is automatically turning off, it is because of high pool water temperature and/or low water flow through the pump. If this happens you need to check water flow through the filter and correct it if needed as this pump uses the water flow for cooling. You may also want to run the pump at night when the temperature is lower.

4 FILTER CARTRIDGE CLEANING INSTRUCTIONS

A. First, unplug (turn off) the Power Filter, remove the RF Diverter (30) and plug the Return Fitting (25) with the RF Plug (21). Press the plug squarely into the opening, to assure a leak-proof fit. Now cap the Pool Suction Fitting (16) with the SF Water Cap (20), only hand tighten the Water Cap. To vent the filter, slowly unscrew the Vent Screw (11). Press down with both hands and twist the Seal Top Retainer (10) counter-clockwise to remove and then pull out the Seal Top (9) and Filter Cartridge (15). After you are finished cleaning the filter cartridge, liberally lubricate the O-Ring (22) with petroleum jelly and re-assemble in reverse order, be sure to remove the RF Plug (21) and Water Cap (20).

B. The filter cartridge can be cleansed of coarse dirt and debris by pressure washing inside and out with a garden hose, making sure to wash between all pleats. Fine particles of dirt are more easily removed from the filter pleats when the cartridge is dry. Therefore, after hosing the cartridge, allow the filter to dry and CAREFULLY BRUSH, but do not scrub the pleated surface areas. Cleaning and scrubbing a filter too vigorously will also wear out the cartridge much faster than if it is simply hosed off correctly.

C. Suntan oils, body oils, and algae can form a coating on the filter pleats which may not be thoroughly removed by hosing. Such films of oils and/or algae will rapidly clog up the filters’ pores, greatly reducing filtration. Therefore, it is imperative to remove such materials from the filter element as soon as possible. To remove oils, we recommend soaking the cartridge in a solution of **1 pound of trisodium phosphate** (or any other strong detergent) **to 5 gallons of water** for up to **12 hours**. Trisodium phosphate is available in many supermarkets, hardware stores, or janitorial supply stores. After the oils have been removed, rinse the filter cartridge to remove any dirt. If algae is a problem, add **1/2 pint of pool chlorine or 1 pint of liquid household bleach** to the cleaning solution, **1 hour** before removing the filter cartridge from the solution. Thoroughly rinse the filter cartridge before replacing it in the filter case. Check the pool chemistry to determine the cause of algae growth.

D. Excessive calcium and/or mineral deposits may build up on a filter cartridge and should be handled differently. Contact your local pool supply store to ask about additional filter cartridge cleaners or treatment for calcium or mineral deposits. Check pool chemistry for high pH or alkalinity; this may cause a calcium or mineral build-up. Now is a good time to remove the Vent Screw (11) and put chlorine tablets into the Filter (15) if necessary.

E. A spare “stand-by” Filter Cartridge is an excellent investment. It provides a convenient way to continue filtration of your pool while cleaning or replacing a dirty Filter Cartridge. Also, a well-maintained, clean cartridge assures you that your filter will always be ready to operate at peak efficiency.

5 POOL MAINTENANCE

- A. Check and adjust pH and chlorine levels daily using required chemicals. See “POOL WATER CARE”, below.
- B. Check filter output daily. If flow is reduced, see Symptom 2 in “TROUBLE SHOOTING GUIDE”, page #7.
- C. Check filter for leaks. If a leak is found, see Symptom 4 in “TROUBLE SHOOTING GUIDE”, page #7.
- D. Check seams in pool periodically. Minor repairs may be made with the patch kit (supplied with pool). Additional patches are available from Polygroup or your local pool supply store.

6 POOL WATER CARE

- A. The following items are required and readily available from your local pool supply store:
  - TEST KIT - Used to check chlorine and pH levels.
  - 1” CHLORINE TABLETS - Used to disinfect pool water and help control the growth of algae.
  - pH CONTROL CHEMICALS - Used to adjust pH levels Up (Soda Ash) or Down (Acid).
  - ALGAECIDES - Used to eliminate algae.
  - SUPERCHLORINATOR - Used to destroy combined chlorine, ammonia, nitrogen, and organic compounds.
  - LEAF NET with handle - Used to remove leaves, trash, insects, etc. from pool.
  - CHLORINE DISPENSER (Supplied with Filter) - Used to dispense 1” chlorine tablets ONLY.
- B. Use test kit daily to check pH and chlorine levels. Adjust accordingly using the required chemicals. **NOTE:** Excessive levels of chlorine or low pH levels will damage pool liner.
- C. The pool can be cleaned using a garden hose powered vacuum from Polygroup or a pool supply store.
- D. Using a foot bath near the pool to wash off your feet prior to entering the pool will assist in keeping the pool clean.
- E. Well water often presents special problems with water chemistry. If you must use well water, take a sample to your local pool chemical supplier for analysis before adding ANY chemicals.
- F. Use the gallons for your pool to calculate the amount of chemicals you will need to correct the pool water based on the gallons of water in your pool. **NOTE:** It is recommended to use a 5 gallon bucket of water to mix and dissolve your chemicals and then applying directly to the pool water. Follow manufacturers label directions on all chemicals.  
\*Most pool supply stores will test your pool water for free and advise you of what chemicals you need, and the correct amount to use for your pool. You will need to tell them the pool capacity in gallons.



G. **IMPORTANT** - We cannot over-stress the importance of proper and adequate daily chemical treatment. Chlorine and pH levels must be maintained at all times. **PUMP AND FILTER ALONE WILL NOT PREVENT ALGAE FROM GROWING IN POOL WATER; THIS CAN ONLY BE DONE BY MAINTAINING PROPER CHLORINE AND pH LEVELS AT ALL TIMES.**

- Maintain pH level between 7.3 and 7.8.
- Maintain chlorine level between 1.0 and 1.6 ppm (parts per million).
- Superchlorinate your pool at least every other week.

**NOTE:**

- A. Hot weather/heavy use may require pH and chlorine levels to be maintained on the upper side of the scale and superchlorination of the pool every week.
- B. Using a pool cover and/or solar cover will assist in maintaining your pH and chlorine levels by reducing the amount of evaporation from your pool.

**CAUTION**

- Concentrated chlorine levels and low pH levels will damage pool. You must follow the instructions for the pool chemicals you use, as to quantity and recommended usage.

**NEVER** drop lumps or pellets of chemicals in pool; this may present a hazard to swimmers and/or damage your liner.

**7 TROUBLE SHOOTING GUIDE**

DISCONNECT ELECTRICAL CORD BEFORE TROUBLESHOOTING FILTER

SYMPTOM	PROBLEM	POSSIBLE SOLUTION
1 Motor fails to start or kicks on and off.	<b>A</b> Unit Not Plugged In	<b>A</b> Unit must be plugged into a 3-wire grounded outlet.
	<b>B</b> GFCI Breaker Tripped	<b>B</b> Reset circuit breaker. If problem persists, have an electrician check circuit.
	<b>C</b> Low Voltage	<b>C</b> Check line voltage - must be 105 to 125 AC volts.
2 No flow or low flow through return hose	<b>A</b> Low Water Level	<b>A</b> Water depth must be no more than 2” from the bottom of inflatable ring or it must cover the intake by at least 4”.
	<b>B</b> Inlet / Discharge Clogged	<b>B</b> Check for obstructions at suction fitting and in return hose.
	<b>C</b> Filter Dirty	<b>C</b> Clean (see page #5) or replace cartridge. Spare cartridges make service more convenient.
	<b>A</b> Chlorine Level	<b>A</b> Maintain chlorine level between 1.0 and 1.6 ppm
	<b>B</b> Filter Dirty	<b>B</b> Clean (see page #5) or replace cartridge. Spare cartridges make service more convenient.
3 Filter is not cleaning pool (water cloudy, green, etc.)	<b>C</b> pH Level	<b>C</b> Maintain pH Level between 7.3 and 7.8.
	<b>D</b> Cartridge Damaged	<b>D</b> Check cartridge for damage and/or holes. Replace if damaged.
	<b>E</b> Low Water Flow	<b>E</b> Check for obstructions at suction fitting and in return hose fitting.
	<b>F</b> Other Chemicals Required	<b>F</b> Have water tested at pool supply store. It may be necessary to add other chemicals due to varying water quality in different localities.
	<b>G</b> Pool Water Very Dirty	<b>G</b> Run pump more often, but never when pool is in use. Clean filter more often.
	<b>A</b> Suction Hose / Return Hose	<b>A</b> Adjust hose clamp (14) on cuff. Check O-ring (24) and retighten. Check hose for any holes or cracks. Replace if needed. See page #3.
	<b>B</b> Vent Screw in Seal Top	<b>B</b> Check O-ring (23) for damage. Replace if needed. Lubricate with petroleum jelly.
4 Water Leakage	<b>C</b> Seal Top Retainer/Seal Top	<b>C</b> Check O-ring (22) for damage. Replace if needed. Lubricate with petroleum jelly.
	<b>D</b> Pump to Volute Housing	<b>D</b> Tighten screws.
	<b>E</b> Volute Housing to Filter	<b>E</b> Check Volute Housing O-Ring for damage.
	PROBLEMS: Should you encounter any problems, contact the Customer Service at (888) 919-0070. Extended operating days and hours during peak season requirements.	

**8 POWER FILTER DISASSEMBLY AND STORAGE**

- A. First, unplug the Power Filter. Now remove the RF Diverter Fitting (28) from the Return Fitting (RF) and then plug the Return Fitting (25) with the RF Plug (21). Now thread the Water Cap (20) onto the Suction Fitting (16) and hand tighten it only!
- B. Slowly unscrew the Vent Screw (11) from the Seal Top (9) allowing the filter system to depressurize.
- C. Remove the Seal Top Retainer (10) by turning counter-clockwise to unscrew. Remove the Seal Top (9). Remove the Filter Cartridge (15) and remove any chlorine tablets left inside the core section of the filter.
- D. Loosen all four Hose Clamps (14), remove the Suction and Return Hoses (12, 13) and allow water to drain out.
- E. Clean and dry all filter pump parts including filter cartridges.
- F. Liberally lubricate the O-rings (22), at the Seal Top (9) and (23) on the Vent Screw (11), with petroleum jelly, and then reassemble it along with the Seal Top (9), Seal Top Retainer (10), Vent Screw (11) onto the Filter Case (8). Store all filter parts carefully.

**LIMITED WARRANTY**

Polygroup Limited (Macao Commercial Offshore), (hereinafter “Polygroup”) warrants to the original purchaser only, the RP type Electric Filter Pump against defects in material and workmanship for 180 days from the date of purchase. Original Purchaser must retain proof of such purchase in the form of an original store sales receipt and must produce such upon request by Polygroup or its designated agents. Warranty claims cannot be processed without a valid proof of purchase.

This Limited Warranty applies only to the original purchaser of the product and is limited solely to the repair or replacement of the product, to be decided in Polygroup's sole discretion. Consequential damages, including claims for loss of water, pool chemicals, damage, or labor are not covered under this Limited Warranty.

This Warranty will be declared invalid should the Purchaser modify or repair the product themselves or by unauthorized persons; use non-Polygroup parts or accessories with the product; use the product in contravention of the Manufacturers Instructions; use improper voltage; abuse the product in any way; or through accident or negligence. Normal wear-and-tear is not covered under this Warranty, nor are acts of God outside the control of Polygroup.

IN NO EVENT SHALL POLYGROUP, THEIR AUTHORIZED AGENTS, RELATED ENTITIES, OR EMPLOYEES BE LIABLE TO THE BUYER OR ANY OTHER PARTY FOR DIRECT OR CONSEQUENTIAL DAMAGES. Some states or countries, or others jurisdictions do not allow the exclusion or limitation of incidental or consequential damages, so the above limitation or exclusion may not apply to you.

ASME COMPLIANT SUCTION FITTING INFO  
PSF-100A AND PSF-100B SUCTION OUTLET  
FOR ABOVE GROUND POOL

IMPORTANT SAFETY INSTRUCTIONS

(1) READ AND FOLLOW ALL INSTRUCTIONS

- (1) PSF-100A and PSF-100B Suction Outlets are certified by IAPMO in accordance with the ASME/ANSI A112.19.8b-2009 Suction Fitting for use in Swimming Pools, Wading Pools, Spas, and Hot Tubs.
- (2) This is a submerged suction outlet for use with above ground swimming pool.
- (3) For single drain only. Use only ONE outlet for each pump.
- (4) Do not locate this suction outlet on sitting areas or on the backrest for such seating area.
- (5) Install this outlet at location recommended by the pool manufacturer.
- (6) The maximum allowable flow rate of this suction outlet is 45 gallon per minute (2,700 gallonper hour).
- (7) Connection Hose:
- Model PSF-100-A is to be connected with 1 1/4" (31.8mm) diameter hose.
  - Model PSF-100-B is to be connected with 1 1/2" (38.1mm) diameter hose.
- (8) The suction outlet is to be mounted at the suction outlet opening as specified by the manufacturer of the above ground pool. The diameter of this opening should be within the range of 1.77" to 1.85" (45.0mm to 47.0mm). Refer to the following diagram for detail assembly instructions:

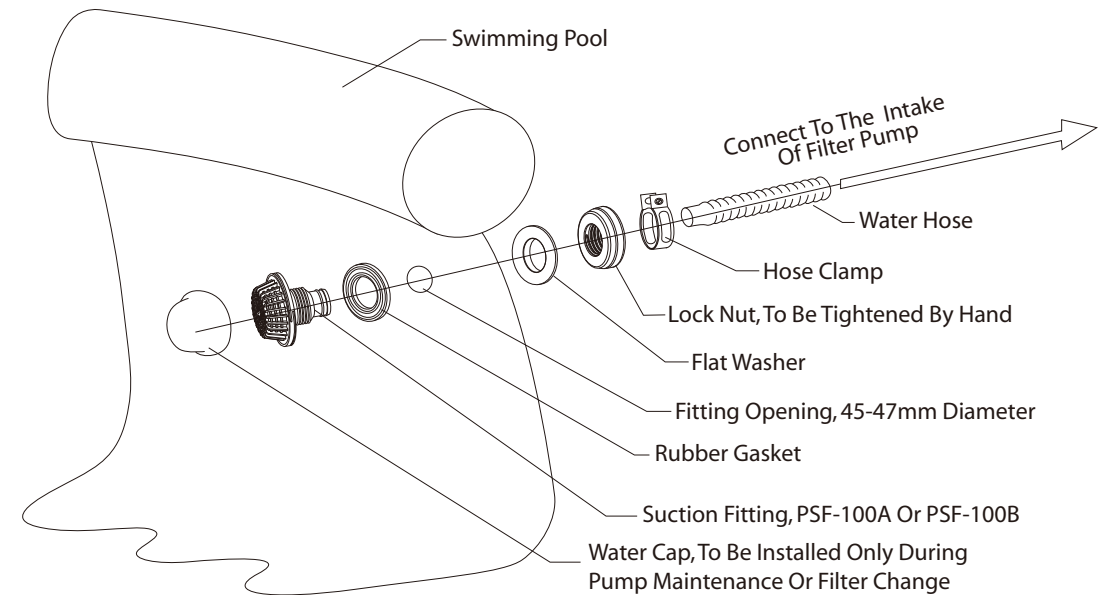

- (9) The suction outlet PSF-100A or PSF-100B is to be replace every 5 years.
- (10) No tool is required for installation.
- (11) Service and Winterizing Instructions

CAUTION! DO NOT EXCEED THE MAXIMUM ALLOWABLE FLOW RATE:

- 45 Gallon per minute (2,700 Gallon per hour).
- Carefully observe and inspect the suction outlet for damage and tampering before each use of the pool.
- Missing, broken or cracked suction outlet must be replaced before using the pool.
- Loose suction fitting should be reattached or replaced before using the pool.
- Remove and store Suction Outlet assembly if temperatures are expected to fall below 32° F.

READ, THEN KEEP THESE INSTRUCTIONS FOR FUTURE REFERENCE

PART LIST

Key#	Description	RP800/F700C	RP1000/F1000C	RP1000/F1500C	RP2000/F2000C	Qty.
		Part #				
1	Pump Body With Cord & GFCI	096-050406	096-050504	096-050504	096-050564	X1
2	Rotor Assembly	096-110003	096-050505	096-050598	096-050565	X1
3	Pump Gasket	078-110031	078-110078	078-110078	078-110078	X1
4	Volute Housing	078-110189	078-110097	078-110097	078-110147	X1
5	O-Ring (On Volute Housing)	090-130012	090-130012	090-130012	090-130025	X1
6	Phillips Head Screw (6 EA)	090-010063	090-010063	090-010063	090-010063	X1
*	Assembled Pump #1 THRU #6	096-050610	096-050609	096-050608	096-050607	X1
7	Pump Retaining Nut	078-110143	078-110143	078-110143	078-110143	X1
8	Filter Case	078-110100	078-110114	078-110114	078-110139	X1
9	Seal Top	078-110101	078-110101	078-110101	078-110140	X1
10	Seal Top Retainer	078-110102	078-110102	078-110102	078-110102	X1
11	Vent Screw	078-110103	078-110103	078-110103	078-110103	X1
12	Suction Hose 3 FT.	063-060010	063-060010	063-060010	063-060010	X1
13	Return Hose 3 FT.	063-060010	063-060010	063-060010	063-060010	X1
14	Hose Clamp	090-160005	090-160005	059910-250450-00PR01-1	059910-250450-00PR01-1	X4
15	8" Filter Cartridge	R-P52-0002	R-P52-0002	R-P52-0002	R-P52-0002	X1
16	Suction Fitting (SF)	078-110284	078-110284	078-110284	078-110284	X1
17	SF Gasket (Black)	078-110123	078-110123	078-110123	078-110123	X1
18	SF Thrust Washer (White)	078-110124	078-110124	078-110124	078-110124	X1
19	SF Nut	078-110125	078-110125	078-110125	078-110125	X1
20	SF Water Cap	078-110282	078-110282	078-110282	078-110282	X1
21	RF Plug	078-110126	078-110126	078-110126	078-110126	X1
22	O-Ring (On Filter Case)	090-130022	090-130022	090-130022	090-130022	X1
23	O-Ring (On Vent Screw)	090-130021	090-130021	090-130021	090-130021	X1
24	O-Ring (On Hose Connection)	090-130030	090-130030	090-130030	090-130030	X4
25	Return Fitting (RF)	078-201401	078-201401	078-201401	078-201401	X1
26	RF Gasket (Black)	078-201402	078-201402	078-201402	078-201402	X1
27	RF Nut	090-201401	090-201401	090-201401	090-201401	X1
28	RF Diverter Fitting	078-201408	078-201408	078-201408	078-201408	X1
29	Assembled Filter #1 THRU #28	096-201403	096-201404	096-201405	096-201406	X1