

IF YOU HAVE QUESTIONS OR CONCERNS, OR ARE MISSING PARTS.....
DO NOT RETURN SPRAYER TO THE STORE!
PLEASE CALL OUR CONSUMER HOTLINE AT 1-800-253-4642
Year-Round Mon.-Fri., 8 a.m. - 7 p.m. and
March 1 – August 31, Saturday and Sunday 10:00 a.m. to 4:00 p.m. ET
Or write us at: Root-Lowell Mfg. Co. · 1000 Foreman Rd. · P.O. Box 289 · Lowell, MI 49331
Visit us on the internet at: <http://www.rlflomaster.com>
e-mail: service@rlflomaster.com

RL FLOMASTER®

OPERATION AND SERVICE INSTRUCTIONS “NO PUMPING SPRAYERS”

MODELS: 2601, 2602, 2602HD, 2603, 2603HD, 2501, 2502, 2503,

WARNING!!! THIS PRODUCT IS DESIGNED TO SPRAY CHEMICALS THAT MAY BE HARMFUL AND COULD CAUSE SERIOUS PERSONAL INJURY IF INHALED OR BROUGHT INTO CONTACT WITH THE USER. FAILURE TO READ AND FOLLOW OPERATING INSTRUCTIONS BEFORE USE AND/OR MISUSE OF THIS PRODUCT COULD RESULT IN EXPLOSIVE FAILURE WITH MAJOR INJURIES.

- **ALWAYS** wear protective clothing, eye protection, and gloves.
- **ALWAYS READ AND FOLLOW** label instructions for chemicals to be applied.
- **AFTER USE** - release pressure, empty, and clean the sprayer.
- **RELEASE** pressure in sprayer before servicing.
- **DO NOT** alter sprayer.
- **DO NOT** spray gasoline or other flammables.
- **DO NOT** store liquids in tank.
- **DO NOT** leave sprayer in the sun.

If your sprayer is equipped with our new poly flow control, please assemble according to the following instructions:

1. Be sure to first insert pink siphon tube into hose insert otherwise sprayer will not operate.
2. Lubricate (with grease or petroleum jelly), the o-ring on the hose insert and slide into tank until fully seated.
3. Slide tank nut to threaded connection and securely screw onto tank.
4. Attach the flow control to the hose by unscrewing the flow control nut from the back of the flow control. Slide it directly onto the end of the hose.
5. Push the hose onto the back of the flow control all the way past the barb and up to the threads and screw together. Hand tighten only.
6. Push the extension rod into the flow control until it stops. Slide extension nut and o-ring to the flow control and screw together. Hand tighten only.

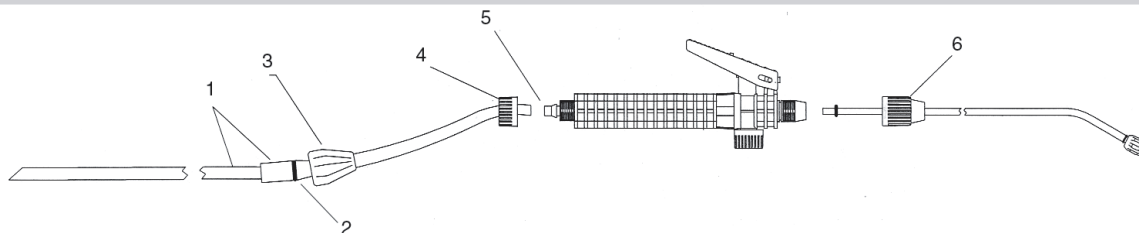

➔ OPERATING INSTRUCTIONS:

1. Remove the auxiliary pump from the tank by turning counter clockwise.
2. Read label and all instructions for chemicals to be applied. **Determine the proper ratio of concentrated chemicals to water and pour enough chemical into the sprayer to yield the amount of spray solution desired.**
3. Close tank by inserting pump assembly through opening. Turn clockwise until pump is sealed tightly into tank. Connect the RL Flo-Master Quick Connect fitting to your garden hose.
4. Turn the water “on”. Water will not flow through the Quick Connect fitting until it is pushed onto the special red tank adapter. Make sure the flow control is in the “off” position and the pump is screwed in tightly.
5. Push the Quick Connect fitting onto the red tank adapter until it snaps into place. Water will now flow into the tank, compressing the air trapped inside.
6. **When water reaches the desired level in the tank - CAREFUL NOT TO EXCEED MAXIMUM FILL LINE** - remove the Quick Connect by pulling back on the gray collar. Once the hose is removed, you are ready to spray. See note in Trouble

shooting Section. NOTE: If you re-pressurize using a water system, you will need to add more chemicals to maintain desired solution concentration.

7. If a pressurized water system is not available, use the auxiliary pump. When the sprayer is filled, about 20 strokes on the pump should supply enough pressure for spraying. Pumping may be needed if tank is only partially filled. As the fluid level goes down, more strokes may be needed. To work the pump, unlock pump handle from pump cap by turning counter clockwise, lock handle again by turning clockwise.
8. To start spraying, squeeze the spray control lever. Release pressure from the lever and the spray will stop.
9. If your sprayer has the poly flow control, lock "on" for continuous spraying by squeezing the lever and sliding the lever forward. If your sprayer has the brass control, lock it "on" by squeezing the lever and pull the lock lever back.
10. To depressurize the tank, turn the tank upside down. Depress the spray control lever until all the air pressure is gone.

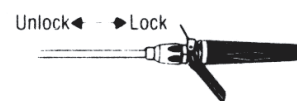

WARNING!!! To prevent ejected pump assembly and/or solution from striking and injuring you, never stand with face or body over the top of the tank when pumping or loosening pump.

11. Empty any remaining solution into a proper storage or disposal container. Do not store chemicals in the tank. If the chemical is stored in the tank, it can clog the system as it dries and it can promote corrosion.
12. Clean the sprayer after each use to prolong its life. After using water based products rinse thoroughly with water, being sure to flush out hose and flow control. After spraying solvent or oil based products, follow chemical manufacturers' recommended cleaning procedures.
13. To store the sprayer, hang the tank upside down with the pump removed and the flow control locked "on". This allows for proper drainage and drying.
14. Check for worn or damaged parts frequently.

➔ MAINTENANCE AND DISASSEMBLY:

To keep the pump working smoothly and efficiently, the plunger u-cup seal needs to be lubricated often. Disassemble pump, according to the instructions below for your model, and apply grease or petroleum jelly around the outside of the plunger cup. Note: Your sprayer was lubricated at the time of manufacture.

STRAIGHT NECK SPRAYER MODELS 2501, 2502, 2503:

Place the pump assembly on the edge of the table as shown and pull with downward motion. The assembly will snap apart when the tank cap strikes the table. To reassemble, insert the plunger assembly into the pump cylinder, resting the tank cap on top of the pump cylinder. Turn the assembly upside down and tap firmly on a hard surface to snap pump assembly back into place.

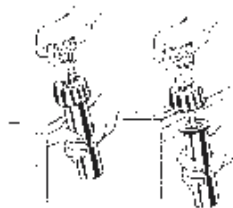

FUNNEL TOP SPRAYER MODELS 2601, 2602, 2602I, 2603, 1602:

Lay pump down on table. With flat blade screwdriver, push in on the tabs on each side of the pump and pry down. Pull up on the handle and the plunger assembly should come out of the pump cylinder. To reassemble, insert plunger assembly into cylinder and push the tabs back into place.

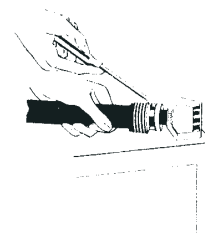

➔ **TROUBLESHOOTING:** Always depressurize the sprayer, remove chemical solution, and clean the sprayer before making repairs. Refer to the parts diagram for part numbers and names. Replacement parts may be purchased at most **RL FLO-MASTER** dealers, or they can be ordered from our Consumer Service Hotline at **1-800-253-4642**.

PROBLEM: Pump works hard or does not pressurize tank.

CAUSE: Plunger cup or plunger o-ring either not lubricated or damaged.

SOLUTION: Apply petroleum jelly around outside of plunger cup or plunger o-ring. Check for cracks or other damage and replace if necessary.

PROBLEM: Spray solution backs up through pump cylinder.

CAUSE: Check valve on bottom of pump cylinder prevented from sealing by dirt, residue, or damage.

SOLUTION: Remove pump cylinder and examine check valve. Clean if dirty. Replace if damaged.

PROBLEM: Hose leaks at tank connection.

CAUSE: (1) Hose/tank screw connector loose OR (2) Hose damaged.

SOLUTION: (1) Tighten screw connector - hand tighten only. OR (2) Cut off damaged section of hose and reassemble with gear clamp, or replace with new hose/flow control assembly.

PROBLEM: Flow control leaks.

CAUSE: (1) Extension o-ring prevented from sealing by dirt or damage OR (2) Extension nut not screwed in all the way on Accu-Spray flow control.

SOLUTION: (1) Clean and examine o-ring, replace if damaged OR (2) Push extension into flow control until it is fully seated. Then screw extension nut into flow control. Hand tighten only.

PROBLEM: Bad spray pattern or low spray volume.

CAUSE: Extension nozzle clogged with dirt or damaged.

SOLUTION: Remove nozzle and clean. Remove extension and clean. If extension cannot be unclogged, replace it.

PROBLEM: Nozzle leaks when flow control is closed.

CAUSE: (1) Extension o-ring prevented from sealing by dirt or damage. OR (2) Nozzle is worn.

SOLUTION: (1) Clean and examine o-ring, replace if damaged. OR (2) Replace nozzle cap.

PROBLEM: Leak at tank opening.

CAUSE: (1) Pump cylinder not sealed tightly into tank OR (2) Damaged cylinder gasket or o-ring OR (3) Residue build-up or dirt around cylinder gasket or o-ring.

SOLUTION: (1) Apply grease or petroleum jelly to cylinder gasket. Screw into pump tightly. OR (2) Thoroughly clean cylinder gasket or o-ring and surrounding area, then apply grease or petroleum jelly to cylinder gasket. OR (3) Replace with new gasket or o-ring.

REPAIR PARTS

PUMP ASSEMBLY

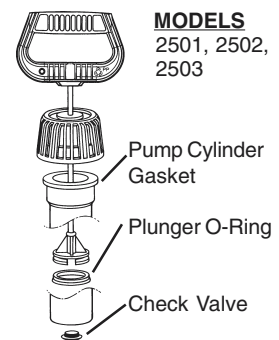
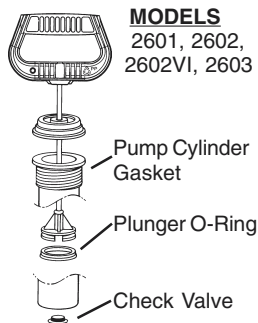
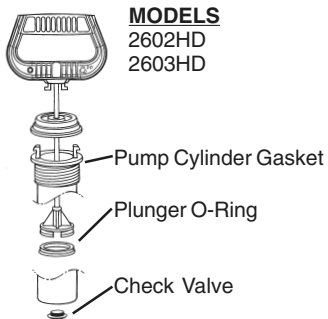

TANK

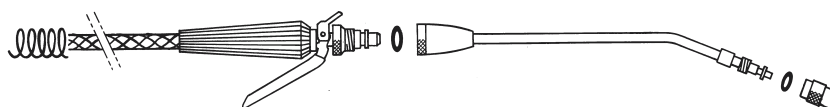
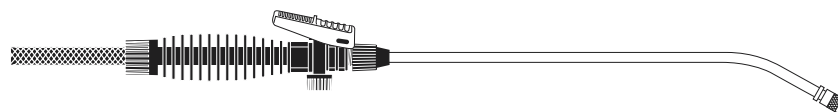
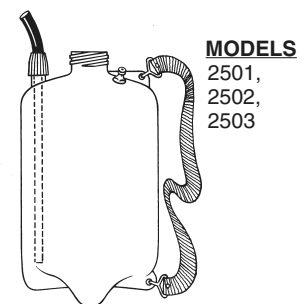
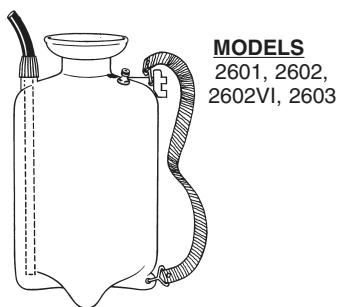
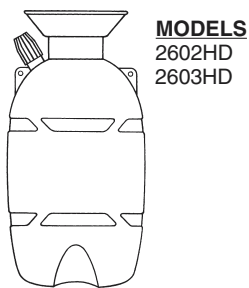

| DESCRIPTION | 2601 2602 2603 | 2501 2502 2503 | 1602 2602VI |
|---|----------------------|----------------------|----------------|
| Pump assembly | 942-802 | 942-662 | 942-812 |
| Soft goods kit (replacement seals, gaskets, plunger) | 1910RG | 1910RG | 1910FS |
| Poly flow control, hose, extension assembly - 2603HD only | 1913PB | 1913 | n/a |
| Brass flow control, hose, extension assembly | 942-400 | n/a | 942-360 |
| Strap(not included on all models) | 955-020 | 955-020 | 955-020 |
| Quick connect | 953-852 | 953-852 | 953-852 |
| Red adapter | 957-430 | 957-430 | 957-430 |
| Siphon tube | 956-390 | 956-390 | 956-390 |
| Nozzle cap kit | 942-111 | 942-111 | 942-111 |

LIMITED LIFETIME WARRANTY

Root-Lowell Manufacturing Co. warrants to the original purchaser only that this product will continue to function as intended if used in accordance with operating instructions (under *NORMAL CONSUMER USE*) for as long as the original purchaser owns the product. If the product fails to function as intended—**DO NOT RETURN IT TO THE STORE— call our CONSUMER SERVICE HOTLINE AT 1-800-253-4642 (toll free) for fast service.** We will, at our option, repair or replace any non-functioning parts without charge (shipping and handling charges will apply). Root-Lowell Manufacturing Co. shall have the option of requiring the return of the non-functioning product to the address listed below together with the proof of purchase to establish a claim under this warranty. This warranty does not apply to damage resulting from accident, misuse, neglect, alterations, operation not in accordance with instructions, commercial use, or normal wear of o-rings or seals.

ANY IMPLIED WARRANTIES, INCLUDING THE IMPLIED WARRANTY OF MERCHANTABILITY AND FITNESS FOR CONSUMER USE, ARE LIMITED TO THE DURATION SPECIFIED ABOVE. ROOT-LOWELL MANUFACTURING CO.'S LIABILITY IS LIMITED SOLELY TO THE REPAIR OR REPLACEMENT OF THE NON-FUNCTIONING PRODUCT OR PART. ROOT-LOWELL MANUFACTURING CO. EXCLUDES LIABILITY UNDER THIS WARRANTY FOR ANY AND ALL INCIDENTAL AND CONSEQUENTIAL LOSS OR DAMAGES.

Some states do not allow limitations on how long an implied warranty lasts, or the exclusion or limitation of incidental or consequential damages, so these limitations or exclusions may not apply to you. This warranty gives you specific legal rights and you may have other rights which vary from state to state.

IF YOU HAVE QUESTIONS OR CONCERNS, PLEASE CALL OUR CONSUMER SERVICE HOTLINE AT 1-800-253-4642 (Monday through Friday, 8:00a.m. to 5:00p.m. Eastern Time) or write: Root-Lowell Manufacturing Co. •Attn: Consumer Service•1000 Foreman Road•P.O. Box 289•Lowell, MI 49331

HELP PROTECT THE ENVIRONMENT. PLEASE USE CHEMICALS CAREFULLY, ACCORDING TO THE DIRECTIONS SPECIFIED BY THE CHEMICAL MANUFACTURER, AND DISPOSE OF THEM PROPERLY.

PLEASE DO NOT RETURN A SPRAYER TO THE STORE!!! CALL OUR CONSUMER HOTLINE 1-800-253-4642