

DASH SERIES COUNTERTOP SYSTEM INSTALLATION INSTRUCTION

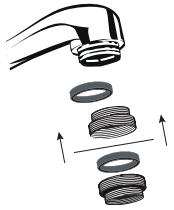

STEP 1. Remove Aerator from faucet on which filter will be installed.



STEP 2. Determine the type of threads on your faucet

External Threads: No adapter should be needed.

Internal Threads: Through trial and error, select the proper adapter and washer to screw into faucet and tighten manually.

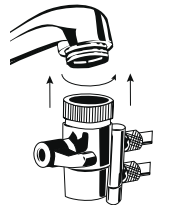

STEP 3. Screw the diverter valve onto the faucet, turning the swivel collar to tighten

Make certain that gasket (already installed in diverter valve) is positioned securely between the diverter valve and the faucet (or adapter). Rotate diverter valve stem to desired positions. Swivel collar may need to be re-tightened. Place assembly conveniently next to sink.



STEP 4. Turn on water and rotate lever

This causes the water to flow through the filter before exiting the faucet. To stop water flow to filter, rotate the lever back to turn water off.

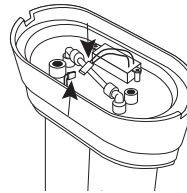

STEP 5. Connecting the filter replacement indicator circuit plug

After making sure the faucet adapter are connected properly, connect the two pin circuit plug to activate the filter replacement timer.

The LED in front of the system will blink a few times indicating that the timer has been activated.

Note:

- The included adapters are designed to fit most faucets. To create a tight seal, you may need to use the gasket from your faucet's aerator in addition to the washers included with the adapters. If the adapters do not fit, consult your local plumbing or hardware supplier for assistance in obtaining the correct thread adapter.
- To avoid damage to diverter valve finish cover with a rag if using pliers to tighten collar.
- A drinking water cartridge may contain carbon fines (Very fine black powder). After installation, flush the cartridge for 5 minutes to remove the fines before using the water.
- It is recommended that you run the tap at least 20 seconds prior to using water for drinking or cooking purposes.
- During initial use, your water may appear cloudy. This cloudiness is caused by air that has been trapped in the cartridge. If you let the water sit for 5 minutes in a glass, you will notice the cloudiness disappear from the bottom up. This phenomenon is not harmful.



You can also visit us online for system installation tutorial and support.
<http://www.aquasureusa.com/support>

SYSTEM START-UP

- Once the system has been connected, activate the systems filter cartridges by running water through the system for 3 - 5 minutes.
- Immediately check entire water filtration system for leaks. If you notice any leaks, turn off the faucet and fix the leak.
- Upon first use, you may notice some carbon fines. This is normal and will disappear during the 3 - 5 minute filter cartridge activation.



CAUTION! If installing the unit in new construction, ensure that house plumbing is flushed thoroughly before opening the water supply valve.

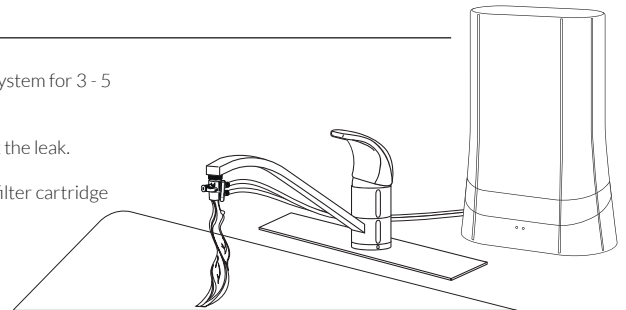

FILTER REPLACEMENT INSTRUCTIONS

STEP 1. OPEN SYSTEM
Remove cover and band

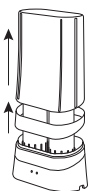

STEP 2. FLIP SYSTEM
Flip system and place in small bucket

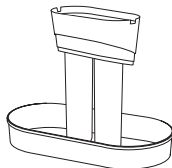

STEP 3. UNSCREW HOUSING
Remove cover and band

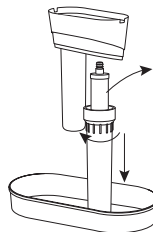

STEP 4. REPLACE FILTER
Replace with new filter

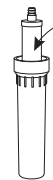

STEP 5. SCREW HOUSING
Screw back housing

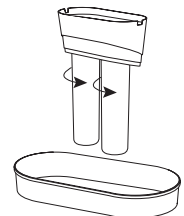

STEP 6. UNPLUG BATTERY
Unplug battery connector

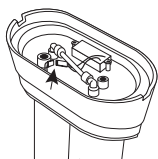

STEP 7. UNSCREW & REPLACE
Unscrew battery case and replace battery

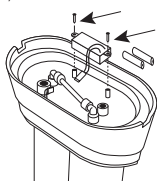

STEP 8. SCREW & PLUG
Screw back battery case and plug battery connector

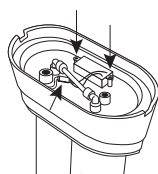

STEP 9. FLIP OVER & CLOSE
Flip system and replace band and cover

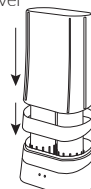

STEP 10. SYSTEM START-UP
Repeat system start-up and flushing steps.

