

Step 1:
Locate filter housing

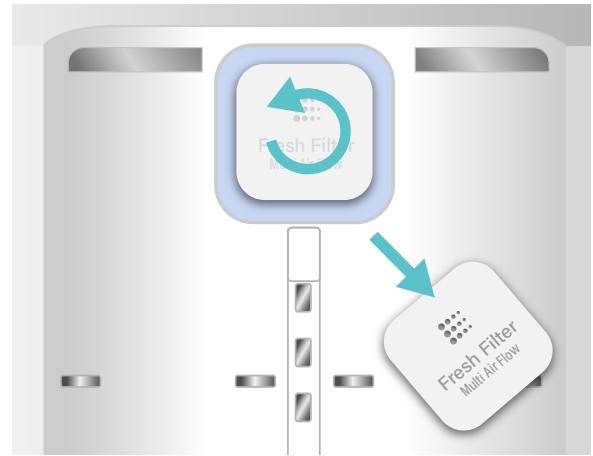

Step 2:
Remove the housing by turning it counter-clockwise

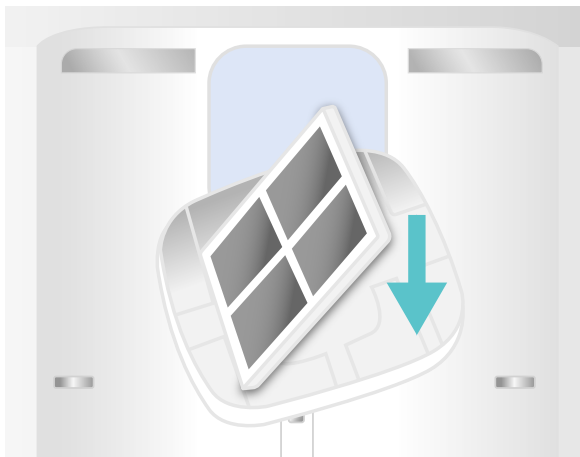

Step 3:
Replace the old filter with the new one - carbon facing outward

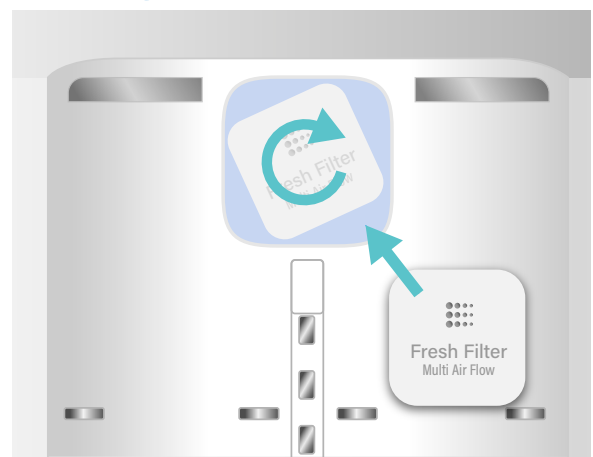

Step 4:
Replace the housing into the refrigerator by turning it in clockwise

FOR EASY REORDER
*use the camera app on your
smartphone to scan this QR code*



Use code **REORDER** for 10%
off of your next order

www.mistfilters.com



Installation Manual for
CWFF343 LT120F Air Filter