



Assembly Instructions and User Manual

POWER RISER



Technical Support

 engineering@versaproducts.com

Customer Service

 support@versadesk.com

 1 (800) 465-1660

I Preface

This electric sit-stand workstation consists of a desk frame, a keyboard tray and a motorized height adjustment system. Please read and completely understand this manual before installation in order to make sure the safe and correct use of the system and maintain the longevity of the overall construction and the built-in electronics.

Instructions of Safety and Warnings:

- Any failure to comply with the safety and installation instructions in this manual may cause serious bodily injury.
- Overlooking any part of the instructions, warnings and additional information marked with the "Note" and "⚠" may result in serious damage to the system or its components.
- Children should never be allowed to operate or touch the product without direct supervision of an adult. Users should prevent children from being near or around the workstation during operation.
- Disabilities and/or lack of experience and knowledge should be prevented from using the product unless under supervision or assisted during use and operation.
- Never sit on or exceed the rated weight of the workstation.



Electrical Safety Instructions:

The product is powered by electricity. In order to avoid burns, fire and electric shock, please read the instructions carefully.



Don't clean the product with water while the power is still connected.



Never operate the system if it's in moist environment or its electrical components have contact with liquids.



Don't disassemble or replace components while the power is still connected.



Don't operate the system if the control box makes noise or odor. Alterations of the given power unit and control box aren't allowed.



Never operate the system with a damaged cord or plug. Please contact your point of purchase to replace the damaged parts.



Other Safety Instructions:

- Remove any obstacles from the area around the workstation during assembly and subsequent use.
- Organize all cords and wires to prevent any possible accidents from occurring.
- Never attempt to modify or change the frame or components that operate the workstation.
- Don't add anything to the adjustable junctions of the frame.
- The workstation is rated for Indoor Use Only.



Disposal: The product with this mark indicates that this product shouldn't be disposed with other household wastes throughout the EU. To prevent possible harm to the environment or human health from uncontrolled waste disposal, recycle it responsibly to promote the sustainable reuse of material resources. To return your used device, please use the local recycle service or contact your point of purchase to withdraw the product.

Preparation

1 What are the specifications you need to know?



Worksurface
Weight Capacity
20kg (44lbs)



Keyboard Tray
Weight Capacity
2kg (4.4lbs)



Power Input
100-240V

2 What are the tools you require while installation?



Scissor



Phillips
Screwdriver

3 What's the thing you'd better have before installation?

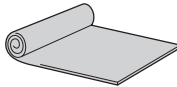

[A Shipping Blanket](#) to protect the workstation and the floor

4 Things you need to know before installation

Ensure that you have received all parts according to the component checklist prior to installation. If any of the components are missing or damaged, contact your local seller for a replacement.

Now let's start the installation.

Checklist and Installation

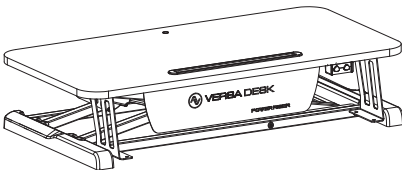

A (x1)

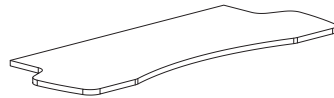

B (x1)

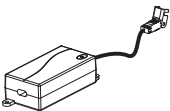

C (x1)



D (x3)



E (x2)



F (x4)



G (x1)



H (x4)
M5x8

- 1**  **WARNING: Do not press the release handle while cutting off the plastic strip lock. Only press the release handle in an upright position.**

Cut off plastic strip lock. Assemble power cables.

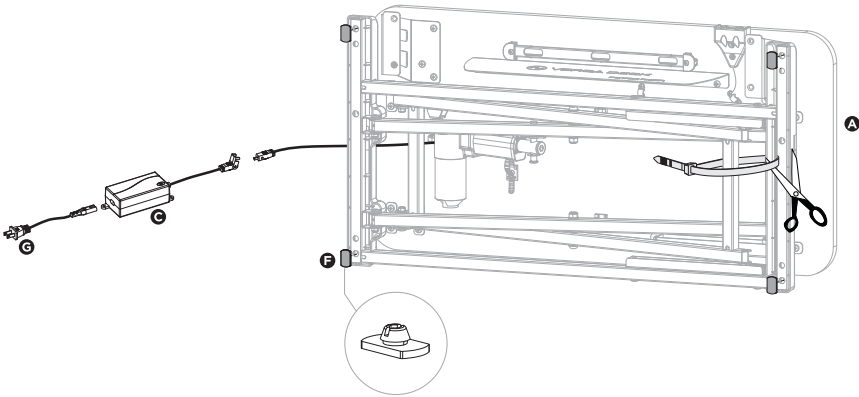

- 2** **Plug in power cable and raise desktop.**

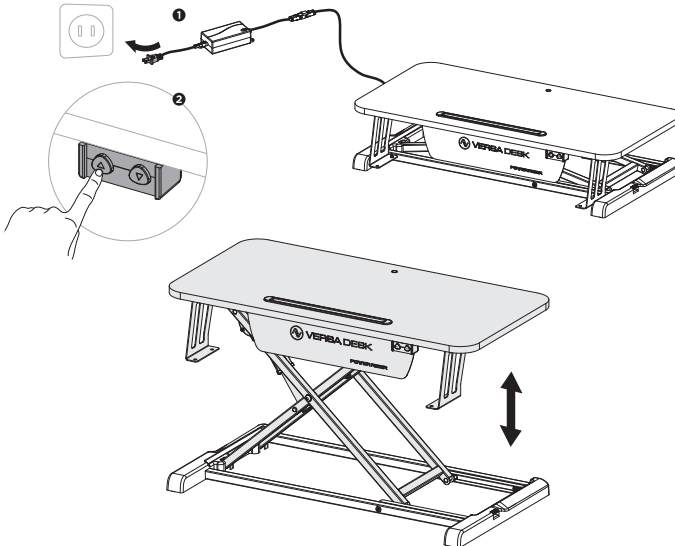

3 Apply protective padding on the underside of the keyboard tray.

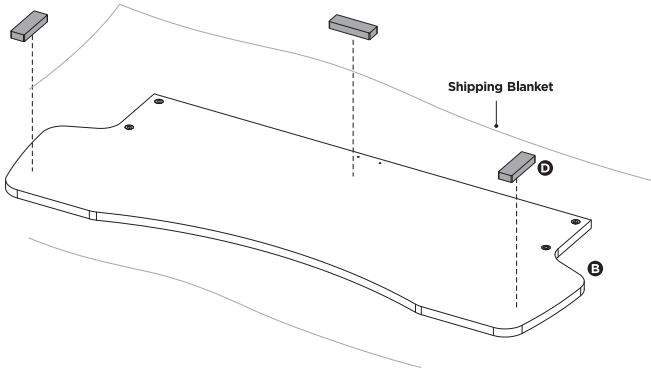

4 Slide in keyboard tray and attach it to the frame.

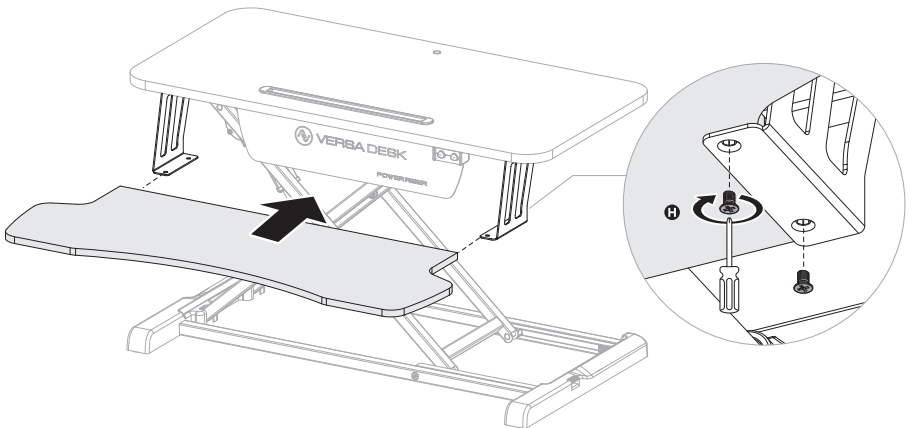

5 Apply cable organizers under desktop to neatly route cables.

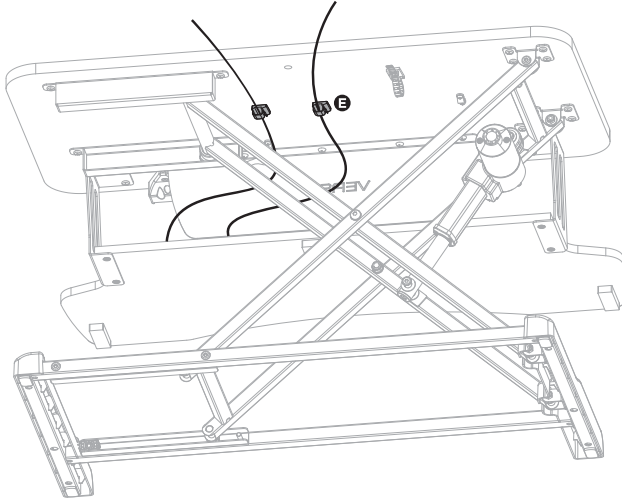

6 Use with any monitor stand and tablet



OR Attach a monitor arm by removing the plastic cap.

